



USING **YOUR BREWER**

OWNER'S MANUAL: Getting the most from your new Elite B40 Keurig® Brewer

COMMENT UTILISER VOTRE CAFETIÈRE

MANUEL D'UTILISATION : Tirez le meilleur de votre nouvelle cafetière Elite B40 de Keurig®



IMPORTANT SAFEGUARDS

Safe Operation & Use



When using electrical appliances, basic safety precautions should be followed, including the following:

1. Read all instructions before using.
2. Do not touch hot surfaces. Use handles and knobs when available.
3. This appliance must be properly installed and located in accordance with these instructions before it is used.
4. The use of accessory attachments not recommended by the appliance manufacturer may result in fire, electrical shock or injury to persons.
5. Do not place on or near a hot gas or electric burner, or in a heated oven.
6. Do not use outdoors.
7. To protect against fire, electric shock and injury do not immerse cords, plugs, or the appliance in water or any other liquid.
8. Do not overfill the Water Reservoir with water.
9. Use **only water** in this appliance! Do not put any other liquids or foods in the Water Reservoir except as instructed in the Cleaning Instructions in this guide.
10. Turn off and unplug the Brewer before cleaning or maintenance. Allow to cool before putting on or taking off parts and before cleaning the appliance.
11. For best operation, plug the appliance into its own electrical outlet on a dedicated circuit to prevent flickering of lights, blowing of fuses or tripping a circuit breaker.
12. Do not operate any appliance with a damaged cord or plug or after the appliance malfunctions or is damaged in any manner. Contact Keurig® Customer Service to report any malfunction of or damage to the Brewer.
13. Do not let the cord hang over the edge of the table or counter, or touch hot surfaces.
14. To disconnect, press the Power Button on the top of the Brewer to 'OFF' status and then remove the plug from the wall outlet.
15. Close supervision is necessary when any appliance is used by or near children.
16. **Do not lift the Handle to open the Lid of the Brewer while brewing is in progress.**
17. Always keep the Water Reservoir Lid on the Water Reservoir unless you are refilling it.
18. This appliance is equipped with a power cord having a grounding wire with a grounding plug. The appliance must be grounded using a 3-hole properly grounded outlet. In the event of an electrical short circuit, grounding reduces the risk of electrical shock.
19. If the outlet is a standard 2-prong wall outlet, it is your personal responsibility and obligation to have it replaced with a properly grounded 3-prong wall outlet.
20. Do not, under any circumstances, cut or remove the third (ground) prong from the power cord or use an adapter.
21. Consult a qualified electrician if the grounding instructions are not completely understood, or if doubt exists as to whether the appliance is properly grounded.
22. Do not use the appliance for other than its intended use.

**SAVE THESE
INSTRUCTIONS.**

CAUTION: There are two sharp needles that puncture the K-Cup® portion pack, one above the K-Cup Holder and the other in the bottom of the K-Cup Holder. To avoid risk of injury, do not put your fingers in the K-Cup Assembly Housing.

CAUTION: There is extremely hot water in the K-Cup Holder during the brew process. To avoid risk of injury, do not lift the Handle or open the K-Cup Assembly Housing during the brewing process.

SHORT CORD INSTRUCTIONS: A short power supply cord is provided to reduce the risk of becoming entangled in or tripping over a longer cord.

If an extension cord is used, (1) the marked electrical rating of the cord set or extension cord should be at least as great as the electrical rating of the appliance; (2) the cord should be arranged so that it will not drape over the countertop or tabletop where it can be pulled on by children or tripped over unintentionally; and (3) the extension cord must include a 3-prong grounding plug.

THIS PRODUCT IS FOR **HOUSEHOLD USE ONLY**.

WARNING THIS PRODUCT CONTAINS CHEMICALS, INCLUDING LEAD, WHICH IS KNOWN TO THE STATE OF CALIFORNIA TO CAUSE CANCER, BIRTH DEFECTS OR OTHER REPRODUCTIVE HARM.



WARNING
RISK OF FIRE OR
ELECTRIC SHOCK
DO NOT OPEN



WARNING: TO REDUCE THE RISK OF FIRE OR
ELECTRIC SHOCK, DO NOT REMOVE THE
BOTTOM COVER. NO USER SERVICEABLE
PARTS ARE INSIDE. REPAIR SHOULD BE DONE
BY AUTHORIZED SERVICE PERSONNEL ONLY.

TABLE OF CONTENTS

KEURIG® GOURMET SINGLE CUP HOME BREWING SYSTEM
Elite — Model B40
Using Your Brewer

SET-UP

Helpful Hints 4

Unpacking 4

Features 5

SECTION 1 — PRIMING & FIRST BREW

Priming & First Brew 6

SECTION 2 — CONTROLS & INDICATORS

Programming Auto Off Timer Feature 10

SECTION 3 — CLEANING & MAINTENANCE

Cleaning 10

De-Scaling 11

Storage 12

SECTION 4 — TROUBLESHOOTING 13

SECTION 5 — WARRANTY 14

Pour des directives en français, veuillez vous reporter à la page 15.

Record your Brewer Serial Number here.

Removing the serial number label from the Brewer will void warranty.

Set-up

Helpful Hints

1. Keep your Brewer turned 'ON' at all times.

To brew a fresh cup of coffee, tea or hot cocoa anytime you want, we suggest you keep your Brewer turned 'ON' all the time. However, you can set the Brewer to automatically turn off two hours after your last brew. Follow the simple instructions on page 10 to make using the Brewer convenient for you.

2. For the best tasting gourmet coffee, tea or hot cocoa Keurig® recommends using bottled or filtered water.

Water quality varies from place to place. If you notice an undesirable taste in your cup of coffee such as chlorine or other mineral taste, we recommend you consider using bottled water or water from a filtration system.

3. Customize the Size, Flavor & Brew That's Perfect for You.

With the choice of over 200 varieties of K-Cups and 2 brew sizes (Small Mug-7.25 oz. and Large Mug-9.25 oz.) your Keurig Brewer gives you endless options to customize the size, flavor and brew that's perfect for you. For a strong, intense cup, select an Extra Bold K-Cup (with up to 30% more ground coffee than regular

varieties) and brew size that's right for you. The smaller the brew size, the more intense flavor in your cup. The larger the brew size, the less intense flavor in your cup.

4. Plug Brewer into its own grounded outlet.

If the electric circuit is overloaded with other appliances, your Brewer may not function properly. The Brewer should be operated on its own circuit, separate from other appliances.

5. Brewing into a travel mug.

To brew into a travel mug, simply remove the Drip Tray Assembly and place the travel mug on the Drip Tray Base.

6. De-scale Brewer regularly.

Please see page 12 for instructions.

Unpacking Instructions

1. Place Brewer box on a large steady surface (such as a table or countertop) or on the floor. Open the box.
2. Remove enclosed literature.
3. Turn the box on its side with front of box face down.

4. Reach into the box and grasp the plastic bag that contains the Brewer.
5. Carefully pull the plastic bag (and packaging materials) toward you and out of the box. The Brewer will still be encased in the polyfoam and be on its side.
6. Remove the top polyfoam packaging material.
7. Carefully lift Brewer off of the bottom polyfoam and place it upright on a flat, steady surface.
8. Lift plastic bag off of Brewer.
9. Record the serial number for this Brewer on page 3 of this Guide. The serial number can be found on the bottom of this box or on the Brewer, behind the Drip Tray Assembly (when removed).
10. Place the Brewer upright on a flat, steady surface. Remove tape holding Water Reservoir in place.

We recommend you save all packing materials in case future shipping of the product is necessary.

WARNING:
Keep all plastic bags away
from children.

Features Elite — Model B40 Brewer

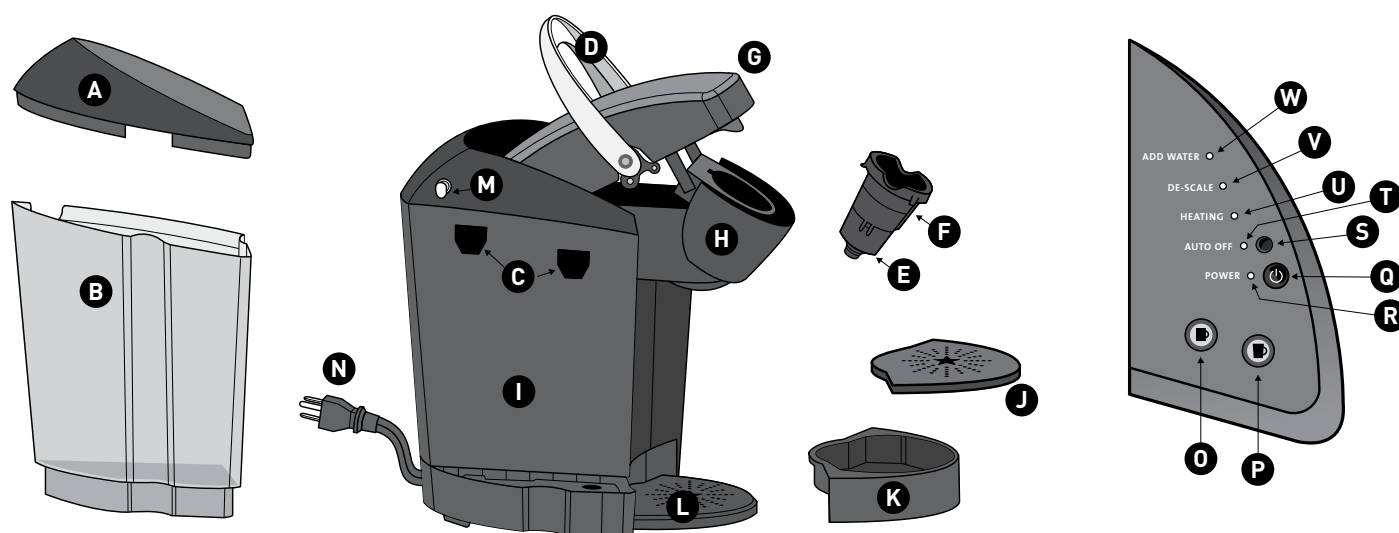

B40 Brewer

- A.** Water Reservoir Lid
- B.** Water Reservoir
- C.** Water Reservoir Lock Tab Slots
- D.** Handle
- E.** Funnel
- F.** K-Cup® Portion Pack Holder [E and F are the K-Cup Holder Assembly]
- G.** Lid
- H.** K-Cup Portion Pack Assembly Housing
- I.** Housing
- J.** Drip Tray Plate
- K.** Drip Tray
- L.** Drip Tray Base
- M.** Vent
- N.** Power Cord

Controls and Indicators

- O.** Small Mug Button
- P.** Large Mug Button
- Q.** Power Button
- R.** Power Light (Green)
- S.** Auto Off Button
- T.** Auto Off Light (Green)
- U.** Heating Light (Red)
- V.** De-Scale Light (Red)
- W.** Add Water Light (Blue)

SECTION 1 Priming & First Brew

IMPORTANT: You cannot use your Keurig® Brewer until it has been primed for its first use as set forth below.

NOTE: If Brewer has been exposed to temperatures below freezing, allow Brewer at least two hours to reach room temperature before priming. A frozen or extremely cold Brewer will not prime.



fig. 1

Priming Your Brewer

1. Unwrap cord and plug the Brewer into a grounded outlet. Remove all pieces of packing tape.
2. Place a Large Mug (10 oz. minimum) on the Drip Tray Plate.
3. Remove the Water Reservoir from Brewer by first removing Lid from Reservoir (fig. 1), then lifting Reservoir straight up and away from Brewer (may be tight). Rinse with fresh water.
4. Fill Water Reservoir with bottled or filtered water so that the water level reaches the line just below the top edge of the clear viewing area. (Be careful not to over fill.)

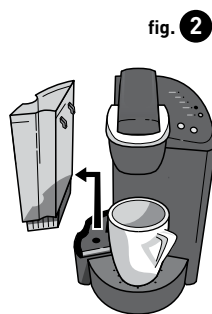

fig. 2

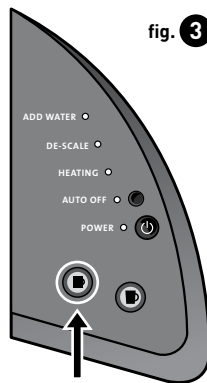

fig. 3

Small Mug

5. Place Water Reservoir base into the left side of the Brewer and be sure the Water Reservoir Lock Tabs engage with the Brewer (fig. 2). Replace Lid on Water Reservoir.
6. Press Power Button found on upper right panel of the Brewer. The green light next to the Power Button will become illuminated.
7. The red light next to 'DE-SCALE' on the LED Control Center will flash to indicate the Brewer needs to be primed. Make sure the Handle is all the way down before continuing. **NOTE: A K-Cup should not be used for the Priming Sequence.**
8. Press the flashing Small Mug Button. (fig. 3) **NOTE: If the Water Reservoir is empty or not in place on the Brewer, the blue light next to 'ADD WATER' on the LED Control Center will be illuminated. The Small Mug Button will not be activated until water is added to the Water Reservoir.**
9. The Brewer will automatically fill with water (priming it) and then the water will be heated. This will take about 3 minutes. During the heating period the red light next to 'HEATING' on the LED Control Center will become illuminated. Once the water is heated, the red light will turn off and the Small Mug Button will flash. **NOTE: Do not lift the Brewer Handle while priming.**

NOTE: You may see small amounts of water coming from the Vent and dripping into the Water Reservoir during this and subsequent heating – this is normal.

10. Press the Small Mug Button to start a cleansing brew. Pour the hot water into the sink.
11. The Brewer may take 15 seconds to reheat water between brews during which time the red light next to 'HEATING' on the LED Control Center may be illuminated. When the water has heated, the red light will turn off.
12. The one-time priming process is now complete and you are ready to brew!

Ready to Brew Your First Cup

fig. 4



1. The green light next to the Power Button on the LED Control Center will be illuminated to indicate the Brewer is powered on.
2. Place a cup or mug on the Drip Tray Plate.
3. Lift the Handle and the K-Cup Holder will open toward you. (fig. 4)
4. Select a K-Cup® portion pack.
NOTE: Do not remove the foil lid or puncture the K-Cup.
5. Place a K-Cup portion pack in the K-Cup Holder. (fig 5.)
CAUTION: There are two sharp needles that puncture the K-Cup, one above the K-Cup Holder and the other in the bottom of the K-Cup Holder



fig. 5



Small Mug
(7.25 oz.)

Large Mug
(9.25 oz.)

To avoid risk of injury, do not put your fingers in the K-Cup Holder.

6. Lower the Handle completely to close the Lid.
7. Select your brew size: The Small Mug choice will yield a 7.25 oz. serving and the Large Mug will yield a 9.25 oz. serving.

NOTE: If you do not push a Brew Button in 60 seconds, the Brew Buttons will be disabled to prevent accidental activation. Re-activate the Brew Buttons by raising and lowering the Handle completely.

8. The blue light behind the Brew Button you choose on the LED Control Center will remain lit while brewing.

CAUTION: There is extremely hot water in the K-Cup Holder during the brew process. To avoid risk of injury, do not lift the Handle or open the K-Cup Assembly Housing during the brew process.

9. There may be a short pause before the brewing process begins. The entire brew process lasts for approximately 1 minute and ends with a burst of air to remove all liquid from the K-Cup.
10. Lift the Handle, remove and dispose of the used K-Cup. **CAUTION:** K-Cup will be hot.
11. Enjoy your first cup of Keurig Brewed® gourmet coffee, tea or hot cocoa!

SECTION 1 First Brew

Brewing Your First Cup [Continued]

12. The red light next to 'HEATING' on the LED Control Center may be lit as the water is heated for the next brew cycle. The Brewer will be ready for use in approximately 15 seconds.

NOTE: Following the brew, your Brewer will fill in preparation for the next brew. The pump will make a vibrating sound. This is normal.

Stopping the Brew Process

If you need to stop the brewing after the process has started, press the Power Button to turn the Brewer 'OFF'. The flow of coffee or tea will stop, the heating element will shut off and the green light next to the Power Button will disappear.

NOTE: You may get less coffee, tea or hot cocoa in your cup during your next brew. We recommend that you perform a cleansing brew with water only after a terminated brew. Then your NEXT brew will be the proper volume.

Adding Water

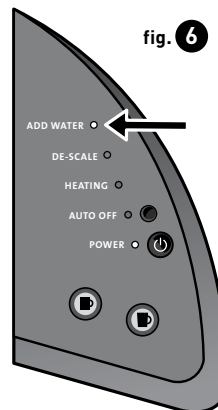

The LED Control Center of your Brewer will indicate when the water level in the Water Reservoir is low or if the Water Reservoir has been removed by illuminating the blue light next to 'ADD WATER' (fig. 6). The Brewer will not allow you to brew when the blue 'ADD WATER' light is illuminated.

The Water Reservoir can be filled in two ways.

1. Lift off the Water Reservoir Lid and pour water directly into the Water Reservoir while it is still attached to the Brewer, then replace the Lid.
2. Remove the Water Reservoir from Brewer by first removing Lid from the Water Reservoir, then lifting the Water Reservoir straight up and away from Brewer. Fill with water. Place the Water Reservoir back on the Brewer and replace the Lid.

IMPORTANT: Do not remove the Water Reservoir during the brewing process.

Brewing Hot Water

Your Brewer is able to produce hot water for making hot cocoa in a packet, for use in cooking, for making soups, etc. Simply raise and lower the Handle on the Brewer without adding a K-Cup® portion pack. The blue lights behind the Brew Buttons on the LED Control Center will flash. Be sure to have a mug or cup on the Drip Tray Plate and then press a Brew Button.

NOTE: After brewing a hot cocoa K-Cup, we recommend running a hot water brew cycle without a K-Cup.

Purging the Brewer

If your Brewer has not been used for more than one week, you should purge the water from the inner tank.

1. If there is water in the Water Reservoir, remove the Lid, then lift Reservoir straight up and away from Brewer. Discard water, rinse and refill with water. Place the Water Reservoir back on the Brewer and replace the Lid. (If there is no water in Reservoir, simply refill.)
2. Be sure the Brewer is turned on. Raise and lower the Handle on the Brewer without inserting a K-Cup and wait until the red light next to 'HEATING' turns off.

3. The blue lights behind the Brew Buttons on the LED Control Center will flash. Be sure to have a mug or cup on the Drip Tray Plate and then press a Brew Button.
4. Repeat steps 2 and 3 two more times to completely purge water from inner tank.

If you are experiencing any problems with your Brewer, please contact Customer Service at 1.866.901.BREW (2739).

SECTION 2

Controls & Indicators (LED Control Center)

Programming Auto Off Timer Feature

Set the Brewer to turn off two hours after the last brew.

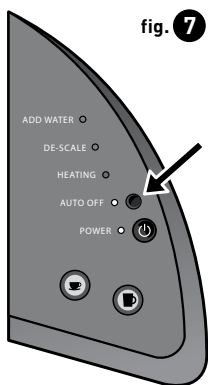

fig. 7

1. Press the Power Button to turn on the Brewer.
2. Press the black Button to the right of the 'AUTO OFF' text on the LED Control Center to turn on the Auto Off Timer feature (fig. 7) The green light next to 'AUTO OFF' will become illuminated. When the Auto Off Timer is enabled, your Brewer will automatically turn off two hours after your last brew.
3. To turn off the Auto Off Timer, simply press the black Button again and the green light next to 'AUTO OFF' will turn off.

SECTION 3

Cleaning & Maintenance

Cleaning External Parts

Regular cleaning of the Brewer's external components is recommended.

1. Never immerse the Brewer in water or other liquids. The Housing and other external components may be cleaned with a soapy, damp, non-abrasive cloth.
2. The Drip tray can accumulate up to 8 ounces of overflow. The Drip Tray and Drip Tray Plate should be periodically inspected and rinsed clean. To remove the Drip Tray Assembly, simply slide it toward you, keeping it level at all times to avoid spilling. The Drip Tray and Drip Tray Plate are dishwasher safe.

Cleaning the K-Cup Holder Assembly

fig. 8

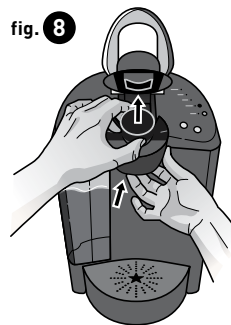

1. **Cleaning the Parts**—The K-Cup® Holder Assembly can be placed onto the top shelf of a dishwasher. **NOTE: Use low temperature cycles in the dishwasher.** To remove from the Brewer, open the cover by lifting the Handle. Grasp the top of the K-Cup Holder with one hand while pushing up on the bottom of the K-Cup Holder from underneath with the other until it releases (fig. 8). After cleaning, align the K-Cup Holder with the opening using the two front ribs as a guide and snap into place from the top.

fig. 9

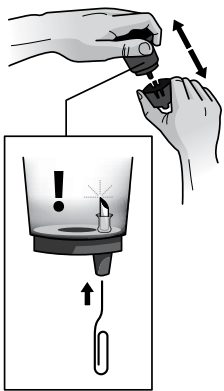

2. Cleaning the Funnel—The Funnel can be removed from the K-Cup Holder by pulling on it until it pops off (fig. 9). The Funnel is dishwasher safe. To replace it, just snap it back onto the K-Cup Holder Assembly.

3. Cleaning the Exit Needle—The Exit Needle is located on the inside bottom of the K-Cup Holder Assembly. Should a clog arise due to coffee grinds, it can be cleaned using a paper clip or similar tool. Remove K-Cup Holder assembly and detach Funnel. Insert the paper clip (as shown in fig. 9) into the Needle to loosen the clog and push it out. The K-Cup Holder is dishwasher safe.

CAUTION: There are sharp needles that puncture the K-Cup above the K-Cup Holder and in the bottom of the K-Cup Holder. To avoid risk of injury, do not put your fingers in the K-Cup Assembly Housing.

Cleaning the Water Reservoir & Water Reservoir Lid

The Water Reservoir Lid should be cleaned with a damp soapy non-abrasive cloth. Lid should **not** be put into the dishwasher. The Water Reservoir can be placed into the top shelf of the dishwasher (**use low temperature cycles**) for cleaning or can be cleaned with soapy water and rinsed thoroughly. Do not dry the inside of the Water Reservoir with a cloth as lint may remain.

CAUTION: Please rinse the Water Reservoir thoroughly after cleaning to ensure that no cleaners or cleaning solutions remain in this area as they may contaminate the water supply in the Brewer.

De-Scaling Your Brewer

fig. 10

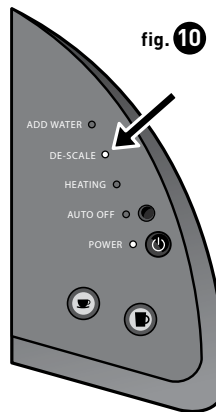

Mineral content in water varies from place to place. Depending on the mineral content of the water in your area, calcium deposits or scale may build up in your Brewer. Scale is non-toxic, but left unattended, it can hinder Brewer performance. De-scaling your Brewer helps maintain the heating element, and other internal parts of the Brewer that come in contact with water.

The Brewer should be de-scaled every 3-6 months to ensure optimal performance. It is possible for calcium deposits to build up faster, making it necessary to de-scale more often.

This Brewer is equipped with sensors to detect when scale buildup is interfering with

the performance of the Brewer. When this is detected, the red light next to 'DE-SCALE' will be illuminated. (fig. 10) However, even if the red light next to 'DE-SCALE' is not illuminated you should continue to de-scale your Brewer every 3 to 6 months.

You should promptly de-scale if 'DE-SCALE' is displayed on the LCD Control Center. Properly follow the de-scaling procedure described.

NOTE: The Brewer will continue to function even when 'DE-SCALE' is displayed. However, if you do not de-scale soon after it is displayed, continued scale build-up could damage the Brewer. If this occurs, 'DE-SCALE' will begin to blink to alert you to the potential damage to the Brewer if you do not de-scale immediately.

SECTION 3 Cleaning & Maintenance

De-Scaling Instructions

A. PREPARE

Step 1: Make sure you have at least 48 ounces of undiluted white vinegar on hand. You will also need an empty sink and a large mug (do not use a paper cup).

Step 2: Empty the water in the Water Reservoir.

Step 3: Disable Auto Off feature.

B. FILL AND CLEAN

Step 1: Pour the vinegar into the Water Reservoir to fill.

Step 2: Place a large mug on the Drip Tray Plate and run a water brew cycle. **DO NOT USE A K-Cup**, just press the Large Mug Button. Pour the contents of the large mug into the sink.

Step 3: Repeat the brew process 3 times.

Step 4: Now let the Brewer stand for at least 4 hours while still on.

C. RINSE

Step 1: Ensure the Water Reservoir is filled with fresh water.

Step 2: Place a large mug on the Drip Tray Plate and run a water brew cycle without using a K-Cup®. Pour the contents of the large mug into the sink.

Step 3: Repeat brew process until the Water Reservoir is empty.

Step 4: You may need to perform additional water brew cycles if you notice any residual taste.

NOTE: If the red 'DE-SCALE' light is still illuminated on the LED Control Center after completing the procedure, repeat the de-scaling procedure above.

Service

Beyond these recommended cleaning and maintenance procedures this Brewer is not user serviceable, for service please refer to the Warranty section of this guide.

Storage

Empty the Water Reservoir before storing and take care to ensure that you store your Brewer in a safe and **frost free** environment. Please be sure to store your Brewer in its **upright position** to avoid water leakage from the inner tank. If you store the Brewer in a cold environment, you run the risk of water freezing inside the Brewer and causing damage. When you prepare to use it after storage, we recommend rinsing the Water Reservoir with fresh water and running three cleansing brews without a K-Cup.

If you plan to move your Brewer to a different location, turn the Brewer off, unplug it and empty the Water Reservoir. If your Brewer has been in an environment below freezing, please be sure to let it warm to room temperature for at least 2 hours before using.

SECTION 4 Troubleshooting

Situation	Solution
Brewer does not have power	<ul style="list-style-type: none"> • Plug Brewer into an independent outlet. • Check to be sure that it is plugged in securely. • Plug into a different outlet. • Reset your home's circuit breaker if necessary. • Make sure that the Power Button has been turned on and the power light is illuminated.
Brewer will not brew when used for the first time	<ul style="list-style-type: none"> • The Brewer must be primed for use by filling the internal hot water tank before the first brew. The red light next to 'DE-SCALE' on the LED Control Center will flash. (refer to page 6) • If Brewer is cold/frozen, wait for at least two hours for it to reach room temperature before powering on.
Brewer will not brew	<ul style="list-style-type: none"> • After placing the K-Cup portion pack in the K-Cup Holder, make sure that the Handle is pushed down securely and the Blue lights behind the Brew Buttons on the LED Control Center are flashing. • If the blue light next to 'ADD WATER' on the LED Control Center is illuminated, add water to Water Reservoir or make sure the Water Reservoir is seated properly in its base. • If the blue light next to 'ADD WATER' on the LED Control Center continues to be on even after refilling, contact Customer Service at 1.866.901.BREW (2739).

Situation	Solution
Brewing a partial cup	<ul style="list-style-type: none"> • The Exit Needle may be clogged. (refer to page 11). • Clean K-Cup Holder if necessary and rinse under faucet. (refer to page 10). • The Water Reservoir may have been removed during brewing. Replace the Water Reservoir and perform a water brew without a K-Cup. • If the red 'DE-SCALE' light is illuminated, descale the Brewer (refer to page 11). • If you have repeated the de-scale procedure on your Brewer two times and it is still only brewing a partial cup, contact Customer Service at 1.866.901.BREW (2739).
Brewer shuts off automatically	<ul style="list-style-type: none"> • Check to make sure that the Auto Off Timer feature has not been set. If the green light next to 'AUTO OFF' on the LED Control Center is illuminated, press the black Button to turn off the Auto Off Timer feature.
If any problems persist, contact Customer Service at 1.866.901.BREW (2739)	

SECTION 5 Warranty

Limited One Year Warranty

Keurig® warrants that your Brewer will be free of defects in materials or workmanship under normal home use for one year from the date of purchase. It is recommended that you fill out and return the warranty card enclosed with your Brewer so that your purchase information will be stored in our system. Keurig will, at its option, repair or replace the Brewer without charge upon its receipt of proof of the date of purchase. If a replacement Brewer is necessary to service this warranty, the replacement Brewer may be new or reconditioned. If a replacement Brewer is sent, a new limited one year warranty will be applied to the replacement Brewer.

This warranty only applies to Brewers operated in the United States and Canada. This warranty gives you specific legal rights, and you may also have other rights that vary from state to state and, in the case of Canada, from Province to Province.

What is not covered by the Limited Warranty?

THIS WARRANTY DOES NOT COVER CONSEQUENTIAL OR INCIDENTAL DAMAGES SUCH AS PROPERTY DAMAGE AND DOES NOT COVER INCIDENTAL COSTS AND EXPENSES RESULTING FROM ANY BREACH OF THIS WARRANTY, EVEN IF FORESEEABLE. Some states or Provinces do not allow the exclusion or limitations of incidental or consequential damages, so the above limitation or exclusion may not apply to you depending on the state or Province of purchase.

Nor does this warranty cover damages caused by services performed by anyone other than Keurig or its authorized service providers, use of parts other than genuine Keurig parts, or external causes such as abuse, misuse, inappropriate power supply or acts of God.

Other Limitations

THIS WARRANTY IS EXCLUSIVE AND IS IN LIEU OF ANY OTHER EXPRESS WARRANTY, WHETHER WRITTEN OR ORAL. IN ADDITION, KEURIG HEREBY SPECIFICALLY DISCLAIMS ALL OTHER WARRANTIES WITH RESPECT TO YOUR B40 BREWER, INCLUDING ANY IMPLIED WARRANTY OF MERCHANTABILITY OR FITNESS FOR ANY PARTICULAR PURPOSE. Some states or Provinces do not allow disclaimers of such implied warranties or limitations on how long an implied warranty lasts, so the above limitation may not apply to you depending on the state or the Province of purchase.

How do you obtain warranty service?

Keurig Brewers are high quality appliances and, with proper care, are intended to provide years of satisfying performance. However, should the need arise for warranty servicing, simply call Keurig Customer Service at our toll free phone number 1.866.901.BREW (2739). Please do not return your Brewer for servicing without first speaking to Keurig Customer Service to obtain an Authorization to Return number (ATR). Keurig Brewers returned without an ATR number will be returned to the sender without servicing.

Keurig, Incorporated
55 Walkers Brook Drive
Reading, MA 01867
1.866.901.BREW (2739)

Keurig, Incorporated
55 Walkers Brook Drive
Reading, MA 01867

Keurig, Incorporated is a wholly-owned subsidiary of
Green Mountain Coffee Roasters, Inc.

Keurig Incorporated est une filiale à 100% de
Green Mountain Coffee Roasters, Inc.

CLICK, CALL OR SHOP | www.keurig.com | 1.866.901.BREW | At over 10,000 stores in US and Canada



For Household Use Only

Covered by U.S. Patent Numbers 7,398,726, 7,165,488,
7,347,138, D513,572, 7,377,162, D544,299, 7,360,418 and
other U.S. and foreign patents pending

©KEURIG INCORPORATED

Made and printed in China

Pour usage domestique seulement

Protégé par les brevets Numéros 7398726, 7165488,
7347138, D513572, 7377162, D544299, 7360418 et autres
brevets des États-Unis et étrangers en instance.

©KEURIG INCORPORATED

Fabriqué et imprimé en Chine



© 2008 Keurig, Incorporated
Tous droits réservés. All rights reserved.