



Navigator™ Pet Pro  
Upright Vacuum

ZERO-M

It's important to read this instruction book prior to using your new product for the first time.

## IMPORTANT SAFETY INSTRUCTIONS

FOR HOUSEHOLD USE ONLY - PLEASE READ CAREFULLY BEFORE USE

If the plug does not fit fully into the outlet, reverse the plug. If it still does not fit, contact a qualified electrician. DO NOT force into outlet or try to modify to fit.

### WARNING

To reduce the risk of fire, electric shock, injury, or property damage:

#### GENERAL WARNINGS

1. Your vacuum cleaner may contain or be made of plastic, wood, metal, and/or other materials. These materials may absorb oil and grease, and may be damaged by oil and grease. Do not use the vacuum cleaner on oily or greasy surfaces.
2. Use only cordless and battery-powered vacuum cleaners.
3. Carefully observe and follow the instructions provided below to avoid fire, electric shock, injury, or property damage. DO NOT use the vacuum cleaner on any surface other than those covered in this manual.
4. The vacuum cleaner is not a toy. Do not use it for anything other than cleaning. DO NOT use it for anything other than cleaning.
5. The use of an extension cord is NOT recommended.
6. The vacuum cleaner is not a toy. Do not use it for anything other than cleaning.

#### USE WARNINGS

7. DO NOT allow the vacuum cleaner to be used by children. Children may become entangled with the cord or the vacuum cleaner.
8. Always turn off the vacuum cleaner before unplugging it and disconnecting any electrical wiring. Wait at least 30 seconds before unplugging.
9. DO NOT handle a plug or vacuum cleaner with wet hands.
10. DO NOT use the vacuum cleaner on any surface other than those covered in this manual.
11. Do not use the vacuum cleaner on any surface other than those covered in this manual.
12. DO NOT damage the power cord.
  - a) DO NOT use the vacuum cleaner on any surface other than those covered in this manual.
  - b) DO NOT touch the plug or the cord while the vacuum cleaner is plugged in.
  - c) DO NOT use the vacuum cleaner on any surface other than those covered in this manual.
13. DO NOT use the vacuum cleaner on any surface other than those covered in this manual.
14. DO NOT use the vacuum cleaner on any surface other than those covered in this manual.
15. Keep the cord and the vacuum cleaner away from heat, fire, and other sources of heat.
16. DO NOT use the vacuum cleaner on any surface other than those covered in this manual.

To reduce the risk of electric shock, this appliance has a polarized plug (one blade is wider than the other). This plug will fit in a polarized outlet only one way. If the plug does not fit fully in the outlet, reverse the plug. If it still does not fit, contact a qualified electrician to install the proper outlet. Do not change the plug in any way.

## SAVE THESE INSTRUCTIONS

### ASSEMBLY

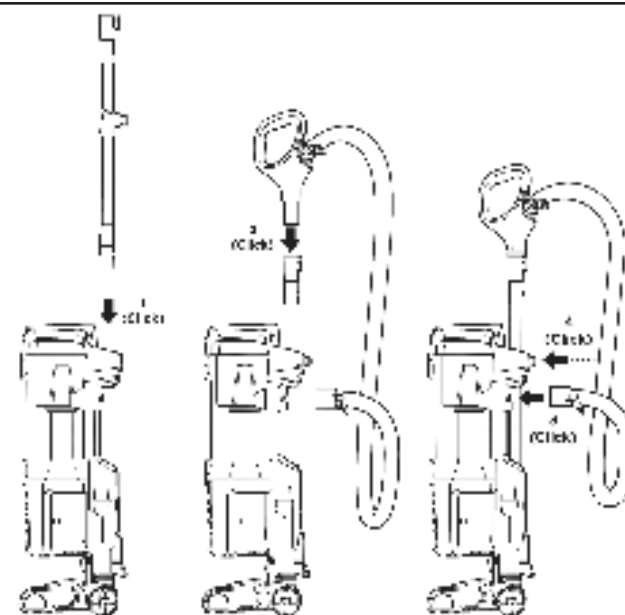

1. Insert power cord into the back of the vacuum.
2. Insert handle into the top of the vacuum.
3. Attach hose to the back of the vacuum.
4. Attach the hose to the clip on the wall.
5. Store accessories on local storage hooks.

For proper operation, ensure all parts are fully clicked into place.

NOTE: Accessories may vary depending on the model. Refer to quick guide, if available.

\*The image shown here is for illustrative purposes only and may be subject to change.

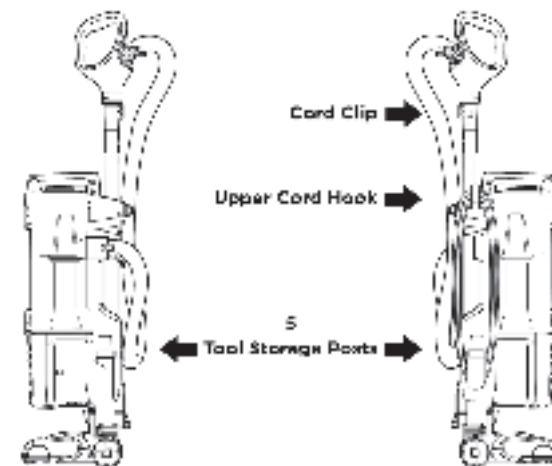

### POWER CORD



For cord access, rotate upper cord hook down and remove cord.



Use cord clip located on the side of wand to hold cord in place while vacuuming.

### WHOLE-HOME CLEANING

#### SETTINGS

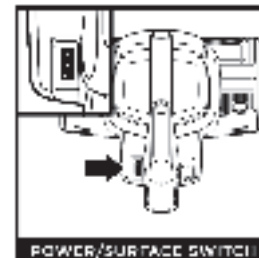

- Power/Surface Switch
- I Hard Floor: For bare floors and sealed hardwood.
  - II Carpet: For carpets.

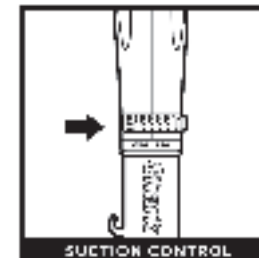

Your Dust on Demand slider located on the top of the handle allows you to adjust suction power depending on your floor type.

NOTE: To reduce suction and increase maneuverability on carpets, turn the slider down.

#### BRUSHROLL INDICATOR LIGHT

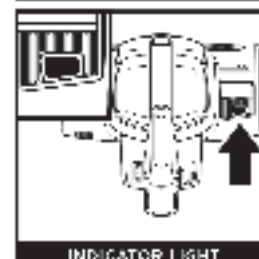

#### WHAT DOES THE BRUSHROLL INDICATOR LIGHT MEAN?

**Blinking Green:** The brushroll is spinning and working as it should.

**Solid Red:** There is a jam in the brushroll area. Turn your vacuum off, unplug from the wall and remove any blockages in the motor.

**Flashing Red:** The motor and floor nozzle is overheating. Turn your vacuum off and wait a minimum of 15 minutes before trying again.

NOTE: The indicator light is not a safety feature. It is only a warning light. It does not indicate a safety hazard.

#### CLEANING MODES



To engage brushroll, place foot on floor nozzle and tilt handle back.



Press the Handle Release button to detach the handle from the wand.



Press the Wand Release button to detach the wand from the reel.

NOTE: All accessories are compatible with both the wand and the handle.

### EMPTYING THE DUST CUP



**IMPORTANT:** Turn off the power and unplug the vacuum before performing maintenance.



To remove Dust Cup, press button on top of dust cup handle. It will snap forward then lift to remove.



Press power release button to open bottom of dust cup.

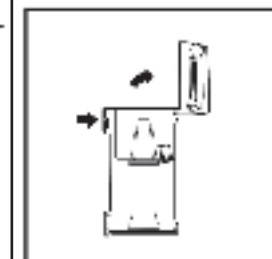

To remove collected debris from Limit Screen, use a screwdriver to lift and tilt handle to open. Gently brush the screen to clean.

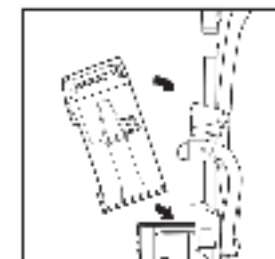

To remove, slide the limit screen into position and then tilt back until it clicks into place.

### CLEANING AND REPLACING THE FILTERS

#### CLEANING FILTERS

Regularly clean and replace your filters to keep your vacuum's suction power optimal.

To clean filters, remove the handle from the vacuum and clean the filters. Do not use any tools to clean the filters. Do not use any tools to clean the filters.

**IMPORTANT:** DO NOT use soap when cleaning the filters.

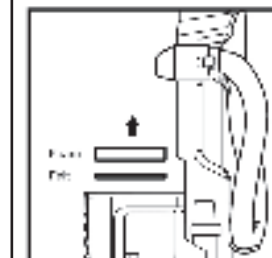

CLEAN PRE-MOTOR FILTERS EVERY 3 MONTHS  
Remove Dust Cup from Front Filter.

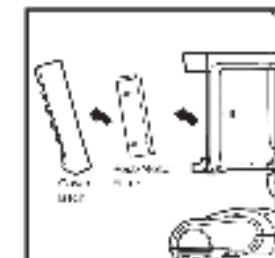

CLEAN HEPA FILTER EVERY YEAR  
Press down on Filter Door. Lift Filter Door and lift out Press tab at top of HEPA Filter and pull away from the base of the vacuum. To replace, insert HEPA filter into unit and push back to filter door.

#### REPLACING FILTERS

Follow the steps below for replacing filters. The Pre-Motor Filter should be replaced every 3 months. The HEPA Filter should be replaced every 1 year.



Replacement Pre-Motor Foam & Felt Filter Kit

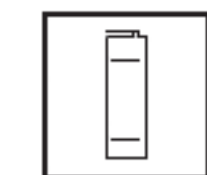

Replacement HEPA Filter

## MAINTENANCE

### Zero-M Technology

ZERO-M

Shark® Zero-M™ self-cleaning is ideal for low- and mid-pile carpet and light to medium weight hard floor surfaces. It is designed to remove dirt and debris from the carpet and hard floor surfaces. It is not designed to remove heavy debris or large objects from the carpet.

**NOTE:** Do not be alarmed if there is visible hair wrap on the brushroll at any given time, as it should eventually make its way to the dust cup.

#### CLEANING THE BRUSHROLL

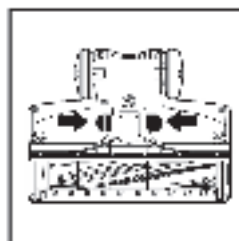
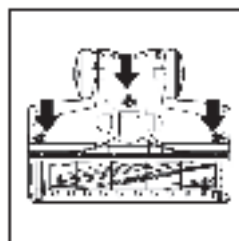

As the unit turns, debris collects on the sides. Then lift the roller to access Brushroll.

#### DEBRIS WRAPPED AROUND BRUSHROLL

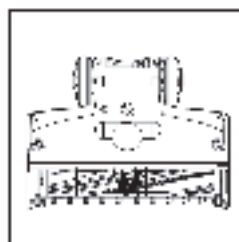

Clean off long hairs on the brushroll.

**NOTE:** Long hair can cause wear on the brushroll. If you notice a lot of hair on the brushroll, it is recommended to clean the unit. Follow Zero-M Technology instructions for cleaning the unit. If you notice a lot of hair on the brushroll, it is recommended to clean the unit. Follow Zero-M Technology instructions for cleaning the unit.

#### DEBRIS BEHIND BRUSHROLL



If you run over a hard or sharp object, or notice a noise change while vacuuming, check for blockages or objects caught behind the brushroll.

Clean away any dust and debris that has gotten behind the brushroll.

To check the cover, push down until it clicks into place, then slide the handle with a coin.

## CHECKING FOR BLOCKAGES

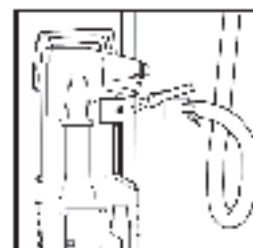

Detach hose from extension cord, and check hose and opening on back of unit for blockages.



Detach wand from motor and handle, and check both ends for blockages.

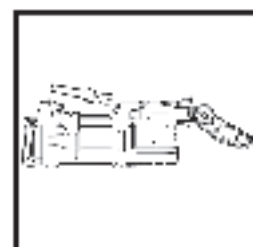

Detach wand from extension cord, and check wand and opening on back of unit for blockages.



Detach wand from motor and handle, and check both ends for blockages.

### TECHNICAL SPECIFICATIONS

Voltage: 120V, 60Hz  
Amps: 9.5A

\*The image shown here is for illustrative purposes only and may be subject to change.

## CHECKING FOR BLOCKAGES CONT...

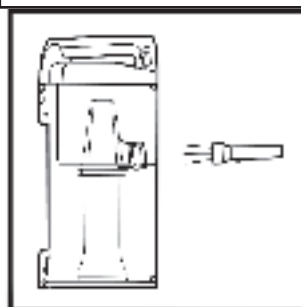

Detach dust cup from extension cord. Empty dust cup, remove debris from lint screen, and check for blockages.

## TROUBLESHOOTING

### Vacuum is not picking up debris. No suction or light suction.

- Check filters to see if they need cleaning. Follow instructions for rinsing and air drying the filters before reinserting in the vacuum.
- Dust cup may be full. Empty dust cup.
- Check hose, hose connections, nozzle, wand, pole, and accessories for blockages. Use any other keeps free.

(Refer to Troubleshooting for more information.)

- Long string, carpet fibers, or hair is wrapped around the brushroll. Use a clean cloth to remove it. If some hair or fibers remain wrapped around brushroll after unit has used, remove the floor nozzle, move it carefully and slowly with scissors and remove from brushroll. See Cleaning the Brushroll section for more information.

### Vacuum lifts area rugs.

- Make sure Power/Surface switch is set to Hard Floor (setting 1).
- Suction is powerful. Take care when vacuuming area rugs or rugs with doctably down edges.

### Brushroll does not spin in carpet cleaning mode.

- If the Brushroll Indicator Light turns red, immediately turn off and unplug the vacuum. Remove and inspect floor nozzle for any blockages. Detach and clean, plug in vacuum, and turn on power.
- With the power on, recline the handle, which will automatically turn on the brushroll.
- Ensure that the Power/Surface switch is set to Carpet (setting 2) for brushroll to spin.

### Vacuum turns off on its own or indicator light flashes red.

This vacuum is equipped with a motor-protected thermostat. If your vacuum overheats, the thermostat will automatically turn the suction motor off. Perform the following steps to restart the thermostat:

1. Turn vacuum off and unplug it.
2. Empty dust cup and clean filters (see Emptying the Dust Cup and Cleaning the Filters).
3. Check for blockages in hose, accessories, and inlet openings.
4. Allow unit to cool for a minimum of 45 minutes.
5. Plug in vacuum and turn it on.
6. Restart the unit with the Power/Surface switch.

### PLEASE READ CAREFULLY AND KEEP FOR FUTURE REFERENCE.

SharkNinja Operating LLC

Illustrations may differ from actual product. We are constantly striving to improve our products; therefore the specifications contained herein are subject to change without notice.

For SharkNinja U.S. Patent Information, visit [www.sharkninja.com/USPatents](http://www.sharkninja.com/USPatents)

© 2012 SharkNinja Operating LLC. SHARK and SHARK NAVIGATOR are registered trademarks of SharkNinja Operating LLC. NAVIGATOR and ZERO-M are trademarks of SharkNinja Operating LLC.

804109574



PRINTED IN MEXICO / SC: 18.10.2019  
OBPN:ZU60Series\_IB\_E\_MP\_Mv4\_181218  
SHNMDL:ZU60\_B / TAB/ Elbrd:J.E.

W



Please be sure to read the enclosed Shark® Owner's Guide prior to using your unit.

# Shark® Navigator™ Pet Pro

ZERO-M™  
CLEANER HEAD

## QUICK START GUIDE

### WHAT'S INSIDE

- 1 Vacuum
- 2 Handle & Hose
- 3 Motor
- 4 Extra dust cup
- 5 Extra dust cup
- 6 Dusting brush

### ASSEMBLY

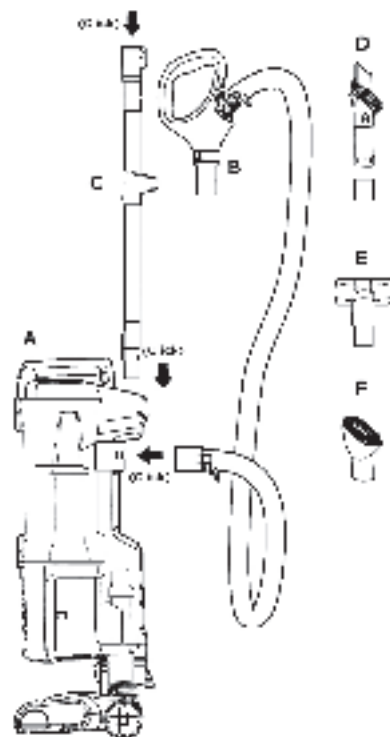

NOTE: For proper operation, ensure all parts are firmly **CLICKED** into place.

### EMPTYING THE DUST CUP

Empty the dust cup after each use.

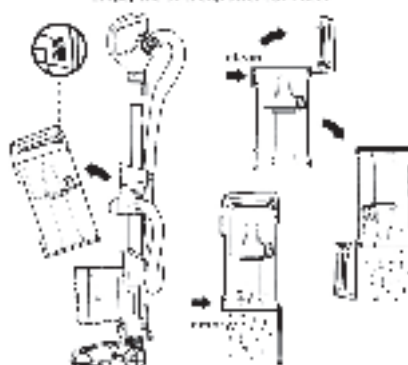

### MAINTENANCE

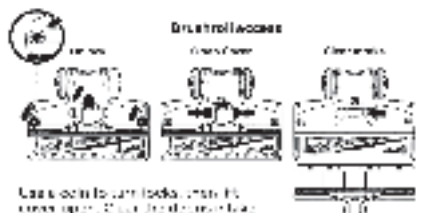

Look for the dust cup and the filter. Clean the dust cup and the filter. Reattach the dust cup and the filter.

## 2 WAYS TO CLEAN

### FLOOR CLEANING

**SUCTION CONTROL**  
Adjust your suction depending on the floor type.  
MIN: to reduce suction for low pile carpet.  
MAX: to increase suction on bare floors.

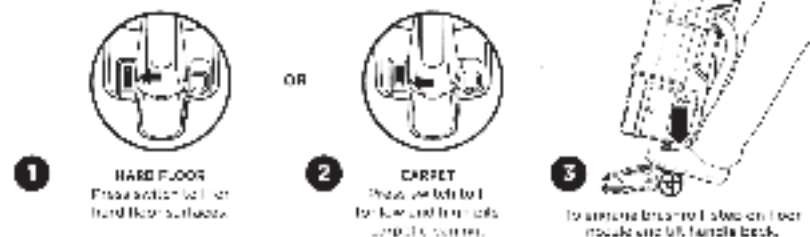

### ABOVE-FLOOR CLEANING

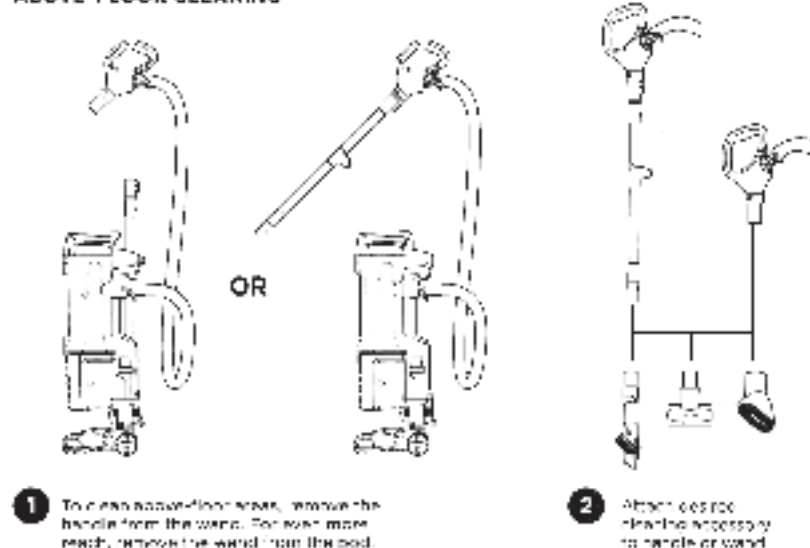

\*Accessories may vary depending on the model.

\* The image shown here is for illustrative purposes only and may be subject to change

804009735



PRINTED IN MEXICO  
SC:26.02.2020 / 1P / Elbrd: J.E  
OBPN:ZU62\_QSG\_MP\_Mv3\_181212  
SHNMDL:ZU62\_B

## IMPORTANT SAFETY INSTRUCTIONS

FOR HOUSEHOLD USE ONLY • PLEASE READ CAREFULLY BEFORE USE

If the plug does not fit fully into the outlet, reverse the plug. If it still does not fit, contact a qualified electrician. DO NOT force into outlet or try to modify to fit.

### WARNING

To reduce the risk of fire, electric shock, injury, or property damage:

#### GENERAL WARNINGS

1. Your vacuum is not a toy. Do not allow children to play with it. Do not use it for anything other than cleaning.
2. Use only identical replacement parts.
3. Carefully observe and follow the instructions for the use of the vacuum. DO NOT use the vacuum for any purpose other than those described in the manual.
4. To prevent possible electric shock, do not use the vacuum near water. DO NOT use it near or in water.
5. The use of an extension cord is NOT recommended.
6. The vacuum cleaner contains no serviceable parts.

#### USE WARNINGS

7. DO NOT allow the appliance to be used in the manner of a power tool or in any other manner that may be dangerous.
8. Always turn off the vacuum cleaner before connecting or disconnecting the power cord. Do not use the vacuum cleaner.
9. DO NOT handle plug or vacuum cleaner with wet hands.
10. DO NOT remove or tamper with the power cord or the filter.
11. Only use the cord and the filter and accessories. Failure to do so will void the warranty.
12. DO NOT remove the power cord.
  - a) DO NOT use the vacuum cleaner if the power cord is damaged or frayed.
  - b) DO NOT use the vacuum cleaner if the power cord is frayed or damaged.
  - c) DO NOT use the vacuum cleaner if the power cord is frayed or damaged.
13. DO NOT put any objects into the vacuum cleaner. DO NOT use the vacuum cleaner to clean anything other than the floor.
14. DO NOT use the vacuum cleaner to clean anything other than the floor.
15. Use the vacuum cleaner only on hard floors. Do not use it on carpet.
16. DO NOT use the vacuum cleaner to clean anything other than the floor.

To reduce the risk of electric shock, this appliance has a polarized plug (one blade is wider than the other). This plug will fit in a polarized outlet only one way. If the plug does not fit fully into the outlet, reverse the plug. If it still does not fit, contact a qualified electrician to install the proper outlet. Do not change the plug in any way.

## SAVE THESE INSTRUCTIONS

### ASSEMBLY

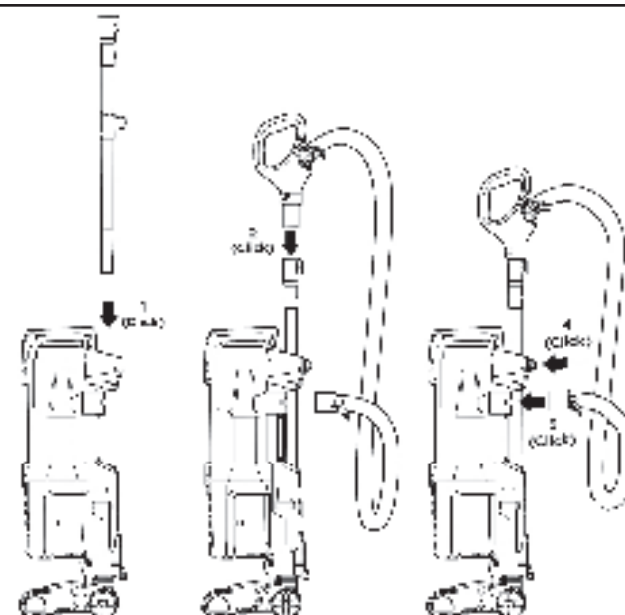

1. Insert cord into cord clip.
2. Insert cord into cord clip.
3. Attach cord to back of vacuum body.
4. Attach cord to back of vacuum body.

For proper operation, ensure all parts are firmly attached to the body. The image shown here is for illustrative purposes only and may be subject to change.

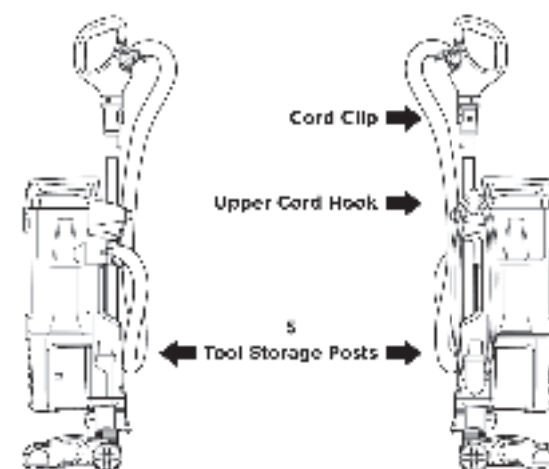

### POWER CORD



For cord access, rotate upper cord hook down and remove cord.



Use cord clip located on the side of wand to hold cord in place while vacuuming.

### WHOLE-HOME CLEANING

#### SETTINGS

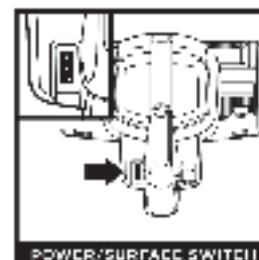

#### POWER/SURFACE SWITCH

Select surface setting:

- I Hard Floor
- II Carpet

For details, see the user manual.

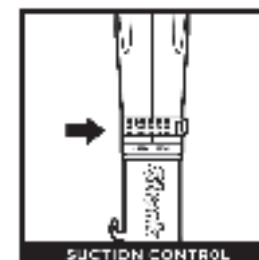

#### SUCTION CONTROL

Turn Suction Control dial located on the top of the handle to select suction level according to the floor type.

MIN: Low suction power for delicate surfaces.

MAX: High suction power for hard floors.

#### BRUSHROLL INDICATOR LIGHT

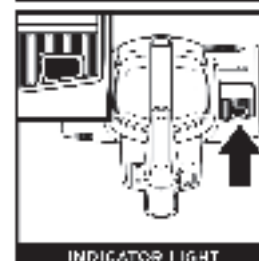

#### INDICATOR LIGHT

WHAT DOES THE BRUSHROLL INDICATOR LIGHT MEAN?

**Solid Green:** The brushroll is spinning and working as it should.

**Solid Red:** There is a jam in the brushroll area. Turn your vacuum off, unplug it, and remove any blockages in the motor.

**Flashing Red:** The motor will not start or is overheating. Turn your vacuum off and wait a minimum of 45 minutes before trying again.

NOTE: For details, consult the 40TH T800 Series Owner's Manual, which is available at [www.sharkvac.com](http://www.sharkvac.com).

### CLEANING MODES



#### UPRIGHT

To engage brushroll, place foot on front of wand and lift handle back.



#### ABOVE-FLOOR—HANDLE

Press the Handle Release button to detach the handle from the wand.

\*Note: Your quick guide shows the accessories that are included with your model. The images shown here are for illustrative purpose only and may be subject to change.



#### ABOVE-FLOOR—WAND

Press the Wand Release button to detach the wand from the pod.

### EMPTYING THE DUST CUP



**IMPORTANT!** Unplug the power cord before performing any maintenance.



#### TO REMOVE DUST CUP, UNPLUG THE POWER CORD, AND PULL THE DUST CUP FORWARD.

Push down on the handle to open the bottom of the dust cup.

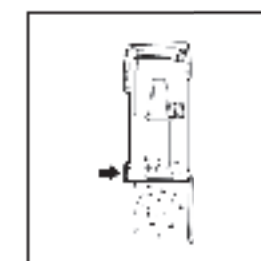

#### TO REINSTALL, PLACE BOTTOM OF DUST CUP INTO DUST CUP AND THEN PULL THE HANDLE UP TO LOCK IT IN PLACE.

Push down on the handle to open the bottom of the dust cup.

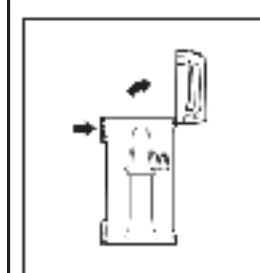

#### TO REMOVE COLLAR AND CLEAN THE SCREEN, PRESS THE RELEASE BUTTON AND LIFT THE HANDLE TO OPEN THE COLLAR AND CLEAN THE SCREEN.

Push down on the handle to open the bottom of the dust cup.

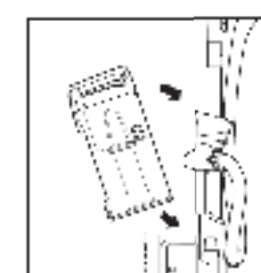

#### TO REINSTALL, PLACE BOTTOM OF DUST CUP INTO DUST CUP AND THEN PULL THE HANDLE UP TO LOCK IT IN PLACE.

Push down on the handle to open the bottom of the dust cup.

### CLEANING AND REPLACING THE FILTERS

#### CLEANING FILTERS

Regularly clean and replace your filters to keep your vacuum's suction power optimal.

To clean the filters, use only mild water and a soft brush. Do not use harsh chemicals or detergents. Always use the correct cleaning method to prevent the filters from being damaged.

**IMPORTANT!** DO NOT use soap when cleaning the filters.

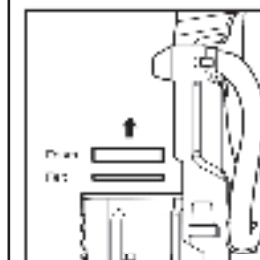

#### C. FAN PRE-MOTOR FILTERS EVERY 3 MONTHS

Remove Dust Cup from Upright Vacuum.



#### C. FAN HEPA FILTER EVERY 6 MONTHS

Press down top of Filter Door. Lift Filter Door and Filter. Press into top of HEPA Filter and pull away from the main body of the vacuum. To install, insert HEPA filter into unit and replace the door.

#### REPLACING FILTERS

Follow the steps shown in the diagram to replace the filters. The Pre-Motor Filter should be replaced every 3 months. The HEPA Filter should be replaced every 6 months.

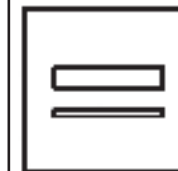

Replacement Pre-Motor Foam & Felt Filter Kit

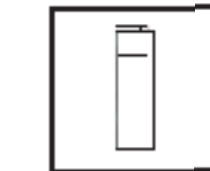

Replacement HEPA Filter



## MAINTENANCE

### Zero-M Technology

**ZERO-M**

Shark® Zero-M™ technology uses laser and deflection sensors to scan the floor in front of and to the sides of the unit to detect a change in floor type. It automatically checks for blockages or objects caught in the brushroll.

**NOTE:** Do not so densely fill the dust cup that hair wraps on the brushroll. If any product is so full, it should be emptying more frequently to the dust cup.

#### CLEANING THE BRUSHROLL

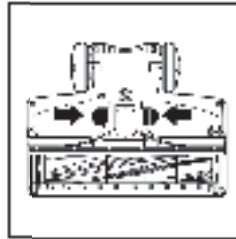
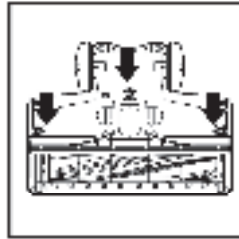

Carry a vacuum cleaner out manually more than 15 ft (4.6 m) to access Brushroll.

#### DEBRIS WRAPPED AROUND BRUSHROLL

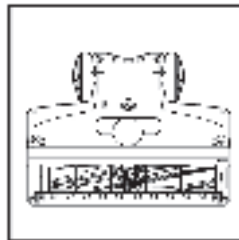

Clean off any debris on the brushroll.

**NOTE:** If hair is wrapped around the brushroll, cutting it with scissors will allow the unit to continue to remove floor soil. If hair is wrapped around the brushroll, it will block the unit's ability to clean debris with the roller and remove it from the brushroll.

#### DEBRIS BEHIND BRUSHROLL

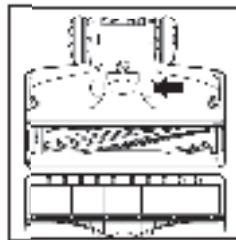

If you run over a hard or sharp object, or vacuum a hole, change the filter immediately. Check for blockages or objects caught in the brushroll.

Clear away any dust, dirt, or debris caught in the brushroll.

Turn on the power, push down on the roller, and place the roller back into the hole with a foot.

## CHECKING FOR BLOCKAGES

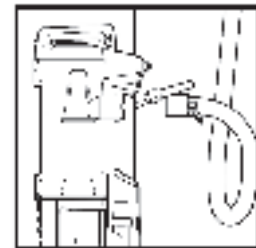

Detach hose from vacuum port and check for and clear any blockages or dust for blockages.

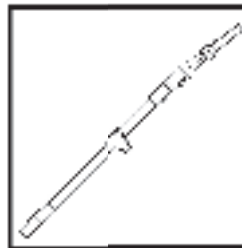

Detach head from floor, hose and brushroll and check both ends for blockages.

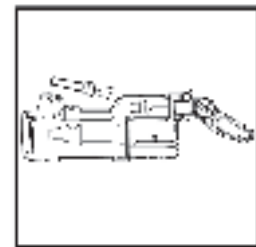

Detach wand from power cord, unplug power, and check opening for blockages.

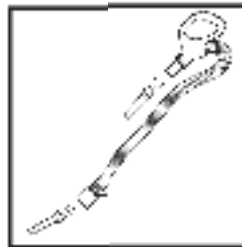

Detach wand from wand and hose from the vacuum port and check opening for blockages.

#### TECHNICAL SPECIFICATIONS

Voltage: 120V, 60Hz

Amps: 9.5A

\*The image shown here is for illustrative purposes only and may be subject to change.

## CHECKING FOR BLOCKAGES CONT...

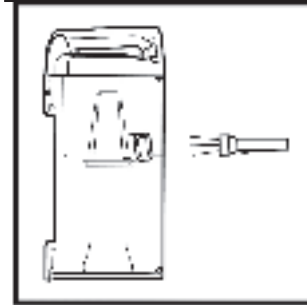

Detach dust cup from vacuum and empty dust cup, remove debris from Int. screen, and check for blockages.

## TROUBLESHOOTING

#### Vacuum is not picking up debris. No suction or light suction.

- Check that the power cord is plugged in correctly. Follow instructions for moving and unplugging the unit before reinserting in the vacuum.
- Dust cup may be full, empty dust cup.
- Check hose, hose connections, nozzle, wand, pole, and accessories for blockages. Clear any blockages from hose.

(Refer to Checking for Blockages section for more information.)

- If any string, carpet fibers, or hair is wrapped around the brushroll, extend cleaning time to allow Zero-M™ technology to remove it.
- If some hair or fibers remain wrapped around brushroll after continued use, remove the hair manually with scissors and remove from brushroll. See Cleaning the Brushroll section for more information.

#### Vacuum lifts area rugs.

- Make sure Power/Surface switch is set to Hard Floor (setting 1).
- Suction is powerful. Take care when vacuuming area rugs or rugs with delaminate down edges.

#### Brushroll does not spin in carpet cleaning mode.

- If the Brushroll indicator light turns red, immediately turn off and unplug the vacuum. Remove pedal from floor, move wand and clean any blockages. Restart vacuum by plugging in power and turning power.
- With the power on, recline the handle, which will automatically turn on the brushroll.
- Ensure that the Power/Surface switch is set to Carpet (setting II). The brushroll will not spin.

#### Vacuum turns off on its own or indicator light flashes red.

This vacuum is equipped with a thermal safety feature. If your vacuum overheats the thermostat will automatically turn the suction motor off. Perform the following steps to reset the thermostat:

- Turn vacuum off and unplug it.
- Empty dust cup and clean filters (see Emptying the Dust Cup and Cleaning the Filters).
- Check for blockages in hose, accessories, and inlet openings.
- Allow unit to cool for a minimum of 45 minutes.
- Plug in vacuum and turn it on.
- Restart the unit with the Power/Surface switch.

#### PLEASE READ CAREFULLY AND KEEP FOR FUTURE REFERENCE.

SharkNinja Operating LLC

Illustrations may differ from actual product. We are constantly striving to improve our products, therefore the specifications contained herein are subject to change without notice.

For SharkNinja U.S. Patent information, visit [www.sharkninja.com/USPatents](http://www.sharkninja.com/USPatents)

© 2018 SharkNinja Operating LLC. SHARK and SHARK NINJA are registered trademarks of SharkNinja Operating LLC. NAVIGATOR and ZTRON are trademarks of SharkNinja Operating LLC.

804109574



PRINTED IN MEXICO / SC: 18.10.2019  
OBPN:ZU60Series\_IB\_E\_MP\_Mv4\_181218  
SHNMDL:ZU60\_B / TAB/ Elbrd:J.E.

**W**