

# DIGITAL WIRELESS BACKUP CAMERA SYSTEMS

◀ Camera and Monitor ▶



**Mold :SWD-M502630CS**

BEFORE INSTALLATION PLEASE READ THE MANUAL

## What's in the Box?



NOTE: The contents included may be different based on the kit you purchased. Please take the actual product as standard

- |                  |                        |
|------------------|------------------------|
| 01 5inch Monitor | 06 Power Cable         |
| 02 Camera        | 07 USB                 |
| 03 Sticker       | 08 Antenna and screws  |
| 04 Bracket       | 09 Trapezoidal bracket |
| 05 Car Charger   |                        |



# Introduction







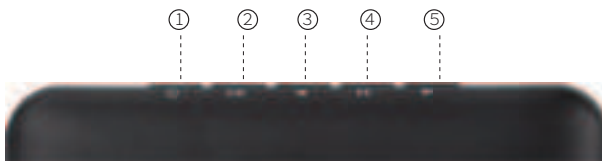
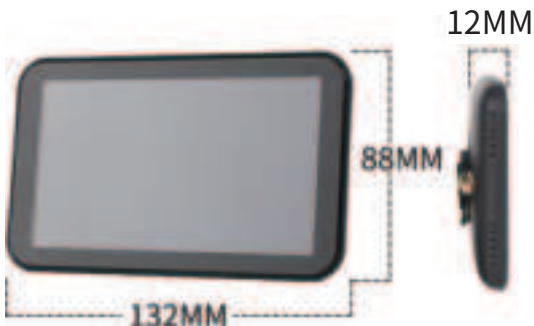

Please read all of the installation instructions carefully before installing the product. Improper installation will void manufacturer's warranty.

Thank you very much for purchasing a Rear View Backup Camera System. With this manual you will be able to properly install and operate the unit.

The Backup Camera System is intended to be installed as a supplement aid to your standard rear view mirror that already exists in your vehicle. The Backup Camera System should not be used as a substitute for the standard rear view mirror or for any other mirror that exists in your vehicle. In some jurisdictions, it is unlawful for a person to drive a motor vehicle equipped with a TV viewer or screen located forward of the back of the driver's seat or in any location that is visible, directly or indirectly, to the driver while operating the vehicle.

# Monitor Operation



| Product name   | SWD-502630CS   |
|--|--|
|  Key 1   | Power key      Switch on/off   |
|  Key 2  | ① Confirm key   ② Card insertion   Start Pause key   |
|  Key 3 | ① Enter menu   Left selection   ② reduce   ③ Car ruler<br>④ In adjustment mode   Position of the vehicle gauge |
|  Key 4 | ① Menu key      ② Return key   |
|  Key 5 | ① Enter menu   Right Select   ② plus<br>③ Short press to switch channels                                       |

## Camera Size



## Box Size

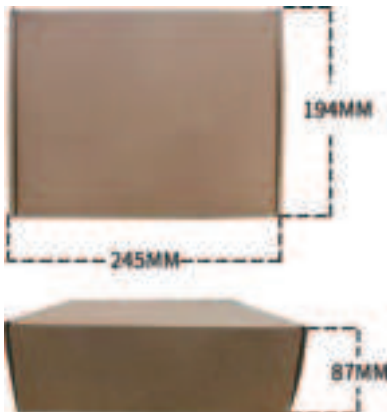

The Packing Box  
is Hard and not  
Easy to Wear

# Installation Diagram



## ► Monitor Installation

Choose a monitor location in your vehicle that does not block your view and complies with local laws for safe driving. Do not place in an area where it might interfere with driving.



Camera Placement Diagram

## ► Camera Installation

### Suitable Installation Position



## Connection mode of accessories

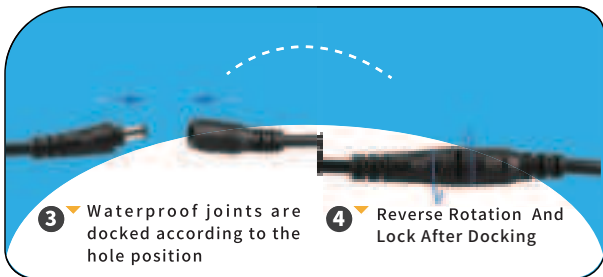

The above is the correct connection mode. Please operate carefully during installation and removal to avoid damage

## Pairing the Camera and Monitor

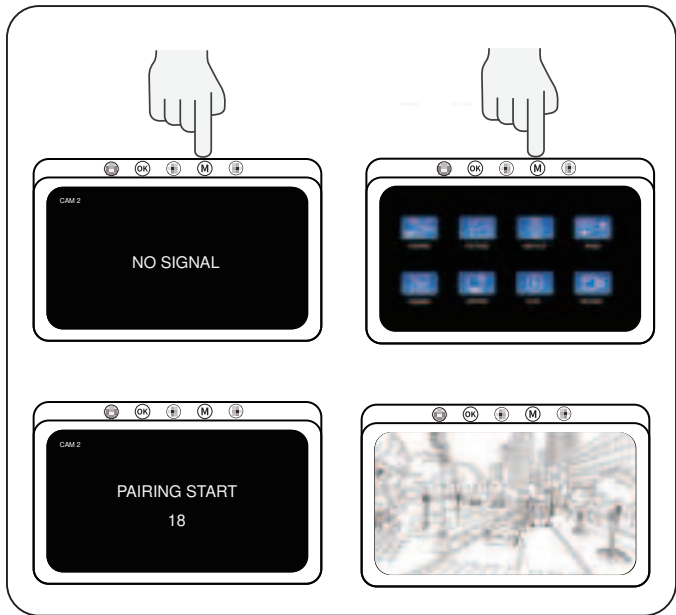

▼ **NOTE:** when you need pairing, please confirm the circuit is properly connected and powered. If you need to pairing multiple cameras, please switch to the corresponding channel.



# Specifications



|                              |                 |
|------------------------------|-----------------|
| <b>Power Supply</b>          | DC12V to 36V    |
| <b>Wireless Frequency</b>    | 2.4 GHz         |
| <b>Wireless Range</b>        | 500m(open area) |
| <b>Delaying Time</b>         | <200ms          |
| <b>Operating temperature</b> | -20°C ~ 80°C    |

## CAMERA

|                          |                 |
|--------------------------|-----------------|
| <b>Image Sensor</b>      | 1/3 inch        |
| <b>Waterproof Rating</b> | IP 68           |
| <b>View Angle</b>        | 100°[H] 130°[D] |
| <b>Camera Pixel</b>      | 1000TVL         |

## MONITOR

|                          |                      |
|--------------------------|----------------------|
| <b>LCD Size</b>          | 5 inch IPS           |
| <b>Resolution</b>        | 1280(H) x 720(V)     |
| <b>Contrast</b>          | 500:1                |
| <b>Brightness</b>        | 500cd/m <sup>2</sup> |
| <b>Response Time</b>     | 25ms                 |
| <b>Power Consumption</b> | <500mA               |

# Troubleshooting



| Problem                       | Solution  |
|-------------------------------|---|
| Monitor Won't turn on         | Check the cigarette lighter has 12V-36V DC Output<br>Check the fuse in the Cigarette socket adapter |
| Camera and Monitor won't pair | Check if the camera is receiving power  |
|                               | Make sure to follow the instructions to operate the Pairing   |
| Weak Signal                   | Check if the camera and monitor antennas are installed  |
|                               | Distance between camera and monitor is too great.<br>Reduce distance between camera and monitor     |
|                               | Large dense objects could be obscuring the signal.<br>If possible, move the objects                 |
|                               | Interference from overheat power lines may be affecting the signal                                  |
|                               | Try unpairing and pairing   |
| Night Vision is poor          | The night sensor on the camera may be dirty or obstructed   |
|                               | Ensure the camera is installed at least 2 inches away from rear lights                              |
| Dark Picture                  | Check whether brightness and contrast are adjusted correctly  |

## FCC Warning Statement

Changes in nearby objects and equipment may affect the ability of equipment to communicate and the user is notified to operate the equipment. The equipment has been tested and found to comply with the limits for a Class B digital device, pursuant to Part 15 of the FCC Rules. These limits are designed to provide reasonable protection against harmful interference in a residential environment.

This equipment generates radio and can receive radio frequency energy. If this equipment is used near or connected with the infrastructure, they could interfere with radio communications. However, there is no guarantee that interference will not occur in a particular installation. If this equipment does cause harm to other electronic devices, it must be stopped or corrected by turning the equipment off and/or the user is recommended to try to correct the interference by one or more of the following measures:

- Reorient or relocate the receiving antenna.
- Increase the separation between the equipment and receiver.
- Connect the equipment into an outlet on a circuit different from that to which the receiver is connected.
- Consult the dealer or an experienced radio/TV technician for help.

This device complies with part 15 of the FCC Rules. Operation is subject to the following two conditions: (1) This device may not cause harmful interference, and

(2) This device must accept any interference received, including interference that may cause undesired operation.