



## POOL CARTRIDGE FILTER

**SKU: 75200**

**175 SQFT**

**SKU: 75201**

**200 SQFT**

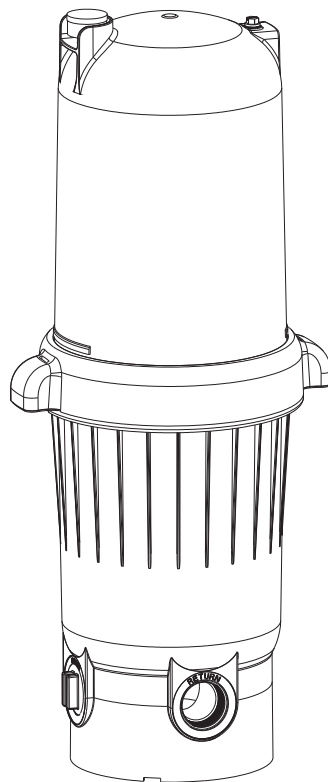

## INSTALLATION AND USER'S GUIDE

75200 

75201 

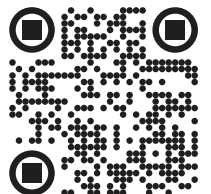



# TABLE OF CONTENTS

<b>TABLE OF CONTENTS</b>	<b>1</b>
<b>IMPORTANT SAFETY INSTRUCTIONS</b>	<b>2</b>
<i>Legends and Symbols</i>	2
GENERAL	3
<b>PRODUCT INFORMATION</b>	<b>5</b>
PACKAGING CONTENTS	5
INTRODUCTION	6
PRODUCT OVERVIEW	6
SPECIFICATIONS	7
DIMENSIONS	7
<b>INSTALLATION</b>	<b>8</b>
INSTALLATION	8
FILTER LOCATION	8
PLUMBING	8
INSTALLATION DIAGRAM	9
STEP 0	10
STEP 1	10
STEP 2	11
STEP 3	12
<b>OPERATION</b>	<b>13</b>
STARTING THE FILTER	13
FILTERING	13
<b>MAINTENANCE</b>	<b>14</b>
REMOVING CARTRIDGE	14
REINSTALLING CARTRIDGE	14
CLEANING CARTRIDGE	14
<b>REPLACEMENT PARTS</b>	<b>15</b>
PARTS DIAGRAM	15
PARTS LIST	16
<b>DISCLAIMER</b>	<b>17</b>
<i>Disclaimer</i>	17
<i>Customer Service</i>	17

# IMPORTANT SAFETY INSTRUCTIONS

## IMPORTANT SAFETY INSTRUCTIONS

This guide provides instructions for installing and using the POOL CARTRIDGE FILTER . If you have any questions about the equipment, please contact XtremepowerUS.

This guide contains important information about safely installing and operating this product. After installation, make sure to share this information with the owner/operator or leave it with them for their reference.

### *Legends and Symbols*

When you come across the safety-alert symbol on your equipment or in this manual, pay attention to the following signal words and remain vigilant about the potential for personal injury.



**DANGER:** Ignoring these hazards can result in death, severe personal injury, or significant property damage.



**WARNING:** Indicates potential hazards that can result in severe personal injury, death, or significant property damage. Ignoring these warnings presents a real danger.



**CAUTION:** Indicates potential hazards that can result in minor or moderate personal injury, property damage, or actions that are unpredictable and unsafe. Ignoring these cautions presents a potential hazard.



#### **NOTE**

**NOTICE:** This label indicates important special instructions that are not directly related to hazards.

---

### **USE OF NON-XTREMEPOWERUS REPLACEMENT PARTS VOIDS WARRANTY**

**ATTENTION INSTALLER:** This manual contains vital information regarding the installation, operation, and safe use of this product. It is essential to provide this manual to the end user of the product. Failure to read and follow all instructions could lead to severe injuries.

---



Failure to comply with all instructions and warnings may lead to severe bodily injury or even death. For optimal safety and functionality, it is advisable to have the product installed and serviced by a certified service professional. Prior to using this product, installers, operators, and owners must carefully review these warnings and all instructions provided in the owner's manual. It is essential to leave these warnings and the owner's manual with the owner for their reference and safety.



For safety reasons, children should not be allowed to use this product. Packing materials and plastic bags are not toys. Keep them away from children to prevent the risk of suffocation.

# IMPORTANT SAFETY INSTRUCTIONS

## GENERAL



### Before Installation

- Read and follow all warning notices and instructions included with this product.
- Failure to comply can result in severe injury, death, or property damage.

### Pool Circulating System

- Do not operate the filter until all operating instructions and warning messages for all equipment in the pool circulating system are read and understood.
- Failure to follow these instructions can result in property damage, severe personal injury, or death.

### Pressure Testing Precautions

- Never adjust closures, lids, or bolts while the system is pressurized. This can cause severe injury or death if parts separate and strike a person.

### Electrical Safety

- Always disconnect power to the pool circulating system at the circuit breaker before servicing the filter.
- Lock out or tag the disconnected circuit to prevent it from being switched on while servicing.
- Failure to do so can result in electric shock, serious injury, or death.

### High-Pressure Operation

- Air can enter and become pressurized during servicing, causing the top closure to separate and potentially result in severe injury, death, or property damage.
- Follow these instructions to avoid this hazard:
  - Release air and pressure from the system before and after servicing.
  - Shut off the pump and open the manual air/pressure relief valve before servicing.
  - Follow Opening the Filter instructions exactly.
  - After service, keep the air/pressure relief valve open until water flows out, ensuring all air is expelled.
- Properly install the lid and clamp ring.
  - Follow the Installing the Filter Lid and Clamp Ring instructions exactly.
  - Tighten the nut until the spring is compressed and tap the clamp with a rubber mallet to ensure proper seating.
- Maintain the circulation system to prevent air entry.
  - Replace worn or damaged parts immediately.
  - Maintain proper water levels in the pool or spa.
- Ensure the return line to the pool is unobstructed.
  - Verify return valves are open and any winterizing plugs are removed.



**EXCESS PRESSURE HAZARD**

# IMPORTANT SAFETY INSTRUCTIONS

## **! WARNING**

### **Important Safety Information**

- Read all safety warnings and instructions thoroughly.
- Failure to follow these can result in electric shock, fire, or serious injury.
- Save all warnings and instructions for future reference.

### **Installation Requirements**

- A qualified pool serviceman must install this filter in accordance with all local codes and ordinances.
- Improper installation can result in death, serious injury, or property damage.

### **System Pressure**

- Never exceed the maximum pressure of system components. The maximum working pressure of this filter is 50 psi.
- Conducting hydrostatic pressure tests or subjecting the filter to higher pressures can damage it.
- Ensure the system pressure does not exceed the maximum pressure of any component.
- If unsure of the operating pressure, install an ASME-approved automatic Pressure Relief or Pressure Regulator set to the lowest working pressure of any system component.

### **Pressure Test Precautions**

- Perform pressure tests only for the minimum time required by local code.
- Keep people away from the system during tests.
- Post warning signs and establish barriers around pressurized equipment.
- Do not exceed the maximum operating pressure of any component during tests.

## **! CAUTION**

### **Operator Responsibility**

- Understand that not all possible conditions and situations can be covered in this manual.
- Use common sense and caution when operating this product.
- Read and understand all ASSEMBLY AND OPERATION INSTRUCTIONS before use.
- Failure to follow safety rules and precautions may result in serious injury.

## **★ NOTE**

### **Save These Warnings**

- Save all warnings and instructions for future reference.



### **COMPONENT SEPARATION HAZARD**

# PRODUCT INFORMATION

## PRODUCT INFORMATION

### PACKAGING CONTENTS

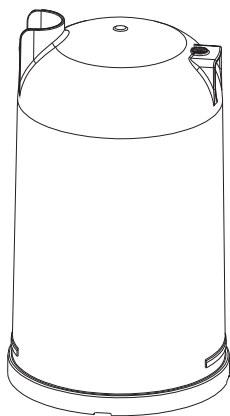

**PARTS # 5**  
**TOP TANK BODY**  
1 PC(S)

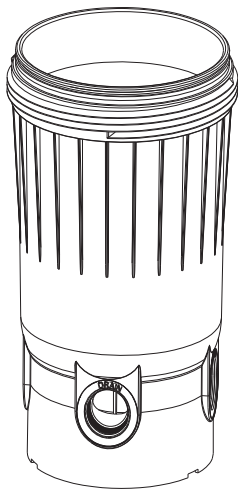

**PARTS # 8**  
**BOTTOM TANK BODY**  
1 PC(S)

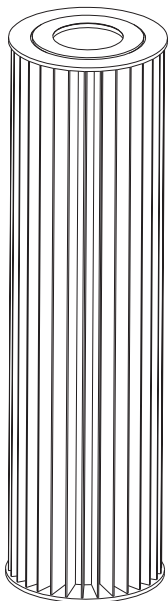

**PARTS # 7**  
**CARTRIDGE ELEMENT**  
1 PC(S)



**PARTS # 6**  
**LARGE O-RING**  
1 PC(S)

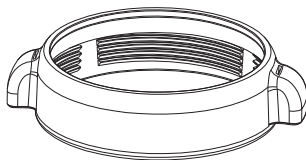

**PARTS # 1**  
**LOCKING RING**  
1 PC(S)



**PARTS # 9**  
**SMALL O-RING**  
1 PC(S)



**PARTS # 3**  
**PLUG W/ GASKET**  
1 PC(S)



**PARTS # 4**  
**PRESSURE GAUGE**  
1 PC(S)



**PARTS # 2**  
**LOCKING RING LATCH**  
2 PC(S)



**PARTS # 10**  
**PLUG**  
1 PC(S)

# PRODUCT INFORMATION

## INTRODUCTION

Xtremeclear Pool Cartridge Filter is esigned for efficiency, durability, and ease of use, our filter keeps your pool water crystal clear.

### Keuploady Features

- High-Efficiency Filtration: Removes dirt, debris, and microscopic particles.
- Durable Construction: Built to withstand outdoor conditions.
- Easy Maintenance: Removable cartridge for quick cleaning.
- Energy Efficient: Reduces energy consumption.
- Compact Design: Fits seamlessly into various pool setups.
- Quiet Operation: Minimal noise for a peaceful poolside experience.

### Benefits

- Improved Water Quality: Clean, clear water for a healthier swimming environment.
- Reduced Chemical Usage: Less need for excessive chemicals.
- Extended Equipment Life: Protects your pool pump and plumbing.
- Cost Savings: Lower energy and chemical costs.

## PRODUCT OVERVIEW

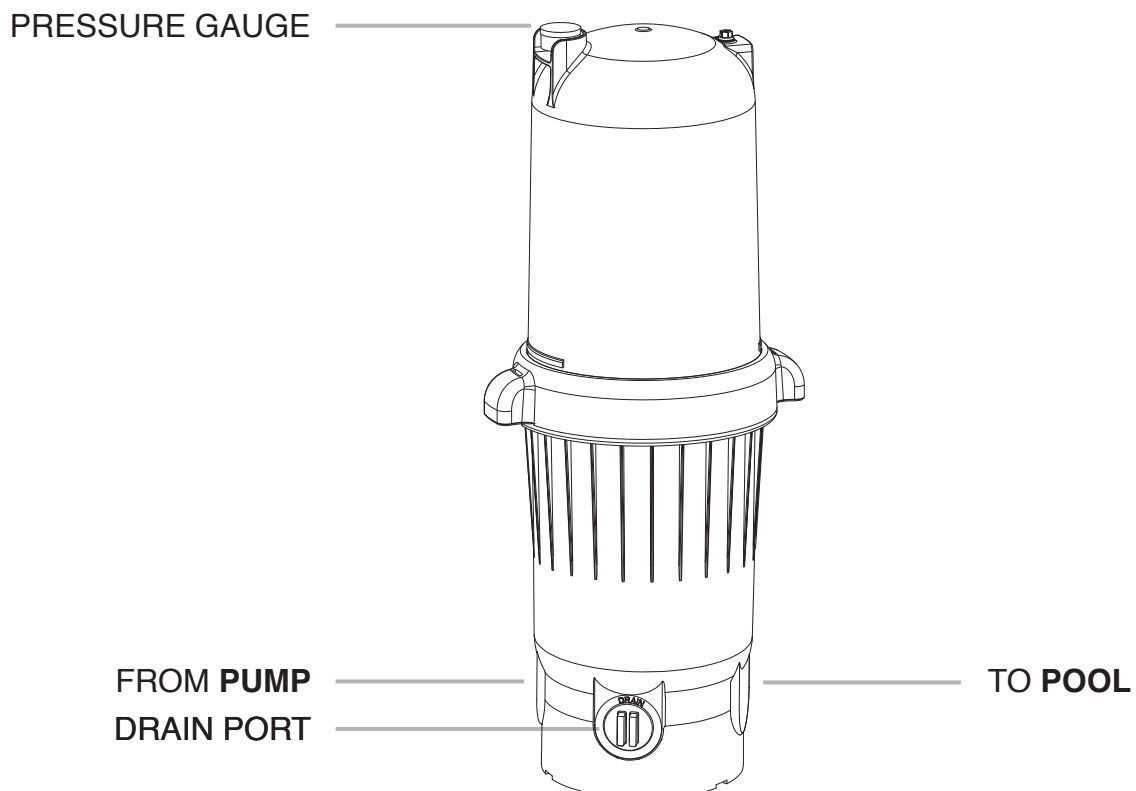



# PRODUCT INFORMATION

## SPECIFICATIONS

MODEL NUMBER	75200	75201
EFFECTIVE FILTRATION AREA	175 FT <sup>2</sup>	200 FT <sup>2</sup>
DESIGNED FLOW RATE	120 GPM	200 GPM
8 HOURS TURNOVER	57,600 GAL	96,000 GAL
10 HOURS TURNOVER	72,000 GAL	120,000 GAL
PORT SIZE	2"	2"
MAX. WORKING	50 PSI (3.5 BAR)	50 PSI (3.5 BAR)
NET WEIGHT	23 LBS	25 LBS

## DIMENSIONS

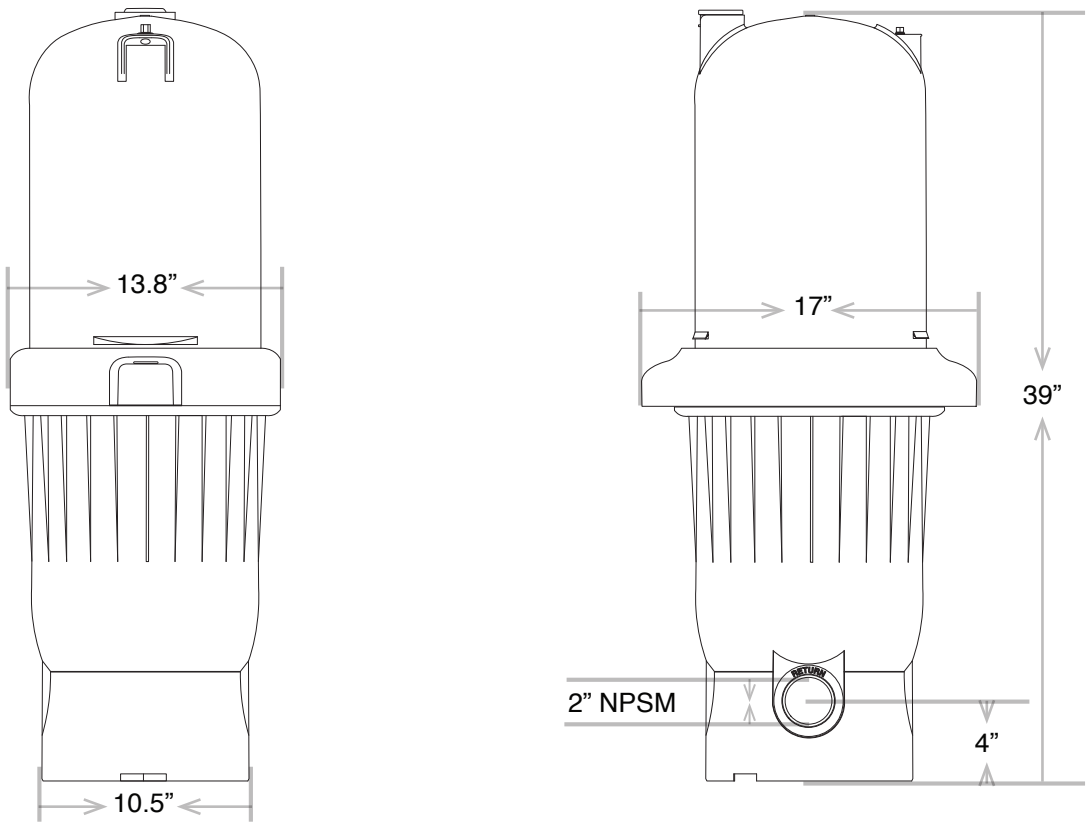

## INSTALLATION

### FILTER LOCATION

- Location: Place the pump and filter as close to the pool as local codes allow. If above the water line, use a self-priming pump.
- Surface: Ensure the filter is on a solid, level surface and accessible for maintenance.
- Drainage: Position the filter to allow gravity drainage.
- Shade: If possible, place the pump and filter in the shade to protect from direct sunlight.

### PLUMBING

- Piping: Use 1-1/2" or 2" piping. Include unions for easy servicing.
- Valving: Install ball valves for controlling water flow. Add valves to prevent backflow if the filter is below water level.
- Connections: Use Teflon tape on male threads. Hand-tighten, then use a wrench for one additional turn.
- Plumbing: Connect the suction line from the skimmer to the pump, and install return plumbing.
- Pressure Gauge: If not pre-installed, wrap gauge threads with Teflon tape and screw into the filter head.
- Drain & Air Relief: Use the provided drain plug and air relief valve for drainage and air removal.
- Electrical: Ensure all electrical connections meet local codes.
- Leak Check: Inspect for leaks before operating.
- Pump Info: Refer to the pump manual for specific details.

# INSTALLATION

## INSTALLATION DIAGRAM

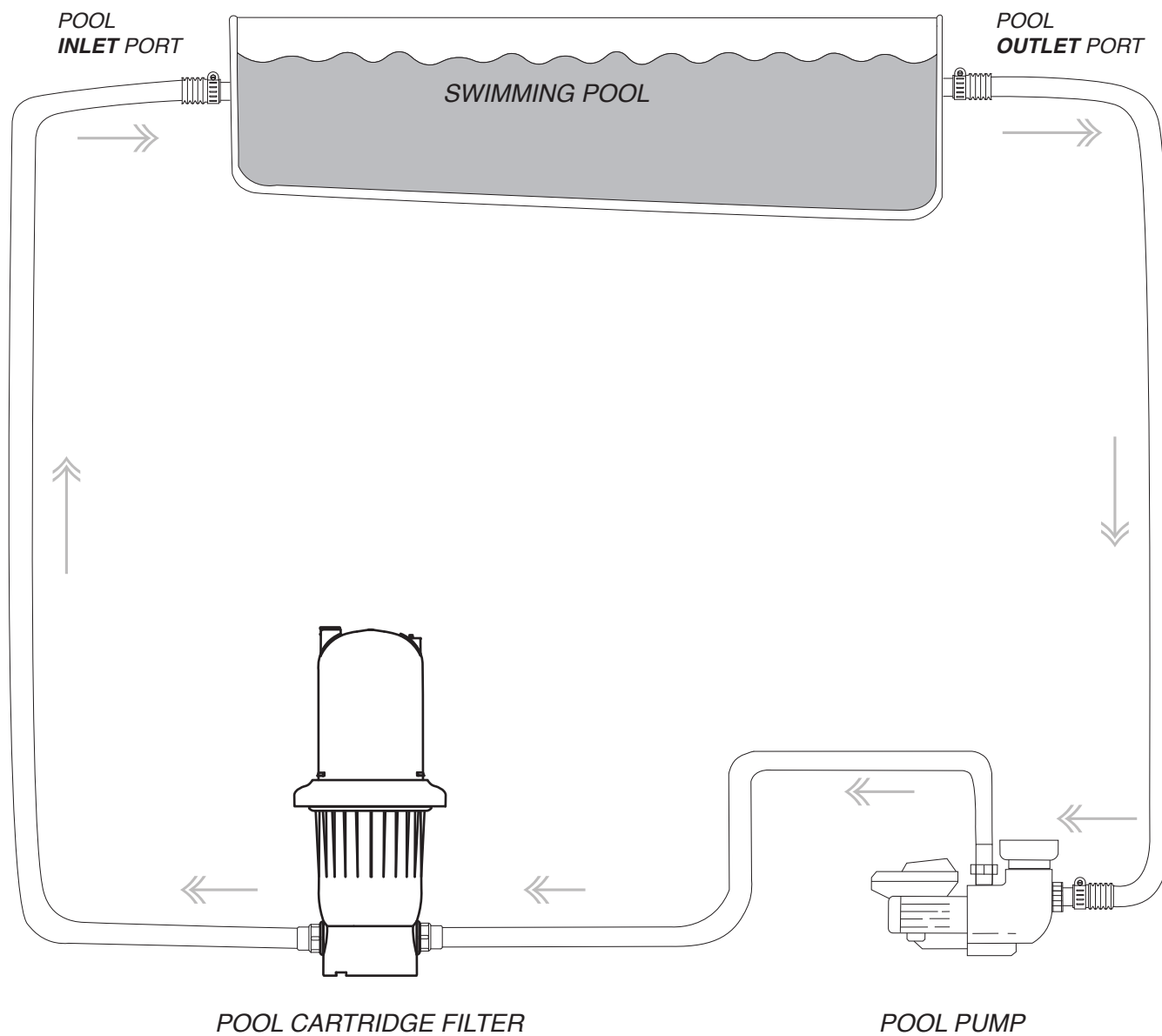

# INSTALLATION

## STEP 0

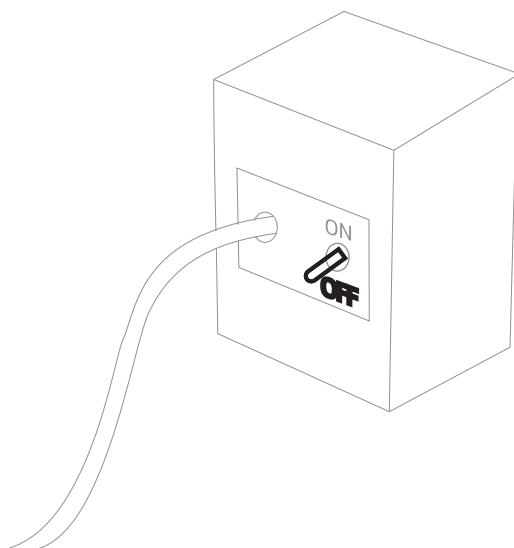

## STEP 1

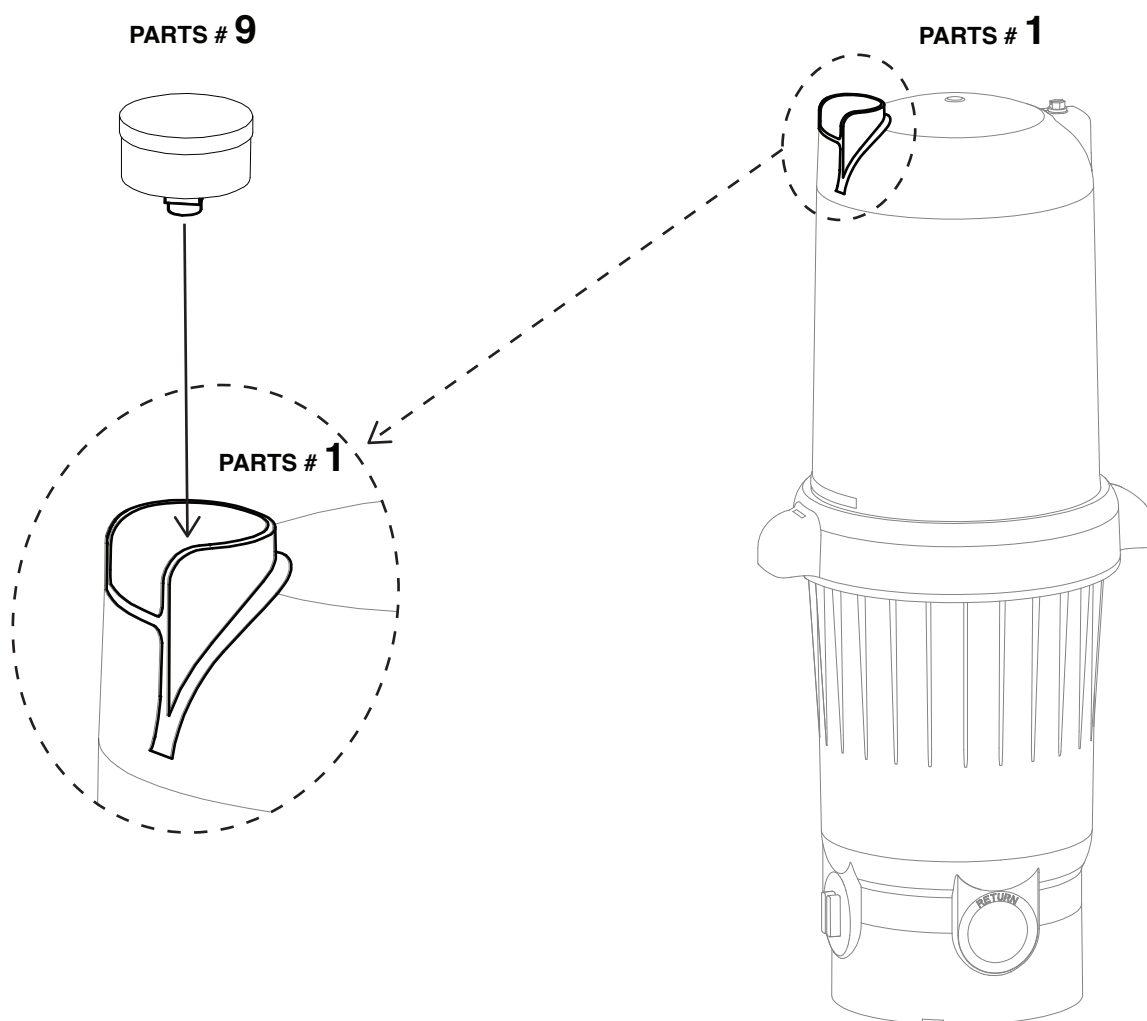

# INSTALLATION

## STEP 2

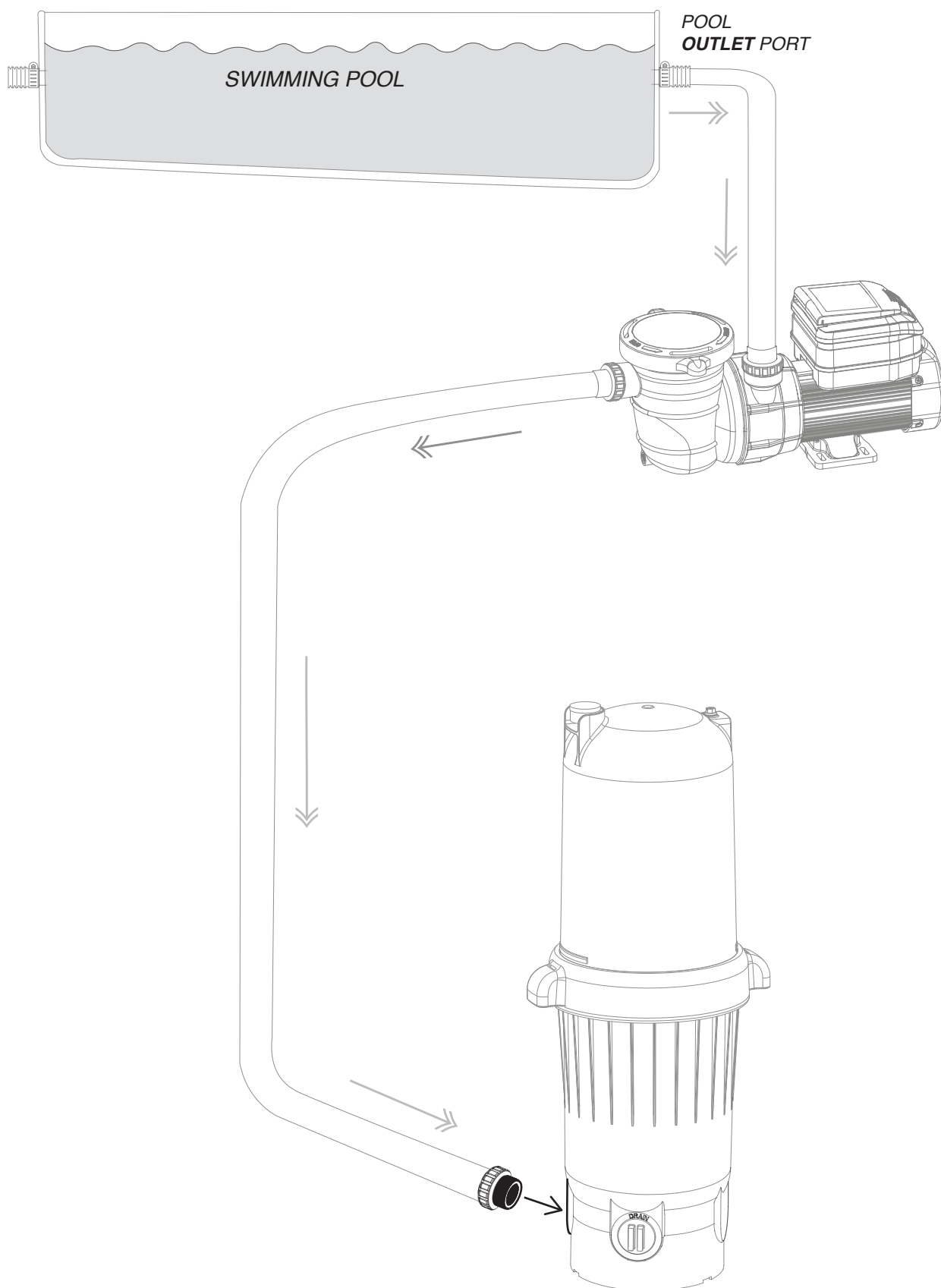

# INSTALLATION

## STEP 3

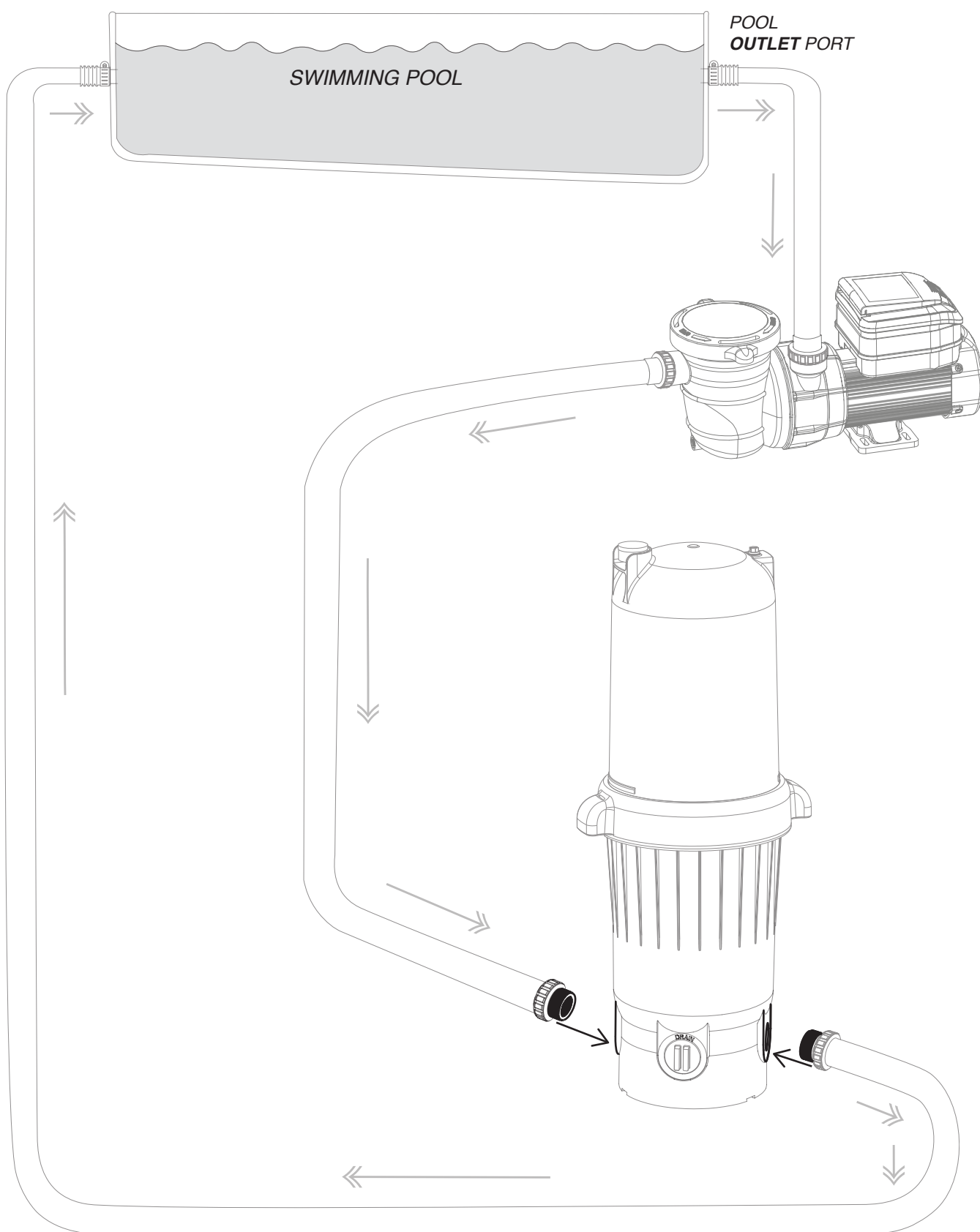

## OPERATION

### STARTING THE FILTER

- Preparation: Ensure the drain plug is closed, and open the manual air relief valve and all suction/return valves.
- Caution: All valves must be open before starting to avoid injury or damage.
- Start the Pump: Hand-tighten the locking knob, stand clear, and start the pump per the manufacturer's instructions. Close the air relief valve once air is vented.

### FILTERING

- Monitor: Filtration begins with steady flow. Clean or replace the cartridge when pressure increases by 7-10 psi or flow decreases.

## MAINTENANCE

### REMOVING CARTRIDGE

- Turn Off Pump: Shut off the pump.
- Prevent Backflow: Close valves if the filter is below water level.
- Drain Water: Remove the drain plug to empty the filter. Close after draining.
- Access Cartridge: Unscrew the locking knob, remove the cover, and lift out the cartridge.

### REINSTALLING CARTRIDGE

- Clean: Remove debris from the filter body.
- Replace Cartridge: Place the cartridge back into the filter and hand-tighten the locking knob.
- Restart: Follow the "Starting the Filter" steps.

### CLEANING CARTRIDGE

- Rinse: Wash the cartridge with a garden hose.
- Deep Clean: Soak in filter cleaner or a 1:1 solution of 20% muriatic acid and water for tough deposits.
- Flush: Rinse thoroughly before reinstalling.
- Spare Cartridge: Keep a spare for continuous, efficient operation.



REPLACEMENT PARTS

PARTS DIAGRAM

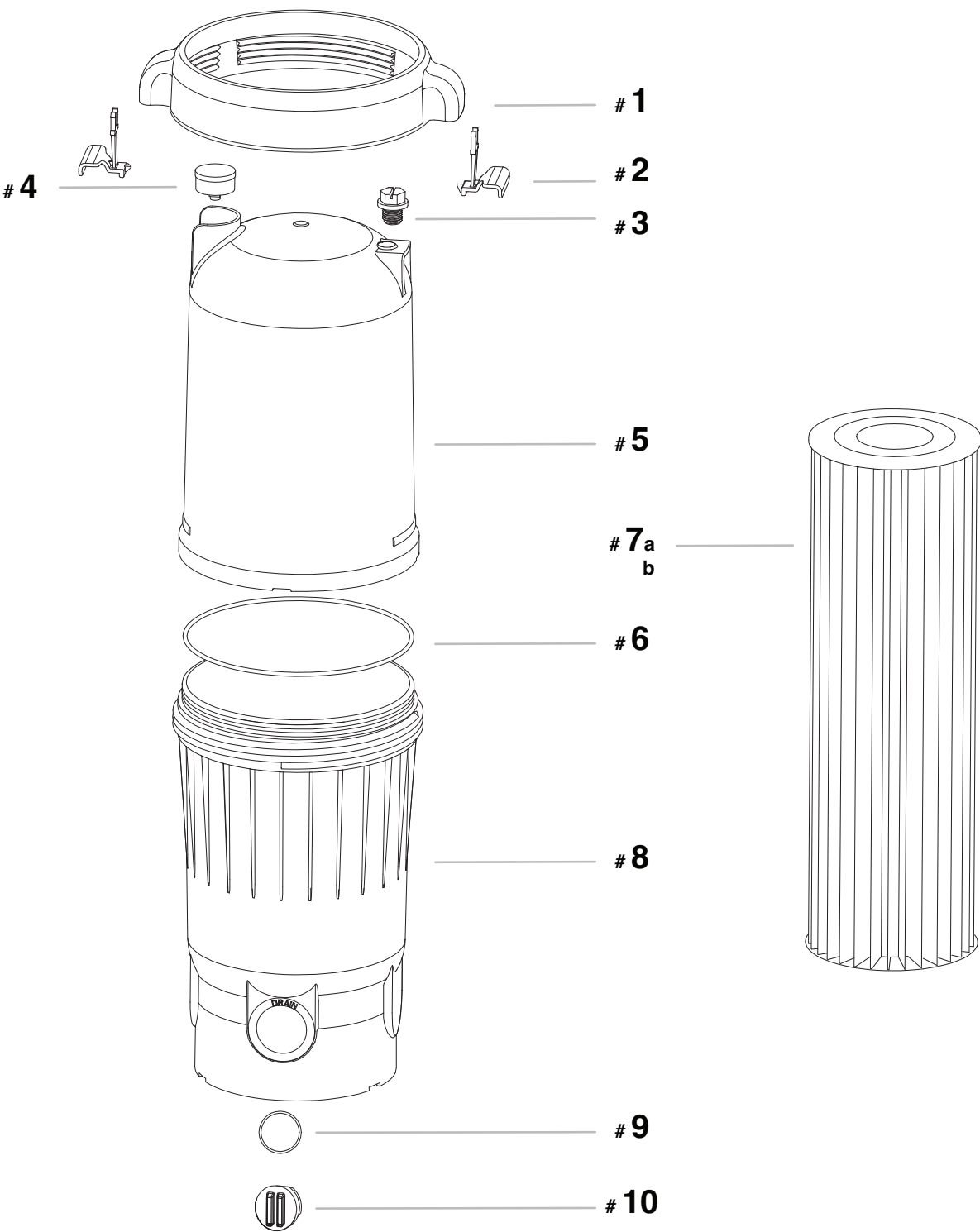

# REPLACEMENT PARTS

## PARTS LIST

ITEM	PARTS NO.	NAME	DESCRIPTION	QTY
1	647310303080	LOCKING RING		1
2	647310304080	LOCKING RING LATCH		2
3	648860105080	DRAIN PLUG WITH GASKET		1
4	65024016000	PRESSURE GAUGE NEW		1
5	647310302080	SEAL COVER		1
6	65431093080	O-RING	$\Phi 278.77 * \Phi 5.33$	1
7 a	65022035000	CARTRIDGE ELEMENT	FOR # 75201	1
7 b	65022036000	CARTRIDGE ELEMENT	FOR # 75200	1
8	647310301080	MAIN BODY		1
9	65431030080	O-RING	$\Phi 54.4 * \Phi 3.1$	1
10	649102607080	PLUG	2"	1

## DISCLAIMER

### ***PLEASE READ THE FOLLOWING CAREFULLY***

---

The manufacturer and/or distributor have provided the parts list and assembly diagram in this manual for reference purposes only. They do not make any representation or warranty to the buyer that they are qualified to make repairs to the product or replace any parts of the product. In fact, the manufacturer and/or distributor expressly state that all repairs and parts replacements should be undertaken by certified and licensed technicians, and not by the buyer.

The buyer assumes all risk and liability arising from their repairs to the original product or replacement parts or arising from their installation of replacement parts. It is strongly advised that qualified professionals handle any repairs or replacements to ensure safety and proper functioning of the product. Improper installation and operation may result in injury, property damage, or voiding of warranty. The manufacturer and/or distributor shall not be held responsible for any accidents, damages, or malfunctions resulting from the buyer's installation and operation of the product. It is essential to follow all safety guidelines and recommendations provided in this manual and to seek professional assistance if unsure about the installation or operation procedures.

---

## CUSTOMER SERVICE

If you have any questions about ordering our pool pumps and replacement parts or pool products, please feel free to contact us using the following contact information:

### ***Customer Service and Technical Support***

**Phone:** (909) 628-0880

**Email:** [customer@xtremepowerusa.com](mailto:customer@xtremepowerusa.com)

**Hours of Operation:** Monday – Friday, 9AM – 4PM (CST)

---