

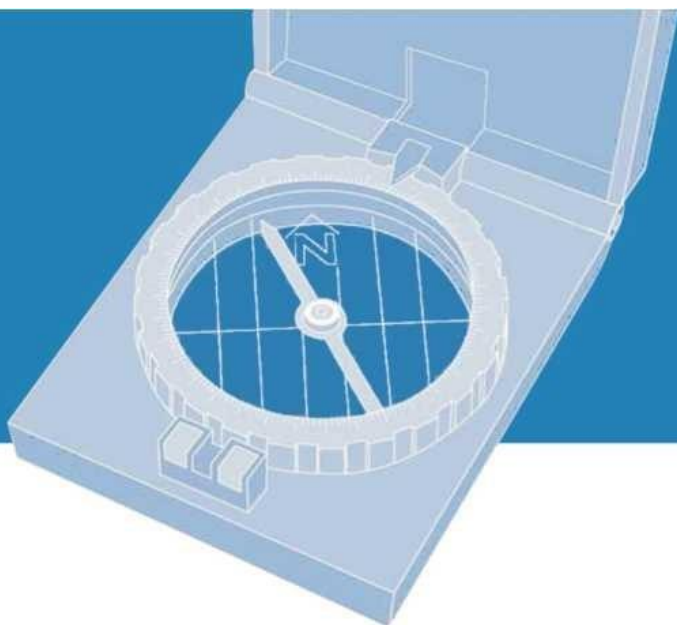

User manual

RCD360 S

RCD360 PRO3



English Manual

Unit overview.....2
Main Function.....3
Compatibility.....4
Power Adapter Instruction.....6
Backup camera function instruction.....8
Instruction wireless APP video.....8
Frequently Asked Question.....9
After-sales Service.....20
Youtube Home Page.....20

Multi-language Manual

Welcome to scan the QR code to see the user manual.



Overview



①	AM/FM	AM530-1600KHZ / FM87.5-108MHZ
②	Media music	SD / USB / Bluetooth audio
③	SCAN	Channel Search quickly
④	Switch	Radio start button or restart
⑤	Phone	Bluetooth connection; Bluetooth call/music Display phone book; Favorite contacts
⑥	APP	Apply Carplay / Android Auto
⑦	Setup	Radio Settings
⑧	Select key	

Main Function

Function\ Version	RCD360	RCD360 S	RCD360 PROIII/PRO3
Language	English	English	English
FM/AM	YES	YES	YES
Media	Bluetooth SD USB	Bluetooth SD USB	Bluetooth SD USB
Apple Carplay	Wired	Wired	Wired/Wireless
Android auto	NO	NO	Wireless
OPS	NO	NO	NO
DAB	No	NO	NO
RDS	NO	NO	NO
AV Camera	YES	YES	YES
MIB Camera	NO	YES, NEED ADAPTER	YES, NEED ADAPTER
RGB Camera	NO	NO	NO
Dynaudio/ Fender Audio	YES	YES	YES
Mic.	Built-in	Built-in	Built-in
Output	4x25W	4x25W	4x25W
Panel Size	215*180*130 mm	215*180*130mm	215*180*130mm
Handfree Call	YES	YES	YES

Car Compatibility

For VW

Golf MK6 2008 - 2014
Golf A6(R) 2008 - 2013
T5 Transporter 2010 - 2013
Scirocco 2008 - 2013
Passat B6(Sedan) 2005 - 2010
EOS 05/2006 - 2014
Polo MK5(Sedan) 2009 - 2014
Sharan 2010 - 2014
Beetle 2011 - 2015

Golf MK5 2003 - 2009
Golf Plus 2004 - 2013
Tiguan 2007 - 2014
Touran 03/2003 - 2014
Passat CC 2008 - 2014
Caddy 2004 - 2015
Jetta/Bora 2005 - 2015
Amarok 2010 - 2015

For SKODA

Fabia 2007 - 2014
Yeti 2009 - 2015

Octavia 2007 - 2012

For SEAT

Toledo 2004 - 2015
Alhambra 2010 - 2015

Leon 2004 - 2008

NOT Compatible Model:

For VW

Golf MK7 2012-2020
Multivan T5 2006

Passat B8 2014-2020

For SKODA

Octavia 2006
Octavia 2 Kambi 2009

Octavia 2 2007/2010

NOTE: If the panel size of the radio is different with the following picture, it is not compatible with the car. Please contact the **after-sale service** to return it.

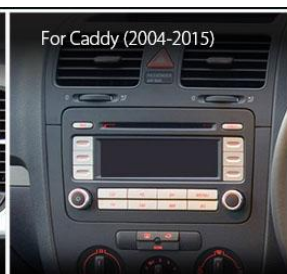
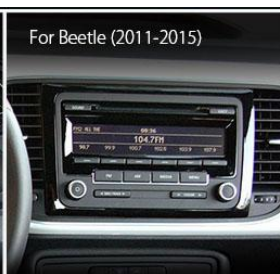

Power Adapter Instruction

There are two power cables (A and B) for this radio, we send cable A by default, if you need B cable, please contact our after sale service.

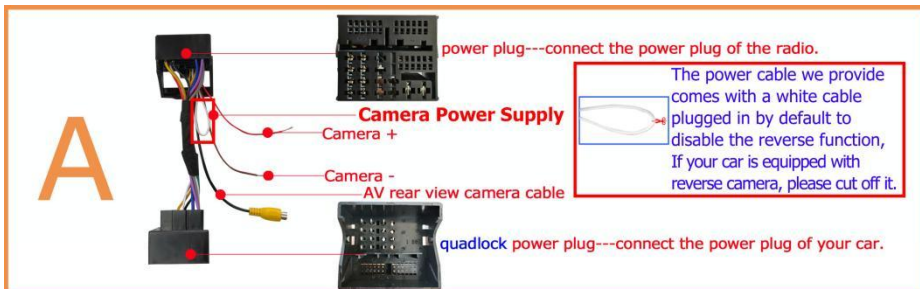

Volkswagen cars have three different power interfaces, namely PQ quadlock, ISO plug and MQB quadlock. See the diagram below:

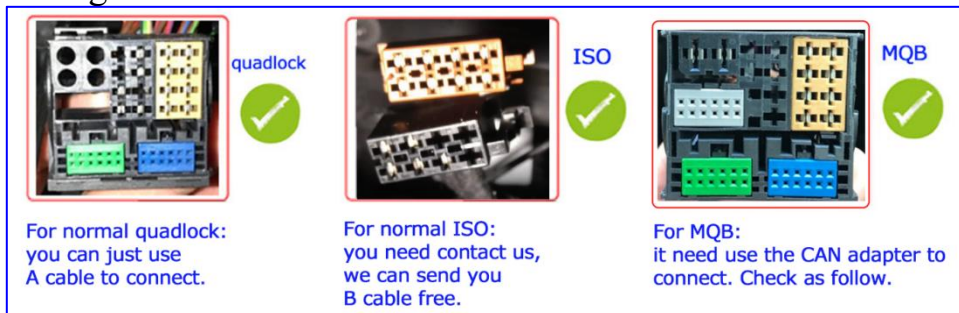

1.If your car is PQ Quadlock, you need the A adapter. It is in the package you received.

2.If your car is ISO Plug, you need the B adapter. Please contact us.

3. For MQB quadlock, it need connect with the CAN adapter like follow pictures shows:

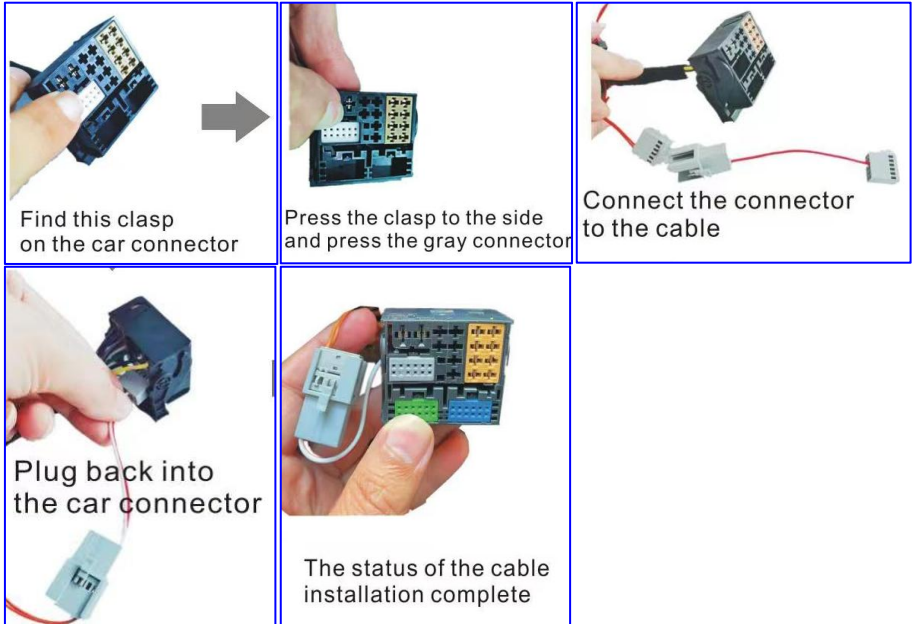

Attention:

If your original radio is MQB Quadlock, or your car is Polo 6C with MQB Quadlock, the RCD360S is **not compatible** with your car. Please contact after-sales service to change a RCD360 PRO2/PRO3 or the radio special for POLO 6C.

Backup camera function instruction

Camera Power Supply

The power cable we provide comes with a white cable plugged in by default to disable the reverse function, and the white cable serves as the standby cable.



- If your car is equipped with reverse camera, please **cut off** the wire.
- If your car doesn't have a reverse camera, no action is required..

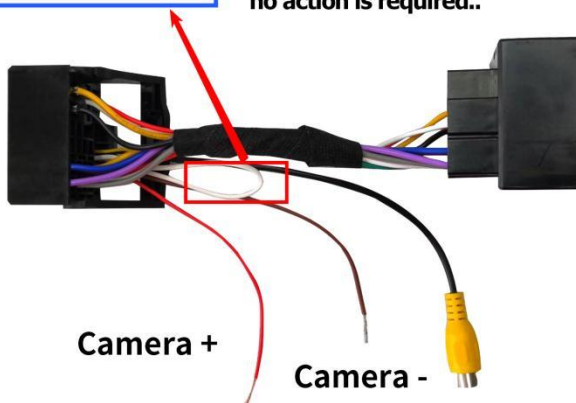

Instructions for wireless Carplay / Android auto



FAQ/Frequently Asked Questions

1.How to connect with the radio.

For the most cars after 2010, the radio is plug and play. Please check all the adapters in our package, then choose the right adapter to install it. There is also a antenna adapter, if your original radio has 2 interfaces, you need to use the antenna adapter.

2.The radio is not compatible

If you find the radio or adapter is not fit for your car after you receive that, please send the dashboard and your original interface photo to our technical customer service. We'd like to help you out.

3.Multi-function steering wheel

- If your car is produced before 2010, we recommend you to purchase the radio RCD360 PRO2.

Otherwise the radio cannot support Multi-function Steering Wheel. Please contact our service for help.

- If the multi-function steering wheel is a little older version, like 8-button or 4-button, you need to choose the radio RCD360 PRO2 and an adapter.

4.RCD360 battery leakage issue

If your car model is manufactured before 2010 and have the battery leakage problem, we recommend you purchasing a **special adapter** to solve it.



The communication in cars is implemented through the CAN-BUS, because the production year of RCD360S is later than your car. Volkswagen upgraded the bus of the subsequent platform models between 2008 and 2010, which resulted in the previous gateway releasing some messages that cannot be interpreted by the new devices. A common phenomenon is that the head unit cannot be notified that your key has been removed, which leads to power leakage. Replacing the gateway may increase some costs, but the benefit is that you don't need to worry about compatibility issues caused by the inability to recognize old version messages when upgrading Volkswagen's original accessories in the future.

The following are the possible reasons of battery leakage and solutions.

1.The radio does not shut down when the key is removed, it is because the CAN signal does not recognize the decoder signal and the signal between the CAN signal and the decoder does not match.

Solution for RCD360S: buy a special adapter

2.External device caused the battery leakage issue.

1) Disconnect all the external devices except the main unit. Check one by one.

2) If the camera caused the battery leakage problem, unplug the camera power cable.

3. **Special case:** The radio intermittently loses communication with the car. When this happens, it cannot be powered on and off with the key, the steering

wheel controls stop working, the machine displays a clock screen when the car loses communication with the machine, and the machine shuts down after 15 minutes. Re-plugged the power cord and the machine worked fine for half a day and the same problem occurred again.

Reason: The probability is because the can line signal is Interrupted, because the CANBUS box is built in the radio, sometimes it maybe lose or defect.

Solution: we prepare the adapter with the CANBUS box outside, if you need, please contact us.



5.Apple Carplay problem

Please connect your iPhone through the USB port, and the device will automatically detect your iPhone. Please make sure that the Carplay function is turned on. Please click Apple Carplay on the APP Menu, and then you can enter the Carplay interface to operate the APPS easily.



Here are some points for Carplay function:

This device may take some time to connect to the iPhone. Please be patient and avoid frequent plugging and unplugging

during the connection process, as this can prevent the connection from being established. Before connecting, please ensure that the iPhone has the following settings: Siri function is turned on, connected to Wi-Fi, and terminal access restrictions for CarPlay function are not enabled.

Carplay doesn't work:

- We suggest that you avoid frequently pulling out the USB cable and only unplug it from your phone, as this can protect the USB port of your device. Regularly plugging and unplugging the USB cable can cause the USB port to become loose and eventually lead to damage.
- Please reset the radio system in the system settings and clear the CarPlay connection records in your phone.

Carplay no sound:

If you decide to use the Carplay function, usually you do not need to connect Bluetooth to the radio. If you have connected both Bluetooth and Carplay, it may cause a conflict. Please turn on the Allow Carplay switch on your phone, otherwise the radio cannot communicate with your phone.

Instructions for wireless carplay and wireless android auto:



Wireless Android precautionary note:

Wireless Android Auto isn't available on devices that run Android (Go edition). Android Auto is integrated into phones with Android 11 and above. To use wireless Android Auto devices need to meet the following requirements: A compatible Android phone with an active data plan and 5 GHz Wi-Fi support. Wireless projection is compatible with these Android versions: Any phone with Android 11.0. A Google or Samsung phone with Android 10.0. A Samsung Galaxy S8/S8+ or Note 8, with Android 9.0

6. Radio Antenna issues

The antenna interface you received is a single hole. Most of the radio can use it directly except the following situations.

- 1) For original UKW-Antenna with 1 facra, doesn't need other adapter

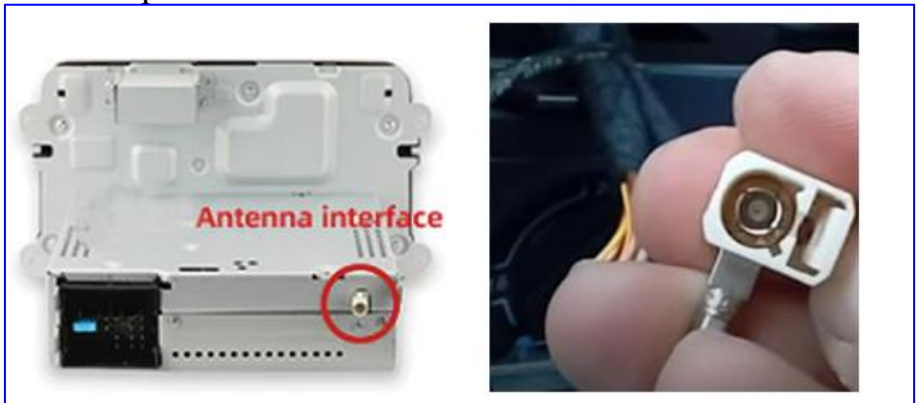

- 2) If your car's original antenna interface is UKW-Antenna with double fakra, as shown in the middle picture below, we recommend purchasing a dual-hole antenna to ensure the normal operation of the antenna. YX2201 or YX2202.

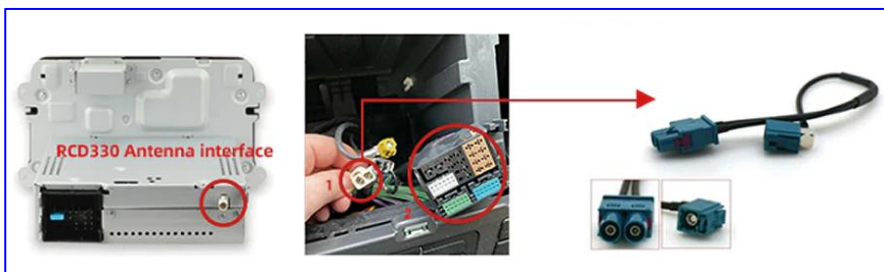

3) If your car's original antenna interface is original UKW-Antenna with double separate facra, as shown in the middle picture below, it needs a dual-hole antenna adapter to connect, SKU-YX2206

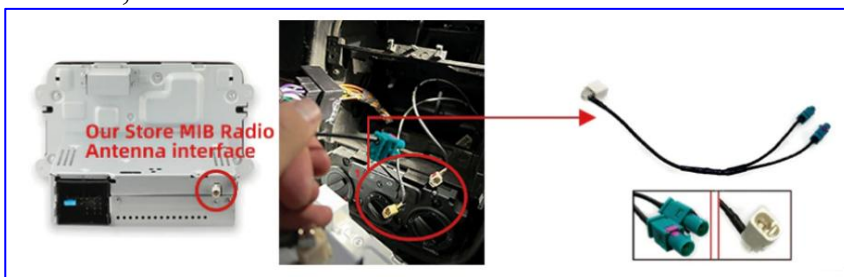

4) If the radio is installed successfully, AM/FM can not search any radio station or the signal is not good, first you can check whether the antenna adapter is connected stably, if the wiring is OK, you may need to buy the antenna amplifier to solve the problem, as shown in the following figure:



If you need the antenna cable, please contact us to buy it.

7.RCD360 camera connection issues

1)Standard rear view camera6

If you like to order a rear camera, please choose the one with **AV port**. You could contact our service for help, and please tell us the model and the year of your car. It will be helpful, if you could send us some pictures about your **license Plate Light with the correct length and width.**

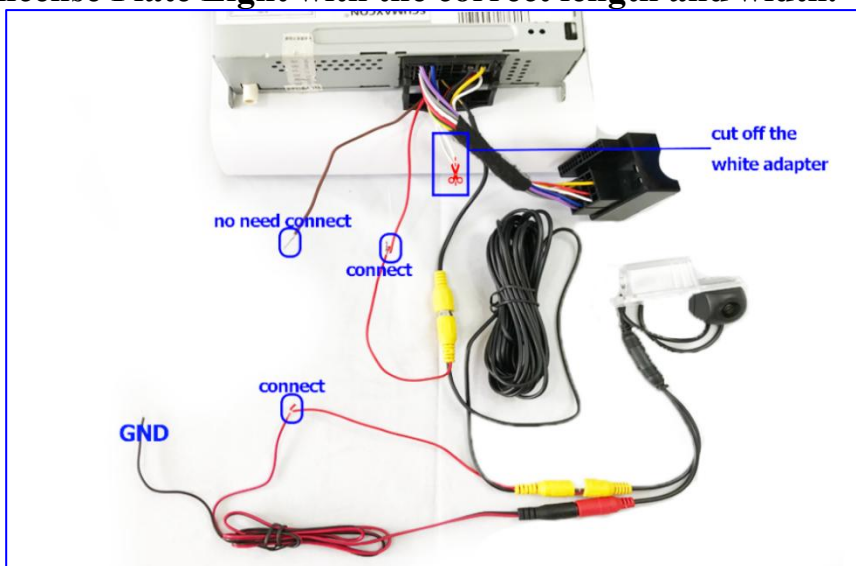

2) Trunk Handle rear view camera (our brand)

-----Trunk Handle **without** track line, connection is the same as the standard rear view camera, refer to the above picture.

-----Trunk handle **with** track line, connection guide:

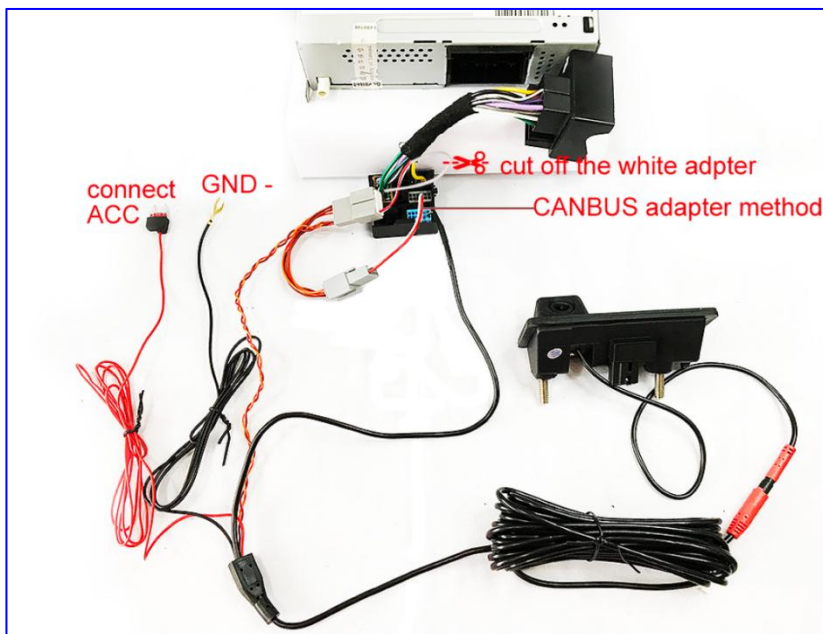

CANBUS adapter connection steps:



Find this clasp
on the car connector

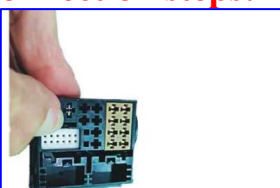

Press the clasp to the side
and press the gray connector



Connect the connector
to the cable



The status of the cable
installation complete



Plug back into
the car connector

- ▶ If your car is **not built-in camera**, no action is required. You can just connect the radio with the power adapter.
- ▶ If your car is installed with an after-market camera, please follow the instructions to connect the AV cable and the reverse detection cable.
- ▶ If your original backup camera is **RGB interface**, the radio doesn't support it, you can contact our after sale service to buy RCD360 PRO2/PRO3S+RGB to AV ADAPTER. Or replace the entire camera with our brand. The current new version of the unit, whether original or after-market, no longer uses the old RGB interface. We recommend that you replace it completely. The RGB to AV converters available on the market are also very unstable and not recommended for purchase.



- ▶ If your original backup camera is **MIB interface**, we recommend you to purchase our RCD360 PRO2/PRO3S radio.

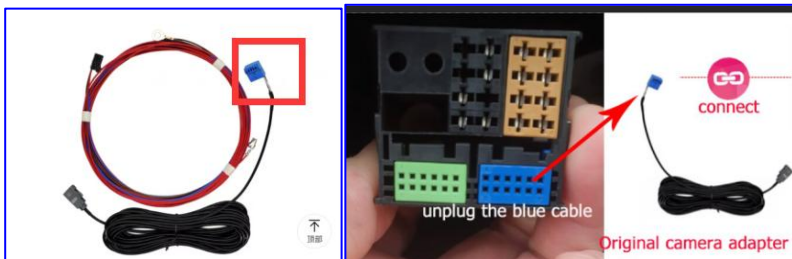

- ▶ After installing the camera, please **test it by closing the trunk** to avoid the camera not working due to the reverse lights not functioning. If you still encounter installation

issues, please refer to the instructions and contact our customer service. 99% of the problems can be resolved.

8. Protection mode

-Display, system, power amplifier temperature protection mode

When the temperature is lower than or equal to minus 20 degrees Celsius or higher than 60 degrees Celsius. The radio will enter the temperature protection mode, the screen will display [not in the operating temperature range. The screen/entertainment system will be shut down soon]. The volume of the radio will decrease.

-Low battery protection mode

When the battery power is too low, the radio will enter the low battery protection mode.

9. Speaker no sound

► If some of your car speakers are not working, first check if the volume balance is properly adjusted. The adjustment method is shown in the following diagram.



► If the issue is not solved, please choose to reset the radio. Please long press the start button 10-15 seconds to restart the radio.

Or you can factory set the radio in “System settings”

► If the issue persists, it is possible that you are using a car

audio system with a power amplifier, such as Dynaudio, Fender or other systems with power amplifiers. In this case, you need to disconnect the car battery and wait for 5 minutes before reconnecting it. This will reset the car amplifier and allow it to properly match with the audio system.



► If the above steps do not resolve the issue, please contact customer support for further assistance.

10. Microphone no sound

If the person you are calling cannot hear your voice, please check if both the car's Bluetooth and CarPlay are connected at the same time. You can only choose one connection method between CarPlay and the car's Bluetooth. If you have previously connected your phone via Bluetooth, please delete the connection, otherwise, the car's Bluetooth will automatically connect to your phone and cause the microphone to not work.

After-sales Service



Facebook



Whatsapp

- 1. Facebook page:** automodificationclub
- 2. YouTube:** @scumaxcontechology2770
- 3. Email:** service@scumaxcon.com
- 4. Technical Blog:**
<https://supercarupgrade.blogspot.com>
- 5. Official Website:** www.scumaxcon.com

YOUTUBE VEDIOS

Welcome to scan
watch the video



the QR code to



RCD360S/RCD360 PRO3 Radio