



Majority Concert

Portable Karaoke System

CNC-KAR-BLK



User Guide

Contents

Controls and Functions.	1
Remote Control and Functions	2
TV Connection.	4
What's in the Box?	4
Instruction Guide	5
Basic Operation.	5
FM Radio	5
Bluetooth Connection	5
USB Port	5
System Setup Menu	6
CD Ripping	7
Technical Specification	8
Warranty	8
Important Safety Information	8



Watch video tutorials and register your product
for a FREE 3-year warranty at
www.majorityradios.co.uk

Main Unit

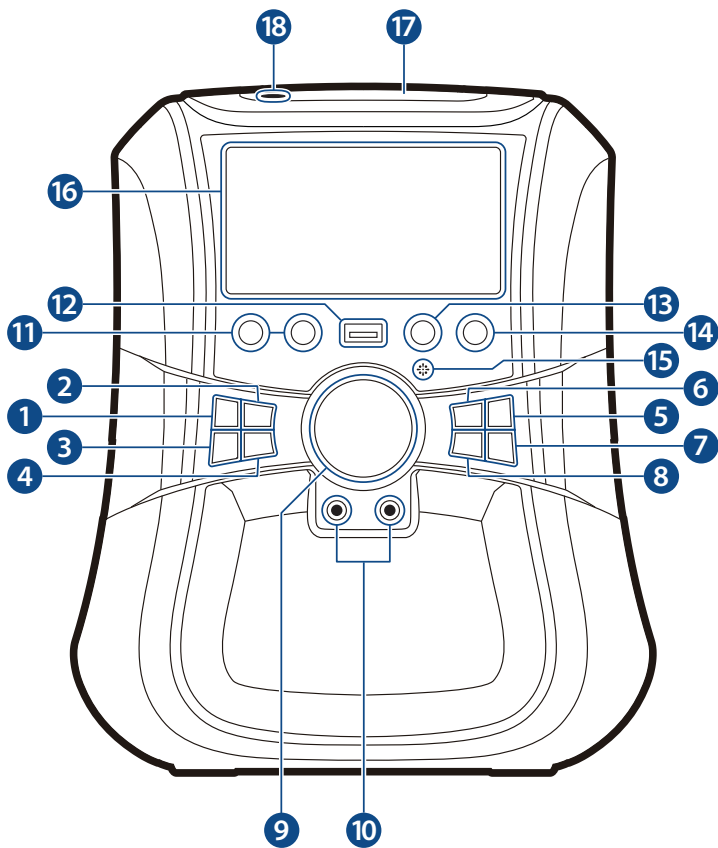

- 1. Standby
- 2. Previous
- 3. Source
- 4. Rewind
- 5. Play/Pause
- 6. Next
- 7. Stop
- 8. Forward
- 9. Volume
- 10. Dual Mic
- 11. Dual Mic Volume
- 12. USB
- 13. Echo
- 14. Vocal
- 15. Indicator
- 16. Display Screen
- 17. CD Compartment
- 18. CD Open Button

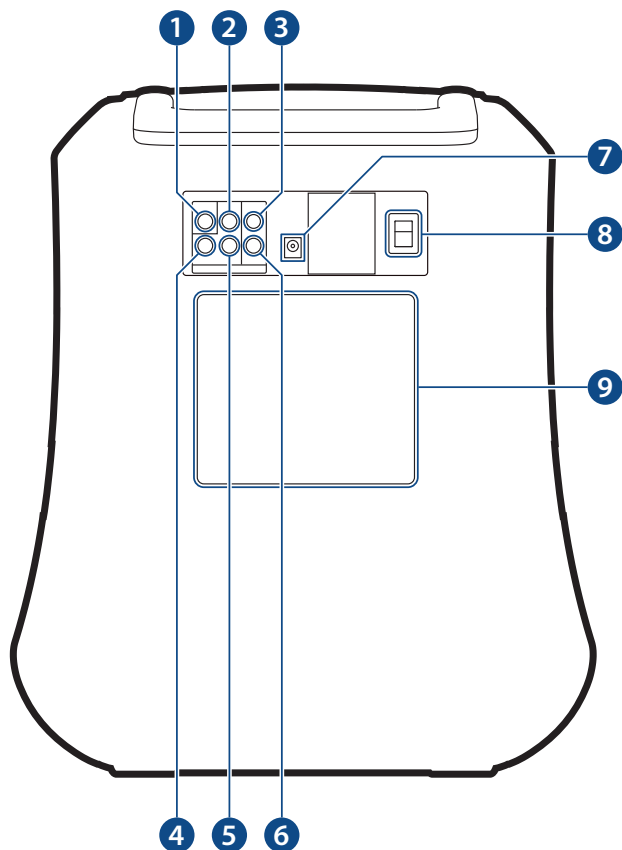

- 1. Coaxial
- 2. AV Out L
- 3. Aux L
- 4. AV Out Video
- 5. AV Out R
- 6. Aux R
- 7. DC IN
- 8. Power On/Off
- 9. Battery Compartment

Controls and Functions

Remote Control

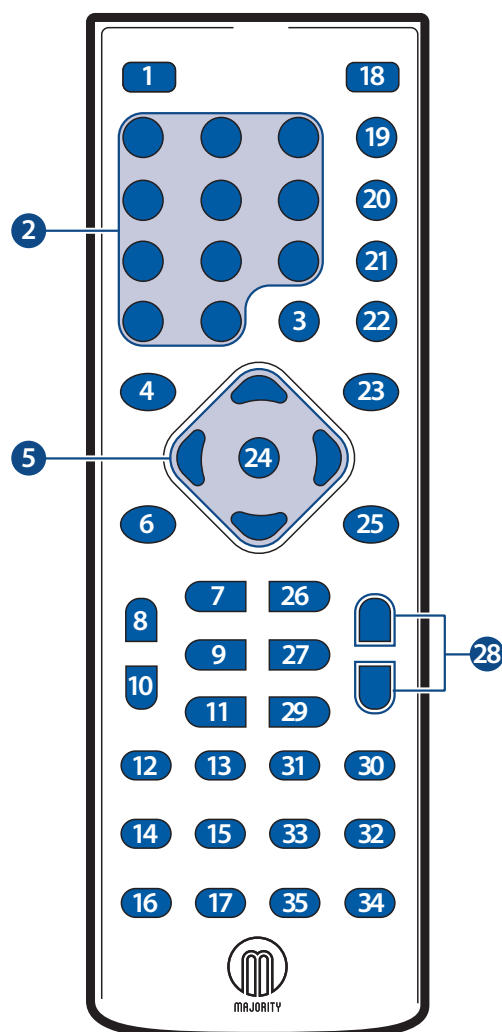

1. Power On/Off
2. Number Keys
3. Time
4. Set Up
5. Navigation
6. Title
7. Rewind
8. Source
9. Previous
10. Volume
11. Stop
12. Language

13. Left/Right Mono/Stereo
14. Subtitle
15. Angle
16. Programme
17. Vocal
18. Mute
19. A/B
20. Repeat
21. PBC
22. Slow
23. Zoom

24. Enter
25. Menu
26. Forward
27. Next
28. Vol +/-
29. Play/Pause
30. Return
31. N/P
32. Display
33. USB/Disc
34. Riping/Copy
35. Record/Stop

POWER (Ref.1) - Press this button to turn the unit on from standby or press again to put back into standby.

MUTE (Ref. 18) - Press this key to stop sound output, press again to return to normal status.

A/B (Ref.19) - This function will allow the user to repeat a desired portion of playback. To choose the part of the DVD, CD or MP3 track you would like to playback press the 'A-B' button (Ref.19) to mark point A. Then press the 'A-B' button again (Ref.19) to mark point B. The DVD or track section will repeatedly playback between these points. To cancel the playback and to continue watching or listening to the DVD or track press the A/B button (Ref.19) a third time.

NOTE: 1. This function works for DVD, MP3 and CD but not for CDG or Kodak picture CD discs.
2. For CD and MP3, the start and end point of the A-B selection must be within the same track.

REPEAT (Ref.20) - This function will allow the user to repeat a particular chapter, title or track. Press the 'Repeat' button multiple times to view options.

For DVD disc: Chapter/Title/All/Off

For CDG and CD Discs: Track/All/Off

PLAYBACK CONTROL (PBC) (Ref.21) - This function only works for video discs. User can access a specific chapter by entering the chapter number through the number buttons (0-10) on the remote control.

SLOW (Ref.22) - User can press the SLOW button repeatedly to adjust the speed of slow motion as desired. This only works on DVD discs.

TIME (Ref.3) - Pressing the 'Time' button during normal playback will allow the TV to display different time modes.

SET UP (Ref.4) - This will take you to the system set up, see page 7.

ZOOM (Ref.23) - This unit has six different zoom modes. Pressing the 'Zoom' button on the remote control repeatedly will display the various options.

TITLE (Ref.6) - The title button will take you back to the main menu of the DVD not for CD/CDG use.

MENU (Ref.25) - The 'Menu' button will take you to the main DVD menu. To resume play, press the menu button again. For CD/CDG you can switch between "Intro" and "Sequence Play" using the 'Menu' button. Intro will play the start of each song and Sequence will play one song after the other. To view the list of tracks for CD/CDG, press the 'Return' button (Ref.30).

SOURCE (Ref.8) - To change the source, press this button to switch between CD/DVD, AUX, Bluetooth and FM Radio.

LANGUAGE (Ref.12) - DVD discs can contain more than one audio sound track. Therefore the user can select the sound track they want by using the 'Language' button on the remote control. Pressing the 'Language' button repeatedly will display different audio modes if available.

LEFT/RIGHT MONO/STEREO (Ref.13) - For CD/CDG only, press multiple times to change between Stereo, Mono L, Mono R or Mix Mono. For some DVD karaoke discs you can remove the vocals using the 'L/R' button. Also see 'Vocal' button (Ref.17).

NTSC/PAL - (Ref. 31) NTSC is the video system or standard used in North America and most of South America. PAL is the predominant video system or standard mostly used in Europe.

RETURN (Ref.30) - To exit from an application press 'Return'. For CD/CDG it will take you to the list of tracks.

SUBTITLE (Ref.14) - To view subtitles press this button, to turn off press again.

ANGLE (Ref.15) - Some DVD discs contain scenes which have been shot from a number of different angles simultaneously. Therefore, the same scenes can be viewed from different angles by pressing 'Angle' button repeatedly. (The recorded angles differ from disc to disc).

NOTE: 1. This function only works on DVD disc.
2. If the DVD disc is recorded with only one angle, this function will not be available.

USB/DISC (Ref.33) - To play a USB, press this.

DISPLAY (Ref.32) - Press 'Display' to show chapter and time information for DVD.

PROG (Ref.16) - Press Programme to programme CD songs in a preselected order. Use the navigation buttons (Ref.5) and 'Enter' button (Ref.24) to make your track selection, then click on the play icon.

VOCAL (Ref.17) - Some DVD Karaoke Discs have various vocals that can be removed, to do this press the 'Vocal' button to remove the vocal. In some cases there are more than one vocal track, press 'Vocal' again to remove the second vocal. This function only works for DVD karaoke discs as most CDG discs are backing tracks without vocals.

RECORD/STOP (Ref.35) - Press to start recording source to USB, press again to stop recording.

RIP/COPY (Ref.34) - Some discs can be copied (CD and MP3), press this button to copy and save in the menu.

TV Connection

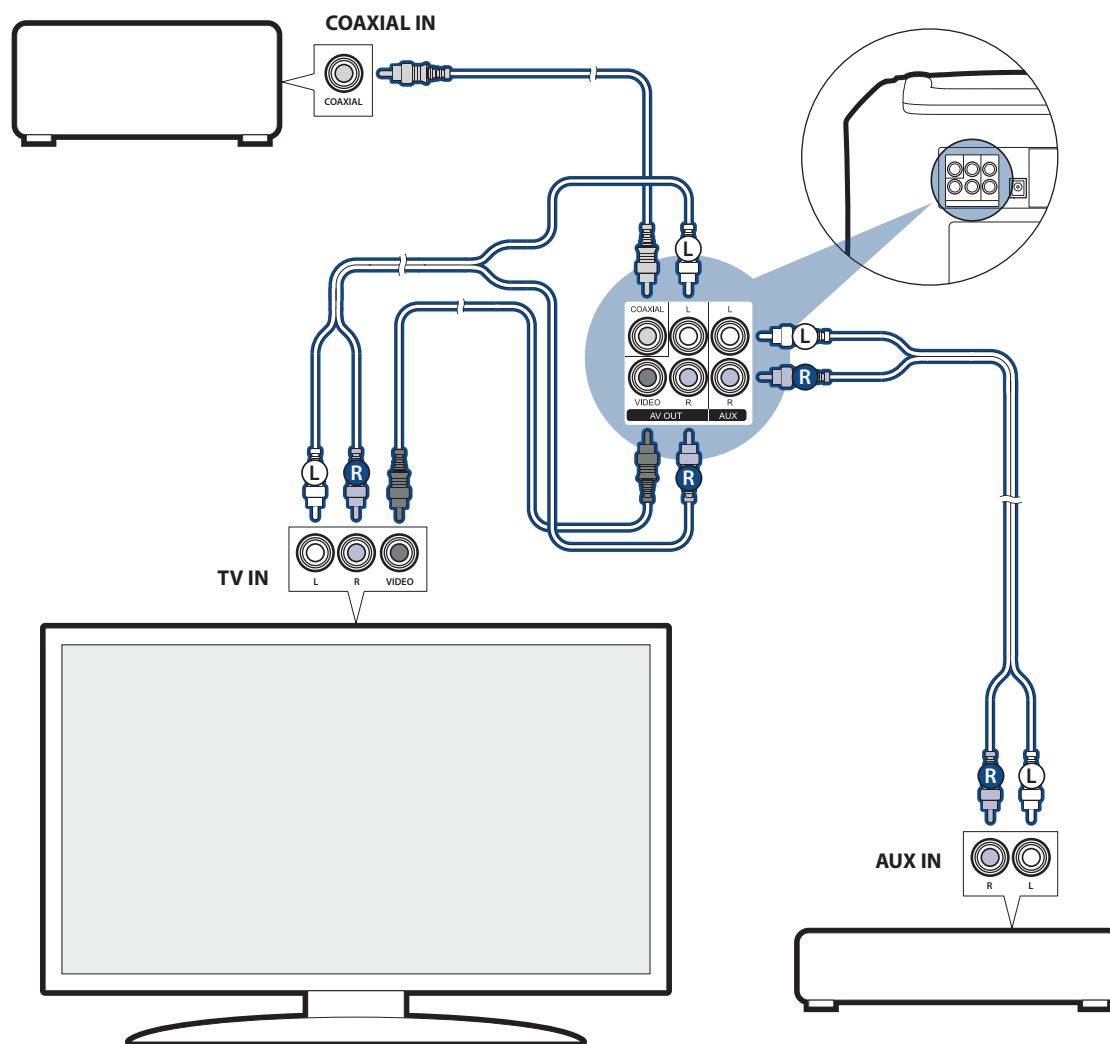

How to connect to your TV

The unit can be connected to your TV using an audio video cable 3 RCA to 3 RCA (Supplied). This will allow any picture to appear on your television screen once you have chosen the correct input on your television - all televisions are different so please refer to your TV manual for this.

To connect the karaoke unit, put one end of the audio cable into your television AV connection points and the other end into the rear of the karaoke unit - Video (**Ref.4**), Audio Right (**Ref.5**) and Audio Left (**Ref.2**). The plugs are colour coded.

What's in the Box?

- Majority Concert Karaoke Machine
- Remote Control
- UK Standard Plug DC 15V Power Supply

- 2 x Microphones
- Instructions Guide
- 1 x 3 RCA Cable

Please note all (Ref.) refer to the Main Unit Controls and Functions mapping guide on Page 1 or, where specified, the Remote Control Controls and Functions Mapping Guide on Page 2.

Basic Operation

Plug the 15V adapter connector into the back of the system labelled DC 15V (Ref.7) and the power supply into the mains.

Turn on the 'On/Off' button (Ref.8) on the back of the machine.

Press the 'Standby' button to turn on the unit (Ref.1). The unit will go straight to DVD/CD Mode and read the disc and start playing.

To select a source press the 'Source' button (Ref.3). Press multiple times until your required option is selected which will show on the display screen.

There are four options:

- CD/DVD
- AUX
- Bluetooth
- FM Radio

Standby

To place the music system back on standby, press the 'Standby' button (Ref.1) then switch the 'On/Off' button (Ref.8) to "Off".

To turn off fully switch the machine off at the mains. The cord must be out of reach of children.

FM Radio

To select FM Radio mode, press through your choices using the 'Source' button (Ref.3). Your choices will be displayed on the front display screen (Ref.16) – choose "FM".

Press 'Play/Pause' button (Ref.5) and the music system will automatically save up to 40 stations that have a good signal.

To select saved stations use the 'Previous' (Ref.2) or 'Next' (Ref.6) buttons.

To fine tune use the 'Rewind' (Ref.4) and 'Forward' (Ref.8) buttons to tune a frequency by 0.1HZ step-by-step.

How to store and recall a station

Find your station and press 'Prog' (Ref.16) on the remote control, the display will show "SAVE [1]". Click on the number you want to save it as. The unit will then save it after a few seconds.

To recall, ensuring you are in FM mode and press the number you want to recall.

Bluetooth Connection

Bluetooth Mode

You can enjoy audio by pairing and connecting any Bluetooth-enabled portable device with the unit through Bluetooth wireless connection.

To select Bluetooth press through your choices using the 'Source' button (Ref.3). The choices will be displayed on the front display screen (Ref.16) – choose "Bluetooth Mode".

Turn Bluetooth on your phone and "CNC-KAR-BLK" will appear, click on this to connect.

The unit will play a short musical sound when connected.

To select music you will need to select the album or playlist from your phone.

USB Port

Connect the USB into the USB port (Ref.12).

To select your source press the 'Source' button (Ref.3) to scroll through your choices which will be displayed on the front display screen (Ref.16) – choose "Disc Mode".

Then press the 'USB/Disc' button (Ref.33) on the remote. The display will change from "No Disc" to "USB Mode".

Note: You will need to ensure that any discs have been removed from the DVD/CD compartment.

USB supports the following formats:

- Movie file support: AVI, MPEG, DAT.
- Audio file support: MP3, WMA.
- Picture file support: JPEG

Operation is the same as the DVD Player with regards to functions.

System Setup Menu

Ensure you have selected "Disc Mode" via the 'Source' button (Ref.3).

Press the 'Setup' button on the remote control (Ref.4). The system set up menu will be displayed.

Pressing the 'Up' and 'Down' navigation keys (Ref.5) on the remote control will take you through the five different set up options. These are: System Set Up, Language Set Up, Audio Set Up, Video Set Up and Digital Set Up.

Once on your required option, press the right navigation button (Ref.5) on the remote control.

Move the cursor using the 'Left/Right', 'Up/Down' buttons (Ref.5) and the 'Enter' button (Ref.24) on the remote. Use the 'Setup' button (Ref.4) to exit the menu.

System Set Up

TV System

There are four types of colour encoding systems that affect the visual quality, PAL, PAL60 or NTSC. AUTO can also be chosen - the system will automatically match the colour.

Screen Saver

Select ON/OFF on the screen using the navigation buttons on the controller (Ref.5) if you would like the standard screen saver to automatically show after a period of inactivity or if you would like it off.

TV Type

Select the best TV Type 4:3PS, 4:3LB or 16:9. Press the 'Enter' button (Ref.24) to confirm your selection.

Password

The system can be locked and unlocked with the following code: 8888. Once it has been locked, settings can not be changed.

Rating

Some discs may not be suitable for children. You can select various options. This sets the parental rating limits on the discs being played.

Default

To return the system back to factory settings select "Restore" on the screen using the navigation buttons on the remote (Ref.5) and press 'Enter' (Ref.24).

Move the cursor using the 'Left/Right', 'Up/Down' buttons (Ref.5) and the 'Enter' button (Ref.24) on the remote control. Use the 'Setup' button (Ref.4) to exit the menu.

Language Set Up

OSD Language - Select your language preference from: English, German, Spanish, French, Portuguese and Italian.

Audio Language - Select your audio language preference from: English, German, Spanish, French, Portuguese, Italian and Latin.

Subtitle Language - Select your subtitle language preference from: English, German, Spanish, French, Portuguese, Italian or Off.

Menu Language - Select your audio language preference from: English, German, Spanish, French, Portuguese, Italian and Latin.

Audio Set Up

Audio out, Microphone Set Up, Key and Microphone Volume have adjustable levels.

Video Set Up

Adjust the system's brightness, contrast, hue, saturation and sharpness.

Digital Set Up

Set the dynamic range and choose Stereo or Mono.

CD Ripping

When playing a CD/MP3 disc you can copy songs to a USB device.

Press the 'Rip/Copy' button on the remote control (Ref.34), this will open the set up menu.

Use the 'Up/Down', 'Left/Right' key cursors to select your options, press 'Enter' (Ref.24) to confirm.

Options

Encoder Options – Select the transcribe file speed. "1 X" will transcribe the file with one side playing as normal and the other side transcribing. "4 X" – the unit will transcribe faster and there will be no sound.

Bit Rate – There are five bit rate choices when transcribing the files – choose the most suitable to transcribe the file.

Note: The higher the bit rate the higher quality music.

File Options – Check (click in the box) then create ID3 if you want to create an ID. Also check (click in the box) then create playlist box to include the file in a playlist.

Storage Options – After the files have been transcribed, choose the device for them to be saved to.

Tracks

Track Title – Use the key cursors to move on to "Tracks, then right key to "Trk Title", press 'Enter' and this will choose all songs on the CD disc. Press 'Enter' again to cancel. Move the cursor up and down to make track changes. The length displays the track time.

Start

Select "Start" using the cursor keys and then "Enter". Press 'Enter' for transcribing to begin.

Total track size: The total tracks waiting to transcribe.

Total time: The total time for the songs waiting to be transcribed.

Total size: Total size of files waiting to be transcribed.

Quit

To stop ripping go to 'Quit' on the menu bar.

NOTE: After CD Ripping there will be a new CD RIP file folder on the USB device.

How to delete a file

To delete a file when using USB multimedia files, press the 'Angle' button (Ref.15) on remote control which will open the "File Delete Menu". Under the "Option Menu", select the file type you wish to delete. Under "Folders", select the folder which is going to be deleted. Under "Tracks" select the track that is going to be deleted. Under the "Start" option, click on the file to be deleted and press 'Enter' (Ref.24) on the remote control. Once the file has deleted go to "Quit" to leave the operation menu.



Watch video tutorials and register your product
for a FREE 3-year warranty at
www.majorityradios.co.uk

Technical Specifications and Warranty

Technical Specifications

Signal Output	Colour System: PAL/NTSC/AUTO Audio System: Audio DAC 24bit/96KHz
Video Format	MPEG-4, DIVX, DVD Video, DVD Audio, Super Video, CD, CD-DA, HDCD, CD-R/RW
Audio Format	MPEG1, LAYER1, LAYER2, LAYER3
Radio	FM 87.5-108MHz

Power Supply and Batteries

The unit is powered and charged by UK Standard Plug DC 15V.

The unit has a built in rechargeable battery. The light indicator (**Ref.15**) on the front of the unit will light up Green when charging, Blue when fully charged and Red when the unit is in standby mode. The unit takes approximately 3 hours to fully charge.

The remote control uses a 2 x AAA batteries and the compartment can be found on the back of the control.

Warranty

All products come with a standard 12 month warranty.

All items must be registered on

www.majorityradios.co.uk for the warranty to be valid.

Once on the web page use the menu to find "register your product".

You will also be given the chance to extend your warranty for an additional 24 months free of charge.

IMPORTANT SAFETY INFORMATION

1. Read these instructions.

2. Keep these instructions. Instructions are also available for download at www.majorityradios.co.uk

3. Heed all Warnings.

4. Follow all instructions.

5. Do not clean the apparatus near or with water. 6. Clean only with a dry cloth.

7. Do not block any ventilation openings.
Install in accordance with the manufacturer's instructions.

8. Do not install near any heat sources such as radiators, heat registers, stoves, or other apparatus (including amplifiers) that produce heat.

9. Protect the power cord from being walked on or pinched particularly at plugs, convenience receptacles, and the point where they exit from the apparatus.

10. Only use attachments/accessories specified by the manufacturer.

11. Unplug this apparatus during light storms or when unused for long periods of time.

12. Refer all servicing to qualified service personnel.
Servicing is required when the apparatus has been damaged in any way, such as power-supply cord or plug is damaged, liquid has been spilled or objects have fallen into the apparatus, the apparatus has been exposed to rain or moisture, does not operate normally or has been dropped.

13. No naked flame sources, such as lit candles, should be placed on the apparatus.

14. Dispose of used electrical products and batteries safely according to your local authority and regulations.

ADDITIONAL WARNINGS

The apparatus shall not be exposed to dripping or splashing and no objects filled with liquid, such as vases, shall be placed on apparatus.

Main plug is used to disconnect device and it should remain readily operable during intended use. In order to disconnect the apparatus from the main mains completely, the mains plug should be disconnected from the main socket outlet completely.

Battery shall not be exposed to excessive heat such as sunshine, fire or the like.

RECYCLING ELECTRICAL PRODUCTS

You should now recycle your waste electrical goods and in doing so help the environment.



This symbol means an electrical product should not be disposed of with normal household waste. Please ensure it is taken to a suitable facility for disposal when finished with.

IMPORTANT: Please read all instructions carefully before use and keep for future reference



Risk of electric shock.
Do not open



Read all instructions carefully before use
and keep for future reference



When servicing, use only identical
replacement parts





MAJORITY

www.majorityradios.co.uk