



KOGAN SMARTERHOME™ 3MP OUTDOOR BATTERY- POWERED SECURITY CAMERA

(WITH BUILT-IN FLOODLIGHT AND SOLAR PANEL)

KASMOTCMSLA

OVERVIEW

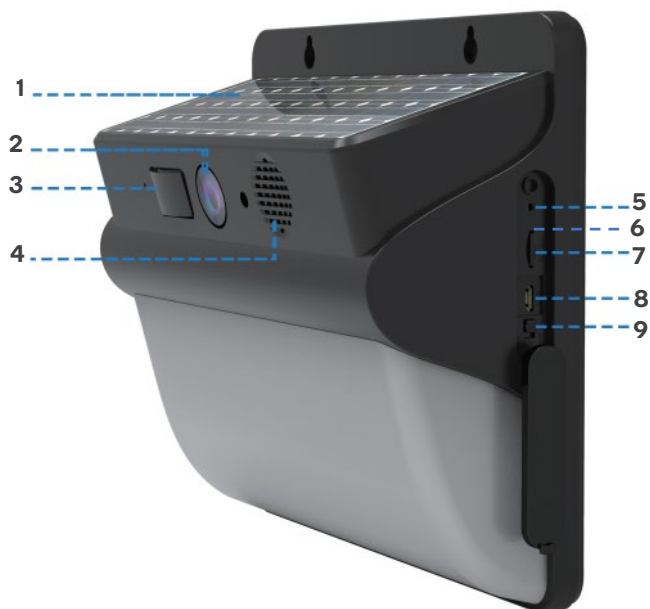

- 1 Solar Panel
- 2 Lens
- 3 PIR
- 4 Speaker
- 5 Reset Button
- 6 Indicator
- 7 Memory Card Slot
- 8 USB Port
- 9 Power Switch

INSTALLATION

Before Installation

- This camera operates exclusively on a 2.4G Wi-Fi network.
- If your Wi-Fi signal is weak at the installation location, you may need a Wi-Fi extender.
- Charge your camera fully before powering it on. It takes approximately 10 hours to charge completely.
- When installing the camera, ensure that the distance between the camera, router, and phone is within a range that maintains a stable connection.

Mounting the Camera

1. Identify the position where the camera needs to be mounted.
2. Ensure you have the two screws and rubber plugs provided in the package.
3. On the selected position, mark the spots for the two screws, corresponding to the screw holes on the back of the camera.
4. If necessary, drill holes at the marked spots and insert the rubber plugs into the holes.
5. Screw the provided screws into the rubber plugs or directly into the marked spots if rubber plugs are not needed. Leave the screws protruding slightly.
6. Align the screw holes on the back of the camera with the installed screws and hang the camera onto the screws.
7. Ensure the camera is securely mounted and stable on the screws.
8. Adjust the camera angle as needed for optimal coverage.

CONNECT TO SMARTERHOME™ APP

Install App

Download the “Kogan SmarterHome” app from the Play Store (Android) or App Store (iOS).



Play Store (Android)



App Store (iOS)



To register:

1. If you already have a SmarterHome account, select ‘Log In’. To register a new account, select ‘Sign Up’.
2. The system will automatically recognise your country. If needed, you can manually select your country from the drop-down box. Enter your email address and tap ‘Get Verification Code’ to continue.
3. A 6-digit code will be sent to the submitted email address. Enter this code before the one-minute timer expires.
4. Continue to the next page and complete your SmarterHome profile.

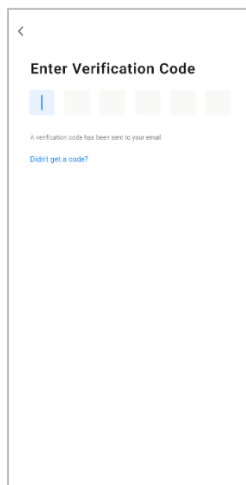
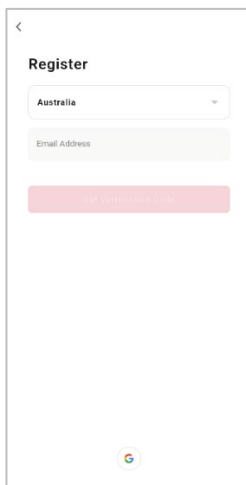
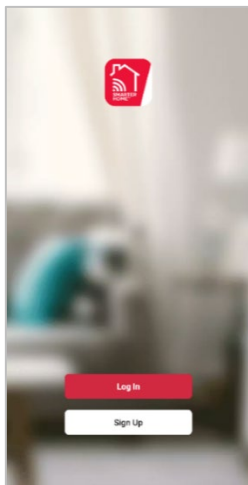

Set Device in Pairing Mode

When the device is first turned on, it may automatically enter pairing mode (the indicator will slowly flash red).

If not automatically in pairing mode when powered on, you can manually set the device in pairing mode by pressing and holding the 'Reset' button for 7 seconds until the 'Initialising camera' voice prompt is heard and the indicator rapidly flashes red.

Add Device Through Network

1. Once registered, tap **"Add Device"** on the app's home page, or the **"+"** in the upper right corner, to add a new device through the network.
2. Select the product type from the list of options in the app (Home Security > Cameras).
3. Ensure that the device is in pairing mode, with the indicator slowly or rapidly flashing red, and tap **"Confirm light is rapidly flashing"**.
4. Enter your Wi-Fi details. It is important that your SmarterHome™ device and the app are connected to the same Wi-Fi network during setup.

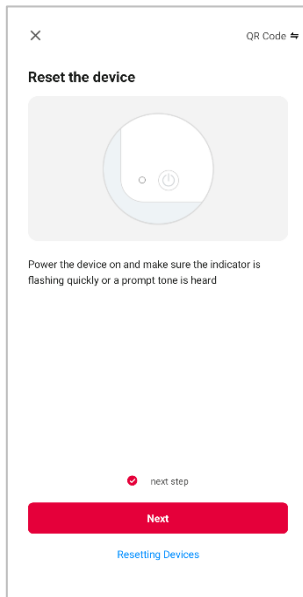
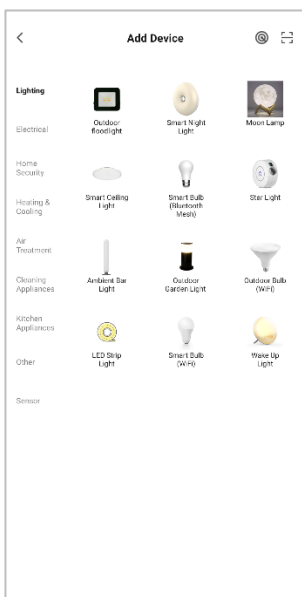
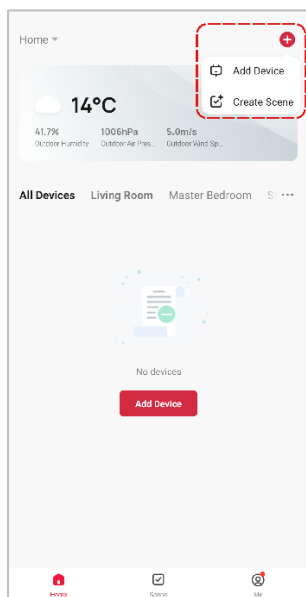

Notes:

- The device and the app have to use the same Wi-Fi network.
- The device is only compatible with 2.4Ghz networks.
- Depending on the product, Steps 3 and 4 may be in opposite order.

5. Calibrate the smart camera by holding your smartphone 15-20cm away from the camera lens until it successfully scans the QR code shown on the following screen of the setup. The device will make a prompt sound to confirm, click “I heard a prompt” to proceed to the next screen.
6. The device will commence the pairing process and connect to the app. Ensure your Wi-Fi router, mobile phone, and the SmarterHome™ device are kept close until connection is complete.
7. After successfully being added, you will have the option to rename the device and assign it to a location. It will now be listed on the app’s home page. Tap the device listing to enter its control page.

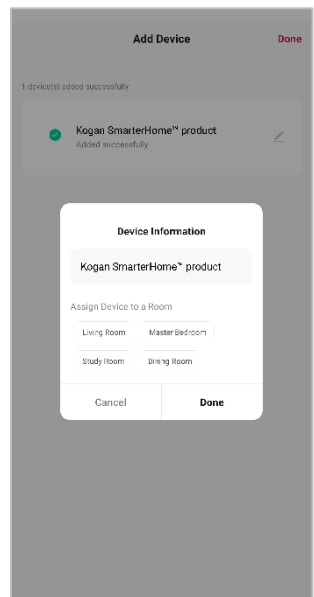
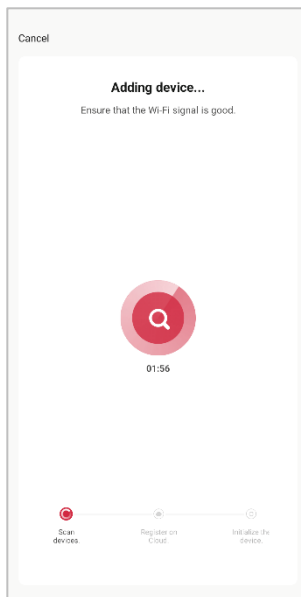

Note:

Once connected, you can select Create Scene from the “+” in the upper right corner (or from the Scene tab) to group connected SmarterHome™ products and automate their functions.

GOOGLE HOME CONTROL

Note:

You will need to have set up a Google Home account prior to linking your Kogan SmarterHome™ device.

Adding “SmarterHome” to the Google Home App

1. From the home page of the Google Home app, select the “+” icon (top left corner, see arrow in the below screenshot) to access the ‘Add and manage’ page.
2. Select ‘Set up device’, then select the ‘Works with Google’ option.

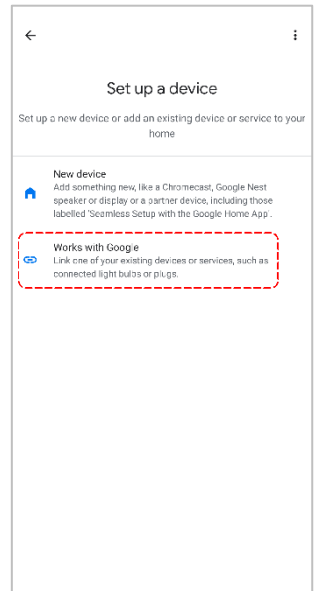
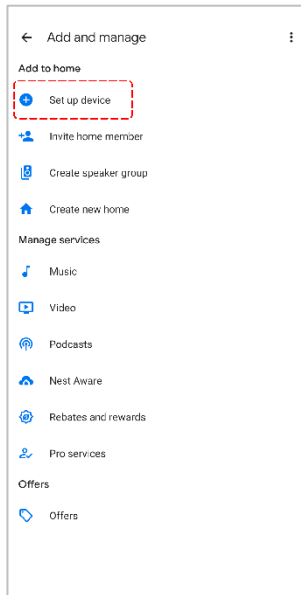
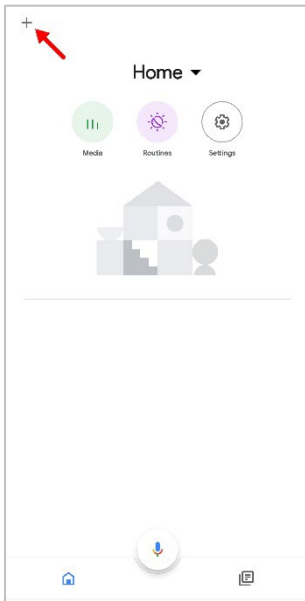

3. Select the search bar and type 'Smarter Home' to locate the Kogan SmarterHome™ service.
4. From here, you will be prompted to sign into your SmarterHome™ account using either your email or mobile phone number, depending on which method you used to register your account.
5. Select "Kogan SmarterHome™" from the app options.

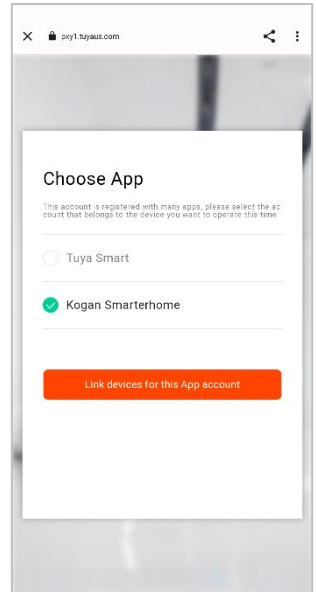
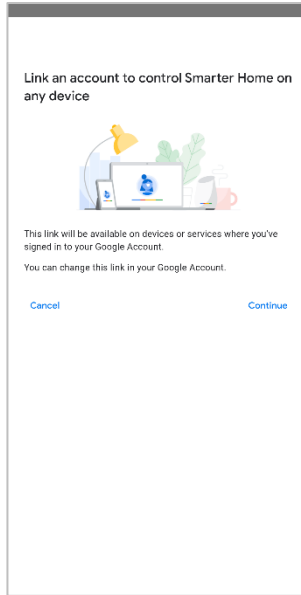
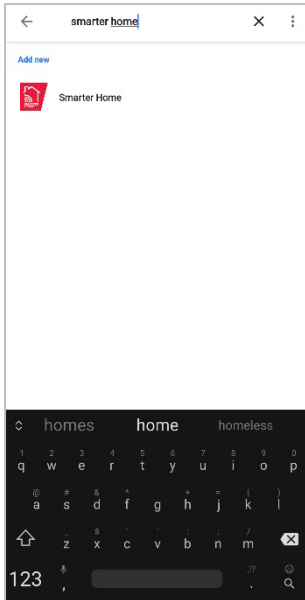

6. Tap 'Authorise' to grant Google permission to access the SmarterHome™ app and your devices.
7. Once connected, the app will display any compatible devices linked to your SmarterHome™ account. From here you can assign them to rooms and set up any routines. Tap on any of the devices to view a list of available commands.

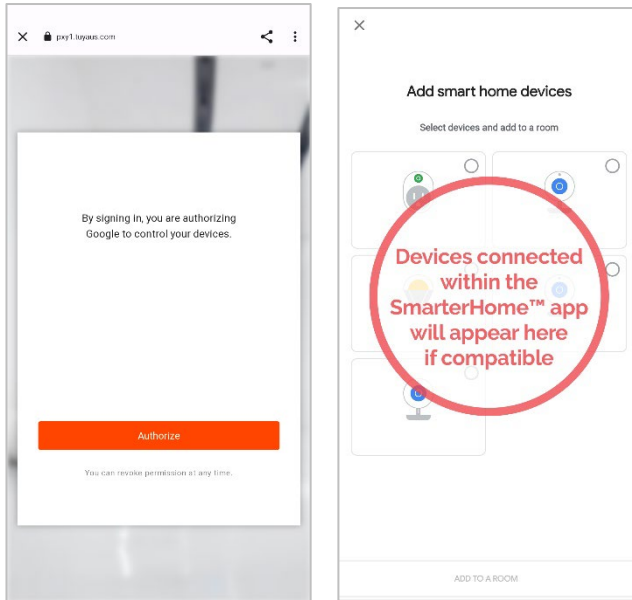

Note:

Please note that Google Home can only control the base/core functions of any compatible SmarterHome™ devices. To make full use of this product's smart functionality, please use the Kogan SmarterHome™ app.

AMAZON ALEXA CONTROL

Note:

You will need to have set up an Alexa account prior to linking your Kogan SmarterHome™ device.

Adding “SmarterHome” to the Alexa App

1. From the home page of the Alexa app, select the “≡” icon in the bottom-right and select “Skills & Games” from the sidebar.
2. Select the search bar and type ‘Smarter Home’ to locate the Kogan SmarterHome™ skill.

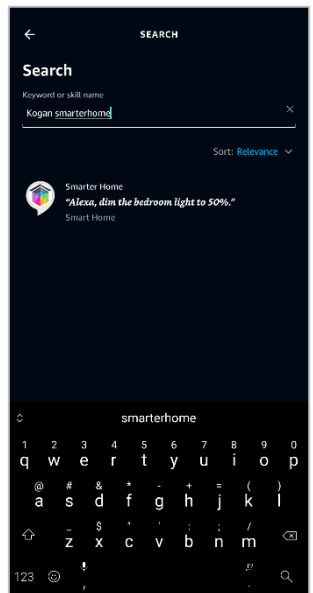
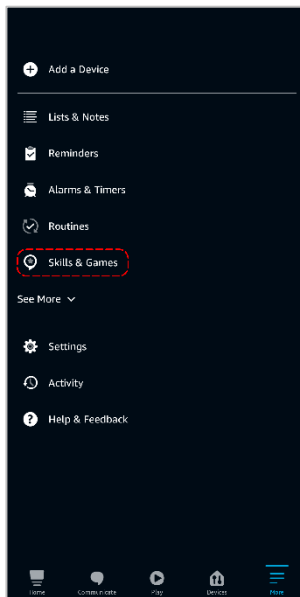
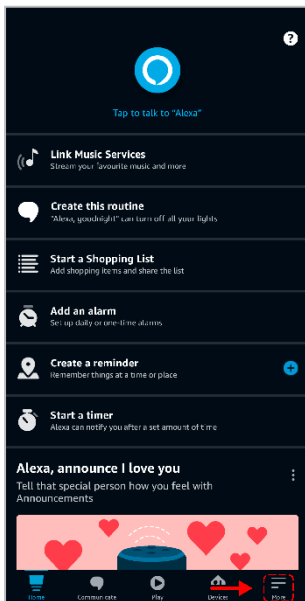

3. Tap 'Enable to Use' to add the Kogan SmarterHome™ skill to Alexa.
4. From here, you will be prompted to sign into your SmarterHome™ account using either your email or mobile phone number, depending on which method you used to register your account.
5. Select "Kogan SmarterHome™" from the app options.

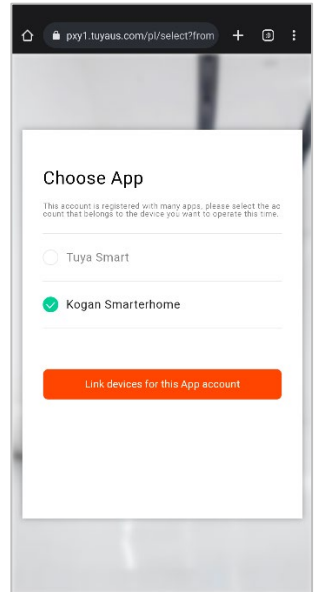
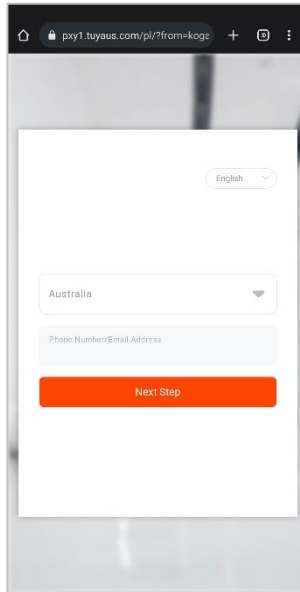
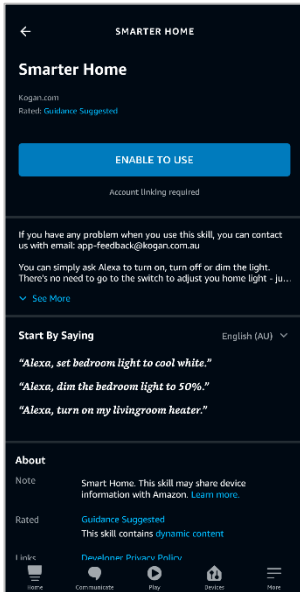

6. Tap 'Authorise' to grant Alexa permission to access the SmarterHome™ app and your devices.
7. Once connected, the app will perform a search and display the devices linked to your SmarterHome™ account. When your devices have successfully connected to the Alexa app, you will be able to control your Kogan SmarterHome™ devices via Alexa's voice commands.

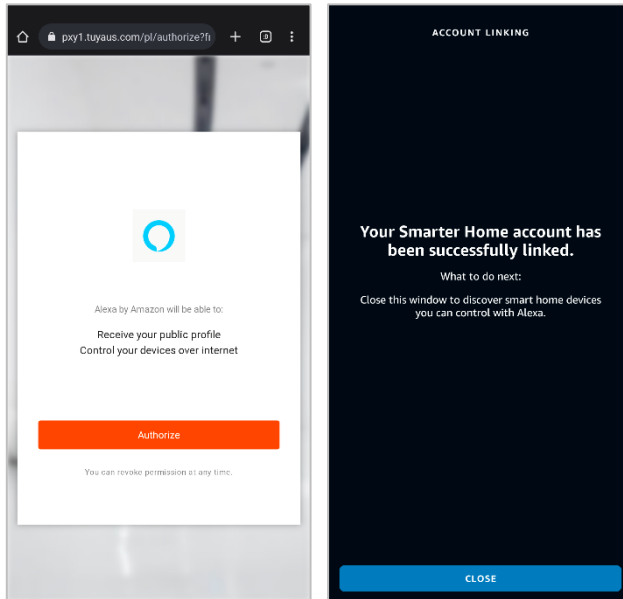

Note:

Please note that Alexa can only control the base/core functions of any compatible SmarterHome™ devices. To make full use of this product's smart functionality, please use the Kogan SmarterHome™ app.

SPECIFICATIONS

Uses	Home/office/store security & surveillance
Video Resolution	2MP
Frame Rate	25fps
Video Format	AVI
Coded Format	H.265
Image Sensor	2MP
FOV	125 degrees
Storage	Micro SD card up to 128GB (not included)
	Cloud storage
Recording Mode	PIR motion activation
Audio	Loud two-way talk with noise cancellation
PIR Distance	8-10 meters
PIR Detection Angle	110 degrees
White LED	40 pieces
Power Supply	Built-in 10400mAh rechargeable battery
	3W solar panel
Recording Capability	1920 x 1080
Battery Standby Time	365 days
Angle of View	110 degrees
Night Vision	8-10 meters (colourful night vision)
Waterproof	IP66
Spotlight	Available
Remote Access	Supported
Connectivity	802.11 b/g/n Wi-Fi connection @ 2.4GHz (does not support 5G 802.11 ac Wi-Fi)
Internet Requirements	Requires a minimum upload speed of 2Mbps for optimal performance
Installation	10-15 minutes average install time
Operating System	iPhone/Android smart phone
Operating Conditions	Weather resistant between -20°C to +60°C (-4°F to 140°F)

NOTES

[illegible]

Need more information?

We hope that this user guide has given you the assistance needed for a simple set-up.

For the most up-to-date guide for your product, as well as any additional assistance you may require, head online to **help.kogan.com**

kogan.com