



Gourmia Espresso Multi Capsule Machine

USER
MANUAL

Model# GCM-7000



Read this manual thoroughly
before using and save it for
future reference

Model: CG9129-GS

© 2016 Gourmia
www.gourmia.com
The Steelstone Group
Brooklyn, NY

All rights reserved. No portion of this manual may be reproduced by any means whatsoever without written permission from The Steelstone Group, except for the inclusion of quotations in a media review.

Although every precaution has been taken in the preparation of this manual, The Steelstone Group assumes no responsibility for errors or omissions. Nor is any liability assumed for damages resulting from the use of the information contained herein. Although every effort has been made to ensure that the information contained in this manual is complete and accurate, The Steelstone Group is not engaged in rendering professional advice or services to the individual consumer; further, The Steelstone Group shall not be held responsible for any loss or damage allegedly arising from any information or suggestion in this manual.



Welcome to the Exciting World of *Fresh Espresso* from Gourmia

Congratulations on your purchase of the Capsule and Ground Espresso Machine from Gourmia, exclusively designed for the discerning espresso lover!

If you are one of those people who cherishes, or maybe even worships, a good fresh ground cup of espresso – that “pick-me-up” goodness when you walk into the room and the smell of freshly brewed, real, delicious espresso – you’ve made the right choice.

With your new Gourmia Capsule and Ground Espresso Machine, preparing fresh espresso that exceeds the expectations of your most demanding coffee connoisseurs is only moments away. Whether you prefer fresh ground, or the convenience and variety of capsules, we’re confident that you’ll find your new compact Espresso Machine from Gourmia easy and fun to use, with the end results being a fresh full-bodied espresso experience that you are sure to love over and over again!

The pages of this manual offer full and comprehensive instructions to guide you through the functions and features of the Gourmia Espresso Maker. Inside this guide you will also find information on its modes of operation, complete step-by-step instructions for the operation, assembly, cleaning, and maintenance of your appliance.

Please read all safety instructions thoroughly to ensure safe usage at all times.

Thank you for your purchase! We sincerely hope you will enjoy this as well as all the many innovative products brought to you by our family at Gourmia.

IMPORTANT SAFEGUARDS

1. Please read the Manual and safety notes thoroughly before beginning operation.
2. Keep Coffee Machine out of children's reach.
3. Make sure voltage indicated on the rating plate agrees with that of the electrical installation.
4. Damaged power cord cannot be used, the machine shall stay away from heat sources and flammable materials:
5. Do not use the machine outdoors, immersed in liquid or close to heat source.
6. If the power supply cord is damaged, it must be replaced by the manufacturer or its services agent or a similarly qualified person in order to avoid a hazard. Please keep the circuit dry and use original accessories.
7. Turn off the power and unplug the power before moving the machine.
8. The original packaging can well protect the coffee machine during the transportation, please retain the packaging box.
9. Proper use and maintenance will extend the life of your coffee machine.
10. Do not open any component or cut off the power supply of the coffee machine during operation.
11. If machine does not work properly, contact the distributor. Do not dismantle the machine or try to fix it on your own. Bring the machine to authorized service center for repair if necessary. The manufacturer will assume no liability for any damage due to unauthorized servicing.
12. The machine should not be operated by the following people: Children, people with mental illness, physical defect, or have a lack of knowledge or experience using this product. Unless the said people have been supervised or guided by qualified personnel who will take full responsibility for their safety during operation.

FOR HOUSEHOLD USE ONLY

TABLE OF CONTENTS

Know Your Espresso Machine.....6

Before Using The Espresso Machine . 7

Using Your Espresso Machine8

Setting Your Espresso Machine.....9

Trouble Shooting 10

Maintenance and Care 11



KNOW YOUR ESPRESSO MACHINE

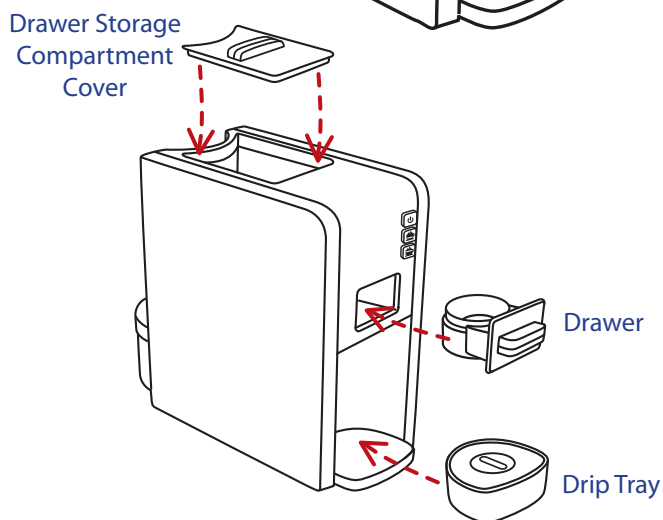
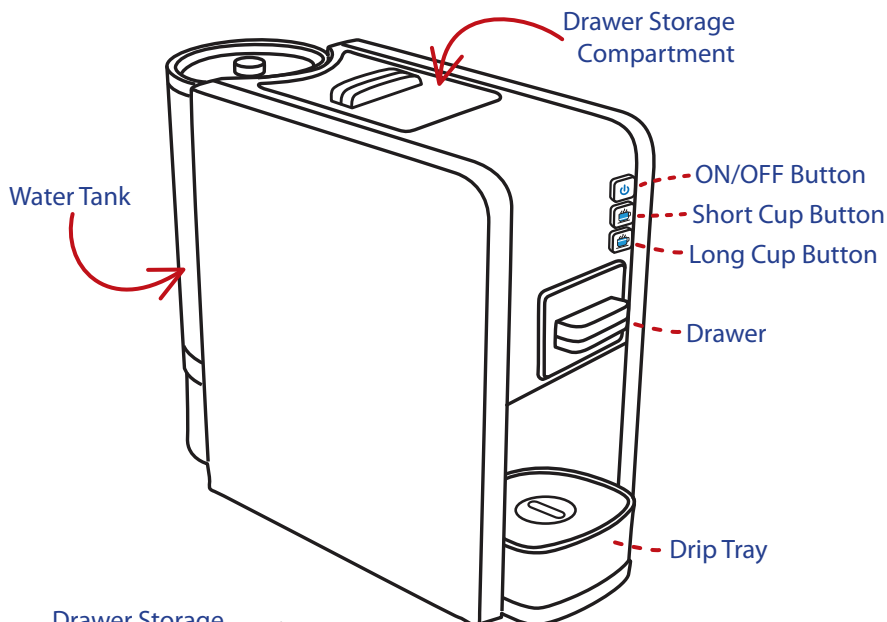

Choose the correct drawer for your capsule brand.
Choice of 4 drawers.
More are available for your specific system.

NC Drawer

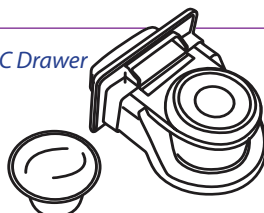

Nespresso

CK Drawer

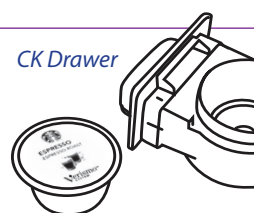

CBTL/Caffitaly, K-fee, Ve

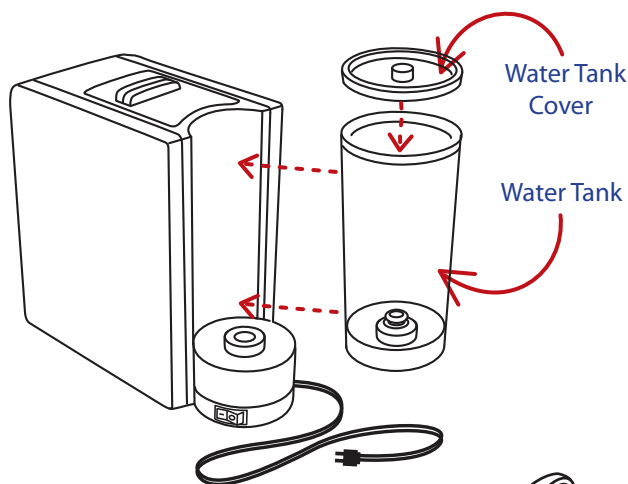
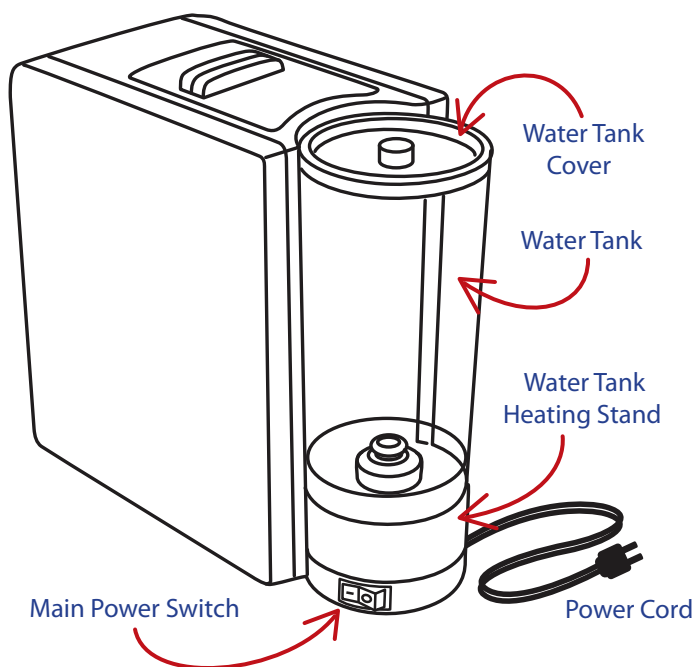

DGDrawer

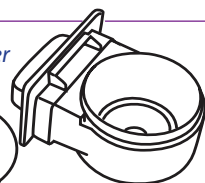

Dole Gusto

GC Drawer

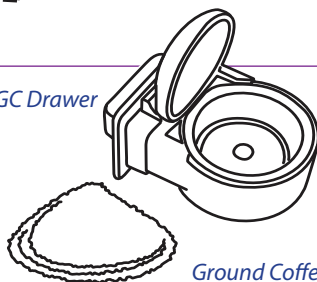

Ground Coffee

ee, Verismo*

* by Starbucks

Using Your Espresso Machine

1. Remove all items from the box carefully, and inspect to make sure that there is no damage to any part.
2. Place the Capsule Espresso Machine on a dry secure surface near a wall outlet.
3. The Water Tank should first be cleaned thoroughly with warm water, rinsed and dried before use.
4. Fill the Water Tank with cool purified water only. Make sure not to over fill the Water Tank.
5. Cover the Water Tank with its lid, and place it firmly on the Water Tank Heating Stand.

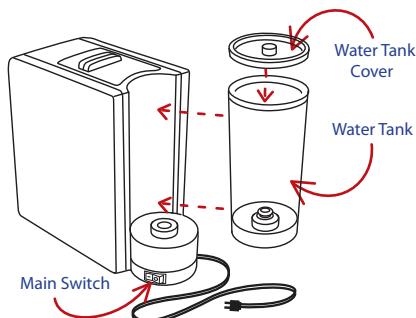

6. Connect the power plug to the wall outlet, turn on the power by pressing the Main Switch on the bottom of the Water Tank Heating Stand.

Once the power has been turned on the ON/OFF button will turn on red.

7. Press the red button to turn the unit on.

The button will begin flashing blue light. After flashing numerous times all the buttons will turn Blue - indicating Stand-by Mode. Your Capsule Espresso Machine is now ready to make espresso, or to be programmed. (See instructions on next page)



8. Select your desired coffee capsule along with its corresponding drawer. (See chart on previous page for available choices.)
9. Place the coffee capsule into the drawer, and slide the drawer into its slot in the front of the unit.
10. Place your espresso cup onto the Drip Tray below the coffee nozzle.
11. Choose the size of drink you would like.
For a Long (65ml default) cup - press the bottom blue button.
For a Short (30 ml default) cup - press the middle button.
12. Time and volume may vary depending on the capsule brand you choose.



Setting the Quantity

1. While each button has a default setting for the amount of coffee it will dispense, you can also adjust its amount to suit your needs.
This can be accomplished while the unit is in standby mode - with ALL THREE BUTTONS in BLUE.
2. For the short setting, press and hold down the Short Cup Button for as long as you want it dispense coffee (from 15 seconds but no longer than 80 seconds) and then release it. The machine will remember this setting when this button is used. To change the Long Cup setting simply repeat the above instructions while holding down the Long Cup Button.
3. To return back to the default setting: Press both the Short and Long Cup buttons at the same time, until they flash 3 times. The buttons will now return to their default settings.

Setting the Temperature

1. While the unit has a default temperature setting, six more temperature settings are available. The coffee temperature may be increased 4 levels and decreased 2 levels. *(To change back to default setting follow #3 step from above)*

2. TO DECREASE TEMPERATURE LEVEL:

Unit must be in standby mode - with ON/OFF button in RED.

Note: Default level is considered Level 3.

- To decrease temperature by one level, press the Short Cup Button for one second - it will flash two times, indicating that the Short Cup Button will now dispense at level 2 heat setting.
- To decrease by two levels, press the Short Cup Button two times - it will now flash 1 time, indicating that the Short Cup Button will now dispense at level 1 heat setting. *(the lowest)*

3. TO INCREASE TEMPERATURE LEVEL:

Unit must be in standby mode - with ON/OFF button in RED.

Note: Default level is considered Level 3.

- | | | | |
|--|--|--|---|
| • To increase temperature by one level, press the Long Cup Button for one second - it will flash 1 time, indicating that the Long Cup Button was increased by one level, to level 4. | • To increase temperature by two levels, press the Long Cup Button two times - it will flash 2 times, indicating that the Long Cup Button was increased by two levels, to level 5. | • To increase temperature by three levels, press the Long Cup Button three times - it will flash 3 times, indicating that the Long Cup Button was increased by three levels, to level 6. | • To increase temperature by four levels, press the Long Cup Button four times - it will flash 4 times, indicating that the Long Cup Button was increased by 4 levels, to level 7. <i>(the maximum)</i> |
|--|--|--|---|

Trouble Shooting

NO LIGHT:

Check the power supply, fuse and main switch.

NO COFFEE:

Water tank may be empty. Fill water tank and press the button several times to make sure the water tank supplies water smoothly.

NOTHING HAPPENS AFTER PRESSING THE BUTTON:

Check to make the drawer is in the right position. Pull drawer out and slide it back in carefully.

THE DRAWER CAN'T BE PULLED OUT:

Turn off the machine to release the pressure inside the machine, then try to pull out the drawer again.

LOUD NOISE:

Check to see if the water tank is filled and the tank is properly inserted.

THE MACHINE TURNS OFF BY ITSELF:

If the machine is not used for 25 minutes it will automatically go into Energy Saving mode to protect the machine.

ALL LIGHTS ARE FLASHING:

Switch off the machine for 1 minute and restart it again.



Maintenance and Care:

Daily cleaning and important information:

1. **WATER TANK:** Remove, drain, clean with a soft cloth and rinse with clean water.
2. **DRIP TRAY AND DRAWER:** Remove, clean out the water or coffee residue with a soft cloth and rinse.
3. **EXTERIOR.** Wipe the outer surface with a soft cloth regularly. Keep the appliance clean, especially the switches and plug, to ensure safety.

NOTE: NO PARTS OF YOUR ESPRESSO CAPSULE MACHINE SHOULD BE TO BE WASHED IN A DISHWASHER OR SIMILAR HOME APPLIANCES.

WARRANTY & SERVICE

This Limited Warranty is for one full year from the date of purchase. It is applicable to the original purchaser only and is not transferable to a third party user. Repair or replacement of defective parts is solely at the seller's discretion. In the event that repair isn't possible, the seller will replace the product/part. If product repair/replacement won't suffice, the seller has the option of refunding the cash value of the product or component returned.

Product defects not covered under the Warranty provisions include normal wear and damage incurred from use or accidental negligence, misuse of instruction specifications or repair by unauthorized parties. The manufacturing company is not liable for any incidental or consequential damages incurred by such circumstances.

**FOR CUSTOMER SERVICE
QUESTIONS OR COMMENTS
VISIT US @ GOURMIA.COM
OR CALL 888.552.0033**

