

VEVOR[®]

TOUGH TOOLS, HALF PRICE

Technical Support and E-Warranty Certificate

www.vevor.com/support

ULTRASONIC CLEANERS

USER MANUAL

MODEL NO.: KZ-F2,KZ-F3,KZ-F6,KZ-F10,KZ-F15

We continue to be committed to provide you tools with competitive price.

"Save Half", "Half Price" or any other similar expressions used by us only represents an estimate of savings you might benefit from buying certain tools with us compared to the major top brands and does not necessarily mean to cover all categories of tools offered by us. You are kindly reminded to verify carefully when you are placing an order with us if you are actually Saving Half in comparison with the top major brands.

VEVOR®

TOUGH TOOLS, HALF PRICE

Ultrasonic Cleaners

MODEL NO.: KZ-F2,KZ-F3,KZ-F6,KZ-F10,KZ-F15



NEED HELP? CONTACT US!

Have product questions? Need technical support? Please feel free to contact us:

Technical Support and E-Warranty Certificate
www.vevor.com/support

This is the original instruction, please read all manual instructions carefully before operating. VEVOR reserves a clear interpretation of our user manual. The appearance of the product shall be subject to the product you received. Please forgive us that we won't inform you again if there are any technology or software updates on our product.



WARNING:

Please read this manual carefully before using the product. Failure to do so may result in serious injury. SAVE THIS MANUAL

SAFETY PRECAUTIONS

When using electrical appliances, basic safety precautions should always be followed including the following:

Read all instructions carefully.

Keep it away from children!

This appliance can be used by children aged 8 years and above and persons with reduced physical, sensory or mental capabilities or lack of experience and knowledge if they have been given supervision or instruction concerning use of the appliance in a safe way and understand the hazards involved. Children shall not play with the appliance. Cleaning and user maintenance shall not be made by children without supervision.

To avoid electrical shock:

- 1) **DO NOT** run the cleaner continuously for more than one hour at a time, as doing so can damage the internal components.
- 2) **DO NOT** operate the unit without fluid in the tank. Always ensure the fluid is no higher than the max mark, always ensure there is a minimum depth of 7cm.
- 3) **DO NOT** drop any item into the tank as this may cause damage to the transducer. Always place the items gently into the tank and use the basket whenever possible.
- 4) The more items that you place in your cleaning bath the less efficient it will clean. It is not advised to overlap items. Always allow plenty of clear space between the items.
- 5) Do keep the lid on during use. This will prevent splashes and reduce evaporation of the fluid.
- 6) Never immerse the machine or power cord in water or other liquid.
- 7) **DO NOT** touch the power plug with wet hands, especially when inserting or removing the plug.
- 8) **DO NOT** touch the unit if the machine has fallen into water during

operation. Remove the power plug from the socket first.

9) **DO NOT** disassemble the machine, except by professionals.

10) **UNPLUG** the power source while filling or emptying the tank.

11) **DO NOT** spray water or liquid over the device and the control panel.

12) **DO NOT** operate the cleaner without proper grounding.

13) **DO NOT** place the device on a soft surface, where the vents could be blocked.

14) Upon completion of the cleaning cycle, turn the heater knob off and isolate the machine from the power source.

15) Take care when adding or removing items from the cleaning tank as the fluid is likely to be hot and displaced fluid can damage the internal components. Any displaced fluid must be dried up immediately.

16) In the event of a malfunction/emergency, disconnect the power supply by removing the power plug from the electrical outlet.

17) When heating is required, the water level should not be less than 2/3 full

18) If the supply cord is damaged, it must be replaced by a special cord or assembly available from the manufacturer or its service agent.

19) The connector must be removed before the appliance is cleaned and that the appliance inlet must be dried before the appliance is used again.

20) This device complies with Part 15 of the FCC Rules. Operation is subject to the following two conditions: (1) This device may not cause harmful interference, and (2) this device must accept any interference received, including interference that may cause undesired operation.

SAVE THESE INSTRUCTIONS

USE PRECAUTIONS

TO PREVENT SERIOUS INJURY AND DEATH FROM TIPPING:

1. **DO NOT SIT OR STAND ON THIS ITEM.**
2. When the machine is used several times continuously, in order to avoid the damage and failure of the parts caused by overheating, the machine will enter into a system of self-protection, it can be resumed after about 5 minutes.
3. Do not get water directly from the tap- Flooding of the device and power switches will lead to malfunction.
4. Do not add anti-toxic , sterilizing or acidic solvents into the cleaning water.
 - May cause deterioration of resin and damage of stainless steel.
5. Do not clean pearls and other low surface hardness articles (Morse hardness of less than 8).
 - Can cause damage discoloration or loss of luster.
6. Do not wash rings , necklaces with gems and diamonds for long periods of time.
 - May cause gems / diamonds to fall off
7. DO NOT use the same socket as TV , radio and computer.
 - Can affect the picture clarity or cause noise.
8. Prevent the device from falling and a violent shaking- This can cause breakage deformation, and malfunction.

TECHNICAL SPECIFICATIONS

Model	KZ-F15	KZ-F10	KZ-F6	KZ-F3	KZ-F2
Product Dimensions (L*W*H) (mm)	355*325*275	330*270*275	325*175*275	265*165*225	175*165*190
Packing Size (L*W*H) (mm)	425*380*325	400*300*325	395*225*325	310*210*280	223*207*260
Net Weight (kg)	8.6	6.8	5.2	3.4	2.3
Gross Weight (kg)	9.5	7.5	5.8	3.8	2.6
Capacity (L)	15	10	6	3	2
Ultrasonic Frequency (KHz)	40				
Ultrasonic power (W)	360	240	180	120	60
Heating power (W)	600	600	500	300	200
Set time (min)	0-30				
Set temperature (°C)	0-80				

*Products such as specifications, appearance, and design are subject to modification without prior notice.

PACKAGE CONTENTS



Small cleaning basket

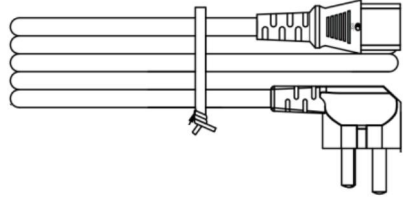

Power cord
(The plug is for reference only,
subject to the material object.)

PRODUCT FUNCTIONS

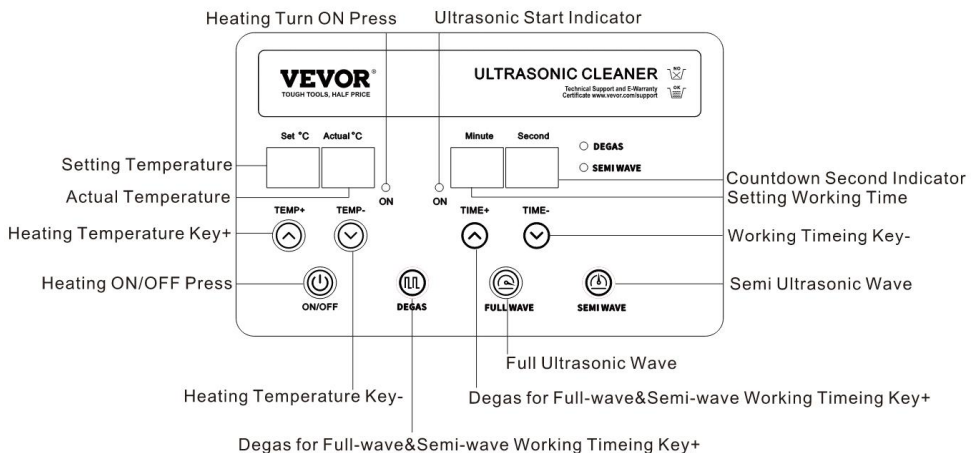

Features:

- Ultrasonic frequency of 40 kHz
- Digital display of temperature and time. Adjustable temperature from 0-80°C.
- Cleaning time with individually adjustable from 0-30min.

- All devices have an useful basket for cleaning parts.
- 6 liter and above size with 1/2" drainage.
- Material tank and casing: Stainless steel.

ITEMS TYPE

Items can be cleaned	
Type	Specific Items
Glasses	Spectacles (without UV film) tortoise shell frame
Office supplies	Ruler , scissors , pen seal etc
Daily supplies	Toothbrush . razor blade comb etc
Jewelry	Rings , necklaces , earrings , etc
Tableware	Metal tableware.ceramic tableware dentures . etc

Items not suitable for ultrasonic cleaning	
Type	Specific Items
Wooden articles	Turtle shell frame , pearl , birthstone opal , emerald , coral , ivory ,emerald, stone , Lacquer ware.
Gems with softer surfaces	
Coating and finishing inferior products	
Bonded gemstones	
Items with scratches and cracks	

It may not be possible to completely remove the remaining denture stone, dental wax , wax yellow black spots and smoking dental wax etc.

Possible inability to clean fixed sedatives in dentures.

Discoloration and rust of metals and precious metals cannot be

removed.

To clean bonding jewels , diamond necklaces and rings may cause them fall off.

OPERATIONS

1. Open the lid , add the clean water , put what you need to cleanse the tank , ensure the clean water is no higher than the " MAX " mark . Do not operate the unit without water in the tank.
2. Plug the adapter into the socket of the machine.
3. Plug the adapter power into the power socket.
4. Short press the " Time " button to switch to the desired time , then short press the ON / OFF" button to start the work.
5. If you want to pause the cleaning , you can short press the on / OFF button to pause , the countdown on the display is paused . Short press the power button again to continue working.
6. If you want to reselect the time , long press the " ON / OFF " key to return to the standby state , and press the " Time " to select the time.
7. When the cleaning work is finished , please unplug the power ,open the lid , take cleaned items from the tank , then pour out dirty water clean and wipe the tank.

Note : Pour water from the side

DAILY MAINTENANCE

1. Pour water into the tank with the measuring cup , half of tanks standard line . After washing with a soft sponge , rinse with the cleaning water.
2. Be careful not to seep water into the power connection at the bottom of the cleaning tank.

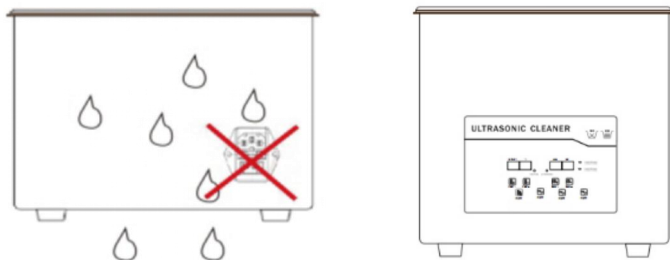

3. After cleaning , please rinse items with clean water once again
Don't seep water into the power connection when cleaning.
4. When the stains are difficult to remove , please wet a clean cloth with water, then wipe them.Be careful not to seep water into the switch and power connection.
5. After wiping , dry the device with a dry cloth.

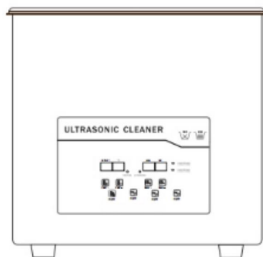

COMPLETION



RECYCLING INFORMATION



Disposal information:

This product is subject to the provision of European Directive 2012/19/EC. The symbol showing a wheelie bin crossed through indicates that the product requires separate refuse collection in the European Union. This applies to the product and all accessories marked with this symbol. Products marked as such may not be discarded with normal domestic waste, but must be taken to a collection point for recycling electrical and electronic devices

Manufacturer: Shanghaimuxinmuyeyouxiangongsi

Address: Shuangchenglu 803nong11hao1602A-1609shi, baoshanqu, shanghai 200000 CN.

Imported to AUS: SIHAO PTY LTD. 1 ROKEVA STREETEASTWOOD NSW 2122 Australia

Imported to USA: Sanven Technology Ltd. Suite 250, 9166 Anaheim Place, Rancho Cucamonga, CA 91730

UK

REP

YH CONSULTING LIMITED. C/O YH Consulting
Limited Office 147, Centurion House, London
Road, Staines-upon-Thames, Surrey, TW18 4AX

EC

REP

E-CrossStu GmbH
Mainzer Landstr.69,
60329 Frankfurt am Main.

VEVOR[®]

TOUGH TOOLS, HALF PRICE

Support and E-Warranty Certificate

www.vevor.com/support