

Mini Camera Drone

M10C

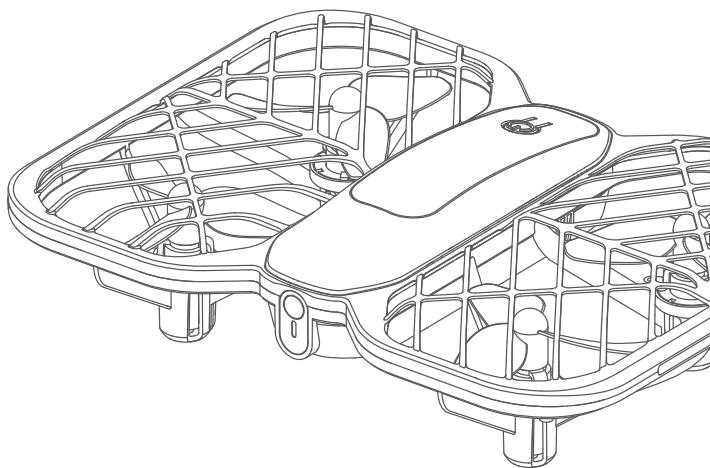

USER MANUAL

Please read this manual carefully before flying and keep it for future use.

V1.03

Model No. DR-UHM11B

- For your safety, please follow the rules and safety guidelines whether you're a beginner or an expert at flying drones.
- According to the relevant laws and regulations in US, all drones must be registered, except those that weigh 0.55 pounds or less (less than 250 grams) and are flown exclusively under the Exception for Recreational Flyers. Please log in to the website of <https://faadronezone-access.faa.gov/#/> to complete the registration. Make sure to observe local laws and regulations about the take-off weight. If the buyer does not register timely, URANHUB will not be responsible for any losses, penalties and injuries caused by illegal flights.
- To meet the electromagnetic requirements of aviation on the radio station, it is forbidden to fly drones within 6.21 miles(10km) on both sides of the runway centerline, or within 12.43 miles(20km) of both ends of the runway. It is also prohibited to fly a drone on the route of an airline. In the area that is prohibited by the relevant authority or department of your country, stop using all flying models and unmanned quadrotors.
- Please download the B4UFLY App from Google Play or App Store, which provides real-time information about airspace restrictions and other flying requirements based on your GPS location.
- Beginning September 16, 2023, all drone pilots who are required to register their UAS must operate in accordance with the rule on Remote ID.

ENGLISH

Thank you for choosing our product and putting your trust in us.
Contact us if you have questions or concerns about the product.

 support@uranhub.com

We hope our products will make flying a whole new experience for you!

Please read the manual carefully for the best use of this product.

Responsible Party

Company Name: Maunaloa Tech Inc.

Address: 501 Silverside Road #515

Telephone: 301 477 1900

Email: Maunaloa2024@gmail.com

CONTENTS

FLIGHT SAFELY	01
BATTERY SAFETY	02
IN THE BOX	03
PRODUCT OVERVIEW	04
Drone	04
Remote	06
FIRST-TIME USE	07
Flight Preparation	07
Connect the URANHUB Fly App with Your Drone	10
FUNCTION OVERVIEW	11
Flight Control	11
Functions	14
EXPLANATION OF DRONE'S LED INDICATORS	20
SPECIFICATIONS	21
Drone	21
Camera	22
Remote	22

FLIGHT SAFETY

* Please fly the drone indoors or in a windless open area. The maximum flight height is limited to 49 ft (15 m), and the maximum flight distance is limited to 164 ft (50 m). Before your first flight, please read the **User Manual** and **Quick Guide** carefully. For detailed operations, refer to the **Flight Control** section.

1. For the safety of your property, keep the drone within your visual range during flight.
2. The drone is made of materials including metal, fiber, plastic, and electronic components. Avoid prolonged exposure to direct sunlight and keep it away from any heat sources. Excessive heat can cause deformation and damage.
3. The drone consists of various precision electronic and mechanical parts. Therefore, make sure that moisture and water do not enter the drone to prevent mechanical or electronic component failures that could lead to accidents.
4. The performance of the drone and battery can be affected by environmental factors such as air density and temperature. Exercise caution when flying at altitudes above 3281 ft (1000 m) above sea level, as the performance of the battery and drone may be reduced.
5. To avoid interference between the drone and other wireless devices, please turn off other wireless devices while using the drone.
6. Avoid flying in areas where magnetic or radio interference may occur, such as near Wi-Fi hotspots, routers, Bluetooth devices, high-voltage power lines, high-voltage power transmission stations, mobile base stations, or broadcast towers. Flying in areas where interference can disrupt communication between the drone and remote may adversely affect flight direction and positioning accuracy, possibly resulting in loss of control. Interference can also cause errors in the video downlink connection.

7. Be cautious around children. Avoid placing fingers in the rotating propellers.
8. Inside the packaging are small accessories. Do not swallow them. Seek immediate medical help if accidentally ingested.
9. Secure valuable items during indoor flights to prevent accidental damage due to operational errors.

BATTERY SAFETY

- RISK OF EXPLOSION BATTERY IS REPLACED BY AN INCORRECT TYPE
- DISPOSE OF USED BATTERIES ACCORDING TO THE INSTRUCTIONS
- BATTERY MUST BE RECYCLED OR DISPOSED OF PROPERLY
- Under no circumstances should the battery touch any liquids. Avoid using the battery in rainy or wet conditions, as it may catch fire or explode unexpectedly.
- It is not allowed to use batteries that are not provided by the manufacturer. Additionally, it is advisable to use the package-included USB charging cable for charging the batteries.
- Batteries that are swollen, leaking, or damaged are strictly forbidden.
- It is recommended to use the battery between -10°C and 40°C; overheating may lead to a fire or explosion. A battery's performance can be adversely affected by extremely low temperatures.
- Do not insert or puncture the battery with any sharp object.
- Battery liquid is highly corrosive, so stay away if it leaks. If skin or eyes are contacted, rinse immediately with plenty of water and seek medical attention.
- Please keep the battery out of children's reach. Immediately seek medical attention if a child swallows parts.
- After being dropped or impacted, the battery should not be used again.

- Place the battery away from heat sources, such as a car in direct sunlight or on a hot day, a fire or a stove.
- To prevent a battery from entering an over-discharged state, avoid storing it for extended periods of time once it has been fully discharged. If a battery is over-discharged, the battery cell will be damaged and unable to be recharged.

IN THE BOX

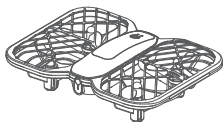

Drone x1



Remote x1



Battery x2

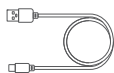

USB Cable for
Charging x1



Spare Propellers
(Ax2 Bx2)



Screwdriver x1



Screws



Removal Tool x1

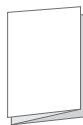

Quick Guide x1

PRODUCT OVERVIEW

Drone

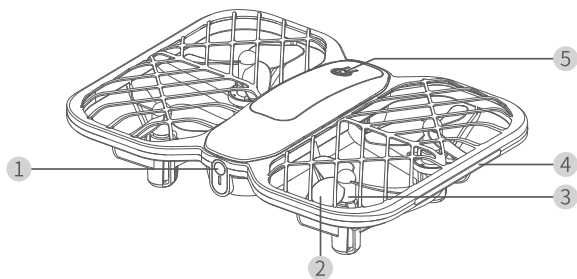

- 1 Camera
- 2 Propeller
- 3 Motor

- 4 LED Light Strip
- 5 Power Button

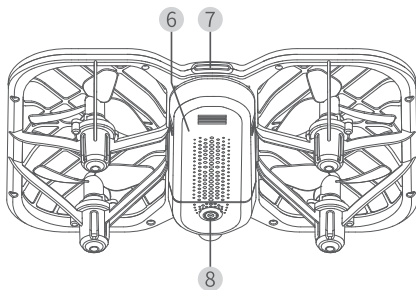

- 6 Battery
- 7 Rear LED Indicator

- 8 Optical Flow Sensor

*How to Replace the Propeller Assembly (Optional)

Please note that there are marks (A/B) on the propellers. When replacing the propellers, make sure to install the A propellers in the original A propellers position and the B propellers in the original B propellers position.

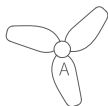
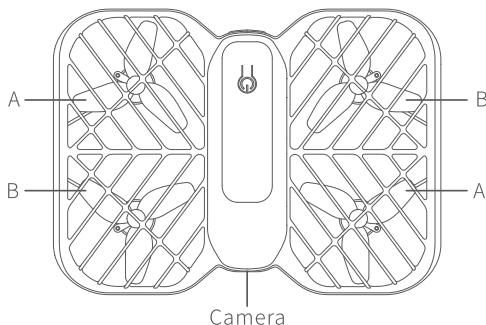

A propeller assembly: Starting with letter A, like A1, A2, etc.

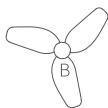

B propeller assembly: Starting with letter B, like B1, B2, etc.

1. Remove the battery from the drone.
2. Unscrew 12 screws on the drone's bottom side using a screwdriver and remove the drone's upper guard.

3. Insert the removal tool into the gap between the propeller and the motor. Gently pry the propeller upward to detach it, and then proceed to replace the propeller.

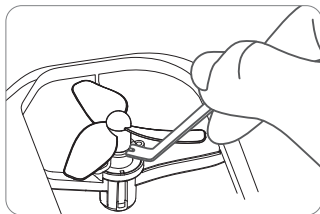

4. Reinstall the upper guard and screws.

Note

When installing the upper guard, pay attention to the positions of the light strips and motor wires to avoid incorrect installation that could lead to malfunctions.

Remote

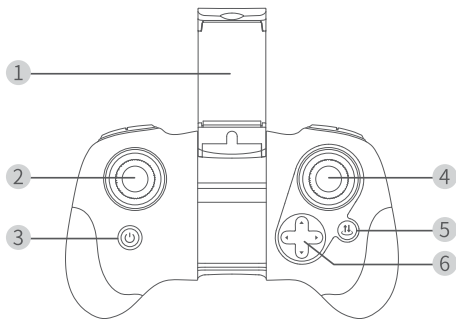

- | | |
|----------------------|--------------------------------|
| ① Phone Holder | ④ Right Control Stick |
| ② Left Control Stick | ⑤ One Key Take-off and Landing |
| ③ Power Button | ⑥ Fine-Tuning Buttons |

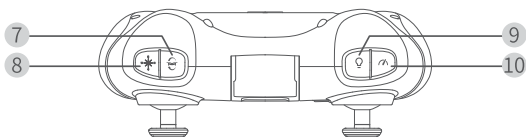

7 3D Flip/Circle Fly

8 Headless Mode

9 Light Mode Switch

10 Speed Switch

FIRST-TIME USE

Flight Preparation

1. Charge the battery with the USB charging cable provided in the box.
The cable can connect to a plug with a maximum output of 5V/2A.

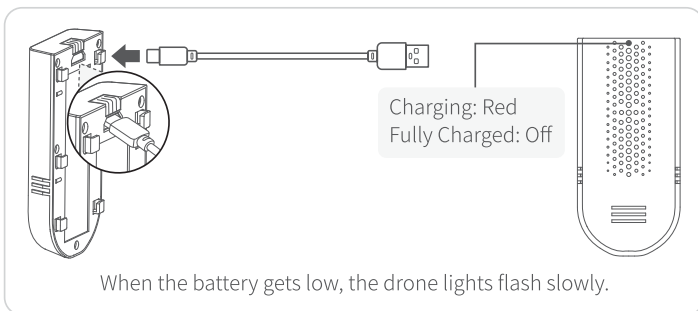

2. Install the battery into the drone after it's fully charged.

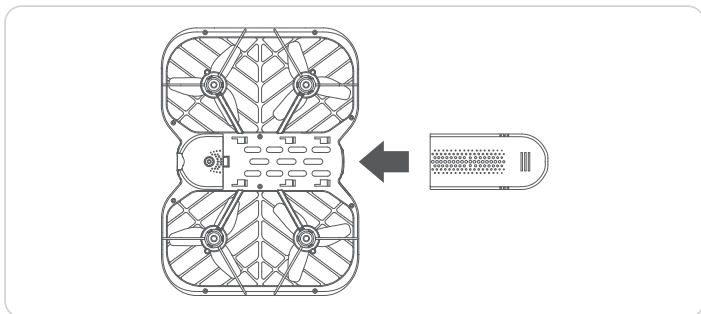

3. Insert 3 AAA batteries (not included) into the remote.

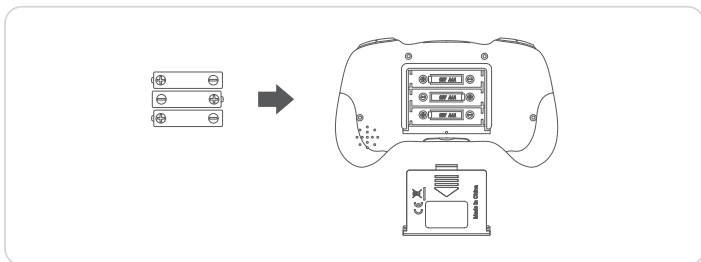

4. Unfold the phone holder to mount your mobile phone.

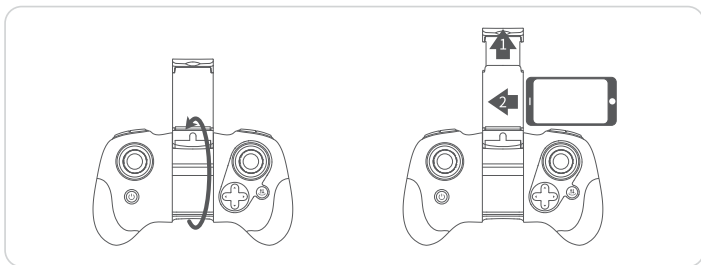

Note

The phone holder can accommodate smartphones with a width ranging from 1.77-3.15 inches (4.5-8cm).

5. Please remove the protective film on the camera before flying.

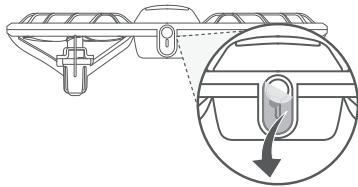

6. Place the drone on a flat and level surface, then press and hold the power button on the drone for 1s to power it on.

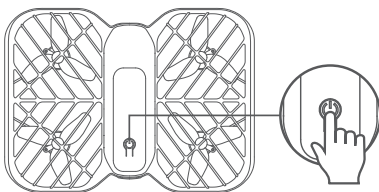

7. Press and hold the power button on the remote for 3s to power it on.
The drone will automatically pair with the remote.

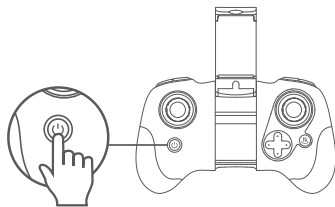

*Successfully Paired: The drone lights transition from flashing green to a colorful breathing mode.

Connect the URANHUB Fly App with Your Drone

Step 1:

Download and install URANHUB Fly from Google Play™/App Store™ or scan the QR codes below.



For Android 8.0 and later



For iOS 8.0 and later

Step 2:

Simply navigate to the WiFi setting of your mobile phone and search for **URANHUB M10C-XXXXXX** WiFi to connect.

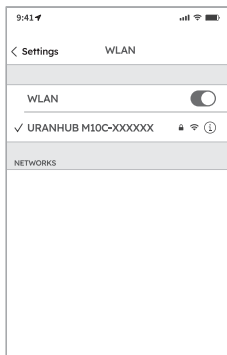

Step 3:

Launch the **URANHUB Fly** app, then tap **Start** to enter the main page to see the live preview.

FUNCTION OVERVIEW

Flight Control

1. Take-off

Option 1:

Unlock the drone by simultaneously pushing the **Left Control Stick** to the lower right at 45° and the **Right Control Stick** to the lower left at 45° (or **Left Control Stick** to the lower left and **Right Control Stick** to the lower right) until the propellers start rotating. Then, push the **Left Control Stick** forward.

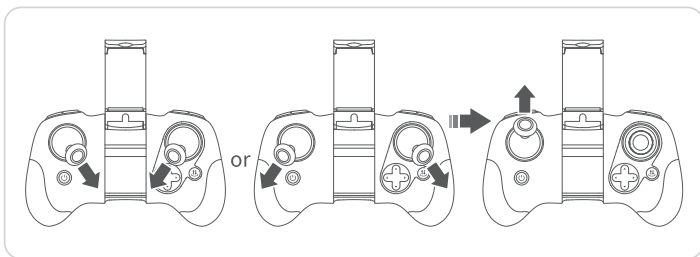

Option 2:

Press and hold the **One Key Take-off** button for 1s.

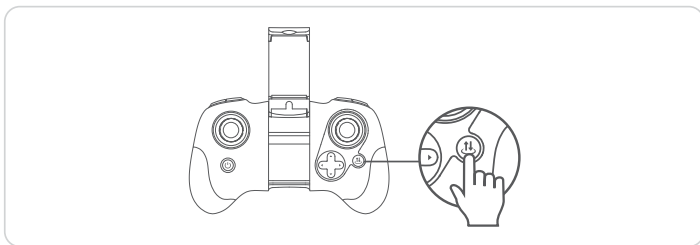

Option 3:

Place the drone in your palm right side up, then toss it into the air at least 10cm high.

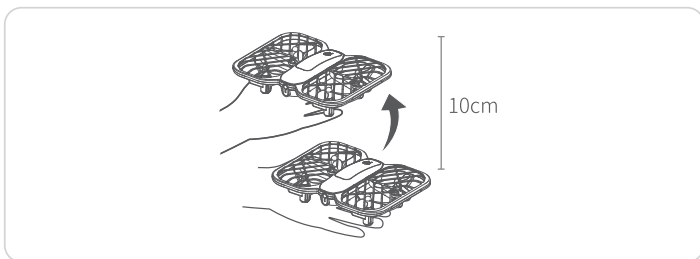

2. Flight Directions

The default remote mode is Mode 1 (used for manual illustration). To switch the remote mode: when the remote is turned off, press and hold the 3D Flip/ Circle Fly button until the remote is turned on.

Mode 1

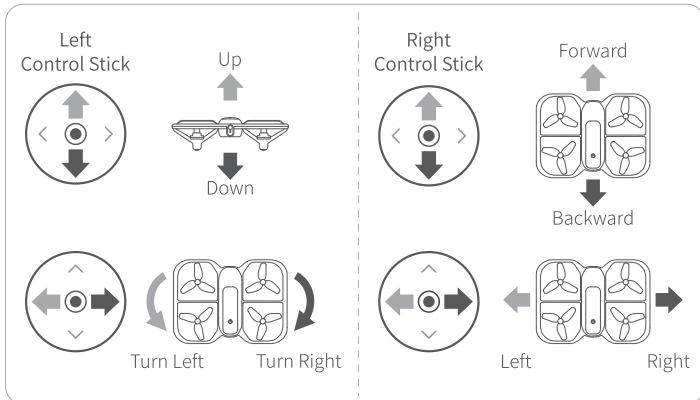

Mode 2

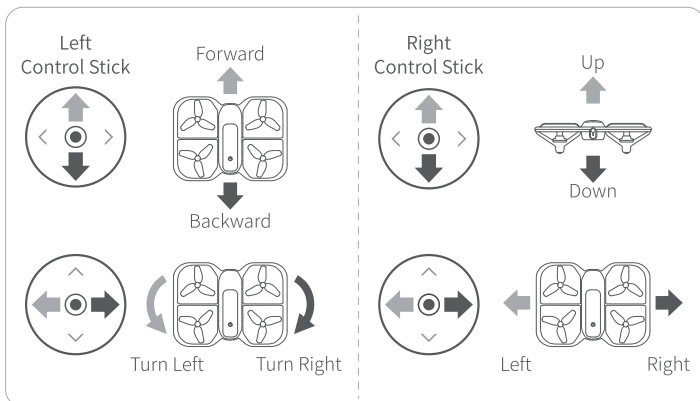

Functions

One Key Take-off and Landing

* Take-off: Place the drone on a flat and level surface without any obstacles then press and hold the (H) button for 1s to make it ascend and hover at a height of 3.9ft (1.2m).

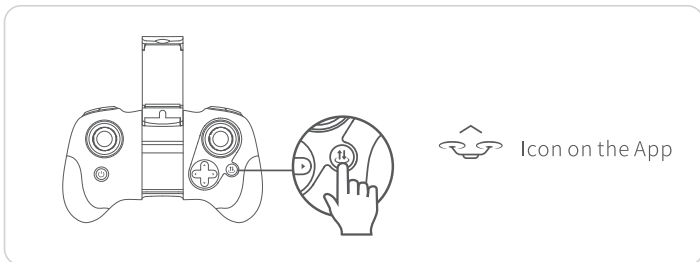

* When the drone hovers in the air without any obstacles, press and hold the (H) button for 1s to make it descend and land until the propellers stop rotating.

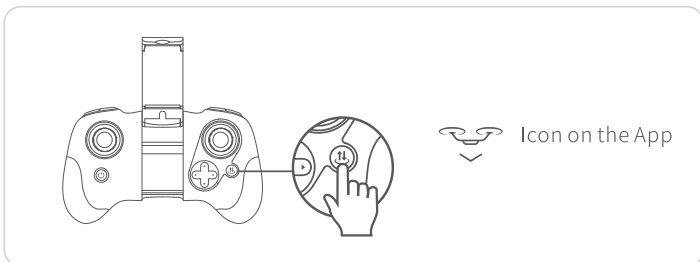

Circle Fly

Ensure there are no obstacles around the drone. Press and hold the  button for 3s on the remote to make the drone fly in a circular pattern.

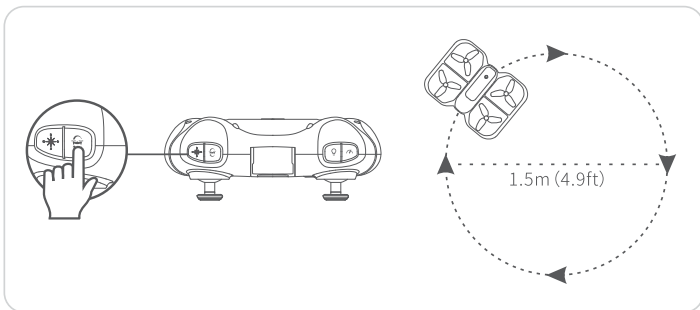

Press and hold the  button for 3s again to disable this function.

3D Flip

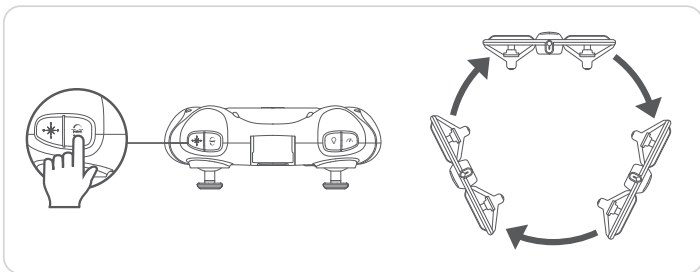

When flying the drone in an obstacle-free area, press the  button to activate the 360° flip function. Once activated, use the **Right Control Stick** to perform flips. Push the stick forward, backward, leftward, or rightward to execute a 360° flip in the corresponding direction.



Note

If no flip operation is executed within 5s after activating this function, the drone will automatically exit standby mode.

Headless Mode

Press and hold the  button on the remote for 3s, or tap the  button on the app to activate this function. The rear indicator flashes slowly. In this mode, the drone will fly following the direction of the **Right Control Stick** regardless of the position of your drone's head or tail.

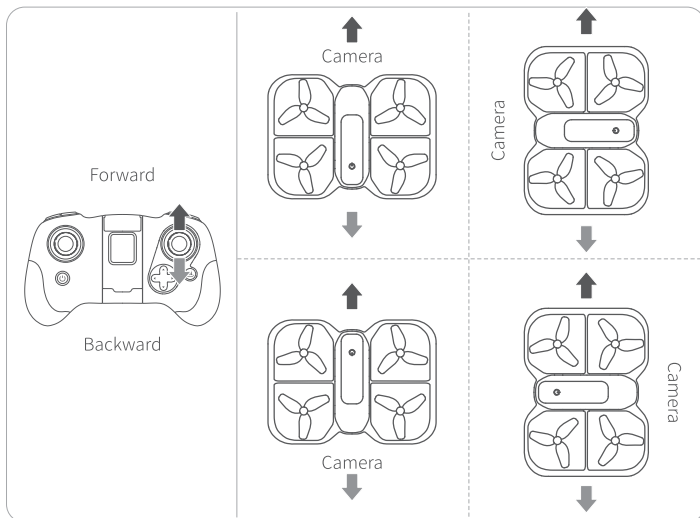



Press and hold the  button for 3s again to disable this function.

Tip:

The drone camera's orientation is its "head" position. In headless mode, the direction is defined by the drone's head orientation at takeoff. Remembering the drone's head orientation during takeoff will help you navigate accurately in headless mode.

Light Mode Switch

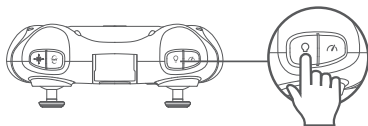

Press the  button to switch between 5 different light modes. To turn off the lights, simply press and hold the  button.

**Speed Switch**

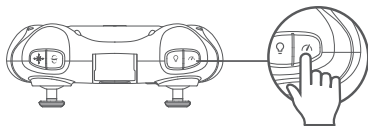
Press the  button to switch between 3 speeds: slow (1 beep), normal (2 beeps), and fast (3 beeps).



Emergency Stop

If an abnormal situation occurs, you can simultaneously press and hold the  button and  button on the remote for 3 seconds to make an emergency stop.

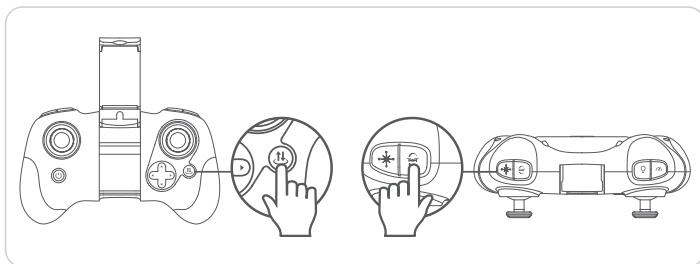

Please make an emergency stop when the drone's flight height is below 9.8ft (3m). If the drone's flight height is above 9.8ft (3m), carefully descend it to a height below 9.8ft (3m) before performing the emergency stop.

Notes

- * When this function is activated, the drone's motor and propellers will stop rotating, causing it to fall from the sky and potentially pose risks of damage. Use this function with caution.
- * After an emergency stop, if you intend to fly the drone again, please check and restart the drone.

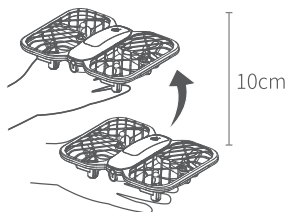

Throw to Go

Place the drone in your palm right side up, then toss it into the air at least 10 cm high. The drone will automatically hover in the air.



Fine-Tuning

To correct a drone that consistently drifts in one direction due to motor wear or prolonged use, you can perform fine-tuning.

During flight, press and hold the  button for 3s to activate fine-tuning mode. Then, press the fine-tuning button opposite to the drone's drifting direction until it stabilizes. Finally, press and hold the  button for 3s to exit fine-tuning mode and save adjustments.

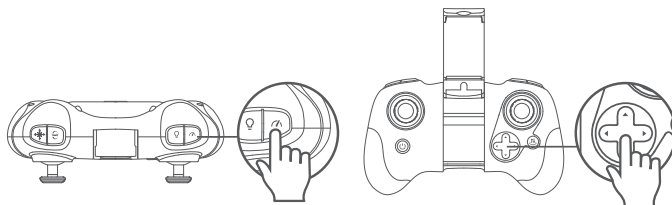

To clear the fine-tuning data, perform a reset.

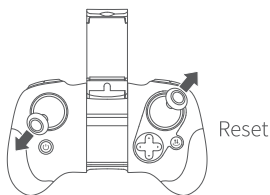

Camera

Take Photos:

Launch the app and tap  to take a photo. The photo will be saved on your mobile phone.

Record Videos:

Launch the app and tap  to start recording a video. Tap the same icon again to stop recording. The video will be saved on your mobile phone.

EXPLANATION OF DRONE'S LED INDICATORS

Powering on	All lights lit
Pairing	Light strips flash green
Reset	Light strips flash green
Low battery	All lights flash slowly
Headless mode	Rear indicator flashes slowly

SPECIFICATIONS

Drone

Model	DR-UHM11B
Weight (with battery installed)	66g
Max.Flight Time	10 minutes
Operating Temperature	32-104°F (0-40°C)
Dimensions	5.7*4.2*1.5 inches (145*107*38mm)
Horizontal Flight Speed (no wind)	Slow: 3.28ft/s (1m/s); Normal: 6.56ft/s (2m/s) Fast: 9.84ft/s (3m/s)
Max. Relative Flight Height	49.2ft (15m)
Max. Flight Distance	164ft (50m)
Battery Capacity	900mAh
Charging Time	≈60 minutes
Input Voltage	5V
Rated Power	≤10W

Camera

FOV	≈70°
Photo Resolution	1280x720 Pixels
Video Resolution	1280x720@20fps
Operating Frequency	2.4GHz-2.4835GHz
Protocol Supported	802.11a/b/g/n

Remote

Operating Frequency	2.4GHz-2.4835GHz
Max.Operating Distance	164ft (50m)
Battery Capacity	AAA batteryx3 (not included)
Battery Life	≈1.5 hours
Applicable Mobile Phone Size	1.77-3.15 inches (45-80mm)
Operating Temperature	32-104°F (0-40°C)

FCC Caution:

Any Changes or modifications not expressly approved by the party responsible for compliance could void the user's authority to operate the equipment.

This device complies with part 15 of the FCC Rules. Operation is subject to the following two conditions:

(1) This device may not cause harmful interference, and (2) this device must accept any interference received, including interference that may cause undesired operation.

Note: This equipment has been tested and found to comply with the limits for a Class B digital device, pursuant to part 15 of the FCC Rules. These limits are designed to provide reasonable protection against harmful interference in a residential installation. This equipment generates, uses and can radiate radio frequency energy and, if not installed and used in accordance with the instructions, may cause harmful interference to radio communications. However, there is no guarantee that interference will not occur in a particular installation. If this equipment does cause harmful interference to radio or television reception, which can be determined by turning the equipment off and on, the user is encouraged to try to correct the interference by one or more of the following measures:

- Reorient or relocate the receiving antenna.
- Increase the separation between the equipment and receiver.
- Connect the equipment into an outlet on a circuit different from that to which the receiver is connected.
- Consult the dealer or an experienced radio/TV technician for help.

For Remote:

This equipment complies with FCC radiation exposure limits set forth for an uncontrolled environment.

For Drone:

This equipment complies with FCC radiation exposure limits set forth for an uncontrolled environment.

This equipment should be installed and operated with minimum distance 20cm between the radiator & your body.

This transmitter must not be co-located or operating in conjunction with any other antenna or transmitter.

URANHUB SUPPORT

 support@uranhub.com



@UranHub_Official