

Manfrotto
Imagine More

INSTRUCTIONS
MVG300XM

Overview

Detachable, multi-functional, professional three axis gimbal with touch screen designed for DSLR and mirror-less cameras.

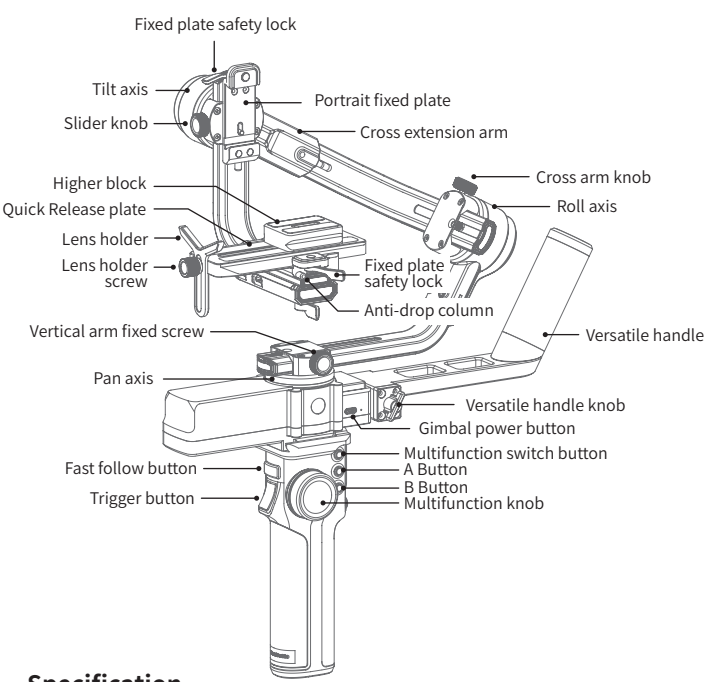
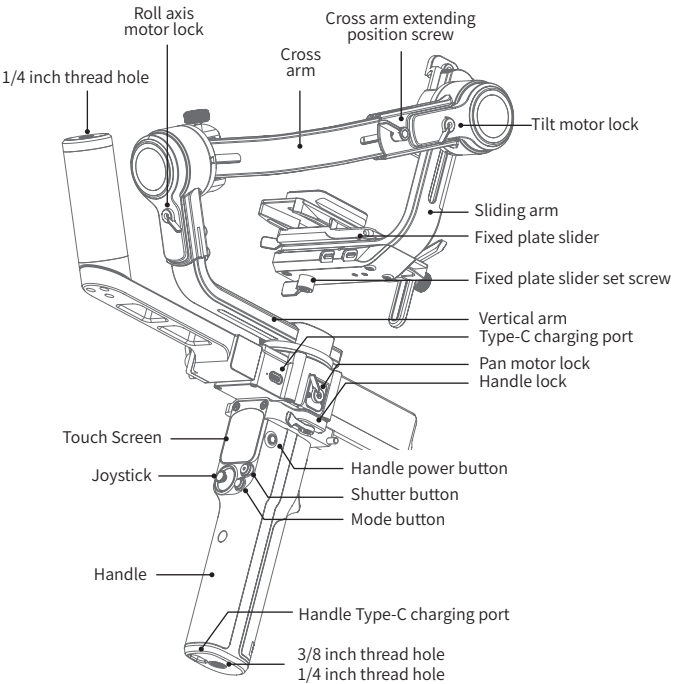

Specification

Max. Tilt Range	340°	Weight	About 2000g
Max. Roll Range	340°	Payload Capability	3400g ^①
Max. Pan Range	360°	Battery Life	10 Hours ^①
Tilt Follow Speed	2°/s ~ 75°/s	Battery	2500mAh
Pan Follow Speed	3°/s ~ 150°/s	Charging Time	>2.6 Hours, support quick charger ≤18W

Compatible Cameras^② Sony, Canon, Nikon ,Panasonic mirror-less camera etc

① In center of gravity balanced state.

② Please download the detailed manual for the specific compatible camera and lens.

Accessories



USB 2.0 to Type-C
×1



Type-C to Micro (A03)
×1



Type-C to TRS2.5 (T02)
×1



Type-C to Mini (B02)
×1



Type-C to Type-C (C02)
×1



Type-C to Multi
Sony shutter cable
×1



Type-C to 2.5mm
Panasonic shutter cable (DC2.5mm)
×1



Tripod
×1



Versatile handle
×1



Quick release plate
×1



Higher block
×1



Short quick release plate (GimBoom)
×1



Lens holder screw
×1



Camera fixed screw
×3



3/8 to 1/4 inch transition screw
×1



Lens holder
×1

User Guide



Please read the manual carefully before using.

TIPS

- (1) Please install the camera before you **power on** the gimbal.
- (2) When the battery is low, please charge the gimbal.
- (3) When not in use for a long time, **power off** the gimbal.

1 Installing the handle

Slide the metal contact part at the bottom of the gimbal part toward the handle and tighten the safety lock of the handle after sliding into the corresponding groove.

When unloading the handle, unlock the safety lock, catch the anti-detachment column, and slowly push out the gimbal.

Install:

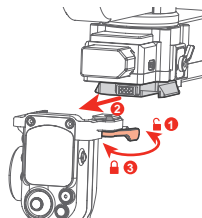

Unload:

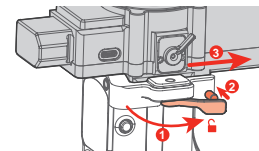

2 Installing the versatile handle

Unlock the versatile handle screw, put the versatile handle into the bottom of the gimbal (follow as the picture), tighten the setting screw.

Lock: clockwise direction

Unlock: anticlockwise direction

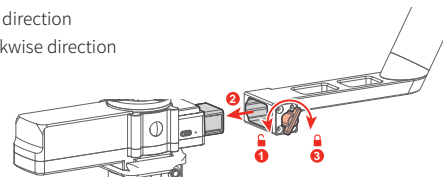

3 Charging

 Be sure to fully charge the gimbal before first use.
If the battery is very low, we suggest you charge it straight away.

Charging with USB2.0 to Type-C supports fast charging.

① ② charging port can be charged simultaneously.

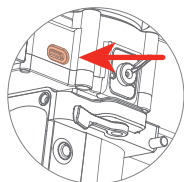

①

Gimbal and handle
charging when connected.
If disconnected, only for
gimbal charging.

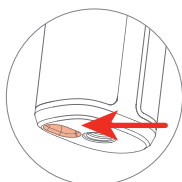

②

Only for
handle charging

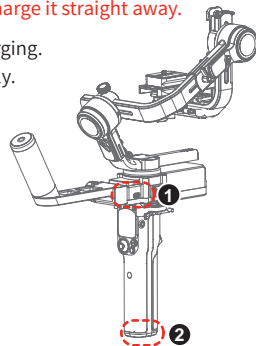

4 Motor lock

Each of the three rotating axes has one positioning lock for convenient positioning and storage purposes.

Be sure to unlock them before using the gimbal.

 Lock

 Unlock

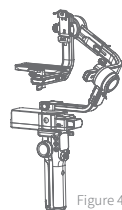
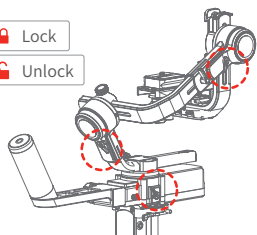

Balanced lock

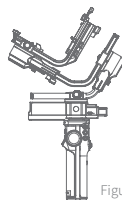

Stored lock

Figure 4-1

Figure 4-2

5 Installing the camera

① Please lock the gimbal at the balanced lock status(as Figure 4-1), install the camera on the quick release plate and unlock the safety lock with the fixed plate safety lock.

② Install the camera onto the quick release plate as close as possible to the sliding arm, adjusting the fixed plate slider.

③ Lock the safety lock.

The position of the sliding block can be adjusted according to the size of the camera, and the higher block selected.

You can refer to the above steps to mount the portrait fixing plate according to needs.

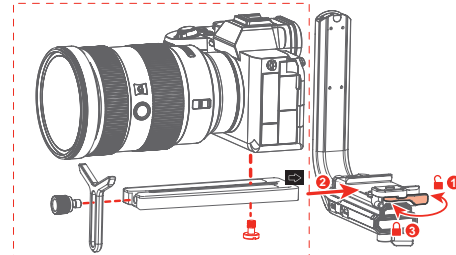

 Be sure the battery and memory card are already installed before installing the camera.

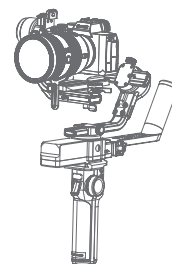

Gimbal configuration

6 Gimbal balancing

 Before balancing the gimbal, please lock the gimbal at the balanced lock status, then unlock each axis position lock by stages.

TIPS

(1) The lens cover should be removed from the camera and the memory card needs to be inserted into the camera to complete all the connections. This ensures the camera is ready for shooting.

(2) During balancing the gimbal, make sure the camera and gimbal are all power off.

(3) If you need to add accessories after the balance is completed, gimbal needs to be re-balanced again.

(4) Balanced standard: the camera will remain stable at any angle.

Take the balancing adjustment of horizontal as an example.

6.1 Balancing the tilt axis

6.1.1 Adjusting sliding arm

- ① Unlock the tilt axis, turn the camera lens upwards.
- ② Unscrew the sliding arm screw.
- ③ Slide vertical arm to balance it until the camera stays there at any angle, balance successful.
- ④ Tighten the sliding arm screw.

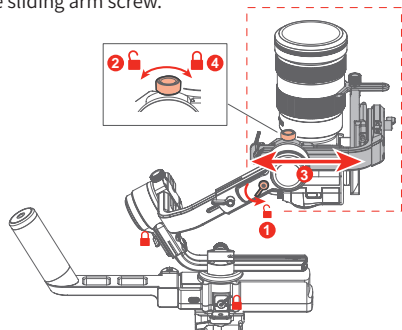

6.1.2 Adjusting the quick release plate

- ① Push the camera lens forward, unlock the quick release plate safety lock.
- ② Move the quick release plate to the camera balancing position.
- ③ Lock the quick release plate with fixed plate safety lock.

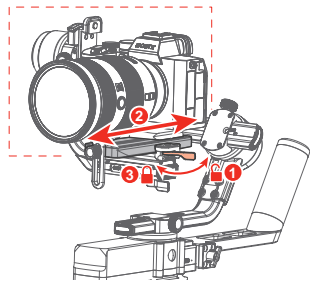

6.2 Balancing roll axis

- ① Unlock Roll axis motor lock.
- ② Unscrew the cross arm screw.
- ③ Move the cross arm to balancing status.
- ④ Tighten cross arm screw.

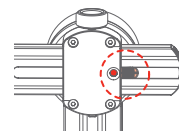
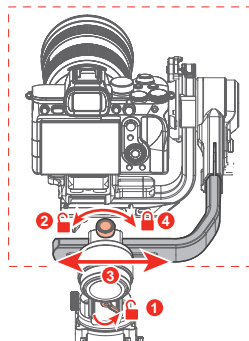

Use the memory red dot to mark the balancing position

6.3 Balancing pan axis

- ① Unlock pan axis motor lock
- ② Hold the handle and slant it(>15°), put the vertical arm horizontally, unscrew the vertical arm screw
- ③ Move the vertical arm to balancing status
- ④ Tighten vertical arm screw.

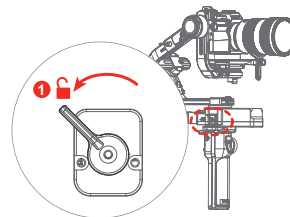

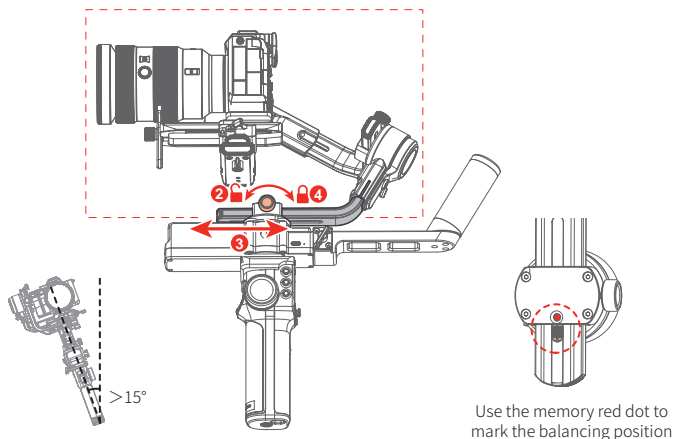

7 Power ON/ OFF

⚠ Be sure to unlock the position lock before using the gimbal.

Long press the power button and release it when you hear the beep sound.

When combined, any power button can be powered on the gimbal. When separate, please power on each part.

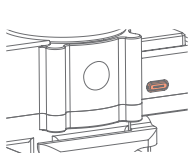

Gimbal Power Button

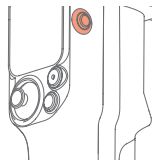

Handle Power Button

8 Locking the touch screen and standby mode

Lock the touch Screen: Single tap any power button to lock the touch screen.

Unlock the touch Screen: Single tap any power button again to unlock it.

Standby mode: Double tap any power button for standby mode.

Wake up mode: In the standby mode, single tap any power button or tap the icon  on the touch screen to wake up the gimbal.

9 Remote control

The handle is a remote control. Powering on the gimbal when it's combined with the handle automatically generates matching information. When used separately next time, the handle can remotely control the gimbal directly.

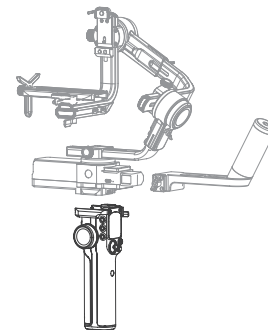

10 Download the APP



Download the Manfrotto gimbal MVG300XM App.



11 Connecting APP

- (1) Turn on the smartphone Bluetooth, power on the gimbal.
- (2) Turn on the gimbal application and follow the prompts to connect to MVG 300XM.



User's manual

Please download the detailed user manual from the [Manfrotto.com](https://www.manfrotto.com) website.

Disclaimer

Thanks for using Manfrotto gimbal. The information in this document affects your safety and your legal rights and responsibilities. Read the entire document carefully to ensure proper configuration before use. Failure to read and follow instructions and warnings in this document may result in serious injury to yourself or others, or damage to your products or damage to other objects in the vicinity. By using this product, you hereby signify that you have read this disclaimer and warning carefully and that you understand and agree to abide by the terms and conditions herein. You agree that you are solely responsible for your own conduct while using this product, and for any consequences thereof. You agree to use this product only for purposes that are proper and in accordance with all applicable laws, rules, and regulations, and all terms, precautions, practices, policies and guideline Manfrotto has made and may make available. Manfrotto accepts no liability for damage, injury or any legal responsibility incurred directly or indirectly from the use of product. Manfrotto will not provide any service for any product obtained from abnormal channels.

Notice

1. Make sure motor spinning is not blocked by external force when gimbal is power on.
2. Gimbal DO NOT contact water or other liquid if the gimbal is not mark waterproof or splash-proof. Waterproof and splash-proof product DO NOT contact sea water or other corrosive liquid.
3. DO NOT disassembly the gimbal except is detachable available. It need send to Manfrotto after-sales or authorized service center to fix it if you accidentally disassembly and cause abnormal work. The relevant costs are borne by user.
4. Prolonged continuous operation may cause the motor surface temperature to rise, please operate carefully.

Storage and Maintenance

1. Keep the gimbal and battery out of the reach of children and pets.
2. DO NOT leave the gimbal and battery near heat sources such as a furnace or heater. DO NOT leave the gimbal and battery inside of a vehicle on hot days.

3. Please storage the battery in dry environment.
4. DO NOT overcharge or overuse the battery, otherwise it will cause damage to the battery core.
5. Never use the gimbal and battery when the temperature is too high or too low.
6. Please take out batteries from gimbal if long time without using gimbal.

Battery Safety Guidelines

1. To avoid fire, serious injury, and property damage, observe the following safety guidelines when using, charging or storing the battery.
 - (1) DO NOT allow the battery to come into contact with any kind of liquid. DO NOT leave the battery out in the rain or near a source of moisture. DO NOT drop the battery into water.
 - (2) If the battery falls into water by accident, put it in a safe and open area immediately. Maintain a safe distance from the battery until it is completely dry. Never use the battery again.
 - (3) If batteries catch fire, use water, water mister, sand, fire blanket, dry powder, carbon dioxide fire extinguisher to extinguish the fire immediately. It is prone to explosion after a large fire. Please choose the fire extinguishing method according to above recommended order according to the actual situation.
 - (4) DO NOT use or charge swollen, leaky or damage battery.
 - (5) DO NOT disassemble or pierce the batteries in any way or the battery may leak.
 - (6) DO NOT drop or strike batteries. DO NOT place heavy objects on the battery or charger.
 - (7) DO NOT use the battery if it falls.
 - (8) DO NOT heat batteries.
 - (9) DO NOT use the batteries in strong electrostatic or electromagnetic environments. Otherwise, the battery may occur short circuit.
 - (10) Electrolytes in the battery are highly corrosive. If any electrolytes make contact with your skin or eyes, immediately wash the affected area with fresh running water for at least 15 minutes, and then see a doctor immediately.
 - (11) Please use official batteries are provided by Manfrotto. If you need replace the battery, please purchase at Manfrotto official website or authorized dealer. Manfrotto will not be responsible for the battery accident and devices malfunction cause by batteries use from unofficial provided.
2. DO NOT drop or strike batteries. If the battery is abnormal, contact Manfrotto After-sales support.

DISCLAIMER

The information contained in this document is subject to change without notice.

Vitec Imaging Solutions makes no warranty and shall not be liable for any errors on information contained in this document.

Any changes or modifications not expressly approved by Vitec Imaging Solutions could void the user's authority to operate this equipment.

INFORMATION FOR USERS



In accordance with Article 10 of Directive 2012/19/UE of the 04/07/2012 concerning Waste Electrical and Electronic Equipment (WEEE).

The above symbol, also present on equipment, indicates that, at such time as the user should decide to dispose of the equipment, it must NOT be disposed of as unsorted municipal waste, but must be collected separately. The same applies to all components of the equipment and any recharge or refill elements that the product may comprise.

For information on the waste collection systems suitable for this equipment, contact Vitec Imaging Solutions or any authorised member of the National Registers in EU countries. Household (or similar) waste may be disposed of via standard municipal differentiated waste collection schemes.

If you purchase a new version of this model or similar equipment - or if your existing equipment measures less than 25 cm - you may return the items you no longer require to your retailer who will take care of contacting the company or organization handling the proper collection and management of used equipment.

Correct separate collection and specific treatment of WEEE are necessary to avoid potential damage to human health and the environment, and favour the recycling and recovery of component materials.

Improper or illegal disposal of this product by the user will result in punishments or fines being applied in accordance with national Decrees based on Directive 91/156/EC and 2008/98/EC.

ESCLUSIONE DI RESPONSABILITÀ

Le informazioni riportate in questo documento sono soggette a variazioni senza preavviso.

Vitec Imaging Solutions non rilascia garanzie e non assume responsabilità per eventuali errori nelle informazioni riportate in questo documento.

Qualunque variazione o modifica apportata senza espressa approvazione di Vitec Imaging Solutions può annullare il diritto dell'utente di impiegare questo apparecchio.

INFORMAZIONE AGLI UTENTI



Ai sensi dell'art. 10 della Direttiva 2012/19/UE del 04/07/2012 sui rifiuti da apparecchiature elettriche ed elettroniche (RAEE).

Il simbolo sopra riportato, presente anche sull'apparecchiatura, indica che essa deve essere oggetto di raccolta separata nel momento in cui l'utilizzatore decide di disfarsene (inclusi tutti componenti, i sotto-insiemi e i materiali di consumo che sono parte integrante del prodotto).

Per l'indicazione sui sistemi di raccolta di detti apparecchi vi preghiamo di contattare Vitec Imaging Solutions o altro soggetto iscritto nei vari Registri Nazionali per gli altri Paesi dell'Unione Europea. Il rifiuto originato da nucleo domestico (o di origine analoga) può essere conferito a sistemi di raccolta differenziata dei rifiuti urbani.

All'atto dell'acquisto di una nuova apparecchiatura o, senza obbligo di un acquisto nuovo, per le apparecchiature con dimensioni inferiori ai 25 cm, è possibile riconsegnare al rivenditore il vecchio apparecchio. Il rivenditore si farà poi carico di contattare il soggetto responsabile del ritiro dell'apparecchiatura.

L'adeguata raccolta separata dell'apparecchio smesso e l'avvio alle successive operazioni di trattamento, recupero e smaltimento ambientalmente compatibile, consente di evitare potenziali effetti negativi sull'ambiente e sulla salute umana, e favorisce il riciclaggio ed il recupero dei materiali componenti.

Lo smaltimento abusivo del prodotto da parte dell'utente comporta l'applicazione delle sanzioni previste dai recepimenti nazionali delle Direttive 91/156/CE e 2008/98/CE.