

## Quick Start Guide

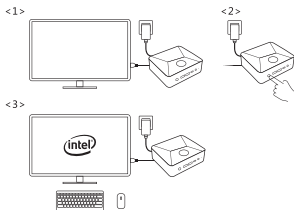

1. Power button	6. Lan port	11. Type C power port
2. USB3.2 port	7. USB2.0 port	12. Security Lock
3. USB3.2 port	8. USB2.0 port	13. SSD Slot
4. Type C port	9. DP port	14. DDR4 Slot
5. Headphone/audio 2 in 1 port	10. HDMI port	



- Connecting power adapter and HDMI.
- Press the button.
- Enter the interface.



1

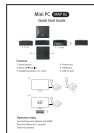

2

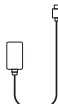

3

- 1: Mini computer
- 2: Quick start guide
- 3: Power Adapter

- Keyboard and Mouse are not included.
- The included power adapter must be used to power the computer , Use of any other power adapter is not supported.
- Specifications are subject to the physical product.

- In order to continue to improve the user experience, we may occasionally update app and firmware.
- Do not use harsh of chemical solvent, cleaning products. We recommend using a soft cloth to wipe.
- Do not throw product into fire, avoid having fire accident.
- Do not attempt to open the housing or to repair, if a failure occurs, please contact the customer service.
- Please note seepage while clean electronics, be careful of electric shock.
- Check for any frayed or damaged cords or plugs.
- Don't arbitrary discard the product, we should protect the environment.
- Work environment: 5°C-35°C, 30%-90% humidity.
- Storage environment: -20°C-60°C, 10%-90% humidity.

1. The guarantee is **valid** for one year. During this period the company may provide you with free repair or **replacement** of parts, if the goods have a manufacturing **problem**.
2. After the warranty period expires, if you are in need of repair products, you can also **contact** our company. We can repair for a fee.
3. We do not repair, if the cause of **failure** is not manufacturing **problem**.
4. If you have any questions, **please** contact us.

## FCC Statement

This equipment has been tested and found to comply with the limits for a Class B digital device, pursuant to part 15 of the FCC Rules. These limits are designed to provide reasonable protection against harmful interference in a residential installation. This equipment generates, uses and can radiate radio frequency energy and, if not installed and used in accordance with the instructions, may cause harmful interference to radio communications. However, there is no guarantee that interference will not occur in a particular installation. If this equipment does cause harmful interference to radio or television reception, which can be determined by turning the equipment off and on, the user is encouraged to try to correct the interference by one or more of the following measures:

- Reorient or relocate the receiving antenna.
- Increase the separation between the equipment and receiver.
- Connect the equipment into an outlet on a circuit different from that to which the receiver is connected.
- Consult the dealer or an experienced radio/TV technician for help.

Caution: Any changes or modifications to this device not explicitly approved by manufacturer could void your authority to operate this equipment. This device complies with part 15 of the FCC Rules. Operation is subject to the following two conditions: (1) This device may not cause harmful interference, and (2) this device must accept any interference received, including interference that may cause undesired operation.

### RF Exposure Information

This equipment complies with FCC radiation exposure limits set forth for an uncontrolled environment. This equipment should be installed and operated with minimum distance 20cm between the radiator and your body.

# Mini PC MAP 02

## 快速入门指南

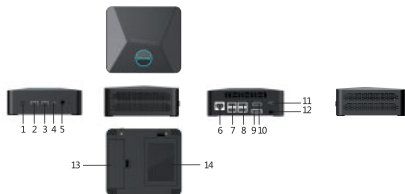

### 功能

1. 电源按钮
2. USB3.2端口
3. USB3.2端口
4. Type C端口
5. 耳机/音频二合一端口

6. 网络端口
7. USB2.0 端口
8. USB2.0 端口
9. DP 端口
10. HDMI 端口

11. Type C 电源端口
12. 安全锁
13. SSD插槽
14. DDR4插槽

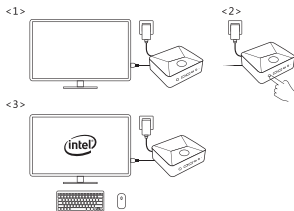

### 操作步骤

- 连接电源适配器和HDMI
- 按下开机电源键
- 进入操作界面



1

### 产品及配件

- 1: 迷你电脑
- 2: 快速入门指南
- 3: 电源适配器

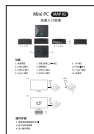

2

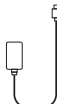

3

### 注意：

- 不含键盘和鼠标。
- 必须使用附带的电源适配器为计算机供电。不支持使用任何其他电源适配器。
- 产品规格以实物为准。

### 使用注意事项

- 为了继续改善用户体验，我们可能偶尔会更新应用和固件。
- 请勿使用有腐蚀性的化学溶剂清洁产品，建议使用软布擦拭。
- 不要将产品投入火中，避免发生火灾。
- 不要试图打开外壳或进行维修，如果发生故障，请联系客服。
- 清洁电子设备时请注意防水，小心触电。
- 检查电线或插头是否有任何磨损或损坏。
- 注意保护环境，当产品不用时不要随意丢弃。
- 工作环境：5°C-35°C，湿度30%-90%。
- 储存环境：-20°C-60°C，湿度10%-90%。

### 保修条款

1. 产品保修期为一年，在保修期内如产品发生故障，属原器件品质不良或制作问题，本公司提供免费维修及部件更换。
2. 保修期满后，用户仍可得到本公司提供维修服务，但要支付相应费用。
3. 一切人为或意外造成的产品损坏不在保修范围内。
4. 如果您有任何疑问，请联系我们。