

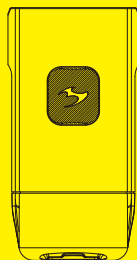

LEPUS LEPUS LITE MANUAL



Read this manual carefully before using and keep for future reference.
Visit www.moon-sport.com for manual updates, The specifications and design are subject to change without notice.

CONTENTS



LEPUS / LEPUS LITE



RB-43
(HANDLEBAR BRACKET)



RB-42
(MOON LIGHT ADAPTER
FOR GOPRO MOUNT)

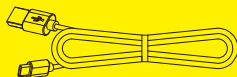

USB-C
(USB CABLE)

Optional accessories:

USB-C-RM2020 (REMOTE CONTROL)
RB-36 (HANDLEBAR CENTRE MOUNT)
RB-41 (HELMET MOUNT)
M-01 (HANDLEBAR COMBO MOUNT XL)
M-03 (STEM CAP MOUNT)
M-06 (AMPLITUDE RACE MOUNT)
PDF 7 (HANDLEBAR MOUNT)

OPERATION



ON / OFF : Press & hold  1s

MODE SELECT : Click 

BATTERY CHECK : 1. Power off

2. Click 

> 11% BLUE  3s

≤ 10% BLUE  3s

* Mode memory: The light resumes previous mode upon next usage.

RUNTIME

LEPUS

ANSI FL1	MODE1	MODE2	MODE3	FLASH1	FLASH2	DAY FLASH
 LUMEN	600	300	100	50	50	600
 H:MIN	2:00	4:00	13:00	120:00	55:00	40:00

LEPUS LITE

ANSI FL1	MODE1	MODE2	MODE3	FLASH1	FLASH2	DAY FLASH
 LUMEN	400	200	100	50	50	400
 H:MIN	2:00	4:10	8:30	76:00	39:00	40:00

HANDLEBAR MOUNTING

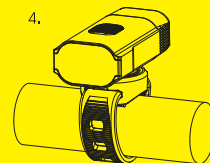
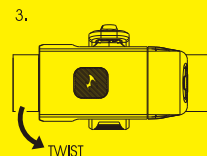
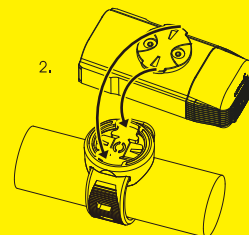
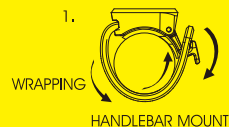

CHARGING

1. Power off.
2. Plug USB cable to USB port.
3. Unplug after fully charged.



- * Do not charge over 5V.
- * Keep away from flammable objects while charging.

BATTERY STATUS AND CHARGING INDICATOR

Low battery
(Slow Flash) ≤10%  BLUE

Charging
(Double Flash)  BLUE

Fully Charged
* 3:00hrs  BLUE

OVERHEAT PROTECTION

The overheat protection device can ensure the bicycle light in a good running temperature condition, so that to protect the LEDs without burning case. If the light is in high temperature during operation, it will dim the light output.

WARNING

Before use, check local lighting laws and regulations.

Avoid shining the light directly into anyone's eyes.

Do not install near wireless cycling computers.

Prevent blinding oncoming traffic — always angle the beam downward.

Keep the light away from water; do not submerge it.

Store in a cool, dry place.

If stored long-term, recharge the light fully at least every 3 months.

WARRANTY

MOON Lights come with a **2-YEAR LIMITED WARRANTY**, and MOON batteries are covered for **180 days**, with both warranties effective from the date of purchase. This warranty covers any defects or malfunctions resulting from manufacturing or design issues.

The warranty does not apply to normal wear and tear, damage from using non-rechargeable batteries, or any problems caused by improper installation, misuse, accidents, negligence, or other mishandling. To request warranty service, customers should contact their authorized local MOON dealer, as we may need the product returned for evaluation.

For additional assistance, please email our customer service team at **cs@moon-sport.com**. Don't forget to register your warranty online at **www.moon-sport.com** to ensure full coverage.