

# ORGSTA

## Q2 Instant Print Camera

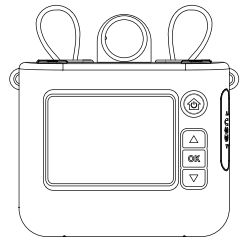

## User Manual



Thank you for choosing our product. Please read this manual carefully before use.

Recommended Age: Children above 3 years old  
Children under 6 years old must use this product under adult supervision.

### 1. Package Contents

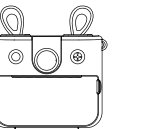

Instant Print Camera

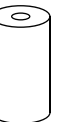

Thermal Printing Paper



Type-C USB Cable



User Manual



Note

All images in this manual are for reference only and may not reflect the actual product due to updates.

### 2. Component Guide

#### A. Front

- Decorative Ears
- Print Button
- Lanyard Hole
- Display Screen
- Camera (rotatable 180° for selfies)
- Shutter Button
- Power/Home Button (Press & hold 3s: Power On/Off)
- Up Button
- OK Button
- Down Button

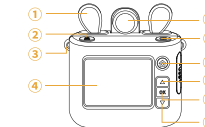

#### B. Rear

- Fill Light
- Paper Exit Slot
- Cover Release Slot
- Speaker Holes
- Camera (rotatable 180°)
- Paper Compartment

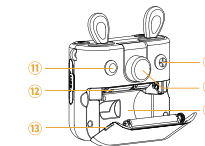

#### C. Side

- MicroSD Card Slot
- USB-C Charging Port
- Reset Hole

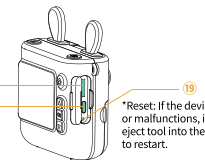

\*Reset: If the device freezes or malfunctions, insert a SIM eject tool into the reset hole to restart.

### 3. Inserting the Memory Card

Due to limited internal storage, insert a MicroSD card to record videos, photos, and MP3 files.

#### Steps to insert MicroSD card:

- Open the rubber cover to access the card slot.
- Insert card with metal contacts facing up. Push until it clicks. Cards insert only one way. Do not force if misaligned.
- Close the rubber cover.
- To eject: Gently push the card to release it.

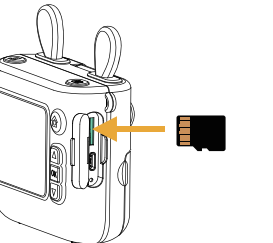

### 4. Loading Thermal Paper

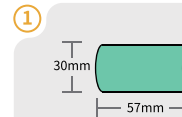

**Paper Specifications:**  
Use thermal paper with width  $\leq 57\text{mm}$  and diameter  $\leq 30\text{mm}$ .

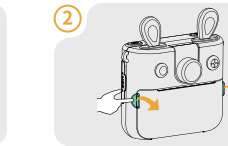

Press the cover release slot and slide open as indicated.

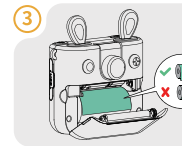

Place paper with printable side facing up.

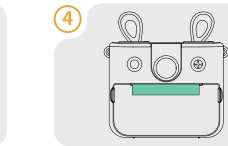

Pull paper through exit slot  $> 1\text{cm}$ , then close cover.



Note

If printing is blank, ensure printable side faces up.

### 5. Printing Functions

#### 1. Instant Print Mode:

In Camera mode, press Print Button (Print icon) until "printer icon" (Printer icon) appears. Photos print immediately after capture.

#### 2. Gallery Print Mode:

In Gallery mode, select a photo and press Print Button (Print icon) to print. Exit Print Mode: Press Print Button (Print icon) again to remove the printer icon.

### 6. Menu & Controls

#### A. Power On/Off:

Press & hold Power Button to turn on/off. Home screen appears when powered on.

#### B. Menu Navigation:

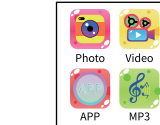

Press / to browse menus, OK to confirm, Power/Home to return.

#### C. Photo/Selfie:

- In Camera mode, rotate lens 180° for selfies.
- Press Shutter or OK to capture.
- Press / to toggle flash/timer/burst/stickers/frames/filters.
- Press & hold / to adjust focus.
- Press Power/Home to go back.

#### D. Video Recording:

- In Video mode, press Shutter or OK to start recording.
- Rotate lens 180° for selfie videos.
- Press Shutter or OK again to stop. Videos save to Gallery.

#### E. Gallery:

- In Gallery mode, Press / to browse photos/videos.
- Press OK to play/pause videos.
- Press Print Button to print photos.
- Press Shutter to delete: Select "Confirm/Cancel" with / , press OK to execute.

\*Video Format: AVI; Photo Format: JPG

#### F. APP Connection:

- In APP mode, download "Snap&Tag" as instructed.
- Keep device on this screen during pairing.



### G. MP3

1. In MP3 mode, Press ▲ / ▼ to skip tracks.
  2. Press OK  to play/pause.
  3. Press & hold ▲ / ▼ to adjust volume.
- \*Add Music: Copy MP3 files to the "MP3" folder on SD card.

### H. Settings:

1. In Settings mode, Configure print mode/density/language/date stamp/auto-off/volume/format/reset.
2. Press ▲ / ▼ to navigate, OK to select options.

## 7. Connect to Computer

1. Insert MicroSD card and power on.
2. Ensure "SD icon" appears on screen.
3. Connect camera to computer via USB cable.
4. Open "Removable Disk (E:)" to access MP3/PHOTO/VIDEO folders.

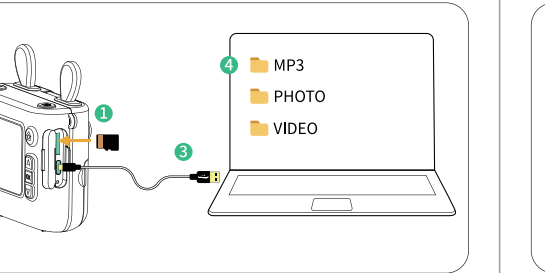

## 8. Charging

1. Charge when battery is low.
2. Inspect cable for damage before use.
3. Battery is non-removable.
4. Do not charge on fabrics (e.g. cotton/linen).
5. Unplug charger after full charge.
6. Adult supervision required during charging.

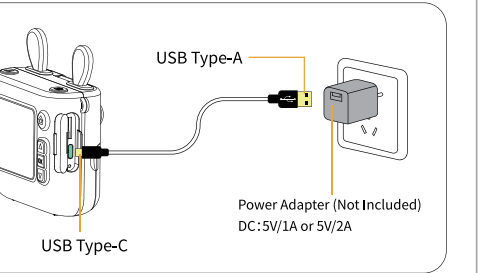

## 9. Warnings

1. For ages 3+.
2. Adult supervision for ages under 6.
3. Do not allow children/pets to chew device.
4. Do not poke eyes/mouth with device.
5. Avoid directing fill light at eyes.
6. Keep away from fire sources.
7. Do not store near heaters/microwaves.
8. Choking hazard: Keep small parts away from children <3.

## 10. FCC Statement

**FCC STATEMENT:** This device complies with Part 15 of the FCC Rules. Operation is subject to the following two conditions:  
This device may not cause harmful interference, and  
This device must accept any interference received, including interference that may cause undesired operation.

**WARNING:** Changes or modifications not expressly approved by the party responsible for compliance could void the user's authority to operate the equipment.

**NOTE:** This equipment has been tested and found to comply with the limits for a Class B digital device, pursuant to Part 15 of the FCC Rules. These limits are designed to provide reasonable protection against harmful interference in a residential installation. This equipment generates uses and can radiate radio frequency energy and, if not installed and used in accordance with the instructions, may cause harmful interference to radio communications. However, there is no guarantee that interference will not occur in a particular installation.

If this equipment does cause harmful interference to radio or television reception, which can be determined by turning the equipment off and on, the user is encouraged to try to correct the interference by one or more of the following measures:  
Reorient or relocate the receiving antenna.  
Increase the separation between the equipment and receiver.  
Connect the equipment into an outlet on a circuit different from that to which the receiver is connected.  
Consult the dealer or an experienced radio/TV technician for help.

**RF warning statemet:**  
The device has been evaluated to meet general RF exposure requirement. The device can be used in portable exposure condition without restriction.

### WARRANTY CARD

Scan code to register - Free 6 months warranty!



If you encounter any quality issues with the product or have any suggestions, please contact us promptly via our after-sales service email, and we will provide you with a satisfactory response.

[orgbro\\_service@outlook.com](mailto:orgbro_service@outlook.com)

**Return and exchange instructions:**  
Please ensure that the goods are intact and in a condition suitable for resale. We will provide service as soon as possible after receiving your request.