



klipxTreme

# FlexPlit

Foldable wireless keyboard with touchpad  
compatible with Bluetooth®

KCK-650E-GR

## I. Hi there!

**Congrats on your new KlipXtreme gadget! This foldable, portable keyboard/mousepad is ready to revolutionize your workspace. With so many perks, make sure to read this manual to fully enjoy your new acquisition. Let's dive in!**

## II. What's in the box

Here's what you'll find inside the FLEXPLIT box:

- Keyboard/mousepad
- USB dongle

As you unbox your new gadget, ensure everything is in perfect condition. If you find any parts missing or damaged, get in touch with KlipXtreme's customer support through the contact options on this page: [klipxtreme.com/submenu/support](https://klipxtreme.com/submenu/support). We're here for you!

## III. Power on and pairing

### 1. Turn it on

To power your keyboard on, move the switch to the "ON" position. The battery icon will turn red for 2 seconds to confirm you did it right.

### 2. Connect it to Bluetooth®

Before we go over the Bluetooth function, keep this in mind: modes Bluetooth and 2.4GHz don't work simultaneously.

#### 2.1. Here's the way-too-easy process of BT pairing:

El teclado solo tiene CONEXIÓN BT ; se puede conectar con 3 dispositivos a la vez. El proceso de conexión es presionar FN + A,S,D para BT1. BT2. BT3 respectivamente, luego C para conectar, luego para cambiar los dispositivos conectados presionar BT1. BT2. BT3, respectivamente.

### 3. Connect it through a 2.4GHz wireless signal

**Quick heads-up:** Bluetooth and 2.4GHz modes can't be used at the same time.

- Insert the USB dongle into any available USB port on your computer.
- Press "FN+2" to switch to 2.4GHz mode.
- Success! You're now connected.

**Remember:** To reconnect your device, press "FN+2" to ensure you're in 2.4G mode. Simple as that, and your Keyboard will be back online.

## IV. Switching operating systems

One the best things about your Keyboard is that you can pair it with Windows, Apple iOS or Android™ gadgets. Here's how it works:

### • For Windows and iOS mode:

FN+Q = iOS

FN+W = Android

FN+E = iOS

V. FN media shortcuts

Instead of searching online for keyboard shortcuts for every system, take a look at this table. It has all the information you need in one place.

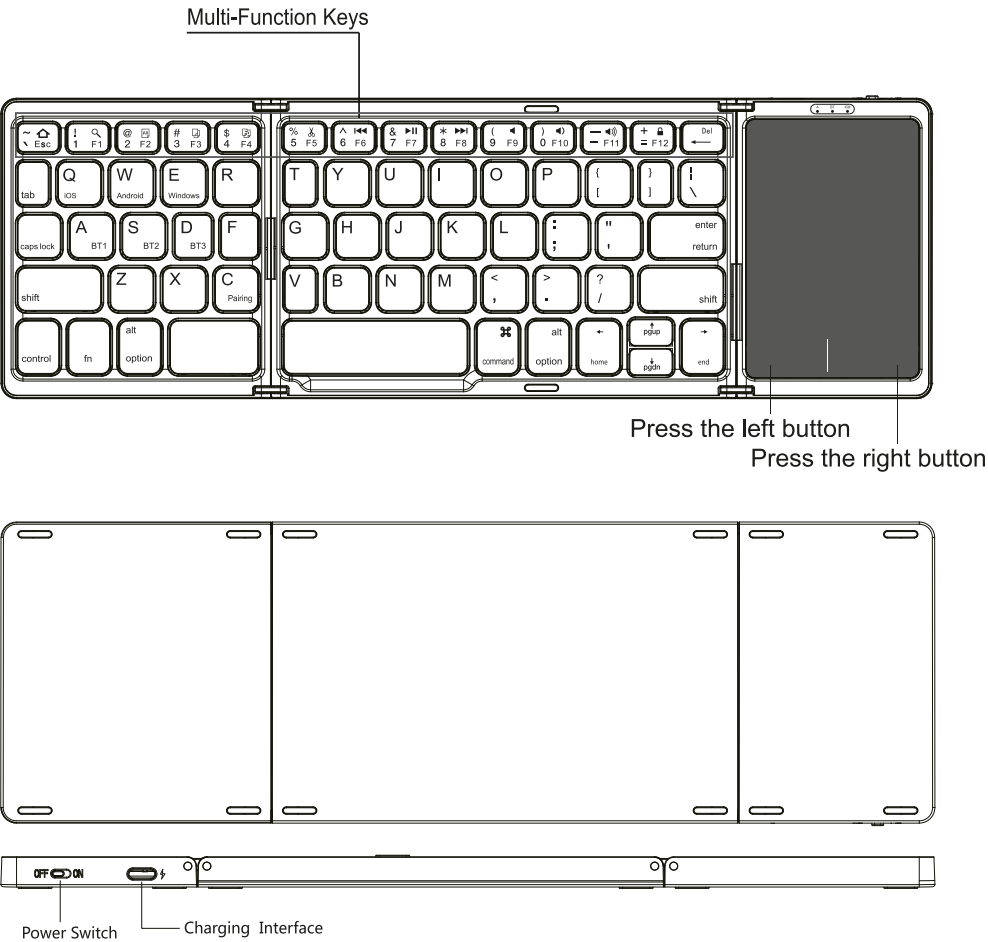

Product features

| iOS/Android  |                        | Windows      |                        | Windows      |                        |
|--------------|------------------------|--------------|------------------------|--------------|------------------------|
| Fn+          | Corresponding function | Fn+Shift     | Corresponding function | Fn+          | Corresponding function |
| ~⏏<br>↵ Esc  | Return to Desk         | ~⏏<br>↵ Esc  | Home Page              | ~⏏<br>↵ Esc  | Esc                    |
| ! 🔍<br>1 F1  | Search                 | ! 🔍<br>1 F1  | Search                 | ! 🔍<br>1 F1  | F1                     |
| @ 📄<br>2 F2  | Select                 | @ 📄<br>2 F2  | Select                 | @ 📄<br>2 F2  | F2                     |
| # 📄<br>3 F3  | Copy                   | # 📄<br>3 F3  | Copy                   | # 📄<br>3 F3  | F3                     |
| \$ 📄<br>4 F4 | Stick                  | \$ 📄<br>4 F4 | Stick                  | \$ 📄<br>4 F4 | F4                     |
| % ✂<br>5 F5  | Cut                    | % ✂<br>5 F5  | Cut                    | % ✂<br>5 F5  | F5                     |
| ^ ⏮<br>6 F6  | Pre-Track              | ^ ⏮<br>6 F6  | Pre-Track              | ^ ⏮<br>6 F6  | F6                     |
| & ⏸<br>7 F7  | Play/Pause             | & ⏸<br>7 F7  | Play/Pause             | & ⏸<br>7 F7  | F7                     |
| * ⏭<br>8 F8  | Next                   | * ⏭<br>8 F8  | Next                   | * ⏭<br>8 F8  | F8                     |
| ( 🔊<br>9 F9  | Mute                   | ( 🔊<br>9 F9  | Mute                   | ( 🔊<br>9 F9  | F9                     |
| ) 🔊<br>0 F10 | Volume-                | ) 🔊<br>0 F10 | Volume-                | ) 🔊<br>0 F10 | F10                    |
| — 🔊<br>_ F11 | Volume+                | — 🔊<br>_ F11 | Volume+                | — 🔊<br>_ F11 | F11                    |
| + 🔒<br>= F12 | lock                   | + 🔒<br>= F12 | lock                   | + 🔒<br>= F12 | F12                    |

## VI. Multichannel connection

### Connecting Devices:

1.First Device:

- Press Fn + BT1.
- Then press Fn + C to start the connection.

2.Second Device:

- Press Fn + BT2.
- Then press Fn + C to start the connection.

3.Third Device:

- Press Fn + BT3.
- Then press Fn + C to start the connection.

Switching Between Devices:

- To switch between connected devices, press Fn + BT1, Fn + BT2, or Fn + BT3.

## VII. Gestos del panel táctil para iOS

Touchpad function description (ios 13.4.1 and above)

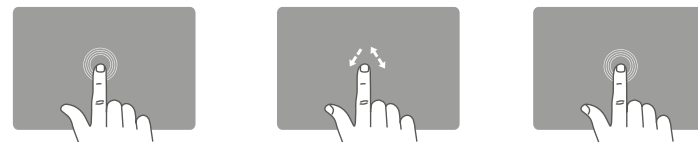
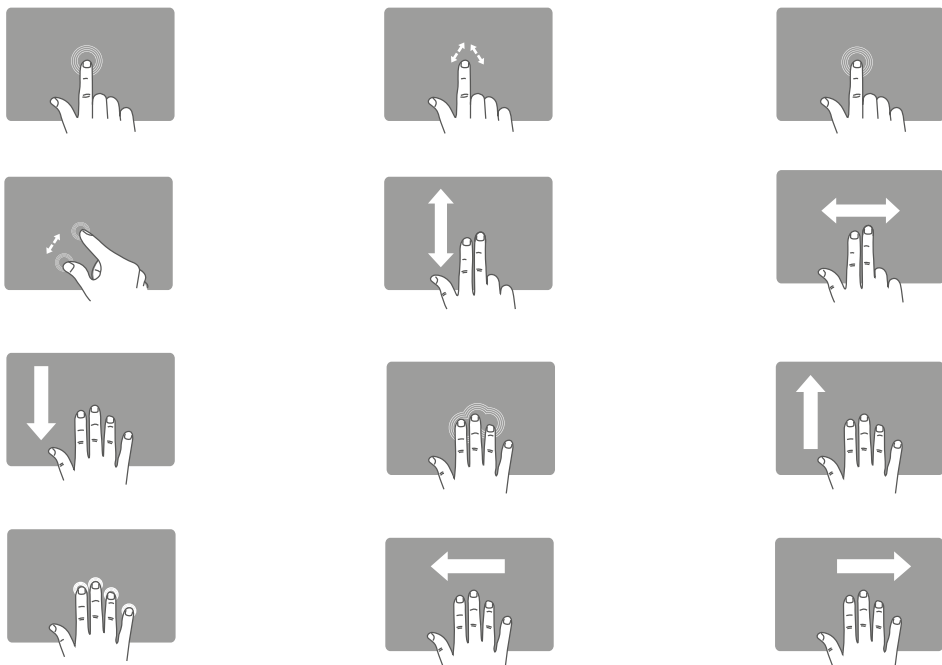

### Single Finger:

- **Tap-Tap:** Mouse cursor
- **Drag:** Double tap and drag

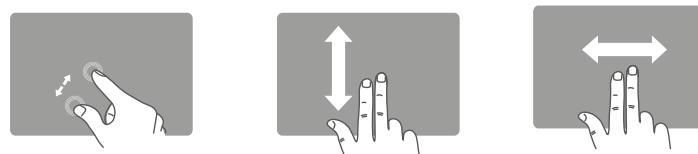

### Two Fingers:

- **Separation/Collapse:** Zoom in/out
- **Slides (Vertical):** Mouse wheel
- **Slides (Horizontal):** Slide the desktop left and right



### Three Fingers:

- **Slides Down:** Open all active windows
- **Slides Up:** Open/hide the bottom application bar (Cmd+Alt+D)
- **Tap:** Desktop

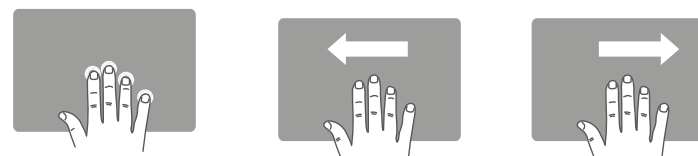

### Four Fingers:

- **Tap:** Regional screenshot (Cmd+Shift+4)
- **Slides Left/Right:** Active windows (Cmd+Tab)

## Touchpad function description (Windows)

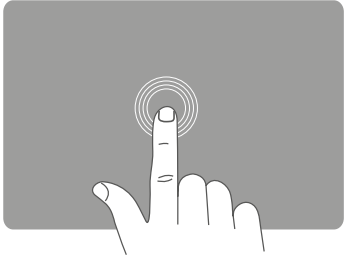

- Single Finger:**
- **Tap:** Left mouse button click

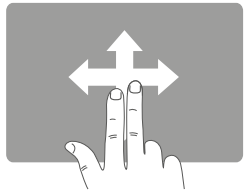
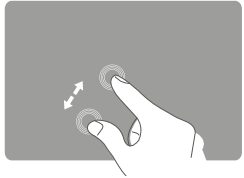

- Single Finger:**
- **Tap:** Left mouse button click

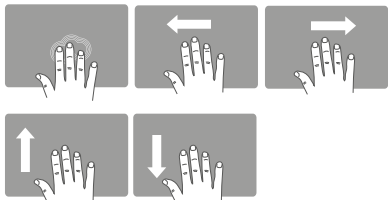

- Three Fingers:**
- **Tap:** Search
  - **Slides Left/Right:** Switch active window continuously
  - **Slides Up:** Open the browser window
  - **Slides Down:** Go Home

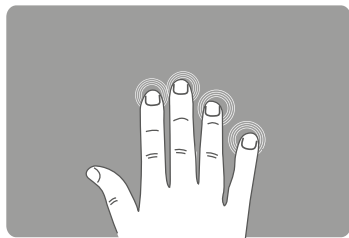

- Four Fingers:**
- **Tap:** Open the Action Center

## Touchpad function description (Android)

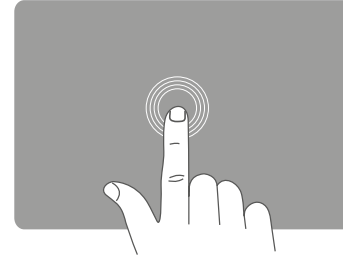

- Single Finger:**
- **Tap:** Left mouse button click

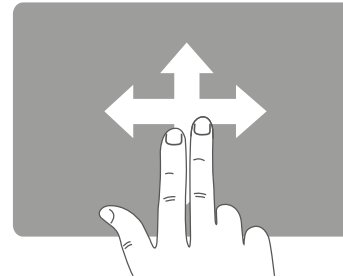

- Two Fingers:**
- **Slides (Vertical/Horizontal):** Mouse wheel

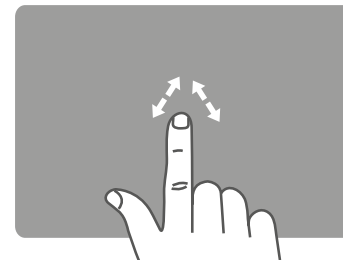

- Single Finger:**
- **Drag:** Mouse cursor

VII. FAQ

I.The tablet PC can’t connect to the Bluetooth keyboard?

- Ensure the Bluetooth keyboard is in pairing mode, then enable Bluetooth on the tablet PC to connect.
- Check if the Bluetooth keyboard is discoverable.
- Verify the Bluetooth keyboard has sufficient battery power; if not, charge it.

2. Why is the keyboard indicator always flashing?

- A constantly flashing indicator light means the keyboard is low on power. Please charge it as soon as possible.

3. Why does the tablet PC display that the Bluetooth keyboard is disconnected?

- If the Bluetooth keyboard is idle for a while, it will enter sleep mode to save power. Press any key to wake it up, and the Bluetooth connection will automatically restore.

IX. Keyboard Maintance

**1.Keep the keyboard away from liquids or humid environments:** Avoid saunas, swimming pools, steam rooms, and rain.

**2. Avoid extreme temperatures:** Do not expose the keyboard to very high or very low temperatures.

**3. Keep out of direct sunlight:** Do not leave the keyboard under the sun for extended periods.

**4. Keep away from flames:** Avoid placing the keyboard near cooking stoves, candles, or fireplaces.

**5. Avoid sharp objects:** Prevent scratches and ensure timely recharging to maintain normal use.

X. Product specifications

And now, for the grand finale: a sprinkle of mildly tedious yet absolutely essential info that you simply can't skip – or else...

| General information    |   |
|------------------------|---|
| Type                   | Wireless Foldable keyboard + Touchpad                     |
| Connection Interface   | Bluetooth v5.0®   |
| Charging Interface     | USB-C   |
| Number of keys         | 64 keys   |
| Multimedia keys        | 13 keys   |
| LED indicators         | 3 (Caps lock, BT, Battery)                                |
| Battery runtime        | 48hrs of continous use                                    |
| On/off switch          | Yes   |
| Additional information |   |
| Language Layout        | Spanish   |
| System requirements    | Windows7 and above, iOS13 and above, Android7.9 and above |
| OS Compatibility       | Windows7 and above, iOS13 and above, Android7.9 and above |
| Keyboard dimensions    | open 11.97 x 3.86 x 0.35in                                |
|                        | folded 5.98 x 3.86 x 0.75in                               |
| Keyboard weight        | 7.58 oz   |

Ps. If you have any questions or run into any issues with your new gadget, don't hesitate to reach out at [klipxtreme.com/submenu/support](https://klipxtreme.com/submenu/support). We're here to help! And hey, if you want to stay connected with your KlipXtreme pals, follow us on Instagram @klipxtreme and tag us in your party pics!

**KlipXtreme®** is a registered trademark. All rights reserved. The Bluetooth® name and logos are registered trademarks owned by Bluetooth SIG, Inc. Google, Google Home, Android™ and Google Play are trademarks of Google LLC. IOS is either a trademark or registered trademark of Cisco in the U.S. and other countries. Mac and macOS are trademarks of Apple Inc., registered in the U.S. and other countries. USB Type-C® and USB-C® are registered trademarks of USB Implementers Forum. All other trademarks and trade names are the property of their respective owners. Any mention of these trademarks is for identification purposes only and does not constitute an endorsement, sponsorship or affiliation with these marks. Made in China.