

# ULTIMEA

**HDMI**™  
HIGH-DEFINITION MULTIMEDIA INTERFACE

**Bluetooth**®



## *User Manual*

**Apollo S50**

**EN:** User Manual

**DE:** Benutzerhandbuch

**JP:** ユーザーマニュアル

**FR:** Manuel de l'Utilisateur

**IT:** Manuale d'uso

**ES:** Manual del usuario

Model No.: U3600  
Apollo S50 4.1 Channel Detachable Soundbar

# Contents

01	User Manual	English
	Connection and Installation .....	02
06	Benutzerhandbuch	Deutsch
	Anschluss und Installation .....	07
11	ユーザーマニュアル	日本語
	接続と設置 .....	12
16	Mode d'Emploi	Français
	Raccordement et installation .....	17
21	Manuale d'uso	Italiano
	Connessione e installazione .....	22
26	Manual del usuario	Español
	Conexión e instalación .....	27

ULTIMEA

Apollo S50

# User Manual



Model No.: U3600

WE ARE  
READY  
TO HELP



support@ultimea.com

## Prefer video tutorial?

Setup guidance video, USER MANUAL or Trouble Shooting on UTIMEA website.

  
@ultimea\_official



support.ultimea.com

+1 888-598-8875 (US) Mon-Fri 9am-5pm (PST)  
+49 89-628-25828 (EU) Mon-Fri 9am-5pm (CET)

## 1 ACCESSORIES LIST



Soundbar

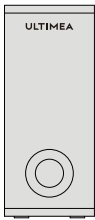

Subwoofer



Power Adaptor

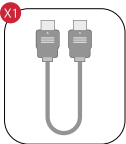

HDMI ARC

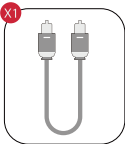

Digital Optical Cable

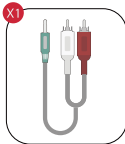

Stereo RCA to 3.5mm  
Audio Cable

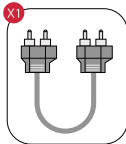

Stereo RCA to RCA  
Audio Cable(100mm)

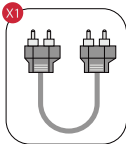

Stereo RCA to RCA  
Audio Cable(2.5m)

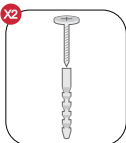

Wall Mounting Kit

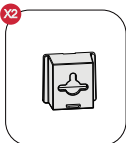

Wall Bracket



Remote Control

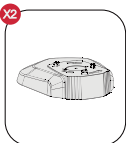

Base



User Manual



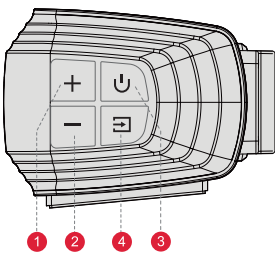



## 2 SOUNDBAR CONTROLS

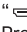

### Control Panel

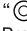
- VOL+:** Volume Up.
- VOL-:** Volume Down.
- Power Button:**  
Press to power on / Hold for 3 seconds to power off.
- SOURCE:**  
Press to switch channels: ARC-OPT(OPTICAL)-BT-AUX-USB.  
Hold for 3 seconds to disconnect the current device and connect to a new device manually on your mobile phone / PC / TV (BT ID: Apollo S50)

## Remote Control

- 1 “”: **Power Button**  
Press to power on / Hold for 3 seconds to power off.
- 2 “”: **ARC**  
Press to switch to HDMI ARC channel.
- 3 “”: **BT**  
Press to switch to Bluetooth channel and enter pairing mode.  
Hold for 3 seconds to disconnect current device and connect to a new device manually on your mobile phone / PC / TV (BT ID: Apollo S50).
- 4 “”: **OPT**  
Press to switch to OPTICAL channel.
- 5 “”: **AUX**  
Press to switch to AUX channel.
- 6 “”: **LED**  
Press to turn off LED, press again to turn on.
- 7 “”: **USB**  
Press to switch to USB channel.
- 8 “+”: **Volume Up**
- 9 “-”: **Volume Down**
- 10 “<”: **Previous**  
For BT and USB mode only: Skip to previous track.
- 11 “>”: **Next**  
For BT and USB mode only: Skip to next track.
- 12 “”: **Play / Pause**  
For BT and USB mode only.  
USB mode: Hold for 3 seconds to switch between single loop playback and list loop playback
- 13 “**MOVIE**”: **MOVIE**  
Press to switch to MOVIE mode, the display will show: “E9 1”.
- 14 “**GAME**”: **GAME**  
Press to switch to GAME mode, the display will show: “E9 2”.
- 15 “**MUSIC**”: **MUSIC**  
Press to switch to MUSIC mode, the display will show: “E9 3”.
- 16 “**BASS MAX**”: **BASSMAX**  
Press to adjust bass level, the display will show: “b5-2”, “b5-1”, “b5 0”, “b5 1”, “b5 2”.
- 17 “”: **Mute / Recover the volume.**

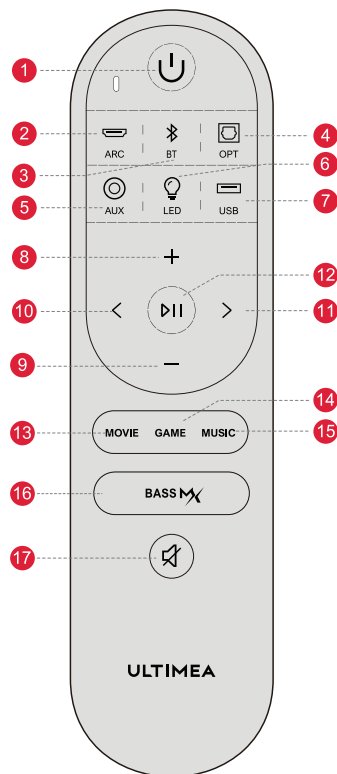

## 3 SOUNDBAR INSTALLATION

### Assembly steps:

- 1 Align the joints of the two parts.

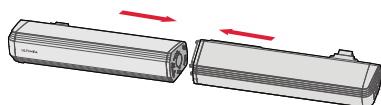

- 2 Twist to connect.

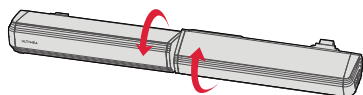

- 3 Plug in the Stereo RCA to RCA Audio Cable.

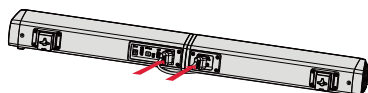

### Detached and stand on base:

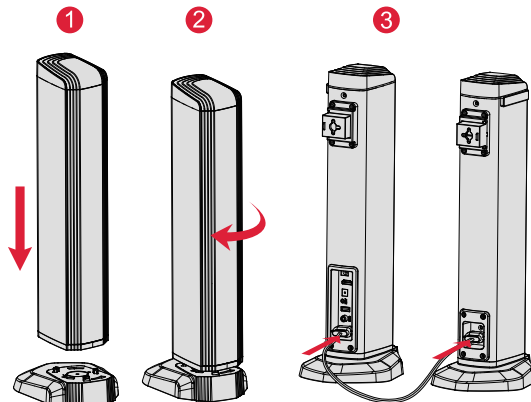

- 1 Set the soundbar on the base and align the joints.
- 2 Twist to connect with the base.
- 3 Plug in the Stereo RCA to RCA Audio Cable.

## 4 CONNECT TO SUBWOOFER

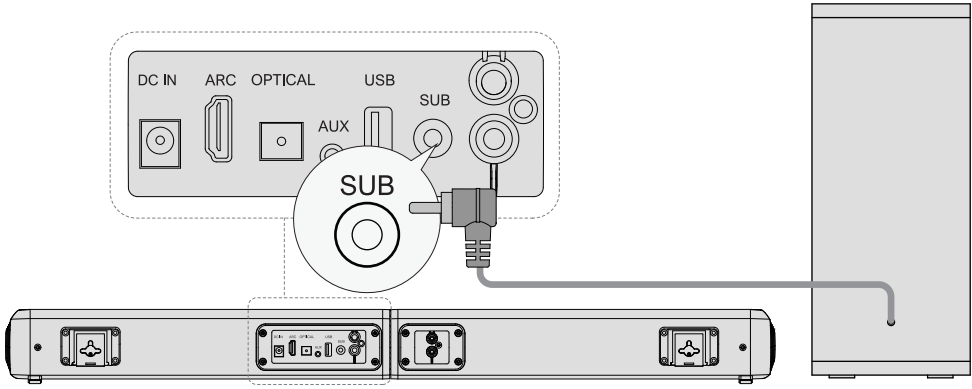

## 5 CONNECT TO TV VIA HDMI OUT ARC

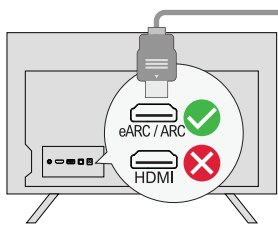

**Step 1:**  
Connect one end of the HDMI cable to the eARC / ARC port on the back of your TV.

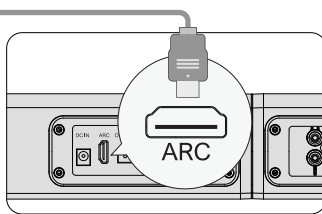

**Step 2:**  
Then connect the other end into the ARC port of the soundbar.

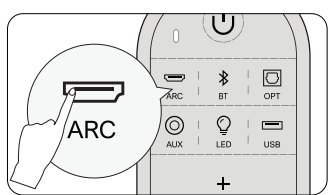

**Step 3:**  
Press "ARC" button on the remote control to select "ARC" input.

**If there is no sound, try setting the TV audio output to PCM:**

TV Settings > Home > Settings > Sound > Digital Audio Output > PCM

**Note: Please turn on the "CEC" function on your TV.**

When eARC / ARC is connected, your TV remote control can control the soundbar and TV simultaneously:

- ❶ Turn on / off    ❷ Adjust the volume

## 6 CONNECT TO TV VIA OPTICAL / AUX

### OPTICAL

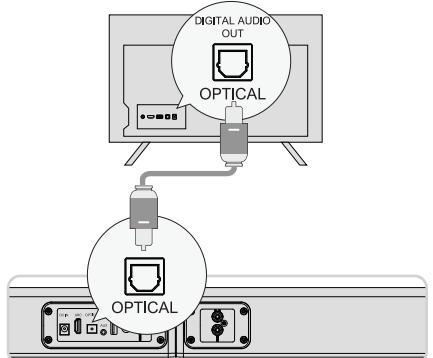

#### OPTION 1: OPTICAL

- ❶ Make sure the TV's port is OPTICAL OUT, connect both sides of the cable to OPTICAL, for both the TV and the soundbar.
  - ❷ Make sure the optical plug is inserted correctly as it shows in the picture. Do not insert the plug upside down and break the optical.
- Note:** If audio is coming from the internal TV speakers, mute or minimize the TV volume.

### AUX

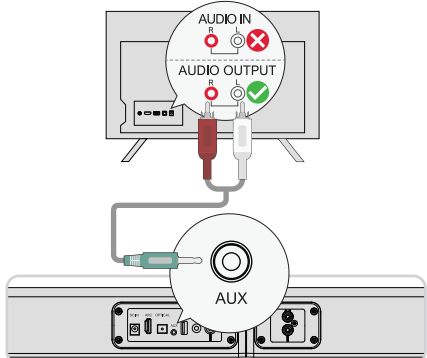

#### OPTION 2: AUX

- ❶ Connect the 3.5mm to RCA audio cable to connect to your TV's RCA AUDIO OUT port.
  - ❷ Make sure the color of the cables ends matches the color of the TV ports.
- Note:** Please remember to unplug the AUX cable from TV and Soundbar when you want to switch other mode.

**In Optical Mode:** If there is no sound, try setting the TV audio output to PCM: TV Settings > Home > Settings > Sound > Digital Audio Output > PCM

## 7 CONNECT TO BLUETOOTH®

- 1 Press the “” button on the soundbar or press the “” button on the remote control to enter Bluetooth pairing mode.
- 2 Go to the Bluetooth setting on your phone, find and select “**Apollo S50**” to connect the soundbar.

**Note:** If it's already in the Bluetooth mode and connected, press and hold “” button for 3 seconds to disconnect current device and choose to connect to a new device manually on your mobile phone / PC / TV.

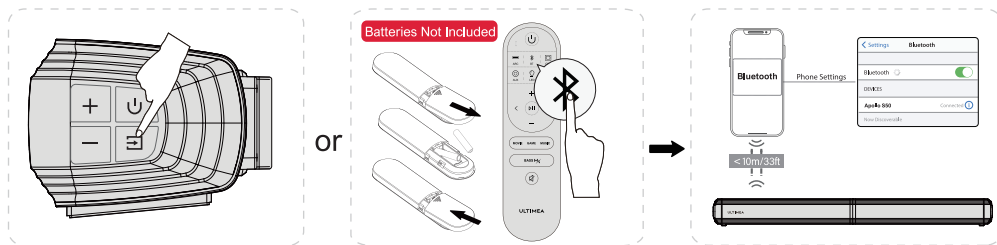

## 8 PLACEMENT OPTIONS

### Detached and stand on base

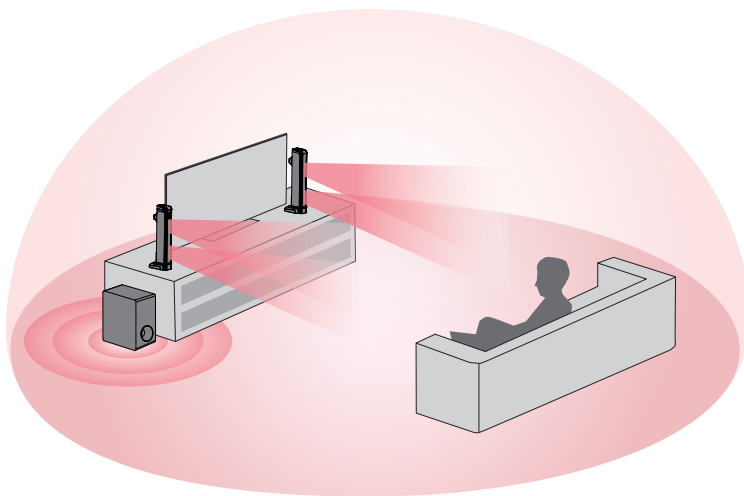

### Horizontal placement

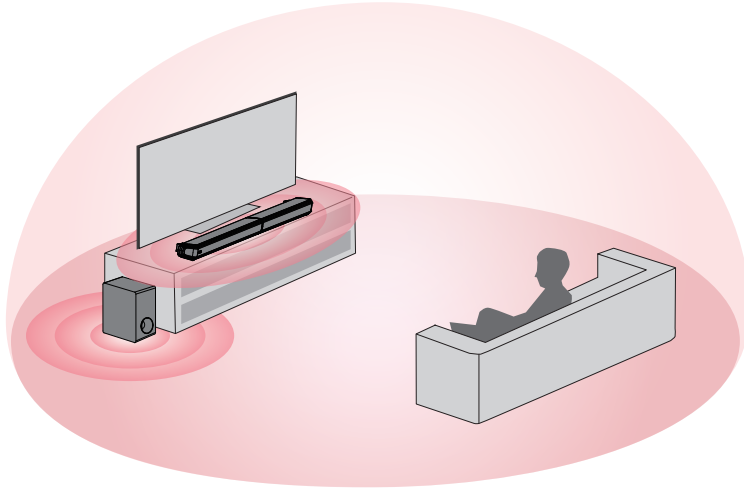

**Note:** The soundbar should be placed at or near ear level.

## 9 WALL MOUNT INSTALLATION

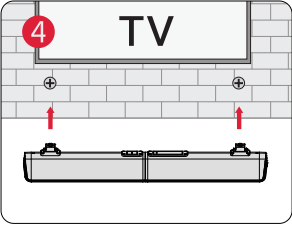
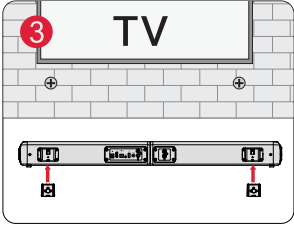
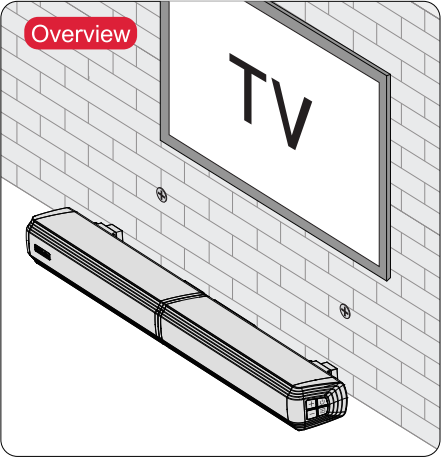
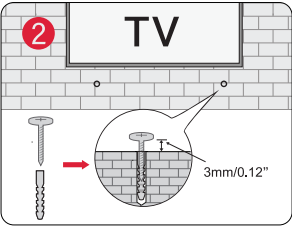
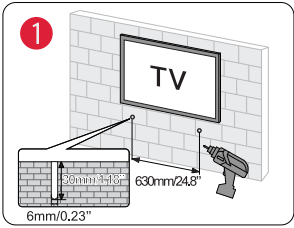

## 10 SPECIFICATIONS

Model Number	U3600
Power Supply	AC 100-240V, ~50/60Hz
Soundbar Drivers	2.25"x 4(Soundbar) + 5.25"(Subwoofer)
Frequency Response	45Hz - 18kHz
Standby Power	<0.5W
Operating Temperature	0°C - 45°C/32°F - 113°F
Bluetooth Vision	5.3

Dimensions and Weight	
Soundbar	811(W) × 98(D) × 70(H)
Subwoofer	270(W) × 115(D) × 270(H)
Packaging	436(W) × 306(D) × 236(H)
Net Weight	4.6kg / 10.1lbs
Gross Weight	6.64kg / 14.63lbs

# SAFETY INSTRUCTIONS

## Please read this user manual carefully and save it for future reference.

Do not make unauthorized alterations to the product, doing so may compromise safety, regulatory compliance, system performance, and may void the warranty.

- Avoid dropping.
- Do not disassemble.
- Do not submerge in water
- Avoid extreme temperatures.
- Do not use the device outdoors during thunderstorms.
- Use original or certified cables.
- Do not place dangerous items on top of this device (e.g. liquid filled objects, lit candles).
- Clean with a dry, soft lint-free cloth. Do not use any corrosive cleaner or oil.
- To avoid hearing damage, do not listen for extended periods at high volume.
- Do not expose the batteries to extreme heat sources such as direct sunlight or open flames.
- The ideal operating temperature for this product and its accessories is between 41°F/5°C and 95°F/35°C.
- The adapter should be installed near the device and should be easily accessible.
- Do not use this product in environments of extreme heat or cold. Never expose this device to strong sunshine or wet environments.

# PROPER DISPOSAL INSTRUCTIONS



This mark shown on the product or its packaging, indicates that this product should not be disposed of with other household waste at the end of its working life.

To prevent possible harm to the environment or human health from uncontrolled waste disposal, please separate this from other types of wastes and recycle it responsibly to promote the sustainable reuse of material resources.

## Waste Electrical & Electronic Equipment

Household user should contact either the retailer where they purchased this product, or their local government office, for details of where and how they can take this item for environmentally safe recycling.

Business users should contact their suppliers and check the terms and conditions of the purchase contract. This product should not be mixed with other commercial wastes for disposal.

# FCC REGULATORY COMPLIANCE

Any changes or modifications not expressly approved by the party responsible for compliance could void the user's authority to operate the equipment.

This device complies with Part 15 of the FCC Rules.

Operation is subject to the following two conditions:

- (1) This device may not cause harmful interference.
- (2) This device must accept any interference received, including interference that may cause undesired operation.

NOTE: This equipment has been tested and found to comply with the limits for a Class B digital device, pursuant to part 15 of the FCC Rules. These limits are designed to provide reasonable protection against harmful interference in a residential installation. This equipment generates, uses, and can radiate radio frequency energy, and if not installed and used in accordance with the instructions, may cause harmful interference to radio communications.

However, there is no guarantee that interference will not occur in a particular installation. If this equipment does cause harmful interference to radio or television reception, which can be determined by turning the equipment off and on, the user is encouraged to try to correct the interference by one or more of the following measures:

- Reorient or relocate the receiving antenna.
- Increase the separation between the equipment and the receiver.
- Connect the equipment to an outlet on a circuit different from that to which the receiver is connected.
- Consult the dealer or an experienced radio / TV technician for help.

# ISED WARNINGS

This device contains licence-exempt transmitter (s) / receiver (s) that comply with Innovation, Science and Economic Development Canada's licence-exempt RSS (s). Operation is subject to the following two conditions:

- (1) This device may not cause interference.
- (2) This device must accept any interference, including interference that may cause undesired operation of the device.

L'émetteur/récepteur exempt de licence contenu dans le présent appareil est conforme aux CNR d'Innovation, Sciences et Développement économique Canada applicables aux appareils radio exempts de licence. L'exploitation est autorisée aux deux conditions suivantes:

- (1) L'appareil ne doit pas produire de brouillage;
- (2) L'appareil doit accepter tout brouillage radioélectrique subi, même si le brouillage est susceptible d'en compromettre le fonctionnement.

The device meets the exemption from the routine evaluation limits in section 2.5 of RSS 102 and compliance with RSS-102 RF exposure, users can obtain Canadian information on RF exposure and compliance.

Le dispositif rencontre l'exemption des limites courantes d'évaluation dans la section 2.5 de RSS 102 et la conformité à l'exposition de RSS-102 rf, utilisateurs peut obtenir l'information canadienne sur l'exposition et la conformité de rf.

This transmitter must not be co-located or operating in conjunction with any other antenna or transmitter. This equipment should be installed and operated with a minimum distance of 20 centimeters between the radiator and your body.

Cet émetteur ne doit pas être Co-placé ou ne fonctionnant en même temps qu'aucune autre antenne ou émetteur. Cet équipement devrait être installé et actionné avec une distance minimum de 20 centimètres entre le radiateur et votre corps.



Declaration of Conformity

We (Manufacturer is responsible for this declaration)  
Dyanic (Shenzhen) Technology Limited  
(Company name)

20th Floor, Building 4, Tianan Cloud Park, Bantian St.,  
Longgang District Shenzhen, China 518000  
(Company address)

Declare under our sole responsibility that the product  
Trade Mark: ULTIMEA  
Product Name: Apollo S50 4.1 Channel Detachable  
Soundbar  
Model No.: U3600

To which this declaration relates is in conformity with  
the essential requirement set out in the Council Directive  
on the Approximation of the laws of the Member States  
relating to RED Directive (2014/53/EU) & RoHS (2011/  
65/EU) product is responsible to affix CE marking, the  
following standards were applied:

EN 55032:2015/A11:2020  
EN 55035:2017/A11:2020  
ENIEC 61000-3-2:2021  
EN 61000-3-3:2013/A1:2021  
ETSIEN 301 489-1 V2.2.3(2019-11)  
ETSIEN 301 489-17 V3.2.4(2020-09)  
EN 300 328 V2.2.2(2019-07)  
EN 50663:2017  
ENIEC 62368-1:2020+A11:2020  
IEC62321-3-1:2013  
IEC 62321-4:2013+A1:2017  
IEC 62321-5:2013  
IEC 62321-6:2015  
IEC 62321-7-1:2015  
IEC 62321-7-2:2017  
IEC 62321-8:2017

Full Name: Yoyo.Yu  
Position: Approbation Manager  
Signature:   
Place/Date: Shenzhen, China / Dec. 25-2022

Trade Marks:



The Bluetooth® word mark and logos are registered trademarks owned by Bluetooth SIG, Inc. and any use of such marks by Soundlab Technology Co.,Ltd. is under license. Other trademarks and trade names are those of their respective owners.



The Adopted Trademarks HDMI, HDMI High-Definition Multimedia Interface, HDMI trade dress and the HDMI Logos are trademarks or registered trademarks of HDMI Licensing Administrator, Inc. in the United States and other.

ULTIMEA

Apollo S50 4.1 Channel Detachable Soundbar  
Model No.: U3600



Dyanic GmbH  
Buchenring 57, 22359 Hamburg, Germany



UK Crossborder limited  
7 Bell Yard London WC2A 2JR, UK United Kingdom

Made in China  
Manufacturer: Dyanic (Shenzhen) Technology Limited  
Address: 20th Floor, Building 4, Tianan Cloud Park, Bantian St.,  
Longgang District, Shenzhen, China 518000

If you need our support, kindly reach out to our  
service team. We are always glad to help.

+1 888-598-8875 (US)  
Mon-Fri 9am-5pm (PST)  
+49 89-628-25828 (EU)  
Mon-Fri 9am-5pm (CET)  
 support@ultimea.com  
 support@ultimea.de  
 support.ultimea.com  
support.ultimea.de



@ultimea\_official