

OPERATION INSTRUCTION



● Seconds Dial Button

● Adjustable Crown

● Reset Button



Minutes Dial



Seconds Dial



12/24 Hours Display



Calendar Indicator

A: Features

- Large Roman Numerals Analog Display
- Japanese Quartz Movement
- Calendar Indicator
- Second Hand, Minute Hand, Hour Hand
- 12/24 Hours Display
- Chronograph

B: How to adjust time and date?



1. Pull the watch crown to the first stage to adjust the calendar.
2. Pull the watch crown to the second stage to adjust the time.
3. Push the watch crown back to the watch case to finish adjusting the calendar or time.

C: How to use the chronograph function?

- ✔ Given the watch case's width of only 40mm, embedded stopwatch buttons are employed to enhance the watch's aesthetic appeal.
- ✔ Please check the watch and locate two push buttons on the watch case. The upper button is the seconds dial button, and the lower button is the reset button.
- ✔ 1. Use a small pin to press the seconds dial button. This will initiate the movement of the seconds dial. Once the pointer completes a full circle, the minutes dial will start moving.
- ✔ 2. If you want to stop it, press the seconds dial button again. This action will pause the seconds dial.
(Note: make sure to complete this step to stop the seconds dial before proceeding to the third step).
- ✔ 3. Simply use a small pin to press the reset button. This process will reset the seconds sub-dial hand to the 12 o'clock position.

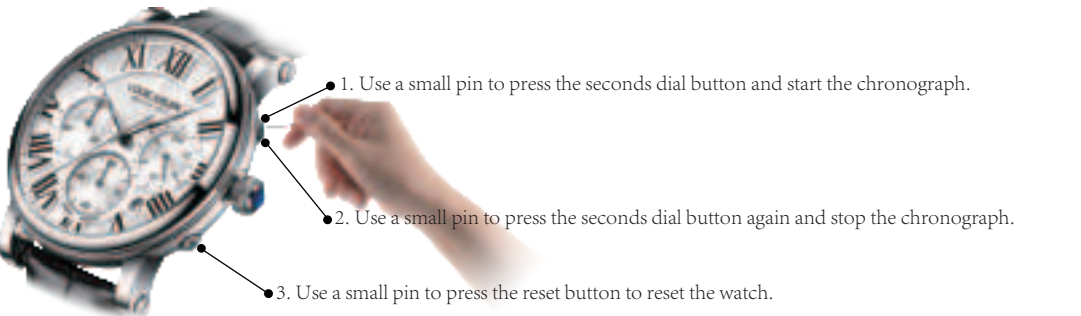

D: What are the questions about resetting the seconds sub-dial and the minutes sub-dial?

- ✔ **Q1: If the seconds sub-dial is not accurate?**
Please pull the watch crown to the second stage, and then press and hold the reset button with a small pin for a moment. The pointer on seconds dial will move rapidly. Please release the reset button when the pointer is about to reach the 60s mark. Next, press the reset button several times until the second hand is correctly aligned with the 60s mark. Finally, push the watch crown back into the case.
- ✔ **Q2: If the minutes sub-dial is not accurate?**
Please pull the watch crown to the second stage, and then press and hold the reset button with a small pin for several minutes. The pointer on seconds dial will move rapidly, once the seconds pointer completes a full circle, the minutes dial will start moving. Please release the reset button when the minutes pointer is about to reach the 60s mark. Next, press the reset button several times until the seconds pointer and minutes pointer are correctly aligned with the 60s mark. Finally, push the watch crown back into the case.
- ✔ **Notes:**
Once you finish the the reset process, please using the chronograph function according to the instruction in paragraph C.



E: Contact Us

If you face any issues with your received watch, whether it's about quality, usage, or any queries, please contact us anytime. We'll respond within 24 hours, providing professional help until you're satisfied. Our aim is to deliver an exceptional shopping experience and excellent after-sales service to every customer. Your satisfaction is our greatest honor.