

## X75 V2 keyboard Handy Guide

### •2.4G WIRELESS CONNECTION



### •WIRELESS CONNECTION



Note: Wireless 2 and Wireless 3 are connected in the same way as Wireless 1. Press the key [FN+2@] to switch to Wireless 2. Press the key [FN+3#] to switch to Wireless 3; When connecting, the blue light flashes slowly.

### •WIRED CONNECTION

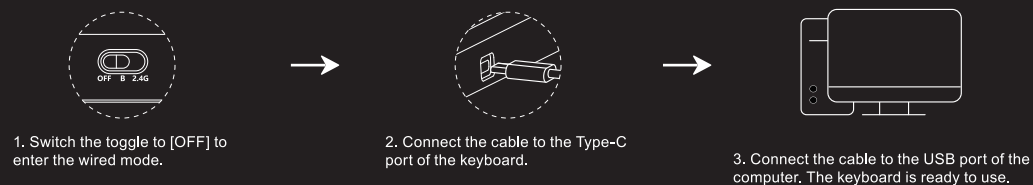

### •SYSTEM MODE SWITCH



### •BACKLIGHT SETTING



### •STATUS LIGHT SETTING



### •SIDE LIGHT SETTING



Scan the QR code to view the electronic manual ▶

