

USER MANUAL



S3



S5



S7

Electric
Pressure Washer

**THANK YOU FOR CHOOSING
SHAKTI TECHNOLOGY
ELECTRIC PRESSURE WASHER
PLEASE READ THE OWNER'S MANUAL
AND SAFETY INSTRUCTIONS CAREFULLY
BEFORE OPERATING THE ELECTRIC
PRESSURE WASHER. SAVE THIS
MANUAL FOR FUTURE REFERENCE.
IF YOU HAVE ANY PROBLEMS AND
QUESTIONS, PLEASE CONTACT US.**

TABLE OF CONTENT

Product Description **04**

Technical Specification **05**

Know Your Product **06**

What's in the Box **07**

Assembly Instructions **08**

Operating Instructions **10**

Maintenance **11**

Troubleshooting **12**

Contact Us **14**

PRODUCT DESCRIPTION

- This high-pressure electric power washer is intended for residential use to clean vehicles, machines, buildings, facades, etc.
- Never use the machine in potentially explosive areas under any circumstances!
- Do not use water that is dirty, gritty, or contains any chemical products, as these could impair operation and shorten the life of the machine.
- This unit can be placed horizontally. Do not step on when placed horizontal.

TECHNICAL
SPECIFICATION

Specification	S3	S5	S7
Motor	1800W	1900W	2100W
Max Flow Rate	06 L/min	08 L/min	10 L/min
Rated Pressure	120 Bar	125 Bar	130 Bar
Voltage	220-240V	220-240V	220-240V

KNOW YOUR PRODUCT

- | | |
|-------------------------|------------------|
| 1 Inlet Pipe | 6 Pressure Gun |
| 2 Water Bucket Filter | 7 Soap Dispenser |
| 3 Inlet Quick Connector | 8 Main Unit |
| 4 Inlet Crystal Filter | 9 Extention Rod |
| 5 Outlet Pipe | |



****All details will remain same for S3 & S7 Model Also**

WHAT'S IN THE BOX

- **Electric pressure washer**
- **Pressure gun**
- **Outlet Hose Pipe**
- **Inlet Pipe**
- **Needle clean-out tool**
- **Inlet Filter Set**
- **Soap Dispenser**
- **User's manual**

IMPORTANT!

The equipment and packaging material are not toys. Do not let children play with plastic bags, foils, or small parts. These items can be swallowed and pose a suffocation risk!

ASSEMBLY

INSTRUCTIONS

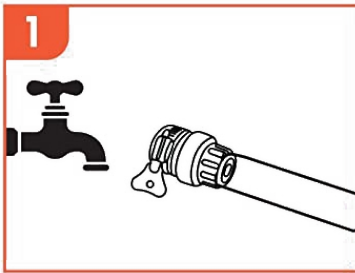

Attach one end of the inlet pipe with the tap connector

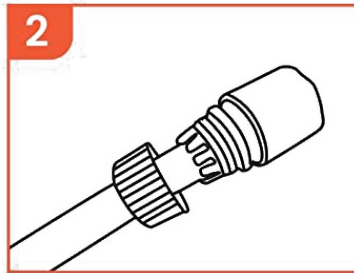

Attach another end of the inlet pipe with the inlet connector.

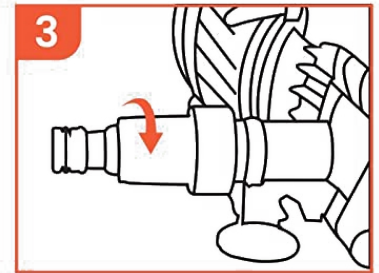

Screw the inlet filter clockwise to attach with the main unit.

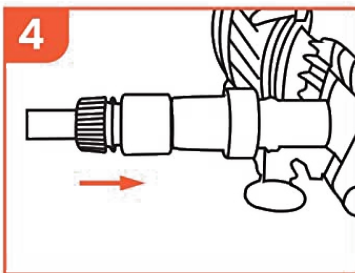

Push and attach the inlet connector with the inlet filter.

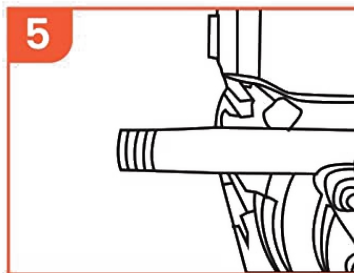

Turn ON the machine. Release the water for few minutes to release the air inside.
(Without the outlet pipe connected)

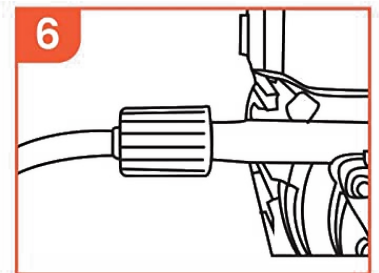

Connect one end of outlet hose pipe with the outlet end of the machine.



Connect another end of the outlet hose pipe with the gun.

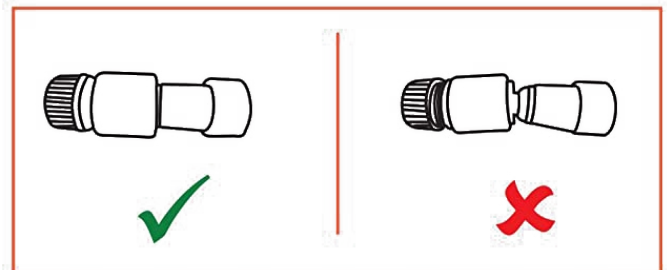

Inlet filter must be straight

Don't bend inlet connector

OPERATING INSTRUCTIONS

- When making washing, especially with high pressure, make sure distance between the nozzles and object is enough otherwise damage to the object may occur.
- When the time slot of not use the machine for more than 5 min, please cut off the machine and press the gun trigger to release the pressure.
- The working pressure of the machine is set from the factory and the user should not adjust it higher, otherwise the machine may be damaged.
- It is normal that when it is working, there may be some water drops out form the water discharge holes in the pump juncture.
- When you want to stop the machine, please follow steps as below:
 1. Switch off the machine
 2. pull the plug off from the socket
 - 3 cut off the water supply (if the water is supplied from the tap).
 4. Press the trigger of the spray gun to release the pressure.
- The accessories like gun and hose matter the performance, so please take care of them any time.
- If the motor cannot work, please turn it off at once, or it may be burned.

MAINTENANCE

- Replace Engine Oil Regularly (Oil grade 15W-40)

A. After first 20 hours' working, the engine oil must be replaced, (60-70ml oil can be filled).

B. Replace the second time after another 50 hours' working and replace the oil regularly after each 100 hours' working.

- Turn off the machine when you make maintenance for the machine

A. If the machine will be in storage for a long time, the left water in the pump must be drained off completely. Keep the machine in a dry and well ventilated condition.

B. If the water source is not very clean; the filter net should be cleaned regularly.

Problem	Cause	Possible Solution
The motor won't run or stop running when it is working.	1) No power supply or poor connect between the plug and socket. 2) The switch or remote control switch may be broken, or the battery depleted. 3) The voltage of the power is too low. 4) Crankshaft and connect rod won't lubricate well. 5) The capacitor broken.	1) Examine the power supply and make the plug & socket well connected. 2) Repair or replace the switch, or replace the battery. 3) Consult with the electric supply. 4) Detach the fan cover from the motor and turn the motor around. If after doing that it still won't work, to agent for repair. 5) To the agent to replace the capacitor.
The nozzle cannot spray water or spray water in low pressure.	1) Nozzle is clogged. 2) The checking valve closes down. 3) There is air in the hose. 4) Water sealing worn off. 5) The filter net is clogged.	1) Clear the nozzle. 2) Run the pump with water tap as water supply for some minutes or clean the checking valve. 3) Make firmly connecting of the water inlet hose to eject the air. 4) Replace the water seal. 5) Clear the filter net.

Problem	Cause	Possible Solution
Pressure unloads.	1) Pressure valve leaking water. 2) Pressure loader clogged 3) Mushroom nail worm off 4) Connecting between gun and hose leaking or gun leaking.	1) Replace some O-rings or go to agent for repairs. 2) Clear pressure loader. 3) Replace the Mushroom nail. 4) Tighten the connecting or replace the gun.
Water leaking on the pump.	1) Supporting ring worn off 2) Water seal worn off. 3) Plunger worn off.	1) Replace the supporting ring. 2) Replace the water seal. 3) Replace the plunger.
Oil leaking on the pump.	1) Some O-ring worn off. 2) Oil seal worn off. 3) Add too much oil to the crankshaft case. 4) Air vent clogged.	1) Replace some O-rings. 2) Replace the oil seal. 3) Drain some oil until the oil level is in middle or 2/3 level of the oil window. 4) Clear the air vent.
When stop the spray gun, the pressure doesn't return to zero but rise & fall continuously.	1) Returning valve damage on outlet pump side.	1) Replace the returning valve.



Waste electrical products should not be disposed of with household waste. Please recycle where facilities exist. Check with your Local Authority or local store for recycling advice.

Do not dispose this product by normal household waste, but take it to a collection point and recycling of electrical and electronic equipment. This is indicated by the symbol on the product, user manual or packaging. Re-use, material utilization or other forms of old appliances, you make an important contribution in protecting our environment.

CONTACT US



Shakti Technolgy
Rajkot, Gujarat (India).



+91 99090 84777
+91 95582 85760



service@shaktitool.com



www.shaktitool.com