

# User Manual

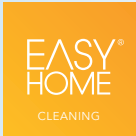

## CARPET CLEANER



# Contents

<b>Package contents.....</b>	<b>3</b>
Components .....	6
Required tools (not included).....	6
<b>General information.....</b>	<b>7</b>
Reading and storing the user manual .....	7
Proper use.....	7
Explanation of symbols .....	7
<b>Safety .....</b>	<b>8</b>
Signal symbol/word definitions.....	8
General safety instructions.....	8
<b>Checking the product and package contents .....</b>	<b>11</b>
<b>Product assembly.....</b>	<b>11</b>
<b>Carpet preparation .....</b>	<b>12</b>
<b>Operation.....</b>	<b>12</b>
Filling the water solution tank.....	12
Cleaning a carpet.....	14
Tips for carpet cleaning .....	14
Emptying the dirty water tank .....	15
<b>Cleaning.....</b>	<b>15</b>
Cleaning the filters .....	16
Cleaning the product .....	17
<b>Storage .....</b>	<b>17</b>
<b>Troubleshooting.....</b>	<b>17</b>
<b>Technical data .....</b>	<b>18</b>
<b>Disposal.....</b>	<b>18</b>
Disposing of the packaging .....	18
Disposing of the product .....	18
<b>Warranty details.....</b>	<b>19</b>
<b>Repair and refurbished goods or parts notice .....</b>	<b>20</b>

# Package contents

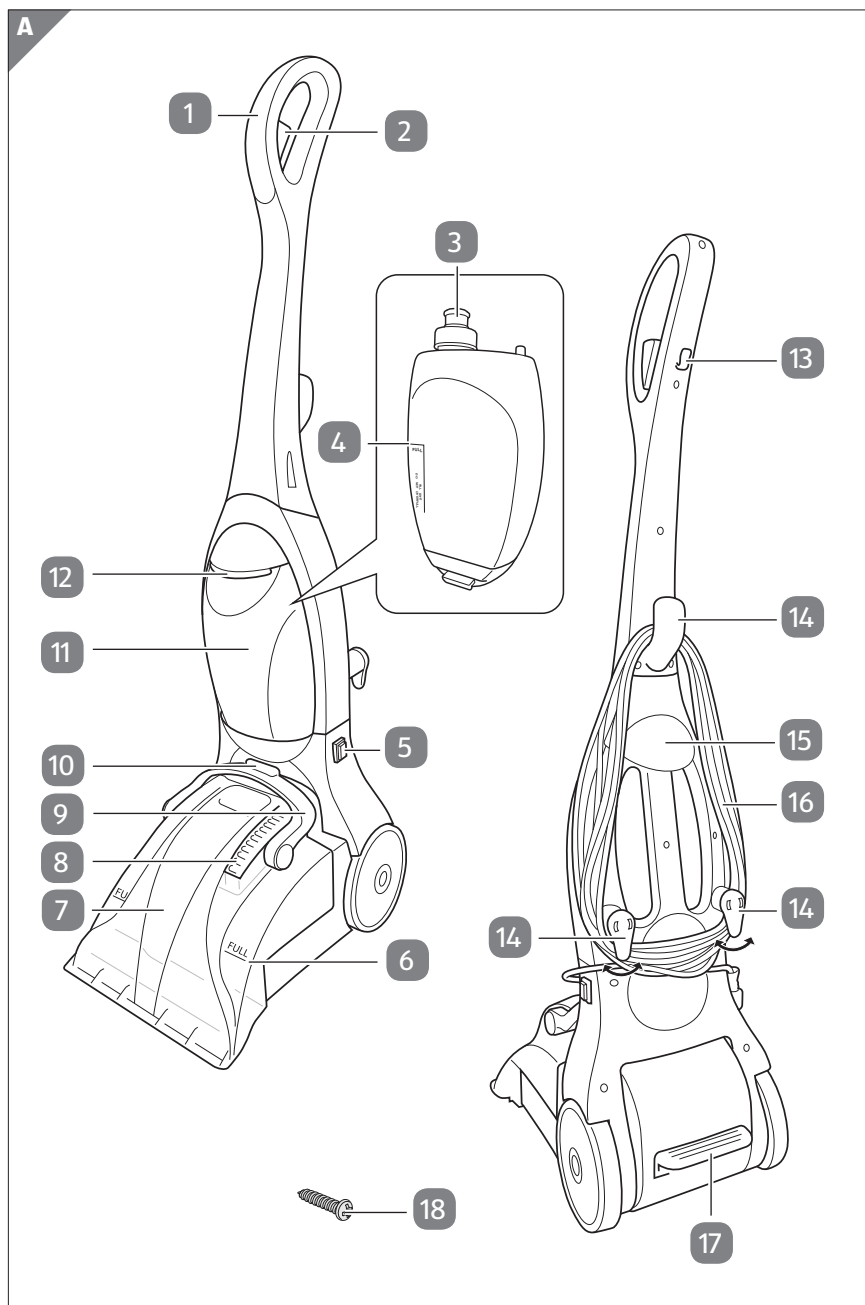

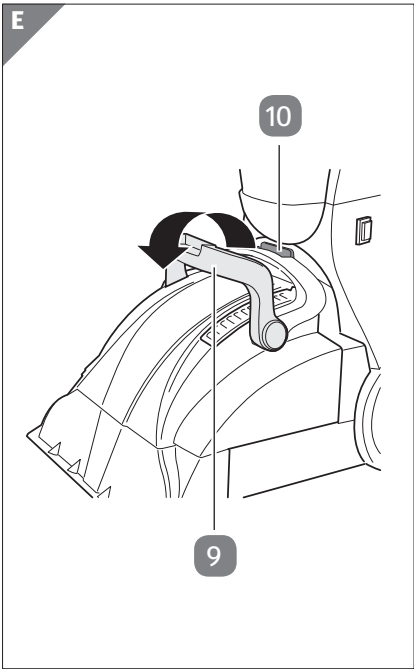
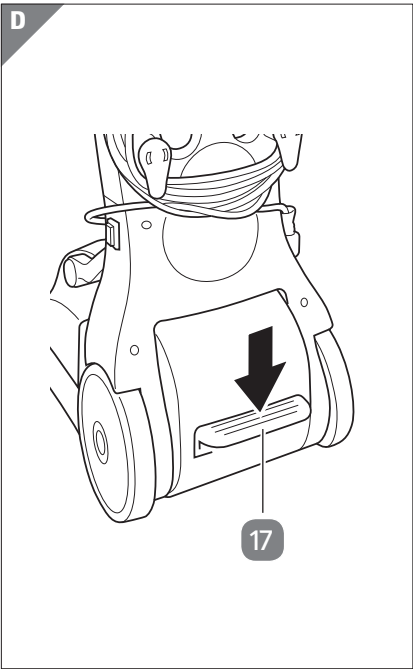
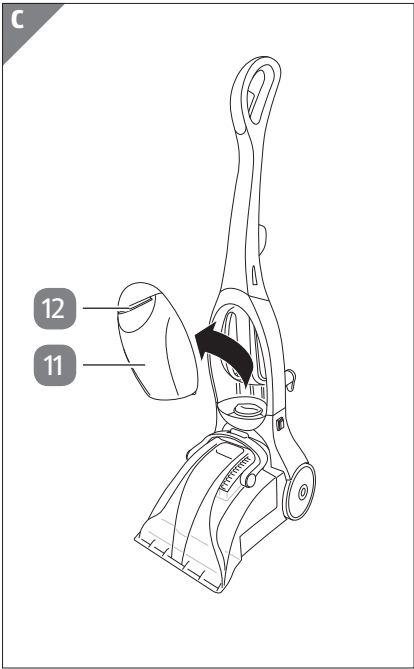
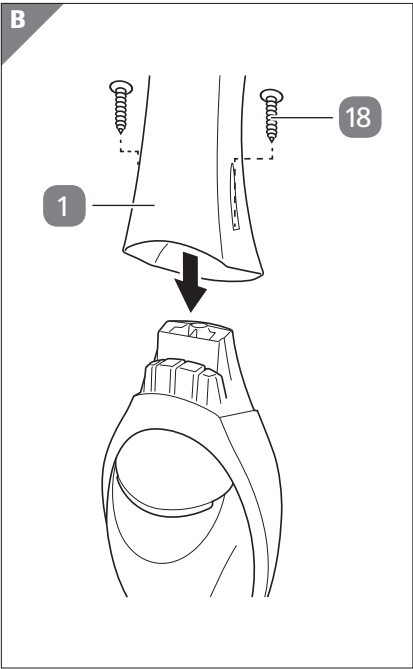

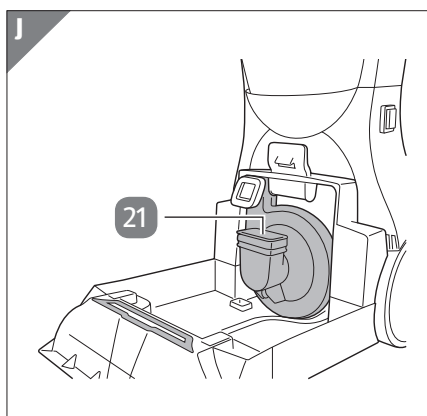
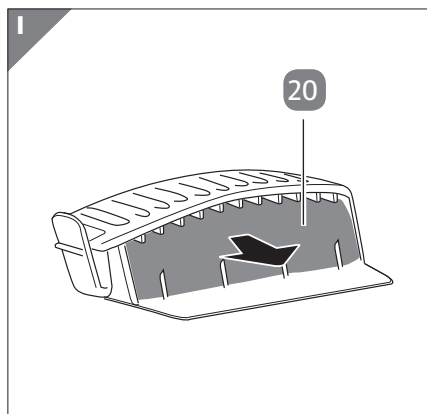
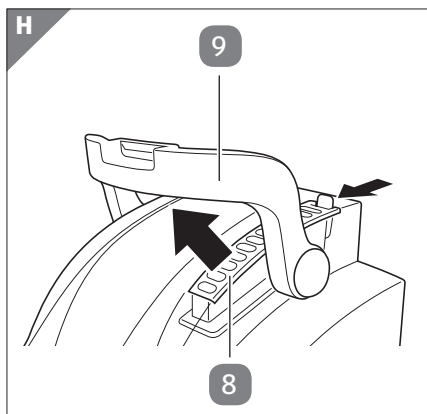
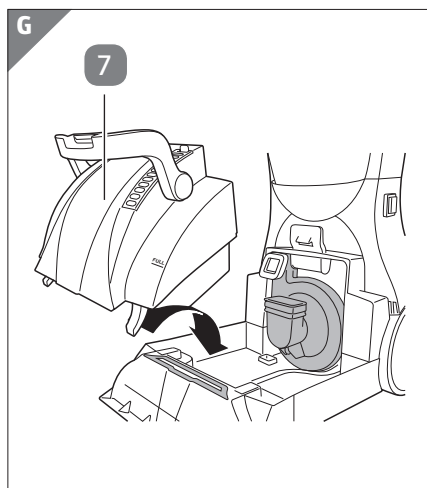
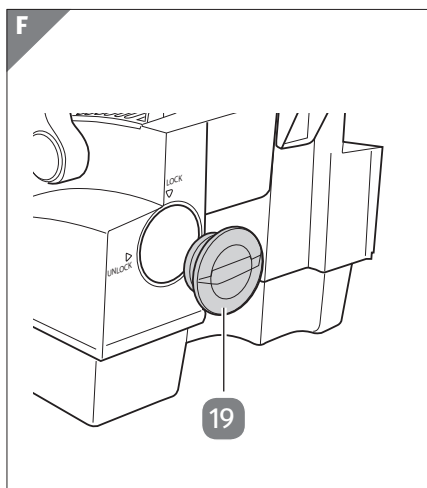

## Components

- |    |                                |    |                                   |
|----|--------------------------------|----|-----------------------------------|
| 1  | Handle                         | 12 | Water solution tank release lever |
| 2  | Solution release trigger       | 13 | Cord clip                         |
| 3  | Water solution tank cap        | 14 | Cord hooks                        |
| 4  | Maximum filling line (FULL)    | 15 | Carrying handle                   |
| 5  | On/off switch (I/O)            | 16 | Mains cord                        |
| 6  | Full line                      | 17 | Handle release pedal              |
| 7  | Dirty water tank               | 18 | Screw, 2×                         |
| 8  | Exhaust filter housing         | 19 | Dirty water tank cap              |
| 9  | Dirty water tank handle        | 20 | Filter                            |
| 10 | Dirty water tank locking latch | 21 | Motor filter                      |
| 11 | Water solution tank            |    |                                   |

## Required tools (not included)

- 22 Crosshead screwdriver



# General information

## Reading and storing the user manual



This user manual accompanies this carpet cleaner (hereafter referred to as the “product”), and contains important information on setup and handling.

Before using the product, read the user manual carefully. This particularly applies to the safety instructions. Failure to do so may result in personal injury or damage to the product.

Store the user manual for further use. Make sure to include this user manual when passing the product on to third parties.

You may contact us at [service@wkfe.com.hk](mailto:service@wkfe.com.hk) for electronic file of IM.

## Proper use

The product is exclusively designed for cleaning carpets. It is only intended for private use and not suitable for commercial purposes.

Only use the product as described in this user manual. Any other use is considered improper and may result in damage to property or persons.

The manufacturer or vendor cannot be held liable for damages or injury incurred through improper or incorrect use.

## Explanation of symbols

The following symbols are used in this user manual, on the product or on the packaging.



This symbol provides you with useful additional information on handling and use.



This symbol identifies appliances that correspond to protection class II.

**IPX4**

The product is protected against water splashing from any angle.



Warranty period: 36 months (3 years)

## Safety

### Signal symbol/word definitions

The following symbols and signal words are used in this user manual.



This signal symbol/word designates a hazard with moderate risk, which may result in death or severe injury if not avoided.



This signal symbol/word designates a hazard with low risk, which may result in minor or moderate injury if not avoided.



This signal word warns of possible damage to property.

### General safety instructions



#### Risk of electric shock!

A faulty electrical installation, excessive line voltage, or incorrect operation may result in an electric shock.

- Only connect the product if the line voltage of the socket corresponds to the data on the rating plate.
- Only connect the product to an easily accessible socket so that you can quickly disconnect it from the mains supply in the event of a problem.
- Do not use the product if it is damaged or if the mains cord or plug is defective.
- If the supply cord is damaged, it must be replaced by the manufacturer, its service agent or similarly qualified persons in order to avoid a hazard.
- Do not open the housing; instead, have a qualified professional perform repairs. Contact a qualified workshop for this. Liability and warranty claims are waived in the event



---

of repairs performed by the user, improper connection or incorrect operation.

- Only parts that comply with the original device data may be used for repairs. This product contains electrical and mechanical parts which are essential for providing protection against sources of danger.
- Do not use the product with an external timer or separate remote control system.
- Do not immerse the product or the mains cord in water or other liquids.
- Never touch the mains plug with wet or damp hands.
- Do not pull the mains plug out of the socket by the cord; instead, always pull it out by the plug itself.
- Never move, pull, or carry the product by its mains cord.
- Keep the product and mains cord away from open flames and hot surfaces.
- Lay the mains cord so that it does not pose a tripping hazard.
- Do not kink the mains cord and do not lay it over sharp edges.
- Only use the product indoors. Do not use the product in damp rooms or in the rain.
- Do not place the product such that there is a risk of it falling into a tub or sink.
- Never reach to retrieve an electrical device if it has fallen into water. In such a case, immediately disconnect the mains plug.
- Never insert any objects into the housing.
- Always switch the product off and unplug it when you are not using it, when you intend to clean it, or in the event of a malfunction.
- **WARNING:** The mains plug must be removed from the mains socket before cleaning or maintaining the product.



## **WARNING!**

**Danger for children and persons with impaired physical, sensory or mental capacities (e.g. partially disabled persons, older persons with reduced physical and mental capacities), or lack of experience and knowledge (e.g. older children).**

- This appliance is not intended for use by persons (including children) with reduced physical, sensory or mental capabilities, or lack of experience and knowledge, unless they have been given supervision or instruction concerning use of the appliance by a person responsible for their safety. Children should be supervised to ensure that they do not play with the appliance. Cleaning and user maintenance should not be made by children without supervision.
- Keep children away from the product and mains cord.
- Do not leave the product unattended while in use.
- Make sure that children do not play with the plastic wrapping. They may get caught in it when playing and suffocate.

## **NOTICE!**

### **Risk of damage!**

Improper handling of the product may result in damage to the product.

- Never expose the product to high temperatures (heaters etc.) or to the effects of the weather (rain etc.).
- Stop using the product if any of the parts are cracked, broken, or deformed. Only replace damaged parts with corresponding original spare parts.
- Do not use the product to suck up any liquid other than the cleaning solution dispensed from it.
- Do not use the product to suck up such wet or damp materials as mud, tile grout, plaster filler, or caulking.
- Do not use the product without the tanks in place.

- Make sure all openings and outlets are free and clear of any blockage that may reduce airflow.
- Keep hair, loose clothing, fingers and other body parts away from the openings and moving parts.
- Do not use the product to suck up flammable or toxic liquids such as gasoline, chlorine bleach or drain cleaner, or use it in areas where they may be present.
- Do not suck up anything that is burning or smoking, such as cigarettes, matches, or hot ashes.

## Checking the product and package contents

### NOTICE!

#### Risk of damage!

If you are not cautious when opening the packaging with a sharp knife or other pointed object, you may quickly damage the product.

- For this reason, be very careful when opening it.
1. Take the product out of the packaging.
  2. Check to make sure that all parts are included (see **Fig. A**).
  3. Check whether the product or individual parts are damaged. If this is the case, do not use the product. Contact the manufacturer via the service address indicated on the warranty card.

## Product assembly



#### Risk of injury!

Improper handling of the product may cause injury.

- Do not connect the product to a mains socket until it is fully assembled.
- Do not operate the product without the handle being firmly screwed into place.

1. Set the product in an upright position.
2. Place the handle **1** firmly onto the main body of the product (see **Fig. B**).  
Make sure that the cord clip **13** is on the same side as the cord hooks **14**.
3. Using a crosshead screwdriver **22**, drive one screw **18** into each side of the handle and fasten them securely (see **Fig. B**).  
Do not overtighten the screws, as this could strip the screw holes.

## Carpet preparation

### NOTICE!

#### Risk of damage!

Using the product as a dry vacuum will damage it.

- Only use the product with an appropriate carpet cleaning solution.
1. Remove as much furniture from the room as possible. Place a plastic or other protective covering under and around any furniture left in the room.
  2. Thoroughly vacuum the carpet to be cleaned with a regular vacuum cleaner.
  3. Dampen a white cloth with the carpet cleaning solution you are going to use with the product.
  4. Rub the cloth gently over a small test area on the carpet and check for any colour bleeding. If the cloth remains clean, it should be safe to clean the carpet.

## Operation

### Filling the water solution tank



#### Risk of injury!

Improper handling of the product may cause injury.

- Always unplug the product before filling the water solution tank.
- Avoid prolonged skin contact with cleaning solutions.

- Keep carpet cleaning solution out of the reach of children.
- In case of contact with eyes, rinse immediately with plenty of water and seek medical advice.

## NOTICE!

### Risk of damage!

Using the product without the water solution tank in place or with a wrong solution may damage the product.

- Always make sure that the water solution tank is properly in place before using the product.
- Do not use any solvents, cleaners with strong acidic or strong alkali formulas, or any type of cleaning solution not specifically for use in carpet cleaning machines.



- Only use suitable (low-foaming) carpet cleaning solution. Using incorrect solutions may cause excess foaming, which will prevent the product from working effectively.
- Carpet cleaning solution is NOT included. Most commercially available low foaming carpet cleaning solutions may be used. Always read the manufacturer's instructions before use.

1. Unplug the product.
2. Lift up on the water solution tank release lever **12** and then remove the water solution tank **11** from the product (see **Fig. C**).
3. Unscrew and then remove the water solution tank cap **3** from the water solution tank.
4. Following the instructions on the bottle, add the cleaning solution and then fill the water solution tank with warm tap water (max. 40 °C / 104 °F).  
Do not fill over the maximum filling line (FULL) **4**.
5. Replace the water solution tank cap.
6. Place the water solution tank back into position by pushing it down until it clicks into place.



Repeat the steps above (except step 4) to empty the water solution tank after use and before storage.

## Cleaning a carpet



- Before cleaning, determine where to start and stop, making sure you will not walk over previously cleaned areas.
- Do not oversaturate the carpet with cleaning solution.
- For heavily soiled areas, additional applications may be necessary.

1. Plug the mains cord **16** into a mains socket and turn the product on by setting the on/off switch **5** to the ON position (**I**).
2. Step on the handle release pedal **17** to lower the handle **1** into the cleaning position (see **Fig. D**).
3. While pressing the solution release trigger **2**, pull the product in a backwards direction towards you.
4. Release the solution release trigger and push the product forwards in the same path to remove the dirty cleaning solution from the carpet.
5. Repeat steps 3–4 to clean other parts of the carpet or heavily soiled areas.
6. When cleaning is done, turn the product off by setting the on/off switch to the OFF position (**O**).
7. Push the handle forwards until it is positioned upright and locked into place.
8. Unplug the product and wrap the mains cord around the cord hooks **14**.

## Tips for carpet cleaning

- Use the carrying handle **15** to lift up the product and move it to the desired cleaning location.
- Do not run the product over the mains cord **16** by holding any excess cord in your free hand while cleaning.
- Use a steady, moderate, forwards and backwards motion.
- Always work from back to front across a room to avoid stepping on wet carpet.
- Do not make the carpet too wet. Use no more than two sets of forwards and backwards strokes while releasing carpet cleaning solution. Always follow with dry strokes; the more dry strokes the better.
- Wipe any cleaning solution from woodwork and furniture to prevent any damage.
- Allow plenty of time for the carpet to dry and avoid walking on it until it is dry.
- Increased air circulation (open doors, fans, etc.) or the use of a dehumidifier will help the carpet dry thoroughly and prevent the growth of mold or mildew.
- Vacuum the carpet thoroughly before cleaning it and after it has dried.

## Emptying the dirty water tank

**CAUTION!**

### Risk of injury!

Improper handling of the product may cause injury.

- Always unplug the product before emptying the dirty water tank.



An automatic shut-off device prevents the product from picking up more dirty water than the dirty water tank can hold. You will know the dirty water tank needs to be emptied when:

- the motor sound rises in pitch,
- the dirty solution has reached the FULL line **6** in the dirty water tank.

1. Unplug the product.
2. Unlock the dirty water tank **7** by pressing the dirty water tank locking latch **10** and lifting up the dirty water tank handle **9** at the same time (see **Fig. E**).
3. Remove the dirty water tank from the product.
4. Open the dirty water tank cap **19** by turning it anticlockwise, so the grip points to the word “unlock” (see **Fig. F**).
5. Empty the dirty water tank, replace the dirty water tank cap and turn it to the “lock” position. Then place the dirty water tank back into the product (see **Fig. G**).
6. Push the dirty water tank handle down until the dirty water tank locking latch clicks into place.

## Cleaning

**CAUTION!**

### Risk of injury!

Improper handling of the product may cause injury.

- Always unplug the product when not in use, refilling the tanks, cleaning it, or performing maintenance.

**NOTICE!**

**Risk of damage!**

Improper handling of the product may result in damage.

- Do not use any aggressive cleaners, brushes with metal or nylon bristles, or sharp or metallic cleaning utensils such as knives, hard scrapers and the like. They could damage the surfaces.
- Never immerse the motor unit in water or any other liquids and do not rinse it under the tap or with a hose.

**Cleaning the filters**

**NOTICE!**

**Risk of damage!**

Improper handling of the product may result in damage.

- Do not clean the filters with any chemicals as this will destroy them.
1. Remove the dirty water tank **7** as described in the chapter “Emptying the dirty water tank”.
  2. Remove the exhaust filter housing **8** from the dirty water tank (see **Fig. H**).
  3. Pull out the filter **20** from the exhaust filter housing (see **Fig. I**).
  4. Rinse the filter with warm water (max. 40 °C / 104 °F). Allow the filter to dry thoroughly.
  5. Replace the filter and put the exhaust filter housing back into the dirty water tank.
  6. With the dirty water tank still removed, pull out the motor filter **21** (see **Fig. J**).
  7. Rinse the motor filter with warm water. Allow the motor filter to dry thoroughly.
  8. Replace the motor filter and put the dirty water tank back into the product as described in the chapter “Emptying the dirty water tank”.



## Cleaning the product

1. Unplug the product.
2. Make sure the water solution tank **11** and the dirty water tank **7** are empty (see chapter “Filling the water solution tank” and “Emptying the dirty water tank”).
3. Use a soft damp cloth to wipe off the product and accessories. Then let all parts dry completely.

## Storage

### NOTICE!

### Risk of damage!

Mineral deposits and mildew can form when cleaning solution and/ or water is left in the tanks, affecting the performance of the product.

- Do not store the product with cleaning solution left in the water solution tank or dirty water left in the dirty water tank.

All parts must be completely dry before being stored.

- Always store the product in a dry area.
- Protect the product from direct sunlight.
- Store the product so that it is not accessible to children.

## Troubleshooting

Some problems may be caused by minor faults that you can fix yourself. To do so, follow the instructions in the following table. If it is still not possible to resolve the problem, contact customer service. Do not repair the product yourself.

Problem	Solution
The product will not operate.	<ul style="list-style-type: none"> <li>– Make sure the product is plugged in.</li> <li>– Make sure that the mains socket is not defective.</li> </ul>
Not enough suction during cleaning.	<ul style="list-style-type: none"> <li>– Empty the dirty water tank; it may be full and the automatic shut-off engaged.</li> <li>– Make sure the dirty water tank is properly installed.</li> </ul>
Cleaning solution will not dispense.	<ul style="list-style-type: none"> <li>– Make sure the water solution tank is fully inserted and securely in place.</li> <li>– Refill the water solution tank if it is empty.</li> </ul>

## Technical data

Model:	VC9385S
Power supply:	230 V~ 50 Hz
Output:	600 W
Protection class:	II □
IP code:	IPX4
Water solution tank capacity:	1.6 L to FULL line (max. capacity 2.3 L)
Dirty water tank capacity:	1.8 L to FULL line (max. capacity 2.5 L)
Product code:	99650

## Disposal

### Disposing of the packaging

- Sort the packaging before you dispose of it. Dispose of paperboard and cardboard with the recycled paper service and wrappings with the appropriate collection service.

### Disposing of the product

- Should the product no longer be capable of being used at some point in time, **dispose of it in accordance with the regulations in force in your city or county.**
- Please ensure your recycling information applies to the local regulations.



## Carpet Cleaner

# Warranty Details

---

REGISTER YOUR PURCHASE AT [www.aldi.com.au/en/about-aldi/product-registration/](http://www.aldi.com.au/en/about-aldi/product-registration/)  
TO KEEP UP-TO-DATE WITH IMPORTANT PRODUCT INFORMATION

---

The product is guaranteed to be free from defects in workmanship and parts for a period of 36 months from the date of purchase. Defects that occur within this warranty period, under normal use and care, will be repaired, replaced or refunded at our discretion. The benefits conferred by this warranty are in addition to all rights and remedies in respect of the product that the consumer has under the Competition and Consumer Act 2010 and similar state and territory laws.

Our goods come with guarantees that cannot be excluded under the Australian Consumer Law. You are entitled to a replacement or refund for a major failure and for compensation for any other reasonably foreseeable loss or damage. You are also entitled to have the goods repaired or replaced if the goods fail to be of acceptable quality and the failure does not amount to a major failure.

---

### AFTER SALES SUPPORT

☎ 1800-898 750

💻 [service@wkfe.com.hk](mailto:service@wkfe.com.hk)

**3**  
**YEARS**  
**WARRANTY**



## Carpet Cleaner

# Repair and Refurbished Goods or Parts Notice

---

REGISTER YOUR PURCHASE AT [www.aldi.com.au/en/about-aldi/product-registration/](http://www.aldi.com.au/en/about-aldi/product-registration/)  
TO KEEP UP-TO-DATE WITH IMPORTANT PRODUCT INFORMATION

---

Unfortunately, from time to time, faulty products are manufactured which need to be returned to the Supplier for repair.

Please be aware that if your product is capable of retaining user-generated data (such as files stored on a computer hard drive, telephone numbers stored on a mobile telephone, songs stored on a portable media player, games saved on a games console or files stored on a USB memory stick) during the process of repair, some or all of your stored data may be lost.

**We recommend you save this data elsewhere prior to sending the product for repair.**

You should also be aware that rather than repairing goods, we may replace them with refurbished goods of the same type or use refurbished parts in the repair process.

**Please be assured though, refurbished parts or replacements are only used where they meet ALDI's stringent quality specifications.**

If at any time you feel your repair is being handled unsatisfactorily, you may escalate your complaint. Please telephone us on 1800-898 750 or write to us at:

Install + Fix Solutions

Unit 1, 9 Kingsbury Street, Brendale QLD 4500, AUSTRALIA

1800-898 750 (08:30 am–6:00 pm AEST)

[service@wkfe.com.hk](mailto:service@wkfe.com.hk)

---

### AFTER SALES SUPPORT

☎ 1800-898 750

💻 [service@wkfe.com.hk](mailto:service@wkfe.com.hk)

**3**

**YEARS  
WARRANTY**

ALDI guarantees that our exclusive brand products are developed to our stringent quality specifications. If you are not entirely satisfied with this product, please return it to the nearest ALDI store within 60 days from the date of purchase, for a full refund or replacement, or take advantage of our after sales support by calling the supplier's Customer Service Hotline.



### Made in China

EASY HOME® is a registered trademark of ALDI Stores

DISTRIBUTED BY:

ALDI STORES

1 SARGENTS ROAD

MINCHINBURY NSW 2770

[www.aldi.com.au](http://www.aldi.com.au)

#### AFTER SALES SUPPORT

99650 



 **1800-898 750**



**[service@wkfe.com.hk](mailto:service@wkfe.com.hk)**

MODEL:  
VC9385S

03/2020

**3**  
YEARS  
WARRANTY