



Natures Composites

Sustainable Outdoor Living



Visit our resources page
for more information



MODERN SEMI-PRIVACY HORIZONTAL FULL SIZE FENCE INSTALLATION GUIDE

Our products and/or processes are protected by the following patents, as well as other patents that are pending: US 11,053,707; US 12,110,703; US 12,084,880. For any further information or questions please visit www.naturescomposites.com or call us at (307) 338-2608.

MODERN SEMI-PRIVACY HORIZONTAL FULL FENCE

**please note hardware kit is included
in-between U-Posts in box*

**Watch out for
green boxes for
our Frequently
Asked
Questions!**

COMPONENTS

ITEM	QTY	DESCRIPTION	NC PART
Complete Product		Composite Modern Horizontal Semi-Privacy Full Size Fence (3.5' x 6')	100301XX60600
A	2	U-Channel Post 2.5" X 2.5" X 94"	300722XX094
B	2	Sliding Top Cap	200721BK00000
C	1	Top Cable Assembly	200030GV06900
D	2	Post Depth Stick	ACPC POST DEPTH STICK
E	9	Square Edge Board 43" X 6" X 7/8"	300341XX043
F	16	NC Spacers (1 1/2 inches)	200723XX0000
G	4	#8 1-5/8" Truss Head Screws (only to be used when screwing two panels together!)	ACSCR#8X1-5/8BRONXETRUS
H	1	Board Stop Assembly (Pre-Installed)	200720BK00000
I	2	1 5/8 Torx Composite - Top Cap Screw	TOP CAP SCREW
J	32?	Velcro Dots	?????

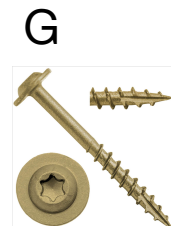
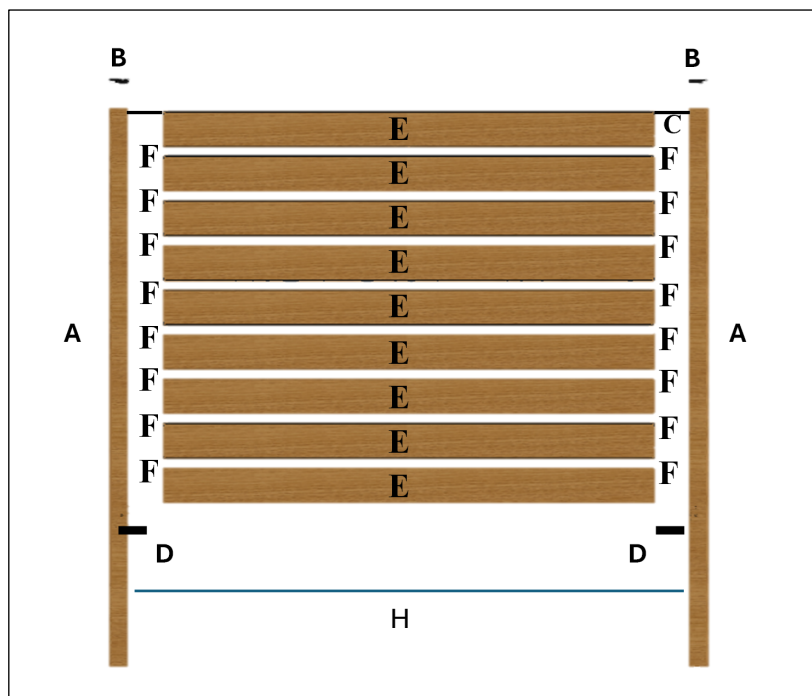

BEFORE YOU BEGIN

Verify Underground Utilities

Use aids such as local building departments, utility companies, or utility location services to ensure the area is free from underground lines or hazards.

1. **Locate Property Lines**
Ensure the fence is installed within your property boundaries to avoid encroachment and comply with legal requirements.
2. **Consult Local Building Codes**
Review local codes to ensure the fence and gate installation meets all requirements. Obtain any necessary permits before starting the installation.
3. **Wear Appropriate Safety Equipment**
Always wear gloves, safety goggles, and work boots to avoid injuries during installation.

FENCE LOCATION

1. **Mark the Fence Layout:** Use stakes and a string line to outline the fence location. The string helps ensure the fence remains straight during installation.
2. **Locate Gate Placement:** Mark the post hole locations for gate posts according to the gate installation instructions.
3. **Mark Corners and Ends:** Identify the locations of corner and end posts.
4. **Mark Intermediate Fence Posts:** Posts should be placed no wider than **69 inches (5.75 feet)** between posts for each fence panel.

TOOLS REQUIRED

Tools for Preparing the Fence and Post Burial

- Tape Measure
- Post Hole Digger & Shovel
- **Post Bubble Level** (for ensuring posts are vertically aligned at 90 degrees)
- Level and String Line
- Wheelbarrow
- Stakes or Markers
- **Torx T20 Bit** (for fastening the self-drilling composite screws provided by NC for both securing the posts and attaching the post cap)
- We recommend using a **power tool** for both operations to ensure proper installation of the fasteners.

How should I space my posts if I'm adding a gate?

To add a gate, you must use two NC 5x5 Commercial Posts—standard posts will not support the weight. The gate is 48" wide, and each 5x5 post is 5.5" wide, so space them 59" apart (outside to outside). This ensures proper hinge and latch function. For extra strength, insert a 4x4 treated wood post inside each composite post, ensuring they function correctly and reducing the risk of operational issues caused by restricted hardware space.

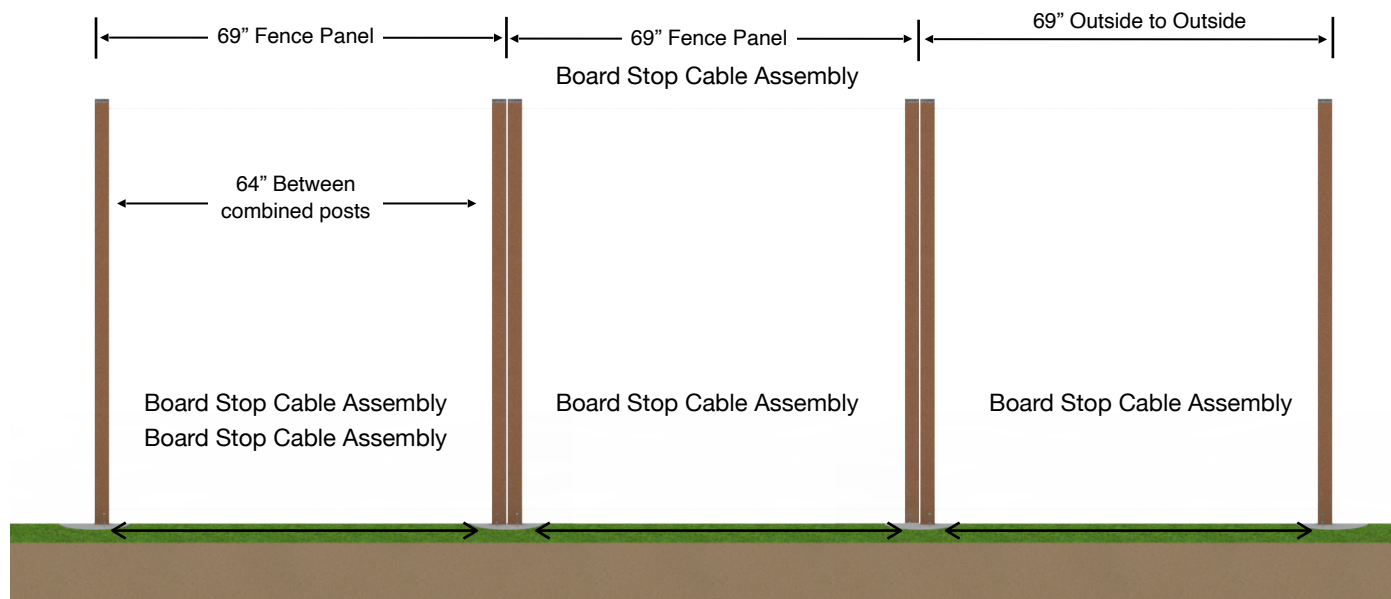

Understanding Your Posts

The **NC patented Universal Post System** is designed for maximum flexibility. Unlike traditional systems that require specific post types (start/end posts, line posts, and corner posts), the NC Modern system uses a **single, versatile U-channel post** that can be adapted for any configuration, simplifying the ordering process and providing flexibility during installation.

Each NC panel system includes **two U-channel posts**, designed with features for smooth installation:

- **Board Stop:**

Each post comes with a **pre-installed board stop**. This helps maintain the correct spacing between boards and ensures that the last board is aligned correctly, leaving just enough room for the installation of the Top Cap.

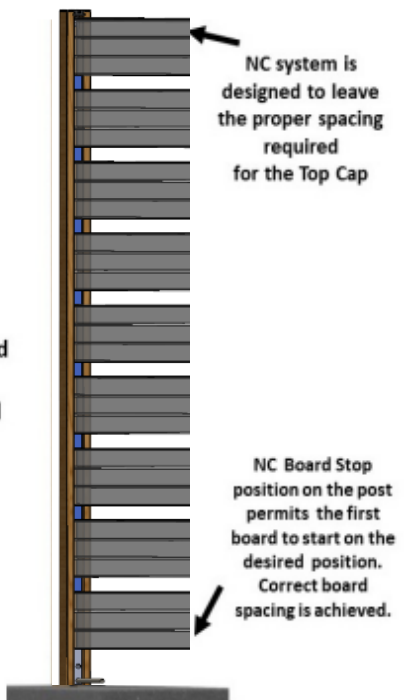
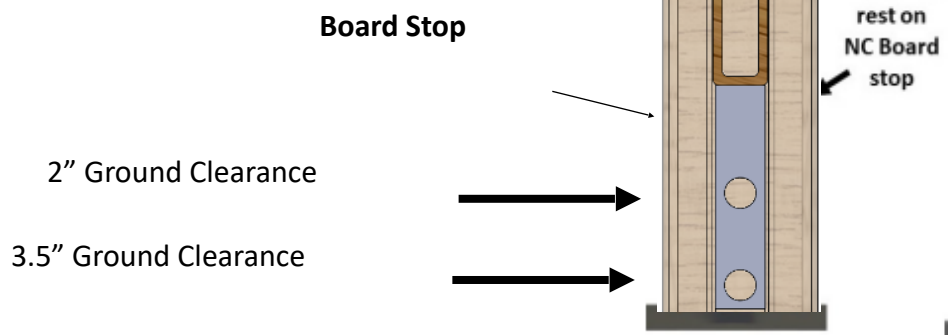

- **Grooves at the Top:**

The posts have **grooves at the top** to accommodate the **Top Cable Fastener** during installation. These grooves also serve as the attachment points for the **Top Cap**, which finalizes the installation and gives the fence a finished look.



TOP CABLE

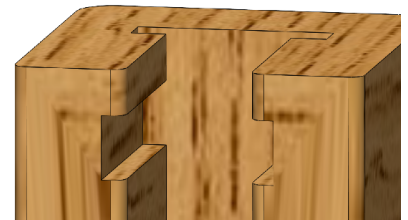

TOP CAP

Can I paint my fence?

No! Painting is not advisable. Our products come pre-finished with durable, lasting color and a textured, non-reflective surface. They're designed to maintain their appearance without the need for painting, staining, or sealing—just occasional cleaning with soap and warm water.

Do I need to buy a line, corner and start/end post?

No! Our patented U-Post system is designed for ultimate versatility, allowing you to use the same post for corners, line posts, and start/end posts with ease. This simplifies installation and reduces the number of different components

Prepare Your Posts

For **Multiple Panel Sections**:

- **Note:** When installing multiple panels, bolt the posts together before the burial process. This ensures proper alignment and simplifies installation.

Procedure for Line Sections, Corner Posts, and End/Gate Posts:

The **NC system** uses a patented design with a **versatile U-channel post**. The **5 composite screws** provided should be used to assemble the posts in the desired configuration. We recommend using a **Torx T20 Bit** and power tool for faster, secure assembly:

- **For Line Sections:** Install two U-channel posts **back-to-back** to seamlessly connect panels.
- **For Corner Posts:** Install two U-channel posts **adjacent to each other**, ensuring correct orientation for corners.
- **For Start/End or Gate Posts:** Install a **single U-channel post** at the start, end, or gate section.



Line Post



Corner Post



End Post

Screw the Adjacent U-Channel Posts Together

If you are placing panels next to the other it is important to screw the posts together for maximum stability. Use the included four #8 1-5/8" Truss Head Screws (G) to secure the U-Post (A).

1. Place the first screw (G) toward the top of the inside of the U-Post (A). Make sure it is below the siding top cap routing!
2. Place the second screw (G) toward the bottom of the U-Post (A) just above your grade line.
3. Place the other two screws evenly between the top and bottom as pictured on the right.

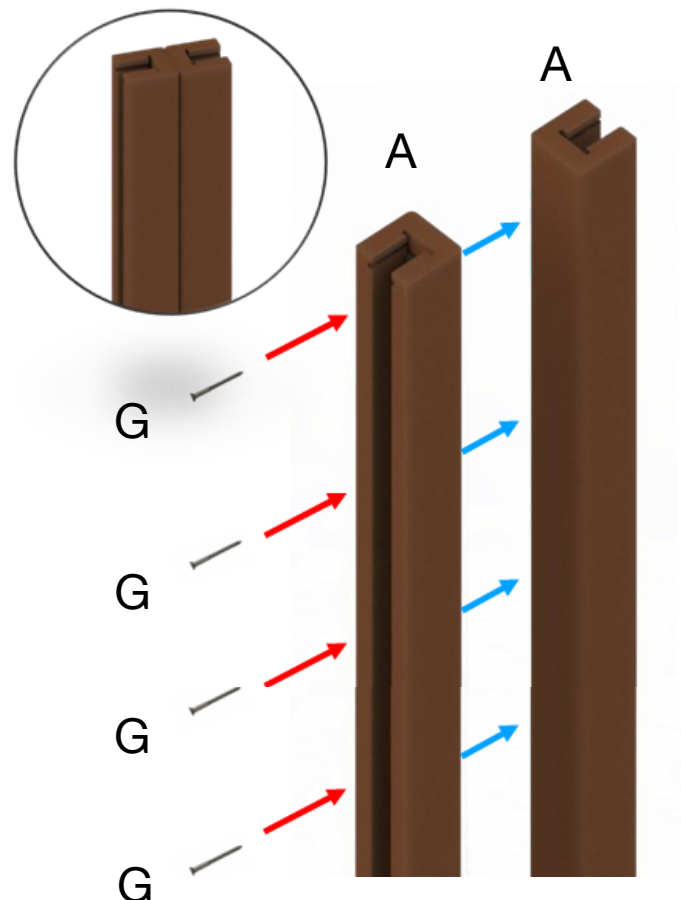

Precise Post Spacing for Installation

NC Top Cable Solution

Another patented feature of the NC system is the **Top Cable Assembly (C)**, which ensures precise post spacing during installation.

1. Precise Post Spacing During Installation

- The **Top Cable system (C)** consists of two H-type fasteners and a **69-inch cable** connecting them. This ensures the precise spacing required for the fence panels to function properly.
- **Install the Top Cable before the burial process:** Insert the H-shaped fasteners into the grooves of the U-shaped posts. Spread the posts apart until the cable is **fully extended**. This keeps the posts aligned and properly spaced during this critical stage. the posts are spaced at exactly **69 inches**.

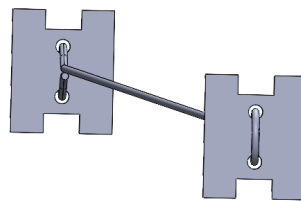

2. Maintaining Post Alignment During Curing

The **Top Cable Fastener** should remain in place throughout the concrete curing process. This keeps the posts aligned and properly spaced during this critical stage.

Note: The Top Cable Fastener is essential for maintaining the correct spacing for the free-floating board system, allowing the boards to move slightly without binding or falling out.

- **If Spacing is Too Short:** Boards will not fit correctly between the posts.
- **If Spacing is Too Wide:** Boards may become loose and potentially fall out of the channels.

Post Installation

1. Dig Post Holes to the Correct Depth

Dig **12-inch diameter holes** at least **25.5 inches deep** to ensure proper stability when burying posts **25.5 inches**.

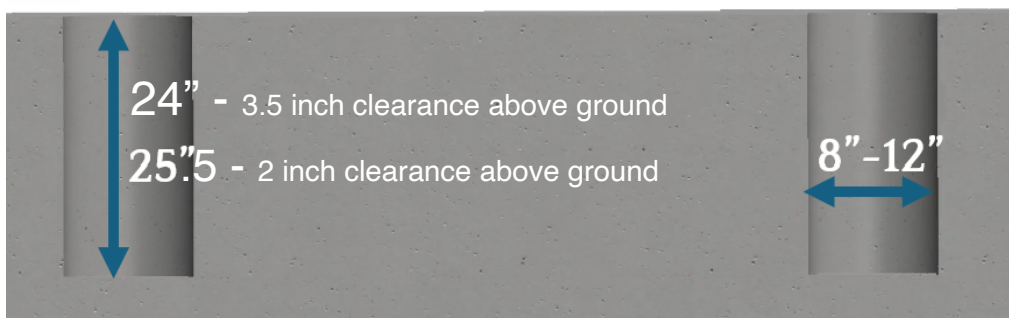

2. **Add Gravel for Drainage**

Pour 6 inches of gravel into the bottom of each post hole to improve drainage and ensure long-term stability.

3. **Set the Posts in Concrete: Two Critical Factors to Monitor**

When setting the posts in concrete, monitor two critical factors to ensure the correct installation:

3.1 Precise Post Spacing:

Use the NC Top Cable Fastener to ensure posts are spaced correctly at 69 inches. Before pouring the concrete, ensure that the Top Cable is fully extended to lock the posts in place at the correct distance, allowing proper fence panel installation. Keep the Top Cable tensioned throughout the curing process to prevent any movement or misalignment of the posts.

3.2 Ground Clearance:

Ground clearance is essential for the proper function and appearance of the fence. The NC system includes a Post Depth Stick, which provides a visual guide to ensure posts are buried to the correct depth, allowing for the intended ground clearance: If the Post Depth Stick is installed in the bottom cavity, the ground clearance will be 3 1/2 inches. If installed in the top cavity, the ground clearance will be 2 inches.

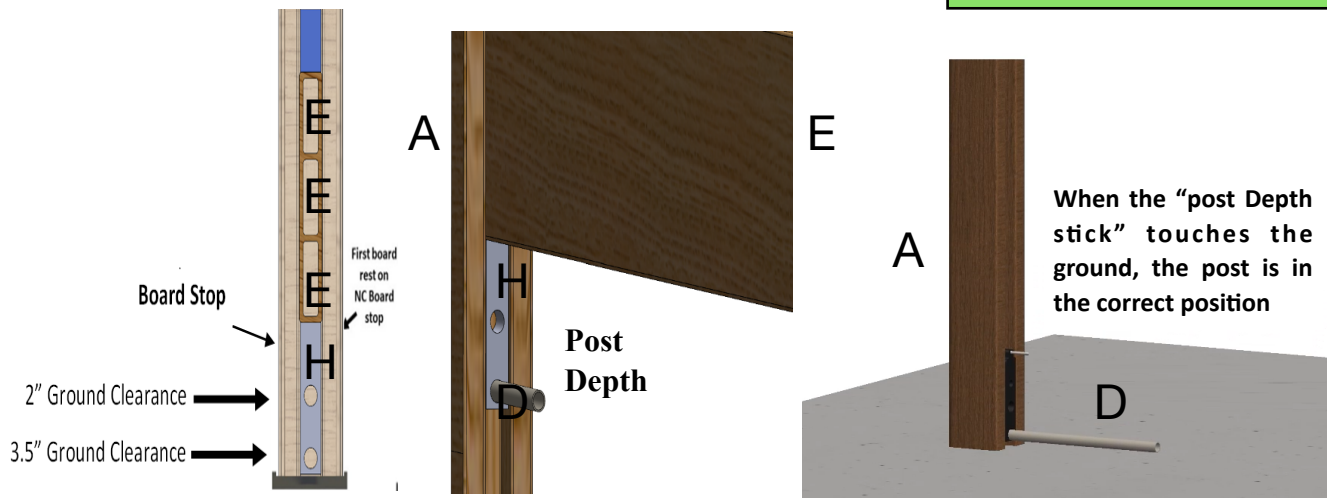

Can I cut my fence to adjust the length?

Yes, our proprietary wheat-based composite formula can be cut just like wood using standard wood-cutting tools. When cutting a fence panel or ranch rail down, make sure to cut all boards at the same place to avoid creating an uneven alignment. First, you must remove the bottom cable by cutting it at the board stop. Then, once the panel is cut to your desired length, you will also need to adjust the Top Cable Assembly, which helps keep the posts plumb and properly spaced. To do this, cut the top cable to the desired length and remove the top cable bracket at the end, as it will need to be replaced. You will need to purchase an aluminum ferrule and stop set to reattach the shortened cable, ensuring it functions correctly. You can reattach it by hitting it with a hammer to crimp it back into place. Following these steps will help maintain proper spacing and stability during your fence installation.

Lower the post into the ground until the **Post Depth Stick** touches the surface. This ensures that the post has been buried to the correct depth. If the terrain is uneven, ensure that both posts are at a consistent depth and aligned horizontally. Use a **Post Bubble Level** to check for vertical alignment.



3. **Maintain Proper Post Alignment and Spacing**

Keep the **Base Cable Assembly** taut to ensure the posts remain correctly spaced. Additionally, continue to use the **Top Cable Fastener** to maintain proper post alignment during the curing process.

4. **Allow the Concrete to Cure**

Allow the concrete to cure for **24-48 hours** before proceeding with installation.

Fence Board Installation

The **NC system** comes pre-assembled with a **Board Stop (H)**, which ensures correct spacing for the boards.

1. **Install Bottom Square Edge Board (E)**

- Hold the bottom board at an angle and insert one end into the U-shaped post. Rotate the other end into the opposite post.
- Push the board down until it rests against the **Board Stop Assembly**.

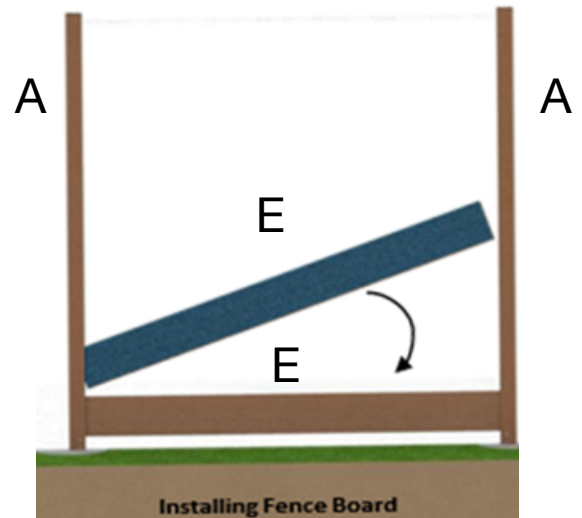

2. **Install NC Spacer with Velcro Dots**

- After you add the first board, attach two Velcro dots (J) to the unfinished side of one NC Spacer (F).
- Position the spacers so it is properly touching the Square Edge Board (E) and secured in place within the U-channel Post (A).
- Repeat on both sides.

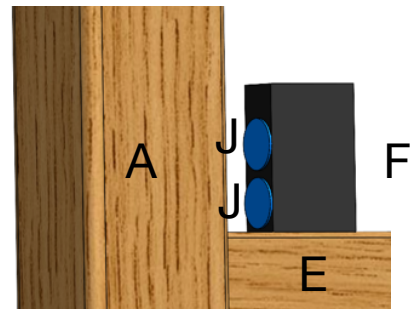

3. **Continue Adding Square Edge Boards and Spacers with Velcro Dots**

Repeat the process with each **Square Edge 1x6 Board**, using the spacers to maintain alignment.

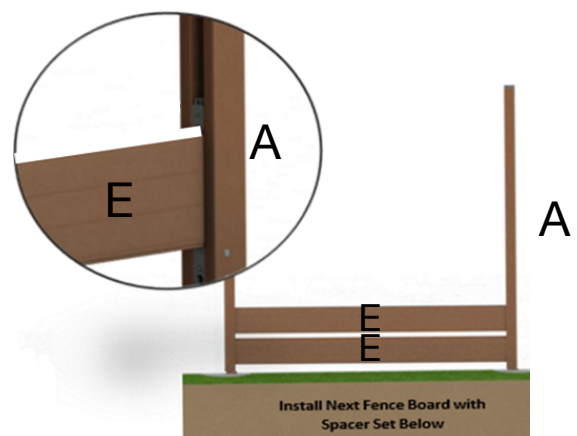

4. Install the Top Cable (C) Inside the Top Cavity of the Last Board

- Before installing the last board, insert the **H-shaped fasteners** attached to the **Top Cable (C)** into the top cavity of the board. Once secured, slide the last board into place.

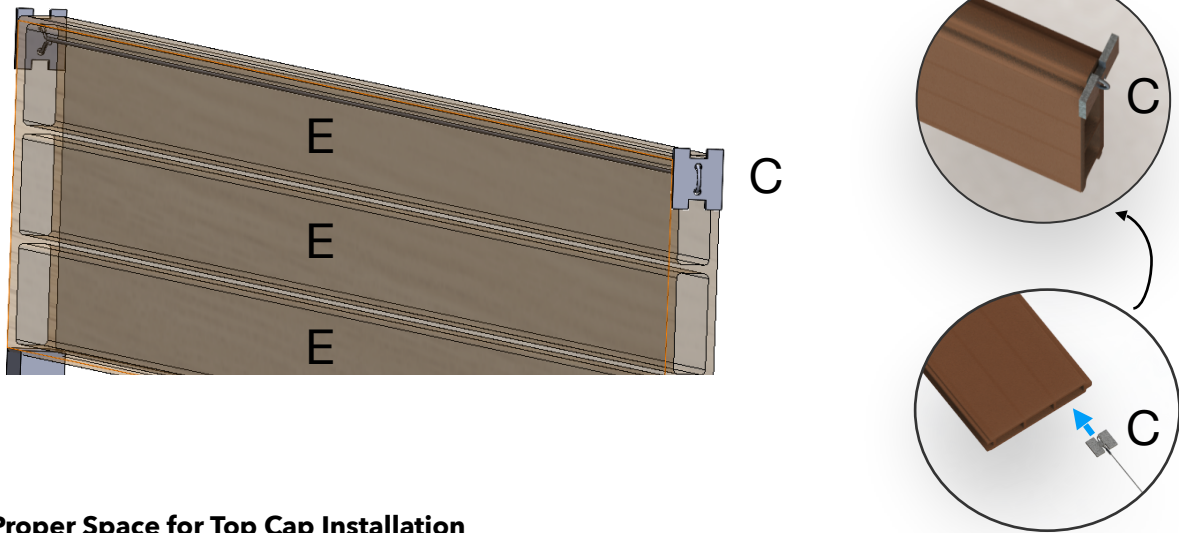

5. Ensure Proper Space for Top Cap Installation

After the last board is installed, ensure a proper gap for installing the **Top Cap (B)**.

Top Cap Installation

- Slide the Top Cap (B) into the Top Cap Routed space on the top of the U-Channel Post (A).
- Fasten the Top Cap (B) using one of the provided 1-5/8 Torx Composite Screws (I) with a Torx T20 Bit and power tool.
- Repeat for both U-Channel Posts (A).

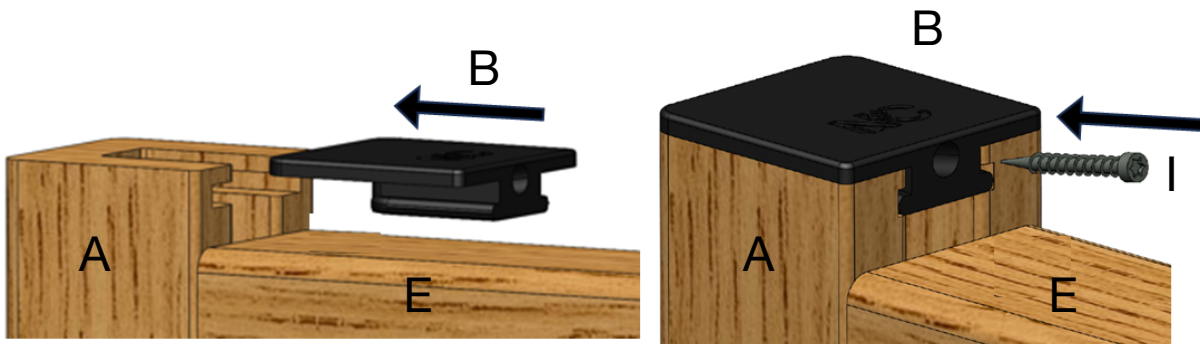

Our products and/or processes are protected by the following patents, as well as other patents that are pending: US 11,053,707; US 12,110,703; US 12,084,880

For any further information or questions please visit www.naturescomposites.com or call us at (307) 338-2608