



Mini Cordless Rotary Tool

Operator's Manual



Thank you for purchasing this product. To ensure proper use and trouble-free operation, please read this guide carefully before operating. If there is any issue, please contact us via Amazon or email: hardell.service@gmail.com, we will help you within 12 hours.



Product Descriptions

Components



- 1.Chuck(Range-1.6/2.3mm)
2. Spindle Locking Button (**DON'T press it when. the device is running**)
3. Speed Indicator(5500/8100/ 10800/12900/ 15000rpm)
4. Type-C USB Charging Port
5. Heat Dissipation Holes (Dissipate the heat produced by the motor operation)
- 6.Speed Control Button(5-level rate)

Specification

INPUT: 3.7V

Battery: 600mAh Li-Ion

No Load Speed:5500-15000r/min

Speed Settings: 5

Collet Size: \varnothing 1.6/2.3mm

Charge time: 1hours (Full charged,all indicator lights turn purple)

Do not wait until the tool is completely dead before plugging it in. If the battery is dead, do not try to press the power button. This will damage the battery instead.

Please full charge the main device before using



1.When charging, the indicator blinks successively.



2.When full charged, all lights turn purple

Package Includes

Sanding/Cleaning



Sanding Bands X20

Sanding Drum Mandrel X1

2.3mm X1

Grinding



Stone Grinding Bit X5

2.3mm X1

Drilling



Hss Twist Drill X2

1.6mm X1

Engraving / Carving



Diamond Bits X5

2.3mm

Polishing



Polishing wheel X2

2.3mm

Cleaning



Nylon Brush X2

2.3mm

Tool Box

USB Cable

Accessory Case

Spanner

X1

X1

X1

X1

NOTE: The product contains a total of 4 collets, Size: 1.6/2.3mm
Usually, there is already a 2.3 mm collet on the rotary tool

How to Use

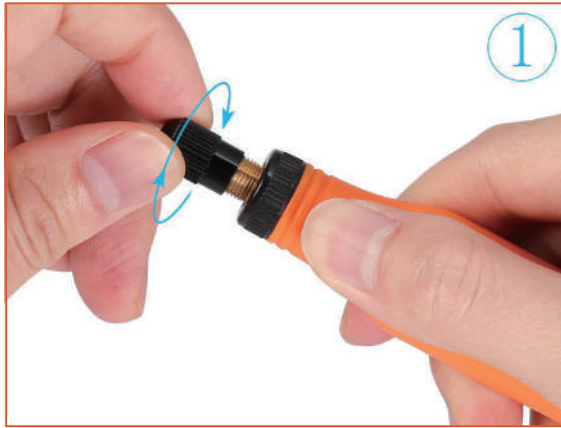

1. Press down the spindle locking button and unscrew the nut



2. Choose the suitable collet and put the black nut

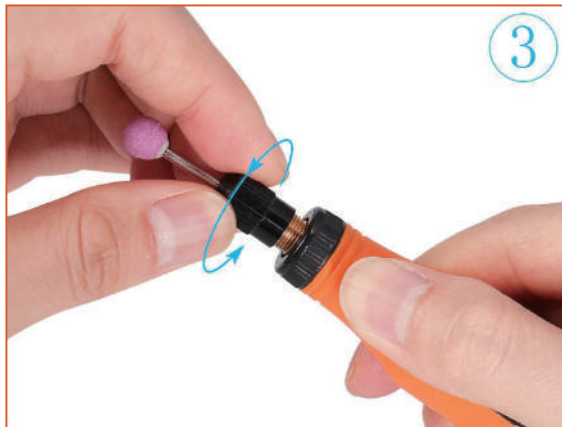

3. Insert the bits you need, hold the lock button and screw on the nut tightly.



4. Release the spindle locking button.

ATTENTION: Different accessories fit different collets, If the accessories come off easily, please replace another suitable collet.



How to fit a sanding band

1. Align the sanding drum and band
2. Press the band into the drum and twist the top of the drums crew to adjust the tightness

Widely Application

Function	Types of Artworks for Creation
Sanding	Suitable for sanding work on Softwood/ Aluminum/ Plastic/ Brass/ Stone/ Shell/ Ceramic etc.
Grinding	Suitable for grinding work on Aluminum/ Steel/ Brass/ Stone/ Shell/ Ceramic etc.
Engraving / Carving	Expertise in engraving on Glass/ Soft Wood/ Aluminum/ Plastic/ Brass/ Stone /Shell/ Ceramic etc.
Drilling	Suitable for drilling on Softwood/ Aluminum/ Plastic / Shell/ Jadeite/ Agate/ Jade etc.
Polishing	Suitable for polishing on Glass/ Soft Wood/ Aluminum/ Plastic/ Brass/ Stone/ Shell/ Ceramic etc.
Cleaning	Suitable for cleaning on Glass/ Soft Wood/ Aluminum/ Plastic etc.

ATTENTION: Not for Heavy-duty Projects !!!



Safety Instructions

1. Keep this product away from children.
2. Keep this product away from water.
3. Do not touch it with wet hands.
4. Do not place the product on hot surfaces, near hot surfaces, or an open fire.
5. Please disassemble the equipment under professional guidance.
6. Do not hold the work by hand or against your body and may lead to loss of control.
7. Do not force tool.
8. Do not use tools if the switch does not turn that on or off.
9. Maintain tools with care. Keep cutting tools sharp and clean.
10. Check for misalignment or binding of moving parts, breakage of parts.
11. Use only accessories that are recommended by the manufacturer for your model.
12. Use this power tool and accessories following the instructions.

Warranty

The product supports a 1-year warranty from the date of purchase. This warranty does not apply to products that have been lost, altered, broken, or damaged by misuse or failure to follow the instruction provided with the product. Never try to repair the product by yourself. For any inquiries concerning our products, please contact our after-sales team via hardell.service@gmail.com, we are free to help you solve your problem anytime.