

VEVOR[®]

TOUGH TOOLS, HALF PRICE

Technical Support and E-Warranty Certificate www.vevor.com/support

ICE MACHINE

MODEL:LB100T/LB160T/LB200T/LB265T

We continue to be committed to provide you tools with competitive price.

"Save Half", "Half Price" or any other similar expressions used by us only represents an estimate of savings you might benefit from buying certain tools with us compared to the major top brands and does not necessarily mean to cover all categories of tools offered by us. You are kindly reminded to verify carefully when you are placing an order with us if you are actually saving half in comparison with the top major brands.

VEVOR®

TOUGH TOOLS, HALF PRICE

ICE MACHINE

MODEL:LB100T/LB160T/LB200T/LB265T



LB100T



LB160T/LB200T



LB265T

NEED HELP? CONTACT US!

Have product questions? Need technical support? Please feel free to contact us:

Technical Support and E-Warranty Certificate
www.vevor.com/support

This is the original instruction, please read all manual instructions carefully before operating. VEVOR reserves a clear interpretation of our user manual. The appearance of the product shall be subject to the product you received. Please forgive us that we won't inform you again if there are any technology or software updates on our product.

IMPORTANT SAFEGUARDS



WARNING: Read all safety warnings, instructions, illustrations and specifications provided with this electric appliance. Failure to follow all instructions listed below may result in electric shock, fire and/or serious injury.

	This is the safety alert symbol. This symbol alerts you to potential hazards that can kill or hurt you and others. All safety messages will follow the safety alert symbol and the word “WARNING” or “CAUTION”. These words are defined as:
	Indicates a hazardous situation which, if not avoided, could result in death or serious injury
	Indicates a hazardous situation which, if not avoided, could result in minor or moderate injury.
	CORRECT DISPOSAL This product is subject to the provision of European Directive 2012/19/EU. The symbol showing a wheeled bin crossed through indicates that the product requires separate refuse collection in the European Union. This applies to the product and all accessories marked with this symbol. Products marked as such may not be discarded with normal domestic waste, but must be taken to a collection point for recycling electrical and electronic devices.



ICE CAN'T BE STORED IN THE ICE BIN DURING NIGHT TIME, IT'S NOT FRIDGE, ICE WILL BE MELTED INTO WATER AND FLOW OUT OF THE MACHINE.

WARNING



During using, service and disposal the appliance, please pay attention to symbol similar as left side, which is located on rear of appliance (rear panel or compressor) and with yellow or orange color. It's risk of fire warning symbol. There are flammable materials in refrigerant pipes and compressor. Please be far away fire source during using, service and disposal.

WARNING

To reduce the risk of fire, explosion, electric shock, exposure to UV radiation, or injury when using your ice maker, follow these basic safety precautions:

- This product must be properly installed and located in accordance with the Installation instructions before it is used.
- When using electrical appliances, basic safety precautions should be followed to reduce the risk of fire, electric shock and injury to persons or property. Read all instructions before using any appliance.
- High humidity environment will increase the risk of short circuit or electric shock. If in doubt, please cut off the power supply of the ice maker.
- Do not exceed power outlet ratings. It is recommended that the ice maker is connected to its own circuit. Use only standard electrical supply that is properly grounded in accordance with the National Electric Code and local codes and ordinances.
- If the ice maker is brought indoors from outdoors during the wintertime, give it a few hours to warm up to room temperature before plugging to power source.
- Do not store explosives, such as combustion-supporting sprays in the appliance.
- The machine is intended to be used in household and similar applications such as:

- kitchen areas in shops, offices and other working environments;
- farm houses
- by clients in hotels, motels and other residential type environments;
- Catering industry and similar non-retail industry.

● This appliance can be used by children aged from 8 years and above and persons with reduced physical, sensory or mental capabilities or lack of experience and knowledge if they have been given supervision or instruction concerning use of the appliance in a safe way and understand the hazards involved. Children shall not play with the appliance. Cleaning and user maintenance shall not be made by children without supervision.

● Avoid direct sunlight and make sure that The machine should be used in the household and without obstacles surrounded, good ventilation place. There is must be 30cm at least between the four sides of the machine with the wall.

● Do not tip the machine over.

● We do not recommend the use of an extension cord, as it may overheat and become a risk of fire.

● Don't use any liquid other than water in the unit to make the ice.

● Do not store or use flammable vapors or liquids near this product.

● Do not allow children to climb, stand or hang on the ice maker. They could seriously injure themselves.

● Do not use with water that is microbiologically unsafe or of unknown quality.

● To avoid risk of injury, place power cord in such a way it cannot be pulled on by children or cause a tripping hazard.

● Place power cord in such a way that it is not in contact with hot surfaces.

● Do not operate if any component, including the cord or plug, is damaged.

● Unplug the product before cleaning or repairing, and when not in use.

(Note: If the machine needs repair, it is strongly recommended that it be operated by professionals. Type Y attachment: If the supply cord is damaged, it must be replaced by the manufacturer, its service agent or

similarly qualified persons in order to avoid a hazard.)

- Do not immerse any part of the product in water.
- Do not plug or unplug product with wet hands.
- Do not place the power cord on carpet or other heat sources
- Do not attempt to disassemble, repair, modify, or replace any part of your product.
- Use this product only for its intended purpose as described in this user manual.
- If the power cord is damaged, it must be replaced by the manufacturer or similar professionals in order to avoid danger.
- Do not use any accessories not recommended by the manufacturer.
- The foaming materials inside is combustible which must be kept away from fire.
- It's forbidden to pull the cable to unplug the plug, pull the plug is a must.
- Except for the method recommended by the manufacturer, no mechanical tools or other methods shall be used to accelerate the defrosting process. Do not damage the refrigeration circuit.
- There are high-pressure, flammable and explosive refrigerants in the compressor. Do not damage the refrigeration system. Care or repair should be carried out by professionals. Be especially careful when installing and transporting.
- There are heat insulation materials in the ice maker, which are combustible materials, and must be kept away from fire sources. Repairs must be carried out by the manufacturer or professionals. Scrap must be disposed of by the designated recycling department.

SAVE THESE INSTRUCTIONS

SIZE

Thank you very much for choosing this ICE machine. ICE machine are precision instruments that should always be handled with care. Please read all of the instructions before using it. The information will help you

achieve the best possible results.

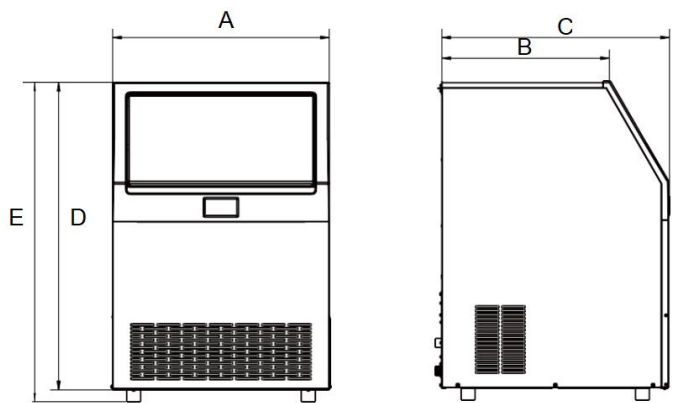

	A	B	C	D	E
LB100T	445	275	400	815	850
LB160T	620	480	650	880	915
LB200T	620	480	650	880	915
LB265T	620	480	650	965	1000

After sealing off,please contrast the packing list,check whether all radom files and enclosures are complete,whether the machine in intact.

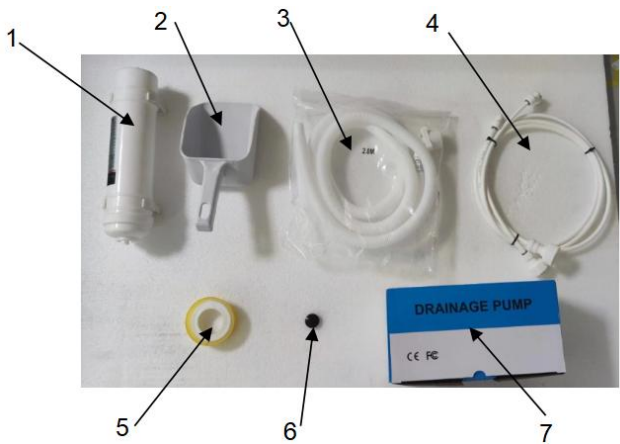

NO	NAME	Function	Quantity
1	Water Filter	Filter Out Water Impurities	1
2	Ice Scoop	Shovel Ice (Plastic PP)	1

3	Ice Maker Drainage Pipe	Ice Maker Drainage Hose (2m)	1
4	ice Maker Water Inlet Pipe	Connect to Ice Maker for Water Inlet	2
5	Sealing Tape	Against Leakage when Connecting Water Pipe	1
6	Sink plug	Block the sink	1
7	Drainage Pump	Help Ice Storage Bin Drains Water When in Elevated Terrain	1

Some models do not include drainage pumps

BASIC STRUCTURE

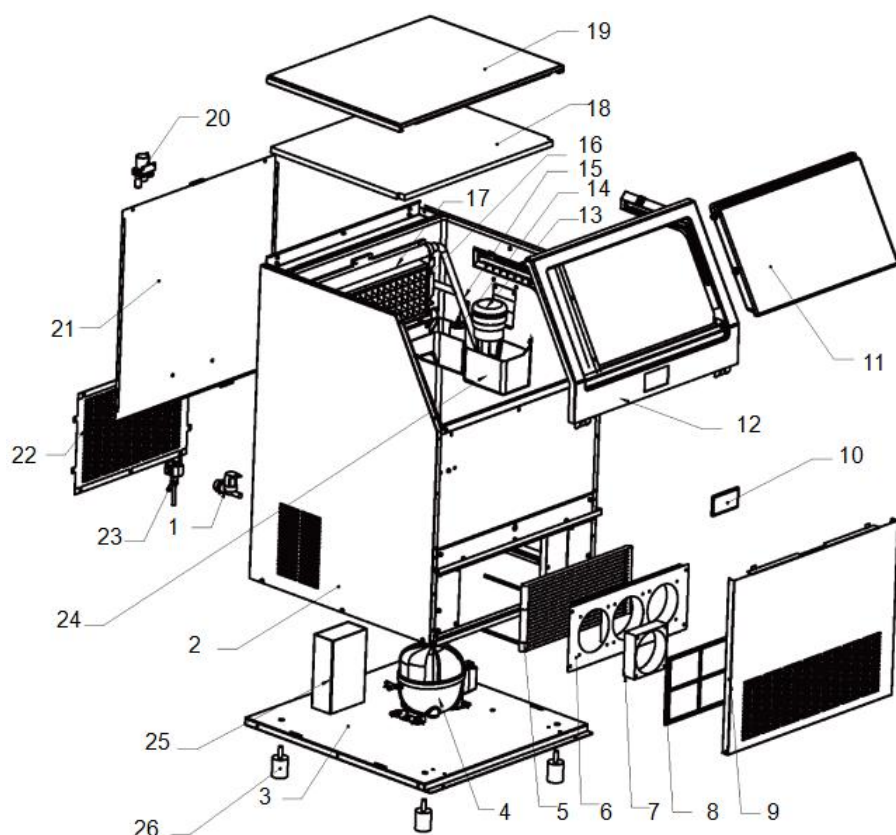

NO.	NAME	NO.	NAME
1	Water supply valve	14	Water level sensor
2	Cabinet components	15	Water pipe
3	Chassis	16	Evaporator
4	Compressor	17	Spray water pipe
5	Condenser	18	Insulation board
6	Fan bracket	19	Top panel
7	Fan	20	water supply valve
8	Filter screen	21	Real panel(above)
9	front panel	22	Real panel(below)
10	Control panel	23	Deicing solenoid valve
11	Door panel	24	Water tank
12	Door frame	25	Electrical box
13	Pump	26	Machine feet

NOTICE TO ALL USERS

1. Please use the standard pre-purified water filter and replace the filter element regularly to ensure it's food hygienic and reduce the risk of failures caused by water scale;
2. For the first time of making ice, due to the high inlet water temperature, normally it takes a little bit longer time to reduce the water temperature in the water tank. After one or two ice-making cycles, the temperature in the water tank will drop to 1--3°C. Machine will enter normal ice making cycle;
3. At least every quarter (every month in areas with poor water quality), it is necessary to descale the water circulation pipes and ice-making components of the machine to reduce risk of failures or less efficient ice-making caused by solenoid valves, water pumps, pipelines and evaporator. Generally the cleaning time can be 5-30 minutes, visually when all the yellow scale has been removed on the surface of the ice evaporator, then it can stop. If conditions permit, you can use food-grade descaling agent or diluted citric acid with a concentration of 20% ,pour it

into the water tank and activate the cleaning mode for internal circulation cleaning, supplemented with a brush to wipe the scale on surface; if those are not available, you can also use undiluted white vinegar, pour into the water tank and use the same cleaning mode, supplemented with a brush to wipe the scale on surface. Immediately after descaling, be sure to use clean water internal and external circulation to clean the entire tank, pipeline, water pump and evaporator at least 3 times (each time you need to unscrew the drain cap to discharge the descaling agent) to ensure food safety and prevent corrosion damage by residues

4. The ambient temperature has a great influence on the ice making speed and life cycle. Please use the equipment under ambient temperature of 15-35 °C, and ensure that the space surrounding and even space on the

top are more than 30cm, then the equipment can be well ventilated and working;

5. Unplug the power supply at least quarterly, open the front panel and use compressed air with a soft brush to remove the dust on the surface of the condenser, then the equipment can run normally and ice-making efficiency is good;

6. Please ensure that the power supply voltage is stable and the socket is reliably grounded for personal and equipment safety;

7. If main power is accessible inside the equipment. Non-professionals are not allowed to do disassemble and repair works, Any maintenance involving the inside components of equipment must be performed when it is completely powered off!

INSTALLPACKING LIST

A. Take out the inlet pipe, filter, filter connecting pipe, and drainage pipe accessories from the accessory box (corresponding to item numbers 1/3/4#).



B. Install the filter element and water faucet: Use two 2-way PE pipes into each end of the filter (pay attention to the direction of the arrow on the filter), connector to connect the inlet pipe of the ice maker to the filter element, use a $\frac{3}{4}$ " connector to connect the ice maker, and use a $\frac{1}{2}$ " connector to connect the Drinking water connection end .

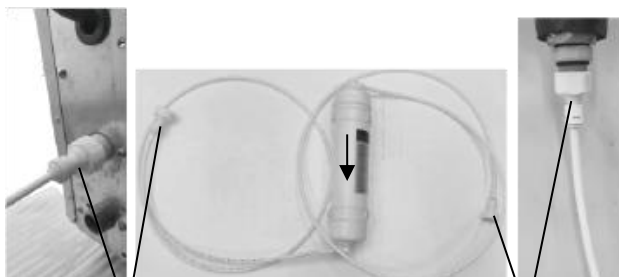

a $\frac{3}{4}$ "connector

a $\frac{1}{2}$ "connector

C. Take out the water inlet pipe, filter, and drain pipe in the accessory box (the water inlet route shown in the diagram -- from the faucet to the main unit water inlet pipe ; the drain route -- from the drain outlet to the floor drain), and connect them to the positions shown in the figure respectively.



Ice Maker Drainage Pipe

The Whole Machine Drainage Installation Notes:

1. Gravity Drainage: Combine the drainage pipes of the main unit and ice storage bin, and connect them to the floor drain together.

2. Electric Drainage: Connect the drainage pipes of the main unit and ice storage bin to the electric water pump. Please note that this pump requires a separate power supply.

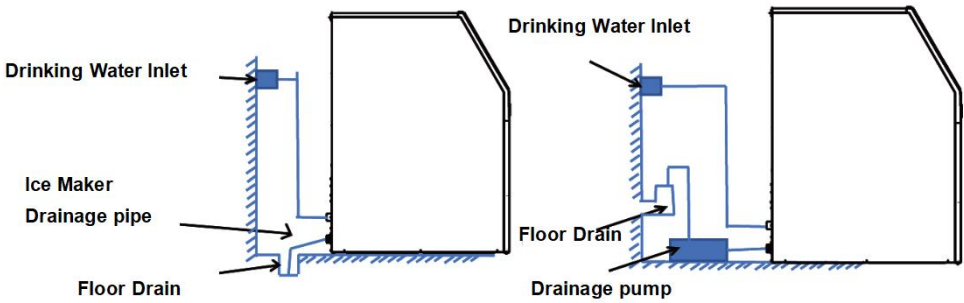

Gravity Drainage

Electric Drainage

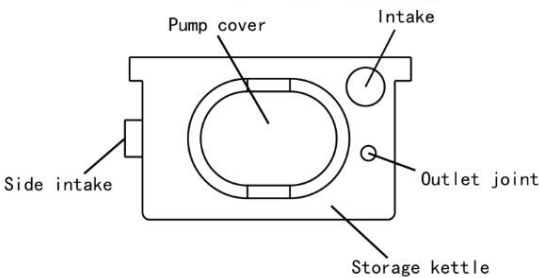
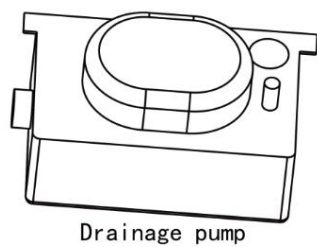

Voltage	100-230V 50-60Hz
Maximum lift	2.0M-2.5M
Operation grade	Discontinuous
Storage tank capacity	1.2L
Applicable Power	15KW
Noise	20dnB(A)
Applicable ambient temperature	1°C-50°C
Power consumption	5W

Refer to the product manual for detailed information
Some models do not include drainage pumps

LCD FULL PAGE DISPLAY

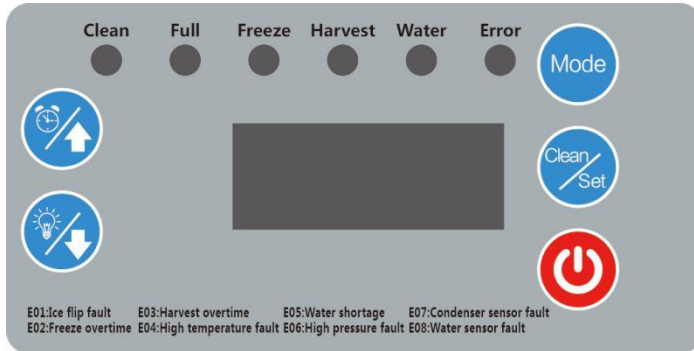

buttons on display board

on/off buttons

press 3 seconds to turn off the machine under turn on status

press on/off button to turn on the machine under turn off status

press the on/off button to exit setting under ice thickness setting and filling water adjust status

mode button

switch the ice making program

clean/set button

press to clean status under machine turn off status

+ /reservation button

press to ice thickness adjust under pressure equilibrium、 making ice、

unload ice、 ice full status

click to increase 1, long press the button to increase continuously under ice thickness adjust status

click to reservation time setting status under turn off status

- /light button

click to decrease 1, long press the button to decrease continuously under ice thickness adjust status

8.fault codes

E-01.ice full button fault, skate board not back in position properly or ice full button damage

E-02.making ice over time,can't detect ice thickness 5 times continuously

E-03.unload ice over time,can't detect ice full button action within 6 minutes
unload ice 3 times continuously

E-04.high temperature fault,condensation temperature higher than setting temperature

E-05.lack of water

E-06.high pressure

E-07.condensation sensor fault

ICE THICKNESS SETTING TIME REFERENCE LIST

Ambient Temperature	Ice-Shedding Time
10°C ~ 20°C	12min ~ 15min
20°C ~ 32°C	15min ~ 18min
32°C ~ 35°C	18min ~ 22min
35°C ~ 43°C	22min ~ 26min

Note: The above data is for reference only. Different regions and different environments may have differences.

DAILY CLEANING AND MAINTENANCE

1. Clearance of side panels and inner container

A、 Before cleaning and sanitizing the ice maker, cleaning up the ice blocks

in the ice cabinet, also ensure the power source and water source have been cut off.

B、Cleaning the side panels and inner container with clean water (you can join some neutral detergent in water), and then wipe up the machine with soft towel.



Attention: Do not spray water to machine directly. Alkaline detergent, perfumed soap, lapping powder, boiling water, bananas oil, tolperison and most of the other organic solvents can't be used to clean the machine.

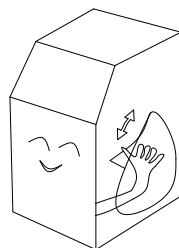

2. Dust removal of the filter screen

In order to use the machine well, please clean the dust that covered on the filter screen once every three months. Open the Ventilation fence in front of the machine, (grasp the frame of ventilation fence by hand, pull it out carefully), use dust collector or brush to clean the dust. The aculeate iron tools can't be used to clean condenser, so as not to damage the radiating fins.

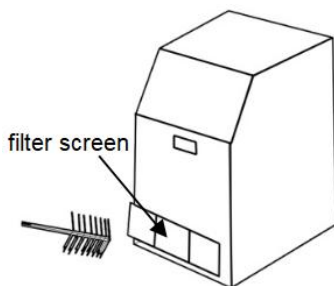

3. Cleaning the spray water pipe

A、Cleaning the ice maker:

The spray water pipe must be cleaned once per half a year. When you

clean it, firstly open the front cover, take out the spray pipe, and then scour off the scum till the every hole is unblocked. Reinstalled it after finish cleaning.

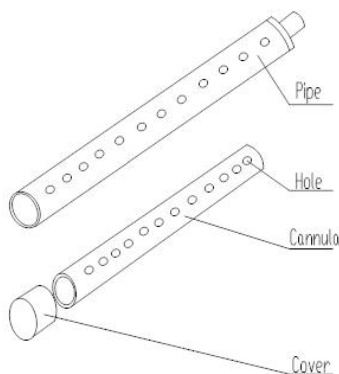

C、 After finishing washing, screw out the cap of the drain-valve and drain out all the dirty water, then tighten the cap.

4. Automatically cleaning of the ice maker

Automatically cleaning of the ice maker: when the machine is making ice, softly push the “clean” key on the electrical box which is on the rear panel, the refrigeration system will stop work, and the machine turn into auto-wash process. The total wash processes is divided into three steps: wash, potch and drain. It will cost bout 30 minutes. In order to improve cleaning effect, the user can add a little neutral detergent, after finishing washing, the machine turns into ice-make condition automatically.

A、 Usually, the machine is connected to the power source continually.

When you connect the machine to the power source firstly, there is a clean process after the water in sink is full: water supply——water pump works ——water pump works and drain-valve opens——water supply——water pump works——water pump works and drain-valve opens——pressure balances. This process will cost about 5 minutes(once every 30 ice-make cycle). In addition, after every four ice-make cycles, there is a drain process, drain out the water in the sink.

B、 After finishing washing, confirm the place of the float ball: If the float ball is on the bottom and the machine is on, this condition is normal, the program will turn into pressure balance process, the water level will be controlled automatically; If the float ball is on the upper position and the machine stops, it means that there are some problems with the water level sensor, water pump or drain valve.

Point: the water-filter core is consumable, it is not in the guarantee scope. If you need it, please contact with our marketing department and buy it.
5. Please according to the following steps if you haven't used the machine for a long time.

A、 Turn off the power switch, take out the plug of the machine, then cut off the power supply and water supply.

B、 Take out the ice block from the cabinet, wipe out the water on the inner of the cabinet.

C、 Wipe out the water on the cabinet, and then open the door, make the cabinet fully dried.

TROUBLE SHOOTING

Fault	Analysis	Solution
Do not make ice	The electric wire didn't connect well.	Check the wire.
	The retained board was pinned by ice block.	Take out the ice block so as to let the retained board return to the original situation.

	The connecting wire of compressor's starter is loose	Check and fasten it
	The starting capacitor of compressor is broken	replace it
	PC board is broken	replace it
	Water level sensor is broken	replace it
	water pump is broken	replace it
The sink is overflow.	water supply solenoid valve is broken	replace it
	water level sensor is broken	replace it
No water flowing on to the ice model	water pump is broken	replace it
	PC board is broken	replace it
The ice block is thin	The surface of condenser is covered with dust.	clean it
	The ambient temperature is too high	You should use the machine in allowable ambient temperature
	The refrigerant leak	check and recharge the refrigerant
	fan motor is broken	replace it
	spray tube is blocked	clean it
	The ice thickness sensor is too close to the ice model.	Adjust the screw of sensor(turn right)

The ice can not drop off.	The ice thickness sensor is broken	replace it
	The solenoid valve is not open	check the electric wire if it is connected well or not. Or replace the solenoid valve
	The ambient temperature is too low	you should use machine in allowable ambient temperature

TECHNICAL PARAMETER AND WIRING DIAGRAM

A、Technology parameters are on the nameplate.

B、The electrical schematic diagram is on the inner side of the board .

VEVOR[®]

TOUGH TOOLS, HALF PRICE

Technical Support and E-Warranty Certificate

www.vevor.com/support

Made In China