



# RC10

## TEAM CAR

GOLD EDITION  
★★★

### INSTRUCTION MANUAL



**20 TEAM ASSOCIATED**



Due to ongoing research and development, photos may not match current kit components.  
RC10 photos shown equipped with items that may NOT be included with vehicle.

## :: Introduction

Thank you for purchasing this Team Associated product. This assembly manual contains instructions and tips for building and maintaining your new Kit. Please take a moment to read through this manual to help familiarize yourself with these steps.

We are continually changing and improving our designs; therefore, actual parts may appear slightly different than in the illustrations. New parts will be noted on supplementary sheets located in the appropriate parts bags.

Check each bag for these sheets before you start to build.

## :: KIT Features

Features in the RC10 Team Kit:

- Authentic replica of the RC10 Buggy Kit originally released in 1990
- Gold anodized 6061-T6 aluminum monocoque tub chassis
- Fully adjustable four-wheel independent suspension
- Long travel, fluid-filled anodized aluminum coil-over shocks
- Sealed 3-gear Stealth A.T.C. transmission
- High-torque ball differential
- Exceptional ground clearance with low center of gravity
- Front and rear tires with one-piece racing wheels
- Clear Viper body and wing
- Fiberglass shock towers
- Full metal ball bearings
- Fits 6-cell NiMH and 2S LiPo battery packs

## :: Additional

Your new RC10 Kit comes as a kit. There are some items you will need to complete your kit (refer to website for suggestions):

- R/C two channel surface frequency radio system
- Electronic Speed Control (ESC)
- Steering Servo
- 2S, 7.4V Lipo stick battery or 7.2V NiMH battery
- Peak detection battery charger
- Retaining Ring Pliers
- Polycarbonate specific paint
- Pinion gear, size to be determined by type and wind of motor you use
- R/C Electric Motor
- Servo Horn (AE #89007)
- Thread Lock (AE #1596)

Tools included:

- Allen wrenches  
(.035", .050", 1/16", 3/32")
- Shock building tool

## :: Other Helpful Items

- Silicone Shock Fluid (Refer to website for complete listings)
- Tire Adhesive (AE #1597)
- Shock Pliers (AE #1681)
- Wire Cutters / Hobby Knife
- Body Scissors (AE #1737)
- Green Slime shock lube (AE #1105)
- Needle Nose Pliers
- Reamer / Hole Punch (AE #1499)
- Calipers or a Precision Ruler
- Soldering Iron

**Associated Electrics, Inc.**  
**21062 Bake Parkway**  
**Lake Forest, CA 92630**



**Customer Service**  
**Tel: 949.544.7500**  
**Fax: 949.544.7501**

# **:: Hardware - 1:1 Scale View**

## **Cap Head (shcs)**

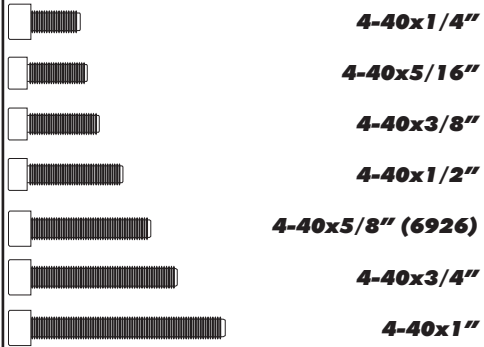

## **Flat Head (fhcs)**

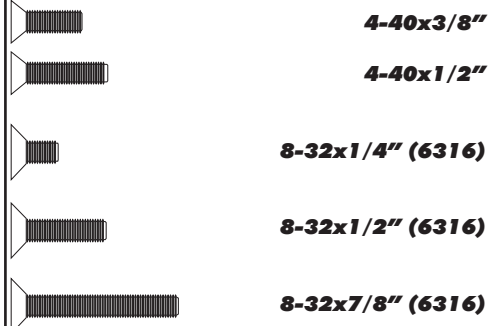

## **Button Head (bhcs)**

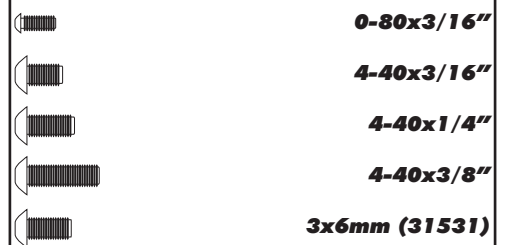

## **Shims and Washers**

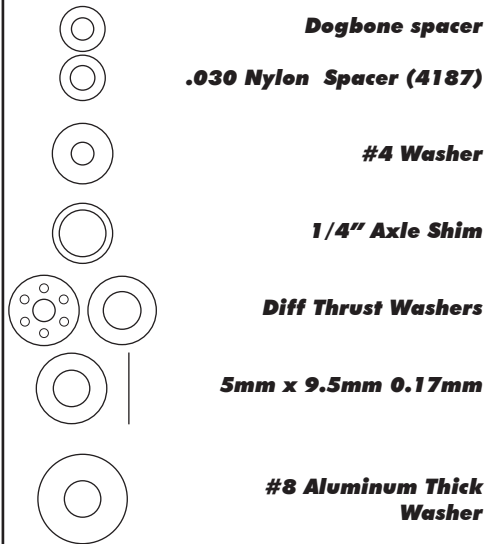

## **Nuts (lock/plain)**

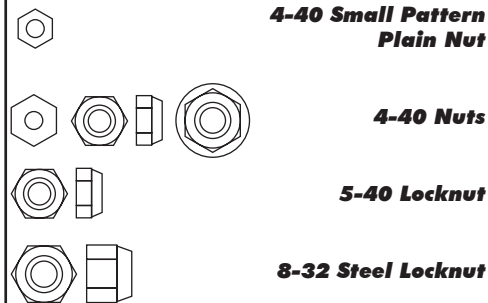

## **Set Screws**



## **Diff Balls**



## **Clips**



## **Bearings**

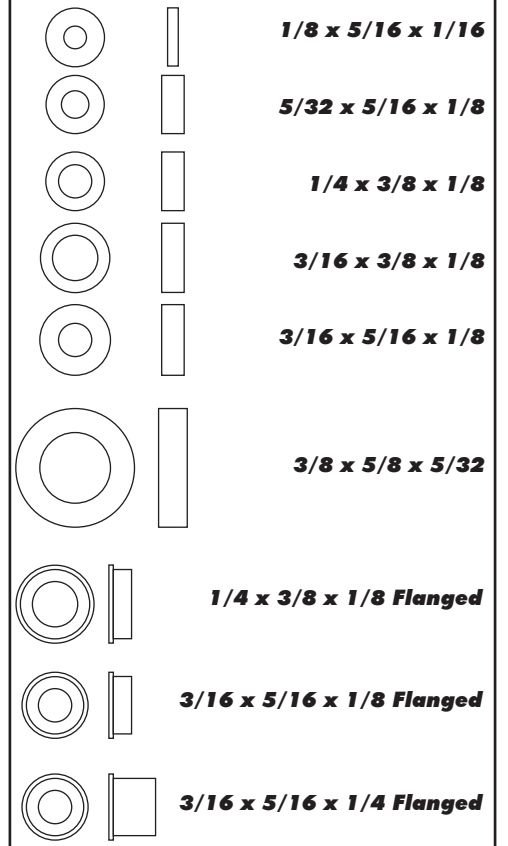

## **Notes:**

**:: Table of Contents**

1..... Cover	11 - 12..... Turnbuckles Build (Bag F)
2..... Introduction	13 - 14..... Shocks Build (Bag G)
3..... 1:1 Hardware "Fold Out"	15 ..... Chassis Build (Bag H)
4..... Table of Contents	15 - 17..... Electronics Build (Bag I)
5..... Nose Plate / Steering Build (Bag A)	17 - 20..... Wheels, Tires and Body Install (Bag J)
5 - 6..... Front Suspension Build (Bag B)	21..... Notes
7 - 8..... Transmission Build (Bag C)	22..... Decal Installation
9 - 10..... Rear Bulkhead Build (Bag D)	
10 - 11..... Rear Suspension Build (Bag E)	

**:: Notes**



This symbols indicates a special note or instruction in the manual.



***There is a 1:1 hardware foldout page in the front of the manual. To check the size of a part, line up your hardware with the correct drawing until you find the exact size.***

## :: Nose Plate / Steering Build - Bag A - Step 1

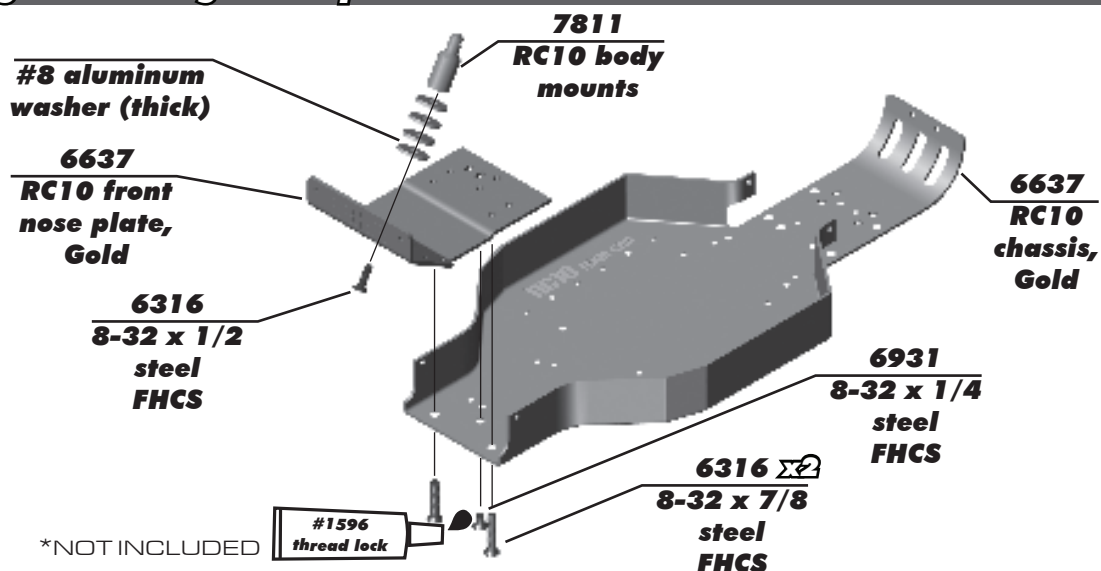

## :: Nose Plate / Steering Build - Bag A - Step 2

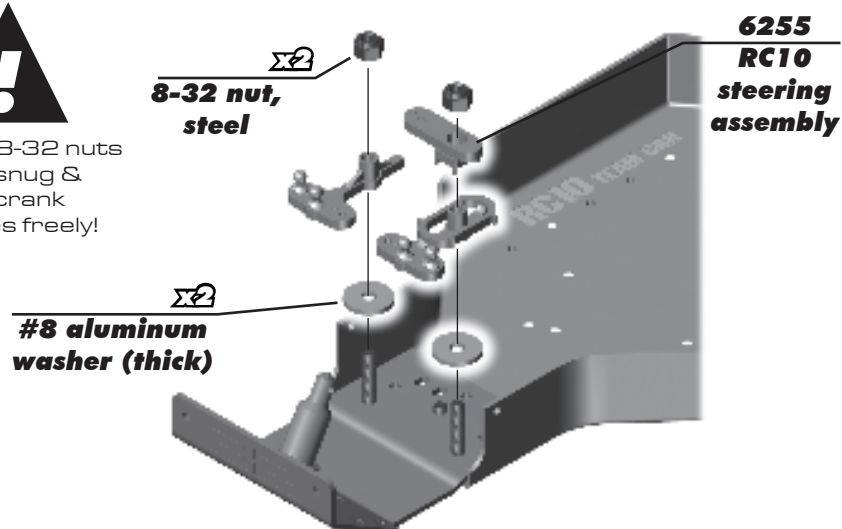
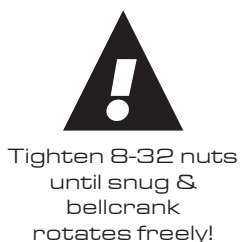
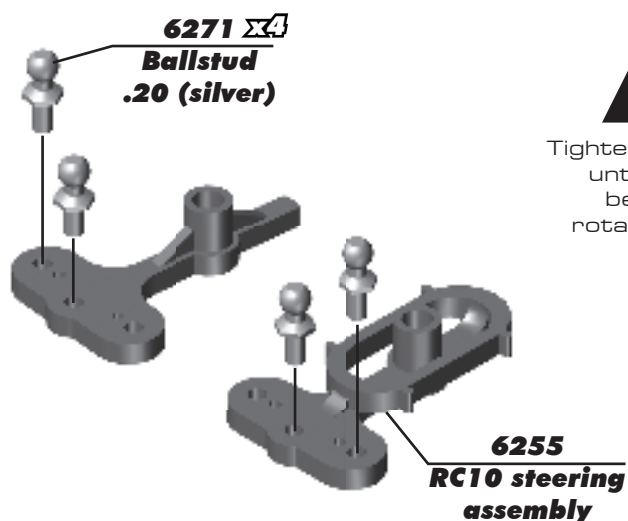

## :: Front Suspension Build - Bag B - Step 1

**LEFT**

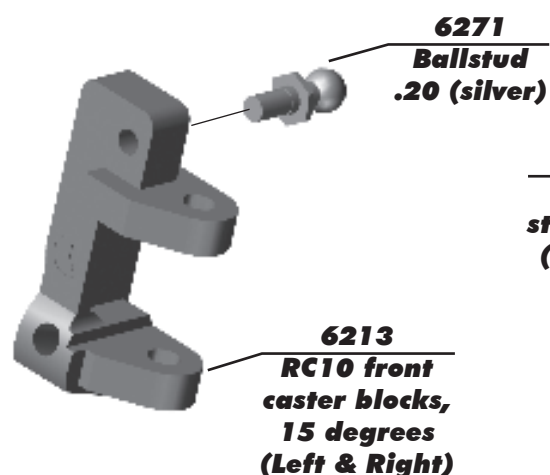

**Build left and right sides!**

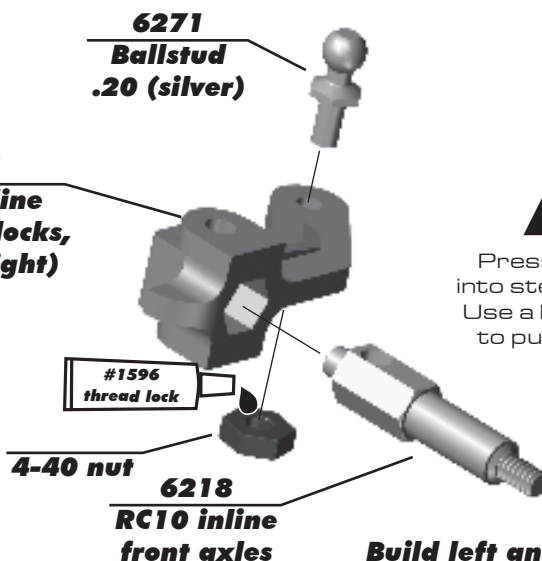

**Build left and right sides!**



## :: Front Suspension Build - Bag B - Step 2

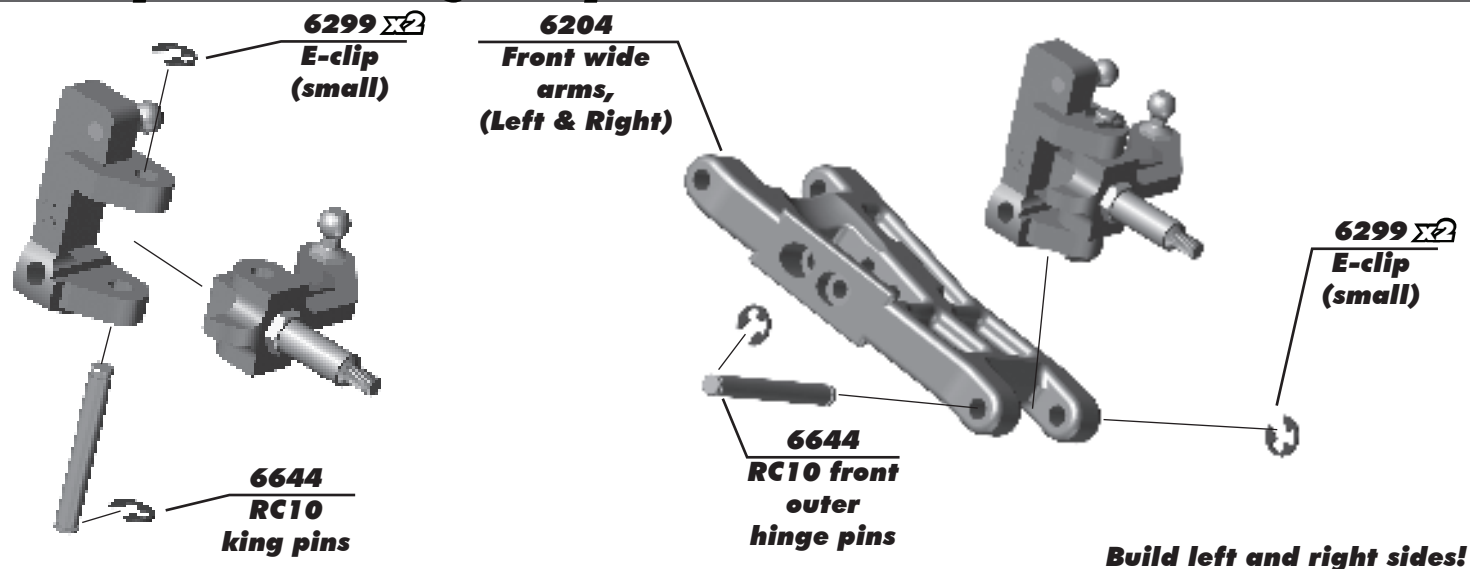

## :: Front Suspension Build - Bag B - Step 3

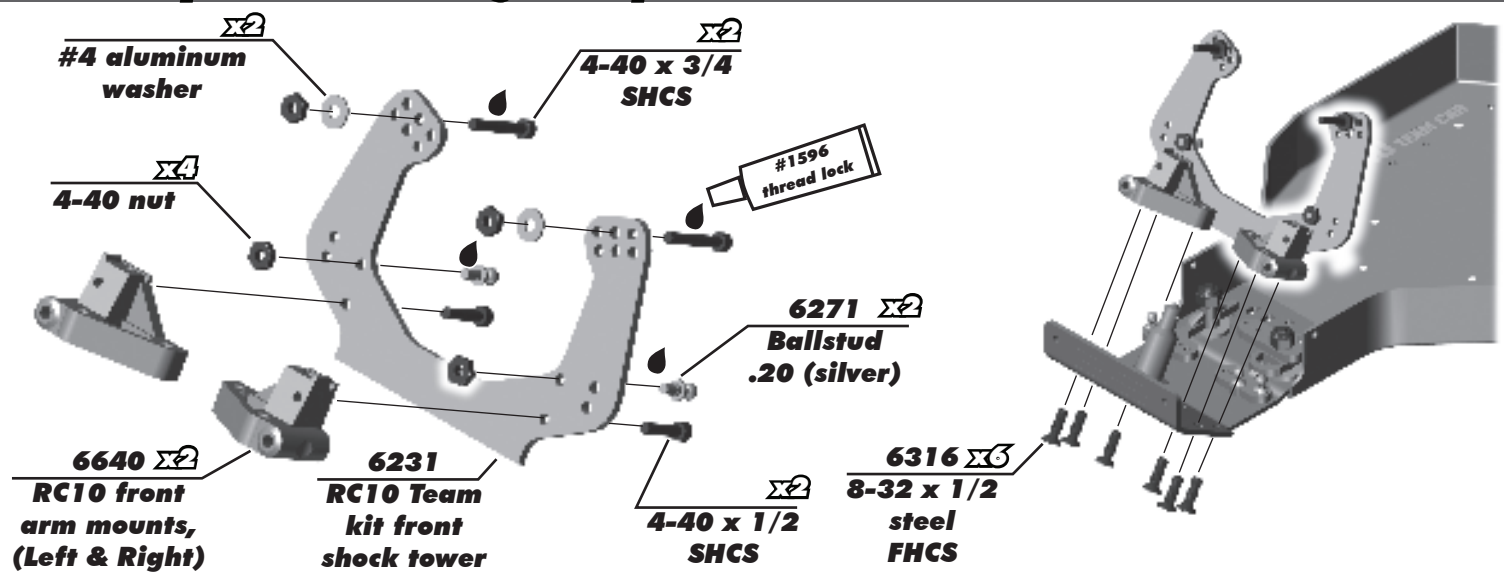

## :: Front Suspension Build - Bag B - Step 4

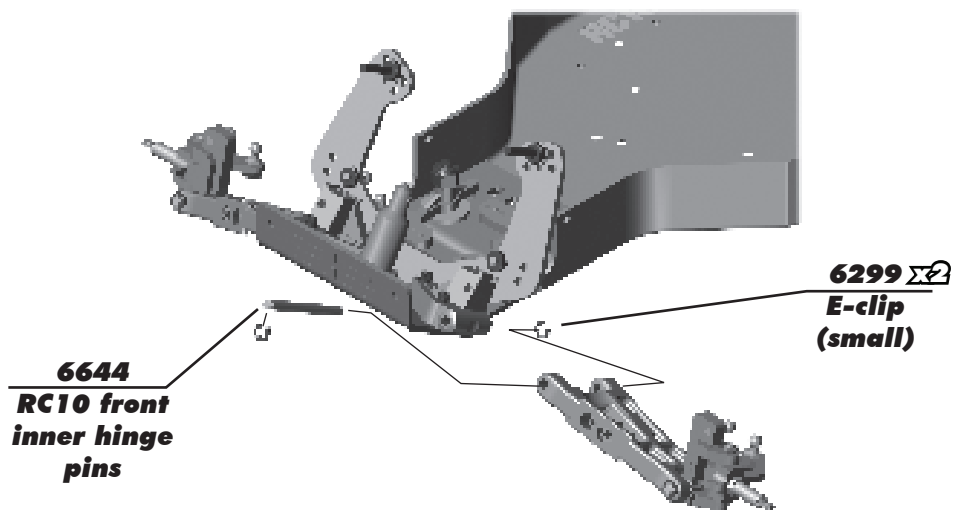

## :: Transmission Build - Bag C - Step 1

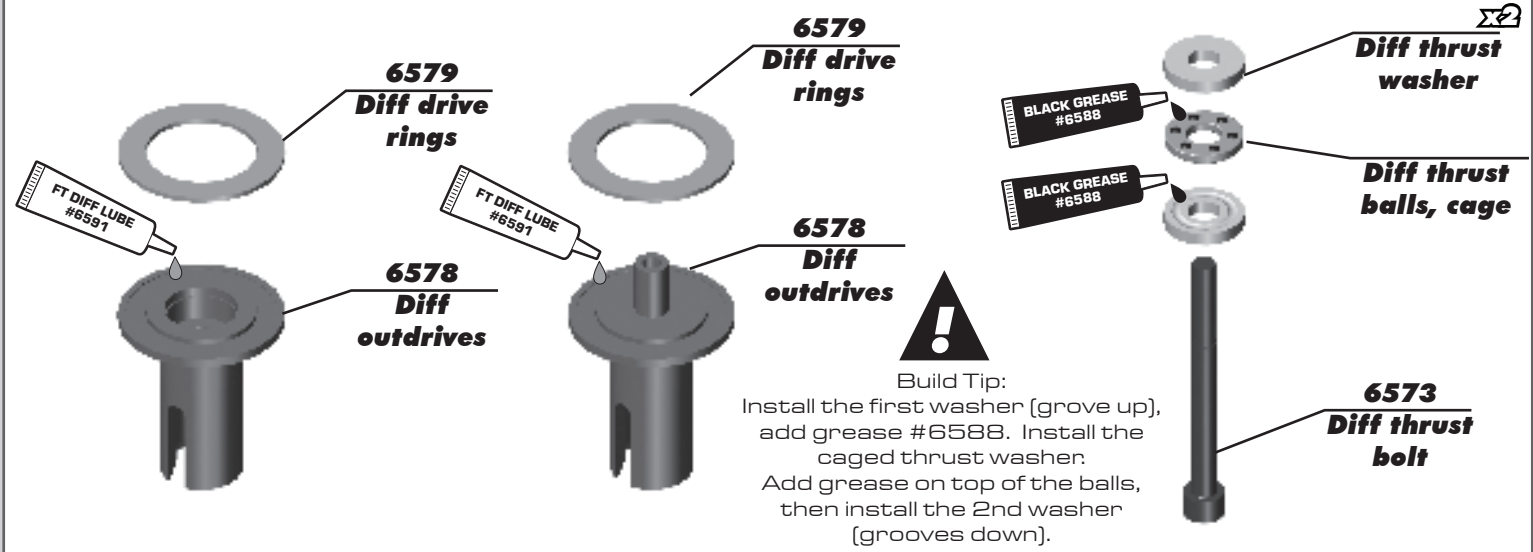

## :: Transmission Build - Bag C - Step 2

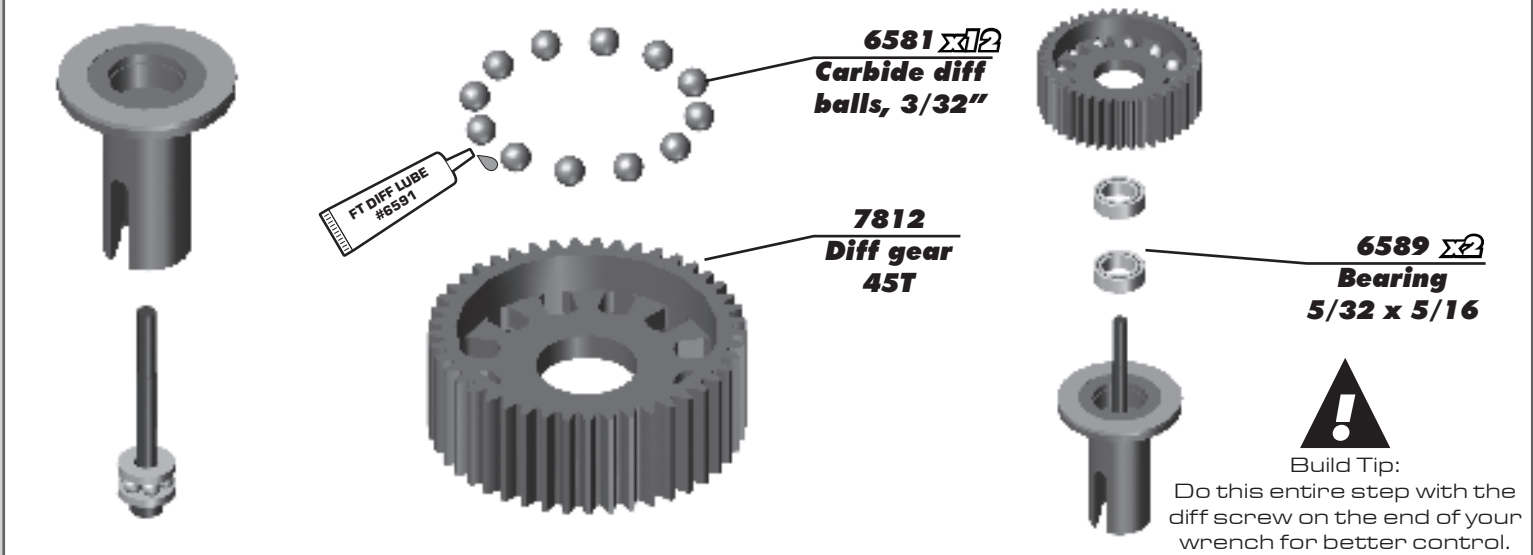

## :: Transmission Build - Bag C - Step 3

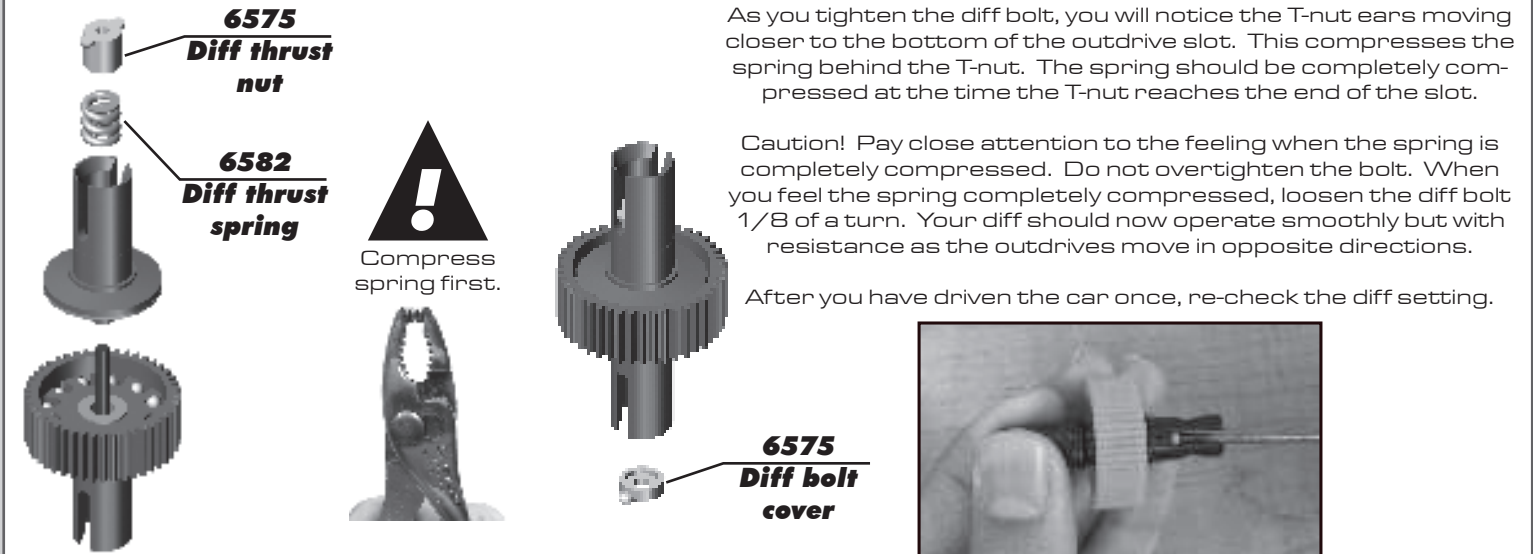

## :: Transmission Build - Bag C - Step 4

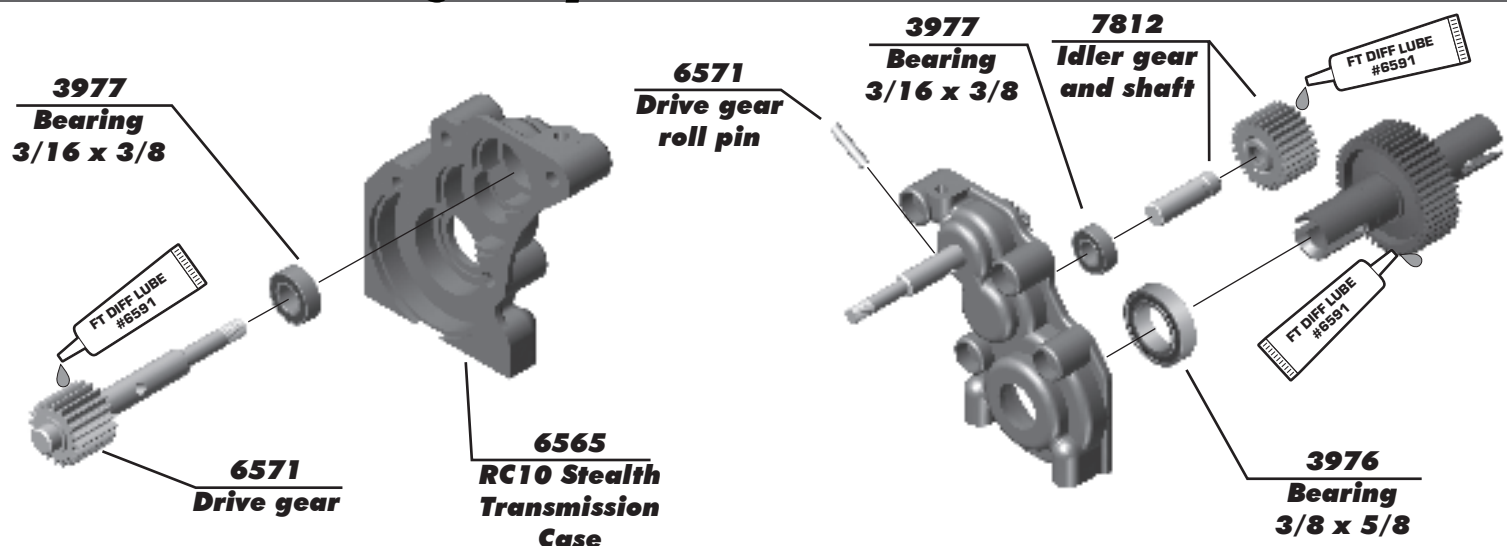

## :: Transmission Build - Bag C - Step 5

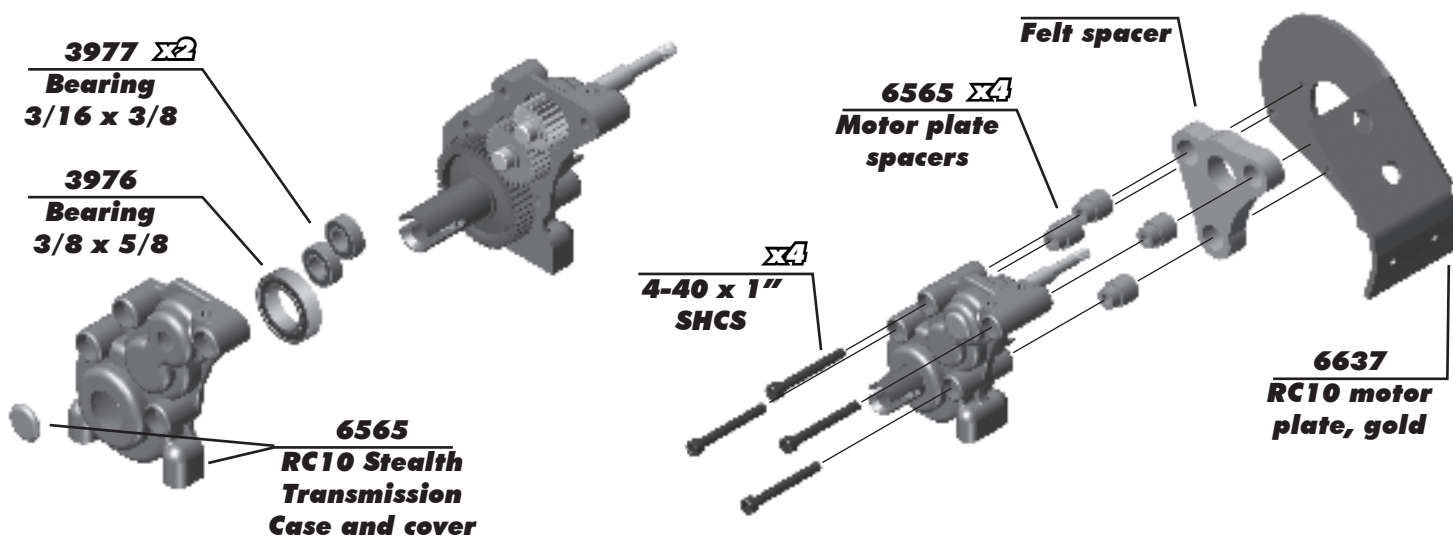

## :: Transmission Build - Bag C - Step 6

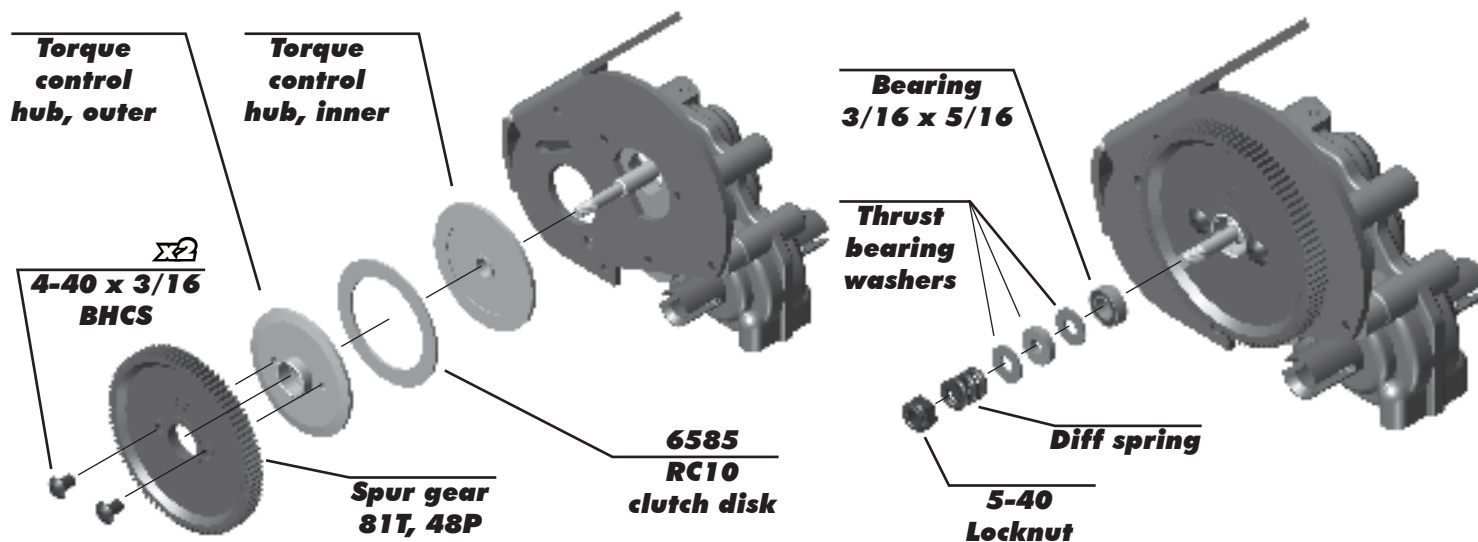



### :: Rear Bulkhead Build - Bag D - Step 1

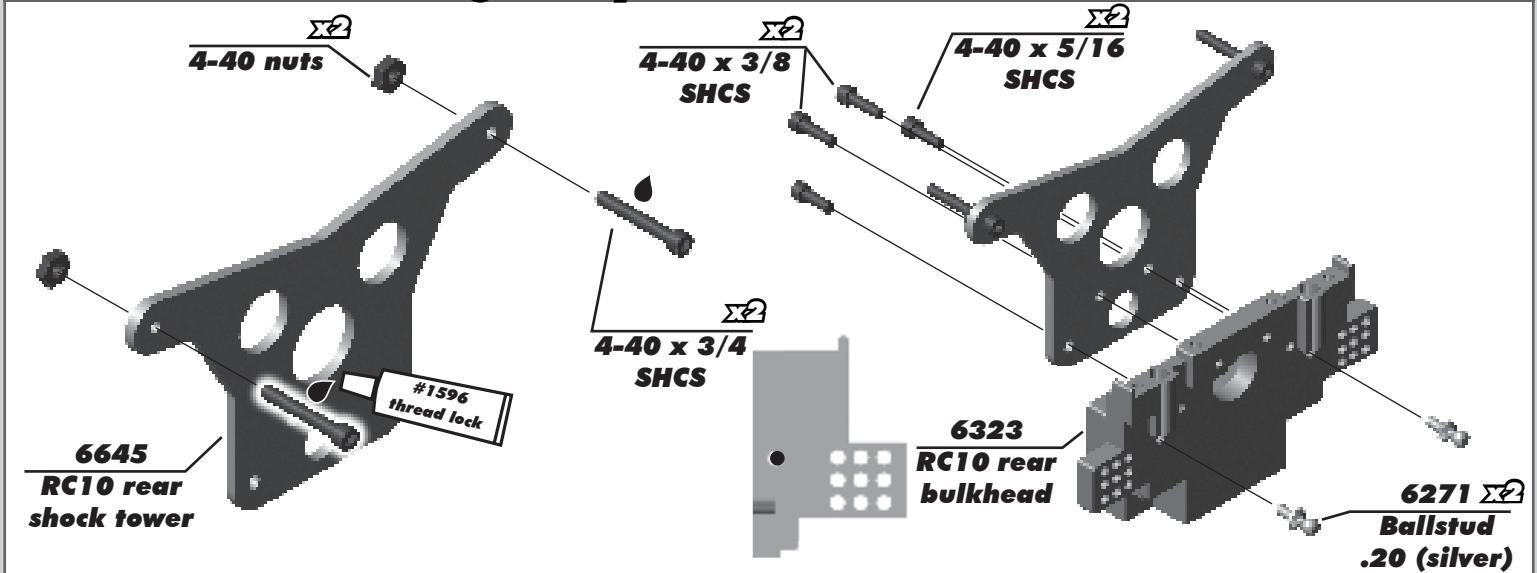

### :: Rear Bulkhead Build - Bag D - Step 2

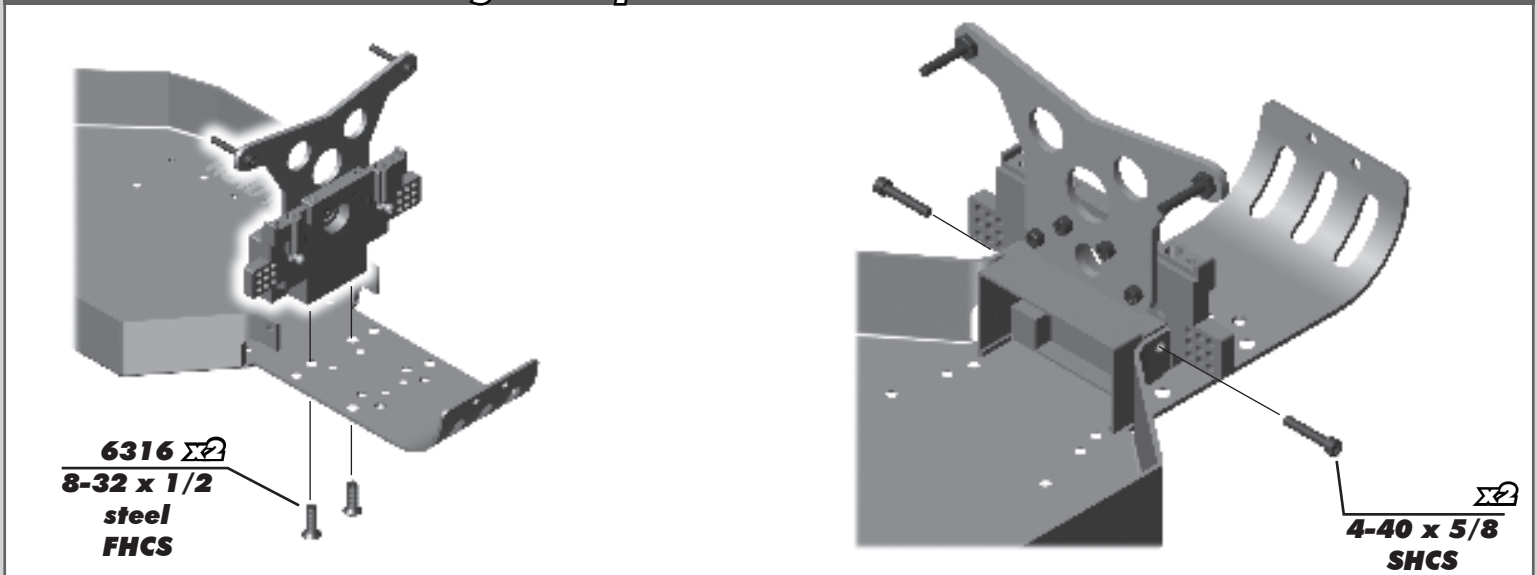

### :: Rear Bulkhead Build - Bag D - Step 3

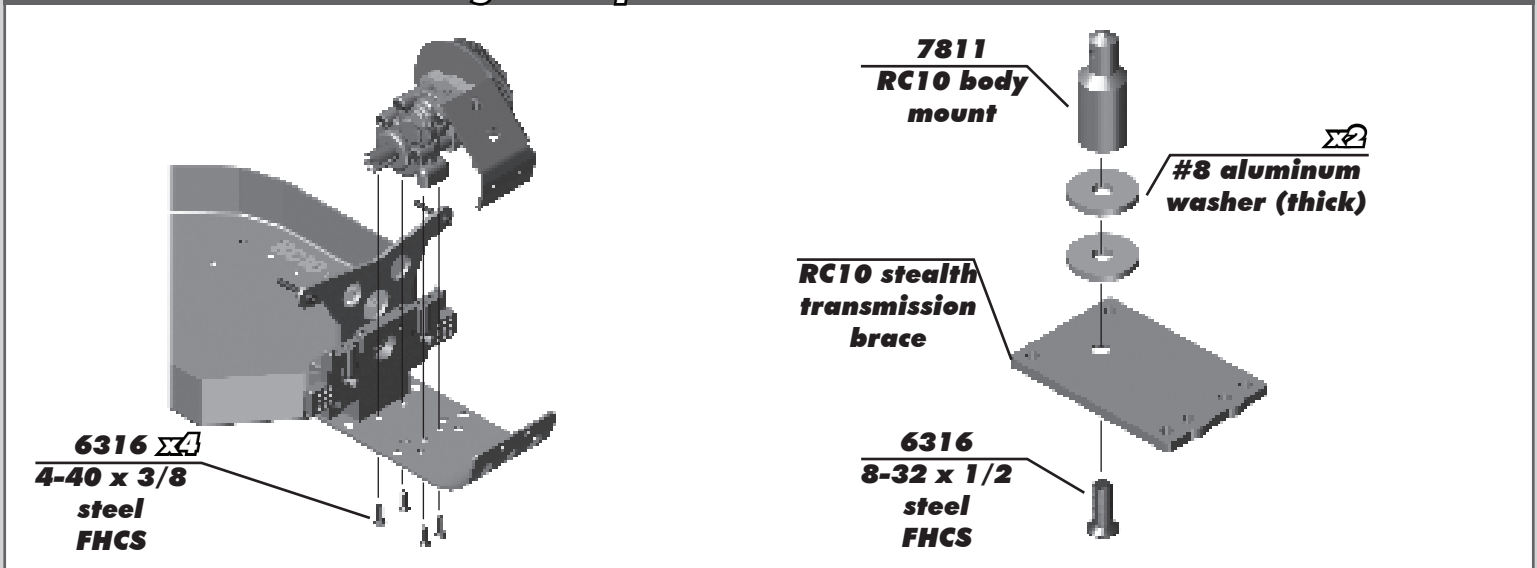

## :: Rear Bulkhead Build - Bag D - Step 4

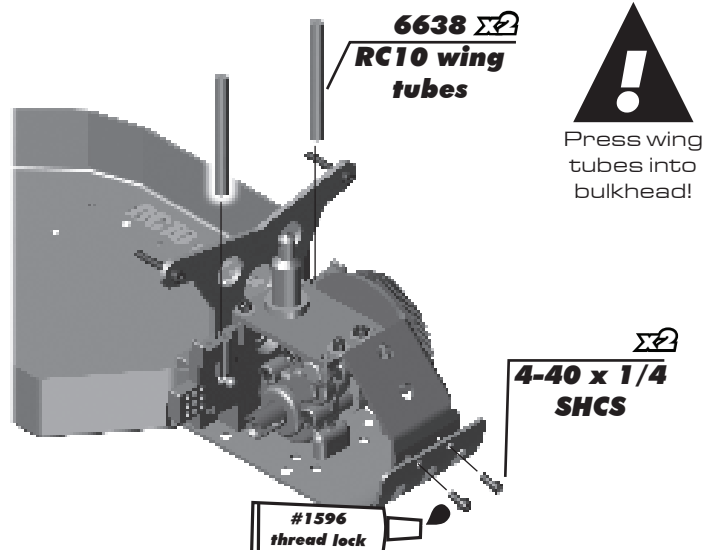
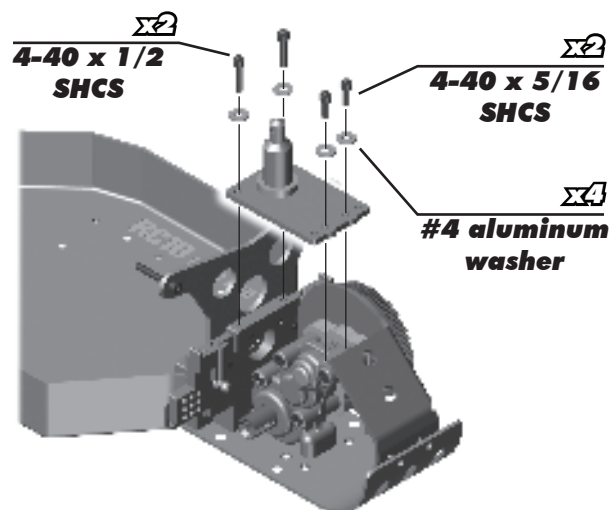

## :: Rear Suspension Build - Bag E - Step 1

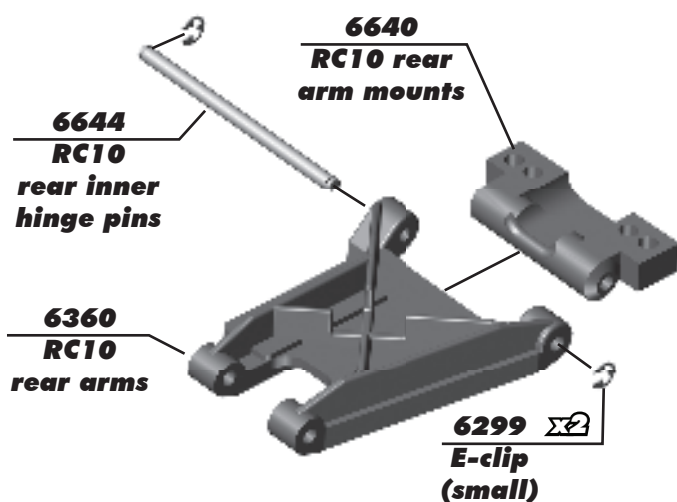

**Build left and right sides!**

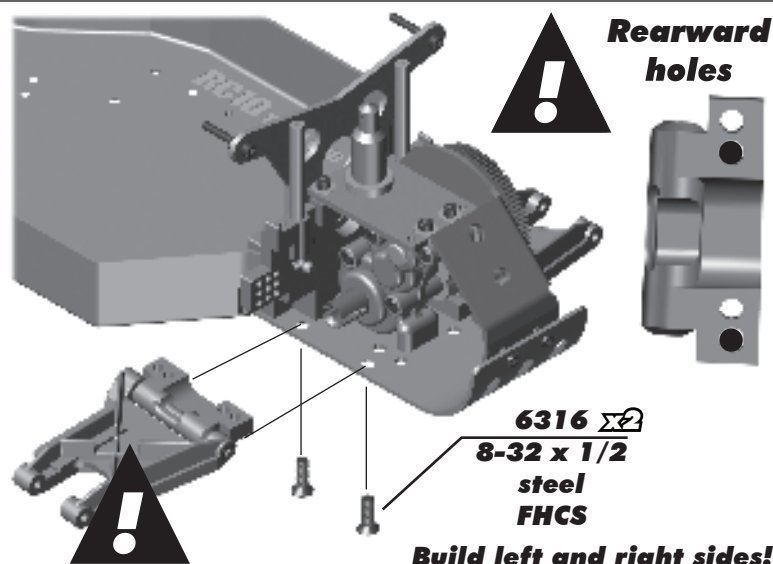

## :: Rear Suspension Build - Bag E - Step 2

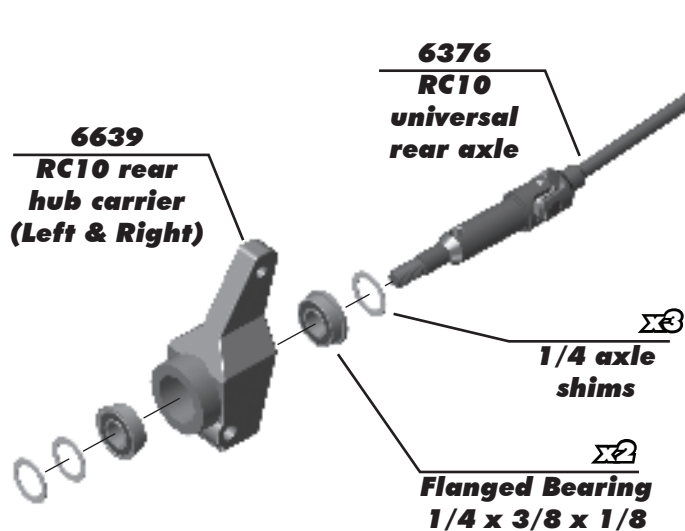

**Build left and right sides!**

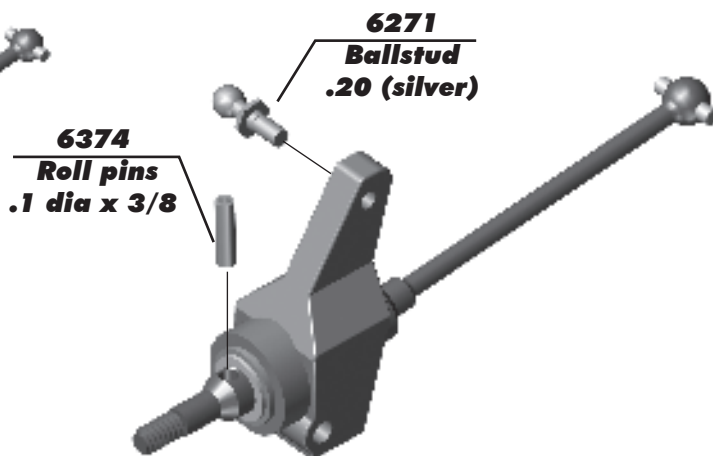

**Build left and right sides!**

## :: Rear Suspension Build - Bag E - Step 3

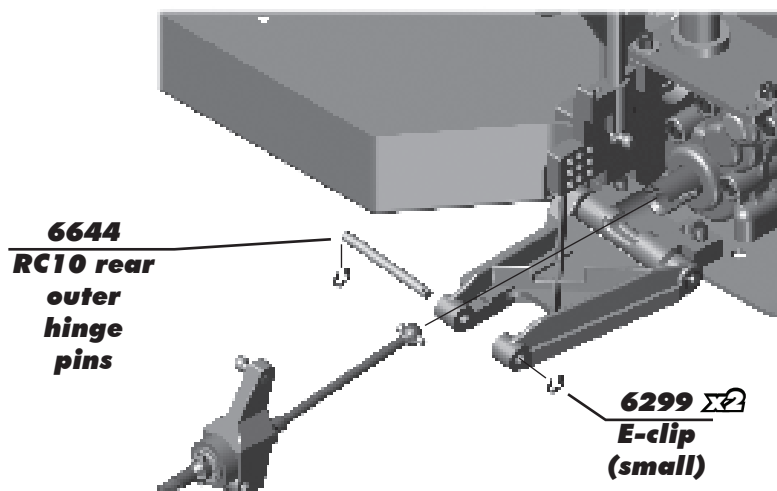

**Build left and right sides!**

## :: Turnbuckles Build - Bag F - Step 1

**!**  
Orient the notch  
to the left  
throughout the  
car. It indicates  
which end has the  
left hand threads!



**6279**  $\Sigma 2$   
**Ball cups**  
**(white)**

**6267**  
**Steel turnbuckle,**  
**black (2.06")**

**Rear Camber Turnbuckle**  
**1.00" (25.50mm)**



Recommended turnbuckle lengths are  
approximate. Final recommended  
settings = 0 degree Front Toe in and  
-2 Degree Camber Front and Rear.

**Build left and right sides!**

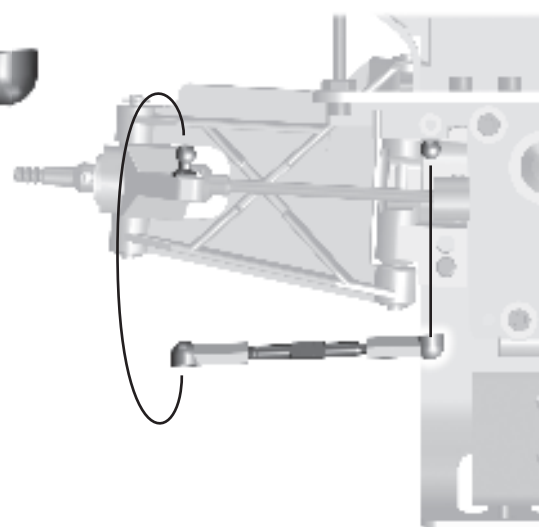

## :: Turnbuckles Build - Bag F - Step 2

**!**  
Orient the notch  
to the left  
throughout the  
car. It indicates  
which end has the  
left hand threads!



**6279**  $\Sigma 2$   
**Ball cups**  
**(white)**

**6267**  
**Steel turnbuckle,**  
**black (1.06")**

**Steering Rack Turnbuckle**  
**0.50" (12.5mm)**

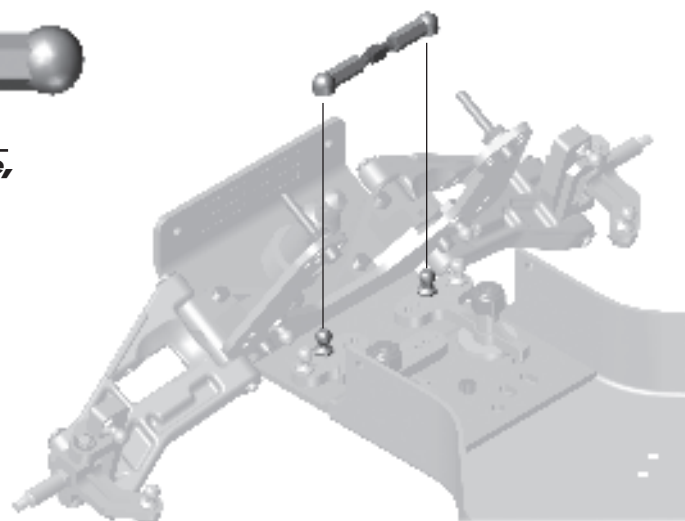
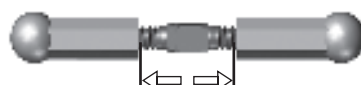

## :: Turnbuckles Build - Bag F - Step 3



Orient the notch to the left throughout the car. It indicates which end has the left hand threads!



**6279 X2**  
**Ball cups**  
**(white)**

**6267**  
**Steel turnbuckle,**  
**black (1.65")**

**Front Camber Turnbuckle**  
**1.14" (29.00mm)**



Recommended turnbuckle lengths are approximate. Final recommended settings = 0 degree Front Toe in and -2 Degree Camber Front and Rear.

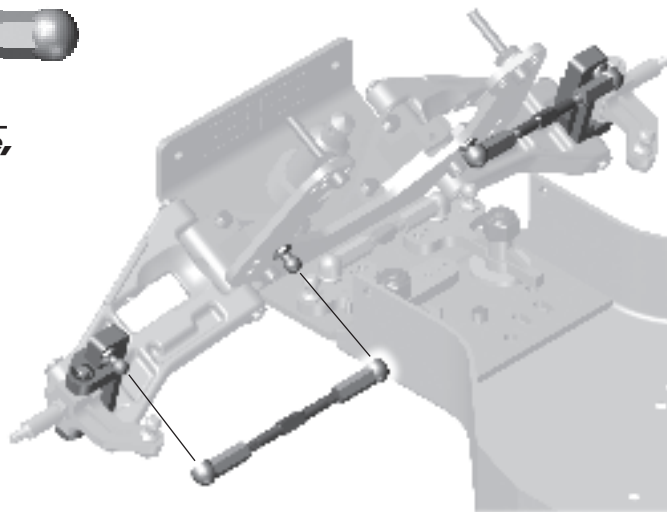

**Build left and right sides!**

## :: Turnbuckles Build - Bag F - Step 4



Orient the notch to the left throughout the car. It indicates which end has the left hand threads!



**6279 X2**  
**Ball cups**  
**(white)**

**6267**  
**Steel turnbuckle,**  
**black (1.65")**

**Steering Turnbuckle**  
**1.37" (35.00mm)**



Recommended turnbuckle lengths are approximate. Final recommended settings = 0 degree Front Toe in and -2 Degree Camber Front and Rear.

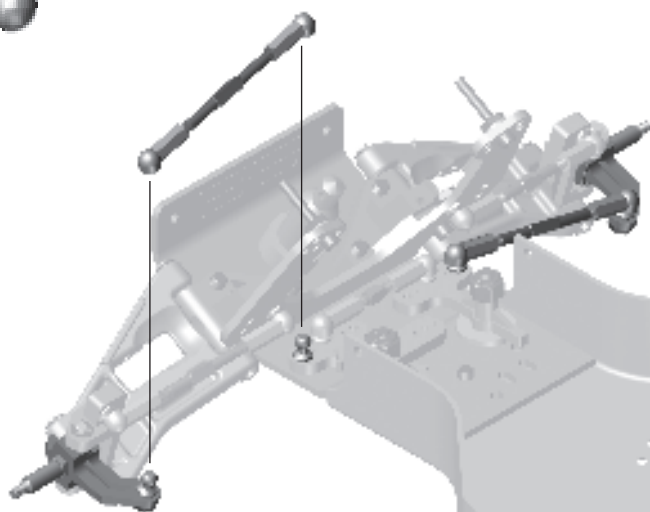

**Build left and right sides!**

## :: Shocks Build - Bag G - Step 1

**Remove spurs**

**Piston**

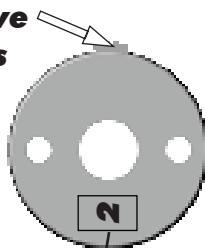

**Piston number here**  
**Use #2 = front shocks**  
**Use #2 = rear shocks**

**6299**  
**E-clip**  
**(small)**

**6460**  
**Shock shaft,**  
**front (0.71)**

**6420**  
**Shock shaft,**  
**rear (1.32)**

**6420/6462**  
**Shock pistons**  
**(1, 2, 3)**

**6299**  
**E-clip**  
**(small)**

**TIP:** Use marker to mark the piston numbers for easy identification!

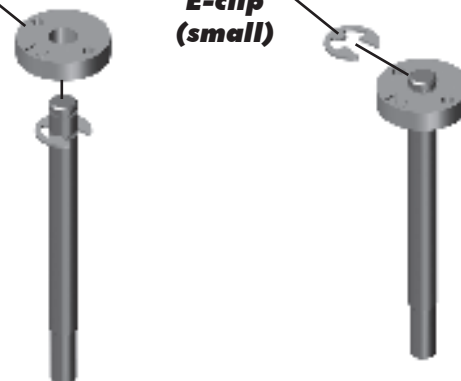

**Build two front and two rear!**

## :: Shocks Build - Bag G - Step 2

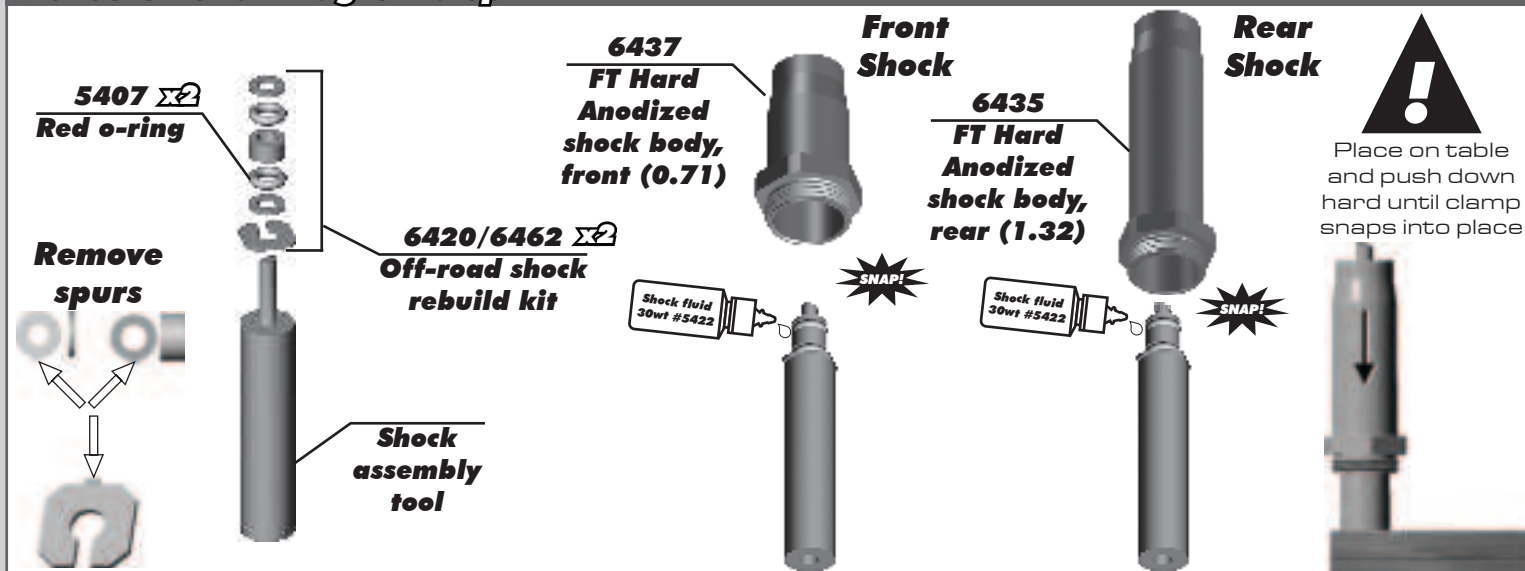

## :: Shocks Build - Bag G - Step 3

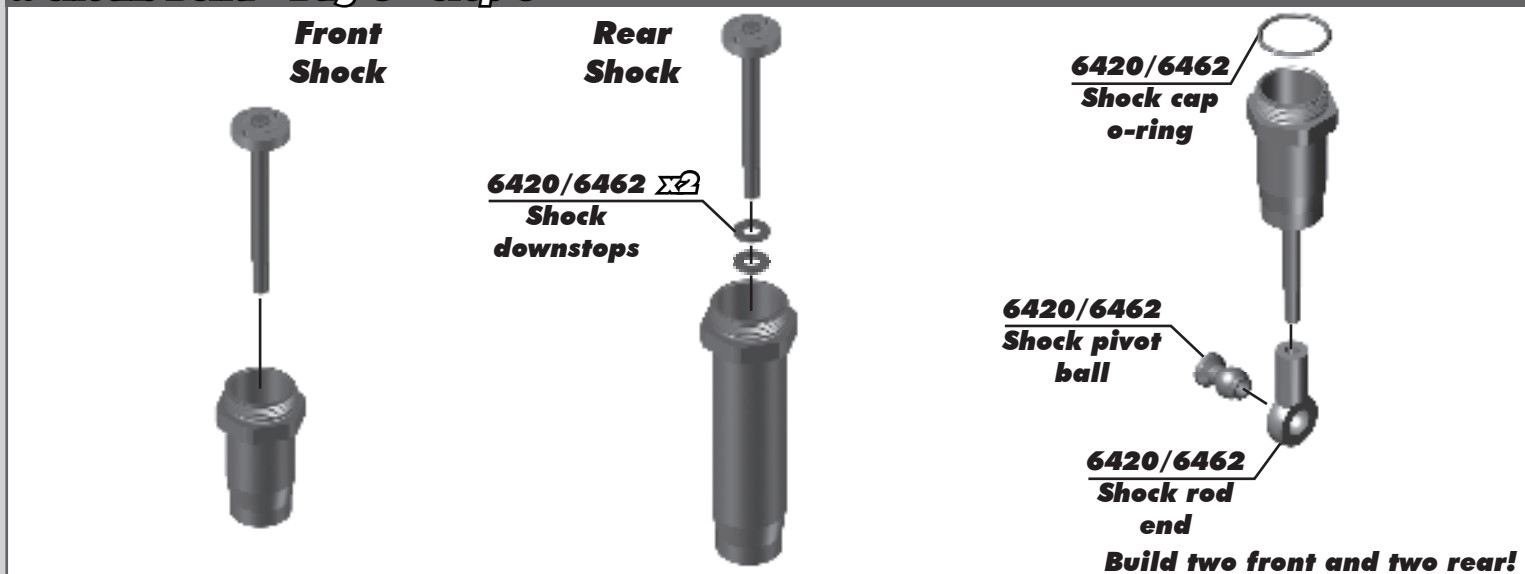

## :: Shocks Build - Bag G - Step 4

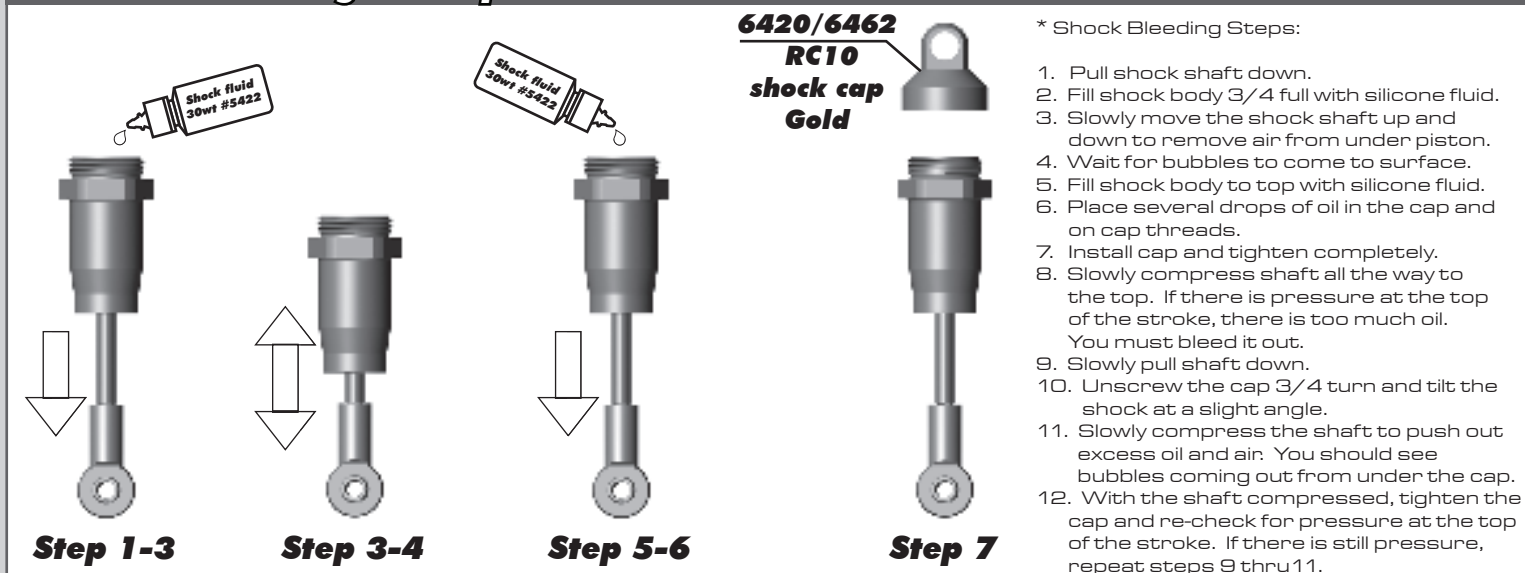



## :: Shocks Build - Bag G - Step 5

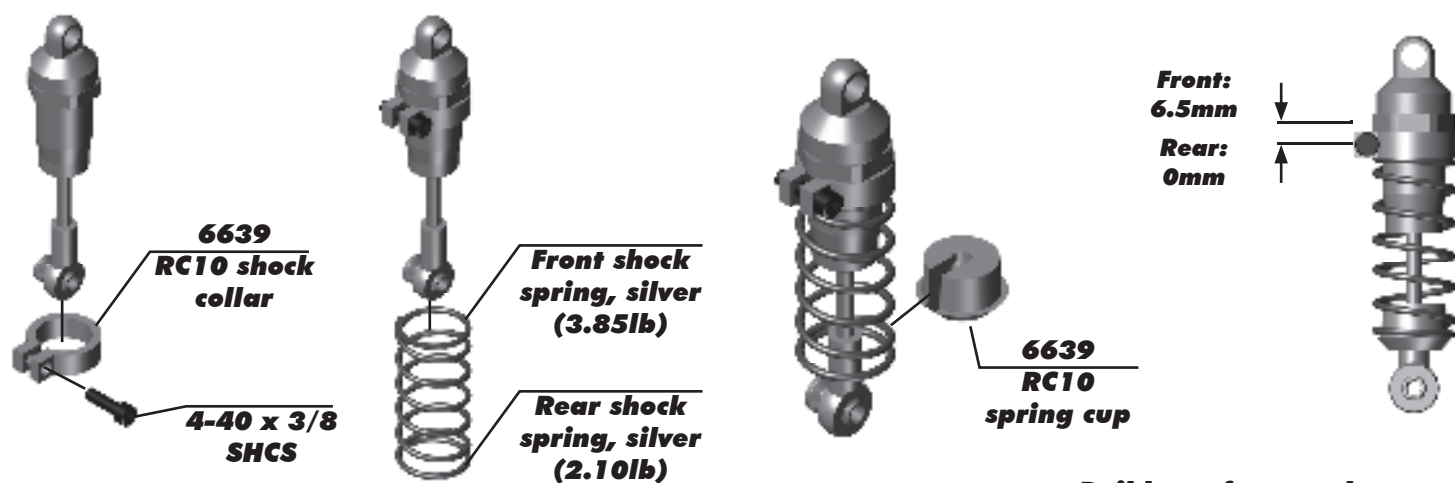

## :: Shocks Build - Bag G - Step 6

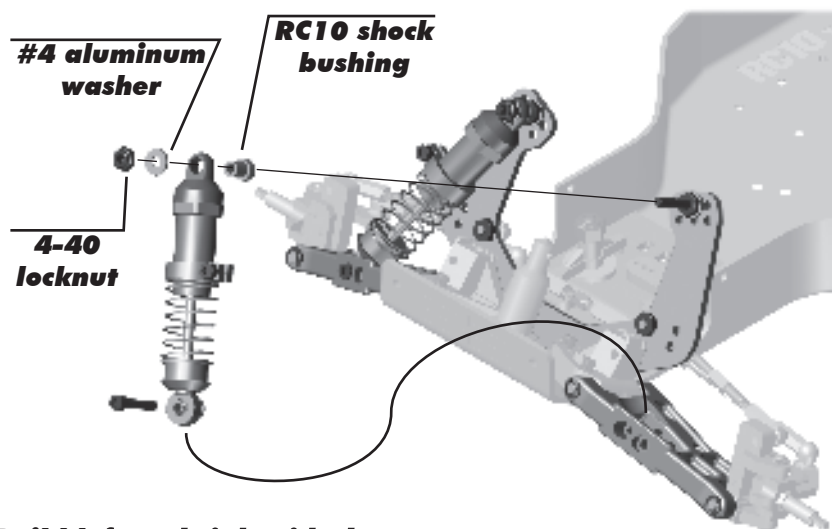

## :: Shocks Build - Bag G - Step 7

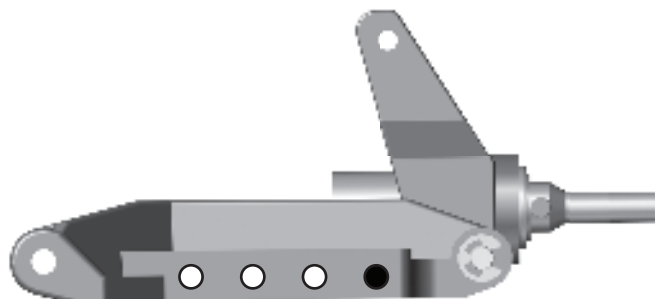
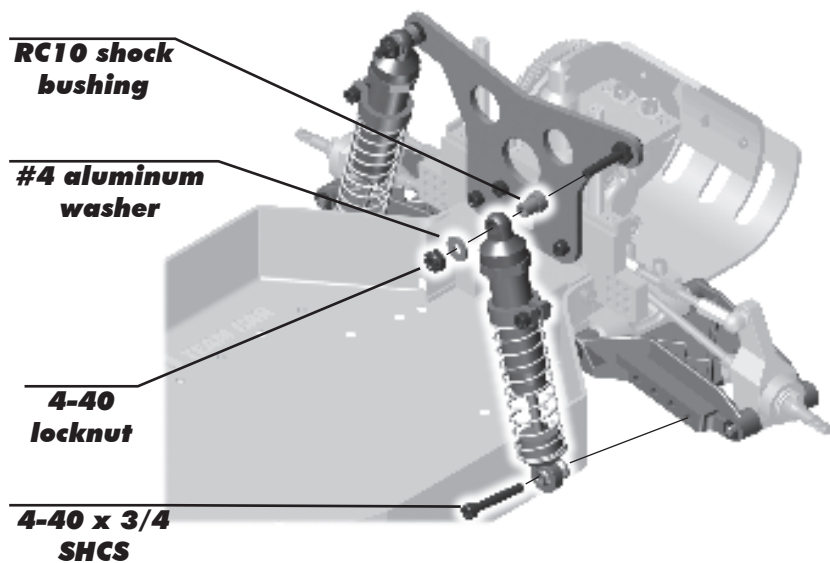

## :: Chassis Build - Bag H - Step 1

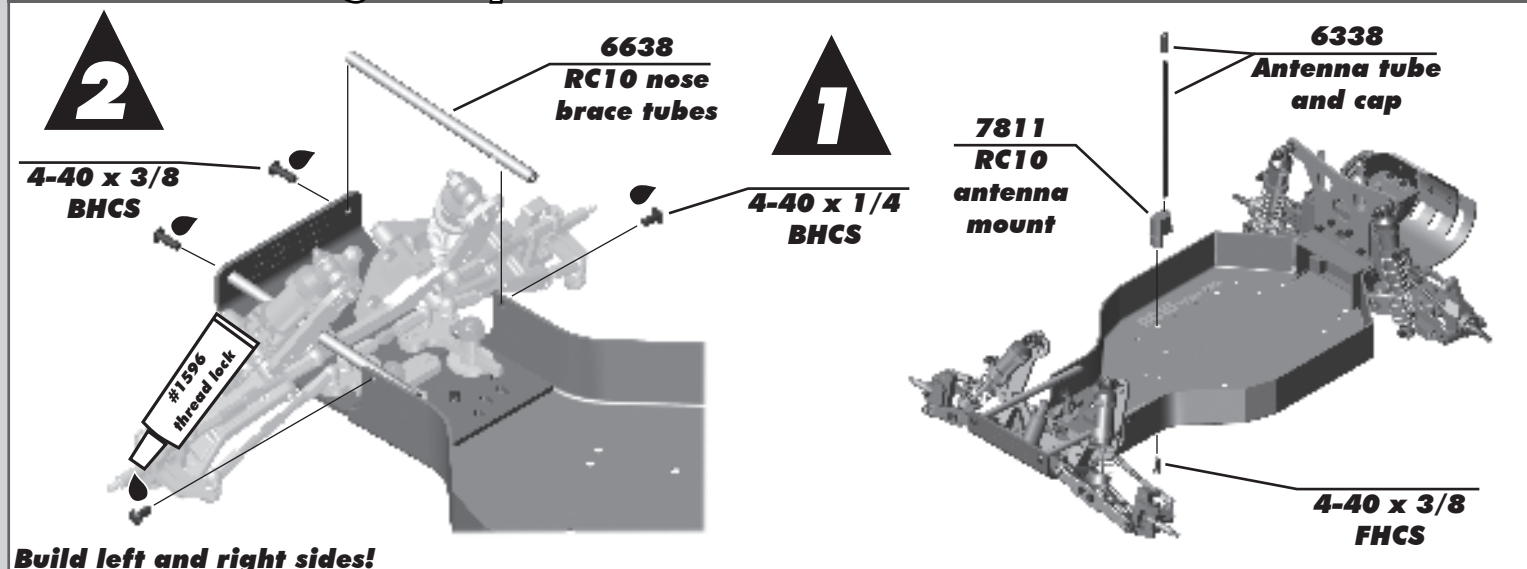

## :: Chassis Build - Bag H - Step 2

## :: Electronics Build - Bag I - Step 1

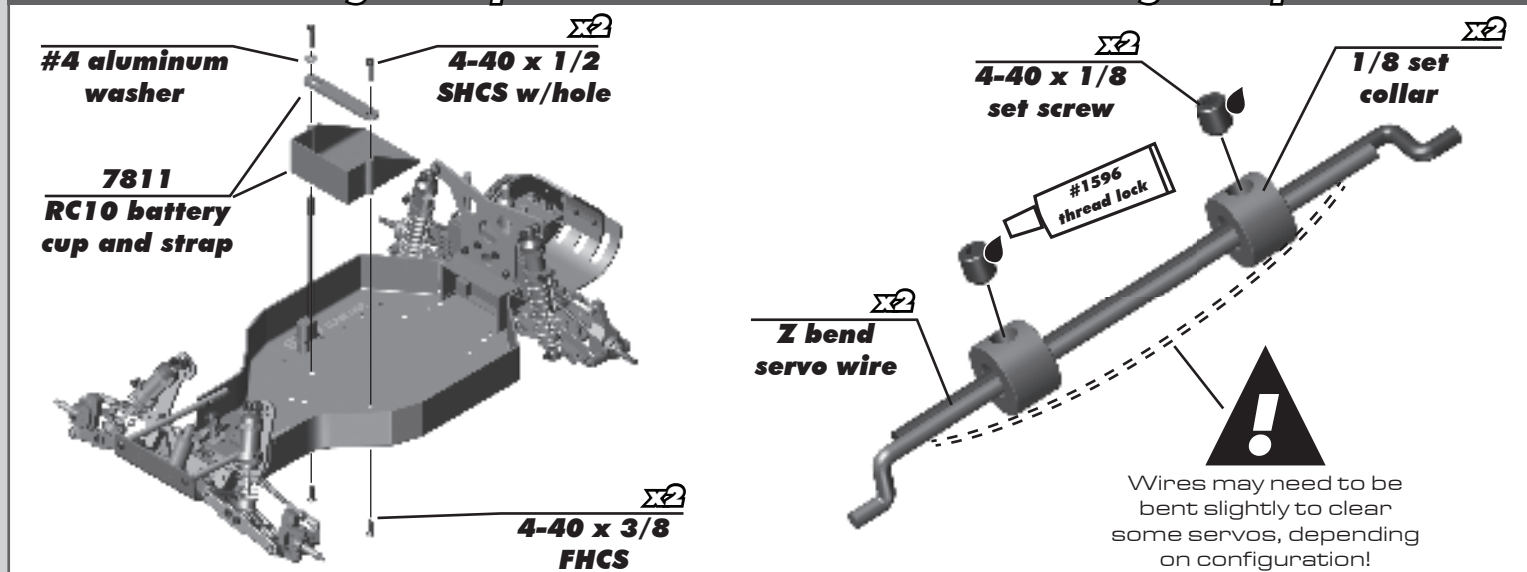

## :: Electronics Build - Bag I - Step 2

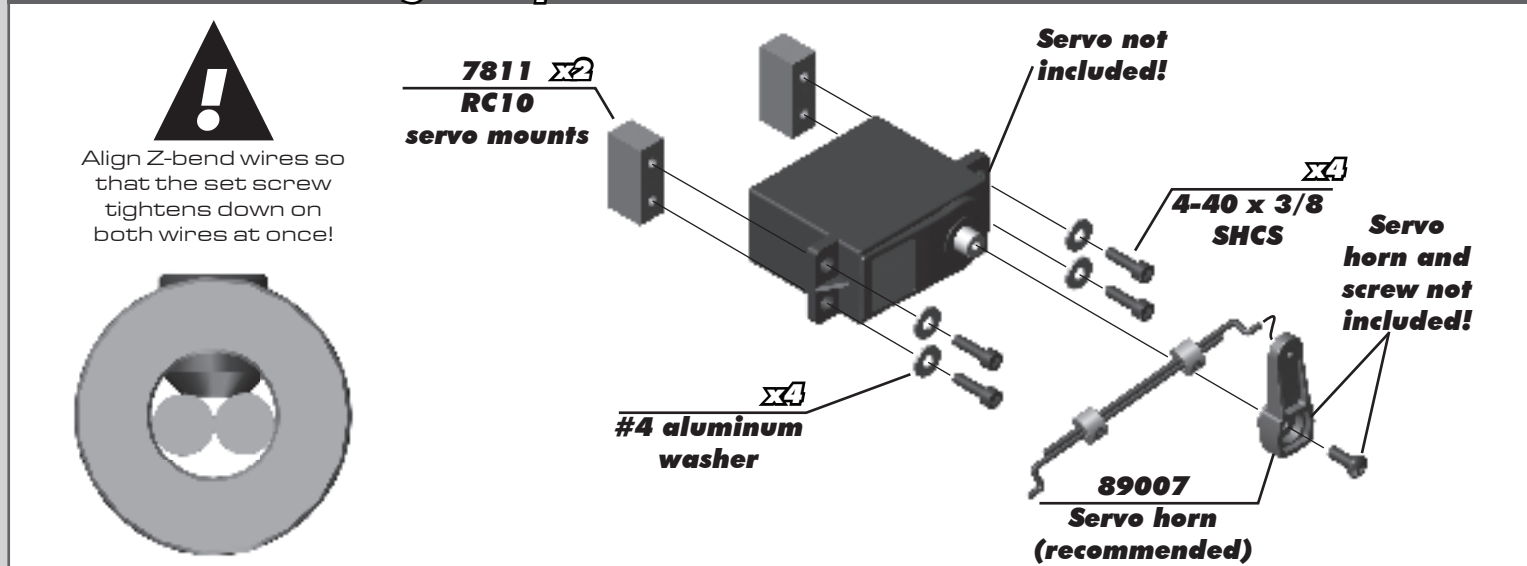

### :: Electronics Build - Bag 1 - Step 3

Follow steps below to properly install Z bend wire into servo horn and steering link.



**NOTE:** Hole choice may vary depending on servo and servo horn used.

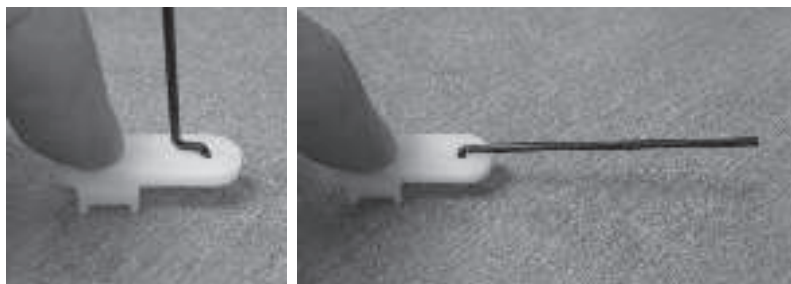

- 1) Press down on the Z bend wire....
- 2) Rotate the wire so the Z bend wire is fully installed into steering link as shown.

**TIP:** Chamfering the top of the hole slightly will help to press in Z bend wire.

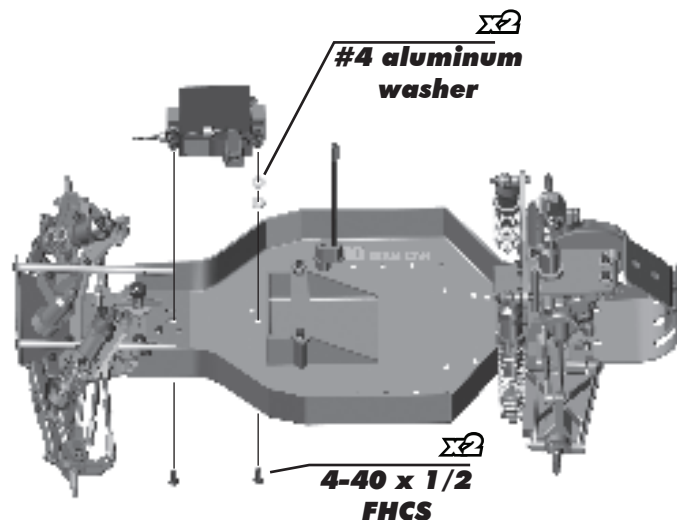

### :: Electronics Build - Bag 1 - Step 4

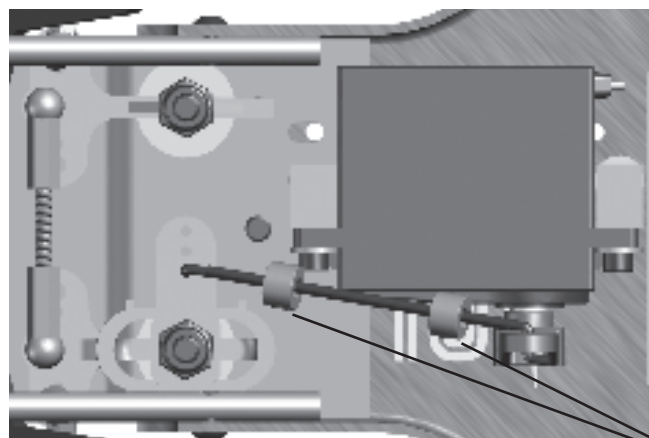

Install Z bend servo wire into steering bellcrank as shown. Ensure that full steering throw can be achieved with your servo horn setup!



Space collars as wide as possible while still clamping both wires.

**Receiver not included!**

**ESC not included!**

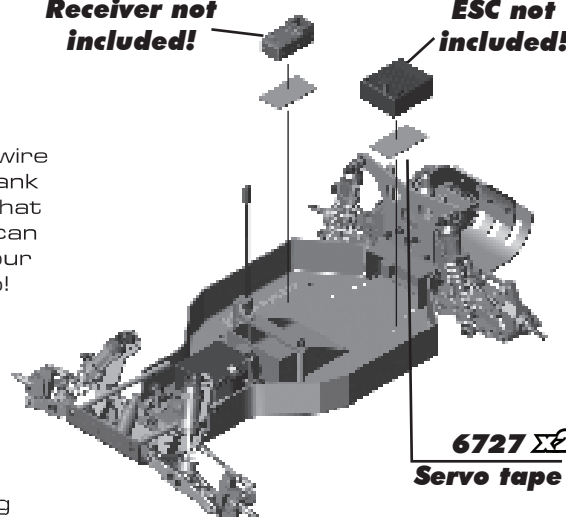

### :: Electronics Build - Bag 1 - Step 5

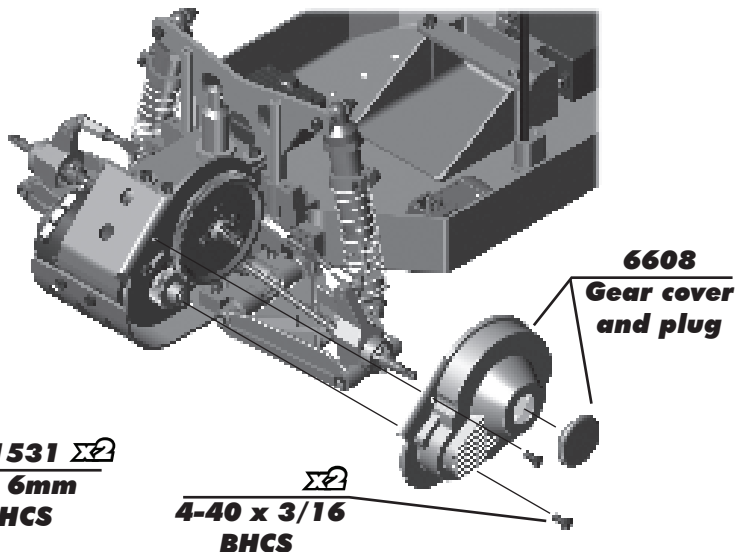
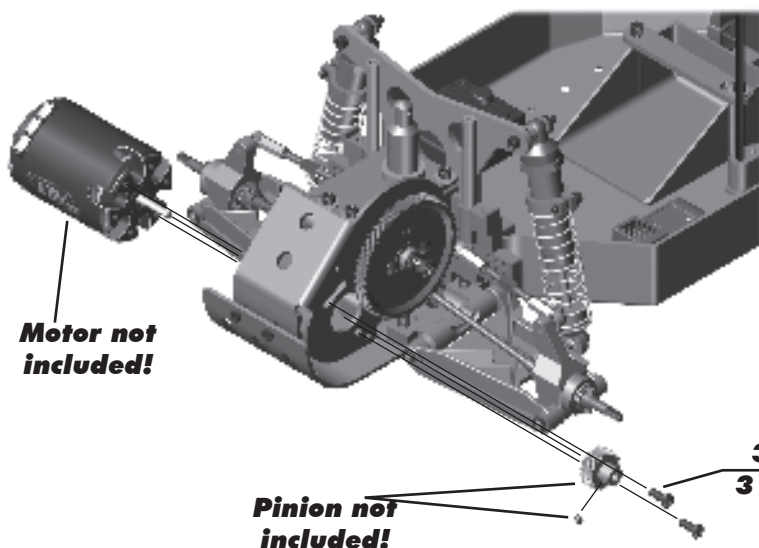

## :: Electronics Build - Bag I - Step 6

**Battery not included!**

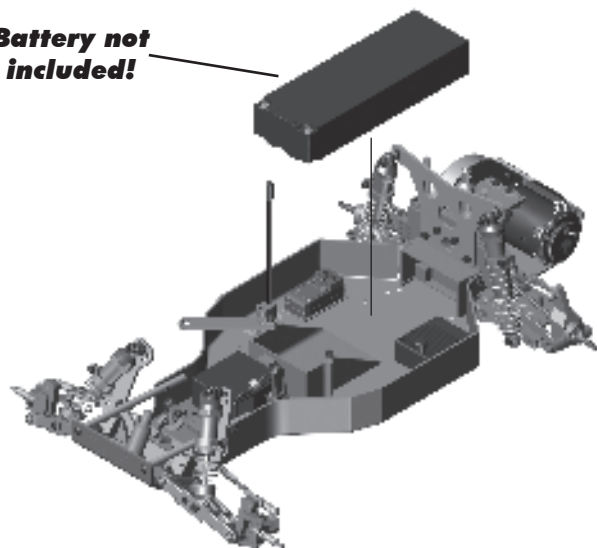

**6332**  
**Body clip**

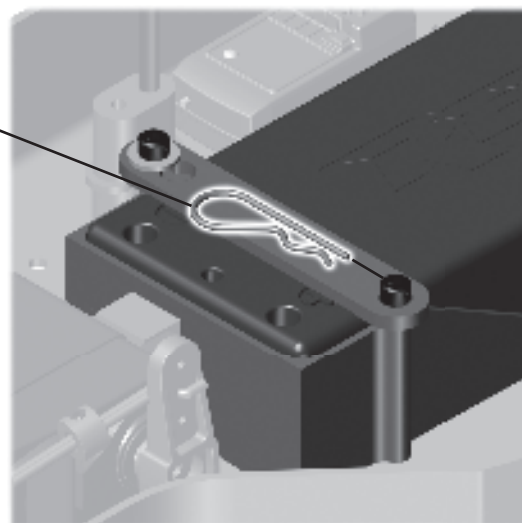

## :: Wheels / Tires and Body - Bag J - Step 1

**6872**  
**Front Tire,**  
**Ribbed**



**6852**  
**Front wheels,**  
**1 Piece**

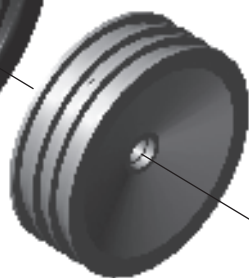

**Flanged Bearing**  
**3/16 x 5/16 x 1/8**

**Σ2**

**4-40**  
**locknut**

**Σ2**

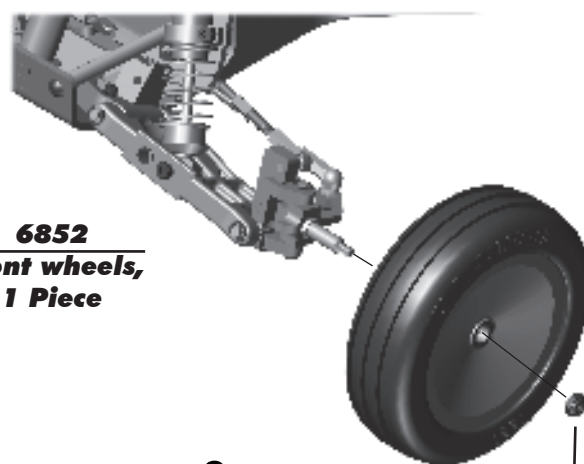

**Pro Tip!**  
Front tires may fit tight  
on the front wheels.  
Use a drop of water to  
lubricate the tire bead  
during installation.

**Build 2**

## :: Wheels / Tires and Body - Bag J - Step 2

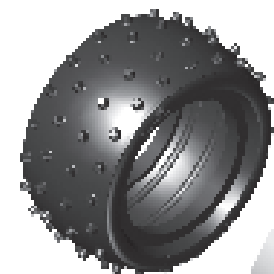

**6822**  
**RC10**  
**rear tire**  
**2.0"**

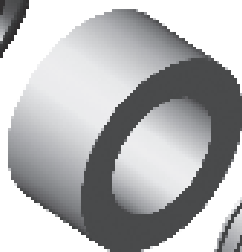

**6806**  
**RC10 rear**  
**wheel**  
**2.0"**

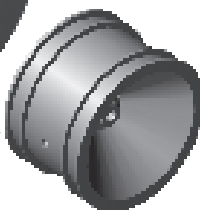

**8-32 steel**  
**locknut**

**Σ2**

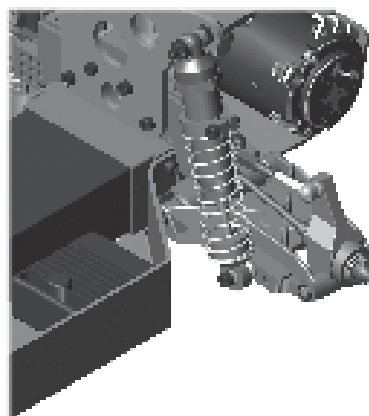

**Build 2**



## :: Wheels / Tires and Body - Bag J - Step 3

### Painting Tips:

Your RC 10 Kit comes with a clear polycarbonate body and wing. You will need to prep the body and wing before you can paint them. Wash the inside thoroughly with warm water and liquid detergent. Dry the body and wing using a clean, soft, lint-free cloth. Use high quality masking tape to make masks for the windows and install them on the inside of the body (RC cars get painted from the inside).

Using high quality masking tape, apply tape to the inside of the body to create a design. Spray (either rattle can or airbrush R/C specific paint) the paint to the inside of the body (preferably dark colors first, lighter colors last).

NOTE: use ONLY paint that is recommended for use with (polycarbonate) plastics. If you do not, you can destroy the plastic body and wing!!!!).

It is recommended to wear a mask while painting.

After the paint has dried, cut the body and wing along the trim lines. Make sure to drill or use a body reamer to make the holes for the body mounts, wing mounts, and antenna!

**6159**  
**RC10 Protech**  
**Buggy body,**  
**unpainted**



## :: Wheels / Tires and Body - Bag J - Step 4

### Light Buckets:

Press the light bucket halves together.

Install light buckets with 2-56 x 3/16 SHCS in areas shown.

**6639**  
**Light**  
**buckets**

**x4**  
**2-56 x 3/16**  
**SHCS**

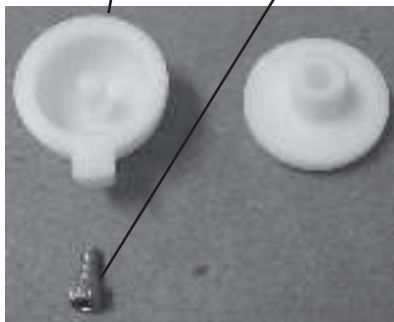

Mount the light buckets in any location of your choosing, or not at all.



## :: Wheels / Tires and Body - Bag J - Step 5

### Painting Tips:

Driver :

Your RC 10 Kit comes with a clear polycarbonate driver figure. You will need to prep the driver figure before you can paint it. Wash the inside and outside thoroughly with warm water and liquid detergent. Dry the driver figure using a clean, soft, lint-free cloth. The driver figure can be painted from the inside or the outside, depending on what type of finish you would like. If painted from the inside, the painted sections will appear glossy. If painted on the outside, the painted sections will appear flat or matte finished. Trim as shown and install inside the body using strapping tape. After painting, cut the body and wing along the trim lines.

NOTE: use ONLY paint that is recommended for use with (polycarbonate) plastics. If you don't, you can destroy the plastic body, driver figure, and wing!!!!.

**RC10 driver**  
**figure, clear**





## :: Wheels / Tires and Body - Bag J - Step 6

**6332**  
**Body**  
**clip**

**6332**  
**Body**  
**clip**

**6121**  
**RC10**  
**Viper body,**  
**clear**

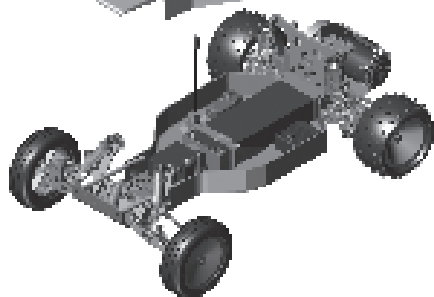

**6639**  $\Sigma 2$   
**Wing**  
**mounts**

**6182**  
**High downforce**  
**wing, 5.5"**

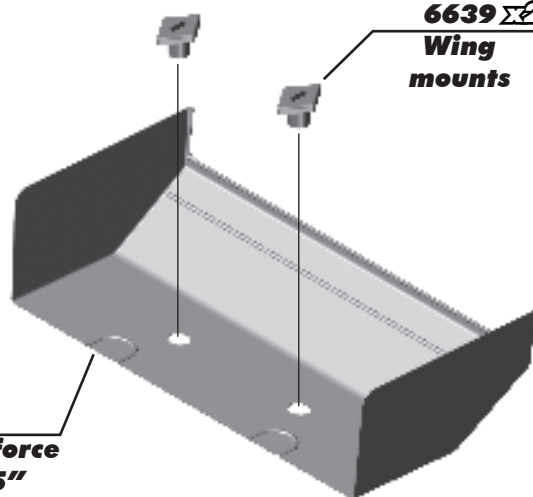

## :: Wheels / Tires and Body - Bag J - Step 7

**Wing mount**  
**wire**

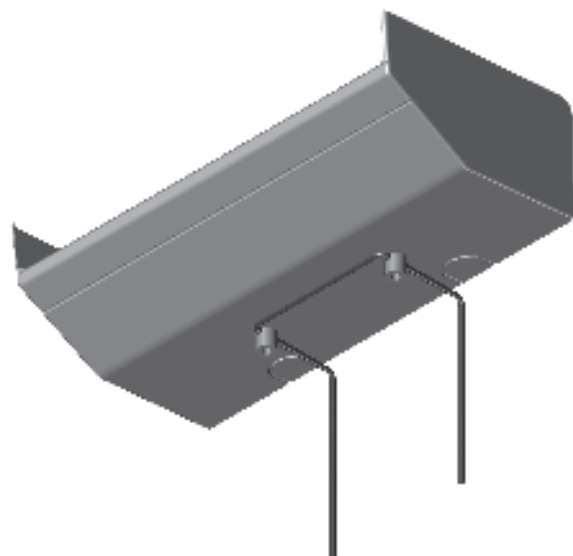
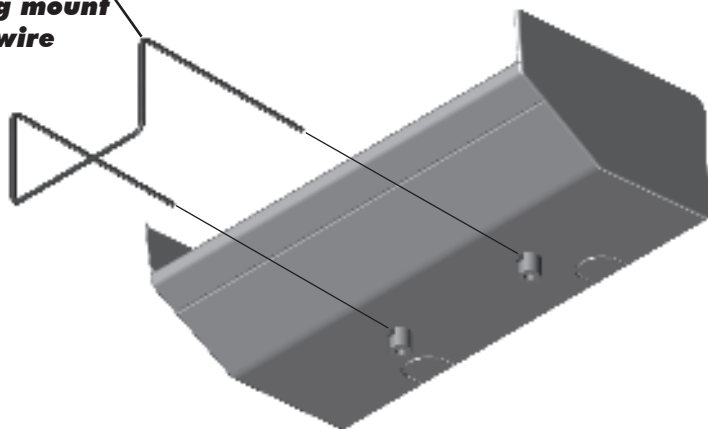

## :: Wheels / Tires and Body - Bag J - Step 8

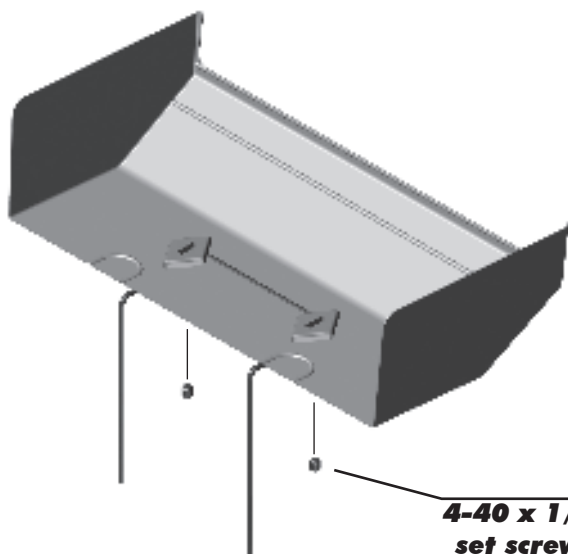

$\Sigma 2$   
**4-40 x 1/8**  
**set screw**

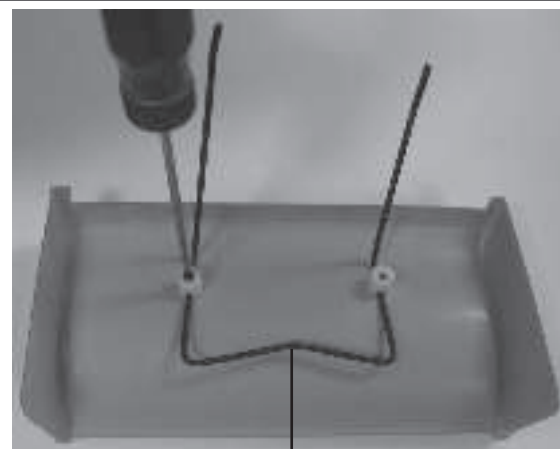

**TIP:** Bending the wire as shown can help ensure the wing buttons are parallel.

**:: Wheels / Tires and Body - Bag J - Step 9**

**TIP:** Bend wire to create tight fit inside wing tubes.

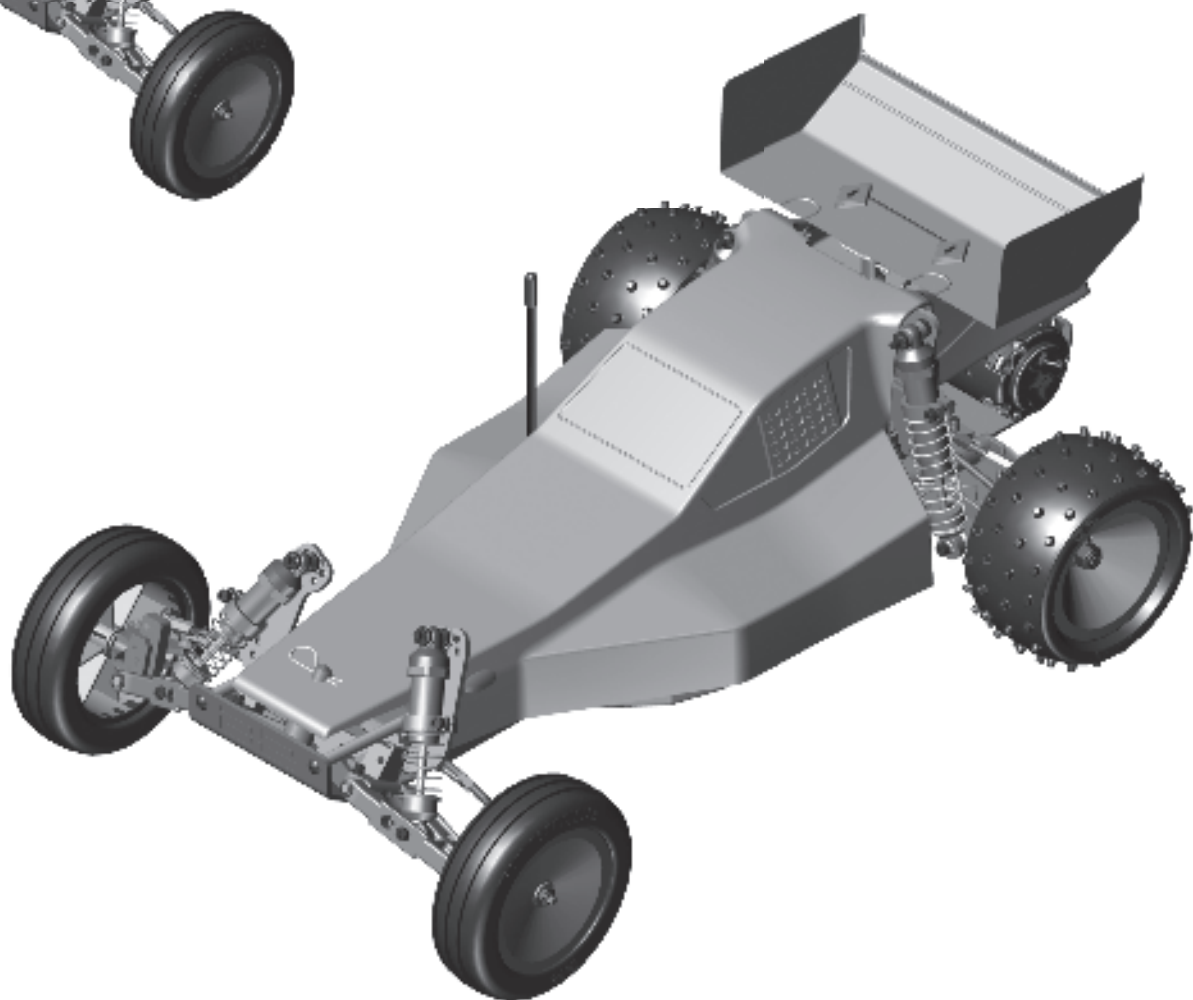
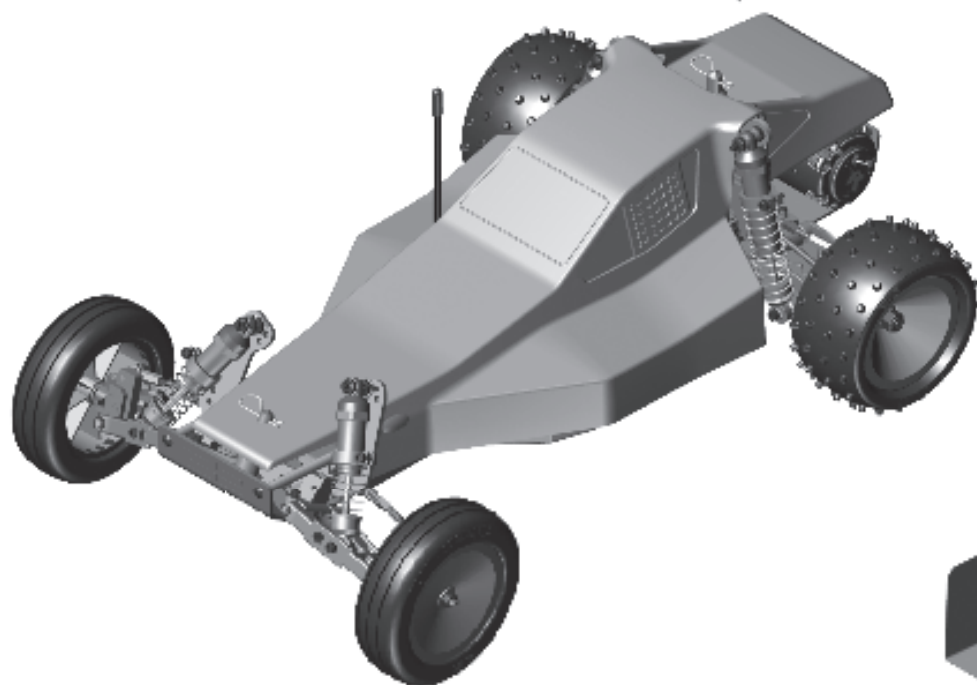
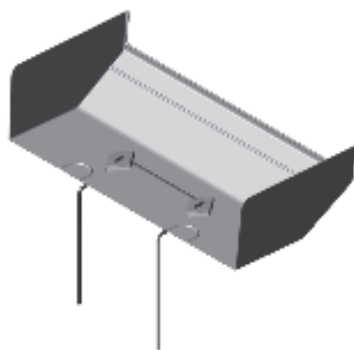

**:: Notes**

**FIND IT ON ASSOCIATEDELECTRICS.COM**



**CARS & TRUCKS**

**Vehicle Spare Parts**

**GO TO:**

**AssociatedElectrics.com →**  
**Team Associated tab →**  
**Cars & Trucks →**  
**Scroll to your vehicle →**  
**Parts & Accessories link**



**SETUP SHEETS  
& MANUALS**

**Setups and Manuals**

**GO TO:**

**AssociatedElectrics.com →**  
**Team Associated tab →**  
**Manuals & Setups →**  
**Scroll to your vehicle**



**A-TEAM APPS**

**Tuning Guides & Tips**

**GO TO:**

**AssociatedElectrics.com →**  
**Support →**  
**A-Team Apps**



***Associated Electrics, Inc.***

**21062 Bake Parkway Lake Forest, CA 92630 USA**

**call: (949) 544-7500 - fax: (949) 544-7501**

**Check out the following web sites for all of our kits, current products,  
new releases, setup help, tips, and racing info!**

***www.AssociatedElectrics.com***

**FOLLOW US ON SOCIAL MEDIA**



**TeamAssociated**  
**ReedyPower**  
**ElementRC**  
**Factory Team**



**@TeamAssociatedRC**  
**@ReedyPower**  
**@Element\_RC**  
**@FactoryTeam\_RC**



**@Team\_Associated**  
**@ReedyPower**



**@Associated\_Electrics**