

QUIKCELL®

# QAIR STEMS™

True Wireless Earbuds &  
Wireless Charging Case

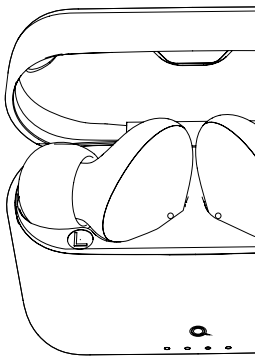

QUICK START GUIDE  
GUIDE DE DÉMARRAGE RAPIDE  
GUÍA DE INICIO RÁPIDO

# SPECIFICATIONS

**BT Version: Bluetooth 5.3**

**Speaker Frequency Response: 20HZ –20,000HZ**

**Battery Type: Li-ion battery**

**Earbuds Battery Capacity: 40mAh\*2**

**Charging Case: 400mAh**

**Playtime: 5.5+15.5 hours**

**Talking Time: 5.5 hours**

**Charging Time: 90 minutes**

**Wireless Range: 10m**

**Waterproof: IPX4**

**Earbud Size: 21mm x 18mm x 32.2mm**

**Charging Case Size: 52.7mm x 44mm x 22.2mm**

**Weight: 3.4g**

**Wireless Charging: Support up to 5W wireless charging**

# WHAT'S INSIDE

- 1 2 Wireless Earbuds
- 2 Wireless Charging Case
- 3 USB-C Charging Cable
- 4 S/M/L Ear Tips

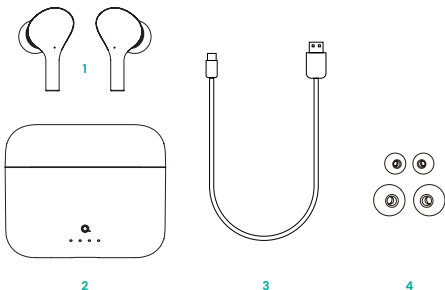

# QAIR STEMS CONTROLS

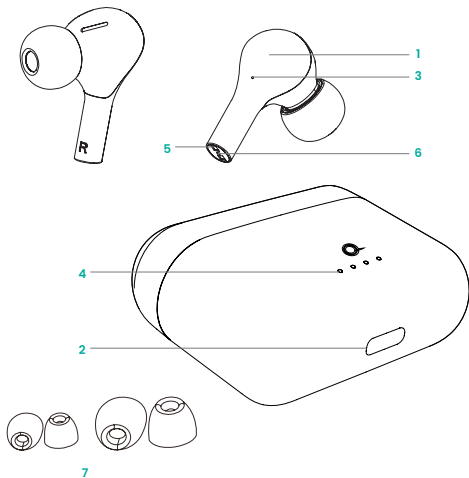

## 1 Multi-Function Buttons:

- Long Press Left or Right earbud button = reject call
- Long Press Left earbud button = decrease volume
- Long Press Right earbud button = increase volume

# QAIR STEMS CONTROLS

- Long Press Right earbud button (+3 seconds) = turn earbuds ON
- Long Press Right earbud button (+7 seconds) = turn earbuds OFF
- Short Press Left or Right earbud button = play/pause music & answer/end calls
- Double Press Left earbud button = skip to previous song
- Double Press Right earbud button = skip to next song
- Triple Press Left earbud button = activate voice assistant
- Press Left or Right earbud button 5 times = switch between gaming mode and music mode

2 USB-C Charging Port

3 Earbuds Indicator Light

4 Charging Case Indicator Lights

5 Charging Pins

6 Microphone

7 Small, Medium, and Large gel ear-tips  
(medium ear-tips are attached by default)

## STEP 1

### POWER ON.

Earbuds automatically power ON when removed from their charging case and you hear “Power On” play through the speakers. Earbuds are automatically turned OFF when returned to their charging case OR when they do not pair with a device after 5 minutes out of their charging case.

(Multi-Function Button does not turn earbuds ON/OFF automatically)

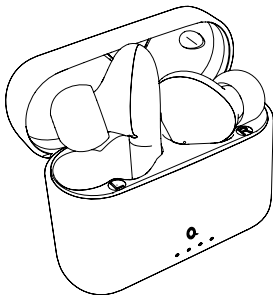

## STEP 2

### CONNECT YOUR STEMS.

After you've removed your earbuds and listened for the "Power On", sit your earbuds side by side. You will then hear "Connected" followed by "Left Channel Connected, Right Channel Connected".

(How to restore earbuds to factory settings: Ensure the QAir Stems are disconnected from the Bluetooth device, or the Bluetooth device is turned off. Then press either the Left or Right earbud 8 times until you see the WHITE light flash repeatedly.)

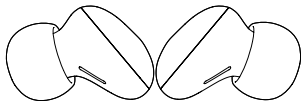

## STEP 3

### PARING YOUR DEVICE.

Now that your earbuds are paired to one another, you can pair them with your device. In your devices Bluetooth settings look for “QAIRSTEMS” to appear as an option and select to complete pairing. When earbuds are paired you will hear “Bluetooth Connected”.

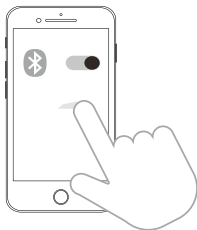



## STEP 4

### LOW POWER? DROP & CHARGE!

#### Wireless Charging

Charge your QAir Stems wirelessly. The QAir Stems charging case supports wireless charging using a wireless charger. While charging, you will see the charging case indicator lights go from 1 BLUE light while charging to all 4 BLUE lights lit when fully charged.

#### Wired Charging

You can also charge your QAir Stems case using the included USB-C charging cable connecting it to a USB power adapter or computer USB port to charge the earbuds. While charging, you will see the charging case indicator lights go from 1 BLUE light while charging to all 4 BLUE lights lit when fully charged.

*\*Wireless charger and USB power adapter are not included. Maximum DC 5V, excessive voltage will damage the charging case.*

See next page for charging your earbuds.

## STEP 5

### CHARGE YOUR STEMS.

When your earbuds are running low on power, you will hear “Battery Low” every 90 seconds until they are placed in the charging case.

Earbuds automatically charge when they are in the charging case (whether the case is on a charger or not, if the case has charge it will power the earbuds). While the earbuds are charging the earbuds indicator light will remain WHITE and will stop when the earbuds are fully charged.

(Keep in Mind: If you only use one earbud for listening you must remove the unused earbud from the charging case before placing the used earbud in it. The two earbuds should always be put back in the charging case together to avoid failure to charge.)

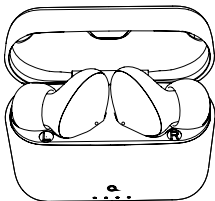



#### ONE YEAR LIMITED WARRANTY

Garantie limitée de 1 an

Garantía limitada de un año, visite

visit [quikcell.com/warranty](http://quikcell.com/warranty)

Visitez le site [Quikcell.com/warranty](http://Quikcell.com/warranty)



© 2023 All rights reserved. Alphacomm, Quikcell and QAir Stems are registered trademarks of Alpha Comm Enterprises, LLC. All other trademarks are the property of their respective owners. Designed by Alpha Comm Enterprises, LLC at

© 2023 Tous droits réservés. Alphacomm, Quikcell et QAir Stems sont des marques déposées d'Alpha Comm Enterprises, LLC. Toutes les autres marques de commerce appartiennent à leurs propriétaires respectifs. Conçu par Alpha Comm Enterprises, LLC au

Diseñado por Alpha Comm Enterprises, LLC en

1500 Lakes Parkway, Lawrenceville, GA.30043.



#### QAir Stems™

QAIRSTEMS-BLK, QAIRSTEMS-WHT

FCC ID: 2BCKH-W10A

Alpha Comm Enterprises Inc., LLC

1500 Lakes Parkway Lawrenceville GA 30043.

1-888-951-0909

Note: This equipment has been tested and found to comply with the limits for a Class B digital device, pursuant to part 15 of the FCC Rules. These limits are designed to provide reasonable protection against harmful interference in a residential installation. This equipment generates, uses and can radiate radio frequency energy and, if not installed and used in accordance with the instructions, may cause harmful interference to radio communications. However, there is no guarantee that interference will not occur in a particular installation. If this equipment does cause harmful interference to radio or television reception, which can be determined by turning the equipment off and on, the user is encouraged to try to correct the interference by one or more of the following measures:

- Reorient or relocate the receiving antenna.
- Increase the separation between the equipment and receiver.
- Connect the equipment into an outlet on a circuit different from that to which the receiver is connected.
- Consult the dealer or an experienced radio/TV technician for help.

This device complies with part 15 of the FCC Rules. Operation is subject to the following two conditions:

(1) This device may not cause harmful interference, and (2) this device must accept any interference received, including interference that may cause undesired operation.

Any changes or modifications not expressly approved by the party responsible for compliance could void the user's authority to operate the equipment.

The device has evaluated to meet general RF exposure requirement. The device can be used in portable exposure without restriction.