

## Varos Socket 5A60 / Varos Liner 6Y200

Right from the start.

### Adjustable, customizable and lightweight

The Varos socket and Varos liner are recommended as a combination for reliable interim and definitive fittings for users with a transfemoral amputation – right from the start. The customizable modular socket components allow for quick assembly and adaptation to the patient model or patient directly. This significantly reduces both the number and duration of visits the patient requires for adjusting the prosthesis. The Varos socket is combined with a specific silicone liner that works to evenly distribute pressure on the residual limb and locks magnetically to the distal socket end.

As a result, the combination of the Varos socket and Varos liner offers your users the advantages of high flexibility and functionality in comparison with conventional sockets. For example, it's easy for the user to put on and take off the socket – even when sitting. Thanks to the Boa Fit System, users can adjust the Varos socket themselves and adapt it to various residual limb volumes and activities if needed.

### Technical data

#### Varos socket

<b>Article number</b>	5A60=L-M	5A60=R-M
<b>Side</b>	Left (L)	Right (R)
<b>Distal connection</b>	Four-hole connection	Four-hole connection
<b>Residual limb length</b>	200–320 mm	200–320 mm
<b>Distal residual limb circumference</b>	350–440 mm	350–440 mm
<b>Proximal residual limb circumference</b>	460–580 mm	460–580 mm
<b>Mobility grade</b>	1–4	1–4
<b>Max. body weight</b>	220 lbs (100 kg)	220 lbs (100 kg)
<b>Weight</b>	47 oz (1320 g)*	47 oz (1320 g)*

\*before being shortened

#### Varos liner

<b>Article number</b>	6Y200=M-1	6Y200=M-2
<b>Distal residual limb circumference</b>	350–410 mm	380–440 mm

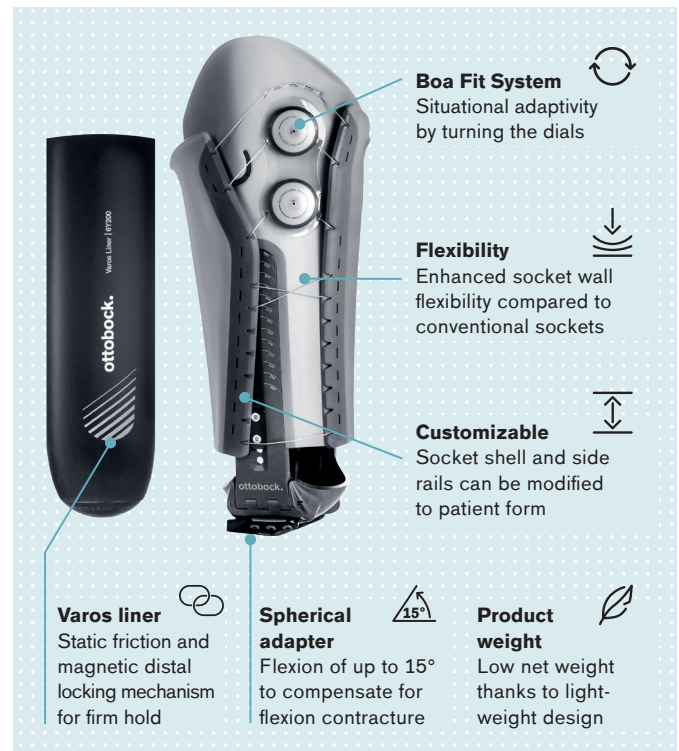

### Benefits at a glance

#### Benefits for CPO:

- Easier and faster fitting thanks to innovative Varos modular socket structure
- Custom made to the patient model or direct with patient with easy adaptability
- Thermoformable material for patient specific customizations
- Typically only one patient visit needed to achieve a good fitting result
- Easy alignment optimization (spherical adapter allowing for a hip flexion up to 15°)

#### Benefits for User:

- Adjustable socket for limb volume variations and different activities (Boa Fit System)
- High wearing comfort
- Secure hold in the socket (magnetic distal liner connection, good static friction properties of the specific Varos liner)
- Lightweight construction
- Easy donning and doffing even when seated