

90 mm

130 mm

7-Color Backlit Wireless Keyboard

ISJ-DJC03

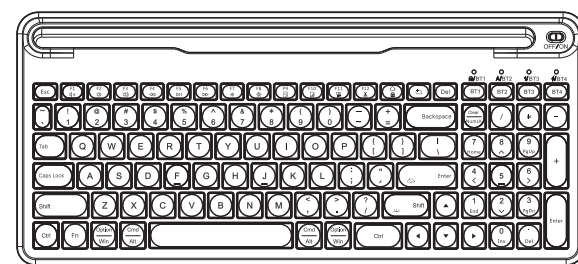

User Manual



20210716

Thank you very much for purchasing this backlit wireless Bluetooth keyboard. Please email us if you have any question or suggestion for this product. We will do our best to assist you.

Product Information

Bluetooth version: Bluetooth 5.1 Keyboard
Working range: 10 M
Battery capacity: 1600 mAh
Working current (without backlight): 1.5 mA
Working hours (without backlight): 1000hours
Working current with the brightest backlight: 200 mA
Working time with the brightest backlight: 8 hours
Charging time: 3 hours
Standby time: 2100 hours
Backlight sleep mode: after 2 minutes of not use
Keyboard sleep mode: after 30 minutes of not use

Package Content

- ▶ Backlit Wireless Bluetooth Keyboard * 1
- ▶ Type C Charging Cable * 1
- ▶ User Manual * 1

LED Indicator Light

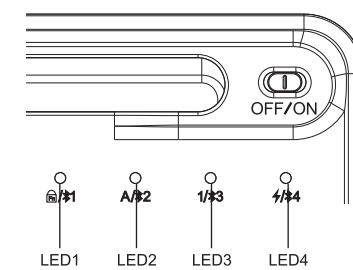

Press "Fn Lock", the LED1 flashes green light
Press "Caps Lock", the LED2 flashes green light
Press "Number Lock", the LED3 flashes green light
LED4 flickers red light slowly if the keyboard is under low battery
LED4 flashes red light while charging and will be off if fully charged

Back Light User Guide

1. Press and hold **Fn** key, press **Shift** key to adjust the brightness of the backlight: Low-Mid-High-Off.
2. Press and hold **Fn** key, press **enter** key to adjust backlight colors, 7 colors in total.

Warning

1. Do not squeeze, twist or hit the keyboard.
2. Do not put this product in microwave, or strong magnetic field.
3. Prevent splashing, make sure the using environment is dry.
4. Please use a soft dry cloth material to clean the keyboard. Remember to turn off the keyboard when not using.

Troubleshooting Common Problems

1. Make sure your keyboard is fully charged before use.
2. Make sure your keyboard is in its working range, (11 yards)
3. Make sure you have turned on the Bluetooth functioned when you connect.
4. Make sure you have been successfully paired to the tablet.
5. Clean up the Bluetooth pairing devices on your laptop and try repairing.
6. Do not pair multiple keyboards to the same device.

How to Connect my Device to #2 or #3 or #4 Channel

1. Hold and press **Fn**, then press **2**, **3** or **4** key to switch to the corresponding Bluetooth Channels, and then press Connect button until the LED indicator light flashes quickly, you can follow the connection steps of your device above to connect the keyboard.

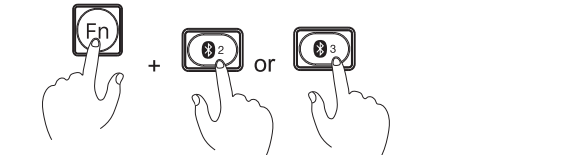

2. When you successfully connected 2 or 3 or 4 devices, you can switch among the devices easily by pressing the button **Fn**, **2**, **3**, **4**, **5**, **6**, **7**.

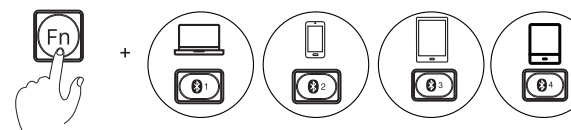

3. The keyboard supports auto-reconnect. It will automatically connect to the previous device when you turn on the keyboard, (make sure you have turned on the Bluetooth). If you connect the keyboard to two or three devices, when you turn on the keyboard, it will automatically connect to the last connected device.

IPad/iPhone Pairing Steps

1. Turn on the keyboard. Hold and press **Fn** key, press **2** key. LED1 Blue light will be on for 1s and then off.



2. Press and hold **2** for 3s, LED1 blue light flashes quickly, your keyboard enters pairing mode and waiting for
3. Find "settings" on your device and turn on "Bluetooth".



4. Find "Bluetooth 5.1 Keyboard", click pair.

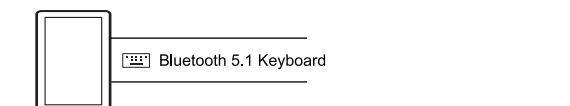

5. Click "connected", and your keyboard have been successfully connected to your device.

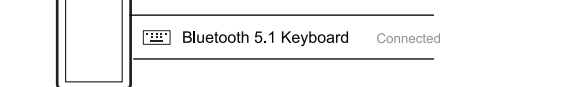

Please Note:

Once you have connected the keyboard, please follow the following steps to finish the setup. Otherwise, they might not be able to function properly.

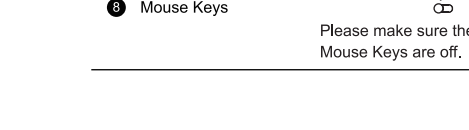
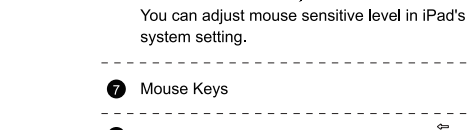
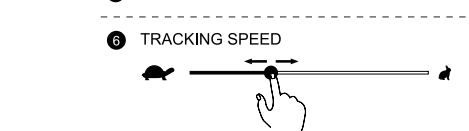
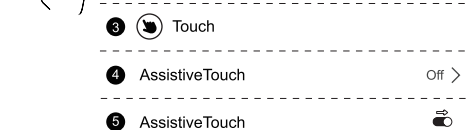
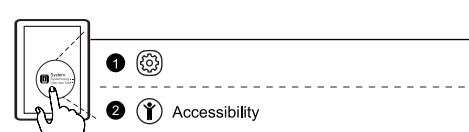

Hua Wei Tablet Pairing Steps

1. Turn on the keyboard. Hold and press **Fn** key, press **2** key. LED1 Blue light will be on for 1s and then off.

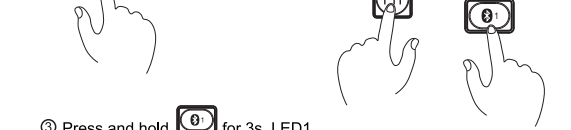

2. Press and hold **2** for 3s, LED1 blue light flashes quickly, your keyboard enters pairing mode and waiting for



3. Find "Settings" on your device and turn on "Bluetooth".

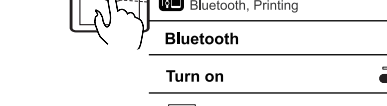

4. Click "connected", and your keyboard have been successfully connected to your device.

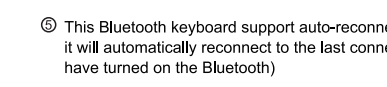

Samsung Tablet Pairing Steps

1. Turn on the keyboard. Hold and press **Fn** key, press **2** key. LED1 Blue light will be on for 1s and then off.

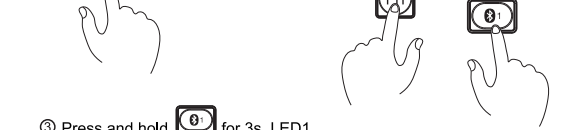

2. Press and hold **2** for 3s, LED1 blue light flashes quickly, your keyboard enters pairing mode and waiting for



3. Find "Settings" on your device and turn on "Bluetooth".

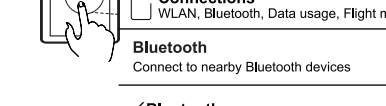

4. Click "connected", and your keyboard have been successfully connected to your device.



Pairing Steps For Tablet With Windows System

1. Turn on the keyboard. Hold and press **Fn** key, press **2** key. LED1 Blue light will be on for 1s and then off.

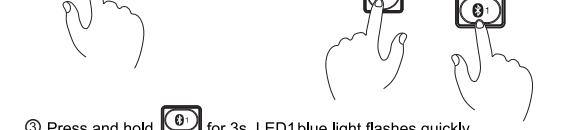

2. Press and hold **2** for 3s, LED1 blue light flashes quickly, your keyboard enters pairing mode and waiting for



3. Turn on Bluetooth on your device, search for "Bluetooth 5.1 keyboard", pair.

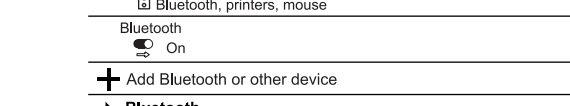

4. The keyboard connects in few seconds.

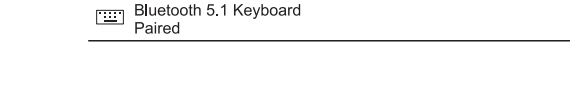

Mac Pairing Steps

1. Turn on the keyboard. Hold and press **Fn** key, press **2** key. LED1 Blue light will be on for 1s and then off.

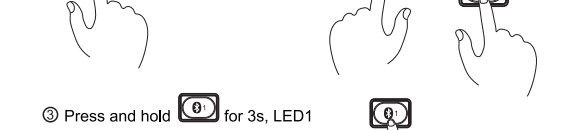

2. Press and hold **2** for 3s, LED1 blue light flashes quickly, your keyboard enters pairing mode and waiting for

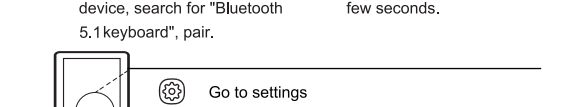

3. Turn on Bluetooth on your device, search for "Bluetooth 5.1 keyboard", pair.

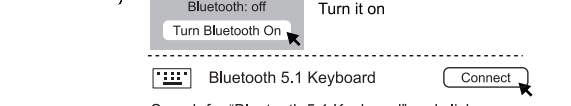

4. The keyboard connects in few seconds.

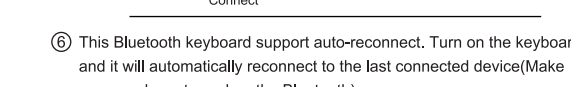

材质：128g哑粉纸
尺寸：90x130mm
工艺：双面印刷 骑马钉