

5. User controls and hearing aid adjustments

Your Hearing Care Professional can provide you with details on your hearing aid controls and adjustments available to you. Your Hearing Care Professional can enable the rocker switch to control volume, hearing programs, and make other adjustments to your hearing aids.

- Your hearing aids automatically adjust their volume and sound to your specific listening situation. An optional signal can indicate volume change. Once the maximum or minimum volume has been reached, you may hear an optional signal tone. The rocker switch can also be used to change hearing programs.

- The miniPocket remote control can adjust volume and programs of your hearing aids.

- The Signia app can change volume, hearing programs, and make other adjustments to your hearing aids. Download the Signia app from the App Store or Google Play store.

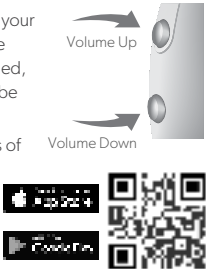

6. Charging your hearing aids

Refer to your charger user guide for instructions and useful tips for charging.

- Before placing your hearing aids in the charger, clean the hearing aid charging contacts. See section 8 for details.
- Place your hearing aids in charger.
- A full charging cycle takes about 4 hours. After 30 minutes, it is possible to use your hearing aids for up to 6 hours. Charging times may vary due to the use of the hearing aids and the age of the power cell.
- We recommend charging your hearing aids overnight so you can be sure to start your day with fully-charged hearing aids.

7. Low power indication

- You will hear an alert signal to indicate the battery is running low.
- The signal will be repeated every 15-30 minutes until the hearing aid stops working and needs to be recharged.
- Once you hear the low battery indicator, you have about 1.5 hours of charge left in your hearing aids depending on your usage.

8. Hearing aid maintenance and care

Ask your Hearing Care Professional for assistance with care and maintenance of the hearing aids, eartips and charger as needed. Your Hearing Care Professional can also provide recommendations for cleaning care products, hearing aid drying products, special care sets, or more information on how to keep your hearing aids and charger in good condition.

Cleaning hearing aids

- Your hearing aids have a protective coating. However, if not cleaned regularly, you may damage the hearing aids or cause personal injury.
- Use a soft, dry tissue or other cleaning tools/solutions recommended by your hearing care provider.
- Clean your hearing aid(s), the charging contacts, and earmolds DAILY right after removing them from your ears to prevent earwax from drying and hardening.
- Earwax accumulation on the charging contacts will affect the ability to charge the hearing aid.
- Earwax wax accumulation on the earmold may affect sound quality.
- Be careful to not damage the wax protection while cleaning your hearing aids.
- Never apply pressure while cleaning.
- Never use running water or immerse the hearing aids in water.
- Do not use alcoholic solvent on the charging contacts
- Clean the earpieces daily and ask your Hearing Care Professional to clean the tubes or to exchange the ear pieces and tubes as needed.



Cleaning charger

- Disconnect the charger from the power supply.
- Clean the charger with a soft, dry tissue.
- Remove debris from the charging contacts. If debris accumulates on the charging contacts, it will prevent the hearing aid(s) ability to charge.
- Never use running water or immerse the charger in water.



Drying

- Ask your Hearing Care Professional for recommended drying products and for individual instructions on when to dry your hearing aids.

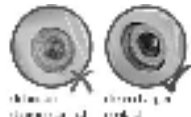

Storage

Short-term storage (up to several days):

- Turn off your hearing aids via the lower part of the rocker switch or place them in a powered charger.
- If the charger is not connected to the power supply when you place your hearing aids in the charger, the hearing instruments are not turned off.
- If the hearing aids are turned off via a remote control or smartphone app, the hearing aids are not completely turned off. They are in standby-mode and still draw some power.

Long-term storage (weeks, months, longer):

- Fully charge your hearing aids and then turn them off via the lower part of the rocker switch before storing them. We recommend storing the hearing aids with drying products recommended by your Hearing Care Professional.
- We recommend recharging your hearing aids every 3 months to avoid damage to the power cell.
- At 6-month intervals you will have to ensure you charge the hearing aids to avoid an unrecoverable deep discharge of the power cell. Deep-discharged power cells cannot be charged anymore and they have to be replaced.

9. Signia Support Website

Visit the Signia Support page for assistance with your hearing aids, Signia app, Bluetooth connectivity, Bluetooth streaming, accessories and FAQs for first-time hearing aid wearers.

<https://www.signia.net/en-us/support/>

10. Signia Consumer Bluetooth Hotline

If you are needing additional assistance with connectivity, you can call the Consumer Bluetooth® Support hotline at (800) 350-6093, open Monday - Friday, 8 a.m. to 8 p.m. Eastern Time Zone.

When calling for troubleshooting, it's helpful to have the hearing aid and smartphone models readily available. Hearing aid model information can be found on in the user manual, paperwork from your Hearing Care Provider, or on the hearing aids themselves. If the information is not easily accessible, don't worry, we will still be able to help!

You can also reach the Consumer Bluetooth Hotline by email: apps.usa@wsa.com. Please include the information mentioned above in your inquiry and we'll be happy to assist.