

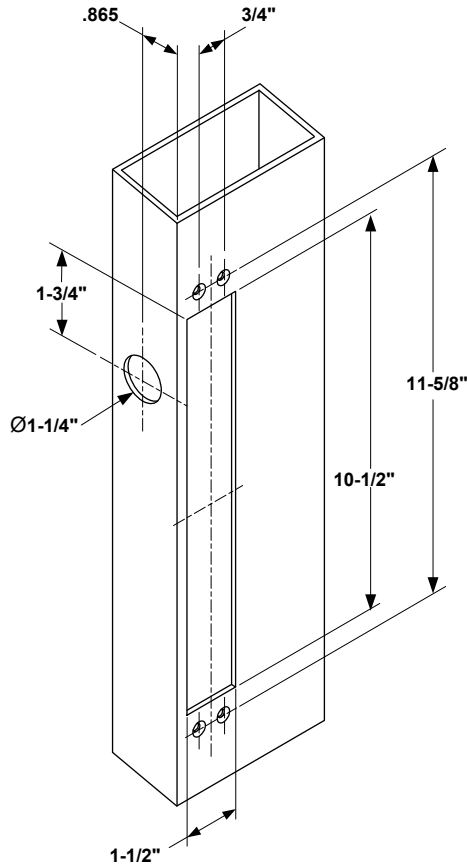

# INSTALLATION INSTRUCTIONS

## 1291AHDMR (.865" BACKSET) CONCEALED MORTISE BOLT LOCK with MECHANICAL RELEASE FAIL-SECURE (SINGLE CYLINDER PREP)

### ALUMINUM FRAME PREPARATION



(8X) TAP TABS  
FOR #10-32

1-1/8" CYLINDER  
(NOT INCLUDED)

Once the Key Cylinder  
is installed. Secure the  
cylinder within the  
guided cylinder slot  
using the Cylinder  
Locking Set screw.

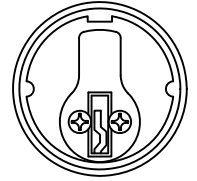

Use standard straight  
cam ILCO (863G) or  
equivalent.

Cylinder  
Locking  
Set Screw

### DOOR PREPARATION

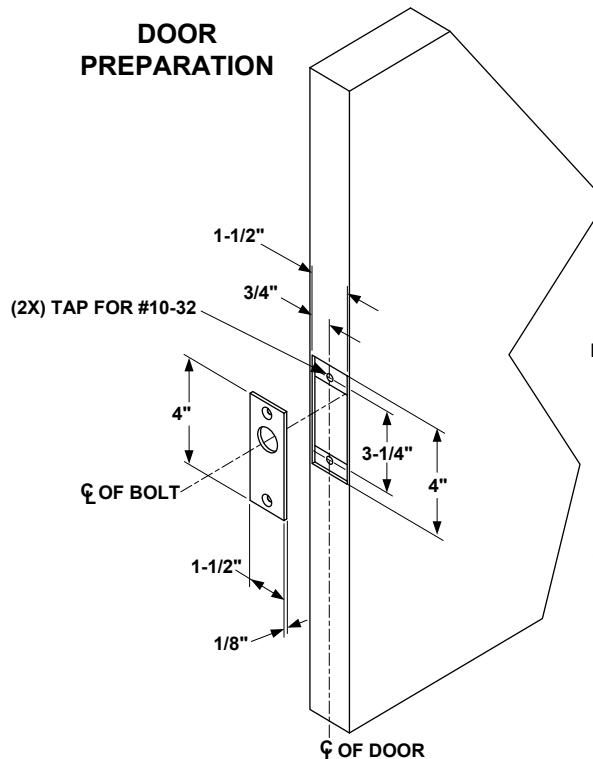

**NOTE: NOT TO SCALE.  
DIMENSIONS ARE SUBJECT  
TO CHANGE WITHOUT NOTICE.**

### TECHNICAL DATA (FOR STANDARD UNIT)

<b>FACE PLATE:</b>	10-1/2" x 1-1/2" X 1/8"
<b>STRIKE:</b>	4" x 1-1/2" x 1/8"
<b>ID REQUIREMENTS:</b>	10-1/2" x 1-1/2" x 1-3/4"
<b>BOLT:</b>	5/8" DIA. STAINLESS STEEL
<b>BOLT THROW:</b>	3/4"
<b>BACK SET:</b>	.865"

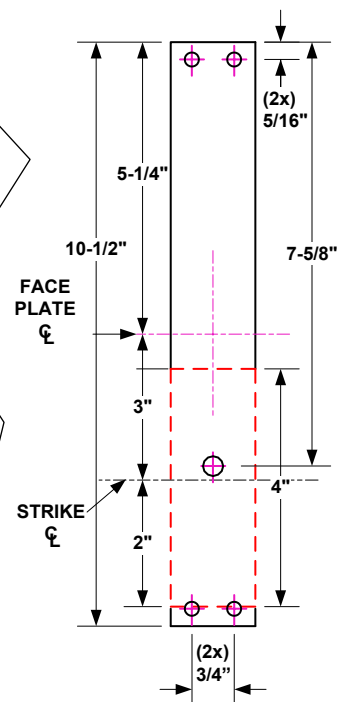

Any suggestions or comments to this instruction or  
product are welcome. Please contact us through  
our website or email [engineer@sdsecurity.com](mailto:engineer@sdsecurity.com)

## HOLLOW METAL FRAME PREPARATION

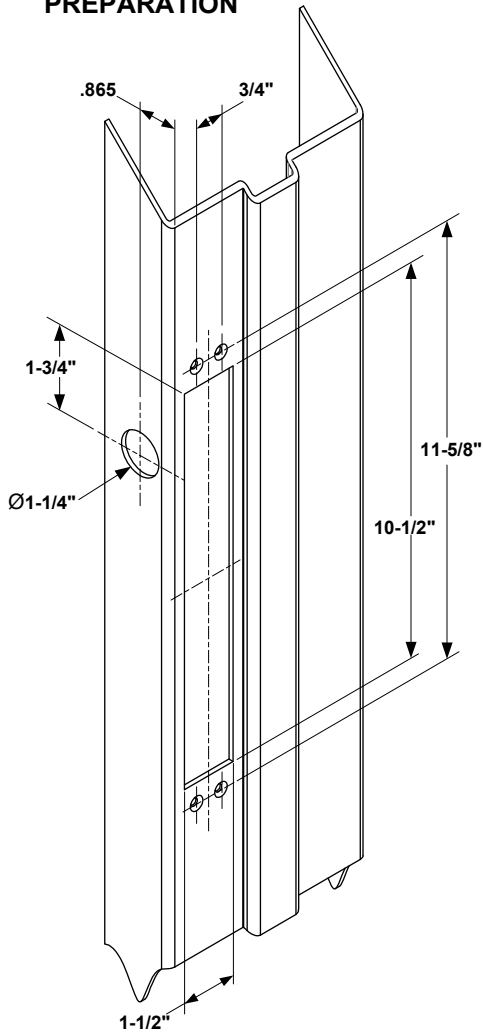

(8X) TAP TABS FOR #10-32

1-1/8" CYLINDER (NOT INCLUDED)

Once the Key Cylinder is installed. Secure the cylinder within the guided cylinder slot using the Cylinder Locking Set screw.

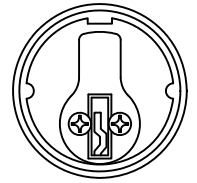
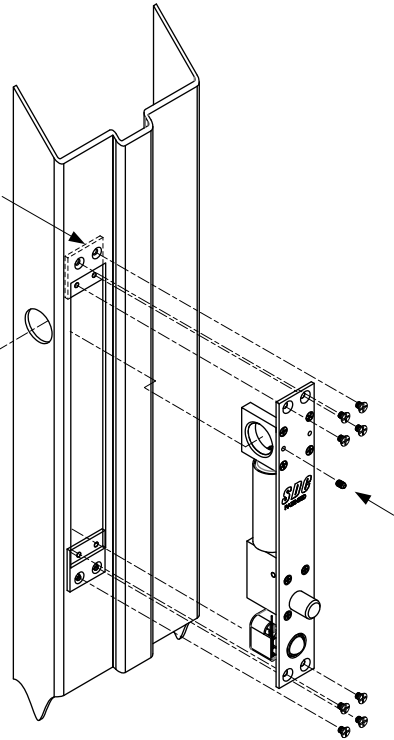

Use standard straight cam ILCO (863G) or equivalent.

Cylinder Locking Set Screw

## DOOR PREPARATION

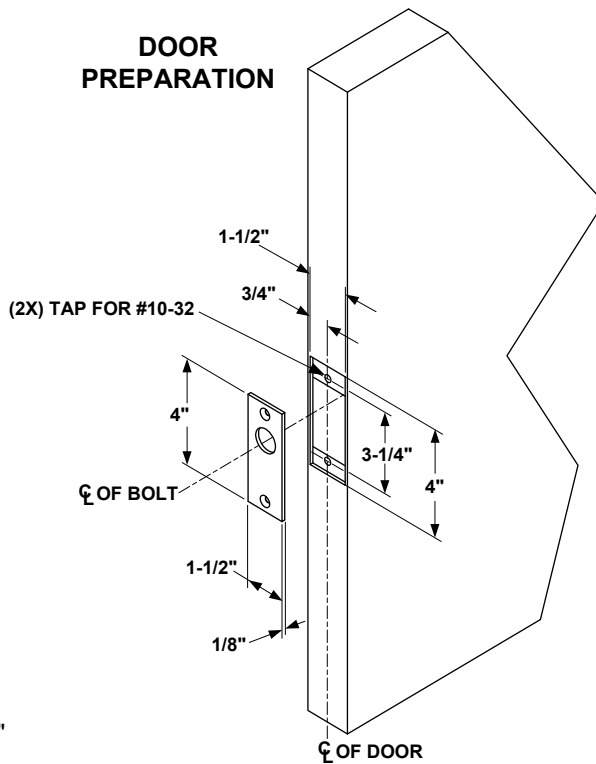

**NOTE: NOT TO SCALE.  
DIMENSIONS ARE SUBJECT  
TO CHANGE WITHOUT NOTICE.**

### TECHNICAL DATA (FOR STANDARD UNIT)

FACE PLATE:	10-1/2" x 1-1/2" X 1/8"
STRIKE:	4" x 1-1/2" x 1/8"
ID REQUIREMENTS:	10-1/2" x 1-1/2" x 1-3/4"
BOLT:	5/8" DIA. STAINLESS STEEL
BOLT THROW:	3/4"
BACK SET:	.865"

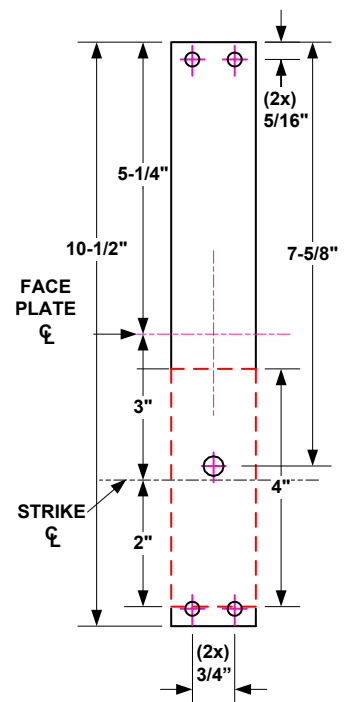

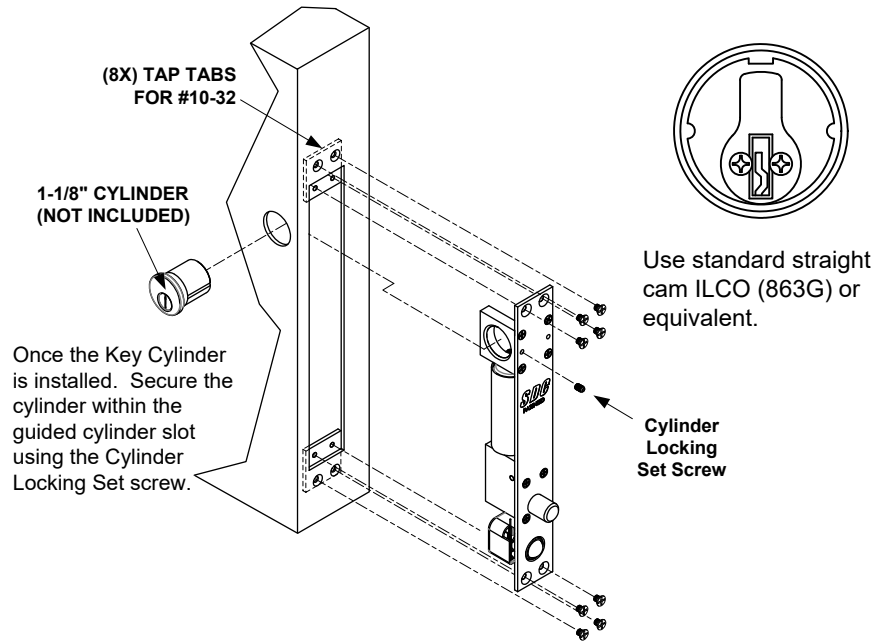
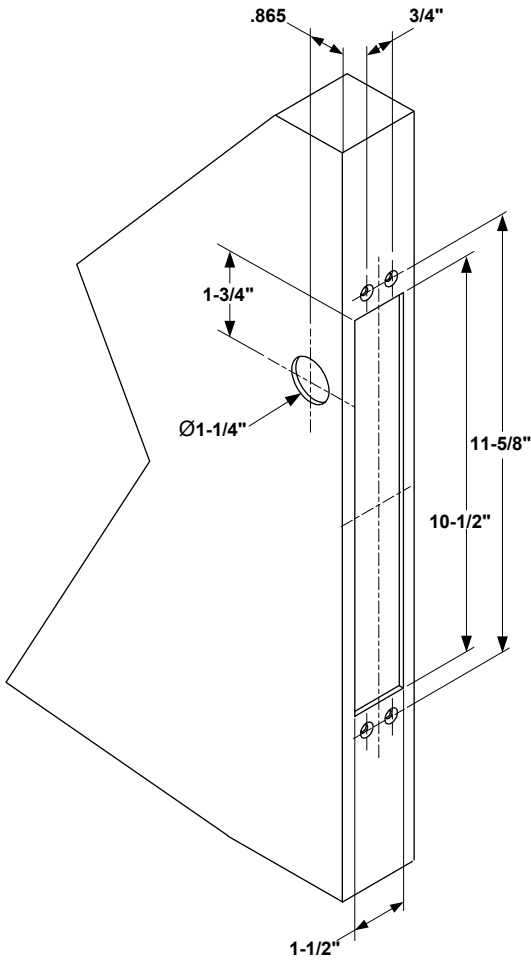
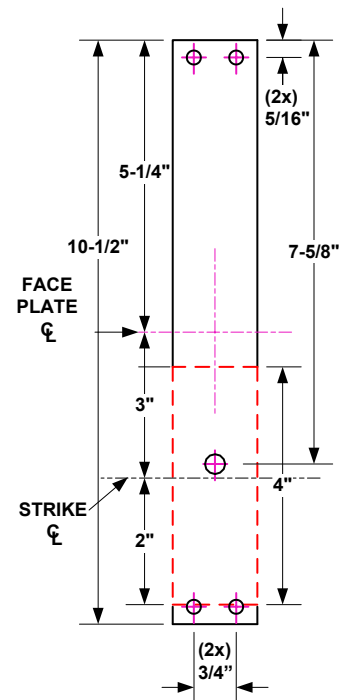
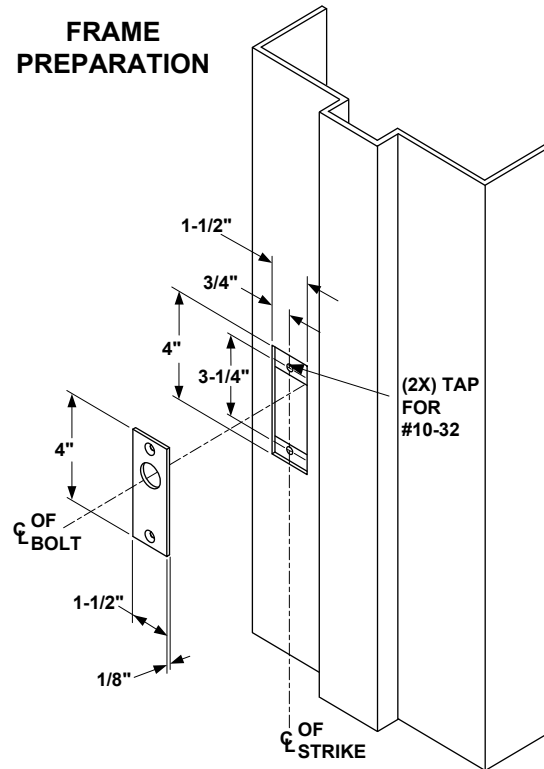
**DOOR  
PREPARATION****FRAME  
PREPARATION**

**NOTE: NOT TO SCALE.  
DIMENSIONS ARE SUBJECT  
TO CHANGE WITHOUT NOTICE.**

**TECHNICAL DATA (FOR STANDARD UNIT)**

<b>FACE PLATE:</b>	10-1/2" x 1-1/2" X 1/8"
<b>STRIKE:</b>	4" x 1-1/2" x 1/8"
<b>ID REQUIREMENTS:</b>	10-1/2" x 1-1/2" x 1-3/4"
<b>BOLT:</b>	5/8" DIA. STAINLESS STEEL
<b>BOLT THROW:</b>	3/4"
<b>BACK SET:</b>	.865"

## INSTRUCTIONS FOR REVERSING THE MOUNTING BLOCK

Remove the Cylinder locking set screw, and screw the Cylinder out of the Mounting Block.

Remove the four screws securing the Mounting Block and the Sliding Link Block.

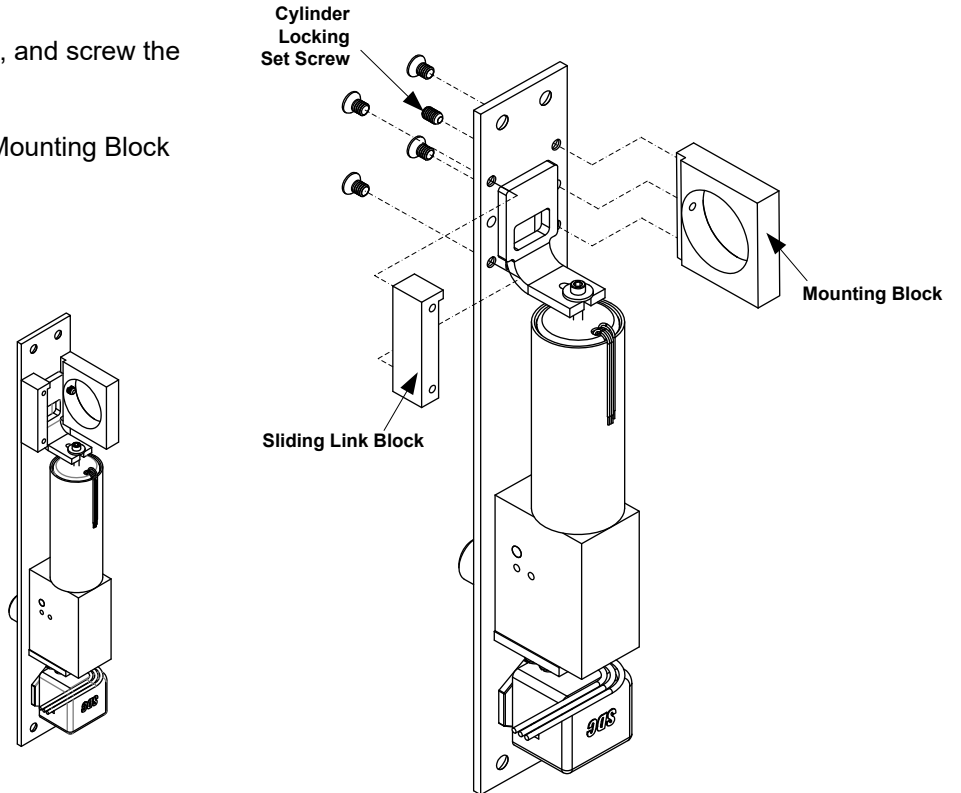

Make sure the sliding Link Block is positioned properly

Reverse the components and re-install as shown.

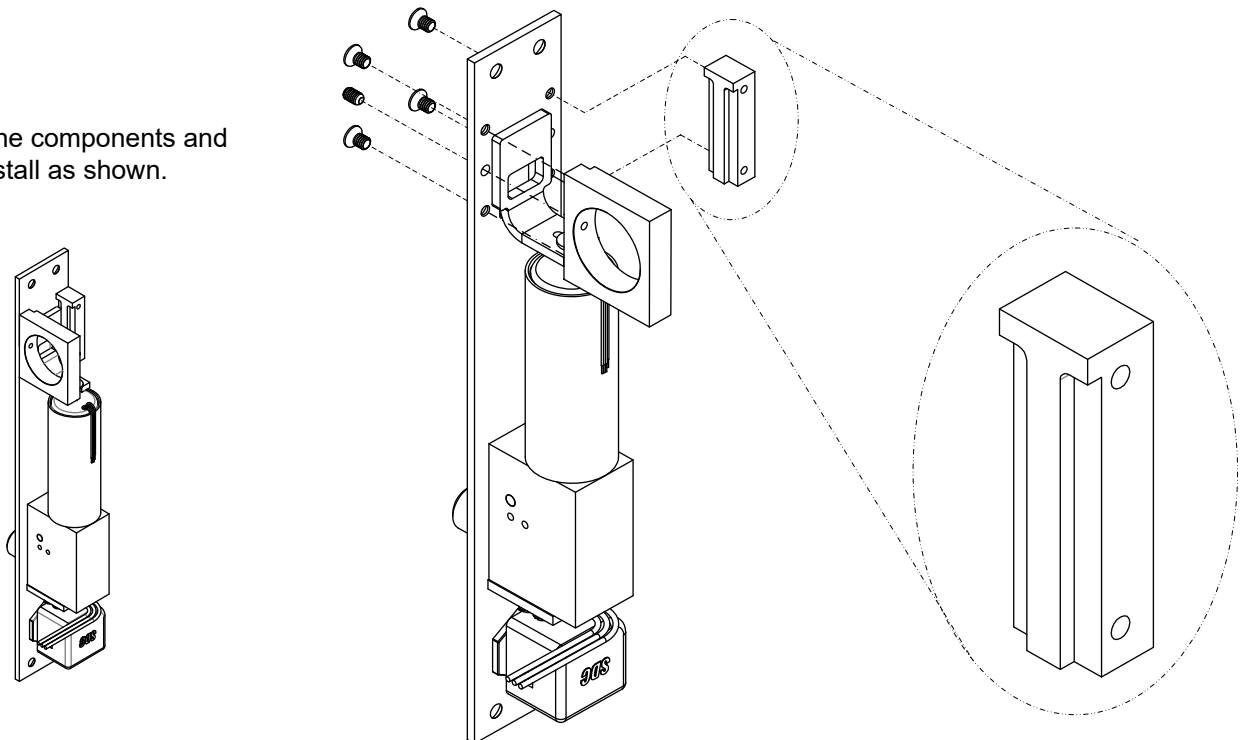



## LOCK WIRING

Select 24VDC OR 12VDC Configuration, and use provided pigtail connector:

### 24VDC SOLENOID CONFIGURATION

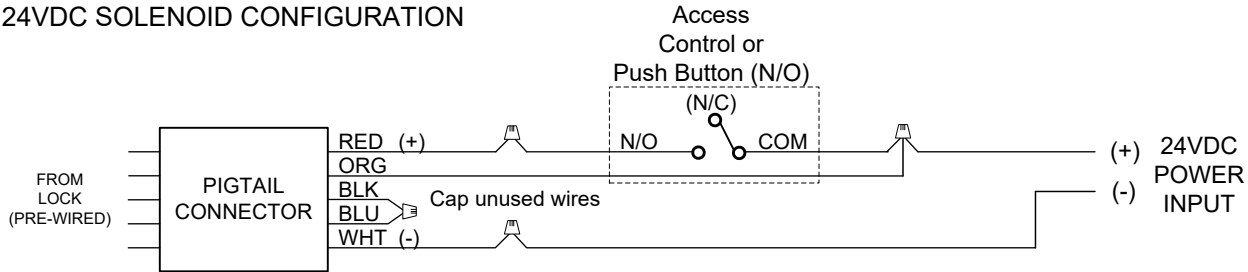

### 12VDC SOLENOID CONFIGURATION

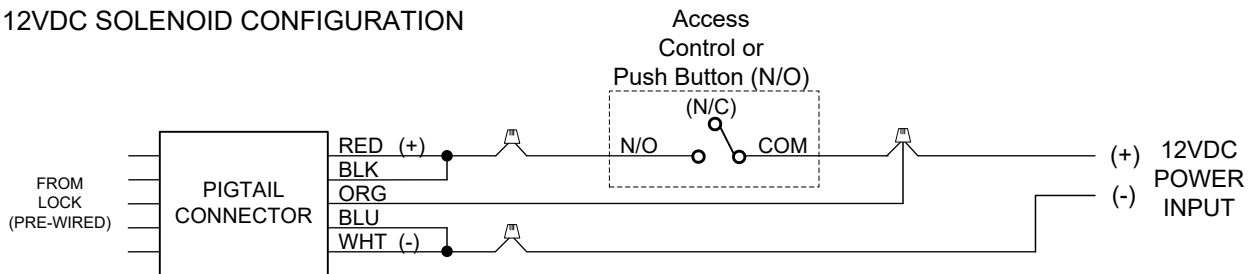

## Electrical Data

### Dual Voltage Solenoid:

12VDC @ .9 Amp (Max) Continuous Duty  
24VDC @ .45 Amp (Max) Continuous Duty

### OPTIONAL BOLT POSITION SENSOR (BPS-MAGNETIC)

B Indicates bolt locked or unlocked 5 Watt

### OPTIONAL DOOR POSITION SWITCH (DPS-MECHANICAL)

D Indicates door opened or closed  
4A @ 30VDC (Resistive)

\* When both options are ordered the Common is shared.

## DPS / BPS CONFIGURATION

