

Installation

Use the crews and plastic wall plugs to install the mounting bracket on the wall, then fix the solar lamp on the mounting bracket. Adjust the irradiation direction of the solar panel, and pay attention to not having shade to block the solar panel, the longer the solar panel is exposed to sunlight, the longer the lighting time will be. Adjust the three spotlights' irradiation angle or direction to achieve the best lighting effect.

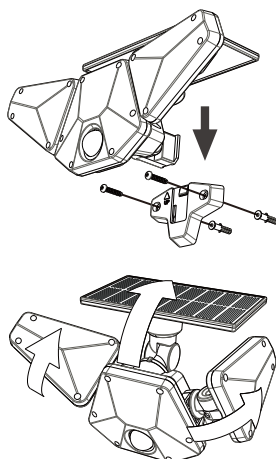

>>> THANKS FOR READING!

If you have any questions about our product, please feel free to contact us.

MADE IN CHINA

USER MANUAL

SOLAR

MOTION SENSOR WALL LIGHT

- Waterproof
- Heat Resistance
- Frost Resistance
- PIR Motion Sensor
- 113LEDs
- Three Modes

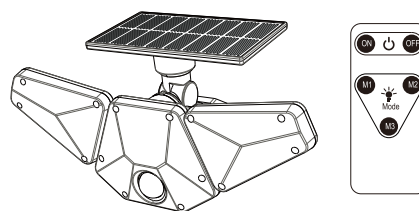

Introduction

The solar lamp can automatically detect surrounding brightness: during the day, it enters the charging mode and converts sunlight into electricity and stores it in the built-in battery. The lamp lights up automatically at night. It has three modes, you can set the desired lighting mode with the switch button on the back or remote control

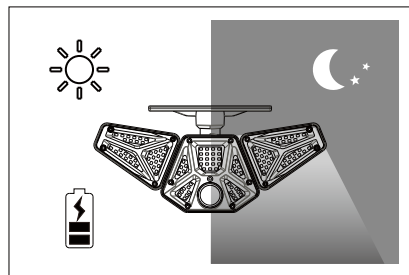

Package contains

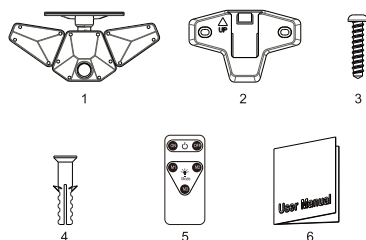

- Solar Lamp
- Mounting Bracket
- Screw
- Plastic Wall Plug
- Remote Control
- Manual

Operation guide

Please turn on the power switch on the back of the product before using it, for lighting mode selection, please press the switch button, Mode 1—Mode 2—Mode 3 as follows:

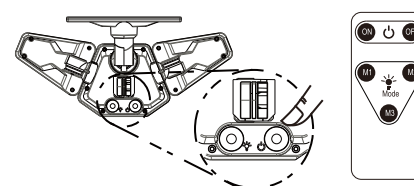

When using the remote control, please take out the plastic spacer, and it should be operated toward the receiving hole that above the sensor. When the mode switched successfully, the light flashes twice.

Mode 1: The lamp lights up when people come to it and goes out when people leave. When motion is detected by the PIR sensor, the lamp will be high light mode, after working for 22 seconds, it will automatically turn off, then enter the standby state.

Mode 2: The lamp lights up when people come to it and becomes dim when people leave. When motion is detected by the PIR sensor, the lamp will be high light mode, after working for 22 seconds, it will automatically switch to dim light, then enter the standby state.

Mode 3: Steady light. Continuous low light mode, PIR sensing function is off. after lighting for 4hrs, it will automatically switch to Mode 1.