

# Sunco

Lighting made better.

User Manual

## **Solus Solar Garden Light**

SKU: GD\_MD4\_SR-BK-2740K



support@sunco.com  
(844) 334-9938



# What's in the Box?

## Solar Sidewalk Light

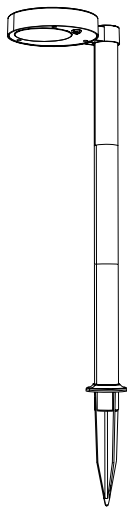

Let there be light!  
(literally)



x1

Light

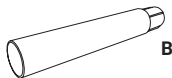

x2

Light Pole



x1

Ground Stake

# Before You Start

## Safety Information

To reduce the risk of fire or physical injury:

- Suitable for outdoor environments ranging from -4°F to 104°F.
- Do not cover the fixture with thermally insulating material.
- Not intended for use with emergency fixtures.
- Not compatible with occupancy sensors.
- Not compatible with dimmers or timing devices.
- Not compatible with third party sensors.
- All electrical connections must be in accordance with local and National Electric Code (N.E.C.) standards.
- Please review installation manual carefully before proceeding. Consult a qualified electrician if you are unfamiliar with proper installation.

This device complies with Part 15 of the FCC rules. Operation is subject to the following two conditions:

- 1) This device may not cause harmful interference.
- 2) This device must accept any interference that may cause undesired operation. Please review all instructions carefully prior to installation.

### **WARNING:**

Cancer & Reproductive Harm-  
[www.P65Warnings.ca.gov](http://www.P65Warnings.ca.gov)

## Quickstart Guide

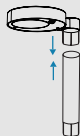

### Step 1

Insert light into light pole.

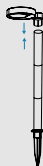

### Step 2

Cover solar panel & select CCT.

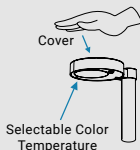

### Step 3

Insert light pole into main body.



### Step 4

Sunlight access required for location.

# Installation Guide

## STEP 1

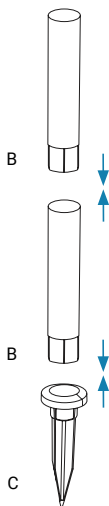

- a. Remove accessories from packaging.
- b. Connect the light poles (B) with the ground stake (C).

## STEP 2

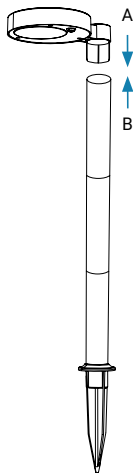

- a. Connect the light pole (B) to the light (A).

## Installation Guide (Cont.)

### STEP 3

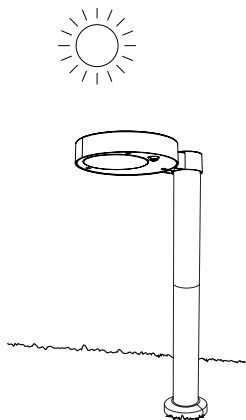

- a. Once fully assembled, place the the light into desired location.
- b. This location should have clear access to sunlight and kept away from other light sources that could interfere with the sensor.

### STEP 4

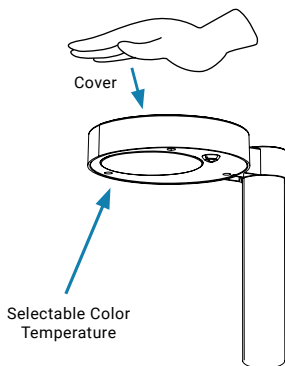

- a. Allow the light to charge before operation.
- b. Press the Power button to turn the light on.
- c. When exposed to light, cover the solar panels before pressing the Power button.
- d. Continue pressing the Power button to toggle between color temperatures and its selectable brightness.

## Product Details

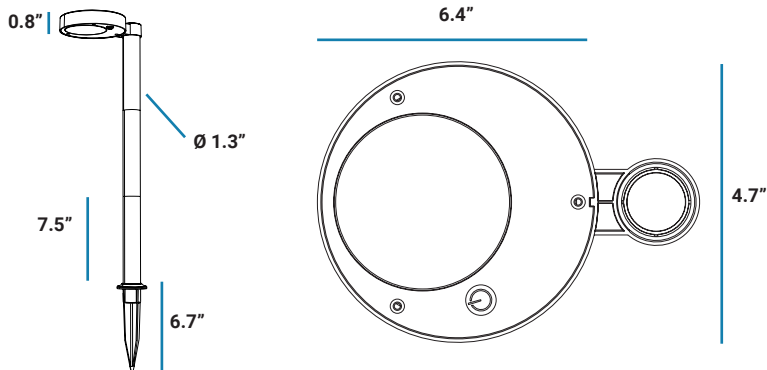

## Specifications

<b>Voltage</b>	3.7V	<b>Lifetime</b>	25,000 Hours
<b>Wattage</b>	2W	<b>Lumens</b>	120 lm
<b>Battery</b>	500mAh 3.7V	<b>CRI</b>	70+
<b>CCT</b>	2700K , 3000K , 4000K	<b>Usage</b>	Outdoor
<b>Material</b>	ABS	<b>Warranty</b>	1 Year
<b>Beam Angle</b>	120°	<b>Battery Included</b>	Yes
<b>Dimmable</b>	Selectable Brightness	<b>Efficacy</b>	60 lm/W

## Common Troubleshooting

We've got you covered! Our troubleshooting section is here to shed some light and provide you with easy-to-follow solutions for any problem.

If you still need some assistance, feel free to contact us. Our team of lighting experts are happy to help brighten your day.

### Installation

Light isn't turning on.

Allow the light to sit outdoors for a full day before testing its functionality.

### Turned On

Light doesn't turn on when power button is pressed.

Allow the light to sit outdoors for a full day before testing its functionality.

### Clean Panel

Light doesn't turn on when power button is pressed.

Check for any obstructions or damage on the light.

### Location

Light isn't turning on in certain location.

Please ensure the solar light is not being obstructed, as it may result in incorrect functioning due to the lack of direct sunlight.



support @sunco.com  
(844) 334-9938

REV 20