



For more information or replacement brushes visit us at [taoclean.com](http://taoclean.com)



Call or text: +1-714-363-3599



Email: [support@taoclean.com](mailto:support@taoclean.com)

**Please Note:**

This equipment has been tested and found to comply with the limits for a Class B digital device, pursuant to part 15 of the FCC Rules. These limits are designed to provide reasonable protection against harmful interference in a residential installation.

This equipment generates, uses and can radiate radio frequency energy and, if not installed and used in accordance with the instructions, may cause harmful interference to radio communications. However, there is no guarantee that interference will not occur in a particular installation. If this equipment does cause harmful interference to radio or television reception, which can be determined by turning the equipment off and on, the user is encouraged to try to correct the interference by one or more of the following measures:

- Reorient or relocate the receiving antenna.
- Increase the separation between the equipment and receiver.
- Connect the equipment into an outlet on a circuit different from that to which the receiver is connected.
- Consult the dealer or an experienced radio/TV technician for help.

Changes or modifications to this unit not expressly approved by the party responsible for compliance could void the user's authority to operate the equipment.

# umma

## DIAMOND

with

germshield+

### USER MANUAL

BA-0130

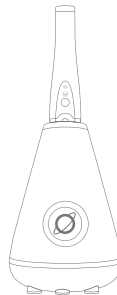

## IMPORTANT

**READ THIS USER MANUAL CAREFULLY  
BEFORE YOU USE THE DEVICE. ALSO,  
PLEASE SAVE IT FOR YOUR  
FUTURE REFERENCE.**



## CONTACT

---

For assistance  
call or text: +1-714-363-3599

---

**T A C** clean © 2022

All rights reserved. No part of this book may be reproduced, stored in a retrieval system, or transmitted in any form or by any means, electronic, mechanical, or otherwise, without written permission of the copyright owners.

---

This device complies with Part 15 of the FCC Rules. The operation of this device is subject to the following two conditions: (1) this device may not cause harmful interference, and (2) this device must accept any interference received, including interference that may cause undesired operation.

# umma

## DIAMOND

with  
germshield+

### WELCOME TO A NEW ERA OF CLEANLINESS

Congratulations on your new Umma Diamond Toothbrush.  
You've made a smart investment in your teeth and we're so happy and grateful you chose our system to care for them.

We have worked night and day to design our best toothbrush and we want you to love it. To get you up and running as fast as possible and ensure the best from your Umma Diamond Toothbrush and UV sanitizer, please take a moment to read these instructions.

What follows are steps to help you understand how to charge your system, operate and keep it maintained to ensure the best performance for superior results, and some technical information, just in case you love engineering as much as we do.



## ATTENTION



### WHEN USING ELECTRICAL DEVICES, BASIC SAFETY PRECAUTIONS SHOULD ALWAYS BE FOLLOWED

CHILDREN SHALL NOT PLAY WITH THE DEVICE.

CHILDREN SHALL NOT CLEAN OR CARRY OUT USER MAINTENANCE WITHOUT ADULT SUPERVISION. THANK YOU.

THIS APPLIANCE CAN BE USED BY CHILDREN FROM 8 YEARS OF AGE SO LONG THEY ARE SUPERVISED OR HAVE BEEN GIVEN INSTRUCTIONS CONCERNING THE USE AND OPERATION OF THE DEVICE IN A SAFE MANNER. THE CHILD MUST UNDERSTAND MISUSE OF THE DEVICE COULD BE DANGEROUS, HARMFUL AND HAZARDOUS TO THE CHILD'S HEALTH AND SAFETY.



## DANGER



THIS APPLIANCE CONTAINS A UV EMITTER. DO NOT STARE AT THE LIGHT SOURCE.

UV LIGHT CAN BE HARMFUL TO THE HUMAN EYE AND SKIN.

BE SAFE AND DO NOT REACH FOR A UV SANITIZER THAT HAS FALLEN INTO WATER.

FIRST UNPLUG THE DEVICE IMMEDIATELY, THEN GATHER THE UV SANITIZER AND WAIT UNTIL IT FULLY DRIES BEFORE ACTIVATING AND USING DEVICE AGAIN.

NEVER FORCE THE UV SANITIZER PLUG INTO AN OUTLET.

IF IT DOES NOT EASILY FIT INTO THE OUTLET, DISCONTINUE USE AND RETURN TO YOUR VENDOR OR TAO CLEAN FOR SERVICE.



## DANGER



DO NOT PLUG THE UV SANITIZER INTO AN OUTLET WITH A VOLTAGE OR FREQUENCY OTHER THAN SPECIFIED ON THE CHARGER. PLEASE BE AWARE VOLTAGE CONVERTERS DO NOT GUARANTEE VOLTAGE COMPATIBILITY. SO BE VIGILANT AND MOST OF ALL BE SAFE.



## WARNING



PLEASE KEEP THE ELECTRIC CORD AWAY FROM HEATED SURFACES AND DO NOT USE THE POWER ADAPTOR IF DROPPED IN WATER.

DO NOT USE THE UV SANITIZER CHARGER IF IT HAS A DAMAGED CORD OR PLUG ADAPTOR.

ONLY USE THE POWER ADAPTOR & CABLE POWER SUPPLY PROVIDED WITH THE CLEANING STATION. ALWAYS HAVE THE CHARGER AND/OR SANITIZER REPLACED WITH ONE OF THE ORIGINAL TYPE IN ORDER TO AVOID DAMAGING THE DEVICE OR CAUSING HARM TO YOURSELF. NO EXCEPTIONS. THANK YOU.

IF THE DEVICE IS DAMAGED IN ANY WAY (TOOTHBRUSH HEAD, TOOTHBRUSH HANDLE, CHARGER AND/OR SANITIZER), STOP USING IT.

IN CASE OF ANY MECHANICAL FAILURE WITHIN THE WARRANTY PERIOD, PLEASE RETURN YOUR TAO CLEAN SYSTEM FOR SERVICE. DO NOT ATTEMPT TO DISMANTLE. DISMANTLING THE DEVICE WILL VOID THE WARRANTY.

THIS DEVICE CONTAINS NO SERVICEABLE PARTS. IF THE APPLIANCE IS DAMAGED, CONTACT THE TAO CLEAN CUSTOMER CARE FOR ASSISTANCE, PLEASE TEXT OR CALL +1 (714) 363-3599 OR EMAIL: [SUPPORT@TAOCLEAN.COM](mailto:SUPPORT@TAOCLEAN.COM)

## ATTENTION

This device has been designed only for cleaning the teeth. Do not use it for any other purpose. Stop using the appliance and contact your dentist if you experience any discomfort or pain.

Umma Diamond was designed for personal use.  
We do not recommend that you share the brush heads.

We want to keep you clean. We want to keep you healthy.  
Most importantly, we want to keep you that way.

Do not put the brush head, the handle, the charger, and/or the sanitizer in the dishwasher.

These instructions are also available in pdf from our website:  
[www.taoclean.com/manuals](http://www.taoclean.com/manuals)

## TIME FOR A NEW BRUSH HEAD?

Umma Diamond loves to keep you sparkling clean, and you deserve the best! We recommend replacing your head every 3 months (or less).

Happy brush, happy life.

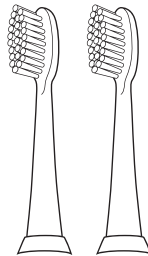

Replacement heads  
[www.taoclean.com](http://www.taoclean.com)

Accept no substitutes



## FEATURES

### CHARGING MODE

Your Umma Diamond should have enough charge to use at least once, so you can take it for a spin right away.

Afterward, you will need to charge the battery.

#### ATTENTION

**THE BATTERY NEEDS 24 HOURS TO CHARGE FULLY THE FIRST TIME.**

It could never be more simple. Just place your Umma Diamond Handle in the plugged in UV sanitizer, and it will automatically start to charge and immediately start the cleaning cycle. After the cleaning process has finished the badge light will change from blue to white.

Keeping the Umma Diamond Handle on its UV sanitizer not only protects the brush head in an excellent clean environment but also keeps it fully charged and ready for use.



## FEATURES

### CLEANING MODE

# germ shield+

Germ shield+ technology delivers the maximum level of sanitization. We designed the UV sanitizer to protect and enclose the toothbrush from environmental pollutants coupled with the circular UV-C lamp to sanitize the toothbrush.

The cleaning station uses a specially designed circular UV-C light bulb that helps kill germs on the brush head, keeping your toothbrush clean and dry; drop the handle in the cleaning station and let it do its thing.

As the cleaning cycle begins, the light will change from white to blue and slowly pulse. After 5 minutes, the light will change back to white.

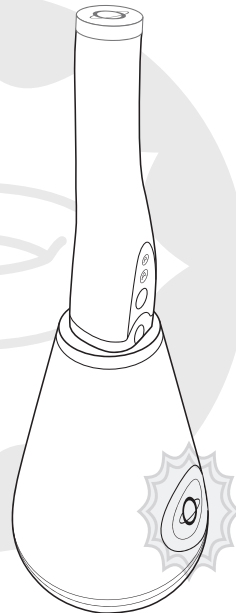

## FEATURES

### DRYING MODE

**Killing 99.9% of germs is unachievable if the brush is kept wet.**

Your Umma Diamond Cleaning Station also has a heating element to gently dry your brush head immediately after completing the UV cleaning process. The cleaning station gently dries the toothbrush while within the UV sanitizer chamber.

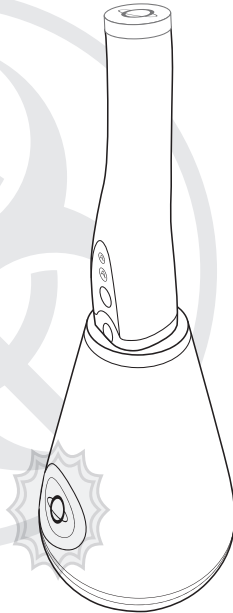

## PREPARING FOR USE

### BRUSH ASSEMBLY

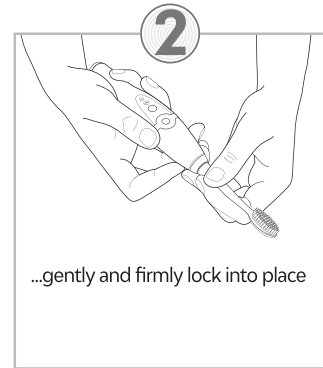
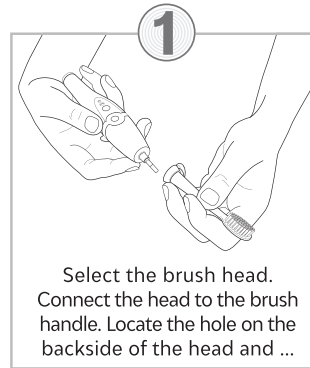

Replace brush heads every three months or sooner to achieve the best results.

**ATTENTION**  
**USE ONLY OFFICIAL TAO CLEAN**  
**REPLACEMENT BRUSH HEADS.**

Fakes won't get the job done.

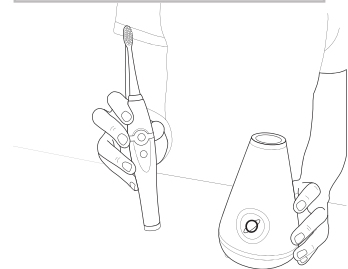

## PREPARING FOR USE

### CONNECTING POWER

To power your system carefully plug the power adaptor into the small socket located below the waistline at the back of the cleaning station.

Use the correct orientation of the plug into the socket. Now you are ready to plug the adaptor into an electrical outlet.

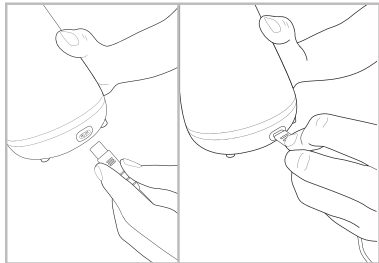

### ATTENTION

**TO ENSURE YOUR UV SANITIZER PERFORMS ITS TASKS PERFECTLY, PLEASE MAKE SURE YOUR SANITIZER IS PLACED ON A CLEAN, FLAT HORIZONTAL SURFACE.**

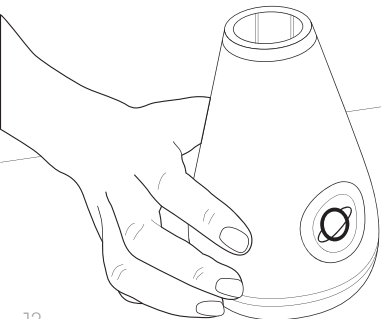

## PREPARING FOR USE

### NIGHT LIGHT SWITCH

Our UV sanitizer base is a brilliant addition to your countertop, guiding you like a beacon of clean throughout the night. However, if you'd like to turn off the inviting white glow of the "night light," it's easy.

Carefully invert the UV sanitizer and locate the "night light" button, as shown by the "night light" icon. You can then toggle the button off by pressing once to disable it. Once the device is done cleaning your brush, and the pulsing blue sequence is finished, the night light will turn off. If you change your mind, press again, and it will start beaming.

Please note: turning the light off will not stop the device from cleaning.

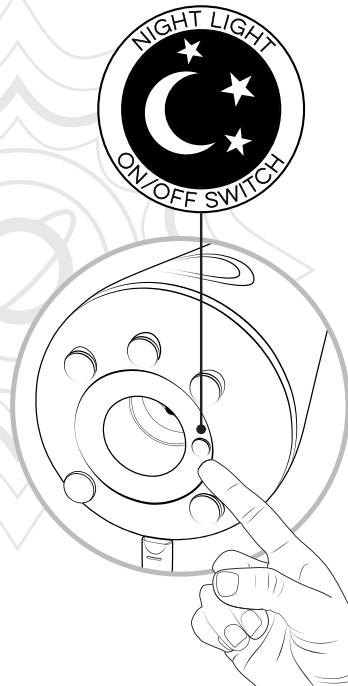

## PREPARING FOR USE

### BRUSHING DOCK

Gently place your brush handle into the cleaning station. The brush handle fits in the station perfectly.

Take care in locating the brush handle so that it drops into the station effortlessly.

Hint: the control panel on the brush should line up with the badge on the base. Did we mention to do this carefully? Good.

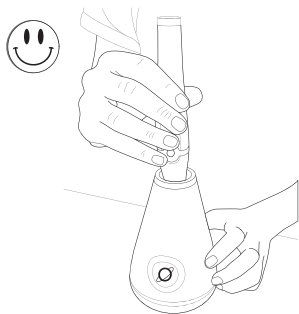

YES!



YES!

## DIRECTIONS FOR USE

### CONTROL PANEL

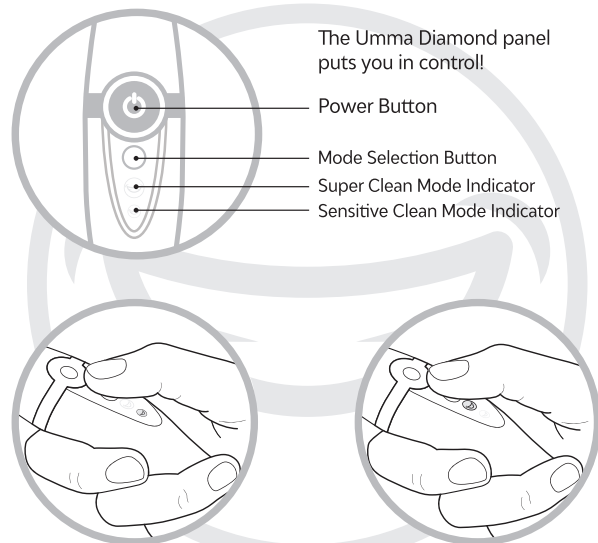

The Umma Diamond panel puts you in control!

Power Button

Mode Selection Button

Super Clean Mode Indicator

Sensitive Clean Mode Indicator

Press once for Sensitive Clean Mode and the small smiley will light up. Nice!

Press again to switch back to Super Clean Mode and the large smiley will light up. Easy!



## ATTENTION LOW BATTERY

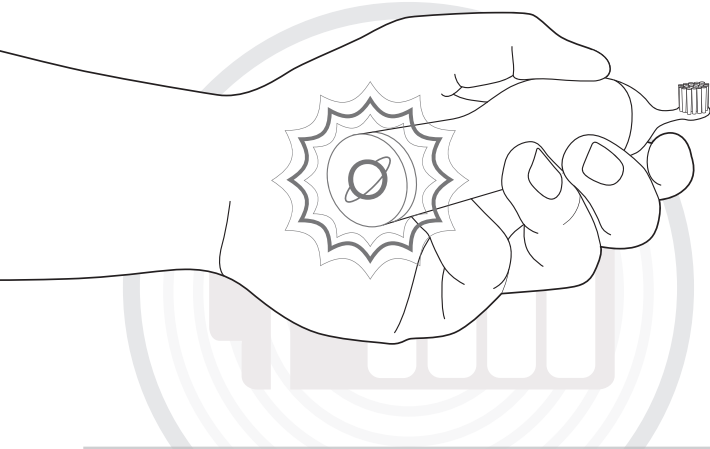

The low battery alert indicates your Umma Diamond Handle is running low on its battery charge. If this occurs, place the handle back into the UV sanitizer. Give it a few moments, and everything will be ok.

If the brush handle continues to pulsate while in the UV sanitizer, please check to see if the power is connected.

## DIRECTIONS FOR USE ACTIVATING THE BRUSH

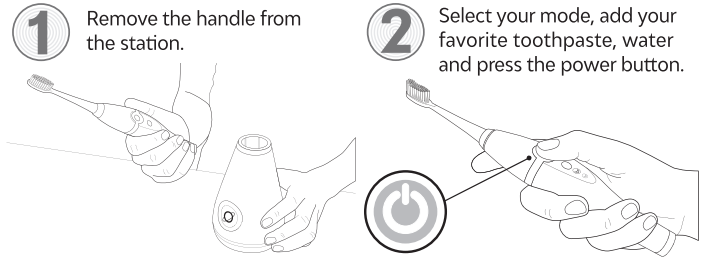

## BRUSHING MODES

Your brush has two cleaning modes and automatically starts in our recommended Super Clean Mode.

Sensitive Clean Mode can be accessed at the touch of a button and offers a gentle, yet thorough cleaning experience for sensitive gums and teeth. The clever brush even remembers the last mode set, so no need to change it.

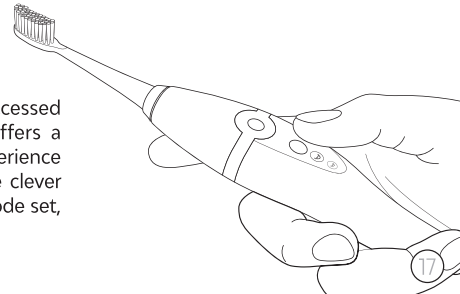

## USING THE DEVICE BRUSHING MOTION

- Wet the bristles of your brush head and apply a small amount of your favorite toothpaste.
- Gently place the bristles against the teeth at a slight angle towards the gum line.
- Press the power button and lightly engage the brush with your teeth.
- Trust your brush: It will do all the brushing for you, so you do not need to apply the same pressure as a manual toothbrush. Sonic technology is superior in cleansing as compared to a manual toothbrush. Your Umma Diamond delivers thousands of brush strokes to safely dislodge debris, hygienically clean and efficiently polish your teeth without applying significant pressure. The brush is happy to clean, so do not press hard or scrub.



Hold the bristles in place against your teeth for a few seconds before sweeping on to the next tooth. Allow the brush to work the gums as well as the teeth.

- Your Umma Diamond Toothbrush delivers the dentist recommended brushing time of two minutes. After the two-minutes of brushing, the device stops automatically.
- At every 30-second interval the brush will alert you to change brushing areas with a brief pause.

## USING THE DEVICE BRUSHING TECHNIQUE

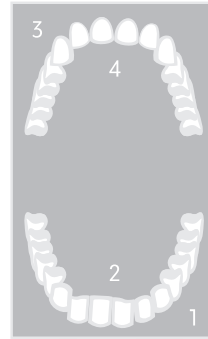

### Optimal brushing technique

Separate your mouth into quadrants and begin brushing your outside bottom teeth.

(1) After the first pause, move to your inside bottom teeth.

(2) After the next pause, continue brushing the outside top teeth.

(3) The last pause signifies the home stretch along the inside top teeth.

The Umma bristles have been selected for their effectiveness when used appropriately. Avoid excessive pressure when brushing to ensure the longest life of the brush, but also the greatest effectiveness.

If you've got braces, keep smiling. Your Umma Diamond is effective on all types of braces and dental restorations (fillings, crowns, implants, and veneers).

After you've finished, feel free to conduct additional cleaning if you need to remove stains or like the feeling. Just go easy and don't press.

We also recommend that you don't use any abrasive toothpaste that may hurt the tooth enamel.

## USING THE DEVICE

### INTERCHANGEABLE HEADS

Our line of Daily Brush Heads is available in three different grades, soft for sensitive gums, medium (included), and firm for a stiffer feel.

TAO Clean also offers specialty heads, such as orthodontic care and whitening.

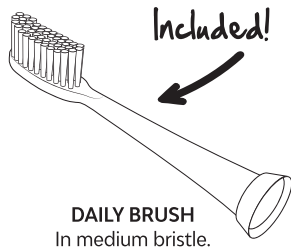

Our unique Umma Orthodontic Head has two specialized areas designed to get your teeth and dental furniture spotlessly clean.

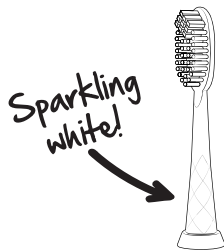

Our Umma Whitening Head uses proprietary bristles clinically proven to remove stains and whiten your smile.

## MAINTENANCE

### BRUSH CLEANING

Please follow these easy to do maintenance routines to ensure your Umma Diamond Toothbrush is always in the very best condition.

Keeping to these routines will also ensure your system is always operating at its best.

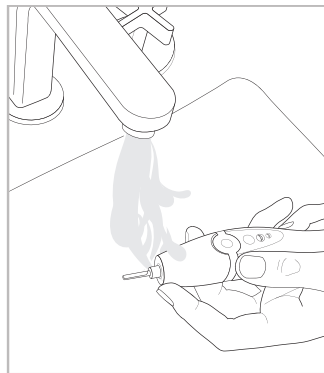

#### Essential Cleanliness Maintenance Routines Keep the Umma Diamond Clean

Always rinse the brush head and bristles after each use.

We recommend that you remove the brush head at least once a week and rinse the shaft area with warm water.

Be careful not to damage the seal on the shaft with sharp objects when you clean.

## MAINTENANCE

### BASE CLEANING

#### Essential Cleanliness Maintenance Routines For The Station

We considered this when we designed the smooth curved interior shape of the UV sanitizer core. We do recommend cleaning once a week to ensure tip-top condition. Use a soft cloth. Wrap the fabric around your finger like so (see diagram no. 1). Unplug the station. Carefully run your finger around the bottom (see no. 2) and do the same around the top-docking hole (see no. 3).

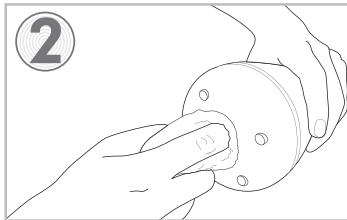
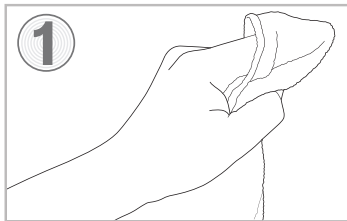

## MAINTENANCE

### WARRANTY

#### Two year warranty

Your Umma Diamond is warranted against defects in workmanship materials for two years for the original purchaser from the date of purchase. It does not cover damage or wear resulting from accidents, misuse, abuse, commercial use, or unauthorized adjustment and/or repair.

**Please note:** It does not cover wear of the brush heads.

There are no expressed warranties except as listed above. This warranty gives you specific legal rights, and you may have other rights which vary from state to state. Should your Umma Diamond Toothbrush require service (or replacement at our option) while under warranty, do not return to the retailer. Instead, please contact our customer service. Our friendly staff are trained to help you. If your Umma Diamond needs to be returned, we will arrange a return label.

For assistance: Text or call: +1 (714) 363-3599  
Email: [support@taoclean.com](mailto:support@taoclean.com)

TAO clean