



Scan the QR code for other languages.  
Scannen Sie den QR-Code für andere Sprachen.  
Scannez le code QR pour d'autres langues.  
Escanee el código QR para otros idiomas.



# Quick Start Guide

## What is in the box



\*Please take the device out of the package and check that your accessories are available, if not, please contact service@reliup.com.

### Demonstration of Products' Placement

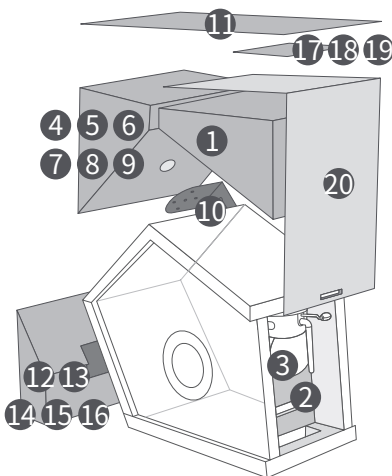

\*Birds are amazing creatures that live freely in the wild, and it's important to remember that we can't control or guarantee their nesting behavior in our Birddy Nests. However, we're here to help you create a welcoming environment that they might find irresistible. If you're lucky enough to have birds choose your Birddy Nest as their home, that's fantastic! But if not, don't worry. Just make some adjustments to the surroundings and patiently wait for their arrival. We'll provide you with all the information you need to make your Birddy Nest as appealing as possible.

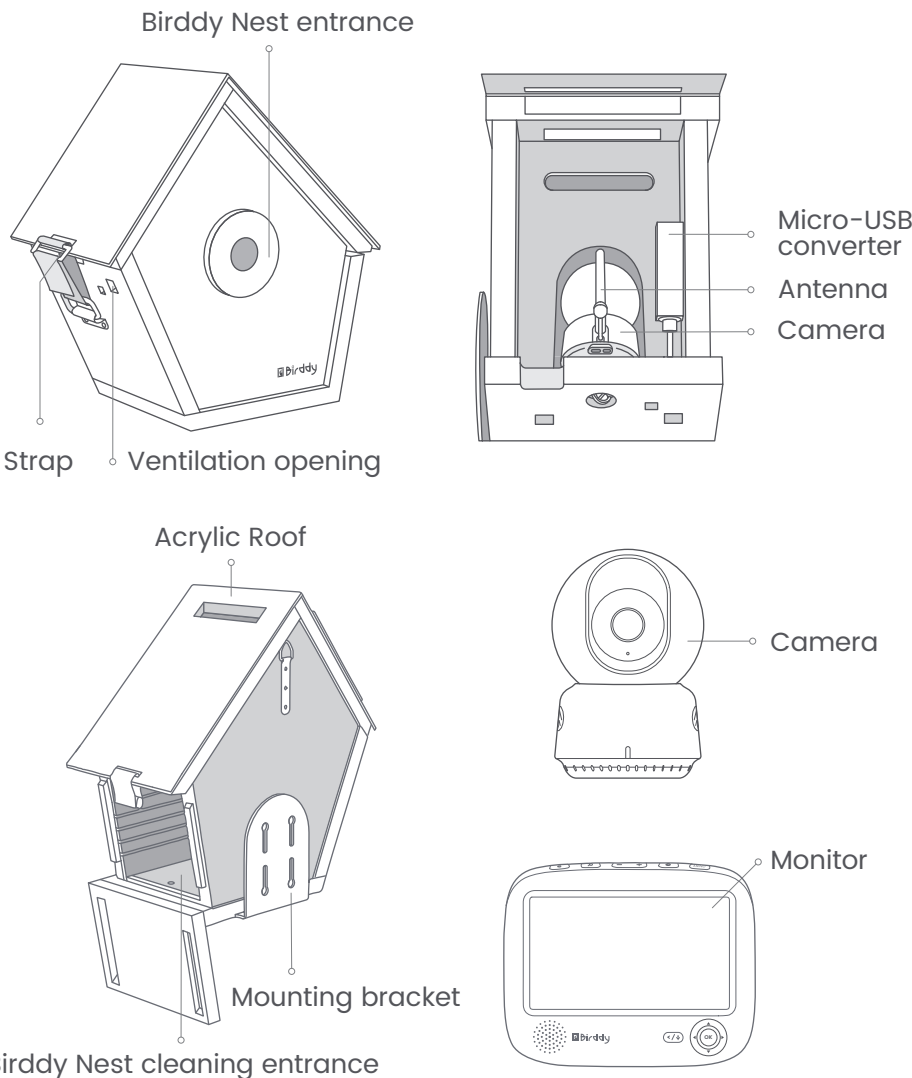

## 1 Product usage guidance

### 1 Monitor Introduction

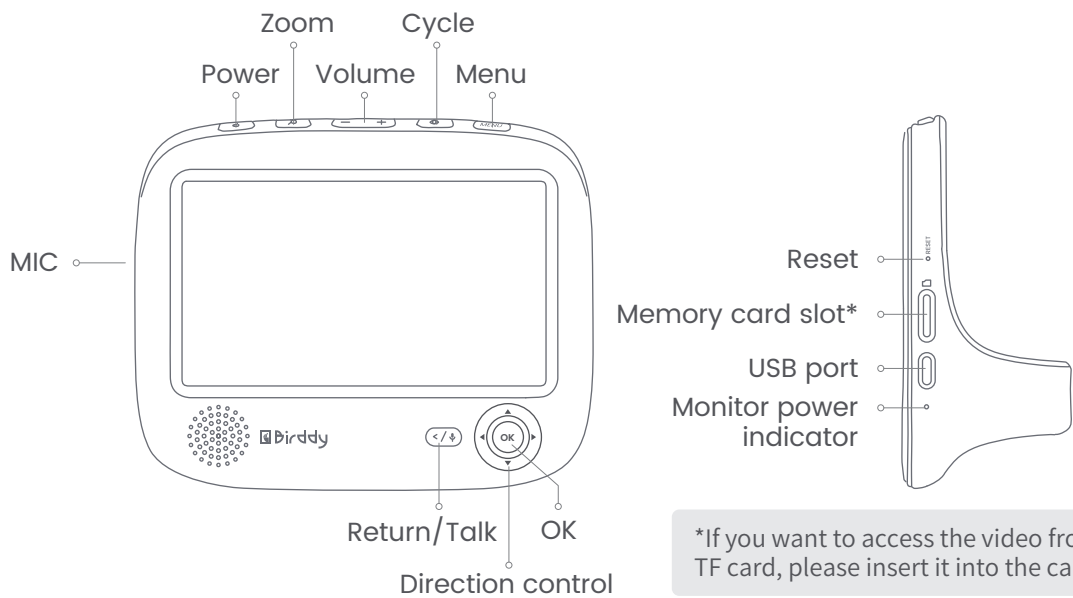

### 3 Charge Monitor

Please fully charge the monitor before use. Charging method:  
1.Connect one end of the Micro USB (1.5m) cable to the Monitor and the other end to the power adapter (5V==2A).  
2.Plug the adapter into a power outlet.

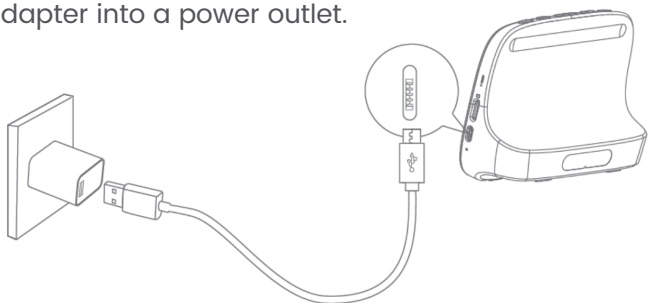

### 2 Camera Introduction

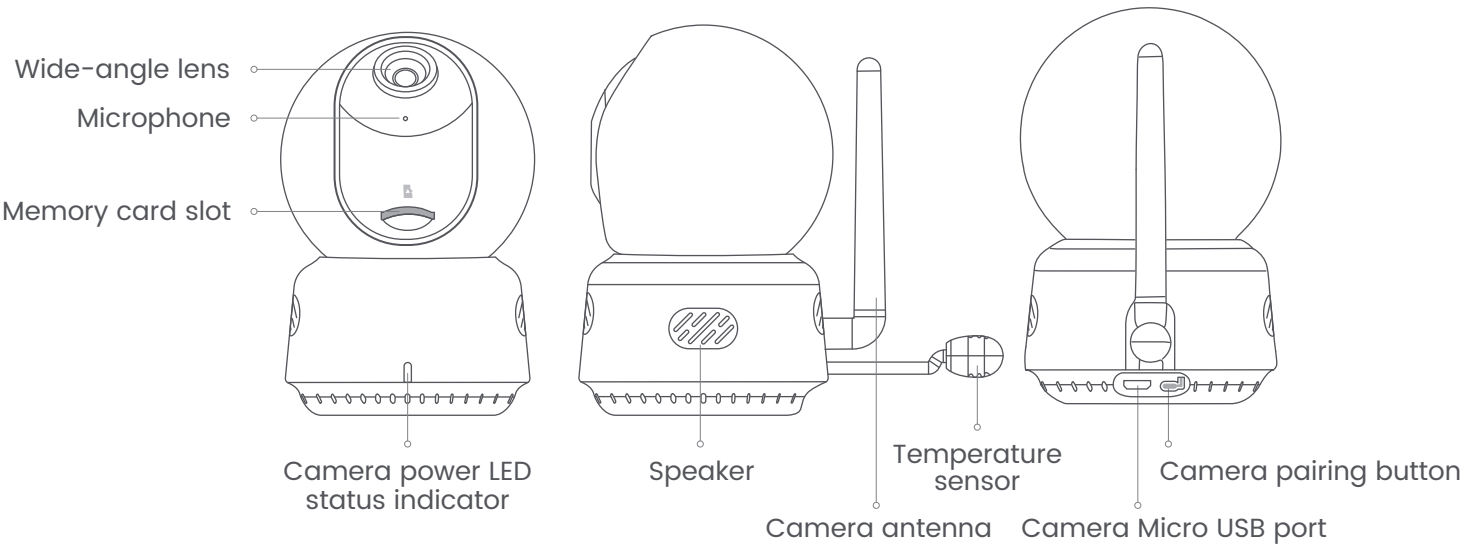

When the monitor initiates a request to add a camera and the camera is within the connection range, press and hold the camera pairing button for 1 second to successfully pair them.

### 4 Charge Camera

1. Connect one end of the POE charging cable to the power adapter (Insert POE hole) and the other end to the micro-USB converter.  
2.Plug the adapter into the power outlet and plug the converter into the camera. Once the monitor is fully charged and the camera is powered, you can use all the products.

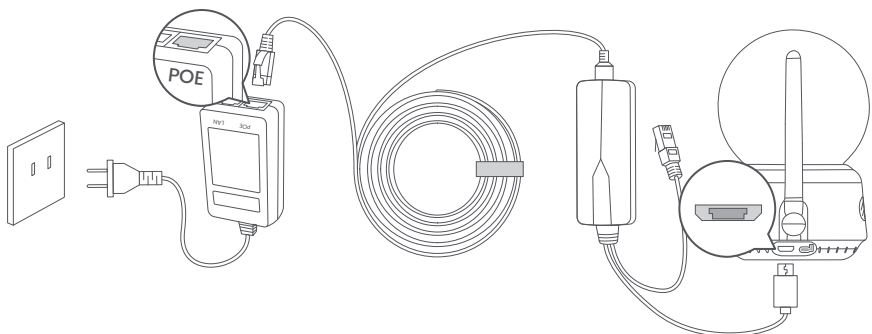

# 2 Assemble Birddy Nest

## 1 Choose a suitable location for the Birddy Nest.

1. Choose the prime bird habitat where you will later place your Birddy Nest.
2. Try to find a spot where the signal is strongest.



3. Some useful tips before choosing a spot:

- 1) Install the Birddy Nest before the arrival of spring.

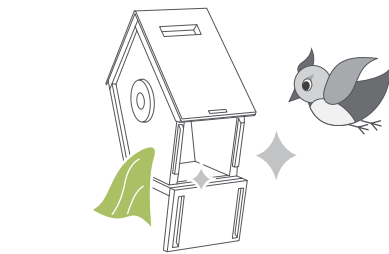

- 2) A clean and sturdy Birddy Nest attracts birds more easily.

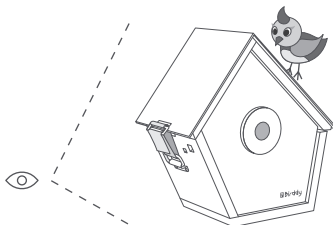

- 3) Place the Birddy Nest at eye level or higher for better visibility.

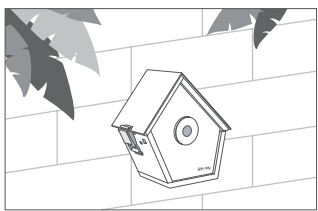

- 4) Keep the Birddy Nest quiet and away from noisy areas, including bird feeders.



Please review "A Guide to Bird Nesting" before installation to better determine the placement of the Birddy Nest.

## 2 Let's get started!

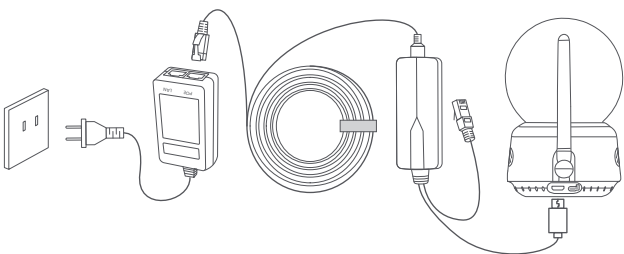

- 1) Make sure the camera and monitor are powered on and connected to each other before starting to ensure a smoother user experience.

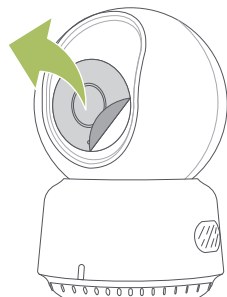

- 2) Ensure that the protective film in front of the camera has been removed for the device to function properly.

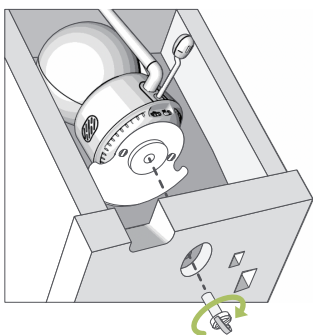

- 3) Align the screw hole in the center of the base with the hole on the Birddy Nest and tighten it with screws. Secure the camera to the base.

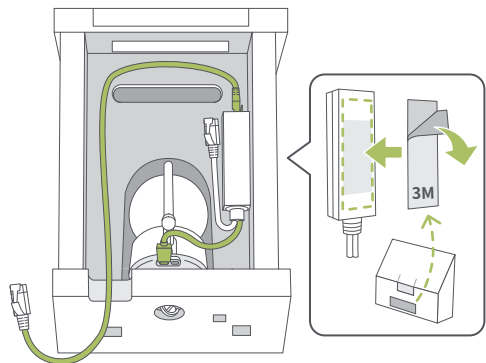

- 4) Stick the 3M adhesive from the pack on the side of the POE adapter. Place the POE adapter near the camera and tidy up any extra cables.

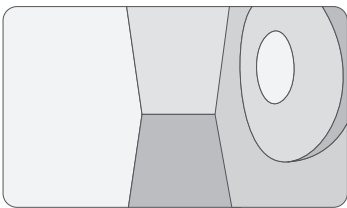

- 5) Open the live stream and confirm if you are satisfied with the device placement and view to avoid Re-adjustments.

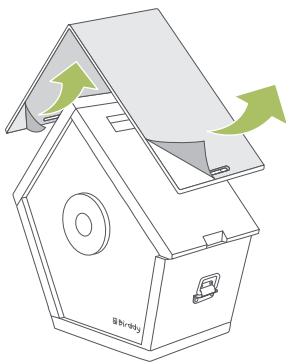

- 6) Tear off the anti-scratch sticker on the top of the Birddy Nest and you will have a beautiful transparent roof.

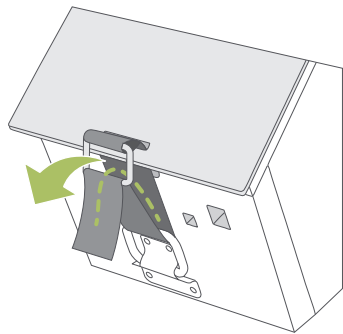

- 7) Tidy up the extra cables around the camera. Lastly, close the top panel of the Birddy Nest.

# 3 Install Bracket

## 1 Secure the bracket to the wall.

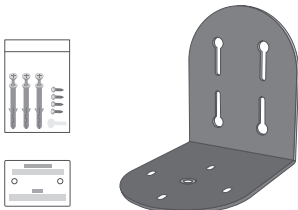

- a. Take out the mounting bracket, screw package and drilling template sticker from the accessory package.

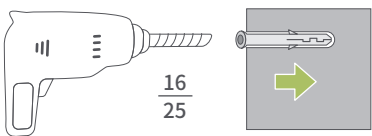

- b. It is recommended to use a 16/25 inch drill bit to drill holes according to the guidance on the stickers and secure the expansion plugs in the holes.

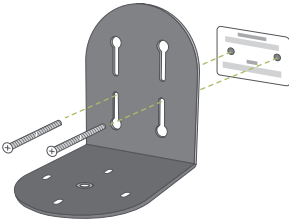

- c. Use screws to securely attach the mounting bracket to the wall.

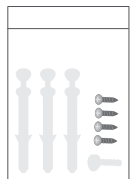

- a. Take out the screw package from the accessory package.

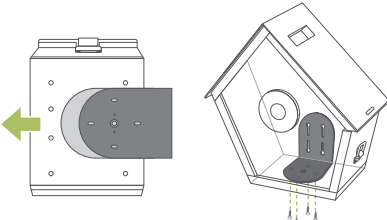

- b. Use M4 screws to secure the mounting bracket to the Birddy Nest.

### Warning

1. Only use batteries approved by the manufacturer. Replacement of the wrong type of battery may result in failure of safety protection and risk of explosion, fire, etc.
2. Do not put the battery in an extremely high-temperature environment, such as sunshine, fire, microwave oven, oven, etc. High temperatures may cause an explosion or leakage of flammable liquid or gas.
3. Do not disassemble, squeeze or cut the battery. It may cause an explosion.
4. Do not place the battery at extremely low pressure, which may cause the battery to explode or leak flammable liquids and gases.
5. Do not continue to use the battery if it is severely swollen.
6. Do not swallow batteries, which can cause chemical burns.
7. If you think the battery may have been swallowed or placed in any part of the body, seek medical help immediately.
8. If the battery compartment is not securely closed, discontinue using the product and keep it away from children.
9. Keep children away from new and used batteries.
10. Please do not throw the battery anywhere. Please comply with the relevant national regulations, the safe disposal of used batteries.
11. If this product contains button batteries, do not swallow. Swallowed button batteries can cause severe internal burns and potentially death within 2 hours.

### CE Warning

Hereby, Reli Technologies LLC declares that the radio equipment type FJ11HWWJ is in compliance with Directive 2014/53/EU. The full text of the EU declaration of conformity is available at the following website: <https://www.reliup.com>

### FCC Verification

FCC Compliance Statement: This device complies with Part 15 of the FCC rules. Operation is subjected to the following two conditions: (1) this device may not cause harmful interference, and (2) this device must accept any interference received, including interference that may cause undesired operation. Changes or modifications not expressly approved by the party responsible for compliance could void your authority to operate the equipment. This equipment complies with FCC radiation exposure limits set forth for an uncontrolled environment. The distance between user and products should be no less than 20cm.

This equipment has been tested and found to comply with the limits for a Class B digital device, pursuant to Part 15 of the FCC Rules. These limits are designed to provide reasonable protection against harmful interference in a residential installation. This equipment generates, uses and can radiate radio frequency energy and, if not installed and used in accordance with the instructions, may cause harmful interference to radio communications. However, there is no guarantee that interference will not occur in a particular installation. If this equipment does cause harmful interference to radio or television reception, which can be determined by turning the equipment off and on, the user is encouraged to try to correct the interference by one or more of the following measures:

- Reorient or relocate the receiving antenna.
- Increase the separation between the equipment and receiver.
- Connect the equipment into an outlet on a circuit different from that to which the receiver is connected.
- Consult the dealer or an experienced radio/TV technician for help.

### WEEE information

All products bearing this symbol are waste electrical and electronic equipment (WEEE as in directive 2012/19/EU) which should not be mixed with unsorted household waste instead, you should protect human health and the environment by handing over your waste equipment to a designated collection point for the recycling of waste electrical and electronic equipment, appointed by the government or local authorities. Correct disposal and recycling will help prevent potential negative consequences to the environment and human health. Please contact the installer or local authorities for more information about the location as well as terms and conditions of such collection points.

### Specifications

Product name: **Birddy Nest**  
Model: FJ23HWWJ

Product name: **Birddy Smart Bird House Monitor Camera (Wired)**  
Model: FJ28HWWJ  
FCC ID: 2AJ2LFJ28HWWJ

Product name: **Birddy Nest Monitor**  
Model: FJ29HWWJ  
Power input: Max 5V=2A  
FCC ID: 2AJ2LFJ29HWWJ

### Support

Reli Technologies LLC  
Address: 919 N Market St Suite 950, Wilmington, DE 19801  
Website: <https://www.reliup.com/>

Contact us: [service@reliup.com](mailto:service@reliup.com)

