

# Replacing battery

Step 1

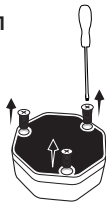

Step 2



FREQUENCY:

2.402 – 2.480 GHz

OUTPUT POWER:

<10mW

Download  
**BTTALK APP**



BTT BUTTON PRO

# POCKET GUIDE

BIKE HANDLEBAR BUTTON FOR COMMUNICATION  
VIA BTTALK APP





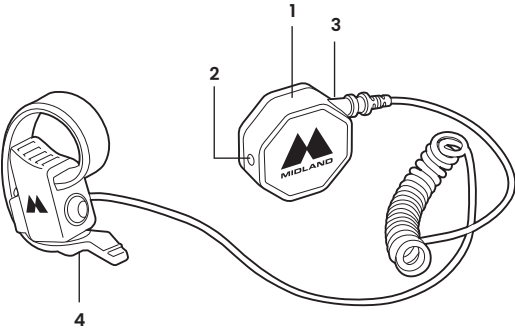

# Description of the parts

- 1. Main PTT
- 2. Led
- 3. Connection of the wired PTT
- 4. Finger PTT



## LED

LED	Status
 Led blinks red	<b>Unit on and not connected to the APP</b>
 Led blinks blue	<b>Unit on and connected to the APP</b>
 Led blinks alternately red and blue	<b>Pairing</b>
 Led blinks red alternately to the connection led	<b>Battery discharged</b>
 Red led 1 sec.	<b>Reset</b>

# Installation

## Step 1

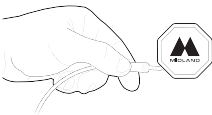

**Note:** insert the connector making sure it is plugged-in completely.

## Step 2

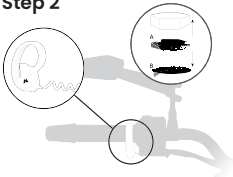

**Note:** Fix the main PTT anywhere with the adhesive Velcro. Fix the wired PTT on the handlebar with the supplied strap, as shown in the picture.

# Pairing

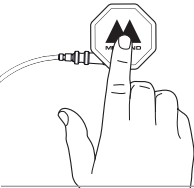

**1 Click** Press once

 Led blinks alternately red and blue.



- 1. Enter Midland APP
- 2. Setting
- 3. Bluetooth Management and follow the instructions of the APP

**Note:** the reset procedure, which is described later on, must be executed before any other pairing.

# Using BTT Button Pro

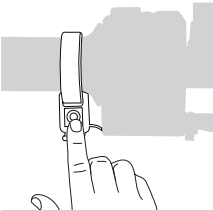

**1 Click** Press once

 Led **blinks** red (not connected)

Open the APP

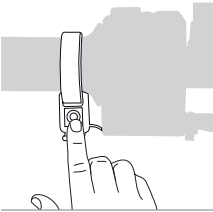

**1 Click** Press once

 Led **blinks** blue (connected)

## Reset



**1 Click** Press once



**10"** Press together 10 sec.

 Steady red led 1 sec. (Reset confirmed)