

HAMPTON BAY[®]

USE AND CARE GUIDE

WALL/WALL BRIDGE CABINET

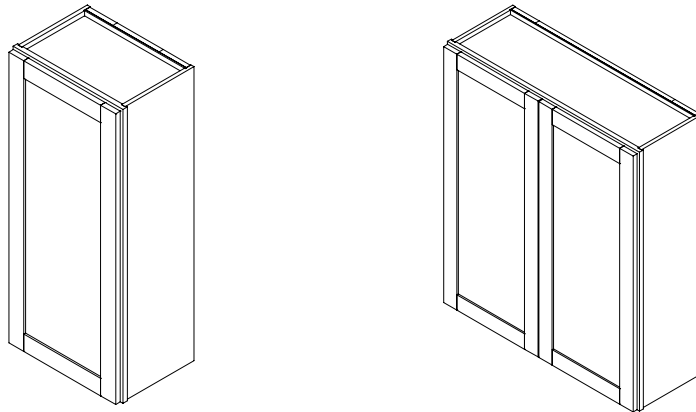

Questions, problems, missing parts? Before returning to the store,
call Hampton Bay Customer Service
8 a.m. – 7 p.m., EST, Monday – Friday, 9 a.m. – 6 p.m., EST, Saturday

1-855-HD-HAMPTON

HAMPTONBAY.COM

THANK YOU

We appreciate the trust and confidence you have placed in Hampton Bay through the purchase of this Cabinet. We strive to continually create quality products designed to enhance your home. Visit us online to see our full line of products available for your home improvement needs. Thank you for choosing Hampton Bay!

Table of Contents

Table of Contents2

Safety Information.....2

 CALIFORNIA RESIDENTS.....2

 MINNESOTA RESIDENTS2

Warranty2

Introduction to CLICKREADY Technology3

Pre-Assembly4

 BEFORE YOU BEGIN.....4

 PEOPLE REQUIRED4

 TOOLS REQUIRED4

 HARDWARE INCLUDED4

Pre-Assembly 5

 PACKAGE CONTENTS.....5

Cabinet Assembly 6

Cabinet Assembly (continued)..... 7

Before Putting in Use 10

Care and Cleaning 11

Safety Information

Please read and understand these instructions before you begin this assembly.

CALIFORNIA RESIDENTS



WARNING: This product can expose you to chemicals including Formaldehyde (GAS), which is [are] known to the State of California to cause cancer. For more information go to WWW.P65Warnings.ca.gov/products.

MINNESOTA RESIDENTS

IMPORTANT HEALTH NOTICE

SOME OF THE BUILDING MATERIALS USED IN THIS HOME (OR THESE BUILDING MATERIALS) EMIT FORMALDEHYDE. EYE, NOSE, AND THROAT IRRITATION, HEADACHE, NAUSEA AND A VARIETY OF ASTHMA-LIKE SYMPTOMS, INCLUDING SHORTNESS OF BREATH, HAVE BEEN REPORTED AS A RESULT OF FORMALDEHYDE EXPOSURE. ELDERLY PERSONS AND YOUNG CHILDREN, AS WELL AS ANYONE WITH A HISTORY OF ASTHMA, ALLERGIES, OR LUNG PROBLEMS, MAY BE AT GREATER RISK. RESEARCH IS CONTINUING ON THE POSSIBLE LONG-TERM EFFECTS OF EXPOSURE TO FORMALDEHYDE.

REDUCE VANTILTION MAY ALLOW FORMALDEHYDE AND OTHER CONTAMINANTS TO ACCUMULATE IN THE INDOOR AIR. HIGH INDOOR TEMPERTURES AND HUMIDITY RAISE FORMALDEHYDE LEVELS. WHEN A HOME IS TO BE LOCATED IN AREAS SUBJECT TO EXTREME SUMMER TEMPERATURES, AN AIR-CONDITIONING SYSTEM CAN BE USED TO CONTROL INDOOR TEMPERATURE LEVELS. OTHER MEANS OF CONTROLLED MACHANICAL VENTILATION CAN BE USED TO REDUCE LEVELS OF FORMALDEHYDE AND OTHER INDOOR AIR CONTAMINANTS.

IF YOU HAVE ANY QUESTIONS REGARDING THE HEALTH EFFECTS OF FORMALDEHYDE, CONSULT YOUR DOCTOR OR LOCAL HEALTH DEPARTMENT.

Warranty

Contact the Customer Service Team at 1-855-HD-HAMPTON or visit [www. Hamptonbay.com](http://www.Hamptonbay.com).

101

Introduction to **CLICKREADY** Technology

Powered by **OVVO**



This cabinet uses **PERMANENT** Ready to Assemble (RTA) technology that **CANNOT** be disassembled. You must carefully review instructions and ensure proper alignment during assembly.

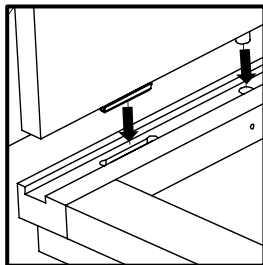

All connectors and dowels must line up when assembling cabinet.

Quantity of connectors/dowels depends on the cabinet type and size.

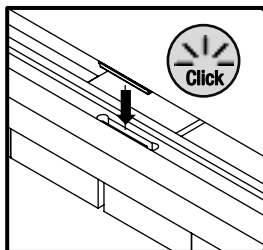

There will be a “clicking” sound when the connectors lock together properly.

BEFORE INSTALLATION, ENSURE ALL CONNECTORS ARE LOCKED IN PLACE AND SEATED.

Pre-Assembly

BEFORE YOU BEGIN

Compare all parts with the Hardware Included and Package Contents sections. If any part is missing or damaged, do not assemble this product. Contact Customer Service.

Assemble the cabinet on a soft surface such as carpet or the cardboard container of this product.

PEOPLE REQUIRED



BASE CABINETS with a width greater than or equal to 27" , CORNER WALL CABINET, LAZY SUSAN CABINET, PANTRY, OVEN CABINET require two people to assemble.

TOOLS REQUIRED



Rubber mallet

HARDWARE INCLUDED



NOTE: Hardware not shown to actual size.

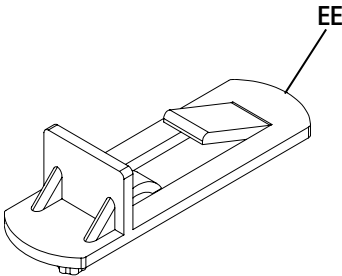
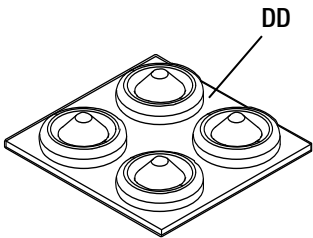



** Extras quantity is provided based upon your cabinet size/type*

Part	Description	Qty. Wall Cabinet without shelf	Qty. Wall Cabinet with 1(2,3) shelf
DD	Silicone Pads	2-4	2-4
EE	Shelf Pin	0	4-8-12

Pre-Assembly

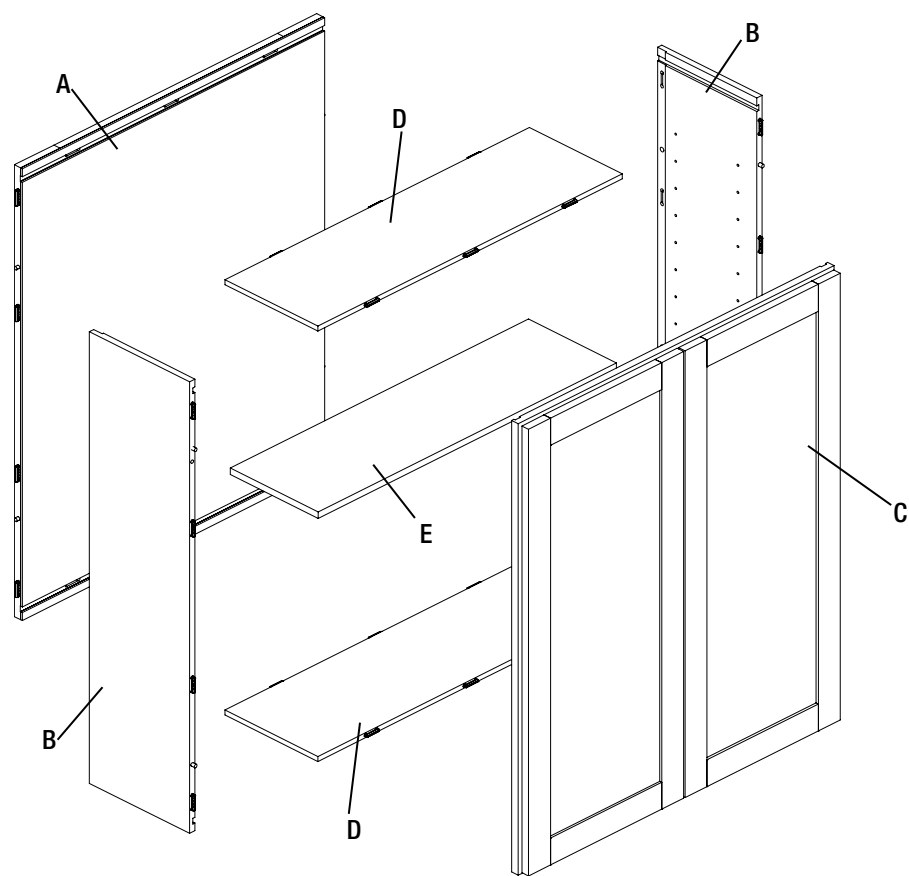
PACKAGE CONTENTS



 **NOTE:** The quantity of connectors per panel depends on its size and type

Part	Description	Qty.
A	Back Panel	1
B	Side Panel	2
C	Face Frame and Doors	1
D	Bottom and Top Panel	2
E	Shelf	0-3*

* The quantity of shelf depends on the cabinet size.

- Wall/Wall bridge cabinets shorter than 24" have no shelf
- 24" tall cabinets have 1 shelf
- 30&36" tall cabinets have 2 shelves
- 42" tall cabinets have 3 shelves

* Wall Cabinets 27" and wider has 2 doors.

Cabinet Assembly

1 Attaching the side panels into the face frame

- Start by placing the face frame (C) flat on a smooth surface that will not scratch or damage the face of the cabinet, such as a towel or piece of cardboard (1) from the packaging.
- Install the two side panels (B) into the mating grooves on the face frame (C) by: aligning the wooden dowels & male connectors on side panel (B) to the holes & female connectors on face frame (C).
- Use both hands to firmly press the sides (B) down at all locations with connectors to ensure they lock together tightly.



IMPORTANT: There will be a “clicking” sound when the connectors lock together properly

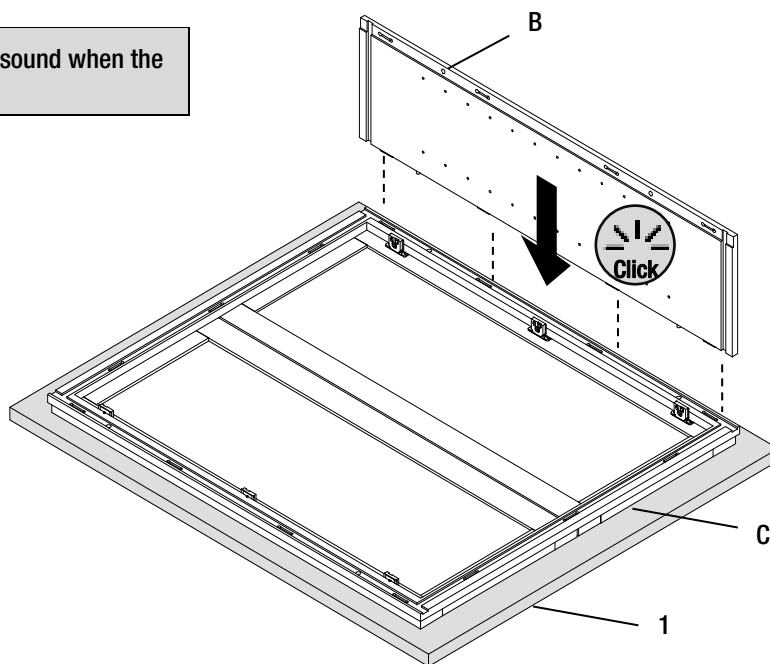
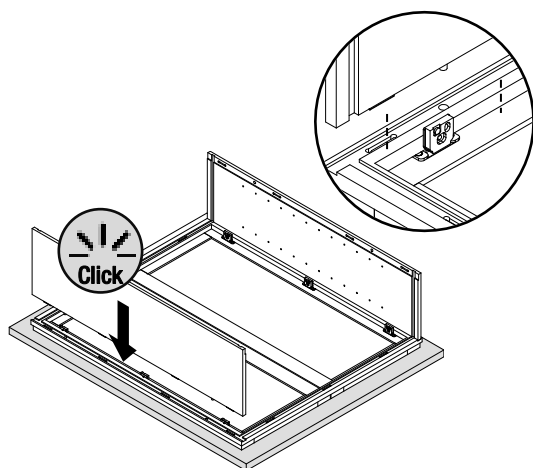

2 Attaching the bottom panel

- Slide the bottom and top panel (D) into grooves in the sides (B). Use both hands to firmly press the panels (D) down at all locations with connectors to ensure they lock together tightly.

SLIDING PANEL	
Bottom/top/ middle panel slides vertically.	Bottom/top/middle panel slides unevenly and tilting.
✓ RIGHT	✗ WRONG

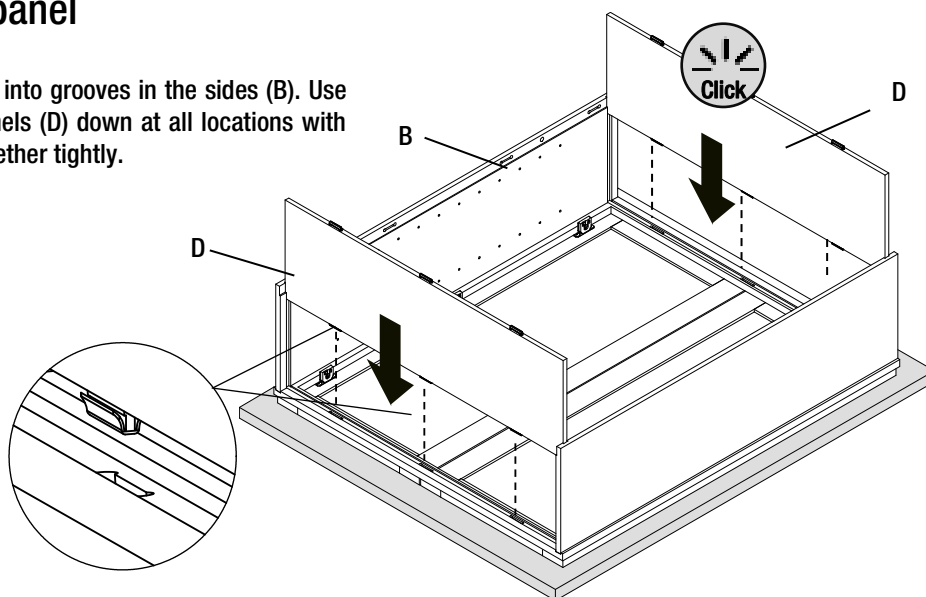

Cabinet Assembly (continued)

3 Attaching the back panel to the bottom panel/support shelf

- Flex outwards side panels (B) slightly then place mating groove on the back panel (A) to the bottom and top panel (D) as shown.
- Aligning the female connectors on back panel (A) to the male connectors on top/bottom panels (D).
- Use both hands to firmly press the back panel (A) down at all locations with connectors to ensure they lock together tightly.

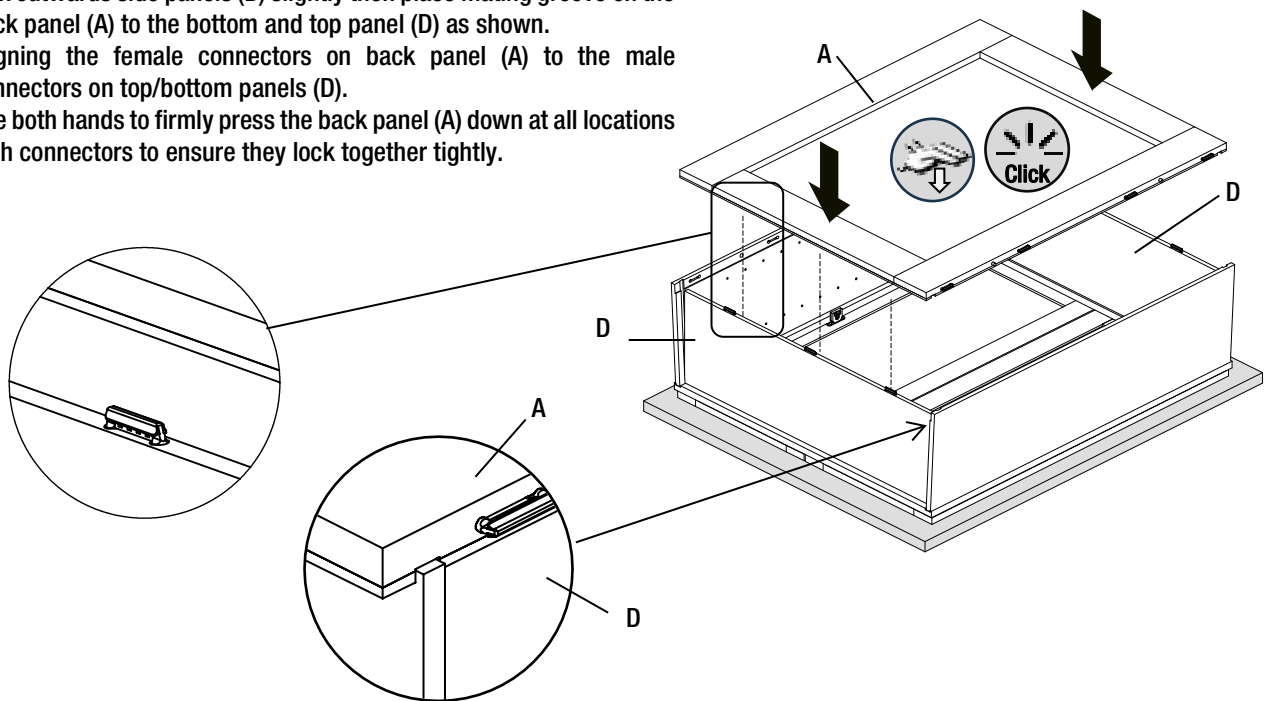

4 Attaching the side panels to bottom panel.

- Attach the two side panels (B) to the back panel (A) by: aligning the wooden dowels & male connectors on the back panel (A) to the holes & female connectors on side panels (B).



IMPORTANT: Use your hands to grab the 2 sides (B) inward at all locations with connectors to ensure they lock with (A) tightly.

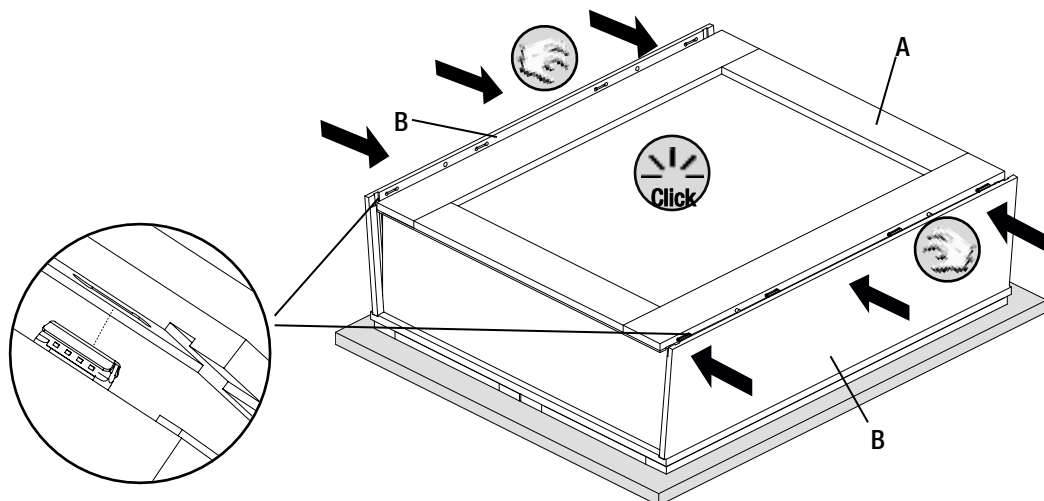

Cabinet Assembly (continued)

5 Attaching the shelf pins into the side panels and installing the shelf

- ☐ Insert the shelf pins with pre-drilled holes on each side panels.
- ☐ Tilt the shelf (E) to fit inside the face frame and snap over the shelf pins (EE).
- ☐ To remove the shelf, push the tabs (1) on the shelf pins and lift the shelf.

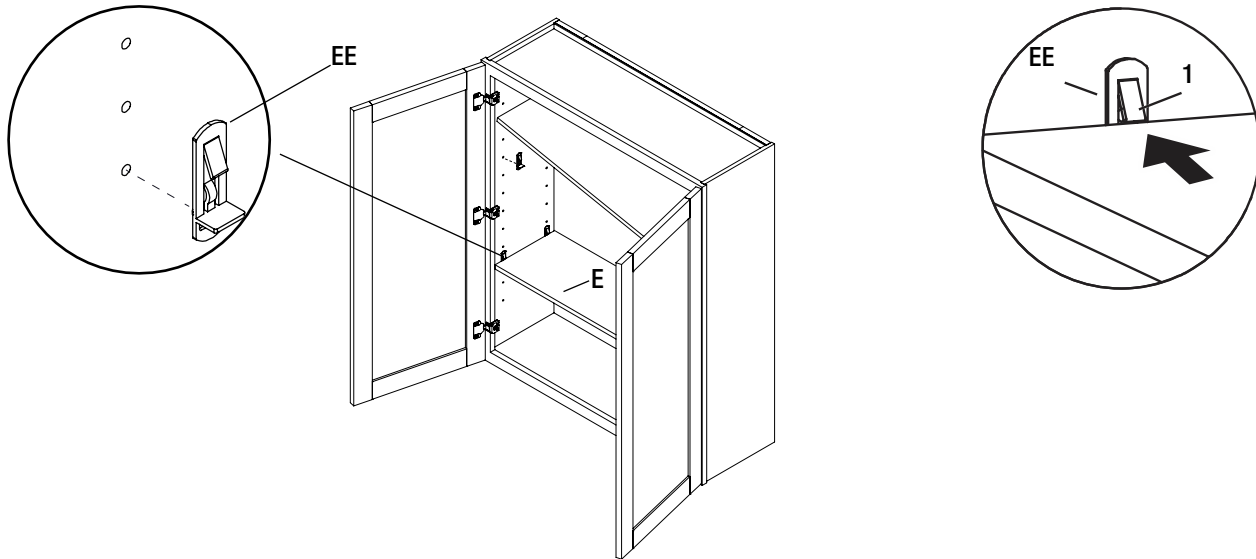

6 Attaching silicone pads

- ☐ Peel and stick 2 silicone pads (DD) onto the inside corners of each door.

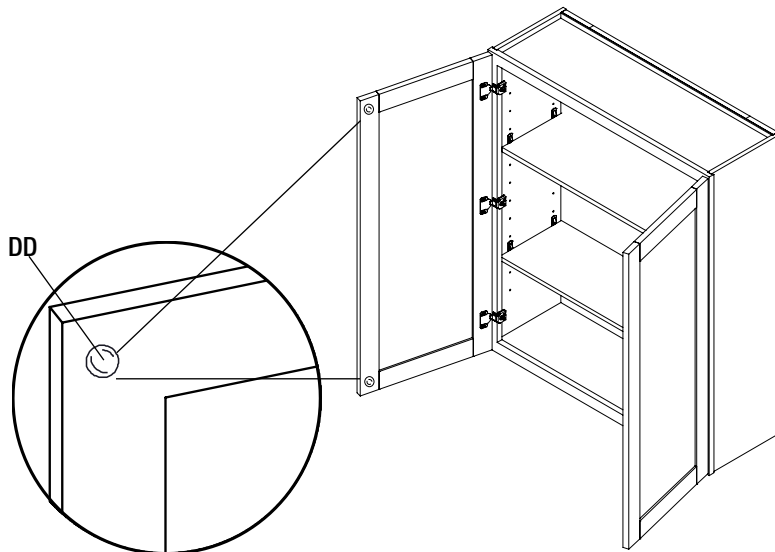

Cabinet Assembly (continued)

7 (OPTIONAL) Reversing the door position.

- ☐ You can remove and reposition the door to the other side of the face frame at any time using the pre-drilled holes. For pre-drilled holes that are not used, you can cover them up using a wax pencil or touch-up paint pen.

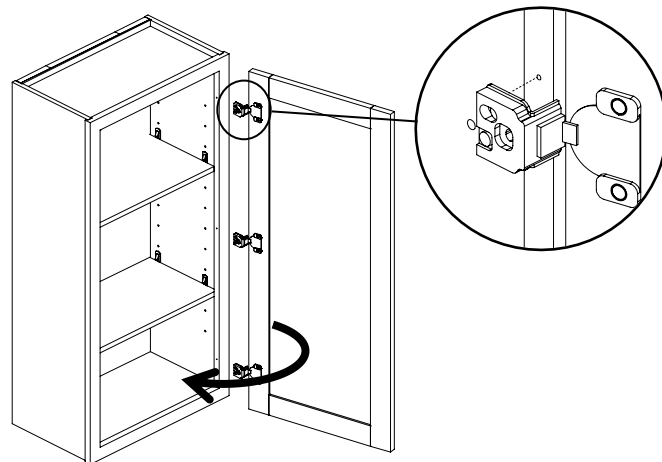

8 (OPTIONAL) Adjusting the door.

- ☐ Door hinges are 6-way adjustable.
- ☐ Up or down adjustment – Loosen screw 1, align the door, and tighten screw 1.



NOTE: It is critical that you do NOT overtighten screw 1.

- ☐ Left or right adjustment – Turn screw 2 clockwise or counterclockwise.
- ☐ In or out adjustment – Turn screw 3 clockwise or counterclockwise.

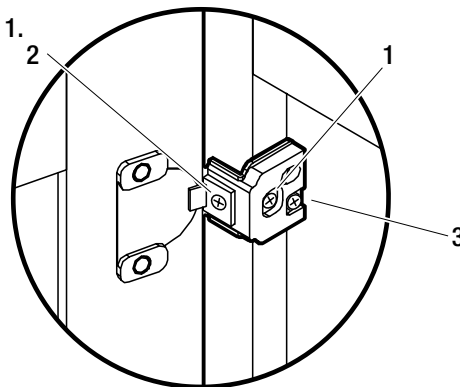

1

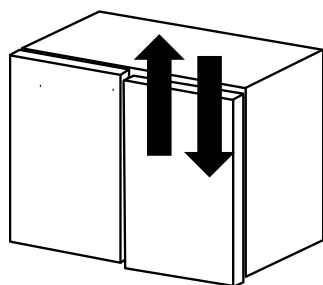

2

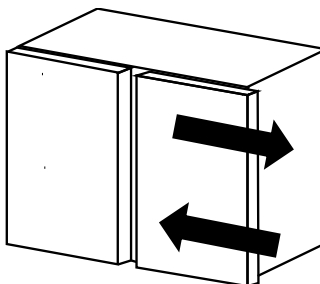

3

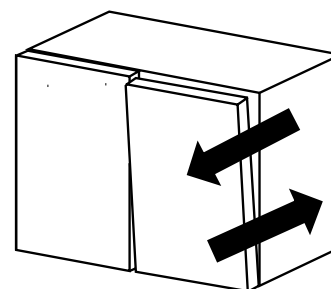

Before Putting in Use

1 Check before putting in use



IMPORTANT:

- Before putting in to use, use a rubber mallet and wooden pad to tap all locations with connectors to ensure they lock together tightly.
- The wooden pad helps avoid damaging the product.



CONNECTION CHECK

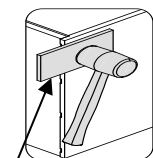

Wooden pad

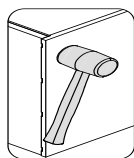

RIGHT



WRONG

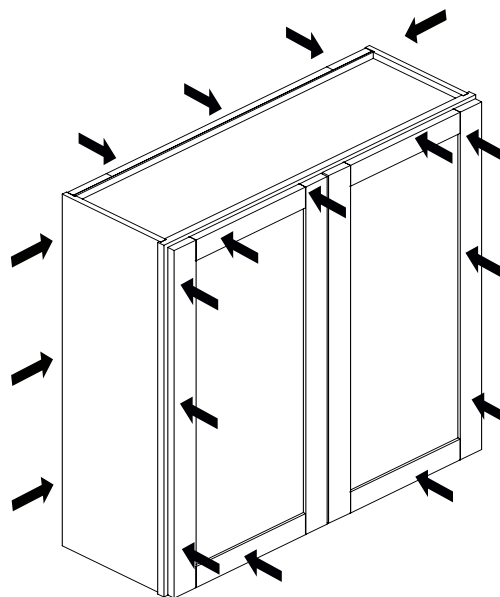

2 Hang or attach the cabinet to the wall.



IMPORTANT:

- When hanging the cabinet on the wall or attaching it to the wall, making sure it is attached to the "frame" of the back panel as shown beside

FRAME

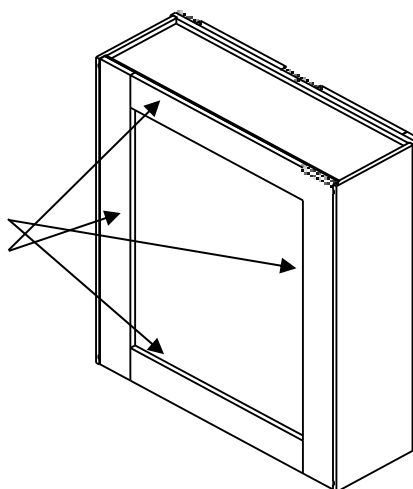

Care and Cleaning

- ❑ For normal spills, a damp cloth is sufficient. Dry the surface immediately.
- ❑ Doors can be cleaned with most general-purpose household cleaners.
- ❑ Do not use caustic agents and/or abrasive scrubbers, or oven cleaners.
- ❑ Cabinets can be cleaned with a damp sponge or cloth using soapy water, or most general-purpose household cleaners. Do not use any abrasive cleaner or scrubbers.
- ❑ Do not allow liquids to remain on the surface for long periods of time.

HAMPTON BAY®

Questions, problems, missing parts? Before returning to the store,
call Hampton Bay Customer Service
8 a.m. – 7 p.m., EST, Monday – Friday, 9 a.m. – 6 p.m., EST, Saturday

1-855-HD-HAMPTON

HAMPTONBAY.COM

Retain this manual for future use.