

User Manual

True Wireless Earbuds

BTWS-TWS110

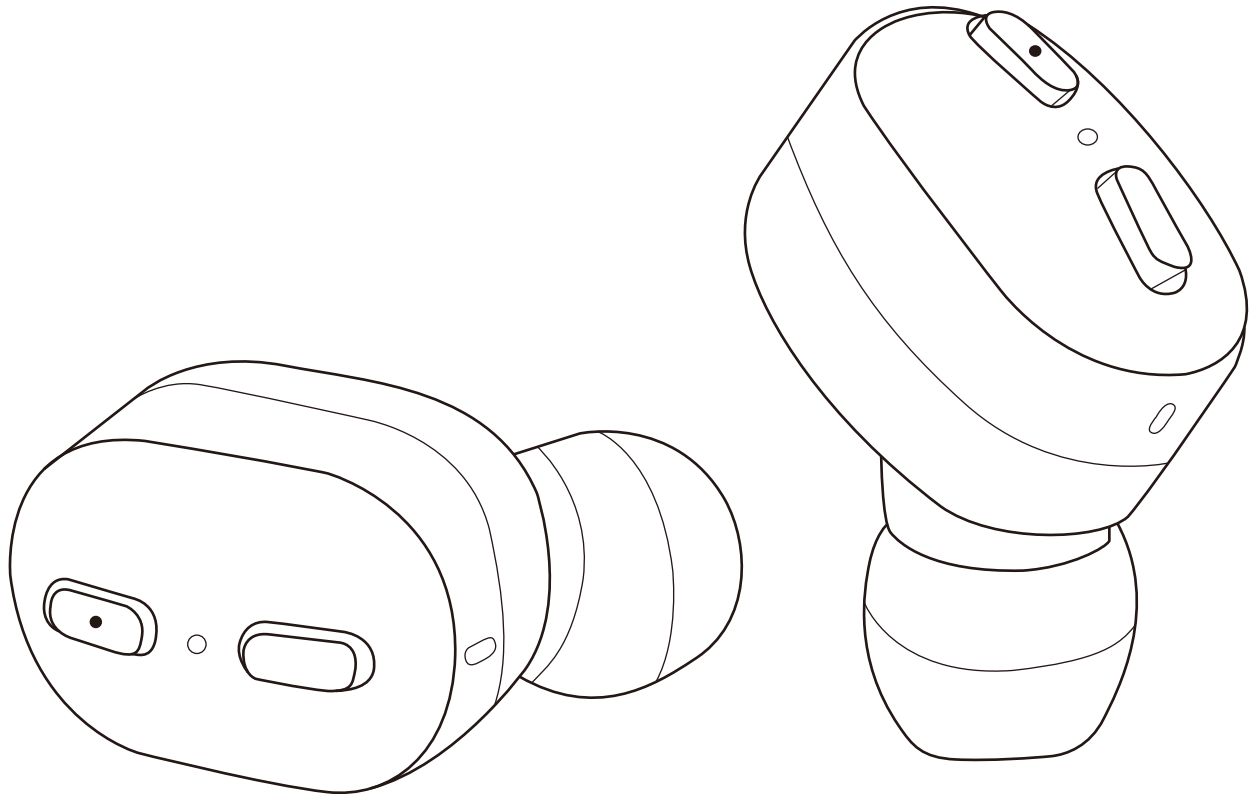

Product Overview	1
How to wear	1
Basic operation	2
Connect to a mobile device	3
LED indicator status	6
Charging	6
Reset / clear pairing history	8

Product Overview

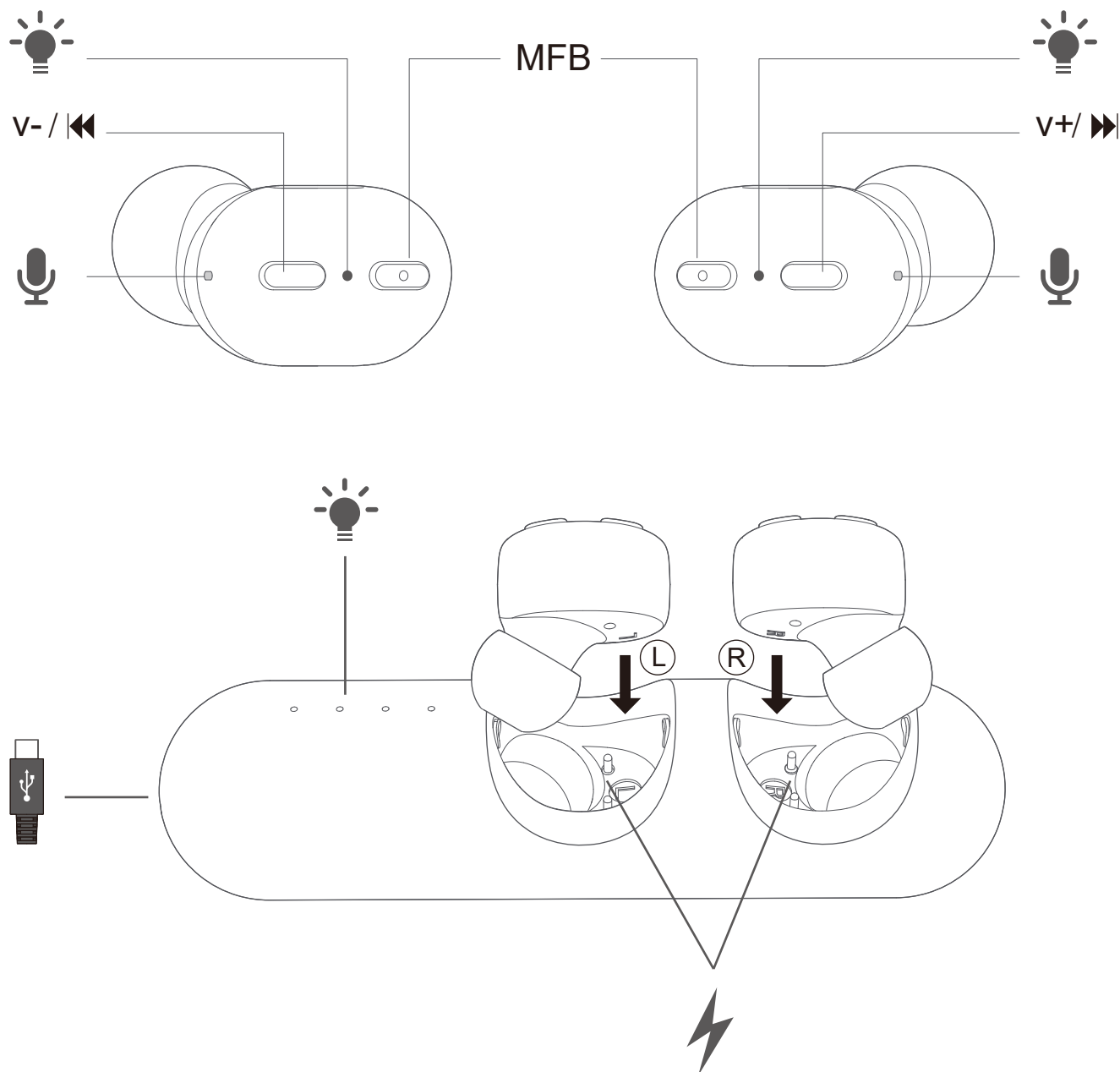

How to wear?

Choose a snug-fitting pair of earbud tips - M works for most (Fig.1)

Insert earbud and adjust for secure fit (Fig.2)

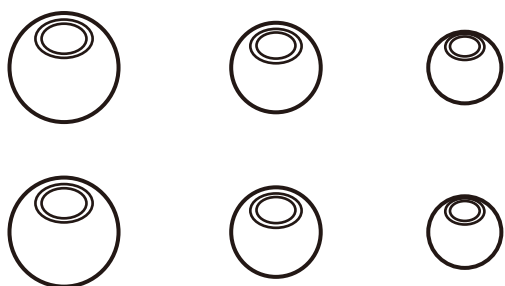



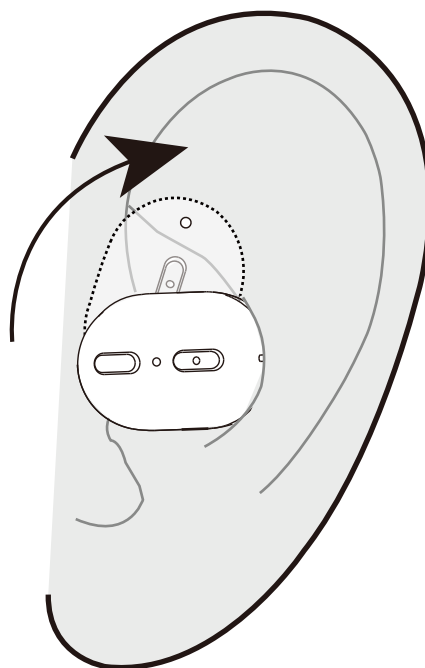



(Fig.1)

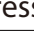

(Fig.2)

Basic operation

FUNCTION	OPERATION
Power On	Take out from charging case. OR short press  about 1s, LED light will illuminate WHITE about 1s.
Power Off	Put the earbuds into the charging case and they will power off and commence charging. Or long press  for about 5s, LED light will illuminate RED for about 2s, then turn off.
Pairing	Remove BOTH earbuds from case - one will automatically enter pairing mode and its LED will flash WHITE and RED alternately
Play / Pause	Short press  once
Volume Up / Down	Short press the  in the RIGHT / LEFT earbud
Previous / Next Track	Long press the  in the LEFT / RIGHT earbud
Answer / End A Call	Short press  once
Active Voice Assistant	Long press  about 1s then release

Connect to a mobile device

NOTE: Make sure to remove **BOTH** earbuds from case for first time use with a new mobile device.

First use >

1. Remove **BOTH** earbuds from the charging case. They will connect to each other, and within 10s one of the earbuds will enter pairing mode - its LED will flash **WHITE** and **RED** alternately

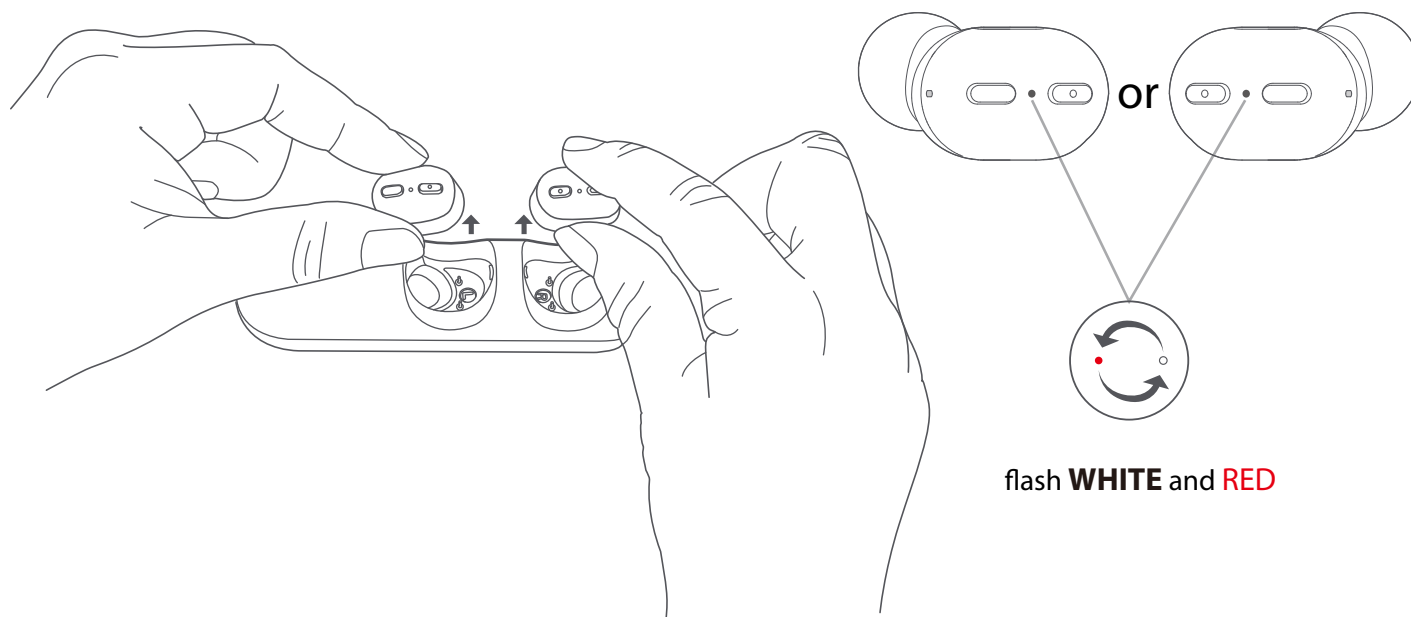

2. Activate Bluetooth on your device. Search and select "Avantree TWS110" to connect. All the LEDs will turn off once connected. Now you can stream audio.

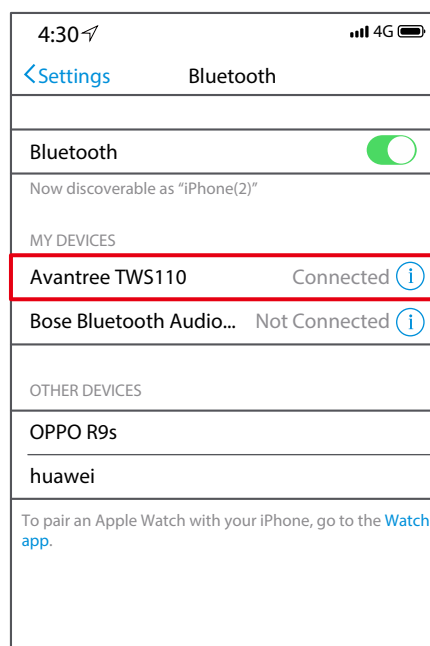
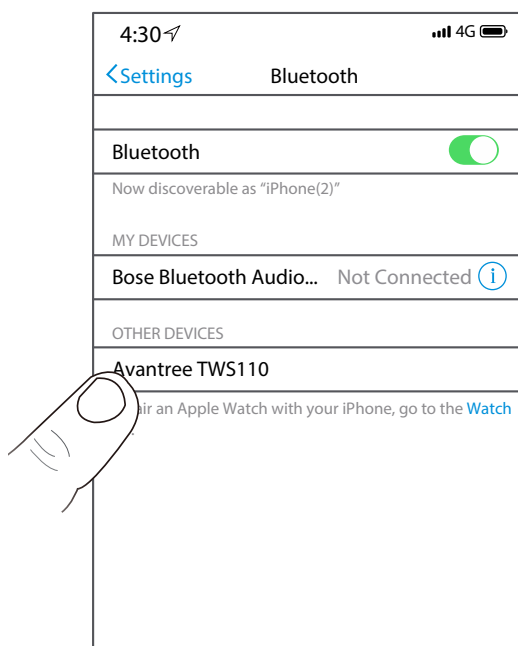

After first use (Reconnect), please >

1. Ensure the Bluetooth on your device is on.

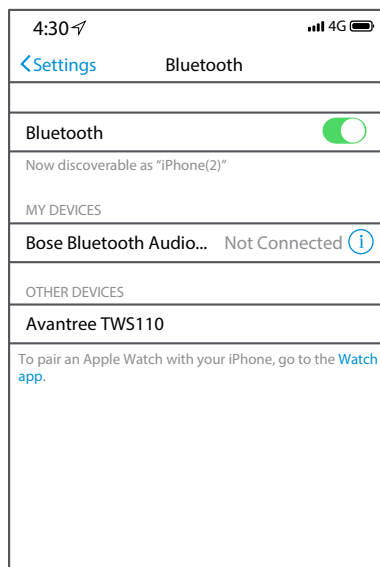

2. Remove BOTH earbuds from the charging case. Wait for 5~10 seconds, they will connect to the LAST PAIRED device.

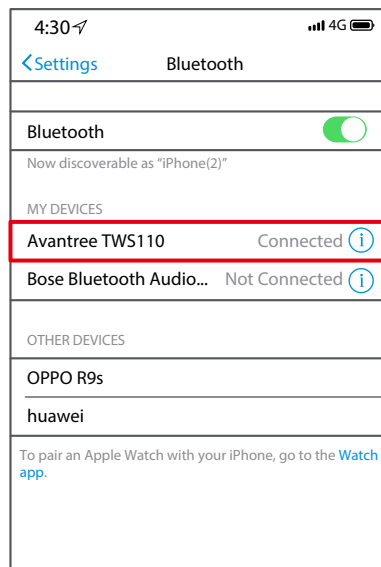
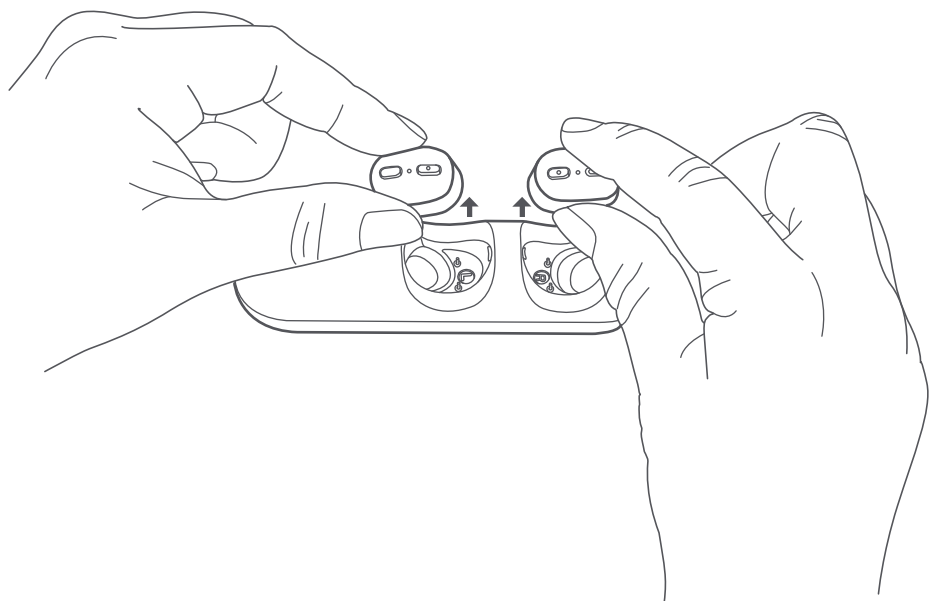

Note: If it fails to reconnect, please click "Avantree TWS110" on your device to manually connect.

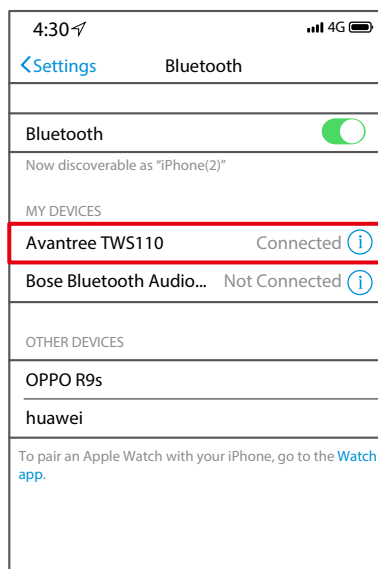
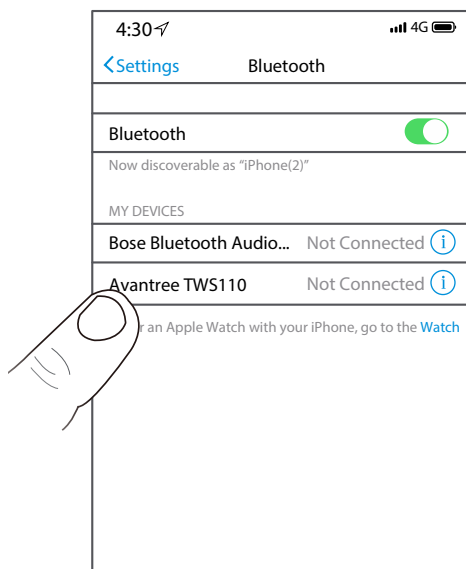

Connect to a NEW device>

1. Make sure the Bluetooth on previously connected device is off.

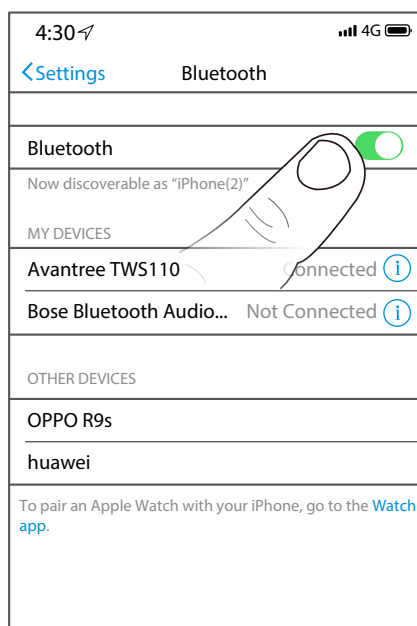

2. Follow the steps in the "First use" section to connect to a new device.

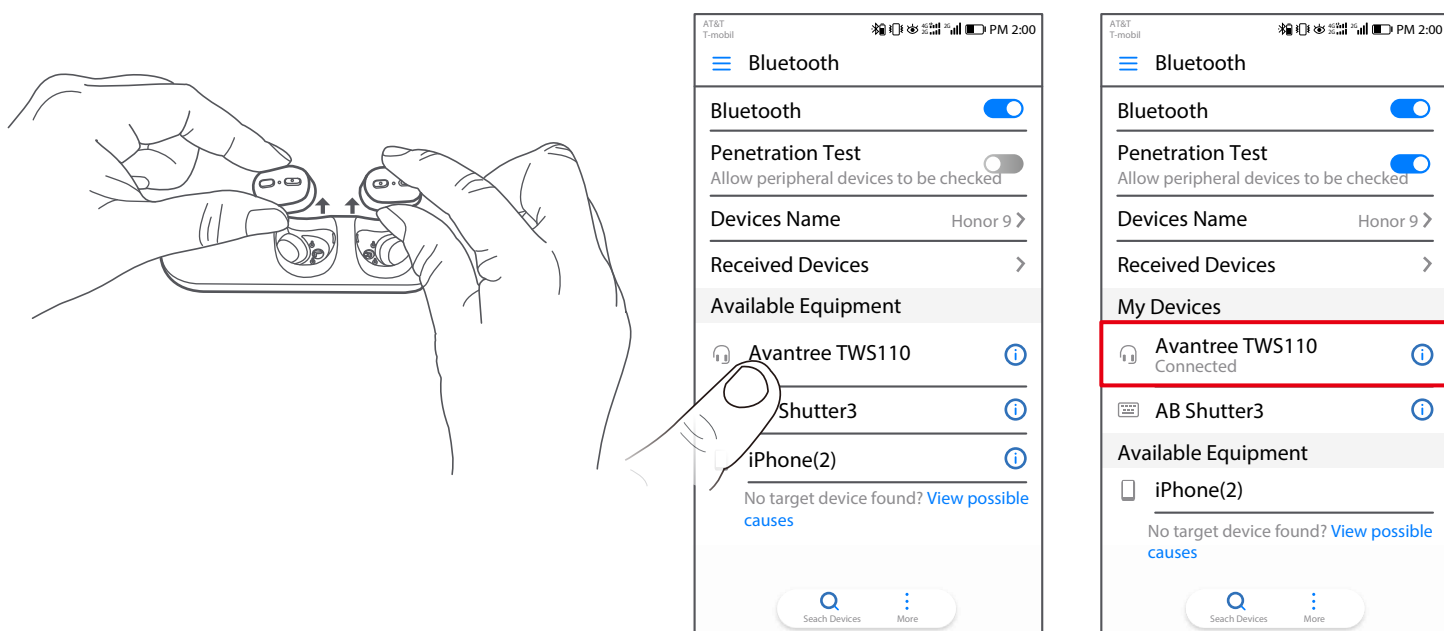

Mono earbud use >

Either side can be used separately as a mono earbud.

1. Make sure you have previously connected the earbuds with your phone as a TWS pair first.
2. Just remove the earbud you want from the case and it will automatically reconnect.

Note that button functions remain unchanged, so R earbud controls volume up and next track.

LED indicator status

EARBUDS STATUS	LED INDICATOR
Ready to pair	Flashes WHITE and RED alternately
Connected	Turns off
Not connected	Flashes WHITE once every 5s
Charging	Solid RED
Fully charged	Turns off

Charging

Charge the earbuds >

When you hear a voice prompt “battery low”, please put the earbuds into the charging case to charge. It normally takes about 1 hour to fully charge.
During charging the LED on the earbud will illuminate **red**. When fully charged, the LED will turn off.

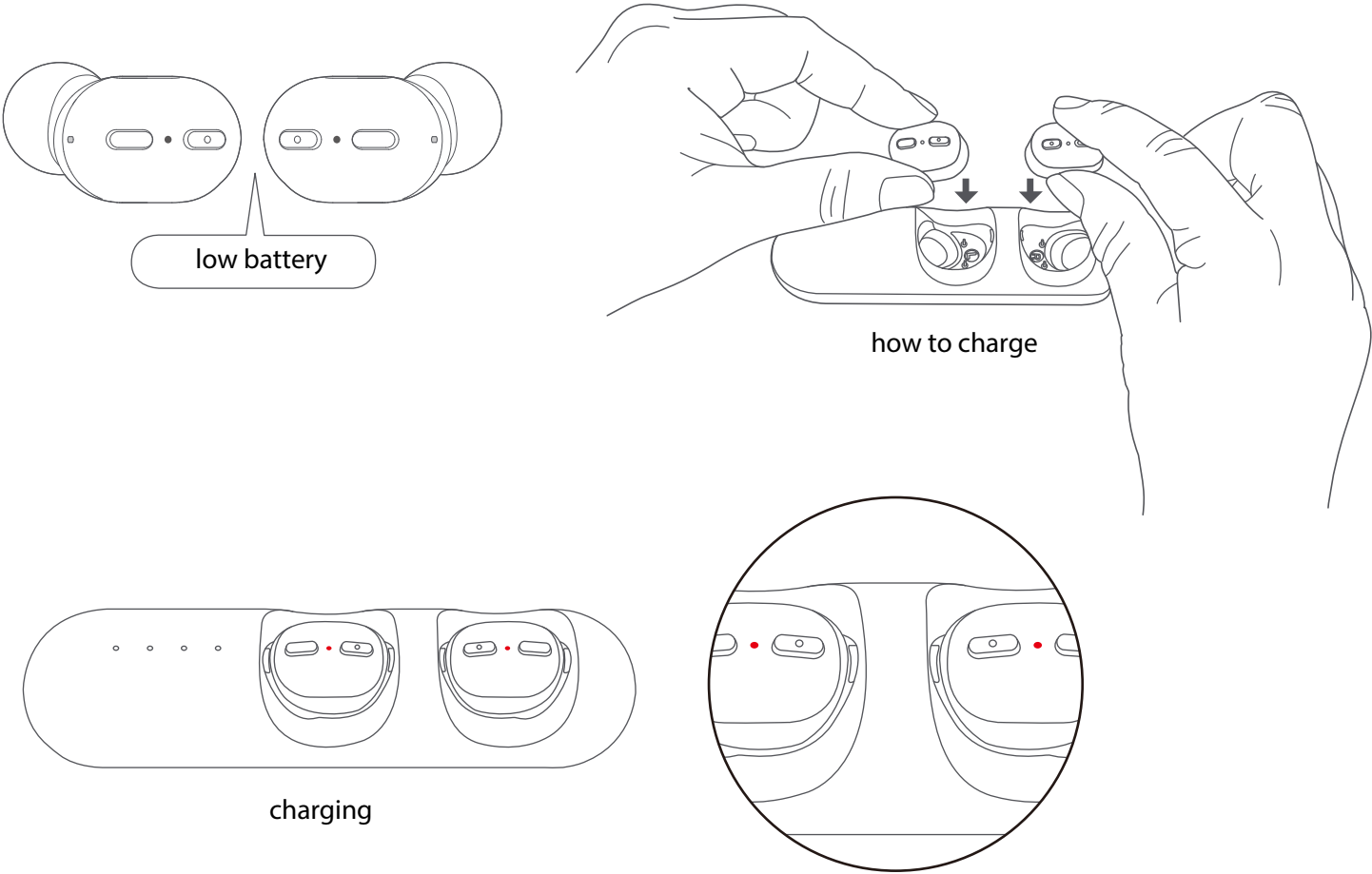

Charge the charging case >

A fully charged case can charge the earbuds 5-6 times, providing up to an additional 24 hours of play time.

When all the LEDs on the case flashes **white** rapidly about 5 times every 20 seconds, you should fully recharge the case (takes about 2.5 hours).

Please use a DC 5V / 0.5-2A USB wall charger / car charger / computer USB port with the included Micro USB cable to charge.

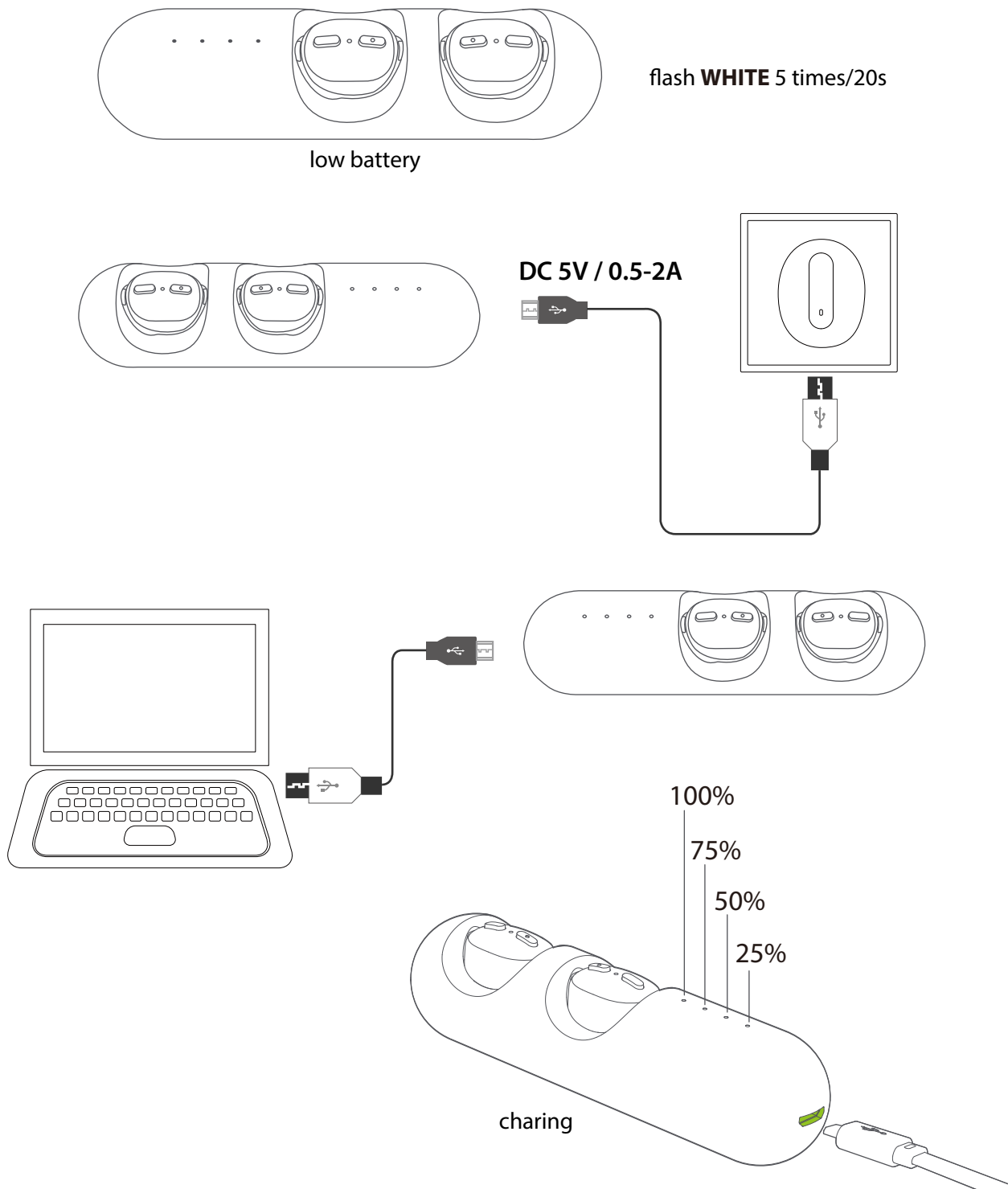



While charging, the LED will flash white based on the battery level. When fully charged, all the LEDs will stay **white** until you pull off the charging cable.

Reset / clear pairing history

If the earbuds exhibit abnormal behavior, e.g. can't pair with device, please 'reset' your pairing history:

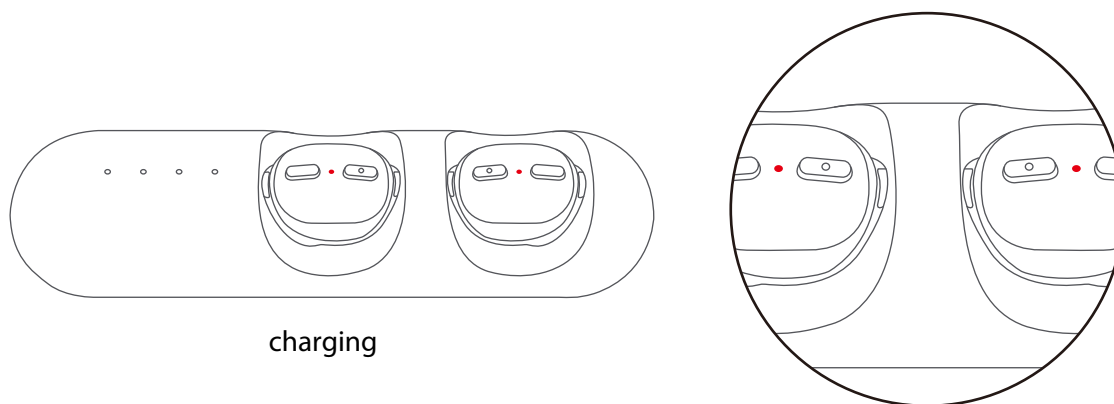
1. Put both earbuds back into the charging case. Make sure the earbuds are powered off and charging.



2. Press and hold  on both earbuds for about 15s, until the LEDs turn WHITE for about 2s. (You can also operate one by one.)

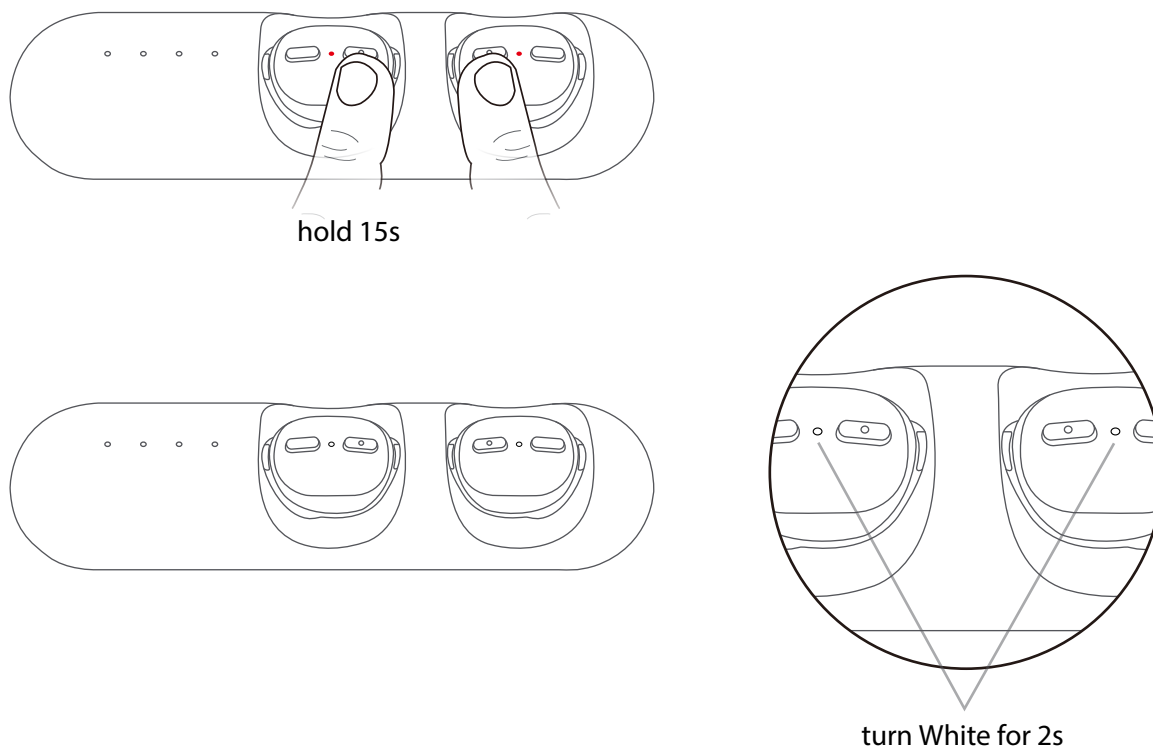

3. Both earbuds are now reset to their factory settings.

Note: In order to pair again with your phone please delete "Avantree TWS115" you're your phone's Bluetooth menu and refer to "First use" section.

