

### **User Manual of Product 1:**

Dreo Tower Fan 42 Inch, Cruiser Pro T1 Quiet Oscillating Bladeless Fan with Remote, 6 Speeds, 4 Modes, LED Display, 12H Timer, Black Floor Standing Fan Powerful for Indoor Home Bedroom Office Room

### **User Manual of Product 2:**

Dreo Table Fans for Home Bedroom, 9 Inch Quiet Oscillating Floor Fan with Remote, Air Circulator Fan for Whole Room, 70ft Powerful Airflow, 120° Adjustable Tilt, 4 Speeds, 8H Timer

**DREO**

# Tower Fan

## USER MANUAL

[www.dreo.com](http://www.dreo.com)

DR-HTF001

### Looking for help?

Contact us to get expert support.



[support@dreo.com](mailto:support@dreo.com)



[\(888\) 290-1688](tel:(888)290-1688)



[www.dreo.com](http://www.dreo.com)

Mon - Fri, 9:00 am-5:00 pm PST/PDT

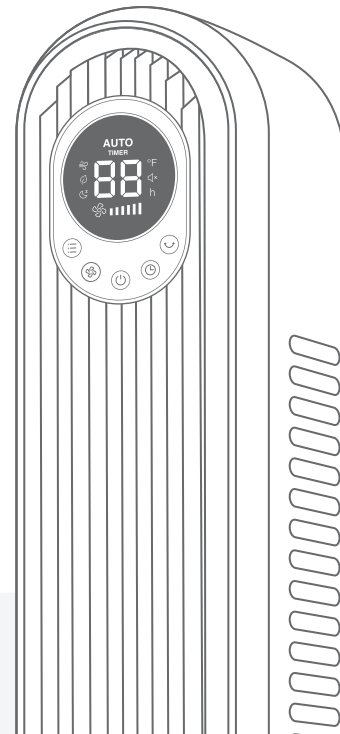

//

# Thanks for Choosing DREO!

Your support means the world to us. We hope you enjoy our product as much as we did creating it.



## CONTENTS

1

### IMPORTANT SAFETY INSTRUCTIONS

1-2

3

### KNOWING YOUR TOWER FAN

6-7

5

### CLEANING AND MAINTENANCE

12-13

7

### DREO CUSTOMER CARE

15

2

### ASSEMBLING YOUR TOWER FAN

3-5

4

### USING YOUR TOWER FAN

8-11

6

### TROUBLESHOOTING

14

8

### FCC STATEMENT

16

# IMPORTANT SAFETY INSTRUCTIONS



READ ALL CAUTIONARY MARKINGS ON THE APPLIANCE AND SAFETY INSTRUCTIONS IN THE USER MANUAL BEFORE USE.



**Do not** cover the air inlet and outlet while in operation.



**Do not** use the fan near flammables and combustibles.



## General Safety

1. Children shall not play with the appliance. Cleaning and maintenance shall not be performed by children without supervision.
2. Use the appliance as described in the user manual only. Any other use not recommended in the user manual may cause fire, electrical shock, or personal injury.
3. This appliance can be used by children aged above 8 years and persons with reduced physical, sensory or mental capabilities or lack of experience and knowledge if they have been given supervision or instruction concerning use of this appliance in a safe way and understand the hazards involved.

## Operation Safety

1. Place the appliance on a flat, dry surface before use.
2. **Do not** immerse in water and any other liquids.
3. **Do not** use the appliance until the base is installed.
4. **Do not** insert your fingers, pencil and any other objects into the grilles while in operation.
5. **Do not** dismantle, repair, or modify. All servicing should be performed by qualified personnel.

## Electricity Safety

1. Make sure that the voltage of your electricity supply is the same as that indicated on the appliance.
2. Always unplug before cleaning or leaving the appliance unused for a long period of time. Keep your hands dry when plugging/unplugging.
3. Do not operate any fan with a damaged cord or plug. Discard fan or return to an authorized service facility for examination and/or repair.
4. Do not run cord under carpeting. Do not cover cord with throw rugs, runners, or similar coverings. Do not route cord under furniture or appliances. Arrange cord away from traffic area and where it will not be tripped over.
5. **WARNING:** To reduce the risk of fire or electric shock, do not use this Fan with any solid-state speed control device.
6. This appliance employs overload protection (fuse). A blown fuse indicates an overload or short-circuit situation. If the fuse blows, unplug the product from the outlet. Replace the fuse as per the user servicing instructions and check the appliance. If the replacement fuse blows, a short-circuit may be present and the appliance should be discarded or returned to an authorized service facility for examination and/or repair.
7. This appliance has a polarized plug (one blade is wider than the other). To reduce the risk of electric shock, this plug is intended to fit in a polarized outlet only one way. If the plug does not fit fully in the outlet, reverse the plug. If it still does not fit, contact a qualified electrician. Do not attempt to defeat this safety feature.

## FOR HOUSEHOLD USE ONLY READ AND SAVE THESE INSTRUCTIONS

### Gentle Reminder:



Check the appliance regularly and refer to TROUBLESHOOTING or contact our customer support if it shows any of the following signs:

- Power cord or plug is damaged.
- Loud noise, unusual smell or excessive heat.

### Specifications

Model	DR-HTF001
Input	AC 120V 60Hz
Rated Power	50W
Battery Type	CR2025 3V

# ASSEMBLING YOUR TOWER FAN

## 2

### Assembly Instructions

When using the appliance for the first time, remove the wraps and attach the parts by following the steps below.

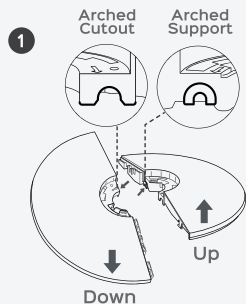

Keep the base halves in a crossed position, then hook the arched cutout on one half onto the arched support on the other half.

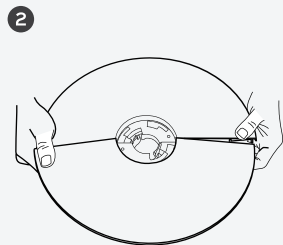

Press down on edges to click two base halves together.



Run the cord through the center hole.

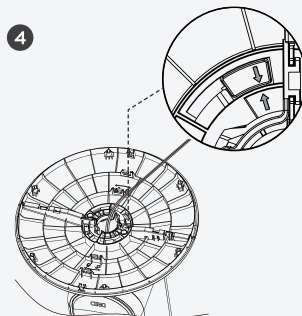

Fit the base onto the bottom of the fan by aligning the arrows on the underside.

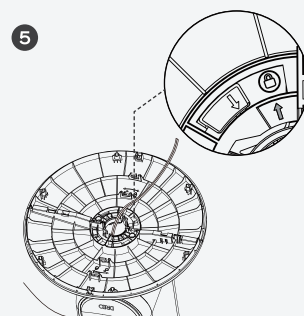

Rotate the base counterclockwise to lock in place.

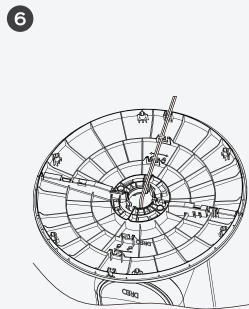

Thread the cord through all REAR cord keepers and put the fan upright.

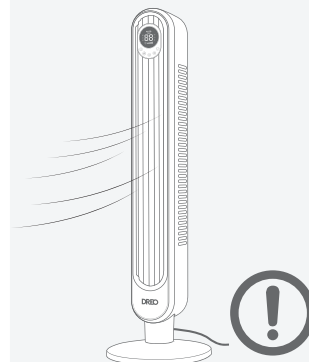

### CAUTION

- Do not operate the tower fan if the base has not been installed.
- Make sure to thread the cord through all rear cord keepers.

## Package Contents

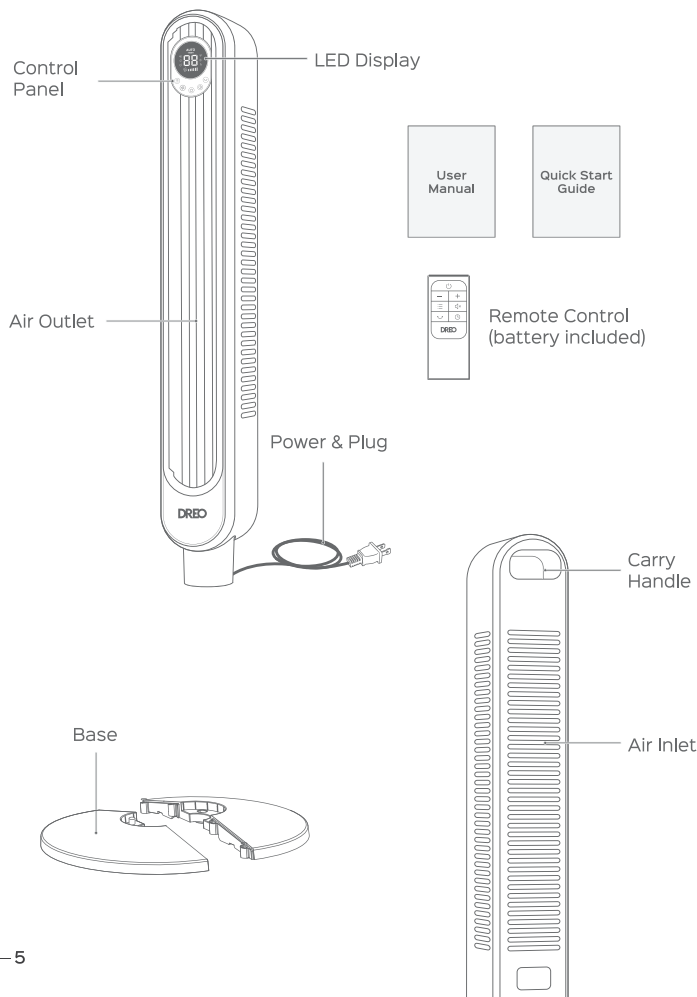

## KNOWING YOUR TOWER FAN

3

### Control Panel

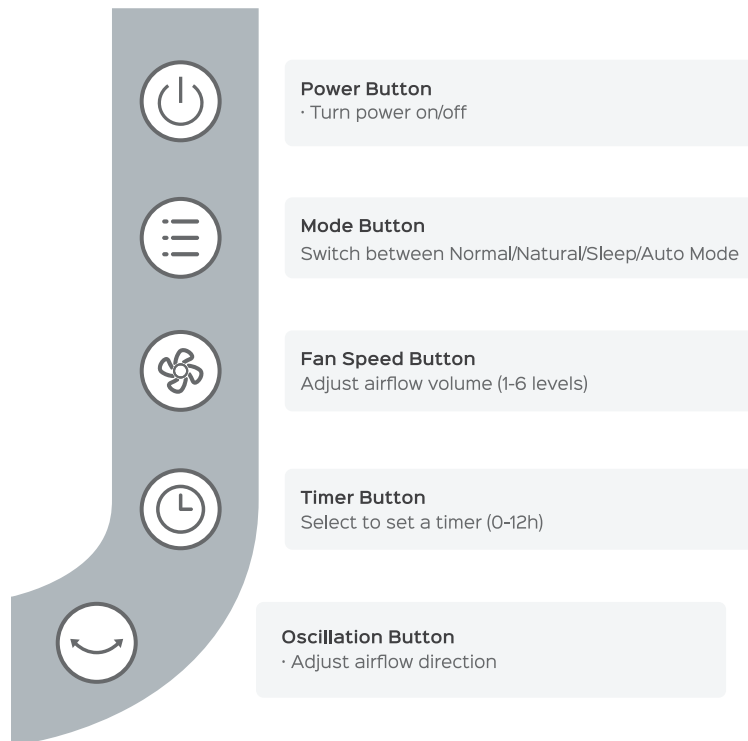

## LED Display

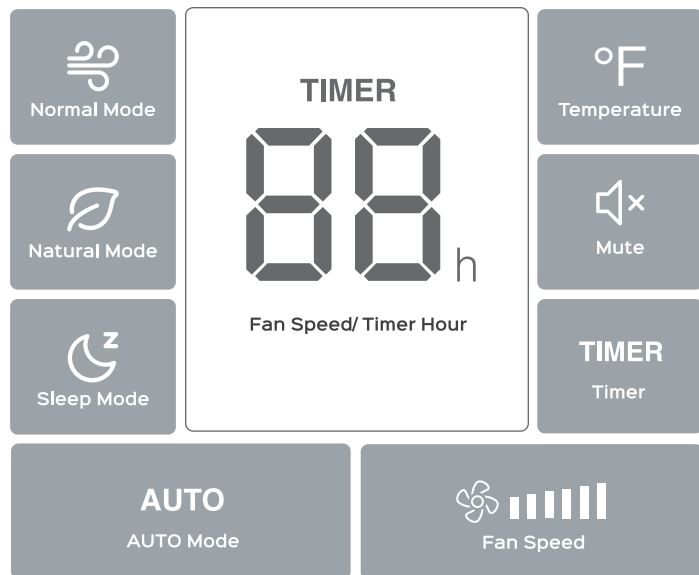

## USING YOUR TOWER FAN

### General Operations



- 1 Press to turn on, and to choose a working mode.
- 2 Press to adjust the airflow volume.
- 3 Press to change the airflow direction.
- 4 Press to set a timer.
- 5 Press to turn off the tower fan.

### Working Modes

#### Sleep Mode (Mute Auto On)

Fan speed decreases every 30 minutes.

Speed decreases by two levels at most and will remain constant if at level 1:

For level 6: 6→5→4

For level 5: 5→4→3

For level 3: 3→2→1

For level 2: 2→1

For level 1: 1

#### Auto Mode

Fan speed adapts to the ambient temperature.

#### Normal Mode

Fan runs at the constant speed.

#### Natural Mode

Fan runs at alternating speeds.

# Additional Features



**Mute** (remote control only)  
Press to turn on/off the button sounds.



**Speed/Temp Switch** (long press)  
The display shows the fan speed by default. Long press the Mode button to switch speed to temperature.



**Timer**  
When the fan is ON, press the Timer button repeatedly to set a timer (1-12h). When the timer ends, the fan will stop running automatically. To cancel, set the timer to 0 hour.  
**Note:** Display will return to fan speed/temperature after 10 seconds.



**Memory**  
If the fan stays connected to the electrical outlet after turning OFF, the fan will operate under the previous settings (except timer setting) when turned ON again.



**Display Auto Off**  
- Display turns off after 1 minute (after 5 seconds in sleep mode).  
- Wake up the display with any button.

## Getting the Most out of Your Tower Fan

1. Remove any tall obstacles that might block the airflow from the fan.
2. Combine with your AC unit to get cooler air throughout the room.
3. Position the tower fan closer to you to get more direct airflow.
4. Place a bucket of ice in front of the fan for an extra cooling boost.

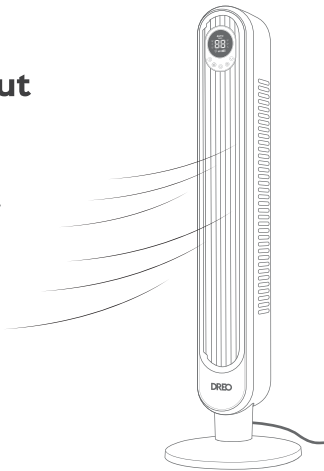

## Remote Control





## Battery Replacement

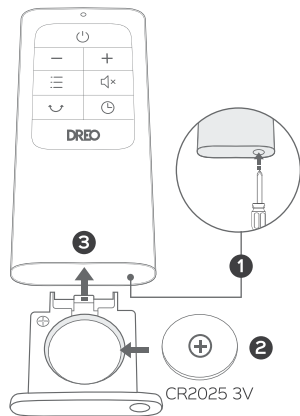

- 1 Press the locking button to pop out the battery holder.
- 2 Replace with the same battery type with the (+) side facing up.
- 3 Push in the holder until securely locked into place.

*Note: If the indicator on the remote control doesn't turn on any more, please consider replacing the battery.*



### WARNING

Chemical Burn Hazard. Keep batteries away from children.

This product contains a lithium button/coin cell battery. If a new or used lithium button/coin cell battery is swallowed or enters the body, it can cause severe internal burns and can lead to death in as little as 2 hours. Always completely secure the battery compartment. If the battery compartment does not close securely, stop using the product, remove the battery, and keep it away from children. If you think batteries might have been swallowed or placed inside any part of the body, seek immediate medical attention.

The cells must be disposed of properly, including keeping them away from children. Even used cells may cause injury.

## CLEANING AND MAINTENANCE

# 5

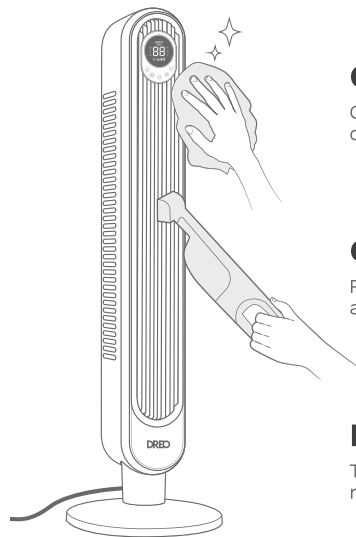

### Outer Surface

Gently wipe off the dust with a soft, dry cloth.

### Grilles & Blades

Remove the dust using a vacuum or air duster.

### Base

The base can be disassembled in reverse order of assembly.



### CAUTION

1. Always unplug the fan before any cleaning or maintenance to avoid the risk of fire, electric shock, or injury to persons.
2. Do not immerse in water or get water inside the motor housing.
3. Do not use any chemical agents when cleaning the fan.
4. Store in a cool, dry place and cover it to protect from dust.

## User Servicing Instructions (Fuse)

This appliance features a fused safety plug that protects against overload or short-circuit situations. If the fuse blows, please cut off power and follow the below instructions or consult a qualified electrician.

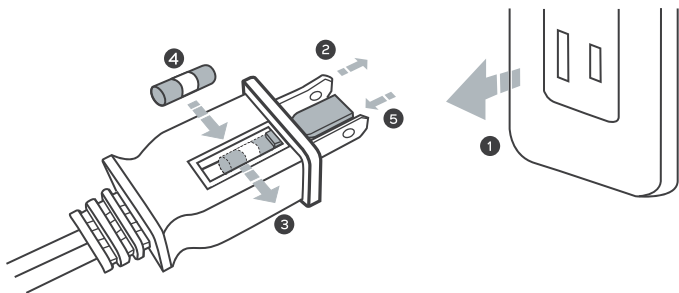

- 1 Grasp plug and remove from the receptacle or other outlet device. Do not unplug by pulling on cord.
- 2 Open fuse cover. Slide open fuse access cover on top of attachment plug towards blades.
- 3 Remove fuse carefully. Push the fuse from the other side to remove the fuse.
- 4 Risk of fire. Replace fuse only with 2.5 Amp, 125 Volt fuse.
- 5 Close fuse cover. Slide closed the fuse access cover on top of attachment plug.



### WARNING

Risk of fire. Do not replace attachment plug. Contains a safety device(fuse) that should not be removed. Discard product if the attachment plug is damaged.

## TROUBLESHOOTING



### My fan won't turn on!

1. Make sure that the cord is connected to a powered outlet and the mains voltage corresponds with the voltage indicated on the fan.
2. Check if the fuse has blown. If the fuse has blown, please refer to **page 13**.

### My fan is shaky and wobbling!

1. Place the fan on a flat, level surface.
2. Incorrect installation might also cause shakiness. Please refer to the assembly instructions in **page 3-4**. Note that the power cord must be run through all three keepers.

### My fan is making vibration and noise!

1. Place the fan on a flat, level surface.
2. Be sure not to insert anything into the air inlet and outlet.

If your problem is not listed or still persists, please contact our Customer Support (**see page 15**).

# DREO CUSTOMER CARE



## Default 12-Month Warranty

This appliance is covered by Dreo warranty for 12 months from the date of its original purchase.

## Extend Your Warranty

Extend your warranty by registering your new appliance on our website <https://dreo.com/warranty>.

### The warranty will not apply in cases of:

1. Accident, misuse, or repairs performed by unauthorized personnel.
2. Any unit that has been tampered with or used for commercial purposes.
3. Normal wear and tear of wearable parts.
4. Use of force, damage caused by external influences.
5. Damage caused by non-observance of the User Manual, e.g. connection to an unsuitable mains supply or noncompliance with the instructions.
6. Partially or completely dismantled appliances.
7. Defects caused by or resulting from damages from shipping or from repairs, service, or alteration to the product or any of its parts that have been performed by a repair person not authorized by Dreo.

We can only provide after-sales service for products that are sold by Dreo or Dreo authorized retailers and distributors. If you have purchased the appliance from a different place, please contact your seller for return and warranty issues.



(888) 290-1688



support@dreo.com



www.dreo.com

Mon - Fri, 9:00 am-5:00 pm PST/PDT

# FCC STATEMENT



This device complies with Part 15 of the FCC Rules.

This equipment has been tested and found to comply with the limits for a Consumer ISM equipment, pursuant to Part 15 of the FCC Rules. These limits are designed to provide reasonable protection against harmful interference in a residential installation. This equipment generates, uses and can radiate radio frequency energy and, if not installed and used in accordance with the instructions, may cause harmful interference to radio communications. However, there is no guarantee that interference will not occur in a particular installation.

"Please note that changes or modifications of this product is not expressly approved by the party responsible for compliance could void the user's authority to operate the equipment."

"If this equipment does cause harmful interference to radio or television reception, which can be determined by turning the equipment off and on, the user is encouraged to try to correct the interference by one or more of the following measures:

- Reorient or relocate the receiving antenna.
- Increase the separation between the equipment and receiver.
- Connect the equipment into an outlet on a circuit different from that to which the receiver is connected.
- Consult the dealer or an experienced radio/TV technician for help.



www.dreo.com



Shenzhen Hesung Innovation Technology Co., LTD



26F, Bldg A7, Creative City, Shenzhen, China



MADE IN CHINA



Intertek  
5020677

**DREO**

# **Air Circulator Fan**

## USER MANUAL

[www.dreo.com](http://www.dreo.com)

DR-HAF001

### **Looking for help?**

Contact us to get expert support.



[support@dreo.com](mailto:support@dreo.com)



[\(888\) 290-1688](tel:(888)290-1688)



[www.dreo.com](http://www.dreo.com)

Mon - Fri, 9:00 am-5:00 pm PST/PDT

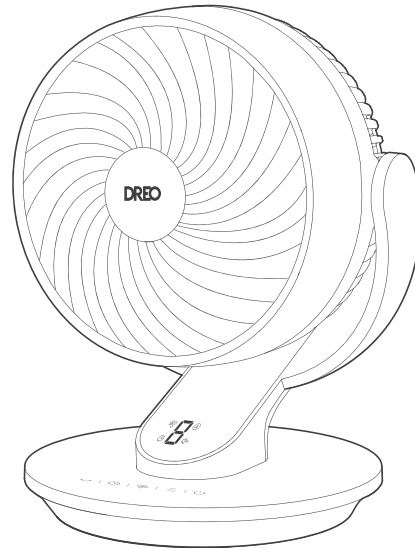

//

# Thanks for Choosing **DREO!**

Your support means the world to us. We hope you enjoy our product as much as we did creating it.



## CONTENTS

**1**

### IMPORTANT SAFETY INSTRUCTIONS

1-2

**2**

### KNOWING YOUR AIR CIRCULATOR FAN

3-5

**3**

### USING YOUR AIR CIRCULATOR FAN

6-10

**4**

### CLEANING AND MAINTENANCE

11-14

**5**

### TROUBLESHOOTING

15

**6**

### DREO CUSTOMER CARE

16

# IMPORTANT SAFETY INSTRUCTIONS



READ ALL CAUTIONARY MARKINGS ON THE APPLIANCE AND SAFETY INSTRUCTIONS IN THE USER MANUAL BEFORE USE.



**Do not** cover the air inlet and outlet while in operation.



**Do not** use the air circulator near flammables and combustibles.

## General Safety

- Children shall not play with the appliance. Cleaning and maintenance shall not be performed by children without supervision.
- Use the appliance as described in the user manual only. Any other use not recommended in the user manual may cause fire, electrical shock, or personal injury.
- This appliance can be used by children aged above 8 years and persons with reduced physical, sensory or mental capabilities or lack of experience and knowledge if they have been given supervision or instruction concerning use of this appliance in a safe way and understand the hazards involved.

## Operation Safety

- Place the appliance on a flat, dry surface before use.
- Do not** immerse in water and any other liquids.
- Do not** use the appliance until the base is installed.
- Do not** insert your fingers, pencil and any other objects into the grilles under any circumstances.
- Do not** dismantle, repair, or modify. All servicing should be performed by qualified personnel.
- Do not** operate the unit close to the curtain. **Do not** hang foreign objects on the grille to prevent damaging the balance of the fan or rotational structure.
- Do not** operate the fan under overly humid, high-temperature, dusty environment or the place where acid or alkali is stored.
- Fans should never blow directly on infant, the elderly and patients for a long time.

## Electricity Safety

### WARNING:

- Make sure that the voltage of your electricity supply is the same as that indicated on the appliance.
- Always unplug before cleaning or leaving the appliance unused for a long period of time. Keep your hands dry when plugging/unplugging.
- Do not operate any air circulator with a damaged cord or plug. Discard air circulator or return to an authorized service facility for examination and/or repair.
- Do not run cord under carpeting. Do not cover cord with throw rugs, runners, or similar coverings. Do not route cord under furniture or appliances. Arrange cord away from traffic area and where it will not be tripped over.
- WARNING:** To reduce the risk of fire or electric shock, do not use this air circulator with any solid-state speed control device.
- This appliance employs overload protection (fuse). A blown fuse indicates an overload or short-circuit situation. If the fuse blows, unplug the product from the outlet. Replace the fuse as per the user servicing instructions and check the appliance. If the replacement fuse blows, a short-circuit may be present and the appliance should be discarded or returned to an authorized service facility for examination and/or repair.
- This appliance has a polarized plug (one blade is wider than the other). To reduce the risk of electric shock, this plug is intended to fit in a polarized outlet only one way. If the plug does not fit fully in the outlet, reverse the plug. If it still does not fit, contact a qualified electrician. Do not attempt to defeat this safety feature.

## FOR HOUSEHOLD USE ONLY READ AND SAVE THESE INSTRUCTIONS

### Gentle Reminder:



Check the appliance regularly and refer to TROUBLESHOOTING or contact our customer support if it shows any of the following signs:

- Power cord or plug is damaged.
- Loud noise, unusual smell or excessive heat.

### Specifications

Model	DR-HAF001
Input	AC 120V 60Hz
Rated Power	52W
Battery Type	CR2025 3V

# KNOWING YOUR AIR CIRCULATOR FAN

# 2

## Package Contents

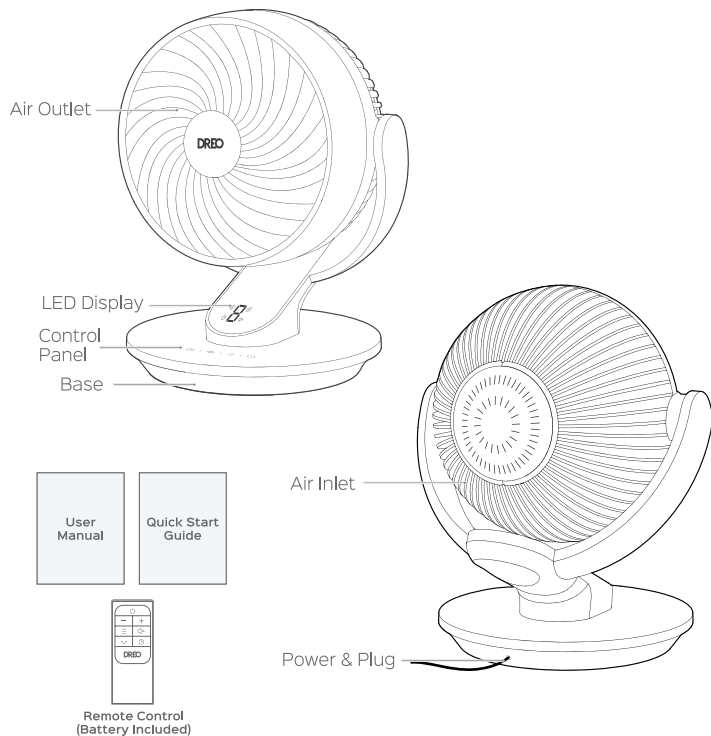

## Control Panel



### Power Button

- Turn power on/off
- Long press 10 seconds to reset to factory settings



### Mode Button

- Switch between Normal/Auto Mode
- Long press to mute/unmute



### Fan Speed Button

Adjust airflow speed (1-4 levels)



### Timer Button

Select to set a timer (0-8h)



### Oscillation Button

Adjust airflow direction (90°)

## LED Display

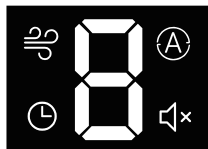

Normal  
Mode



Fan Speed /  
Timer Hour



Auto Mode



Timer



Mute

# USING YOUR AIR CIRCULATOR FAN

# 3

## Getting the Most out of Your Air Circulator Fan

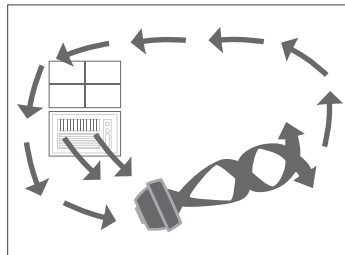

### Summer:

#### Use with Air Conditioner

Position the air circulator in front of your AC to circulate cold air and provide better cooling.

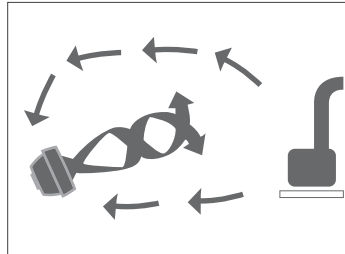

### Winter:

#### Use with Heater

Send the heat to corner of the room and circulate warm air faster.

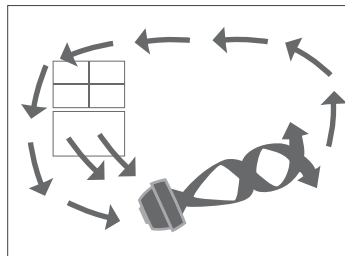

### Spring & Fall:

#### Circulation

Make the indoors as fresh and pleasant as the outdoors



## General Operations

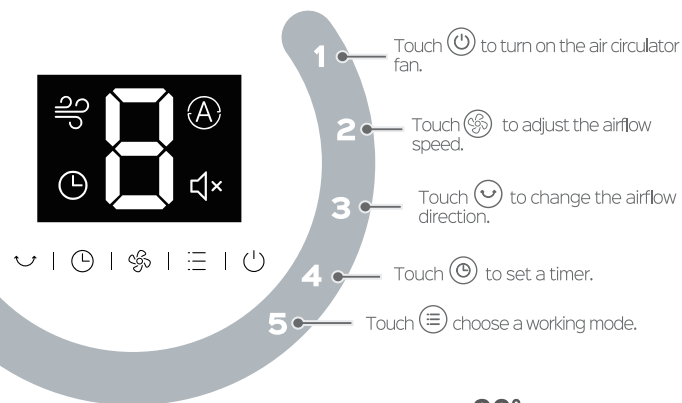

Tilt the fan head by hand to the desired angle.

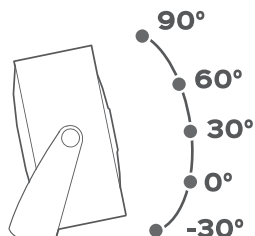

## Working Modes



### Normal Mode

Fan runs at the fixed speed.



### Auto Mode

Fan speed adapts to the ambient temperature.

## Additional Features



### Timer

When the fan is ON/OFF, touch the timer button repeatedly to set a timer from 1 to 8 hours. When the timer ends, the fan will stop/start running automatically. To cancel, set the time to 0 hour.

**Note:** When the auto off timer is enabled, display will return to fan speed after 3 seconds.



### Child Lock

Long press the Oscillation button and Timer button at the same time for 3 seconds to turn on/off Child Lock. "L" will flash on the display when turned on/off.

**Note:** Child Lock doesn't apply to the remote control. You can also turn off Child Lock by re-plugging in.



### Memory

If the fan is turned OFF or disconnected from power, it will operate under the previous settings (except the timer setting) when it is turned ON again.



### Countdown Display

When long pressing buttons for Factory Reset, Child Lock, and Mute, a countdown will show on the display accordingly.



### Display Auto Off

Display turns off after 1 minute. Wake up the display with any button.

## Remote Control

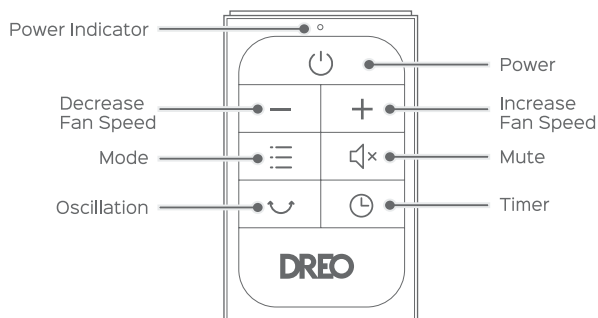

## Battery Replacement

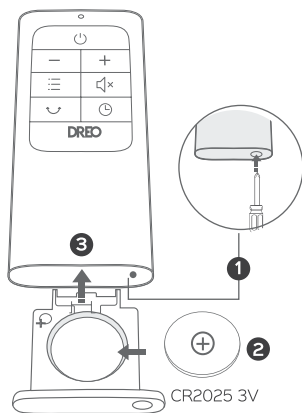

- 1 Press the locking button to pop out the battery holder.
- 2 Replace with the same battery type with the (+) side facing up.
- 3 Push in the holder until securely locked into place.

**Note:** If the indicator on the remote control doesn't turn on any more, please consider replacing the battery.



### WARNING

**Chemical Burn Hazard.** Keep batteries away from children.

This product contains a lithium button/coin cell battery. If a new or used lithium button/coin cell battery is swallowed or enters the body it can cause severe internal burns and can lead to death in as little as 2 hours. Always completely secure the battery compartment. If the battery compartment does not close securely, stop using the product, remove the battery, and keep it away from children. If you think batteries might have been swallowed or placed inside any part of the body, seek immediate medical attention.

The batteries must be disposed of properly, including keeping them away from children. Even used cells may cause injury.

# CLEANING AND MAINTENANCE

# 4

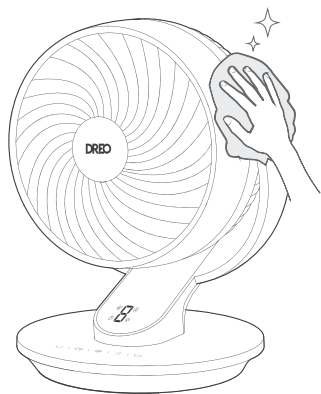

## Outer Surface

Gently wipe off the dust with a soft, dry cloth.

## CAUTION



1. Always unplug the air circulator before any cleaning or maintenance to avoid the risk of fire, electric shock, or injury to persons.
2. Do not immerse in water or get water inside the motor housing.
3. Do not use any chemical agents when cleaning the fan.
4. Store in a cool, dry place and cover it to protect from dust.

## Front Grille and Blades



### WARNING

To reduce the risk of electrical shock and injury to persons, turn off and unplug the appliance before any cleaning and maintenance.

1

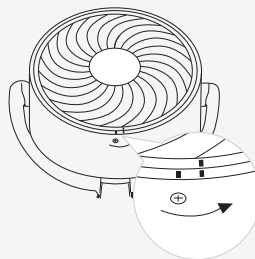

Remove the screw on the front grille, rotate the grille counterclockwise to take it off.

2

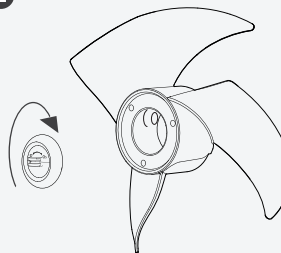

Remove the blade cap by rotating it as shown and take the blade assembly out of the shaft.

3

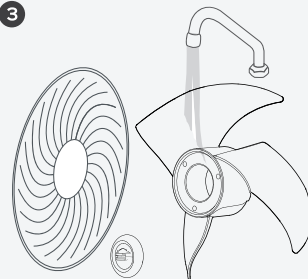

Rinse cap, blades, and grille under running water or with a clean, damp cloth.

4

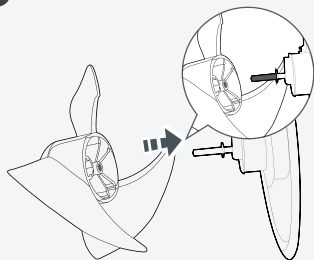

Dry up all parts, and insert the blade assembly back into the shaft by aligning the D-shaped points on the center.

5

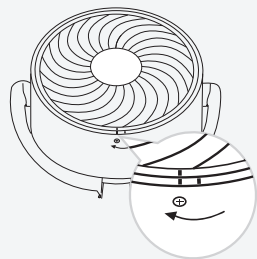

Align the point on the front grille with the right point on the casing as shown, then rotate the grille clockwise and install the screw back in place.

## User Servicing Instructions (Fuse)

This appliance features a fused safety plug that protects against overload or short-circuit situations. If the fuse blows, please cut off power and follow the below instructions or consult a qualified electrician.

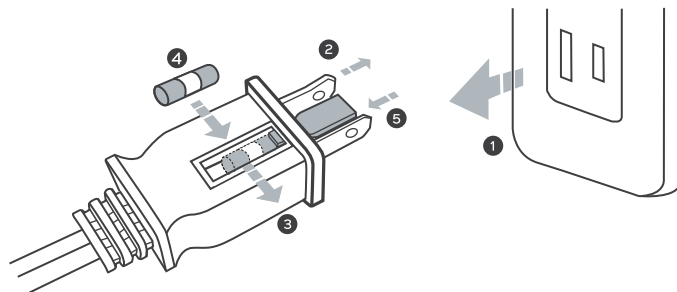

- 1** Grasp plug and remove from the receptacle or other outlet device. Do not unplug by pulling on cord.
- 2** Open fuse cover. Slide open fuse access cover on top of attachment plug towards blades.
- 3** Remove fuse carefully. Push the fuse from the other side to remove the fuse.
- 4** Risk of fire. Replace fuse only with 5 Amp, 125 Volt fuse.
- 5** Close fuse cover. Slide closed the fuse access cover on top of attachment plug.



### WARNING

Risk of fire. Do not replace attachment plug. Contains a safety device(fuse) that should not be removed. Discard product if the attachment plug is damaged.

# TROUBLESHOOTING

## 5

### My air circulator won't turn on!

Make sure that the cord is connected to a powered outlet and the mains voltage corresponds with the voltage indicated on the air circulator.

### My air circulator is shaky and wobbling!

Place the air circulator on a flat, level surface.

### My air circulator is making vibration and noise!

1. Place the air circulator on a flat, level surface.
2. Be sure not to insert anything into the air inlet and outlet.
3. It is normal that the fan makes a little noise when manually adjusting the fan head.

If your problem is not listed or still persists, please contact our Customer Support (**see page 16**)

# DREO CUSTOMER CARE

## 6

### Default 12-Month Warranty

This appliance is covered by Dreo warranty for 12 months from the date of its original purchase.

### Extend Your Warranty

Extend your warranty by registering your new appliance on our website <https://dreo.com/warranty>.

The warranty will not apply in cases of:

1. Accident, misuse, or repairs performed by unauthorized personnel.
2. Any unit that has been tampered with or used for commercial purposes.
3. Normal wear and tear of wearable parts.
4. Use of force, damage caused by external influences.
5. Damage caused by non-observance of the User Manual, e.g. connection to an unsuitable mains supply or noncompliance with the instructions.
6. Partially or completely dismantled appliances.
7. Defects caused by or resulting from damages from shipping or from repairs, service, or alteration to the product or any of its parts that have been performed by a repair person not authorized by Dreo.

We can only provide after-sales service for products that are sold by Dreo or Dreo authorized retailers and distributors. If you have purchased the appliance from a different place, please contact your seller for return and warranty issues.



(888) 290-1688



support@dreo.com



www.dreo.com

Mon - Fri, 9:00 am-5:00 pm PST/PDT



www.dreo.com



Shenzhen Hesung Innovation Technology Co., LTD



26F, Bldg A7, Creative City, Shenzhen, China

MADE IN CHINA



Intertek  
5018396