

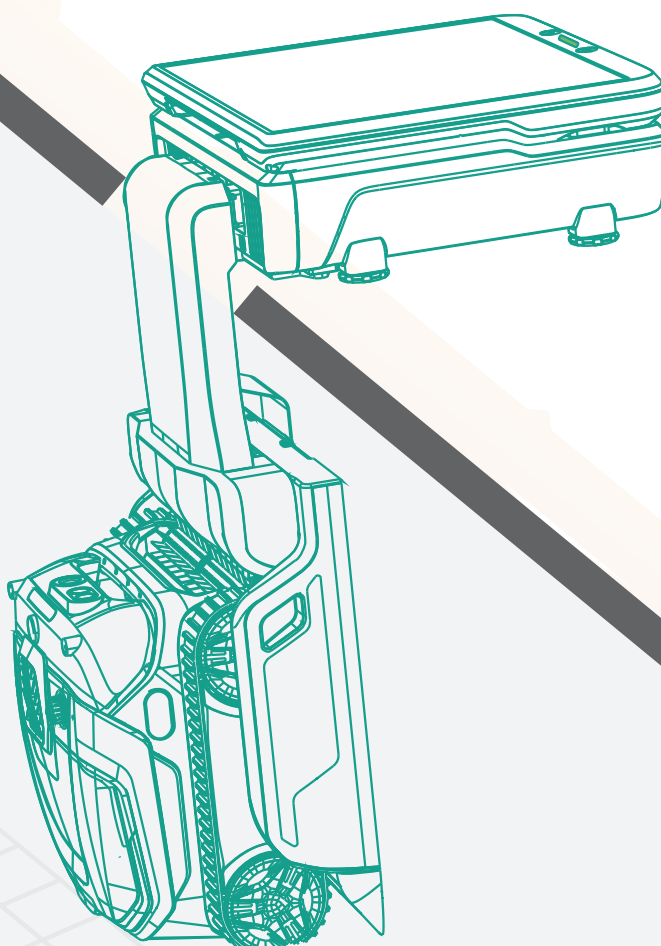

## Robotic Pool Cleaner

WYBOT S3



## User Manual

Read through the entire manual before running your new robotic pool cleaner, and keep this manual handy for your reference.

Copyright© 2025 WYBOTICS Co., Ltd. All Rights Reserved.



Dear Valued Customer,

Thank you for choosing WYBOT! Your trust and support mean the world to us. We are committed to providing innovative and intelligent pool cleaning solutions, allowing you to enjoy a pristine pool with minimal effort and more quality time with your family.

WYBOT Robotic Pool Cleaners are designed for high efficiency, low power consumption, and ease of use. Featuring underwater automatical charging, underwater communication, AI-assisted dirt detection, smart navigation, powerful suction, effective scrubbing, fine filtration, remote control, and seamless adaptability to various pool shapes and materials, WYBOT ensures a thorough and intelligent cleaning experience.

At WYBOT, we continuously strive to enhance your pool care with smart, energy-efficient, and reliable solutions. If you have any questions or feedback, please feel free to contact us via email or visit our website. Your insights are invaluable in helping us improve.

Enjoy effortless pool cleaning with WYBOT—where technology meets convenience.

# Safety Instructions

Please read this manual carefully before using the cleaner. Your safety is our top priority. Operate the device strictly according to the instructions provided. WYBOTICS Co., Ltd. shall not be held liable for any loss or injury resulting from improper use.

Failure to follow the safety instructions may lead to serious injury, electric shock, or even death.

1. Install and assemble all components of the WYBOT S3—including the above-ground dirt collector, connection cords, and docking station—strictly according to the installation instructions.
2. Use only accessories that are recommended or sold by WYBOTICS Co., Ltd.
3. Do not modify the robotic pool cleaner. Unauthorized modifications may impair the operation of the cleaner, cause injury or damage, and void the limited warranty.
4. Use only the original and authorized charger and docking station. Do not use them to charge other devices. Improper use may result in overheating or leakage of corrosive battery fluid.
5. Do not use a charger with a damaged cord. Avoid using unauthorized extension cords to connect the charger.
6. The product includes a long extension cord. Please organize it properly to avoid entanglement or damage.
7. Ensure the electrical outlet is protected by a Ground Fault Circuit Interrupter (GFCI) and an Earth Leakage Interrupter (ELI).

## WARNING

Do not allow children, individuals with reduced physical, sensory, or mental capabilities, or persons unfamiliar with these instructions to operate the robotic pool cleaner.

Before cleaning and maintenance

- 1) Regularly inspect the robotic pool cleaner to ensure all parts are functioning properly.
- 2) The cleaner is designed for daily pool maintenance. It is not recommended for the first cleaning after opening the pool for the season.
- 3) Do not allow children to ride or play with the robot or docking station.
- 4) Do not expose or charge the device in flammable environments.

## WARNING

Do not operate the cleaner with damaged covers or if the power cord is frayed or worn.

When cleaning and maintenance

- 1) Do not enter the pool while the robot is operating.
- 2) Do not operate the cleaner when the pool filtration system is running.
- 3) Be cautious of your balance when installing or maintaining the robot at the poolside.
- 4) Do not lift or remove the robot from the pool during a cleaning cycle.
- 5) This device contains Bluetooth and Wi-Fi modules operating at 2.4 GHz. It complies with applicable RF exposure standards. To reduce exposure, follow operating instructions and avoid prolonged close contact with the communication modules.

## WARNING

If the dirt collector or docking station emits unusual noise or alarm signals, stop the cleaning process immediately.

Do not touch any moving parts until they have come to a complete stop.

After cleaning

- 1) Regularly empty the above-ground dirt collector.
- 2) Perform at least one self-cleaning cycle before removing the robot from the docking station.

## WARNING

The dirt collector may contain water treated with pool sanitation chemicals. Keep children away from the collector.

# Safety Instructions

## Daily Maintenance

- 1. The robotic pool cleaner is equipped with a solar panel for power supply. Do not place objects on the solar panel.
- 2. To maintain optimal solar charging performance, keep the surface of the solar panel clean and free from dust, water, or shadow.
- 3. Routine maintenance of the robot and docking station is recommended.
- 4. If the extension cable of the power supply or the docking station cord becomes damaged, immediately disconnect the power. Contact after-sales support and have the component repaired or replaced by a qualified technician.
- 4. Use only the pool cleaner in the following water conditions:

Chlorine	Max 4 mg/L
pH	7.0 - 7.8
Temperature	41 - 95 °F (5 - 35 °C)
NaCl	Maximum 5000 PPM

# Symbols illustration

In this manual, product interface, and mobile app, you will encounter the following symbols. Please review them carefully to ensure safe and efficient use of your robotic pool cleaner.

## In the manual



Failure to operate the product as per the safety instructions can result in serious injury, electrocution or death.



The robot conforms to the applicable EC directives.



The robot conforms to the applicable FCC rules.



The robot conforms to the regulations of Restriction of Hazardous Substances.



It is not permitted to dispose of the product as normal household waste. Please recycle the product in accordance with local legal requirements.

## In the app



Online

**Robot Connected to Solar Kit**  
Indicates a successful connection between the robot and the solar kit. Users can send commands through the mobile app.



Offline

**Robot Disconnected from Solar Kit**  
Indicates a communication failure between the robot and the solar kit. Some product functions may be limited.



Tap to begin a pool cleaning cycle.



Tap to command the robot to return to the docking station for charging.



Tap to initiate the robot's self-cleaning function while it is docked.



Enables the robot's Vision AI functionality. Once enabled, available cleaning modes will update automatically based on the environment.

# Symbols illustration

## On the solar kit









**Start Cleaning Button**  
Used to start a cleaning cycle when the robot is docked or in standby mode underwater.



**Home button**

- While the robot is underwater and cleaning, press to send it back to the docking station.
- While the robot is charging on the dock, press and hold the button for one minute to initiate or cancel a self-cleaning cycle.

### LED Light

	Solid purple light	Good connection with the robot underwater
	Running purple light	Solar kit is on.
	Solid blue light	The robot is returning to the station
	Solid green light	Charging the robot
	Flashing green light	Self-cleaning of the robot
	Flashing cyan light	Under upgrading
	Flashing yellow light	Collector drawer not properly installed
	Solid red light	Solat kit error
	Flashing red light	Robot error

## On the robot



Full pool mode/ Floor then wall mode (Default)



Floor mode (including standard floor (Default) / Turbo floor/ Eco floor)



Wall mode



Waterline mode



Vision AI indicator

### Note:

Press power button to switch between different cleaning modes. Vision AI mode can only be activated through the mobile app.

	Solid blue light	Robot is on
	Solid green light	Current battery level
	Flashing green light	Under charging
		Under vision cleaning mode
	Flashing yellow light	Returning to the docking station
		Low battery
	Flashing cyan light	Under upgrading
	Flashing red light	Robot error

# Content

01 / WYBOT S3 AT A GLANCE	01
02 / PACKING LIST	03
03 / ASSEMBLE WYBOT S3	04
04 / ACTIVATE WYBOT S3	07
05 / MAP OUT THE POOL	09
06 / START CLEANING	10
07 / DEVICE SPECIFICATION	12
08 / MAINTAIN WYBOT S3	14
09 / FAQ	15
10 / LIMITED WARRANTY	16
11 / CERTIFICATION	16
12 / CUSTOMER CARE	16

01 / WYBOT S3 AT A GLANCE

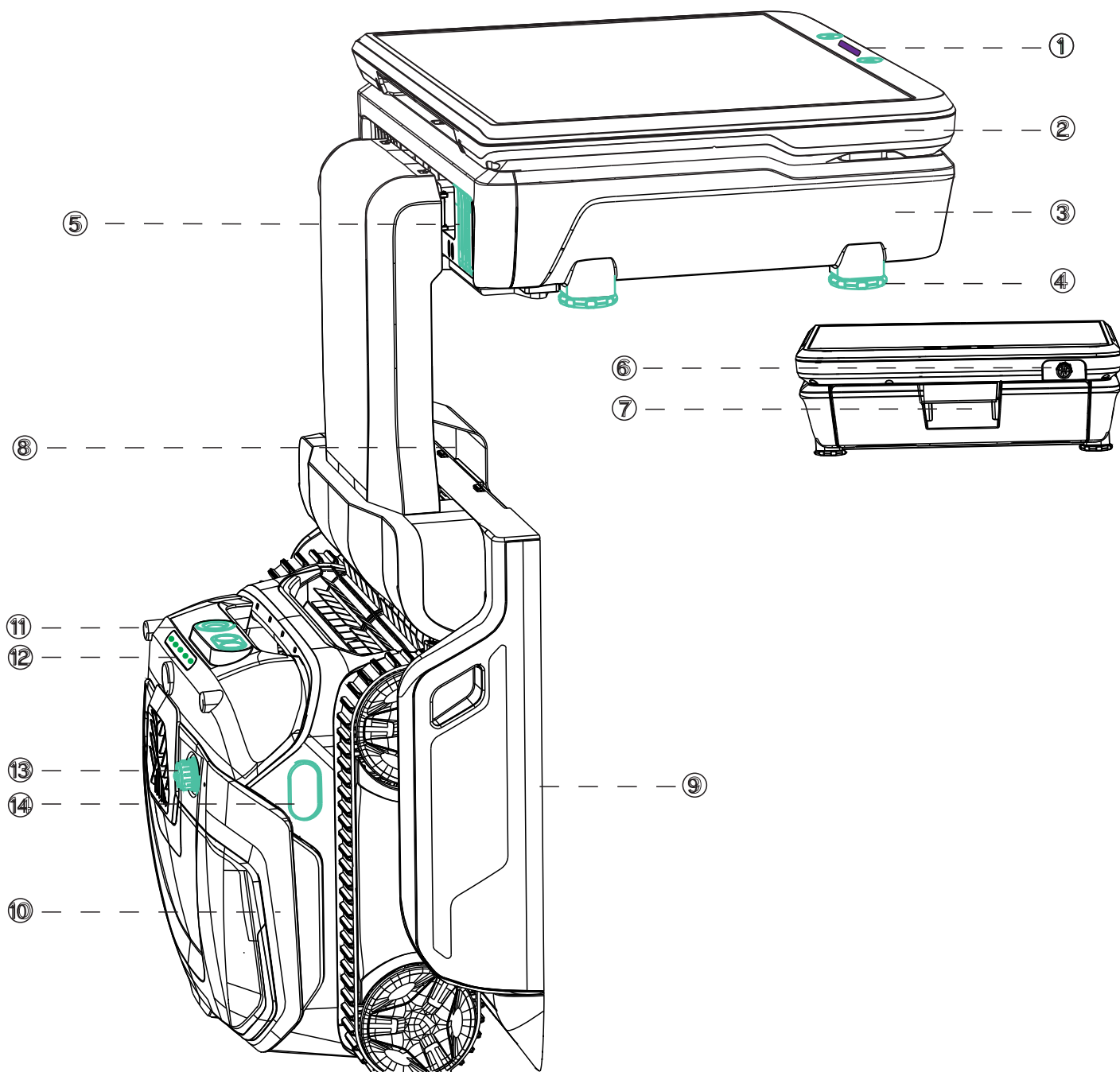



## 01 / WYBOT S3 AT A GLANCE

### ② Solar Kit

#### ① Control Panel

- ⏮ Calls the robot back to the docking station while underwater. Once docked, the robot will begin charging and perform a self-cleaning cycle.
- ▶ Releases the robot from the docking station to begin an automatic cleaning cycle.
- 📊 Displays the robot's operational status, including power supply, communication connection, and charging state.

### ③ Dirt Collector

#### ④ Level-Adjustment Screws \* 4

Use these screws to adjust the height and keep the dirt collector level with the pool deck.

#### ⑤ Dirt Collector Water Outlet

Releases filtered water after an ultra-fine filtration cycle within the dirt collector.

#### ⑥ Charging Port

Connects the extended charger cord to a power outlet for charging the robot.

#### ⑦ Dirt Collector Handle

Hold the handle to draw the collector out.

### ⑨ Docking station

#### ⑧ Station neck

Secures the docking station to the dirt collector and stabilizes the station against the pool wall.

### ⑩ Robot

#### ⑪ Front sensors

Includes camera and ultrasonic sensors for dirt detection and navigation.

#### ⑫ Robot status and cleaning mode indicator

Displays the current operating status and selected cleaning mode of the robot.

#### ⑬ Robot charging port

#### ⑭ Infrared sensor

## 02 / PACKING LIST

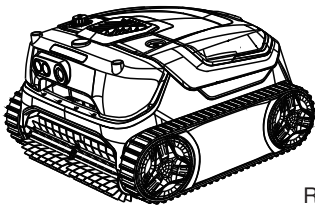

Robot \* 1

(Including filter basket and ultra-fine filter)

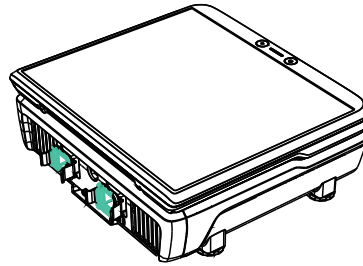

Solar kit & Dirt collector \* 1

(Including filter bag and sanitation ball)

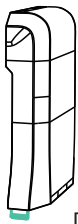

Decorative cover \* 1

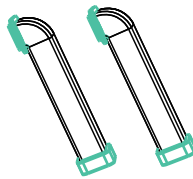

Pipe \* 2



Station neck \* 1

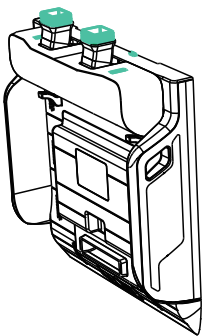

Docking station \* 1

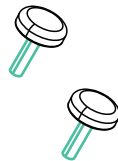

Screws \* 2



Chlorine ball \* 1

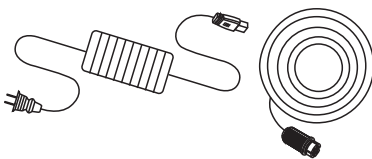

Dual-head DC charger \* 1

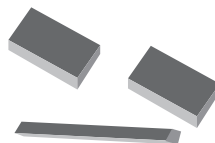

Floating parts

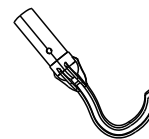

Hook \* 1

### Note:

The green-highlighted section in the diagram indicates the connection area, which must be manually assembled for the WYBOT S3 to function properly.

### 03 / ASSEMBLE WYBOT S3

WYBOT S3 consists four main parts, and will function well when all are set up correctly. Please assemble all the parts in accordance with the instructions below.

#### Find a proper place for the solar kit (including dirt collector) and docking station

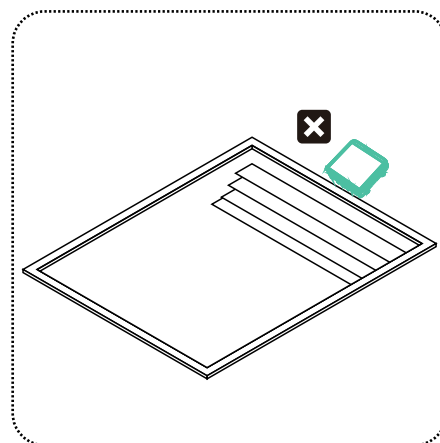
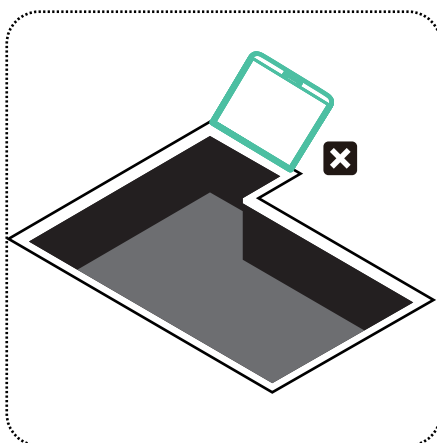
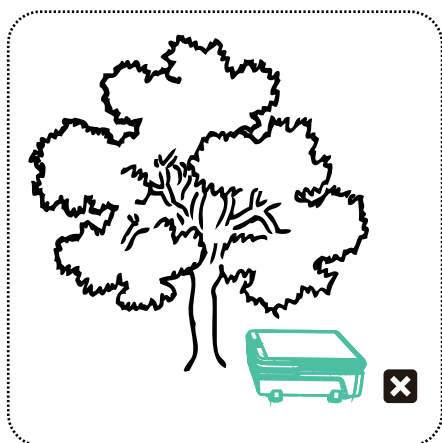
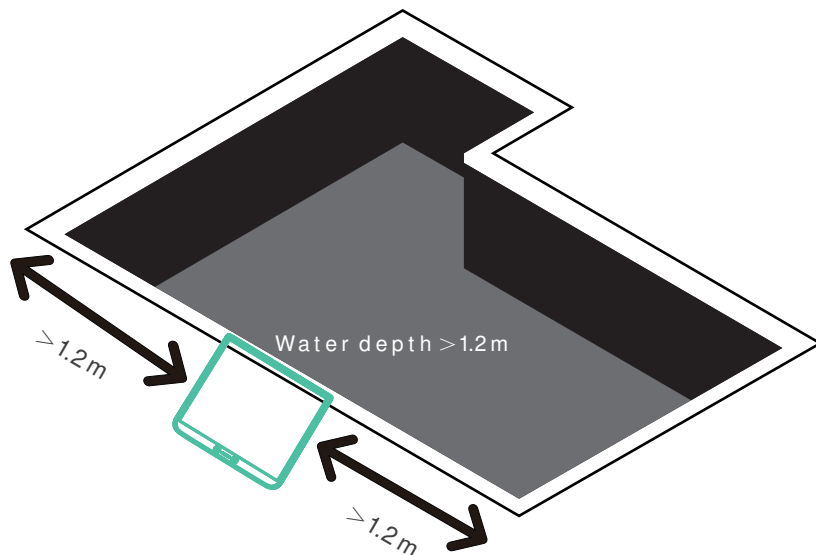
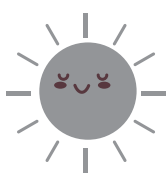

#### Note:

1. **The solar panel serves as a supplemental power source for your device.** In sunny weather with sufficient sunlight, it provides continuous energy for efficient and eco-friendly cleaning. In the event of an unexpected power outage, it can also function as an emergency backup power supply to ensure uninterrupted operation.
2. The solar panel works best under direct sunlight. Shadows from clouds, buildings, trees, or even a glass pool enclosure can significantly reduce charging performance. We highly recommend **placing the solar panel in a location with continuous exposure to direct sunlight.**
3. The docking station sends commands to the robot. For better underwater communication, we recommend **placing the docking station in an open area with a full view of the entire pool.**
4. The wall where the docking station is installed should be **flat, undamaged, and free of steps, tanning ledges, or other obstructions.** This ensures reliable communication and allows the robot to return to the station correctly.
5. Newly added pool water may contain excess oxygen, which can affect underwater communication and docking. Please wait at least two days before using the robot.

### 03 / ASSEMBLE WYBOT S3

After placing the solar kit in the recommended location, proceed with assembling the docking station.

#### Assemble the docking station

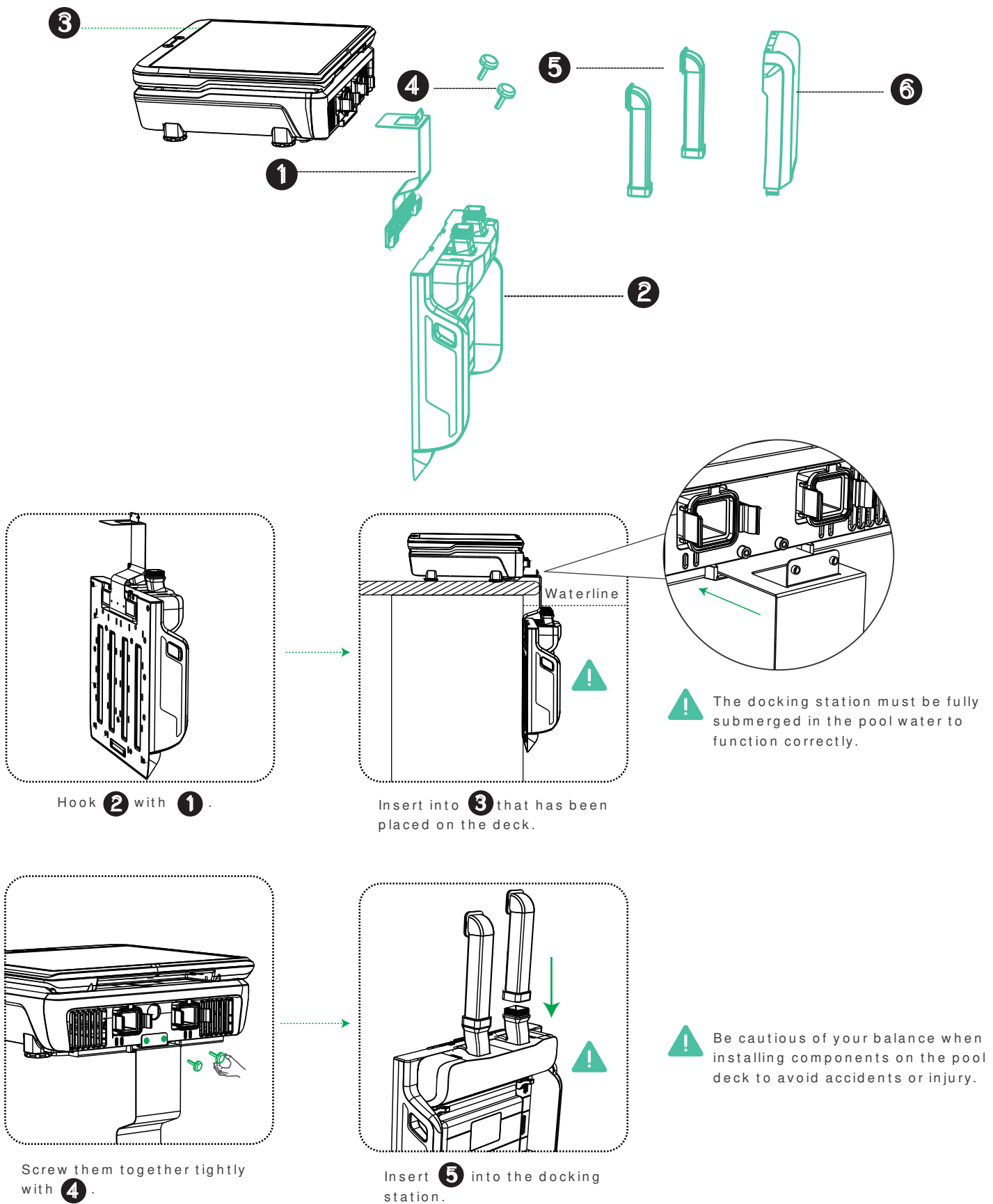

### 03 / ASSEMBLE WYBOT S3

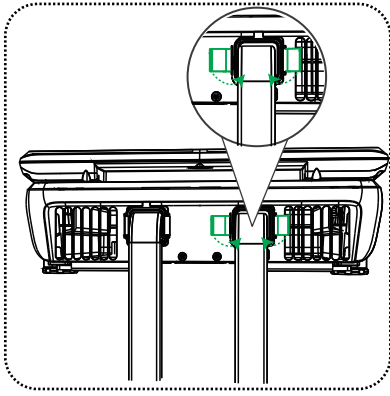

Fasten the upper part of **5** with **3**.

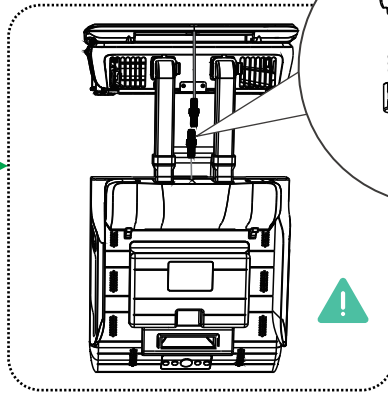

When connecting the cables between the solar kit and the docking station, ensure the cable connectors remain dry. Water ingress may cause damage to internal components and compromise robot performance.

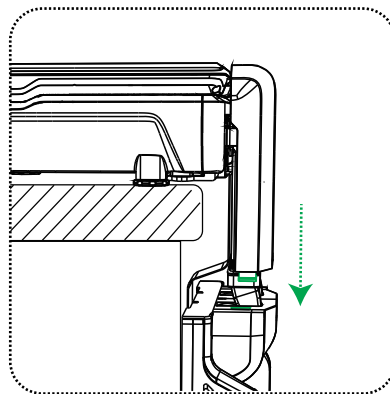

Insert **6** into the docking station.

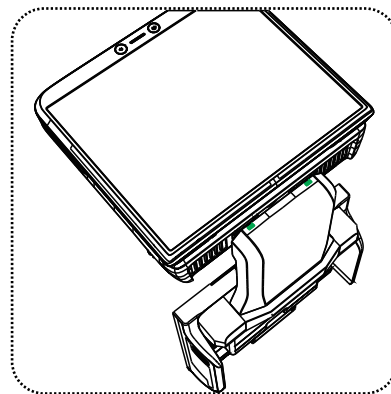

Ensure the upper part of **6** be fastened well.

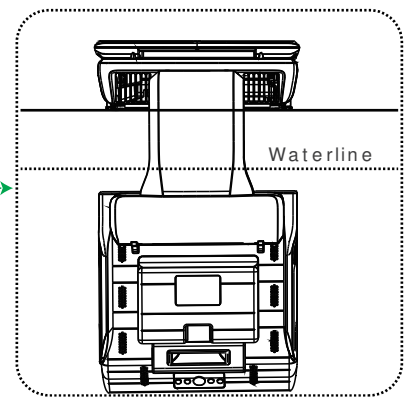

Finish assembling the docking station.

#### Note:

1. Ensure the dirt collector remains level after the docking station is installed. You may **adjust the leveling using the level-adjustment screws located at the bottom of the collector.**
2. The docking station must **remain securely attached to the pool wall after installation to ensure stable operation and accurate robot docking.**
3. **Avoid placing any weight on the solar panel during the assembly of the docking station**, as this may damage the panel or affect its charging efficiency.

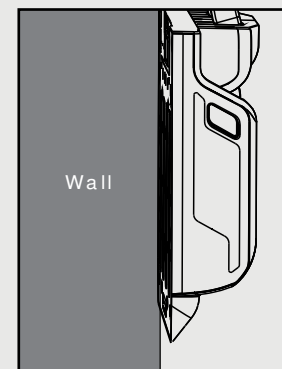
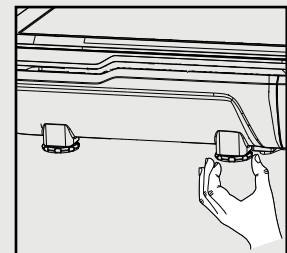

## 04 / ACTIVE WYBOT S3

After installing the dirt collector and docking station, please follow the steps below to activate the system:

### Active the docking station

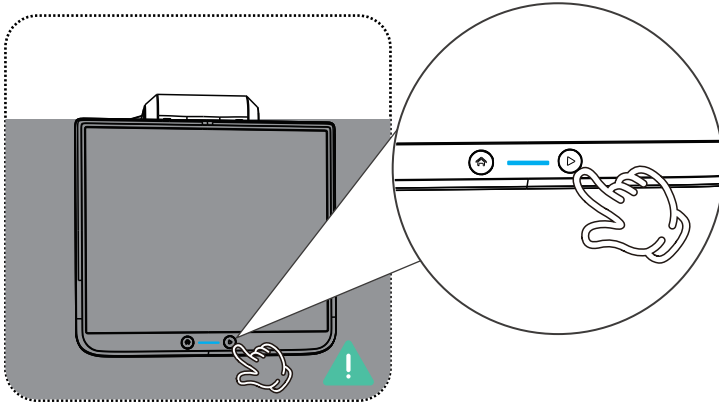

Long-press the start button to activate the solar kit.



If no blue indicator light appears on the solar kit after pressing the power button, the docking station may have a low battery.

1. Place the assembled system under direct sunlight for at least two hours to recharge (Ensure docking station battery > 80%).
2. Alternatively, you may connect the long-cable DC charger to the solar kit for faster charging.

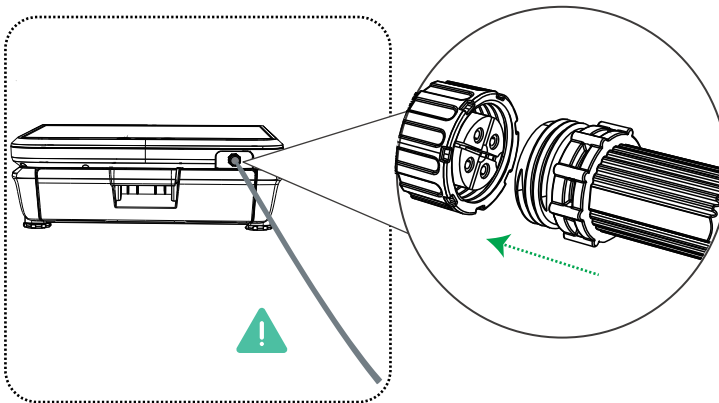

When charging via the DC charger, ensure the docking station is positioned at least 3 meters (approximately 10 feet) away from the pool edge to avoid electrical hazards. Stretch the cable neatly along the poolside to prevent tripping hazards.

### Active the robot

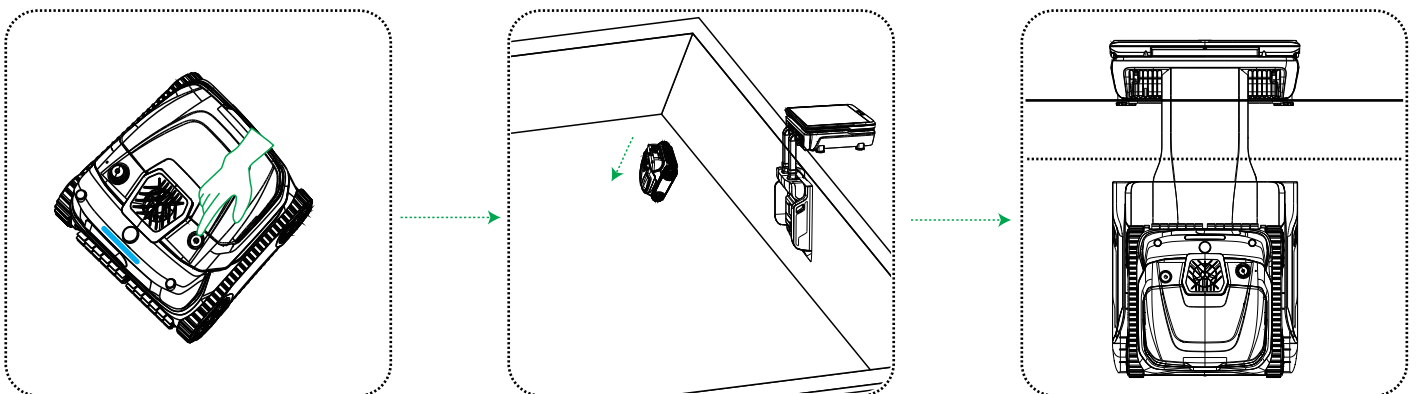

#### Note:

1. When the robot is powered on, the blue indicator light will illuminate.
2. You can or Place the robot in the pool first, then press the Home button on the solar kit to summon the robot back to the docking station, or place the robot directly onto the docking station.
3. When the robot returns to the docking station and begins charging, the indicator light will turn green, signaling a successful connection.

## 04 / ACTIVE WYBOT S3

### Note:

4. If no long-cable charger is connected to the solar kit, the docking station will begin solar charging to store sufficient internal power. During this period, the robot will not display a green indicator light.
5. It is recommended to fully charge the robot using the long-cable charger before the first use for optimal performance.

### Connect to the APP

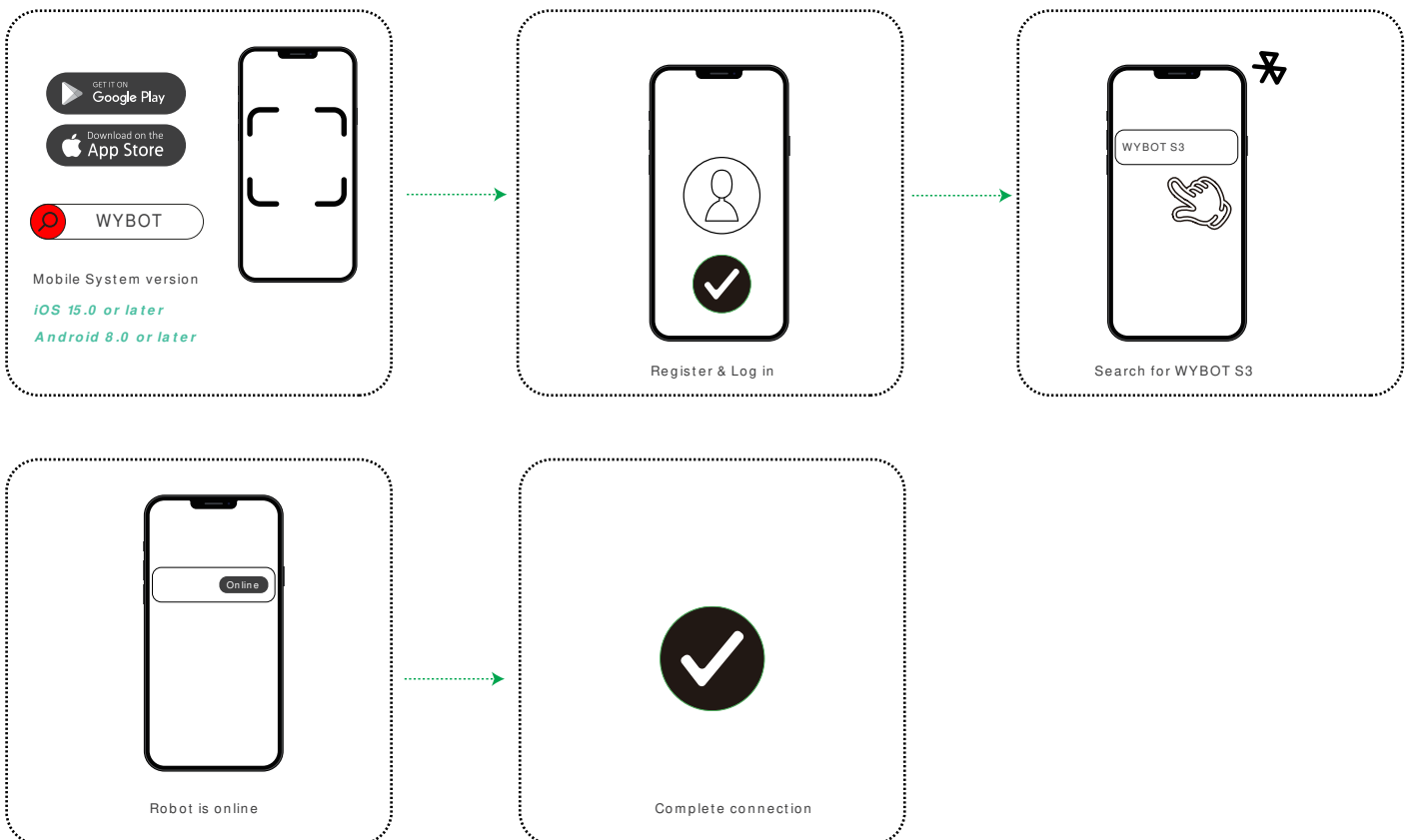
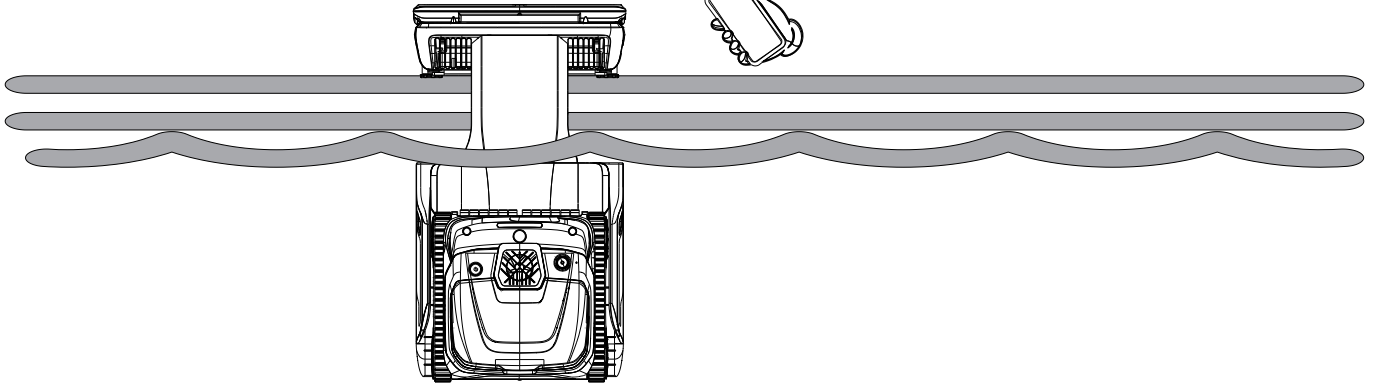

### Note:

1. **Ensure the docking station is powered on, and that the robot is actively charging on the docking station**, when attempting to connect to the WYBOT App.
2. **Enable Bluetooth** on your mobile device before searching for WYBOT S3 in the app.
3. For detailed instructions on using the WYBOT App, please scan the QR code on the right.