

NFP240624 Figure Number

**INSTALLATION INSTRUCTIONS**

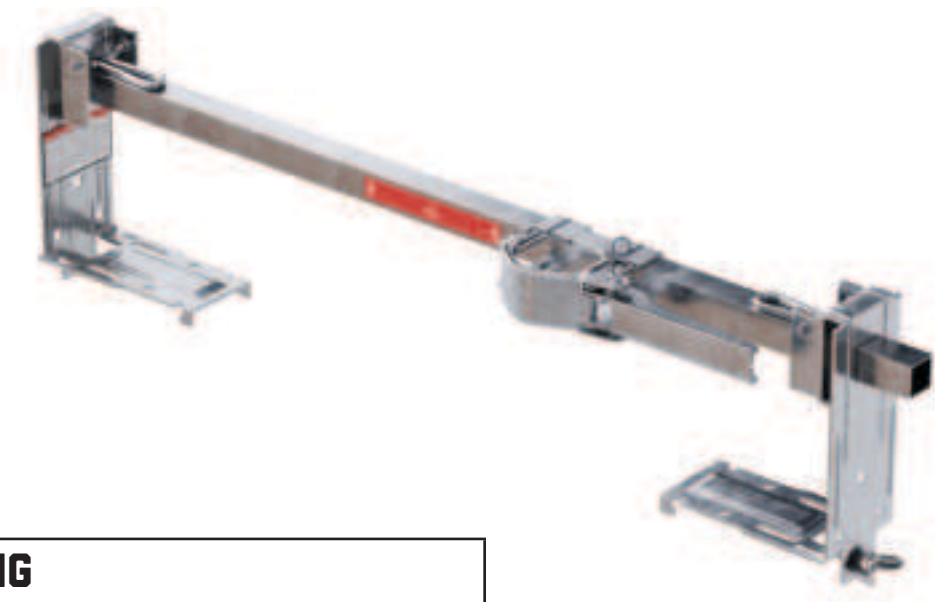

**⚠ WARNING**

- You must read and understand all instructions and warnings before attempting to install any Specflex® sprinkler drop system components.
- Failure to follow these instructions can lead to improper operation, resulting in serious injury, death or property damage.
- We recommend wearing safety glasses or goggles, a hard hat and shoes with foot protection during installation.

**REQUIRED SYSTEM PARTS**

- Flexible Hose (Braided)
- NFP240624 Pre-Assembled Bracket

**REQUIRED TOOLS**

- Pipe Wrench, Screwdriver
- PTFE Tape



# SPECFLEX®

## BRACKET FOR HAT FURRING CHANNELS



NFP240624 Figure Number

### INSTALLATION INSTRUCTIONS

1. Inspect the Specflex® sprinkler drop system components for any sign of physical damage. Make sure all components are included and in the proper order.



2. Disconnect the inlet nipple and outlet reducer from the flexible hose and check that each sealing gasket is in place properly. Reconnect outlet reducer to the flexible hose.



3. Ensure that both end threads are clean without any damage. Apply PTFE tape to the inlet nipple threads. Use a pipe wrench to connect the inlet nipple to the branch line.



4. Use a pipe wrench to connect the flexible hose to the inlet nipple. Torque range should be a minimum of 50 to a maximum of 58 ft-lbs.



**DO NOT USE PTFE TAPE ON THE INLET NIPPLE THREAD TO CONNECT TO THE FLEXIBLE HOSE.**

NFP240624 Figure Number

## INSTALLATION INSTRUCTIONS

5. Loosely assemble the adjustable end bracket based on the distance between the hat furring channels. Attach the NFP240624 bracket to the hat furring channels. Ensure the leg of each end bracket is properly engaged to the hat furring channels.



6. Tighten the wing bolts to secure the end brackets onto the hat furring channels. The recommended torque is 1.40–1.48 ft-lbs (190-200 cN • m).



**DO NOT OVERTIGHTEN THE WING BOLT WITH TOOLS.  
THIS MAY CAUSE DAMAGE TO THE WING BOLT.**

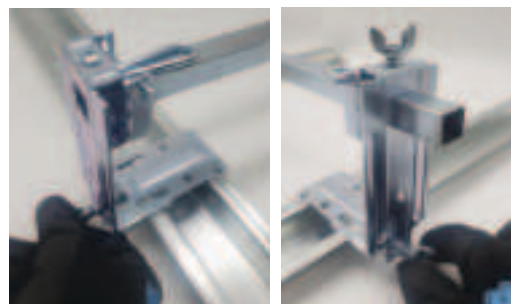

7. Latch down the lever and tighten the top wing bolt on the adjustable end bracket to secure it onto the stock bar. The recommended torque is 1.40–1.48 ft-lbs (190-200 cN • m).



8. Tighten two sheet metal screws on each end of the bracket, making sure to fully penetrate the hat furring channel. The recommended torque is 1.40–1.48 ft-lbs (190-200 cN • m).

Ensure the bottom wing bolts on both ends of the bracket are fully tightened.



NFP240624 Figure Number

## INSTALLATION INSTRUCTIONS

9. Press the release pin and open the center bracket. Load the flex hose on the proper height position in accordance with the type of sprinkler head being used.

Close the gate of the center bracket from the left to right and firmly push the lever toward the stock bar until it clicks to secure the outlet reducer.



10. Verify the location marking on the outlet reducer and match the outlet location for the remaining head installations.

