

AIR PURIFIER

USER MANUAL



High Clean Air
Delivery Rate



3-Stage Filtration
System



Low Noise Level



Child Lock

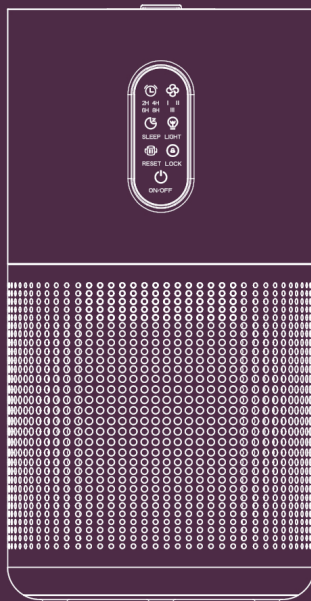

CUSTOMER SERVICE

Our customer service team is standing by to assist you
if you have any questions or concerns.



www.mookashops.com



support@mookashops.com



1-855-666-9955

READ AND SAVE THESE INSTRUCTIONS

DIRECTORY

IMPORTANT SAFEGUARDS	01
ATTENTION	05
PRODUCT TECHNICAL FEATURES	07
PRODUCT APPEARANCE DIAGRAM	08
PARTS TO INTRODUCE	09
USE AND OPERATION	10
INSTRUCTIONS FOR USE	14
CLEANING AND CARE/FAQ	20
PARAMETERS OF THE UNIT	21

IMPORTANT SAFEGUARDS 1

In order to prevent harm or damage happened to users or others, be sure to comply with the requirement as below:

WARNING/ATTENTION



WARNING

It reminds that misusing or mishandling may cause death.



ATTENTION

It reminds that misusing or mishandling may cause hurt.



FORBID



FORCE

Unplug or disconnect the appliance from the power supply before servicing.

WARNING: To Reduce The Risk Of Fire Or Electric Shock, Do Not Use This Fan With Any Solid-State Speed Control Device.

WARNING: To Reduce The Risk Of Fire, Electric Shock Or Injury To Persons, Do Not Use Replacement Parts That Have Not Been Recommended By The Manufacturer (e.g. Parts Made At Home Using A 3D Printer)

2 IMPORTANT SAFEGUARDS



WARNING

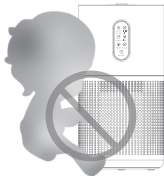

Please supervise your children and avoid them from touching or using machine.



AVOID WET

Do not connect or disconnect the power with wet hand.
It may cause electrical shocking.



NO DISASSEMBLE

Do not disassemble, repair or reconstruct.
It may cause fire or damage.
Please contact the seller for replacement.



FORBID

Do not use over-limit sockets or wiring connectors. Please use the rated voltage.
It may cause a fire.

IMPORTANT SAFEGUARDS 3



Do plug the power into the socket completely.

It may cause fire because of heating or electrical shocking.

Do not use the damaged plug or loose socket.



AVOID WET

Avoid any water on the surface of the unit.

It may cause short circuit or electrical shocking.



DISCONNECT POWER

The appliance must be disconnected from the supply mains before cleaning or other maintenance.

Otherwise the unit may start working in a sudden which may cause electrical shocking or hurt.

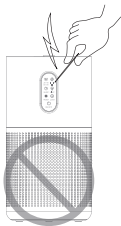

Do not insert any metal objects into the unit.

It may cause hurt or electric shocking.

4 IMPORTANT SAFEGUARDS



FORBID

Do not repair it when the cord or plug is damaged.

It may cause short circuit, electric shocking or fire. Please contact the retailer for replacement.



If there is dust on the plug, it may weaken the insulation and even cause a fire.

Take out the plug and clean it with dry cloth.

Please remove the plug from the socket if not using for a long period.



ATTENTION

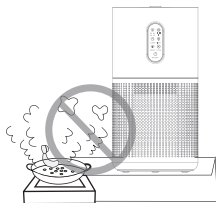

Do not use in the room with a gas stove.

It may cause hurt because the machine is not a ventilator.

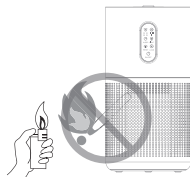

Do not place the unit near fires.

It may cause fire.

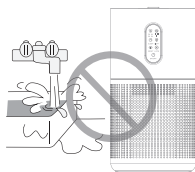

Do not use in the watery or high temperature room such as the bathroom etc.

Otherwise it may cause creepage, electric shocking or fire.

6 ATTENTION

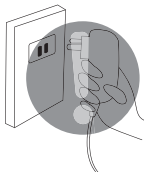

Please hold the plug instead of the cord when unplug the power.

Otherwise it may cause short circuit, breaking of the cord, electric shocking or fire.

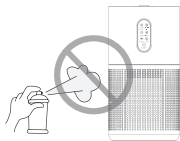

Keep away from alcohol, organic impregnant.

It may cause cracking, short circuit, electric shock, injury or fire.

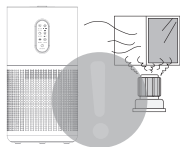

Please ventilate timely when used with fire in the room.

Please remove the plug from the socket if any conditions as below:

- If all switches do not work
- If the power cord or plug hot singularly
- If any peculiar smell, exceptional noise or vibration
- Any other abnormality or failure

If the power cord is damaged, please send it to the retailer or service center or technician for repairing. Do not change or repair it by yourself.

The multi-functional filter is composed of pre-filter, HEPA layer and activated carbon layer.

DIAGRAM OF PURIFICATION

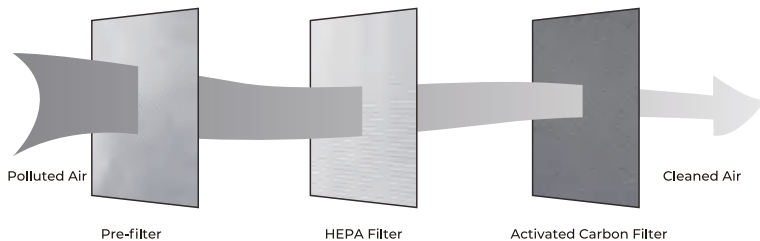

8 PRODUCT APPEARANCE DIAGRAM

APPEARANCE DIAGRAM

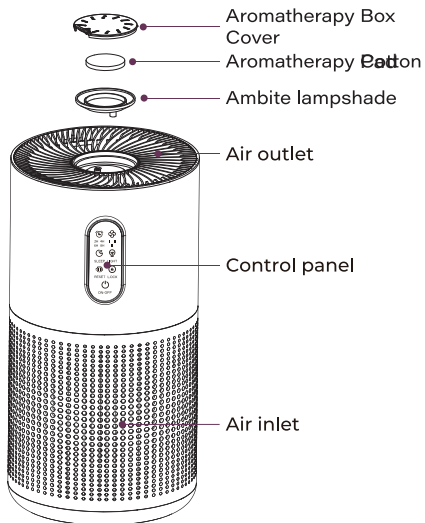

DECOMPOSITION DIAGRAM

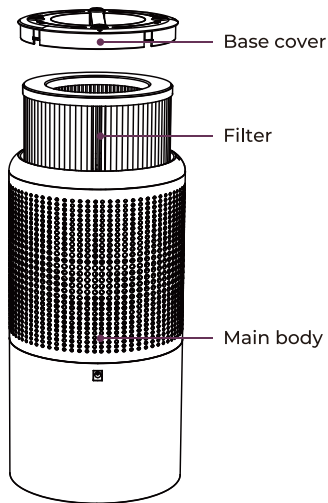
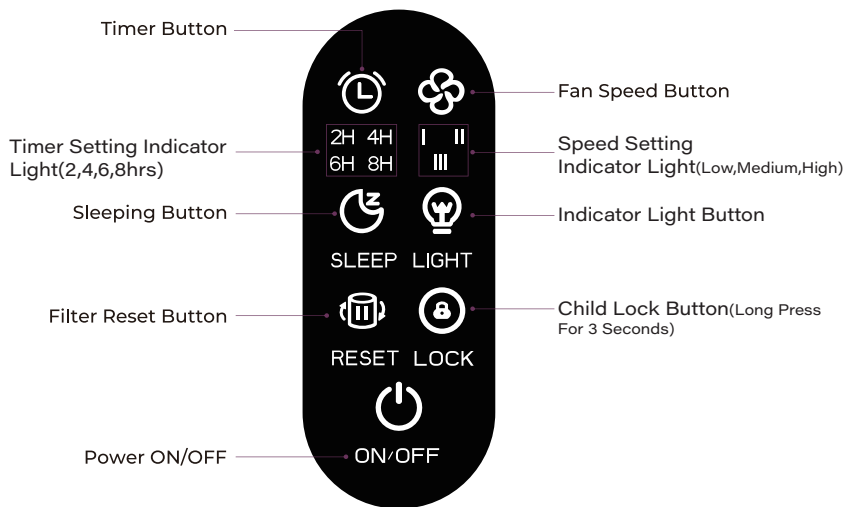

DIAGRAM OF CONTROL PANEL



10 USE AND OPERATION

PLACEMENT

- ◆ Make sure the appliance is placed at least 30cm away from any wall or piece of furniture. Do not position the appliance directly under furniture or objects that may obstruct the exhaust air flow.
- ◆ Do not use the appliance near any source of heat.

REPLACE THE FILTER

- ◆ Replace the filter and reset.

The filter replacement indicator will light up when cumulative running time reaches 1440hrs. Please replace the filter with a new one. Then, press and hold the reset button for approximately 3 seconds to reset the filter's lifetime counter, and the filter replacement indicator will turn off.

REMOVE THE FILTER

1. Switch the appliance off and unplug it.
2. Invert the equipment.
3. Rotate the base cover counter-clockwise to take out the filter.
4. Remove the filter as soon as the base cover will be opened.

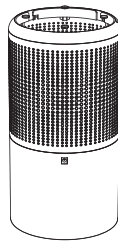
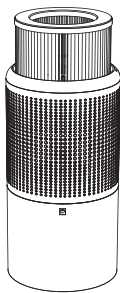
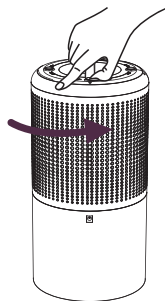
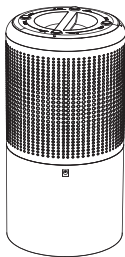

12 USE AND OPERATION

INSTALL THE FILTER

1. Please remove the new filter protective film before installation.
2. Rotate the base cover clockwise properly until the filter is installed securely

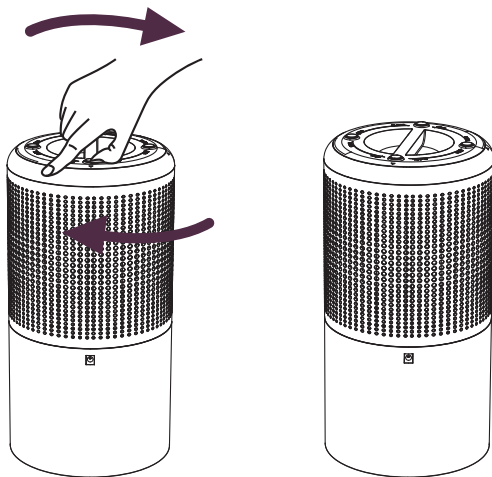

EXTERNAL POWER SOURCE

Suitable Voltage: 24V 

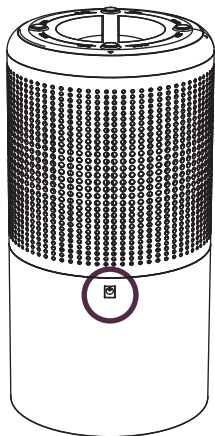

24V DC power adapter inlet

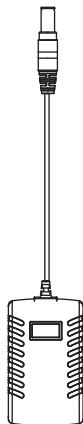

Power adapter

14 INSTRUCTIONS FOR USE

POWER SETTING

- ◆ All the indicator lights will be on for 1 second for self-checking after connecting power, then enter standby mode. The pictures below are for reference.
- ◆ To turn on or switch off the appliance, press the power button while in standby mode.

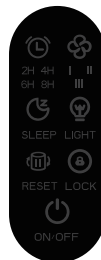

FAN SPEED SETTING

Press the fan speed button to select the fan speed: low, medium, high.



Low speed

Medium speed

High speed



TIMER SETTING

- ◆ Press the timer button to set the working time.



Timing is off



Timing 2hrs



Timing 4hrs

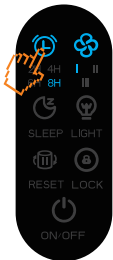

Timing 8hrs



Timing 6hrs

16 INSTRUCTIONS FOR USE

- ◆ Use the control lock to temporarily lock the control panel and deactivate the function buttons. To turn on or deactivate the child lock, press and hold the child button on the top control panel for approx. 3 seconds. Child lock indicator light on the display will either light up or be switched off accordingly



Deactivate child lock

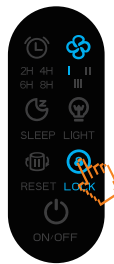

Turn on child lock



INSTRUCTIONS FOR USE 17

- ◆ The filter replacement indicator will light up when the cumulative running time reaches 1440 hours. Please replace the filter with a new one. Then, press and hold the reset button for approximately 3 seconds to reset the filter's lifetime counter, and the filter replacement indicator will turn off.

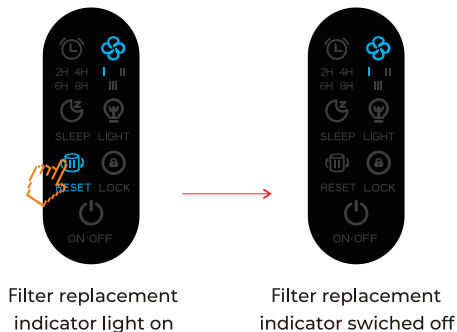

18 INSTRUCTIONS FOR USE

SLEEPING MODE

- ◆ To turn on or deactivate sleep mode by pressing sleep button. Sleep mode sets the appliance to the lowest speed setting with fan speed indicator light switched off and sleep mode indicator light turned on.

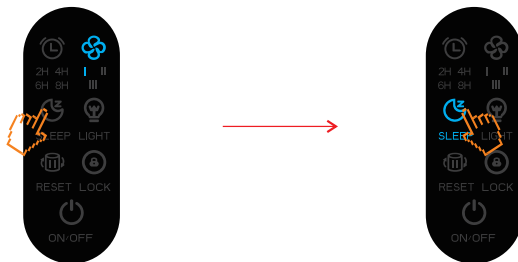

Deactivate sleep mode



Turn on sleep mode

USE AMBIENT LIGHT FUNCTION

- ◆ Press Indicator light button to turn on or switch off the Indicator light

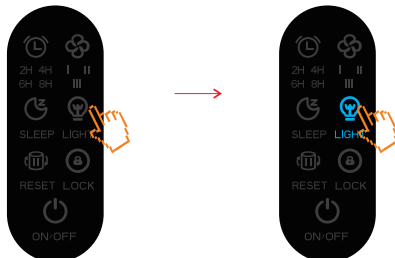

Switch off Indicator light

Turn on Indicator light



20 CLEANING AND CARE/FAQ

MAINTENANCE AND CLEANING METHODS



Please remove plug from the socket before cleaning and maintenance .

- ◆ Cleaning the body for this device by damp cloth, then wipe it dry.
- ◆ If the machine is too dirty, neutral detergent can be used for cleaning, but please dilute the detergent before use.
- ◆ Do not clean the unit with the solvent listed on the right which may cause distortion or discolour.

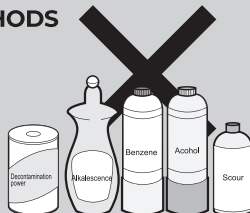

If the machine can't work properly, please kindly check as below before you send it out for repair

Problem	Checking methods	Possible solution
Do not work	<ul style="list-style-type: none">• Please check if the plug is disconnected from the socket.	➡ Power plug should be plugged properly
Odor can not be removed	<ul style="list-style-type: none">• Is there a very strong odor in the using environment? (Notes: air should be purified continuously)	➡ It is recommended to ventilate first and then turn on the machine
	<ul style="list-style-type: none">• Does the using life time for filters come to the end?	➡ Please replace the used filter with a new one.
High noise	<ul style="list-style-type: none">• Is the PE bag for filter removed?	➡ Please take out filter and tear off PE bag.
	<ul style="list-style-type: none">• Does the using life time for filter come to the end?	➡ Please replace the used filter with a new one.

If the problem is still existed after above inspections, please disconnect the power and it for repair

PARAMETERS OF THE UNIT

Model No.:	B-D03
Voltage Supply:	24V ===
Power consumption(w):	22W
Net Weight:	1.75kg
Dimensions(wxdxh):	191x191x363 (mm)

FILTER PARAMETERS

Item name	Dimensions(wxdxh)	Life time
High efficiency composited filter	158*158*186 (mm)	1440H

mooka

Beyond Elegance



www.mookashops.com



support@mookashops.com



1-855-666-9955



Made in China