

# Bathys MG

Démarrage rapide / Quick Start



GO TO THE  
USER MANUAL



[www.focal.com/  
usermanual/bathys-mg](http://www.focal.com/usermanual/bathys-mg)

- FR** Accéder à la notice d'utilisation
- DE** Bedienungsanleitung lesen
- IT** Accedi alle istruzioni per l'uso
- ES** Acceda a las instrucciones de uso
- PT** Ir para o manual do utilizador
- NL** Ga naar de gebruiksaanwijzing
- PL** Przejdź do instrukcji obsługi
- RU** Перейти к инструкции по эксплуатации
- ZH** 访问使用说明
- TW** 訪問用戶指南
- KO** 사용설명서 보러가기
- JP** 取扱説明書を見る
- AR** اذهب إلى دليل الاستخدام

 **FOCAL®**

TÉLÉCHARGER L'APPLICATION

---

DOWNLOAD THE APP



## Bathys MG



A  
x 1

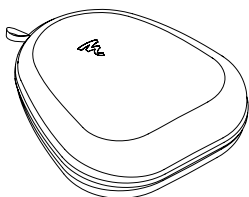

B  
x 1



C  
x 1



D



E

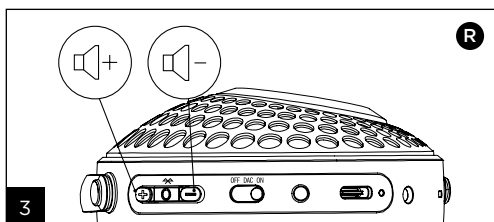
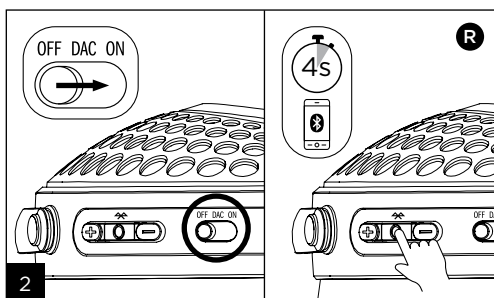
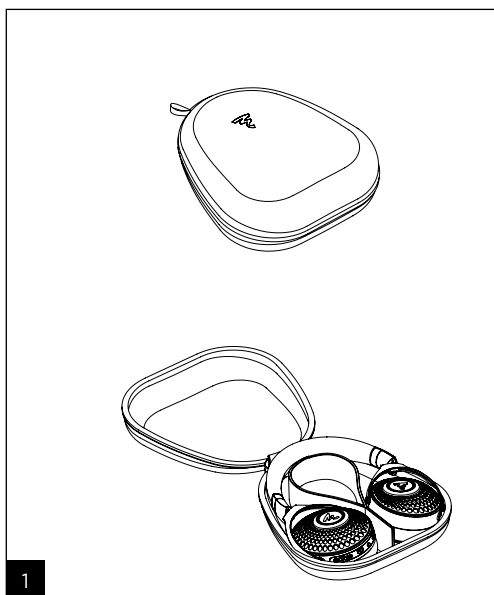

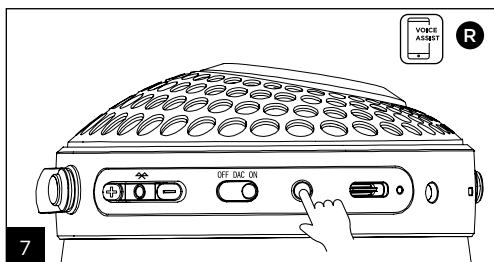
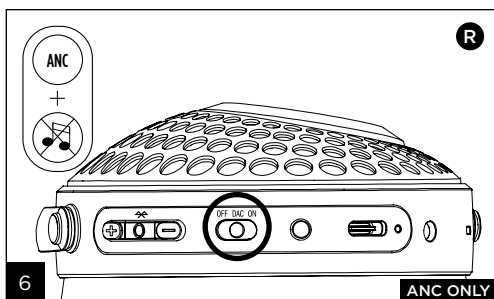
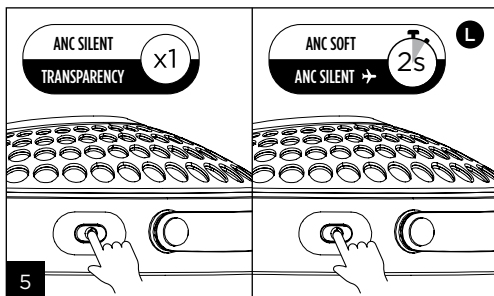
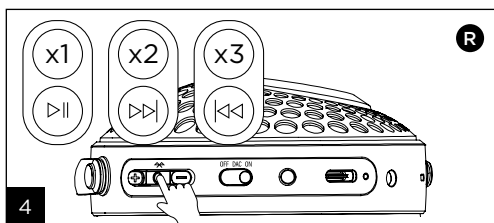

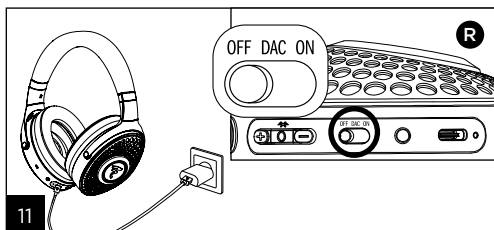
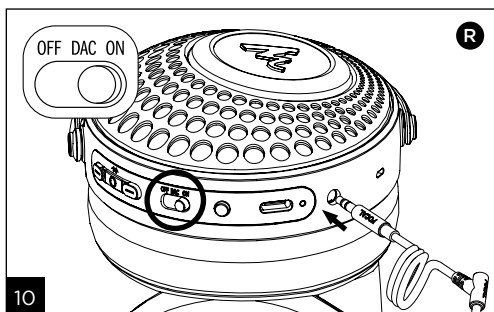
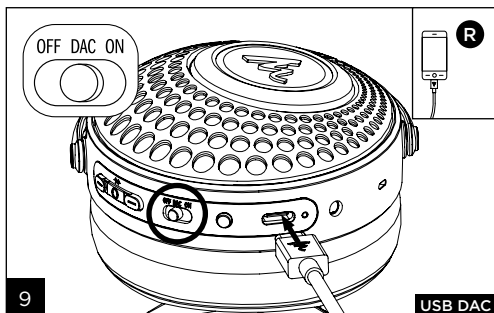
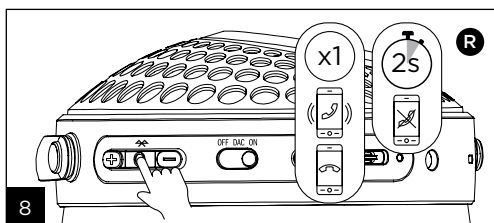

# IMPORTANT SAFETY INSTRUCTIONS!

Before using the product, read the instructions and keep them carefully for future reference if required.

## **IMPORTANT SAFETY INSTRUCTIONS**

- 1) Read these instructions.
- 2) Keep these instructions.
- 3) Heed all warnings contained in these instructions.
- 4) Follow all the instructions.
- 5) Listening to high powered headphones can damage the ears and lead to hearing problems (temporary or permanent deafness, ringing in the ears, tinnitus, hyperacusis).



Exposure to excessive volumes (over 85 dB) for more than one hour can cause irreparable damage to your hearing. The headphones must, therefore, be turned on before wearing them and we strongly advise against using the headphones at full volume, nor for more than one hour a day at medium volume.

Do not use the headphones continuously; take regular breaks. If you experience buzzing or ringing (tinnitus) in the ears, hearing loss or a "muffled" sensation, stop listening to the headphones immediately. If symptoms persist after a few hours, consult your doctor immediately who will, if necessary, refer you to an ENT specialist. In some cases, immediate treatment can prevent irreversible damage.

6) Always turn on the headphones before wearing them, set the listening device's volume to the lowest setting before connecting your headphones and increasing the volume. Once the headphones are in place, gradually increase the volume to a reasonable and comfortable level.

7) Never use the headphones without the earpads or protective tips.

8) Be sure to use the headphones in such a way that you can still hear sounds around you. In particular, the product's active noise cancellation may make ambient noise inaudible or significantly change your perception of warning signals; reducing the chance of hearing ambient noise is a risk for yourself and those around you.

Do not use the headphones in conditions requiring special attention, such as when outdoors in heavy traffic, near a construction site or a railway line, etc.

Never drive a vehicle (car, motorcycle, boat, electric scooter, etc.) or ride a bicycle, skateboard, roller blades, hoverboard, etc. while wearing the headphones. Any use under these circumstances is dangerous and, in some countries, illegal.

9) It is also not recommended to use the headphones for running, walking or doing any other activity in crowded places. If you use the headphones under these circumstances, set the volume to low so that you can hear ambient sounds, including horns, alarms and warning signals.

10) Please ensure that children and young people under the age of 14 are not allowed to use the headphones without supervision. Be particularly vigilant with regard to children and adolescents who often use these devices at excessive volumes.

11) Do not use the headphones for anything but their original function. Never use headphones as a form of noise protection. Do not use the headphones as an aviation communications headset.

12) Use compliant adapters to connect your headphones to aeroplane seat plugs. Failure to do so may result in personal injury or property damage caused by overheating.

13) If you feel heat or lose audio signal, remove and disconnect the headphones immediately.

14) Do not place burning objects near and/or on the headphones, such as lit candles, lighters, etc.

15) Do not apply any weight or pressure to the headphones for too long, including when turned off or not in use.

16) Do not expose your headphones to moisture or immerse them in water.

17) The headphones do not require specific cleaning. If necessary, use a soft, dry cloth. Do not use cleaning products containing solvents.

18) Have any repairs or servicing carried out by a professional. Such operations are necessary in the event of damage of any kind, such as liquid spillage, cable damage, exposure to rain, dropping the device, etc.

Do not modify the system or its accessories. Unauthorised modifications may compromise your safety, regulatory compliance and device performance.

If you replace your earpads, be sure to replace them only with the specific pad model provided by the manufacturer so as not to affect the sound quality and active noise reduction.

19) This product poses risks of:

- choking;
- fire or electrocution (do not expose the device to rain or moisture, or any other liquid).

20) This product contains magnetic components and generates magnetic fields which may interfere with pacemakers and implanted defibrillators. Before using the headphones, contact your GP if you have any questions regarding the effect of these components on the functioning of an implanted medical device.

21) This product complies with all applicable European regulations and directives. This symbol means that the product (including its battery if applicable) must not be thrown away with household waste but must be taken to an appropriate collection centre for recycling. Proper disposal and recycling helps protect

natural resources, human health and the environment. For more information on the disposal and recycling of this product, contact your local council, your waste collection service or the store where you purchased this product.

22) This product contains a lithium-ion battery, which should be handled with care. Lithium batteries can be dangerous if not used and handled properly. In extreme cases, abnormal use of lithium batteries can lead to:

- explosion
- fire
- release of heat
- release of smoke or gas.

23) Caution, do not open the device. It is forbidden to disassemble, open, pierce, or perform any other action on the battery on your own.

Caution, there is a danger of explosion if the battery is incorrectly replaced.

Replacing and/or removing the battery from your Focal product must be carried out by a professional. The battery must be replaced by a battery identical to the original one and obtained from a Focal dealer.

Focal cannot guarantee the safety or compatibility of batteries from other manufacturers, or that they will function properly with the device.

Do not short-circuit the (+) and (-) terminals of the battery with conductive elements (in contact with metallic objects in particular), or by any other means.

Do not reverse the polarities.

Do not place burning objects near and/or on the headphones' built-in battery. In general, the battery should not be exposed to excessive heat such as sunshine, fire or similar (above 70°C) and/or humidity above 90%.

Do not expose the battery and charger to water (do not immerse, pour liquid on them, expose to condensation or get wet). Do not expose to rain.

Never use a damaged battery.

Do not subject the battery to impacts or vibrations. In the event of a severe impact, stop using the battery.

Do not destroy or incinerate the battery.

Exposure to internal battery components or the products



released when burned can be hazardous. If you have been exposed, contact your GP.

If, during use, the battery gives off an unusual odour or becomes abnormally hot or warped, switch off the device immediately and contact your Focal dealer.

Only use this product with a certified Limited Power Supply (LPS) that meets local regulatory requirements (e.g. UL, CSA, VDE, CCC & CE).

Only charge the battery at an ambient temperature between 0°C and 45°C.

Never charge a swollen, leaking or otherwise damaged battery. Never use a modified or damaged charger. Only charge the battery on non-flammable surfaces (do not charge it on a flammable surface such as carpet or wooden floors) and do not charge it near flammable materials. Charge the battery on a non-conductive surface to prevent any damage associated in particular with a short circuit.

Keep the battery and charger out of the reach of children under 14 years old.

Do not use the headphones while the battery is charging.

Any battery (original or replacement) should not be exposed to heat such as sunshine, fire or similar.

### **OPTIMAL CONDITIONS FOR BATTERY USE**

For your headphones' battery to retain optimal autonomy, and in the event of prolonged non-use, recharge it regularly and at least once every three months or so.

Turn off battery-powered products when not in use.

For optimal use, do not use headphones with a battery in places subject to excessive heat (above 40°C) or excessive cold (below -5°C).

In the event of a problem, contact your specialist dealer.

- The replacement of a battery with an incorrect type can defeat a safeguard (for example, in the case of some lithium battery types);

- the disposal of a battery into fire or a hot oven, or mechanically crushing or cutting of a battery can result in an explosion;

- leaving a battery in an extremely high temperature surrounding environment can result in an explosion or the leakage of flammable liquid or gas;

- a battery subjected to extremely low air pressure may result in an explosion or the leakage of flammable liquid or gas.

### **FCC Regulatory Compliance**

This device complies with Part 15 of the FCC Rules. Operation is subject to the following two conditions: (1) this device may not cause harmful interference, and (2) this device must accept any interference received, including interference that may cause undesired operation.

changes or modifications not expressly approved by the party responsible for compliance could void the user's authority to operate the equipment.

This equipment has been tested and found to comply with the limits for a Class B digital device, pursuant to Part 15 of the FCC Rules. These limits are designed to provide reasonable protection against harmful interference in a residential installation. This equipment generates, uses and can radiate radio frequency energy and, if not installed and used in accordance with the instructions, may cause harmful interference to radio communications. However, there is no guarantee that interference will not occur in a particular installation.

If this equipment does cause harmful interference to radio or television reception, which can be determined by turning the equipment off and on, the user is encouraged to try to correct the interference by one or more of the following measures:

- Reorient or relocate the receiving antenna.

- Increase the separation between the equipment and receiver.

- Connect the equipment into an outlet on a circuit different from that to which the receiver is connected.

- Consult the dealer or an experienced radio/TV technician for help.

This equipment complies with FCC radiation exposure limits set forth for an uncontrolled environment. This transmitter must not be co-located or operating in conjunction with any other antenna or transmitter.

#### ISED Regulatory Compliance

This device contains licence-exempt transmitter(s)/receiver(s) that comply with Innovation, Science and Economic Development Canada's licence-exempt RSS(s). Operation is subject to the following two conditions: (1) This device may not cause interference. (2) This device must accept any interference, including interference that may cause undesired operation of the device. This equipment complies with IC RSS-102 radiation exposure limits set forth for an uncontrolled environment.

**EU Declaration of Conformity:** Hereby, FOCAL JMLab declares that these wireless headphones are in compliance with Directive 2014/53/EU. The full text of the EU declaration of conformity is available at the following internet address: <https://www.focal.com/declaration-of-conformity-for-the-european-union>

#### Conditions of warranty

All Focal loudspeakers are covered by warranty drawn up by the official Focal distributor in your country. Your distributor can provide all details concerning the conditions of warranty. Warranty cover extends at least to that granted by the legal warranty in force in the country where the original purchase invoice was issued.



Qualcomm® aptX™  
Adaptive

Qualcomm is a trademark of Qualcomm Incorporated, registered in the United States and other countries.

aptX is a trademark of Qualcomm Technologies International, Ltd., registered in the United States and other countries.

Qualcomm® aptX™ Adaptive audio supports low-latency, robust and high resolution Bluetooth wireless audio.



The Bluetooth® word mark and logos are registered trademarks owned by Bluetooth SIG, Inc. and any use of such marks by Focal is under license. Other trademarks and trade names are those of their respective owners.



Use of the Made for Apple badge means that an accessory has been designed to connect specifically to the Apple product(s) identified in the badge and has been certified by the developer to meet Apple performance standards. Apple is not responsible for the operation of this device or its compliance with safety and regulatory standards.

Apple, Apple TV, Apple Watch, iPad, iPad Air, iPad Pro, iPhone, and Lightning are trademarks of Apple Inc., registered in the U.S. and other countries. tvOS is a trademark of Apple Inc. The trademark "iPhone" is used in Japan with a license from Aiphone K.K.



This device complies with Part 15 of the FCC Rules. Operation is subject to the following two conditions: (1) this device may not cause harmful interference, and (2) this device must accept any interference received, including interference that may cause undesired operation.

Markings related to country certifications and manufacturer information are located under the earpads. To access it, you need to remove the earpads and lift the acoustic fabric.

Les marquages relatifs aux certifications pays et information sur le fabricant se trouvent sous les coussinets. Pour y accéder, vous devez enlever les coussinets et soulever le tissu acoustique.

Focal مكبرات

<p>في بلدك. Focal</p> <p>مشمولة بضمان يمنحه الموزع الرسمي لمكبرات Focal</p> <p>Operation Frequency: 2402MHz to 2480MHz</p> <p>بجميع التفاصيل المتعلقة بالضمان. يمتد</p>	<p>مكبرات الصوت من يروك موزعك Focal</p>
<p>EIRP or emission power (Max):</p>	<p>4.56dBm (2.86mW)</p>

مكبرات Focal

## REGISTER YOUR PRODUCT ONLINE



[www.focal.com/  
warranty](http://www.focal.com/warranty)

- FR** Enregistrer votre produit en ligne
- DE** Registrieren Sie Ihr Produkt online
- IT** Registra il tuo prodotto online
- ES** Registre su producto en línea
- PT** Possível registar um produto online
- NL** Registreer uw product online
- PL** Zarejestruj swój produkt online
- RU** Зарегистрируйте свой продукт онлайн
- ZH** 您可以在线注册产品
- TW** 現在您可以在線上為產品進行註冊
- KO** 당신의 제품을 온라인에서 등록하세요
- JP** 製品のオンライン登録をお願いします
- AR** يمكنك الآن تسجيل منتجك عبر الإنترنت



Raccolta differenziata.  
Verifica le disposizioni  
del tuo Comune.

(((CCAM22LP0030E2



Scansionare il codice QR per  
informazioni sullo smaltimento  
degli imballaggi  
Scan QR code for information  
on packaging disposal



FOCAL.JMLAB UK  
SP1 2LN



FR



EMBALLAGE  
EXTÉRIEUR

ET



CALES



BAC  
DE  
TRI

Cet appareil  
se recycle

REPRISE  
À LA LIVRAISON



À DÉPOSER  
EN MAGASIN



À DÉPOSER  
EN DÉCHÈTERIE



Points de collecte sur [www.quefairedemesdechets.fr](http://www.quefairedemesdechets.fr)

Focal-Jmlab® - BP 374 - 108, rue de l'Avenir -  
42353 La Talaudière cedex - France - [www.focal.com](http://www.focal.com)  
Tel. (+33) 04 77 43 57 00 - SCLC - 19/12/2024 - v2 -  
CODO3136

# Bathys MG

Manuel d'utilisation / User Manual / Gebrauchsanleitung / Manuale d'uso / Manual de uso /  
Manual de utilização / Handleiding / Руководство по эксплуатации /  
使用手册 / 사용 설명서 / 取扱説明書 / دليل المستخدم

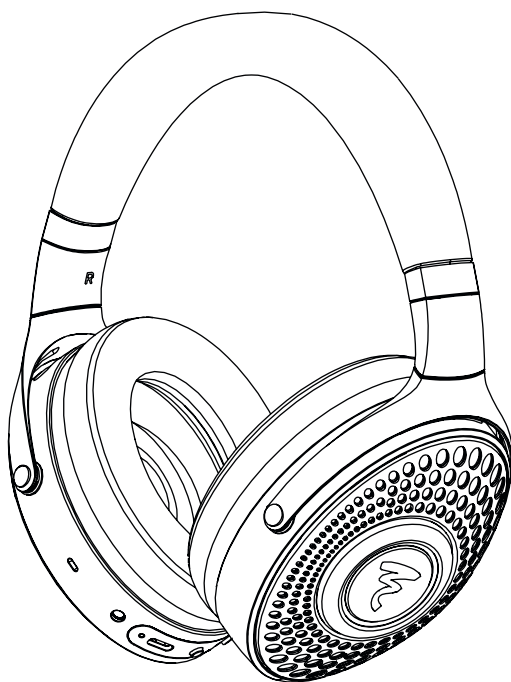

 **FOCAL®**

FR

EN

DE

IT

ES

PT

NL

PL

RU

ZH

KO

JP

AR

# Bathys MG

Manuel d'utilisation / User manual

Bathys MG	
Type	Closed-back headphones, active, noise cancelling
Bluetooth®	5.2 Multipoint ; range > 15m
Bluetooth® frequency band	2402 - 2480Mhz
Maximum emission power	4.56dBm (2.86mW)
Audio codecs	SBC, AAC, aptX™, aptX™ Adaptive
Autonomy	30h Bluetooth® Noise Cancelling 35h mode jack 42h mode USB DAC
Other functions	Google Fast Pair
Drivers	40mm Magnesium
Frequency response	10Hz to 22kHz
Harmonic distortion rate	<0.2% @1kHz
Battery type	Lithium-ion 1060mAH
Power supply	5V-2000mA (Not supplied)
Microphones	8
Control application	Focal & Naim, iOS and Android compatible
Weight	350g
Cables and connectors	1.2m 3.5mm Jack 1.2m USB Type-C®
Carrying case	9.5x8.3x2.8" (24x21x7cm)

# READ THIS FIRST!

## IMPORTANT SAFETY INSTRUCTIONS!

EN



Warning symbol. This symbol is designed to warn the user of the presence of important instructions mentioned in the user manual and relating to the handling, operation and maintenance of the device.

Before using the product, read the instructions and keep them carefully for future reference if required.

- 1) Read these instructions.
- 2) Keep these instructions.
- 3) Heed all warnings contained in these instructions.
- 4) Follow all the instructions.
- 5) Listening to high powered headphones can damage the ears and lead to hearing problems (temporary or permanent deafness, ringing in the ears, tinnitus, hyperacusis).



Exposure to excessive volumes (over 85 dB) for more than one hour can cause irreparable damage to your hearing.

The headphones must, therefore, be turned on before wearing them and we strongly advise against using the headphones at full volume, nor for more than one hour a day at medium volume.

Do not use the headphones continuously; take regular breaks. If you experience buzzing or ringing (tinnitus) in the ears, hearing loss or a "muffled" sensation, stop listening to the headphones immediately. If symptoms persist after a few hours, consult your doctor immediately who will, if necessary, refer you to an ENT specialist. In some cases, immediate treatment can prevent irreversible damage.

6) Always turn on the headphones before wearing them, set the listening device's volume to the lowest setting before connecting your headphones and increasing the volume. Once the headphones are in place, gradually increase the volume to a reasonable and comfortable level.

7) Never use the headphones without the earpads or protective tips.

8) Be sure to use the headphones in such a way that you can still hear sounds around you. In particular, the product's active noise cancellation may make ambient noise inaudible or significantly change your perception of warning signals; reducing the chance of hearing ambient noise is a risk for yourself and those around you. Do not use the headphones in conditions requiring special attention, such as when outdoors in heavy traffic, near a construction site or a railway line, etc.

Never drive a vehicle (car, motorcycle, boat, electric scooter, etc.) or ride a bicycle, skateboard, roller blades, hoverboard, etc. while wearing the headphones.

Any use under these circumstances is dangerous and, in some countries, illegal.

9) It is also not recommended to use the headphones for running, walking or doing any other activity in crowded places. If you use the headphones under these circumstances, set the volume to low so that you can hear ambient sounds, including horns, alarms and warning signals.

10) Please ensure that children and young people under the age of 14 are not allowed to use the headphones without supervision. Be particularly vigilant with regard to children and adolescents who often use these devices at excessive volumes.

11) Do not use the headphones for anything but their original function. Never use headphones as a form of noise protection. Do not use the headphones as an aviation communications headset.

12) Use compliant adapters to connect your headphones to aeroplane seat plugs. Failure to do so may result in personal injury or property damage caused by overheating.

13) If you feel heat or lose audio signal, remove and disconnect the headphones immediately.

14) Do not place burning objects near and/or on the headphones, such as lit candles, lighters, etc.

15) Do not apply any weight or pressure to the headphones for too long, including when turned off or not in use.

16) Do not expose your headphones to moisture or immerse them in water.

17) The headphones do not require specific cleaning. If necessary, use a soft, dry cloth. Do not use cleaning products containing solvents.

18) Have any repairs or servicing carried out by a professional. Such operations are necessary in the event of damage of any kind, such as liquid spillage, cable damage, exposure to rain, dropping the device, etc. Do not modify the system or its accessories. Unauthorised modifications may compromise your safety, regulatory compliance and device performance.

If you replace your earpads, be sure to replace them only with the specific pad model provided by the manufacturer so as not to affect the sound quality and active noise reduction.

19) This product poses risks of:

- choking;
- fire or electrocution (do not expose the device to rain or moisture, or any other liquid).

20) This product contains magnetic components and generates magnetic fields which may interfere with pacemakers and implanted defibrillators. Before using the headphones, contact your GP if you have any questions regarding the effect of these components on the functioning of an implanted medical device.

21)



This product complies with all applicable European

regulations and directives. This symbol means that the product (including its battery if applicable) must not be thrown away with household waste but must be taken to an appropriate collection centre for recycling. Proper disposal and recycling helps protect natural resources, human health and the environment. For more information on the disposal and recycling of this product, contact your local council, your waste collection service or the store where you purchased this product.

22)



This product contains a lithium-ion battery, which should be handled with care.

Lithium batteries can be dangerous if not used and handled properly. In extreme cases, abnormal use of lithium batteries can lead to:

- explosion
- fire
- release of heat
- release of smoke or gas.

23) Caution, do not open the device. It is forbidden to disassemble, open, pierce, or perform any other action on the battery on your own.

Caution, there is a danger of explosion if the battery is incorrectly replaced. Replacing and/or removing the battery from your Focal product must be carried out by a professional. The battery must be replaced by a battery identical to the original one and obtained from a Focal dealer.

Focal cannot guarantee the safety or compatibility of batteries from other manufacturers, or that they will function properly with the device.

	<p>Warning symbol. This symbol is designed to warn the user of the presence of important instructions mentioned in the user manual and relating to the handling, operation and maintenance of the device.</p>	
<p>Do not short-circuit the (+) and (-) terminals of the battery with conductive elements (in contact with metallic objects in particular), or by any other means. Do not reverse the polarities. Do not place burning objects near and/or on the headphones' built-in battery. In general, the battery should not be exposed to excessive heat such as sunshine, fire or similar (above 70°C) and/or humidity above 90%. Do not expose the battery and charger to water (do not immerse, pour liquid on them, expose to condensation or get wet). Do not expose to rain. Never use a damaged battery. Do not subject the battery to impacts or vibrations. In the event of a severe impact, stop using the battery. Do not destroy or incinerate the battery. Exposure to internal battery components or the products released when burned can be hazardous. If you have been exposed, contact your GP. If, during use, the battery gives off an unusual odour or becomes abnormally hot or warped, switch off the device immediately and contact your Focal dealer. Only use this product with a certified Limited Power Supply (LPS) that meets local regulatory requirements (e.g. UL, CSA, VDE, CCC &amp; CE). Only charge the battery at an ambient temperature between 0°C and 45°C. Never charge a swollen, leaking or otherwise damaged battery. Never use a modified or damaged charger. Only charge the battery on non-flammable surfaces (do not charge it on a flammable surface such as carpet or wooden floors) and do not charge it near flammable materials. Charge the battery on a non-conductive surface to prevent any damage associated in particular with a short circuit. Keep the battery and charger out of the reach of children under 14 years old. Do not use the headphones while the battery is charging. Any battery (original or replacement) should not be exposed to heat such as sunshine, fire or similar.</p>	<p><b><u>OPTIMAL CONDITIONS FOR BATTERY USE</u></b> For your headphones' battery to retain optimal autonomy, and in the event of prolonged non-use, recharge it regularly and at least once every three months or so. Turn off battery-powered products when not in use. For optimal use, do not use headphones with a battery in places subject to excessive heat (above 40°C) or excessive cold (below -5°C). In the event of a problem, contact your specialist dealer.</p> <ul style="list-style-type: none"> <li>- The replacement of a battery with an incorrect type can defeat a safeguard (for example, in the case of some lithium battery types);</li> <li>- the disposal of a battery into fire or a hot oven, or mechanically crushing or cutting of a battery can result in an explosion;</li> <li>- leaving a battery in an extremely high temperature surrounding environment can result in an explosion or the leakage of flammable liquid or gas;</li> <li>- a battery subjected to extremely low air pressure may result in an explosion or the leakage of flammable liquid or gas.</li> </ul> <p><b>FCC Regulatory Compliance</b> This device complies with Part 15 of the FCC Rules. Operation is subject to the following two conditions: (1) this device may not cause harmful interference, and (2) this device must accept any interference received, including interference that may cause undesired operation. changes or modifications not expressly approved by the party responsible for compliance could void the user's authority to operate the equipment.</p>	<p>This equipment has been tested and found to comply with the limits for a Class B digital device, pursuant to Part 15 of the FCC Rules. These limits are designed to provide reasonable protection against harmful interference in a residential installation. This equipment generates, uses and can radiate radio frequency energy and, if not installed and used in accordance with the instructions, may cause harmful interference to radio communications. However, there is no guarantee that interference will not occur in a particular installation. If this equipment does cause harmful interference to radio or television reception, which can be determined by turning the equipment off and on, the user is encouraged to try to correct the interference by one or more of the following measures:</p> <ul style="list-style-type: none"> <li>- Reorient or relocate the receiving antenna.</li> <li>- Increase the separation between the equipment and receiver.</li> <li>- Connect the equipment into an outlet on a circuit different from that to which the receiver is connected.</li> <li>- Consult the dealer or an experienced radio/TV technician for help.</li> </ul> <p>This equipment complies with FCC radiation exposure limits set forth for an uncontrolled environment. This transmitter must not be co-located or operating in conjunction with any other antenna or transmitter.</p> <p><b>ISED Regulatory Compliance</b> This device contains licence-exempt transmitter(s)/receiver(s) that comply with Innovation, Science and Economic Development Canada's licence-exempt RSS(s). Operation is subject to the following two conditions: (1) This device may not cause interference. (2) This device must accept any interference, including interference that may cause undesired operation of the device. This equipment complies with IC RSS-102 radiation exposure limits set forth for an uncontrolled environment.</p>



# Bathys MG

## User manual

16

EN

To facilitate the FOCAL JMLab warranty, it is now possible to register your product online at: [www.focal.com/warranty](http://www.focal.com/warranty)



Thank you for purchasing a Focal product. Welcome to our High-Fidelity world. Innovation, tradition, excellence and pleasure are our values; our one and only aim is to bring you a sound that is rich, pure and true. To get the most out of your product, we recommend that you read the instructions in this booklet, then store it in a safe place to refer to in the future.

### 1. Package contents

- 1 x Bathys MG headphones
- 1 x carrying case
- 1 x Jack cable
- 1 x USB-C® cable
- 1 x Quick Start
- 1 x Brand content

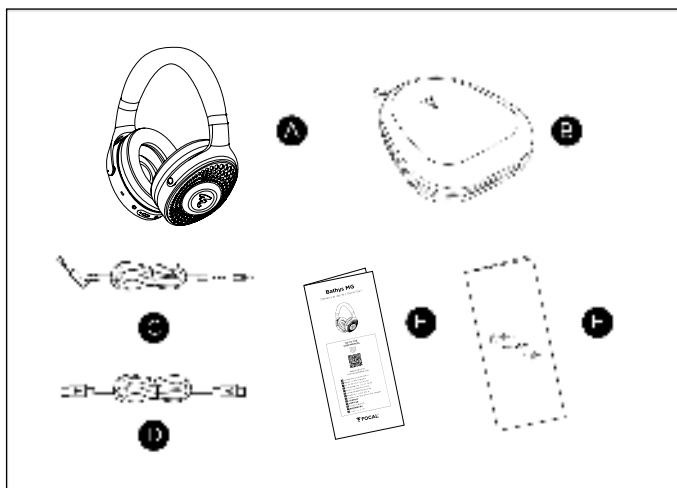

### 2. Application

The Focal app allows you to configure and control the headphones from your mobile device, including via your smartphone.

Using the app, you can manage Bluetooth® connections, headphones settings and access any new features added through updates (EQ).



- Download the app

App Store  
Google Store

- Follow the instructions in the app

### 3. Powering on - Powering off - Pairing

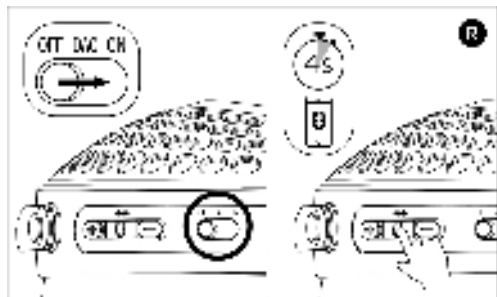

To turn on the headphones, slide the power button to ON.

To turn them off, return the button to the OFF position. If you stop using the headphones for longer than 15 minutes, in Bluetooth® mode, they will automatically enter standby. To turn back on from standby, press the multifunction button.

The headphones can save up to 8 devices. When you turn them on, the headphones will attempt to connect to one of the saved devices. To launch pairing with another device, press and hold the multifunction button for 4 seconds; the logo will flash and a sound signal will be emitted. Go to the Bluetooth® settings on the device to connect to the headphones. Once paired with the device, the headphones are ready to use.

### 4. Using the headphones in Bluetooth®, jack and USB DAC modes

#### a. Bluetooth®



To use the headphones in Bluetooth® mode, the power switch must be in the ON position. When using the headphones for the first time, the pairing mode is automatically enabled. To connect to the device, go to its Bluetooth® settings and connect it to the “Focal Bathys MG” headphones. Once the pairing is successful, the headphones are ready to use.

To connect to another device, enable the pairing mode on the headphones by pressing and holding the multifunction button for 4 seconds. The logo will flash and a sound signal will be emitted. Go into the Bluetooth® settings for the device to connect the headphones. In free field, the Bluetooth® has a 16.4-yard (15-metre) range. Beyond that distance, the headphones will disconnect from the source.

# Bathys MG

## User manual

18

EN

### b. Jack

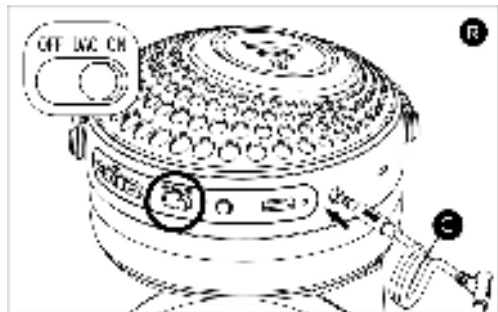

To use the headphones with the jack mode, you must use the jack cable supplied in the pack. Connect the cable to the jack input on the right-hand earcup of the headphones. The power switch must be in the ON position. When you connect the jack cable, the Bluetooth® function will disconnect. If the cable is damaged, contact your dealer who will supply you with the spare parts you need.

### c. USB DAC

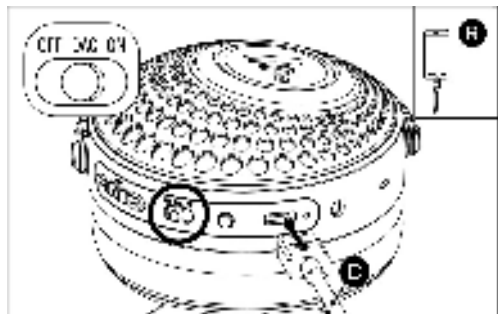

To use the USB DAC mode, use the USB-C® cable supplied with the product and move the power switch to the DAC position. If the cable is damaged, contact your dealer who will supply you with the spare parts you need.

5. Playing multimedia - Volume

Play / pause	Press the multifunction key
Next	Press the multifunction key twice
Previous	Press the multifunction key three times
Increase volume	Press the + key
Reduce volume	Press the - key

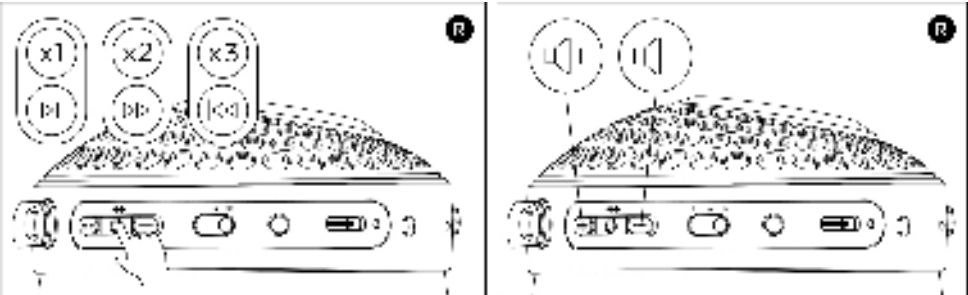

6. Charging the headphones

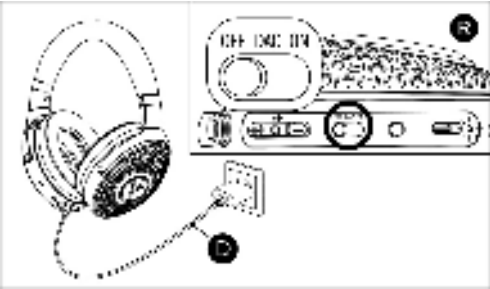

To charge the headphones, use the USB-C\* supplied and connect it to the USB-C\* input on the right-hand earcup of the headphones. The power switch must be in either the OFF or ON position. The headphones must be switched off while they are being charged.

If you use a USB AC adapter, it must have a 5-volt output and a 300mA current as a minimum. The headphones come equipped with the fast charging feature. To use it, connect the device to a 2-amp (2000mA) adapter.

15 minutes of fast charging will give you around 5 hours of additional listening time. It takes around one and a half hours to fully charge the headphones (with 2 amps). With a full charge, you will have approximately 30 hours of battery life.

The battery's performance diminishes over time and the more times it is charged. The battery life, charging time and fast-charging time shown are therefore likely to change.

During charging, the battery light will flash white. Once the battery is fully charged, the battery light will stay white.

### 7. Active noise reduction - Transparency mode

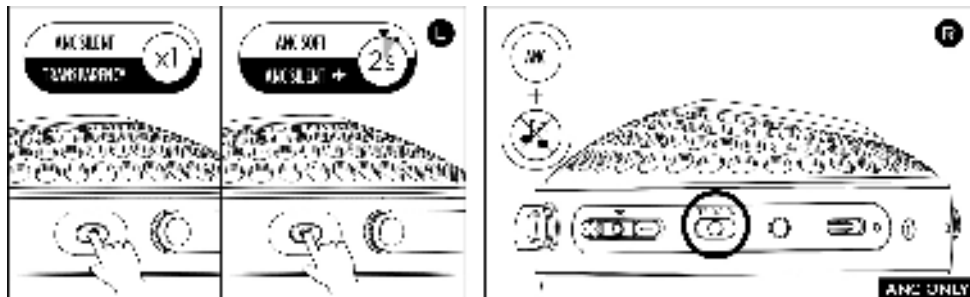

To change the noise reduction mode or enable the transparency mode, press the button located on the left-hand earcup of the headphones. Choose between noise reduction and transparency mode with a short press. Change the noise reduction mode by pressing and holding for 2 seconds. These modes can be changed using the app.

There are 2 noise reduction modes and one transparency mode.

- Silent: provides the highest level of noise reduction.
- Soft: reduces the lowest-frequency noises while allowing you to hear ambient noise.
- Transparency: allows you to hear ambient noise and have a conversation without removing the headphones, while continuing to listen to your music.

If the headphones are used without music in the DAC position, the active noise reduction feature reduces background noise. The noise reduction will work as long as there is battery. If the ON position is used, the headphones will automatically enter standby after 15 minutes, which will switch off active noise reduction. You should follow the same precautions relating to active noise reduction as when using the feature with music.

### 8. Voice assistants

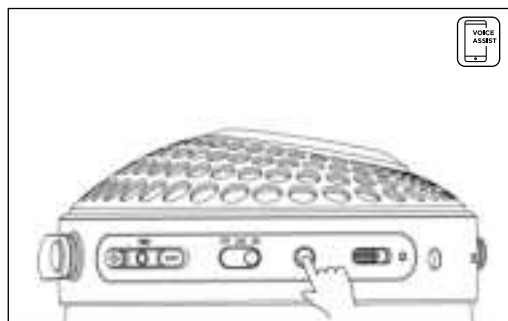

The headphones are compatible with the voice assistants on your devices.

To activate this feature, press the button on the right-hand earcup of the headphones, and speak.

## 9. Telephone communications

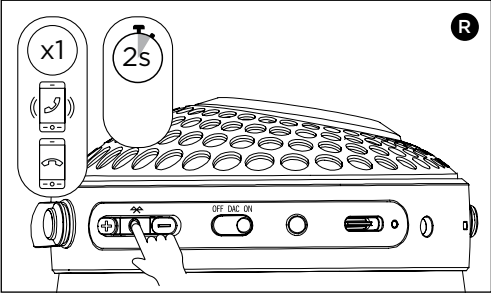

If you receive a call while you are listening to music, the playback will pause and you will hear a ringtone through the headphones. The headphones are fitted with microphones which use Clear Voice® technology. To answer, press the multifunction button. To hang up, press this same button again. To reject the call, press and hold on the multifunction button for 2 seconds.

## 10. Product lighting

The headphones are fitted with LEDs on the earcups. You can deactivate the use of different lights via the app in Bluetooth® mode.

Feature	Light behaviour
Searching for device	LEDs flash
Pairing mode	LEDs flash slowly
Connected	LEDs light up
Battery charging	USB LED flashes
Battery charged	USB LED lights up
Jack mode	LEDs light up 50%
USB-C® mode	LEDs light up 50%
OFF	LEDs switched off

## 11. Connecting to several devices at the same time

The headphones are fitted with multipoint Bluetooth® technology which allows them to be connected to two devices at the same time. The headphones can therefore switch easily between two audio sources without using the normal process of Bluetooth® reconnection. The headphones can also automatically answer a call on your phone when you are listening to audio content on another source (for example, a computer or tablet). The headphones can save up to 8 devices. If more than 8 different devices are connected, the device that was paired first will be removed. You will need to pair it again. To do this, press and hold the multifunction button for 4 seconds.

### 12. Replacing the earpads

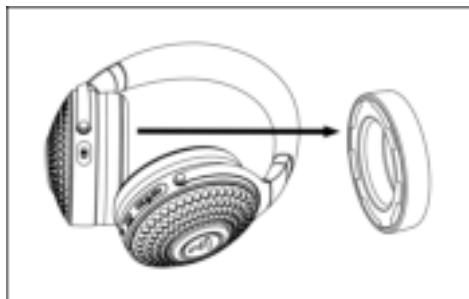

If your earpads show signs of wear, they are easy to replace: carefully pull on your earpads to detach the 6 clips.

When you are replacing the earpads, ensure that the clips are all correctly mounted so as not to alter the sound quality and active noise reduction. They must be replaced with the same model. Contact your dealer, who will be able to provide you with the spare parts you need.

### 13. Cleaning the headphones

You can clean the headphones by simply dusting with a soft, dry cloth. If there are any stains or marks on the leather parts, contact a specialist as it is not advisable to clean this material yourself.

### 14. Storing the headphones

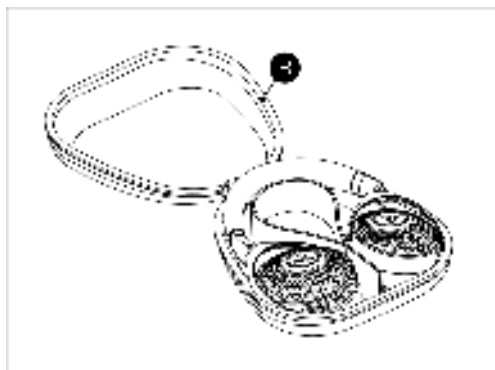

When you are not using the headphones, we recommend that you switch them off and store them flat in their carrying case, turning the earcups to face inwards.

Fully charge the battery if you do not plan on using the headphones for several months. If the headphones are not in use for a prolonged period, charge the battery fully every 3 months in order to preserve device performance.

### 15. Firmware update

Use the app to update the firmware for the headphones, without which some of the device's features will no longer be available.

### 16. Restoring the factory settings - Forced shutdown

To restore the factory settings on the headphones, press and hold the “-” and “ANC” buttons at the same time for 8 seconds. Everything saved on the headphones will be deleted.

To carry out a forced shutdown on the headphones, press the “+”, “-” and “ANC” buttons at the same time. The latest settings used on the headphones will be stored.

### 17. Troubleshooting

If you encounter any difficulties when using the product, consult the frequently asked questions (FAQ) on our website. If the problem persists, contact customer service.

### 18. Warranty

Outside France, Focal equipment is covered by a warranty for which the terms and conditions are determined or implemented locally by the official Focal distributor for each country, in accordance with the laws in force in the region in question.



## Déclaration conformité CE simplifiée

Focal JMLab déclare que ce produit est conforme aux critères essentiels et autres dispositions de la directive 2014/53/UE et des autres directives européennes applicables. L'attestation complète de conformité est disponible à l'adresse : [https://www.focal.com/sites/www.focal.fr/files/shared/catalog/document/eu-sdoc\\_bathys\\_foahalnomb0-eu1.pdf](https://www.focal.com/sites/www.focal.fr/files/shared/catalog/document/eu-sdoc_bathys_foahalnomb0-eu1.pdf)

Ce produit est conforme à toutes les réglementations de 2016 en matière de compatibilité électromagnétique et à toutes les autres réglementations britanniques applicables. Focal JMLab déclare que ce produit est conforme aux critères essentiels et autres dispositions des réglementations de 2017 sur les équipements radio et des autres réglementations britanniques applicables.

[https://www.focal.com/sites/www.focal.fr/files/shared/catalog/document/ukca-sdoc\\_bathys\\_foahalnomb0-uk1.pdf](https://www.focal.com/sites/www.focal.fr/files/shared/catalog/document/ukca-sdoc_bathys_foahalnomb0-uk1.pdf)

## FCC and IC

**Caution:** The user is cautioned that changes or modifications not expressly approved by the party responsible for compliance could void the user's authority to operate the equipment.

This device complies with Part 15 of the FCC Rules and Industry Canada licence-exempt RSS standard(s). Operation is subject to the following two conditions:

(1) this device may not cause harmful interference, and (2) this device must accept any interference received, including interference that may cause undesired operation.

**NOTE:** This device complies with Part 15 of the FCC Rules. Operation is subject to the following two conditions: (1) this device may not cause harmful interference, and (2) this device must accept any interference received, including interference that may cause undesired operation.

changes or modifications not expressly approved by the party responsible for compliance could void the user's authority to operate the equipment. This equipment has been tested and found to comply with the limits for a Class B digital device, pursuant to Part 15 of the FCC Rules. These limits are designed to provide reasonable protection against harmful interference in a residential installation. This equipment generates, uses and can radiate radio frequency energy and, if not installed and used in accordance with the instructions, may cause harmful interference to radio communications. However, there is no guarantee that interference will not occur in a particular installation.

If this equipment does cause harmful interference to radio or television reception, which can be determined by turning the equipment off and on, the user is encouraged to try to correct the interference by one or more of the following measures: Reorient or relocate the receiving antenna. Increase the separation between the equipment and receiver. Connect the equipment into an outlet on a circuit different from that to which the receiver is connected. Consult the dealer or an experienced radio/TV technician for help. This equipment complies with FCC radiation exposure limits set forth for an uncontrolled environment. This transmitter must not be co-located or operating in conjunction with any other antenna or transmitter.

## FCC and IC Radiation Exposure Statement:

This equipment complies with FCC and Canada radiation exposure limits set forth for an uncontrolled environment. This transmitter must not be co-located or operating in conjunction with any other antenna or transmitter.

## ISED Regulatory Compliance

This device contains licence-exempt transmitter(s)/receiver(s) that comply with Innovation, Science and Economic Development Canada's licence-exempt RSS(s). Operation is subject to the following two conditions: (1) This device may not cause interference. (2) This device must accept any interference, including interference that may cause undesired operation of the device.

This equipment complies with IC RSS-102 radiation exposure limits set forth for an uncontrolled environment.

This device complies with Part 15 of the FCC Rules. Operation is subject to the following two conditions: (1) this device may not cause harmful interference, and (2) this device must accept any interference received, including interference that may cause undesired operation.



Qualcomm is a trademark of Qualcomm Incorporated, registered in the United States and other countries. aptX is a trademark of Qualcomm Technologies International, Ltd., registered in the United States and other countries. Qualcomm® aptX™ Adaptive audio supports low-latency, robust and high resolution Bluetooth wireless audio.



The Bluetooth® word mark and logos are registered trademarks owned by Bluetooth SIG, Inc. and any use of such marks by Focal is under license. Other trademarks and trade names are those of their respective owners.



Use of the Made for Apple badge means that an accessory has been designed to connect specifically to the Apple product(s) identified in the badge and has been certified by the developer to meet Apple performance standards. Apple is not responsible for the operation of this device or its compliance with safety and regulatory standards. Apple, Apple TV, Apple Watch, iPad, iPad Air, iPad Pro, iPhone, and Lightning are trademarks of Apple Inc., registered in the U.S. and other countries. tvOS is a trademark of Apple Inc. The trademark "iPhone" is used in Japan with a license from Aiphone K.K.



This device complies with Part 15 of the FCC Rules. Operation is subject to the following two conditions: (1) this device may not cause harmful interference, and (2) this device must accept any interference received, including interference that may cause undesired operation.

Markings related to country certifications and manufacturer information are located under the earpads. To access it, you need to remove the earpads and lift the acoustic fabric.

Les marquages relatifs aux certifications pays et information sur le fabricant se trouvent sous les coussinets. Pour y accéder, vous devez enlever les coussinets et soulever le tissu acoustique.

Operation Frequency:	2402MHz to 2480MHz
EIRP or emission power (Max):	4.56dBm (2.86mW)

USB Type-C® and USB-C are registered trademarks of USB Implementers Forum.



Atenção: conforme lei brasileira nº 11.291, a exposição prolongada a ruídos superiores a 85dB pode causar danos ao sistema auditivo. IFT ID: EUFOBA22-16584 - Véase instructivo anexo

Imported in Mexico by EUROTRONICS SA DE CV, GENERAL MARIANO ARISTA 54 INT. NAVE 10 col. argentina poniente MIGUEL HIDALGO, CIUDAD DE MÉXICO C.P.11230 - R.F.C. EUR100525NRA

**Élimination correcte de ce produit.**

Ce marquage indique que ce produit ne doit pas être éliminé avec les autres déchets ménagers au sein de l'UE. Par mesure de prévention pour l'environnement et pour la santé humaine, veuillez le recycler de manière responsable, pour favoriser la réutilisation des ressources matérielles. Pour retourner votre appareil usé, veuillez utiliser les systèmes de retour et de collecte ou contactez le détaillant chez lequel le produit a été acheté. Celui-ci pourra procéder au recyclage du produit en toute sécurité

**Correct elimination of this product.**

This marking indicates that within the EU this product should not be disposed of with other household wastes. To prevent any risk to the environment or human health, please recycle them responsibly to encourage the reuse of material resources. To return your used device, please use the return and collection systems available, or contact the retailer where you purchased the product. They can recycle this product safely.

**Ordnungsgemäße Entsorgung des Produkts.**

Diese Kennzeichnung weist darauf hin, dass dieses Produkt innerhalb der EU nicht mit anderen Haushaltsabfällen entsorgt werden darf.

Als Präventivmaßnahme für die Umwelt und die menschliche Gesundheit muss auf eine verantwortungsbewusste Wiederverwertung zur Förderung der Wiederverwendung von materiellen Ressourcen geachtet werden. Für die Rückgabe von Gebrauchtgeräten verwenden Sie bitte zur Verfügung stehende Rückgabe- und Recyclingsysteme oder wenden Sie sich an den Händler, bei dem Sie das Produkt erworben haben. Letzterer kann das Gerät sicher dem Wertstoffkreislauf zuführen.

**Eliminación correcta de este producto.**

Este símbolo indica que este producto no debe eliminarse con el resto de residuos domésticos dentro de la UE. Con el objetivo de proteger el medioambiente y la salud pública, recicle de forma responsable para favorecer la reutilización de los recursos materiales. Para devolver su aparato usado, utilice los sistemas de devolución y recogida o póngase en contacto con el vendedor del producto. Este podrá proceder al reciclaje del producto de forma totalmente segura.

**Corretto smaltimento di questo prodotto.**

Questa marcatura indica che, nell'UE, questo prodotto non deve essere smaltito insieme agli altri rifiuti domestici. A titolo preventivo per l'ambiente e la salute, deve essere riciclato in modo responsabile per favorire il riutilizzo delle risorse materiali. Per mandare indietro l'apparecchio usato, si prega di utilizzare il sistema di reso e raccolta o di contattare il rivenditore da cui è stato acquistato il prodotto, il quale potrà procedere a riciclare il prodotto in totale sicurezza.



FOCAL.JMLAB UK  
SP1 2LN



PAP

Raccolta differenziata.  
Verifica le disposizioni  
del tuo Comune.



FR



ET



CALES



BAC  
DE  
TRI

Cet appareil  
se recycle

REPRISE  
À LA LIVRAISON



OU

À DÉPOSER  
EN MAGASIN



OU

À DÉPOSER  
EN DÉCHÈTERIE



Points de collecte sur [www.quefairedemesdechets.fr](http://www.quefairedemesdechets.fr)

Scansionare il codice QR per  
informazioni sullo smaltimento  
degli imballaggi  
Scan QR code for information  
on packaging disposal

# BATHYS MG

## Product sheet

Bathys MG embodies the essence of wireless listening, combining high-fidelity sound with active noise cancelling. Using magnesium speaker drivers with 'M'-shaped domes, it delivers natural, dynamic and extremely detailed sound, transforming every listening session into an immersive, captivating experience. With over 30 hours of battery life and a refined design inspired by Focal's high-end headphones, it combines premium materials (genuine leather, magnesium and aluminium) with exceptional comfort. Lightweight and robust, Bathys MG is the ideal companion for everyone in search of sound perfection wherever they go.



### Key points

- Bluetooth® 5.2 portable headphones with active noise cancelling
- Magnesium speaker drivers with 'M'-shaped domes, made in France in the Focal workshops
- Rich, natural, ultra-precise sound reproduction with powerful bass and crystal-clear treble
- USB-DAC mode: high-resolution sound up to 24bits/192kHz
- Over 30-hour battery life in Bluetooth® mode. Fast-charge function offering 5 hours of listening in 15 minutes
- Refined design and premium materials: genuine leather, aluminium, magnesium
- Focal & Naim application: precise EQ adjustment and personalised headphone control
- Lightweight, ergonomic design for travel convenience

Type	Closed-back wireless headphones with active noise cancelling
Bluetooth® technology	5.2 Multipoint
Bluetooth® range	>15m
Bluetooth® frequency band	2402mHz - 2480mHz
Audio codecs	SBC, AAC, aptX™ Adaptive, aptX™
Battery life	30h Bluetooth® Noise Cancelling 35h Jack mode 42h USB-DAC mode
Other functions	Google Fast Pair
Speaker drivers	1½" (40mm) Magnesium speaker drivers with 'M'-shaped domes, made in France
Frequency response	10Hz to 22kHz
Harmonic distortion rate	<0.2% @1kHz
Microphones	8
Weight	0.77lbs (350g)
Carrying case (supplied)	9½" x 8¼" x 2¾" (24 x 21 x 7cm)
Control application	Focal & Naim, iOS and Android compatible
Connections	Bluetooth® / 3.5mm Jack / USB-C® connector



#### Accessories (supplied)

- Rigid carrying case
- 2 cables:
  - 1.2m (3.9ft) Jack cable
  - 1.2m (3.9ft) USB-C® cable
- Quick start guide

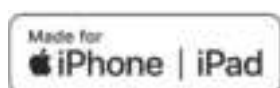

Bluetooth®



Qualcomm®  
aptX™



Google and Google Fast Pair are trademarks of Google LLC.  
The Bluetooth® word mark and logos are registered trademarks owned by Bluetooth SIG, Inc. and any use of such marks by Focal is under license.  
Other trademarks and trade names are those of their respective owners.  
Qualcomm is a trademark of Qualcomm Incorporated, registered in the United States and other countries.  
aptX is a trademark of Qualcomm Technologies International, Ltd., registered in the United States and other countries.  
Use of the Made for Apple badge means that an accessory has been designed to connect specifically to the Apple product(s) identified in the badge and has been certified by the developer to meet Apple performance standards.  
Apple is not responsible for the operation of this device or its compliance with safety and regulatory standards. Apple, Apple TV, Apple Watch, iPad, iPad Air, iPad Pro, iPhone, and Lightning are trademarks of Apple Inc., registered in the U.S. and other countries. tvOS is a trademark of Apple Inc. The trademark "iPhone" is used in Japan with a license from Aiphone K.K.