



## Wireless carplay module

### How to Connect for the Wireless CarPlay

#### Step 1, Connect BOX with Your Car

- Start your car first.
- Make sure to **disconnect** your **iPhone Bluetooth** with the **car screen** or **any other device**.
- Connect The BOX to the USB or Type-C interface of the original car screen with the iPhone interconnection function (CarPlay Function).

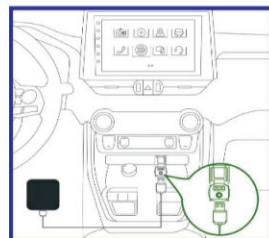

#### Step 2, Identify BOX

- When you see the picture on the right on your car screen, then connect your iPhone Bluetooth to BOX.
- Any questions about the connection, please contact the via the **WhatsApp** for a **perfect solution**.

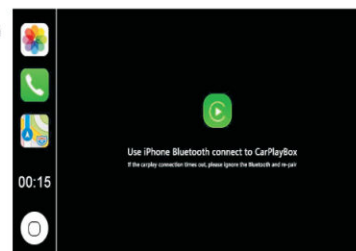

#### Step 3, Bluetooth Pairing

- Turn on your iPhone Bluetooth and WiFi first.
- Before pairing, **Disconnect** the Bluetooth and WiFi between your iPhone and car screen (or any other device).
- Use your iPhone to search for the Bluetooth **"CarPlayBox\_\*\*\*\*"** for pairing (**Only Bluetooth, Not WiFi**). It usually takes 5-10 seconds (It depends on your iPhone and car). Just enjoy the wireless CarPlay after the only one-time pairing.

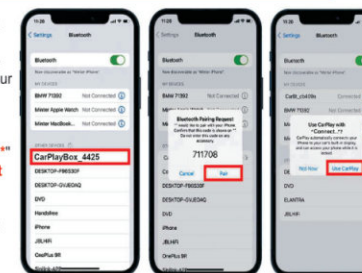

#### Special Note for Connection

- Before Bluetooth Pairing, Make sure to **disconnect** the Bluetooth and WiFi between your iPhone and the **original** car screen or any other device to avoid interference.
- Please use your iPhone search Bluetooth **"CarPlayBox\_\*\*\*\*"** for pairing, and follow the iPhone prompts to connect. (**Only Bluetooth, Not WiFi**)
- If you have any questions about connection or use, please contact **technical support team** via **WhatsApp** for a **solution**.

### OTA Online Upgrade Method

#### Step 1, Disconnect Car USB and Connect WiFi

- First of all, Make sure to **disconnect** the BOX with your Car USB port (or Type-C port).
- DO NOT USE THE CARPLAY PORT BUT ANOTHER USB PORT**
- Use another phone charger or power bank to power. BOX for OTA online upgrade (5V/300mA).
- Connect your iPhone WiFi to the BOX.
- WiFi Name: **CarPlay\_\*\*\*\***, Password: **88888888**.

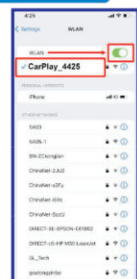

#### Step 2, Enter the IP Address to Upgrade Page

- Enter the **IP Address 192.168.2.1** in your iPhone browser, and enter to the upgrade page.

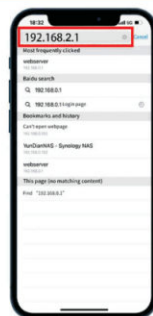

#### Step 3, Check the Version and Upgrade

- You can check the upgrade options, history versions, and upgrade logs on the upgrade page.
- If the device fails, you can download the upgrade log and send it to the **Technical Support Team** via **WhatsApp** to fix the device for you.



#### Special Note for OTA Online Upgrade

- First of all, Make sure to disconnect the BOX with your Car USB or Type-C port.
- DO NOT USE THE CARPLAY PORT BUT ANOTHER USB PORT**
- Use another phone charger or power bank to power.
- If you have any questions about connecting, using and upgrading this device, please contact **Technical Support Team** via **WhatsApp** to get a satisfactory solution.

## **FCC Statement**

This equipment has been tested and found to comply with the limits for a Class B digital device, pursuant to part 15 of the FCC Rules. These limits are designed to provide reasonable protection against harmful interference in a residential installation. This equipment generates, uses and can radiate radio frequency energy and, if not installed and used in accordance with the instructions, may cause harmful interference to radio communications. However, there is no guarantee that interference will not occur in a particular installation. If this equipment does cause harmful interference to radio or television reception, which can be determined by turning the equipment off and on, the user is encouraged to try to correct the interference by one or more of the following measures:

- Reorient or relocate the receiving antenna.
- Increase the separation between the equipment and receiver.
- Connect the equipment into an outlet on a circuit different from that to which the receiver is connected.
- Consult the dealer or an experienced radio/TV technician for help.

Caution: Any changes or modifications to this device not explicitly approved by manufacturer could void your authority to operate this equipment.

This device complies with part 15 of the FCC Rules. Operation is subject to the following two conditions: (1) This device may not cause harmful interference, and (2) this device must accept any interference received, including interference that may cause undesired operation.

### **RF Exposure Information**

The device has been evaluated to meet general RF exposure requirement. The device can be used in portable exposure condition without restriction.