

POWER DUO

BLUETOOTH® TOWER SET

240 WATTS & DEEP BASS

2.0 CHANNEL
MULT-LIGHT MODES
HDMI ARC FOR TV



ITEM NO.: ABT385

Quick Start Guide

1.

WHAT'S INCLUDED

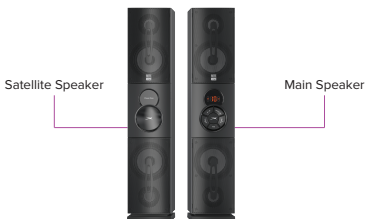

ABT385
Power Duo Bluetooth Tower Speakers



Remote Control



Quick Start Guide

2.

ASSEMBLY

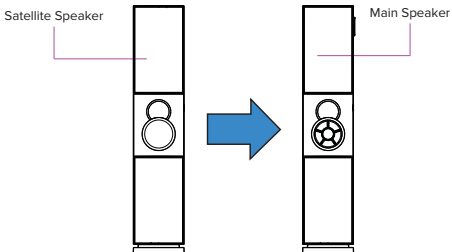

Connect the satellite speaker to the main speaker.

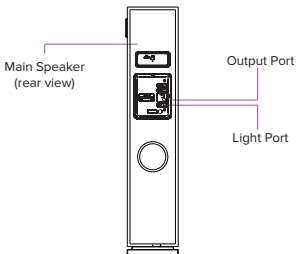

The cable attached to your satellite speaker has two plugs. These plugs connect to the output port and the light port on the main speaker.

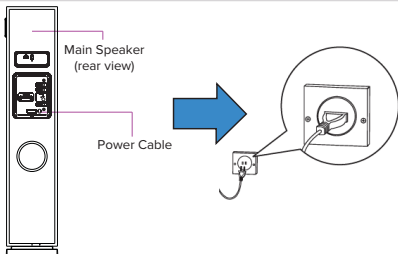

Once your speakers are connected properly, you can insert the power cable on your main speaker into an available power outlet in your home.

3.

AUDIO INPUT

Plug external audio devices into the various ports on on the main speaker.

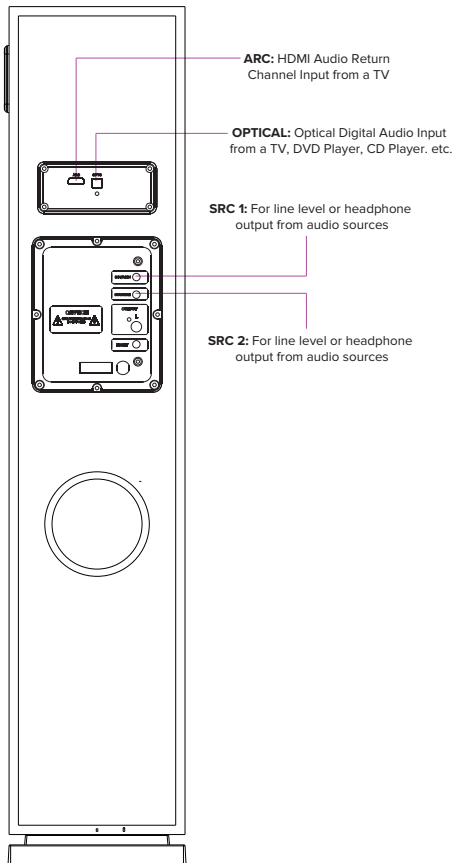

4.

USING THE REMOTE

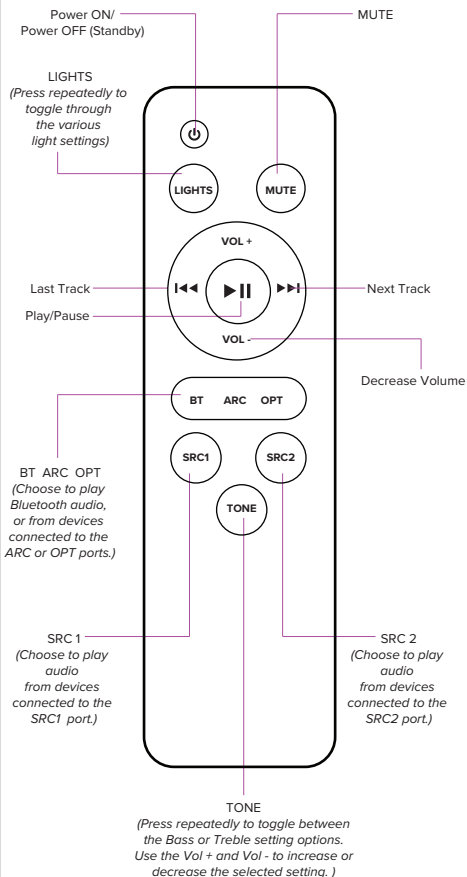

5.

SPEAKER CONTROLS

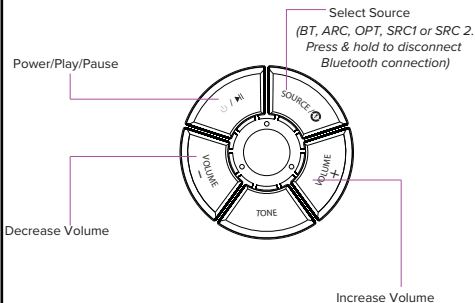

FRONT CONTROL PANEL



Microphones (not included) can be plugged into the Mic1 and Mic2 input jacks so that you can sing along while your favorite songs are playing.

Rotate the ECHO knob to add more vocal effect to your voice.

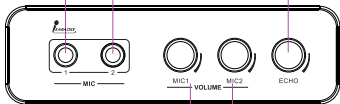

Rotate the Mic1 and Mic2 volume knobs to increase or lower the volume on each microphone.

SIDE CONTROL PANEL

6.

BLUETOOTH PAIRING

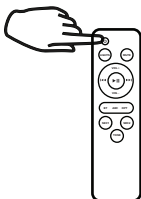

Press the Power ON button on your remote control to power on your speakers.

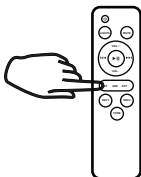

Press the BT button on your remote control to enter Bluetooth mode.

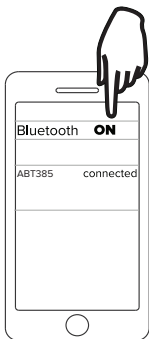

Go to the Bluetooth settings menu on your phone. Make sure that Bluetooth is turned on. Connect to the device listed as "ABT385."

7.

SPEAKER PLACEMENT

For best results you should place one speaker directly to the left of a TV or computer monitor, and the other speaker placed directly to the right of a TV or computer monitor (see below).

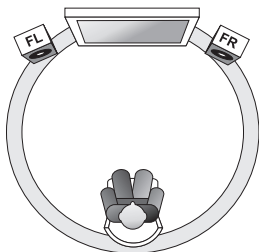
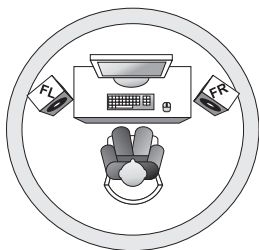
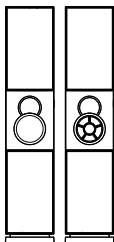

FL-front left
FR-front right

8.

SAFETY PRECAUTIONS

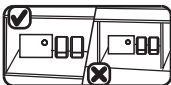
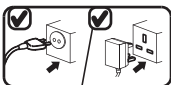

**Having Trouble?
We're here to help!**



Call us 24/7 at 1-855-292-4087
E-mail us at support@alteclansing.com
or visit us at alteclansing.com

9.

FCC STATEMENT

Changes or modifications not expressly approved by the party responsible for compliance could void the user's authority to operate the equipment.

This device complies with Part 15 of the FCC Rules. Operation is subject to the following two conditions: (1) this device may not cause harmful interference, and (2) this device must accept any interference received, including interference that may cause undesired operation.

This equipment has been tested and found to comply with the limits for a Class B digital device, pursuant to Part 15 of the FCC Rules. These limits are designed to provide reasonable protection against harmful interference in a residential installation. This equipment generates, uses and can radiate radio frequency energy and, if not installed and used in accordance with the instructions, may cause harmful interference to radio communications. However, there is no guarantee that interference will not occur in a particular installation.

If this equipment does cause harmful interference to radio or television reception, which can be determined by turning the equipment off and on, the user is encouraged to try to correct the interference by one or more of the following measures:

- Reorient or relocate the receiving antenna.
- Increase the separation between the equipment and receiver.
- Connect the equipment into an outlet on a circuit different from that to which the receiver is connected.
- Consult the dealer or an experienced radio/TV technician for help.

10.

SPECIFICATIONS

Power Audio: 120W (RMS) 2.0 Channel
240 W (PMPO) Total

Driver Units: 5.25" x 4 + 2.25" x 4

Frequency Response: *Satellite:* 120Hz-20KHz
Subwoofer: 20Hz-170Hz

Separation: ≥40dB

S/N: ≥70dB

Distortion: ≤0.5% (1K, 1W)

Power Supply: ~120V/60HZ

Dimensions: *Subwoofer:* W172xH830xD343(mm)
Satellite: W172xH830xD343(mm)

This warranty covers the original consumer purchaser only and is not transferable.

This warranty covers products that fail to function properly UNDER NORMAL USAGE, due to defects in material or workmanship. Your product will be repaired or replaced at no charge for parts or labor for a period of one year.

What Is Not Covered by Warranty:

Damages or malfunctions not resulting from defects in material or workmanship and damages or malfunctions from other than normal use, including but limited to, repair by unauthorized parties, tampering, modification or accident.

To Obtain Warranty Service and Troubleshooting Information:

Call 1-855-292-4087 or Visit our website at www.alteclansing.com.

To receive Warranty service along with the name and address of an authorized product service center, the original consumer purchaser must contact us for problem determination and service procedures. Proof of purchase in the form of a bill of sale or receipted invoice, evidencing that the Product is within the applicable Warranty period(s), MUST be presented in order to obtain the requested service. It is your responsibility to properly package and send any defective products along with a dated copy of proof of purchase, a written explanation of the problem, and a valid return address to the authorized service center at your expense. Do not include any other items or accessories with the defective product. Any products received by the authorized service center that are not covered by warranty will be returned unrepaid.

NO WARRANTIES, WHETHER EXPRESS OR IMPLIED, INCLUDING, BUT NOT LIMITED TO, ANY IMPLIED WARRANTIES OF MERCHANTABILITY OR FITNESS FOR A PARTICULAR PURPOSE, OTHER THAN THOSE EXPRESSLY DESCRIBED ABOVE SHALL APPLY. DISTRIBUTOR FURTHER DISCLAIMS ALL WARRANTIES AFTER THE EXPRESS WARRANTY PERIOD STATED ABOVE. NO OTHER EXPRESS WARRANTY OR GUARANTY GIVEN BY ANY PERSON, FIRM OR ENTITY WITH RESPECT TO THE PRODUCT SHALL BE BINDING ON DISTRIBUTOR. REPAIR, REPLACEMENT, OR REFUND OF THE ORIGINAL PURCHASE PRICE - AT DISTRIBUTOR'S SOLE DISCRETION -ARE THE EXCLUSIVE REMEDIES OF THE CONSUMER. IN NO EVENT WILL DISTRIBUTOR, ITS MANUFACTURERS, OR SAKAR INT. BE LIABLE FOR ANY INCIDENTAL, DIRECT, INDIRECT, SPECIAL, PUNITIVE OR CONSEQUENTIAL DAMAGES (SUCH AS, BUT NOT LIMITED TO, DAMAGES FOR LOSS OF PROFITS, BUSINESS, SAVINGS, DATA OR RECORDS) CAUSED BY THE USE, MISUSE OR INABILITY TO USE THE PRODUCT. EXCEPT AS STATED HEREIN, NO OTHER WARRANTIES SHALL APPLY. NOTWITHSTANDING THE FOREGOING, CONSUMER'S RECOVERY AGAINST DISTRIBUTOR SHALL NOT EXCEED THE PURCHASE PRICE OF THE PRODUCT SOLD BY DISTRIBUTOR. THIS WARRANTY SHALL NOT EXTEND TO ANYONE OTHER THAN THE ORIGINAL CONSUMER WHO PURCHASED THE PRODUCT AND IS NOT TRANSFERABLE.

Some countries, states or provinces do not allow the exclusion or limitation of incidental or consequential damages or allow limitations on warranties, so limitation or exclusions may not apply to you. This warranty gives you specific legal rights, and you may have other rights that vary from state to state or province to province. Contact your authorized retailer to determine if another warranty applies. This product is manufactured, distributed and sold by SAKAR International, Inc. All other trademarks are the property of the respective owner, who has not sponsored, endorsed or approved this product.

JUST LISTEN.

The Bluetooth® word mark and logos are registered trademarks owned by the Bluetooth SIG, Inc. and any use of such marks by Sakar International is under license. Other trademarks and trade names are those of their respective owners.