

**IMPORTANT:** FOR YOUR PROTECTION, YOU MUST CAREFULLY READ ALL WARNINGS AND INSTRUCTIONS IN THEIR ENTIRETY PRIOR TO INSTALLATION, OPERATION, SERVICE OR MAINTENANCE. FAILURE TO DO SO CAN RESULT IN DEATH, PERSONAL INJURY AND PROPERTY DAMAGE. If you do not understand these warnings and instructions, or if additional information is desired, please contact Signify [TSC@signify.com](mailto:TSC@signify.com) phone 1-833-744-6439.

- Installation, service and maintenance of luminaires must be performed by a qualified professional and in accordance with all federal, state and local laws, regulations and electrical codes. This professional should be familiar with the construction and operation of this product and any hazards involved. If not qualified, do not attempt installation, service or maintenance.
- To reduce the risk of death, personal injury or property damage from fire, electric shock, falling parts, cuts, abrasions and other hazards, please read all warnings and instructions included with the luminaire, on the luminaire's packaging and affixed to the luminaire itself.
- Maintenance of the luminaires should be performed by person(s) familiar with the luminaire's construction and operation and any hazards involved.



#### WARNING

##### RISK OF FIRE, ELECTRIC SHOCK OR PERSONAL INJURY

- Disconnect or turn off power before attempting any installation, service or maintenance.
- Verify that supply voltage is correct by referencing the luminaire label information.
- Make all electrical and ground connections in accordance with the National Electrical Code (NEC) and any other applicable laws, regulations or codes.
- All wiring connections should be capped with UL-approved wire connectors.



#### WARNING

##### RISK OF FIRE OR PERSONAL INJURY

- Keep combustible materials away from LED/lamp & lens
- Do not operate in close proximity to persons, combustible materials or substances affected by heat or drying.



#### WARNING

##### RISK OF FIRE, ELECTRIC SHOCK OR PERSONAL INJURY

- Wear gloves and safety glasses at all times when removing luminaire from carton, installing, servicing or performing maintenance.
- Avoid direct eye exposure to the light source while it is on.



#### WARNING

##### RISK OF FIRE, ELECTRIC SHOCK OR PERSONAL INJURY

- Allow Led/lamp & lens to cool before handling.
- Do not touch enclosure or light source
- Do not exceed maximum wattage marked on luminaire label.
- Follow all manufacturer's warnings, recommendations, instructions and restrictions for driver type, burning position, mounting locations and replacement.



#### CAUTION

##### RISK OF PRODUCT DAMAGE

- Never connect luminaires and/or components under load with supply voltage turned on.
- Do not mount or support these luminaires in a manner that can cut the outer jacket or damage wire insulation.
- Do not restrict fixture ventilation. Allow for some volume of airspace around luminaire. Avoid covering luminaire with insulation, foam or other material that will prevent convection or conduction cooling.
- Do not exceed luminaire maximum ambient temperature.
- Do not modify the luminaire.
- Only use luminaire in its intended application and location.
- Led products are polarity sensitive. Ensure proper polarity before installation.
- Electrostatic Discharge (ESD) can damage LED. Personal grounding equipment must be worn during all installation and servicing of the luminaire.
- Do not touch individual electrical components as this can cause ESD, shorten LED life, or impact LED performance.
- Some components inside the luminaire may not be serviceable. In the unlikely event your luminaire may require service, stop using it immediately and contact Signify.
- Always read the luminaires complete installation instructions prior to installation for any additional luminaire specific warnings.
- In the case of HID or Fluorescent luminaires, regular re-lamping is required to keep luminaire operating within safe limits
- **Do not install damaged product.** Handling and installing damaged products can potentially increase the risks mentioned In case of damage and/or missing parts upon arrival of the luminaire.
- These instructions do not purport to cover all details or variations in equipment nor to provide every possible contingency to meet in connection with installation, operation or maintenance.
- Please see luminaire specific Installation and Maintenance Instruction for additional warnings or any applicable FCC or regulatory statements. Failure to follow any of these Instructions could void luminaires warranties.

##### Luminaire Maintenance

- Regular luminaire maintenance programs are recommended.
- It is recommended to clean the outside of the luminaire and the refractor/lens.
- Frequency of cleaning will depend on ambient dirt level and minimum light output which is acceptable to user.
- If clean water is not sufficient for cleaning, use a neutral, synthetic, not-scratching and not-abrasive cleaning substance.
- Never use alkaline and/or acetous cleaning substances.
- Make sure that the cleaning substance is carefully removed by rinsing with lots of clean water.
- Signify recommends using a cleaning solution that has a PH between 5 and 8.
- Recycle: For information on how to recycle electronic products and components, please visit [www.epa.gov](http://www.epa.gov).

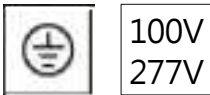
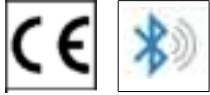

The luminaire should be positioned so that prolonged staring into the luminaire at a distance closer than 1.3ft is not expected



Connect the battery for luminaire operation

1



2



3

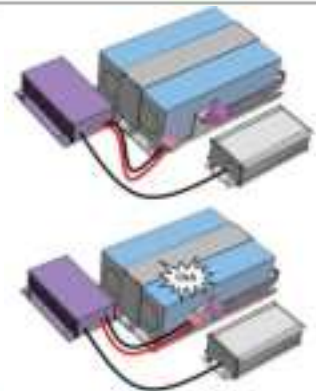

This luminaire must be installed by qualified personnel only



Disconnect power, battery and panel before servicing



Use gloves to install/service the luminaire



Always follow this mounting instructions to fix the luminaire



Never modify the luminaire nor the fixation locations for installation Risk of



accident due to incorrect tightening torque

## ① Dimensions

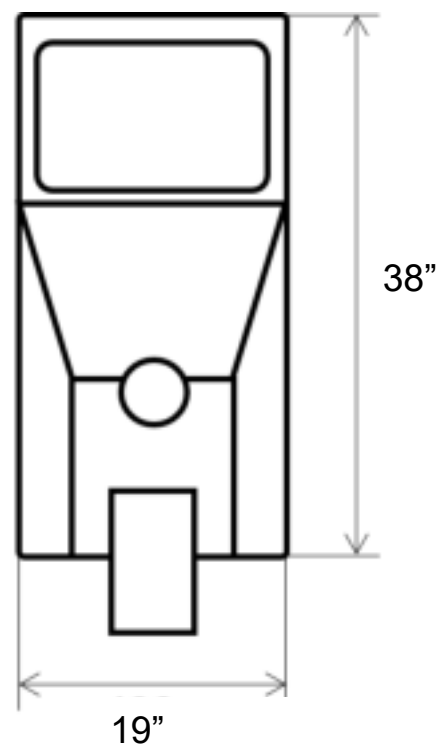
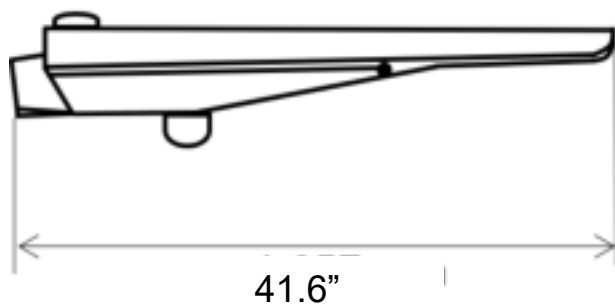

Weight	
Hybrid with 12Ah battery	55.2 lbs
Hybrid with 18Ah battery	59.6 lbs



## ① Effective Projected Area - EPA

		Tilt Angle			
		0°	5°	10°	15°
Mounting	Post-Top	0.834 ft <sup>2</sup>	0.875 ft <sup>2</sup>	1.014 ft <sup>2</sup>	1.612 ft <sup>2</sup>
	Side Entry	0.806 ft <sup>2</sup>	0.896 ft <sup>2</sup>	1.526 ft <sup>2</sup>	—

## ① Recommended luminaire cleaning

Cleaning interval months	Pollution category
12	High pollution
24	Low pollution
36	Clean environment





For optimal performance of the luminaire contact your local SIGNIFY employee for solar sizing and configuration.

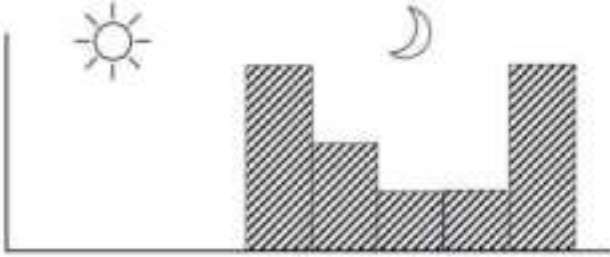

The installation of the luminaire is not recommended under these conditions:

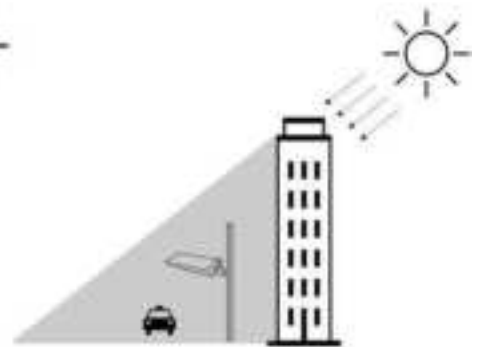
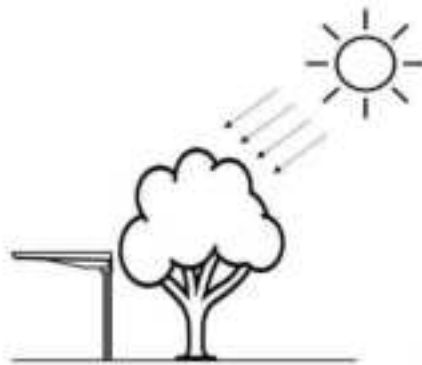

The luminaire performance and battery charging can be affected by external parameters.

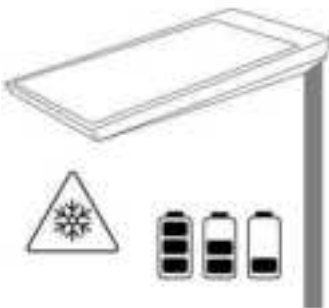

Additional photovoltaic vertical panels can be fixed to the pole. Contact your local SIGNIFY employee for further information.

911401822202

200Wp Vertical Panel Subsystem Vmpp 36V

912300058711

Kit for installation of the PV Vertical Panel

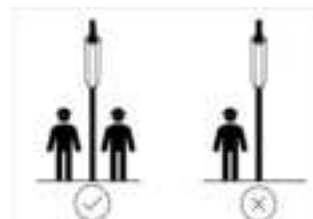

Please, refer to the specific *Vertical Panel Mounting Instructions* when ordering this option.

## ① Spigot fixation

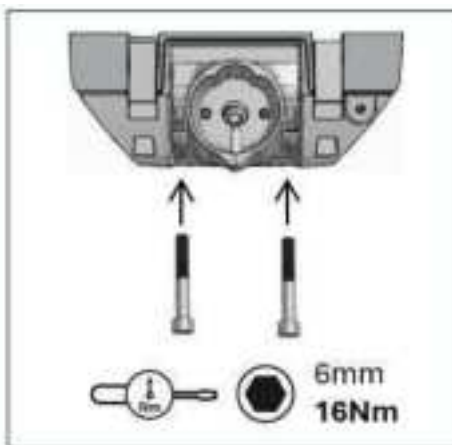
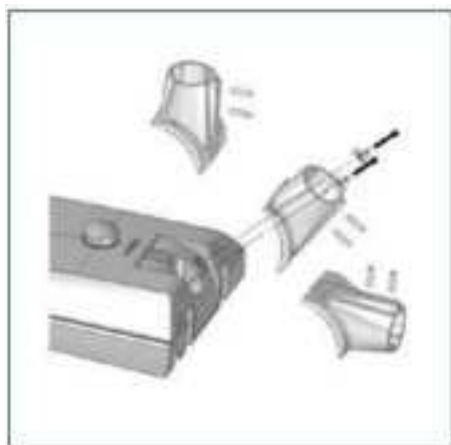

## ① Luminaire orientation

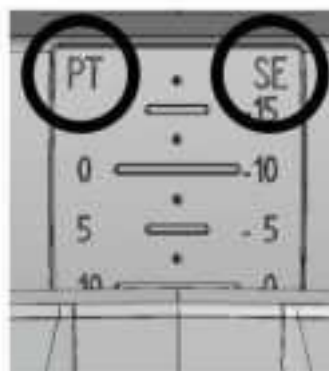
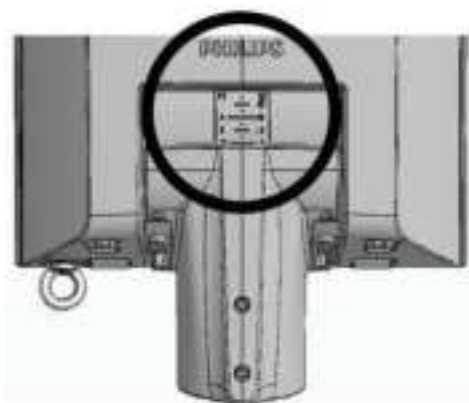

### Post Top:



20°
17,5°
15°
12,5°
10°
7,5°
5°
2,5°
0°

### Side Entry:



10°
7,5°
5°
2,5°
0°
-2,5°
-5°
-7,5°
-10°
-12,5°
-15°
-17,5°
-20°

## ⚠ Spigot into pole

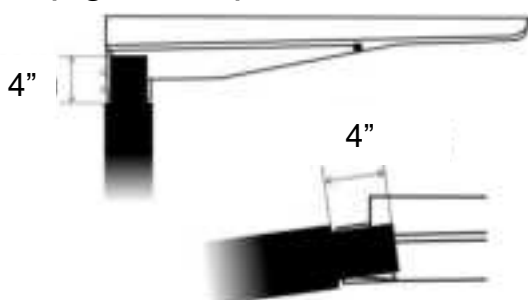

## ⚠ Open luminaire only if base is supported or if luminaire is installed on the pole





## DISCONNECT POWER BEFORE SERVICING

### Mains connection

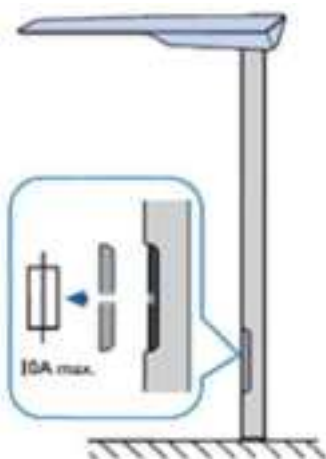
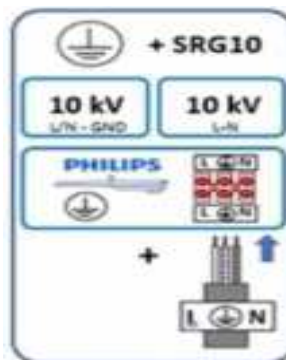
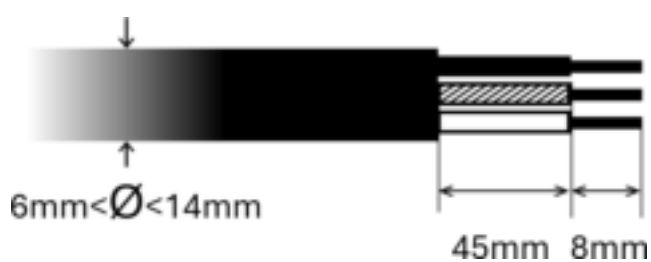
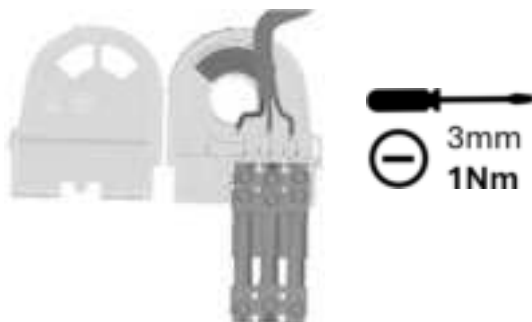



## 1 Labelling

Watch out to the installation date. The battery is 70% level charged when leaving factory. Depending on storage time and ambient temperature, the battery can lose some charge.



The labels in the luminaire contain a QR code. For any contact with SIGNIFY regarding the product, please scan the QR code and keep it for reference.

## 1 Service Tag



To get an overview of all spare parts, service instructions and battery charging, please refer to detailed instructions in the Service Manual available via the SIGNIFY Service tag apps (Android and iOS).

© 2020 Signify Holding B.V. All rights reserved. This document is provided under a Creative Commons license. You are free to share and adapt the content of this document, but you must give appropriate credit to Signify Holding B.V. and indicate if changes were made. You may not use the content for commercial purposes without the prior written permission of Signify Holding B.V. For more information, please visit <https://creativecommons.org/licenses/by-sa/4.0/>.

**GENLYTE**  
SOLUTIONS  
a Signify business

Signify North America Corp.  
4700 Greenleaf Drive, Suite 100  
Fremont, CA 94538  
Telephone: (510) 595-6000  
Fax: (510) 595-6001  
Website: [www.signify.com](http://www.signify.com)

Signify Europe Ltd.  
1000 The Quadrant  
Milton Keynes, MK14 6LE  
United Kingdom  
Telephone: (44) 1908 500000  
Fax: (44) 1908 500001  
Website: [www.signify.com](http://www.signify.com)