

# Ovalis - Connected Blind Control Switch

## Device user guide

Information about features and functionality of the device.

10/2022

# Legal Information

The Schneider Electric brand and any trademarks of Schneider Electric SE and its subsidiaries referred to in this guide are the property of Schneider Electric SE or its subsidiaries. All other brands may be trademarks of their respective owners.

This guide and its content are protected under applicable copyright laws and furnished for informational use only. No part of this guide may be reproduced or transmitted in any form or by any means (electronic, mechanical, photocopying, recording, or otherwise), for any purpose, without the prior written permission of Schneider Electric.

Schneider Electric does not grant any right or license for commercial use of the guide or its content, except for a non-exclusive and personal license to consult it on an "as is" basis. Schneider Electric products and equipment should be installed, operated, serviced, and maintained only by qualified personnel.

As standards, specifications, and designs change from time to time, information contained in this guide may be subject to change without notice.

To the extent permitted by applicable law, no responsibility or liability is assumed by Schneider Electric and its subsidiaries for any errors or omissions in the informational content of this material or consequences arising out of or resulting from the use of the information contained herein.

---

# Table of Contents

Safety information .....	5
Ovalis - Connected Blind Control Switch.....	6
For your safety .....	6
About the device.....	6
Installing the device .....	7
Pairing the device .....	7
Configuring the device .....	8
Selecting the device location.....	8
Renaming the device .....	8
Identifying the device .....	9
Setting the default run time .....	9
Shutter calibration .....	10
Removing the device from Wiser system .....	10
Resetting the device .....	11
Using the device.....	11
Operating the device manually .....	11
Opening/Closing the shutter using app .....	12
Setting up a schedule.....	12
Moments .....	13
Automation.....	16
LED Indication.....	21
Troubleshooting .....	21
Technical Data .....	22





# Safety information

## Important information

Read these instructions carefully and look at the equipment to become familiar with the device before trying to install, operate, service, or maintain it. The following special messages may appear throughout this manual or on the equipment to warn of potential hazards or to call attention to information that clarifies or simplifies a procedure.



The addition of either symbol to a “Danger” or “Warning” safety label indicates that an electrical hazard exists which will result in personal injury if the instructions are not followed.



This is the safety alert symbol. It is used to alert you to potential personal injury hazards. Obey all safety messages that accompany this symbol to avoid possible injury or death.

### **DANGER**

**DANGER** indicates a hazardous situation which, if not avoided, **will result in** death or serious injury.

**Failure to follow these instructions will result in death or serious injury.**

### **WARNING**

**WARNING** indicates a hazardous situation which, if not avoided, **could result in** death or serious injury.

### **CAUTION**

**CAUTION** indicates a hazardous situation which, if not avoided, **could result in** minor or moderate injury.

### **NOTICE**

NOTICE is used to address practices not related to physical injury.

# Ovalis - Connected Blind Control Switch



S3X0567W

## For your safety

### **⚡⚠ DANGER**

#### **HAZARD OF ELECTRIC SHOCK, EXPLOSION, OR ARC FLASH**

Safe electrical installation must be carried out only by qualified electrical personnel. Qualified electrical personnel must prove profound knowledge in the following areas:

- Connecting to installation networks
- Connecting several electrical devices
- Laying electrical cables
- Safety standards, local wiring rules, and regulations

**Failure to follow these instructions will result in death or serious injury.**

## About the device

You can use the Connected Blind Control Switch (hereinafter referred to as **blind control switch**) to control one blind or roller shutter motor that is equipped with an end position switch.

## Control options

**Home control:** To control the blind control switch through the Wiser app you will need the **Wiser Hub**.

**Direct operation:** The blind control switch can always be controlled directly on-site. You can also connect it with mechanical double push-buttons.

## Functions



- Protection of the motor against damage.
- Operating with extension units (mechanical double push-button).

## Installing the device

Refer to the installation instructions supplied with this product.

## Pairing the device

Using the Wiser Home app, pair your blind control switch with the **Wiser Hub** to access and control the blind control switch. Follow the steps to pair the blind control switch:

1. On the Home page, tap  icon.
2. Tap **Devices** >  icon and **Shutters > 1-Gang Switch > Next**.  
**NOTE:** The next screen shows the joining process of the blind control switch.
3. Short press the push button 3 times and make sure that the LED blinks amber.

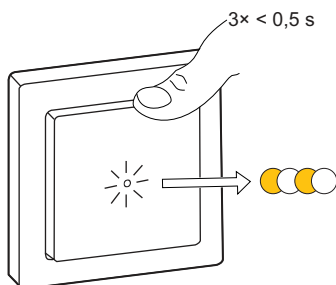

4. Wait for a few seconds until the LED turns green. You can also see in the app that the device is joined.

**NOTE:** If the LED is blinking green and red, see the instructions by tapping the link **LED blinking green and red?**.

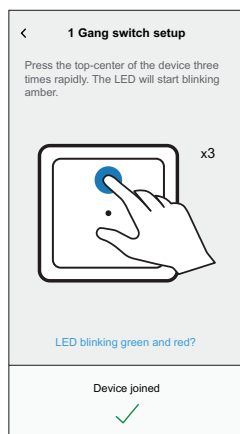

5. Tap **Next** to enter the name of the device and assign the device to a new room or an existing room.

The blind control switch is now listed under **All** devices.

## Configuring the device

### Selecting the device location

Using the Wiser Home app, add the blind control switch to any room (such as living room, bedroom, kitchen etc).

1. On the Home page, tap  icon.
2. Tap **Devices > Shutters > Blind control switch > Location (A)** to assign the blind control switch to an existing room or a new room (B) and tap **Submit**.

**NOTE:** Blind control switch is the name given to the device by the user. Any name can be assigned when pairing with the **Wiser Hub**.

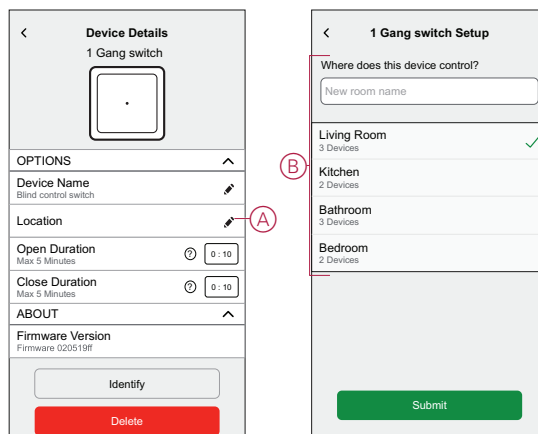

### Renaming the device

Rename the device using the Wiser Home app.

1. On the Home page, tap  icon.
2. Tap **Devices > Shutters > Blind control switch > Device Name (A)** to rename the device.

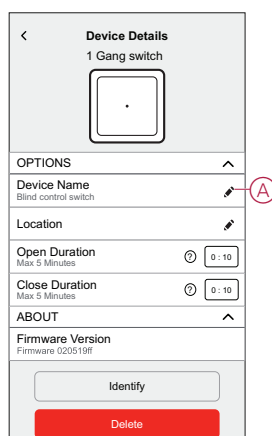

## Identifying the device

Using the Wiser Home app, identify the blind control switch among the devices available in a home.

1. On the Home page, tap  icon.
2. Tap **Devices > Shutters > Blind control switch > Identify (A)**.

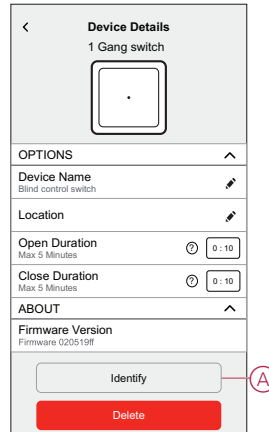

The status LED blinks red and the shutter opens/closes gradually, upon successful identification of the blind control switch.

3. Tap **OK** to finish identifying the device.

## Setting the default run time

Each shutter motor varies in the time it takes to complete the opening/closing movement (i.e., edge to edge). Therefore, the opening/closing time of the shutter must be determined in the app.

To determine the default run time, manually open/close the shutter and record the time it takes to fully open/close the shutter.

1. On the Home page, tap  icon.
2. Tap **Devices > Shutters > Blind control switch**.
3. Tap **Open duration/Close duration (A)** and enter the recorded shutter opening/closing time.

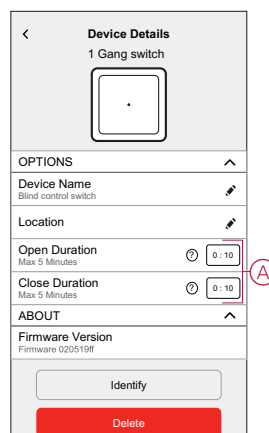

## Shutter calibration

The blind control switch is supplied in an uncalibrated state. Each shutter motor varies in the time it takes to complete the opening/closing movement (i.e., edge to edge).

1. Upon setting the default run time, go to the Home page, tap **All** and find the device.
2. On the control panel page, drag the sliding bar up/down to set the desired shutter opening percentage (A).

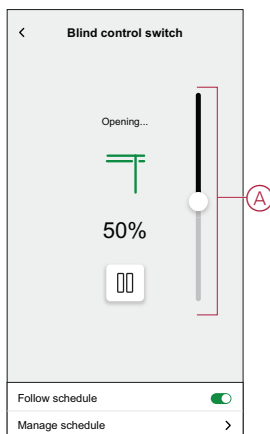

The shutter opens completely and then it reaches to the desired position set in step 2. The shutter is now calibrated.

**IMPORTANT:** Do not use the shutter either manually or on the app during calibration to avoid interruption.

## Removing the device from Wiser system

Using the Wiser app, you can remove the blind control switch from the system. Follow the steps to remove the device:

1. On the Home page, tap  icon.
2. Tap **Devices > Shutters > Blind control switch > Delete** (A).

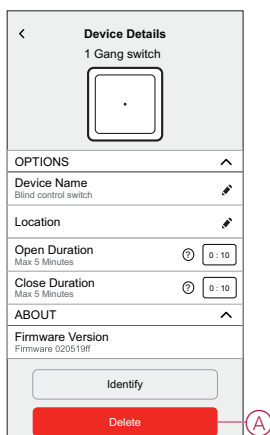

### NOTE:

- Removing the device will reset the blind control switch. The LED starts blinking amber indicating that the blind control switch is ready for pairing.
- If there is a problem while pairing or resetting the blind control switch, refer to [Resetting the device](#), page 11.

## Resetting the device

You can reset the device to factory default manually.

Short-press the push button three times ( $<0.5$  s) and then long-press the push button once ( $>10$  s).

The LED blinks red after 10 s, and then release the push button.

Upon successful reset, the LED stops blinking. Then, the device restarts and blinks green for a few seconds.

**NOTE:** After reset, the LED turns amber indicating that it is ready for pairing.

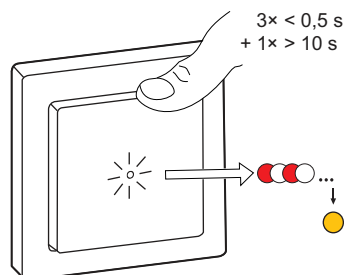

## Using the device

### Operating the device manually

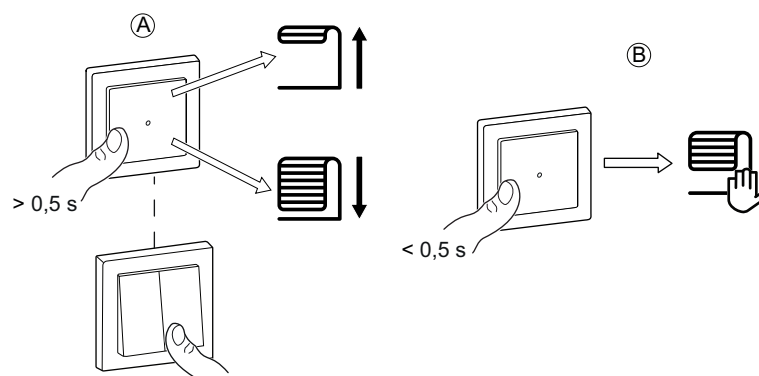

You can operate the shutter manually using the push button.

- Press the push button  $>0,5$  s on the device or extension unit to operate the device gradually (A).
  - Press ( $\wedge$ ) to open the blind.
  - Press ( $\vee$ ) to close the blind.
- Short press  $<0,5$  to stop the moving blind (B).



## Opening/Closing the shutter using app

Follow the steps to open/close the shutter:

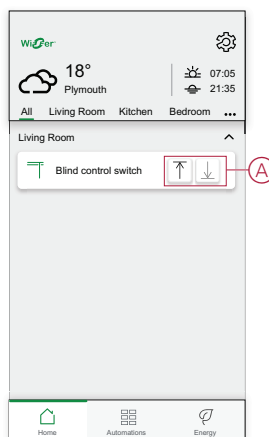

1. Go to the Home page, tap **All** and find the device.
2. Tap   icon (A) to open/close the shutter.





## Setting up a schedule

The devices can be fully controlled by schedule. Once the schedule is set, the devices operates at a given time.

Follow the steps to create a schedule:

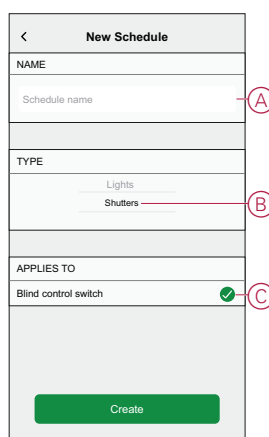
1. On the **Home** page, tap  icon.
2. Go to **Schedules** and then tap  icon to create a schedule.
3. Enter the name of the schedule (A).
4. In the **TYPE** menu, select **Shutters** (B).
5. In the **APPLIES TO** menu, select **Blind control switch** (C) from the listed devices.



6. Tap **Create** to setup the events.
7. Tap  icon to add an event such as **STATE** (shutter opening/closing) and **WHEN** ( sunrise/sunset or specific time range).
8. Tap **Set** to save the schedule.



## Moments

Moment allows you to group multiple actions that are usually performed together. By using the Wiser Home app, you can create moments based on your needs.

### Creating a moment

Follow the steps to create a moment:

1. On the **Home** page, tap  icon.
2. Go to **Moments** and then tap  icon to create a moment.
3. Enter the name of the moment (A).

**TIP:** You can choose the cover image that represents your moment by tapping  icon.

4. Tap **Add actions** (B) to select the list of devices.

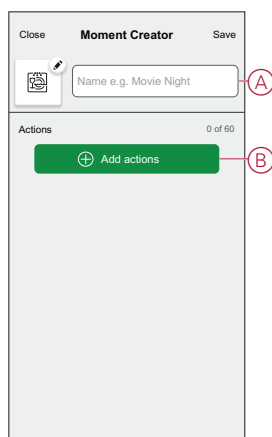

5. In the **Add actions** menu, you can select the devices (C).

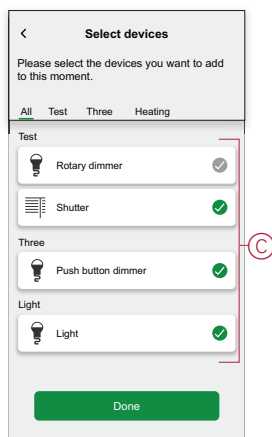

6. Once all the device are selected, tap **Done**.

7. On the **Moment creator** page, tap on the device to set the condition. For example, if you select blind control switch, you can select one of the following conditions.
- Drag the sliding bar up/down to fully open/close the shutter (D, E).
  - Drag the sliding bar to open the shutter as required (F).

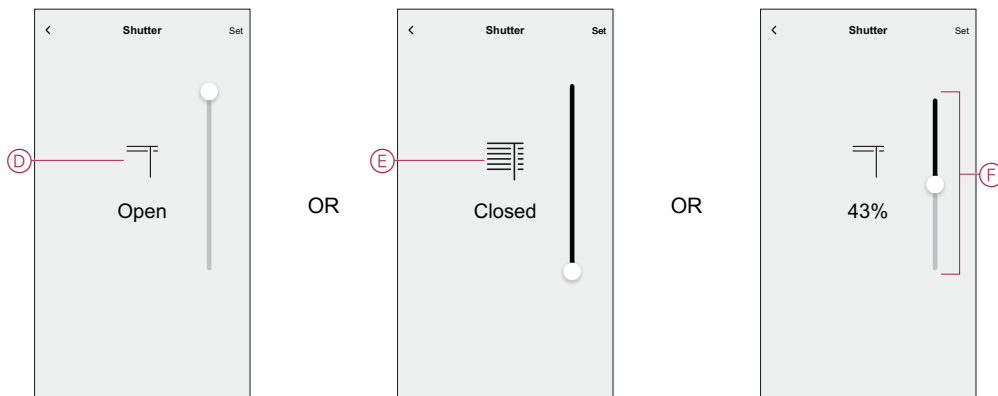



8. Once all conditions are set, tap **Save**.

Once the moment is saved, it is visible on the **Moments** tab. You can tap on the moment to enable it.

## Editing a moment

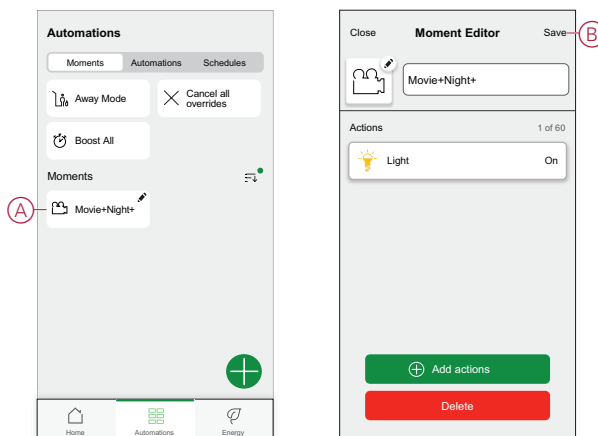

Follow the steps to edit a moment:

1. On the **Home** page, tap  icon.
2. Go to **Moments**, locate the moment you want to edit and tap  (A) icon.
3. On the **Moment Editor** page, you can tap each item to change the settings and tap **Save** (B).



## Deleting a moment

Follow the steps to delete a moment:

1. On the **Home** page, tap  icon.
2. Go to **Moments**, locate the moment you want to delete and tap  (A) icon.
3. On the Moment Editor page, tap **Delete** (B) and tap **Ok**.

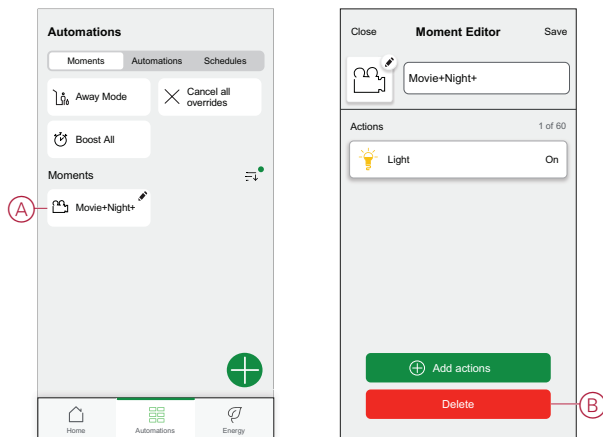



## Automation

An automation allows you to group multiple actions that are usually done together, triggered automatically or at scheduled times. By using the Wiser app, you can create automations based on your needs. This example demonstrates how a device works when the condition is met.

### Creating an automation

Follow the steps to create an automation:

1. On the **Home** page, tap  icon.
2. Go to **Automation** and then tap  icon to create an automation.
3. Enter the name of the automation (A).

**TIP:** You can choose the cover image that represents your automation by tapping  icon.

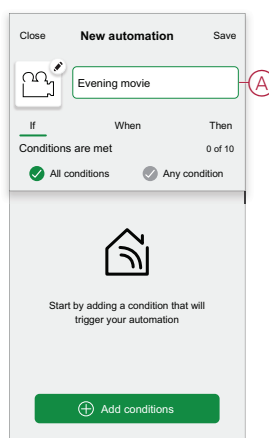

4. Tap **Add a condition** (B).

**NOTE:**

- A Condition will be set to trigger an Automation for example when the shutter is opened, or the motion sensor is detecting the movement.
- You can add one condition to an automation; to add another condition, you must create another automation.

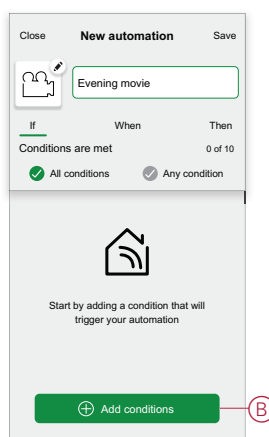

## 5. Select a device that will set the condition.

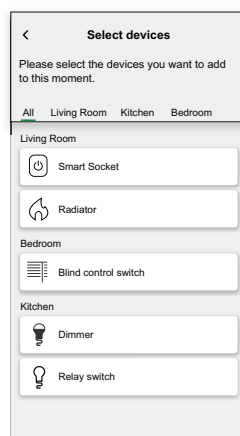

## 6. Select the state of the device that will trigger the automation, for example shutter in Open or Closed state.

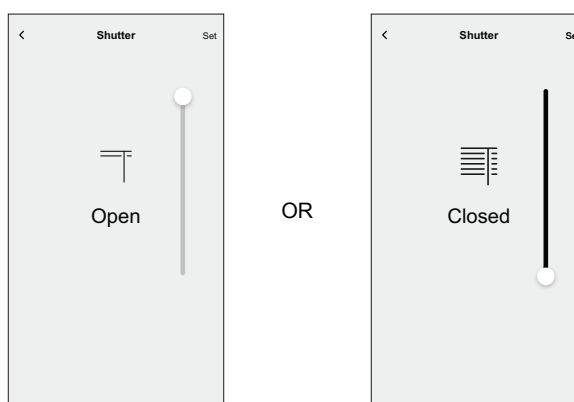
7. Tap **Set** on the upper right corner.

**TIP:** If you want to change the condition, swipe it to the left and tap the bin icon. Then add a new condition with the required parameters.

8. Tap **Action> Add an action**.

**NOTE:** You can add one action in an automation; to add another action, you must create another automation.

## 9. Select the type of action:

- **Control a device** - Select the Device and set the desired state of the Device.
- **Send notification** - You will be notified if the condition is met.
- **Activate a moment** - Select a Moment.

For this example, we will choose **Control a device**.

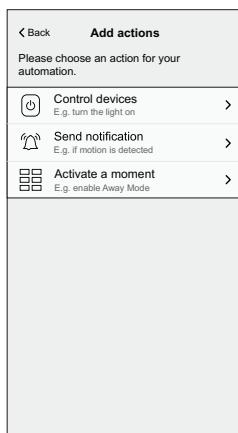
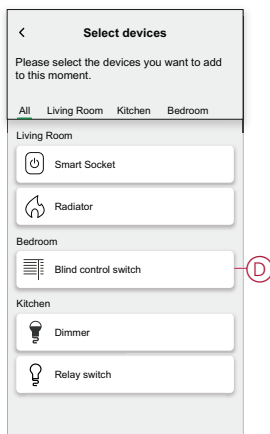
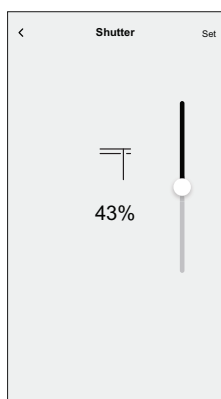
10. Select **Blind control switch** (D) as a device that will trigger an action.11. Set the state, for example the blind control switch opening/closing percentage or fully Open/Closed. Then tap **Set** on the upper right corner.

OR

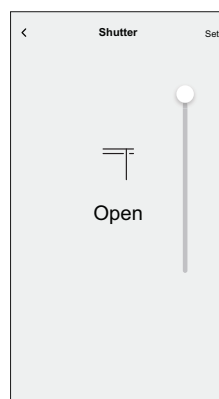

OR

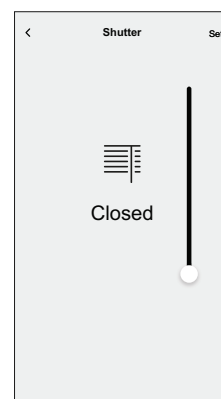

12. Tap **Save**. The saved Automation is displayed on the **Automation** page. Tap the toggle switch (E) on the Automation page to enable/disable the Automation.

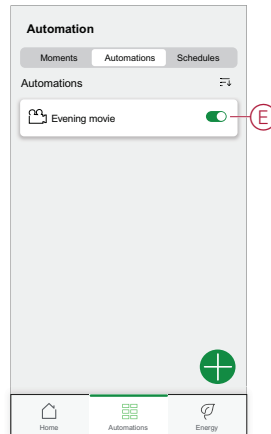

## Editing an automation

Follow the steps to edit an automation:

1. On the **Home** page, tap  icon.
2. Go to **Automation**, tap the automation you want to edit (A).

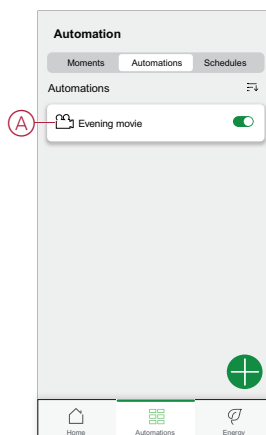

3. On the **Edit automation** page, you can:
  - Change the icon.
  - Rename the automation.
  - Change the condition or action.

- Remove the Condition or Action by swiping it to the left and tapping the **bin** icon (B).

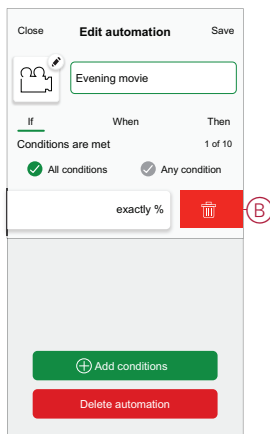

- Add a new condition or action and then tap **Save**.

## Deleting an automation

Follow the steps to delete an automation:

- On the **Home** page, tap icon.
- Go to **Automation**, tap the automation you want to delete (A).

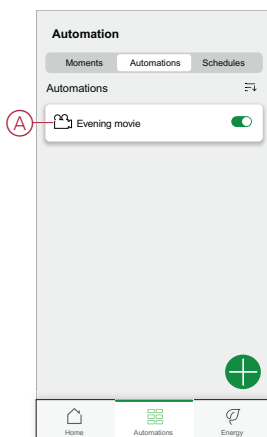

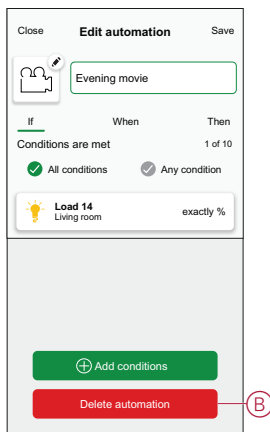

- On the Edit automation page, tap **Delete Automation** (B) and tap **Ok**.







## LED Indication

### Pairing

User Action	LED Indication	Status
Press the push button 3 times	LED blinks amber per second. 	Pairing mode is active for 30 seconds. When pairing is completed, LED glows green for some time before turning Off. 

### Resetting

User Action	LED Indication	Status
Press the push button 3 times and hold it down once for > 10 s.	After 10 s, the LED blinks red. 	The device is in reset mode. It is reset to the factory settings after 10 seconds. The device then restarts and the LED blinks green for a few seconds and then stays amber. 

### Identifying the device

LED Indication	Status
The LED blinks red. 	The shutter opens/closes gradually, upon successful identification of the Blind control switch.

### Different connectivity mode

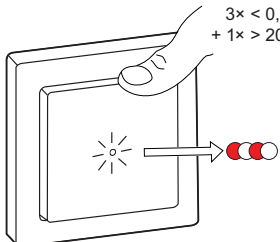
LED Indication	Status
The LED blinks green and red while pairing. 	The device is trying to connect to other connectivity mode. Short press the push button 3 times and then hold for 20 seconds. When the LED blinks red rapidly, release the push button. 

## Troubleshooting

Symptom	Solution
Connected shutter cannot be controlled.	<ul style="list-style-type: none"> <li>Check power supply.</li> <li>Remove power to the blind control switch and then re-connect power again.</li> <li>Check the load.</li> <li>In the case of an external push button, check the wiring.</li> <li>Re-couple devices.</li> </ul>
Shutter is not driving to the desired position.	Reset to factory default settings, refer to <a href="#">Resetting the device</a> , page 11
Shutter is not moving in set time.	Calibrate again.

## Technical Data

Nominal voltage	AC 230 V, 50 Hz		
Nominal power	Load type	Load name	Load value
		Motor	500 W
Standby	Maximum 0.4 W		
Connecting Terminals	Screw terminals for max. 2 x 2.5 mm <sup>2</sup> , 0.5 Nm		
Extension unit	Mechanical Double push-buttons, unlimited number, max. 50 m		
Fuse protection	10 A circuit breaker		
Nominal current	4 A, cosφ = 0.6		
Operating frequency	2405 - 2480 MHz		
Max. radio-frequency power transmitted	< 10 mW		
Communication protocol	Zigbee 3.0 certified		

# Compliance

## Compliance information for Green Premium products

Find and download comprehensive information about Green Premium products, including RoHS compliance and REACH declarations as well as Product Environmental Profile (PEP) and End-of-Life instructions (EOLI).

### General information about Green Premium products

Click the link below to read about Schneider Electric's Green Premium product strategy.

<https://www.schneider-electric.com/en/work/support/green-premium/>

### Find compliance information for a Green Premium product

Click the link below to search for a product's compliance information (RoHS, REACH, PEP and EOLI).

**NOTE:** You will need the product reference number or product range to perform the search.

<https://www.reach.schneider-electric.com/CheckProduct.aspx?cskey=ot7n66yt63o1xblflyfj>

## Trademarks

This guide makes reference to system and brand names that are trademarks of their relevant owners.

- Zigbee is a trademark of the Connectivity Standard Alliance™.
- Apple® and App Store® are brand names or registered trademarks of Apple Inc.
- Google Play™ Store and Android™ are brand names or registered trademarks of Google Inc.
- Wi-Fi® is a registered trademark of Wi-Fi Alliance®.
- Wiser™ is a trademark and the property of Schneider Electric, its subsidiaries and affiliated companies.

Other brands and registered trademarks are the property of their respective owners.

Schneider Electric  
35 rue Joseph Monier  
92500 Rueil Malmaison  
France

+ 33 (0) 1 41 29 70 00

[www.se.com](http://www.se.com)

As standards, specifications, and design change from time to time,  
please ask for confirmation of the information given in this publication.

© 2022 – Schneider Electric. All rights reserved.

DUG\_Ovalis Shutter\_WH-01