

Trouble Shooting

To Ensure Canopy is Flush to Ceiling:

The patent pending metal springs uniquely have saw-toothed edges at the ends. When positioned correctly, it grips to the sides of the recessed can, securely holding the fixture in place. While pushing canopy flush to the ceiling, canopy may need to be rotated slightly to make sure the metal teeth grips onto the sides of recessed can when canopy is flush to ceiling.

To Straighten Fixture:

If necessary turn and manipulate canopy. Or make sure stem and socket cup ring is threaded on straight. If needed, loosen stem and socket ring and re-tighten onto socket to adjust shade position.

To Detach Fixture from Recessed Can:

DO NOT use excessive force to pull down flushmount from the ceiling as entire recessed could be pulled out if springs are not loosened first. With one hand, use wedge tool to pry edge of the canopy from the ceiling while firmly pulling and twisting (if needed) flushmount with other hand. This will flex the springs horizontally and loosen their grip, allowing flushmount to be pulled down.

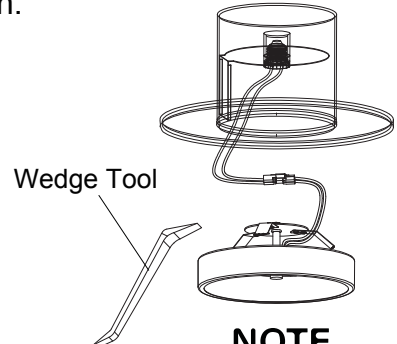

NOTE

Each Flush Mount should be installed in the intended manner as instructed. Not all existing recessed cans will be compatible with Worth Home Products Flush Mount Fixture.

For questions or missing parts please call or email Sales@Worthhp.com (713) 660-0025

Installation Instructions

3. Fixture Connectivity

Connect the orange male and female connectors. Then screw the male (E26) socket into the recessed can.

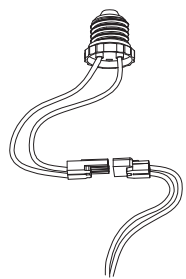

4. To Install Fixture

Insert the metal springs into the recessed can until the metal teeth on the edges of the springs catches onto to the walls of the recessed can. Tuck all the wires into the can prior to covering the entire recessed opening with the fixture canopy.

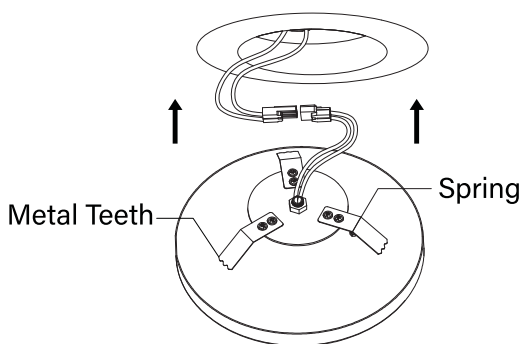

5. To Attach Shade to Semi-Flushmount

Semi-Flushmount having sockets usually have accompanying shades. Mount shades onto fixture by letting socket pass through center opening and threading on decorative socket rings to socket. Make sure rings thread on evenly and catch the socket threadings.

Preparation

Tools Required

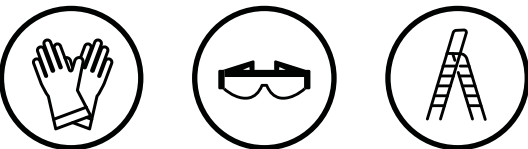

Gloves Safety Goggles Ladder

1. Preparing the Installation

Remove the existing trim and bulb from the housing, revealing the existing socket. Locate the socket in your existing recessed housing and remove any screws and springs attached to the trim cover.

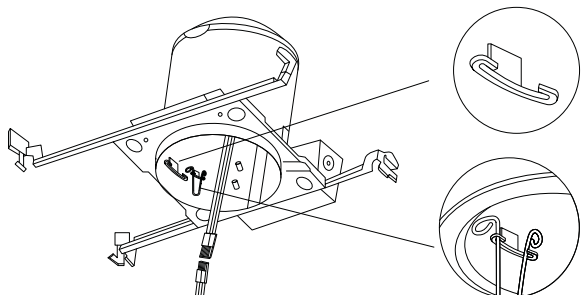

2. Connecting the Socket Adapter

Screw the medium base (E26) socket adapter (A) into the socket in the recessed housing.

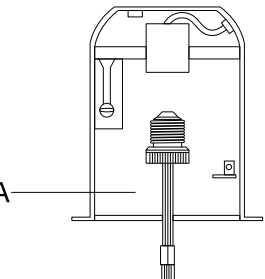

NOTE

For replacment bulbs, use 75 watt maximum, E26/E27 medium bulbs (Not included).

Safety Information

WARNING ⚠

Carefully read and understand the information in this manual before beginning the installation process. Turn off electricity before installation begins and we recommend consulting a licensed electrician.

Install this fixture kit only in luminaires (recessed can fixtures) that have the construction features and dimensions show in the drawings and where the input rating of the recessed can does not exceed the input rating of the luminaire.

Product Description Part

Socket Adapter	A
Recessed Can	B
Connector	C
Spring Clips	D
Canopy	E
Shade*	F
Socket Cup Ring	G

\*Shade May Vary\*

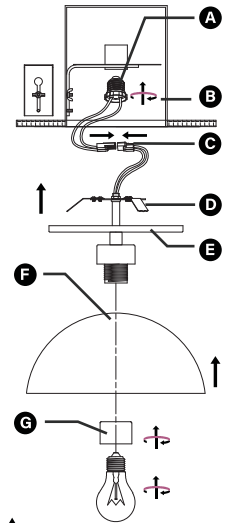

WARNING ⚠

Shut off the power at the circuit breaker or fuse panel before removing the old fixture.

NOTE

Keep your receipt and these instructions for proof of purchase.

worthhome

Sales@worthhp.com

Instant Flush Mount

Medium Base

Thank you for your purchase

We appreciate your business, trust, and confidence in our innovative product line. For over 17 years, Worth Home Products has delivered award winning lighting solutions that install easily and transform decors in minutes.

Visit us online to see our full line of styles and designs.

Set Includes

- Instant Flush Mount Fixture
- Medium Base Socket Quick Connector
- Removable Wedge Applicator

\*PATENT PENDING\*

FOR USE WITH INCANDESCENT RECESSED NON-IC OR IC LUMINAIRES

SUITABLE FOR USE WITH LUMINAIRES WITH 5INCH/6INCH DIAMETER LAMP COMPARTMENT

**WARNING – RISK OF FIRE OR ELECTRIC SHOCK. THIS PRODUCT MUST BE INSTALLED IN ACCORDANCE WITH THE APPLICABLE INSTALLATION CODE BY A PERSON FAMILIAR WITH THE CONSTRUCTION AND OPERATION OF THE PRODUCT AND THE HAZARDS INVOLVED.**

**WARNING –Risk of fire or electric shock. Install this kit only in luminaires that have the construction features and dimensions shown in the photographs and/or drawings.**

Do not make or alter any open holes in an enclosure of wiring or electrical components during kit installation.

**WARNING –To prevent wiring damage or abrasion, do not expose wiring to edges of sheet metal or other sharp objects.**

Installers should examine all parts that are not intended to be replaced by the retrofit kit for damage and replace any damaged parts prior to installation of the retrofit kit.

**WARNING – Risk of fire. Input ratings may need to be determined based on any configuration(s) permitted by the installation instructions. Regardless of the configuration(s) of the retrofit kit, the input ratings of the overall retrofit kit shall not exceed the marked input ratings of the host luminaire.**

This product is rated for damp location. Any installation in outdoor surrounding requires covered porch for installation and far enough distance away from exposure to rain or water spray.