

HYUNDAI

OWNER'S MANUAL

TOWER FAN

Model: HY30ITFANMA

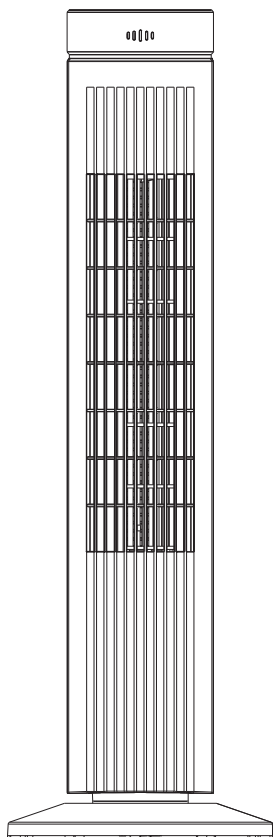

READ AND SAVE THESE INSTRUCTIONS

Attention: Pictures in the IM are for reference only.



GENUINE PRODUCT OF
HYUNDAI CORPORATION

SAFETY INSTRUCTIONS

CAUTION

- Read rules for safe operation and instructions carefully.
- This appliance can be used by children aged from 8 years and above and persons with reduced physical, sensory or mental capabilities or lack of experience and knowledge if they have been given supervision or instruction concerning use of the appliance in a safe way and understand the hazards involved. Children shall not play with the appliance. Cleaning and maintenance shall not be made by children without supervision.
- Never insert fingers, pencils, or any other object through the grille when fan is running.
- Disconnect the fan when moving from one location to another.
- Ensure the fan is on a stable surface when operating to avoid overturning
- Indoor and household use only.

WARNING

- If the power cord is damaged, it must be replaced by manufacturer or its service agent or a similarly qualified person in order to avoid a hazard.
- To protect against the risk of electrical shock, do not immerse the unit, cord or plug in water or other liquid.
- When the appliance is not in use and before cleaning, unplug the appliance from the outlet.
- When the fan is assembled, the rotor blade guard shall not be taken off anymore.



- Correct Disposal of this product

This marking indicates that this product should not be disposed with other household wastes throughout the EU. To prevent possible harm to the environment or human health from uncontrolled waste disposal, recycle it responsibly to promote the sustainable reuse of material resources. To return your used device, please use the return and collection systems or contact the retailer where the product was purchased. They can take this product for environmental safe recycling.

PRODUCT OVERVIEW

Part Figure

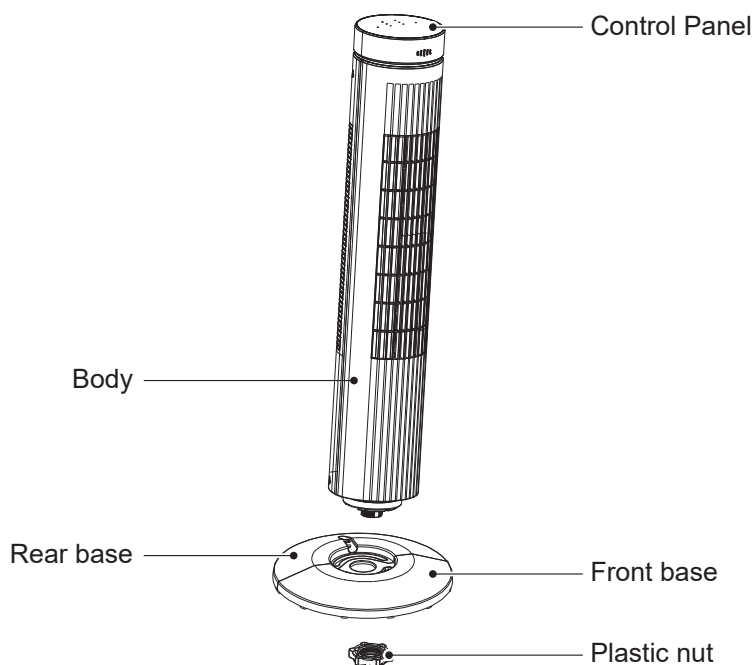

NOTE

All the pictures in this manual are for explanation purpose only. Any discrepancy between the real object and the illustration in the drawing shall be subject to the actual product.

PRODUCT INSTALLATION

Assembly Instructions

NOTE

A screwdriver is not included with the product. We recommend preparing your own screwdriver for a smooth installation experience.

1. Take out the two parts of the base from the box. Insert the two poles of part A into two holes of part B, and insert the two poles of part B into two holes of part A to assemble the base as Fig 1.

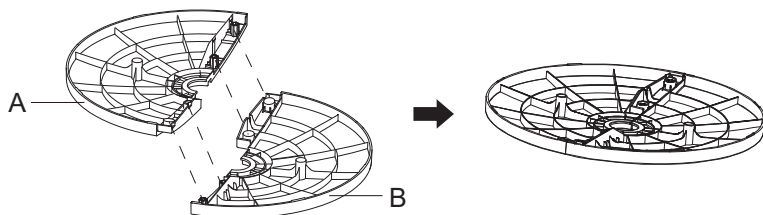

Fig 1

2. Pass the power cord through the slot, then insert the fan body into the base. Fix the fan body on the base with the plastic nut as Fig 2.

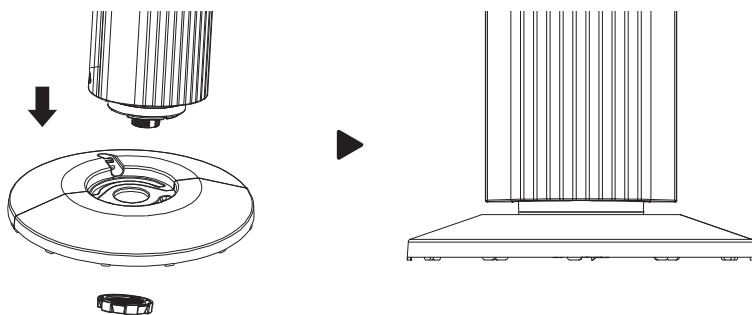
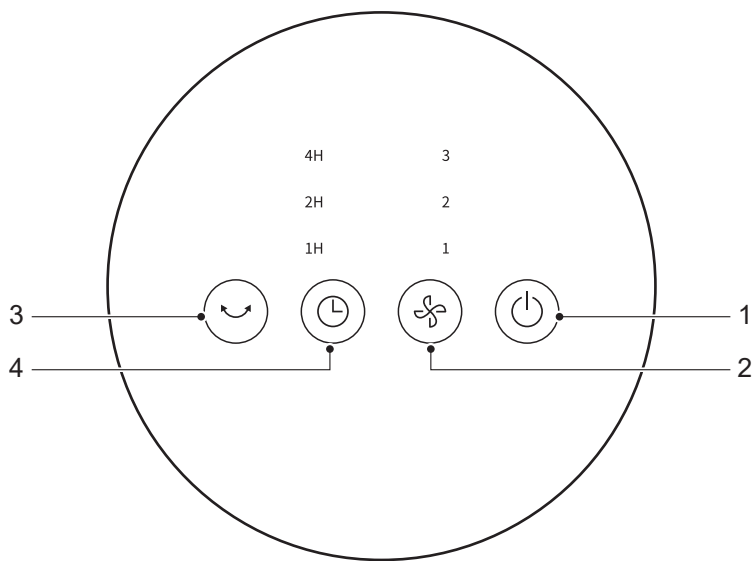





Fig 2

OPERATION INSTRUCTION

Control Panel



No	Button	Function description
1	 ON/OFF	<ul style="list-style-type: none">• Press to switch the fan on/off.
2	 SPEED	<ul style="list-style-type: none">• When the fan starts up, press to cycle through the following fan speed levels: 1-2-3-1.
3	 OSC/ LOUVER	<ul style="list-style-type: none">• In the power-on state, press to select oscillation mode. The lights on the display indicate fan oscillation mode.
4	 TIMING	<ul style="list-style-type: none">• The timer can be set for up to 7 hours.

Remote Control

- The buttons on the remote controller such as OSCILLATION, ON/OFF, DECREASE or INCREASE, TIMER, have identical functions to their corresponding buttons on the unit.
- The remote control operates effectively within 5m in the front of the product and within an angle of 30°.
- The battery contains heavy metals, acid and alkali substances, which threaten human health; waste batteries should be sorted and recycled.

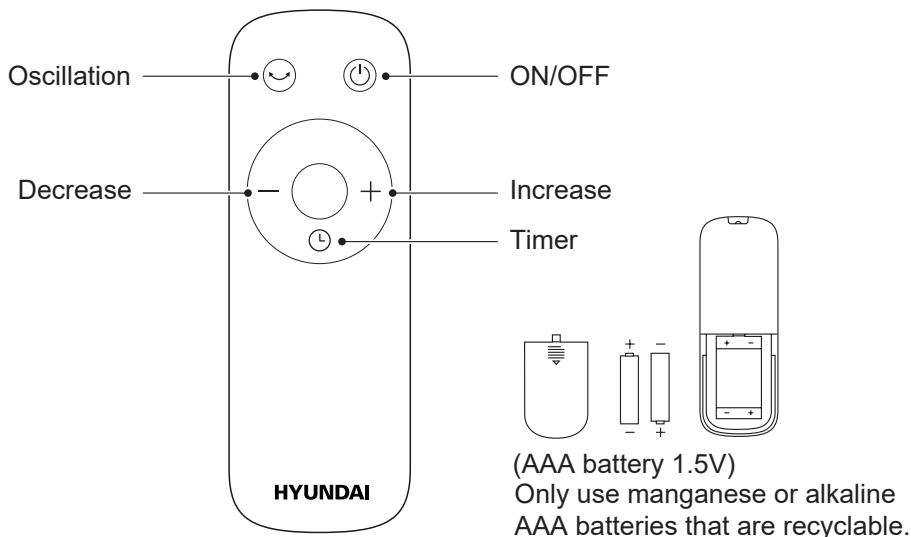

⚠ WARNING

- Use standard or alkaline AAA batteries. DO NOT use rechargeable batteries.
- Do not mix new batteries with old.
- Do not mix alkaline, standard (carbon-zinc) or rechargeable (ni-cad, ni-mh, etc.) batteries.

CLEANING MAINTENANCE

- Be sure to unplug from the electrical supply source before cleaning.
- Use a damp cloth or sponge for general cleaning.
- Remove more persistent dirt with a cloth that is dampened with warm soapy water, and thoroughly remove soap film with a damp cloth. Do not use any solvents (such as thinners), as these may damage the plastic casing.
- Be sure not to make water or other liquid enter inside of the motor.

TROUBLESHOOTING

If the product does not operate or does not operate properly, first check according to the following list. If the reason the product does not operate or does not operate properly is not included in the following list, the product may have failed. At this time, it is recommended to send the product to the dealer for repair.

Problem	Cause	Solution
The machine does not work properly after installed	• The power cable is not plugged in or has poor contact.	Make sure the plug is properly inserted into the outlet.
	• The switch on the body is not turned on.	Turn on the switch on the body.

SPECIFICATIONS

Product Model	HY30ITFANMA
Voltage	220-240V~
Frequency	50Hz
Power	35W

HYUNDAI

Imported/Distributed by Kogan Australia Pty Ltdc
Licensed by HYUNDAI Corporation Holdings, Korea