

Label Printer User Manual

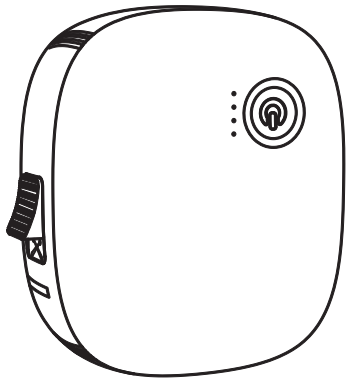

Read this manual carefully before using the product and keep it properly.

Package Contents

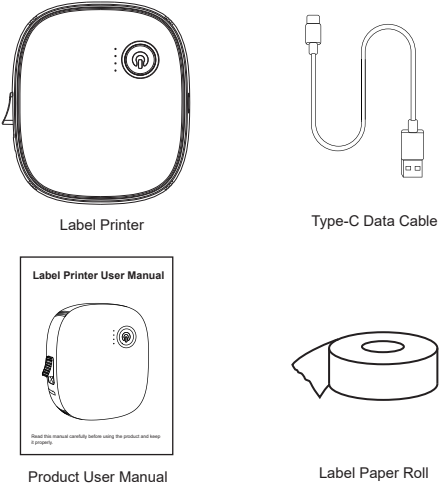

Note: The quantity of label paper varies depending on the purchased package.

Product Overview

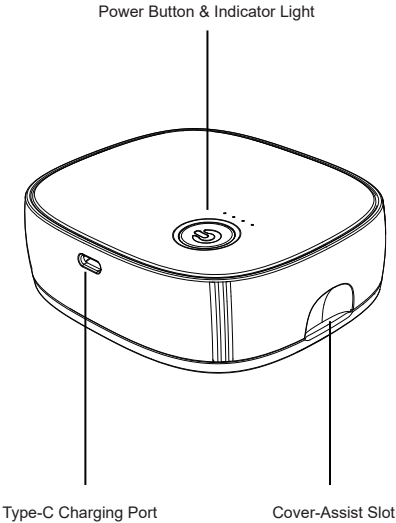
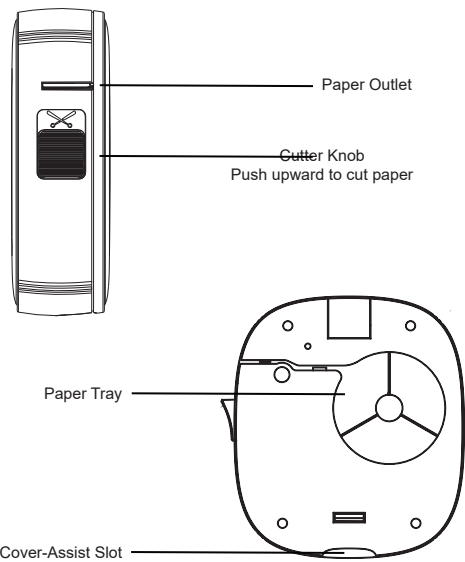

User Guide

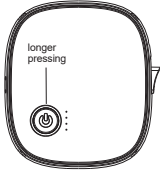

1

Before using this device for the first time, please make sure to charge it fully. When using, please disconnect the charger and press the power button for 3 seconds to turn on/off.

2 App download

You can choose any one of the following three methods.

- iOS users: Open the "App Store" and search for "Printer Mate" to download it.
- Android users: Open "Google Play" and search for "Printer Mate" to download it.
- Turn on the device, double - click the power button, scan the QR code on the paper to download the APP.
- Scan the QR code on the right to download.

3 Adding Device

Make sure your phone's Bluetooth is turned on and open the app. Then, tap "+ Add Device" in the top-right corner of the home screen, or directly select "Printer Mate" below to choose the corresponding device for pairing. Once connected, you can print your desired content.



Change the Paper

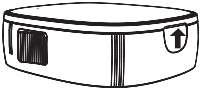

1

Open the cover in the direction indicated by the arrow in the diagram.

2

Place the label paper into the paper tray and align it with the printing channel. Note: Ensure correct orientation as shown in the diagram. Incorrect placement may cause printing failure.

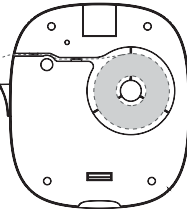

3

After installing the label paper, push the cutter knob upward to trim excess paper. Wait for the knob to retract before removing the cut labels. Do not push the cutter knob during printing to avoid paper jams.

Specifications

Model: AH-P05
Dimensions: 91×31×98 mm
Net Weight: Approx. 159g
Battery Type: Lithium Battery
Input Parameters: 5.0V --- 1.0A
Battery Capacity: 1200mAh
Charging Time: Approx. 150 minutes
Operating Temperature: 0 C~40 C
Wireless Connection: Bluetooth BLE 2.0
Supported Systems: Android 8.0 or iOS 12.0 and above

Troubleshooting

Q1 Device Won't Turn On

A: Low battery, charge immediately.

Q2 Charging Failure

A: Use a compliant charging cable or a 5V/1A adapter. Charge at room temperature (avoid extreme heat or cold).

Q3 Printing Issues

A: Check if the device is powered on. Verify correct label paper installation. Ensure the cover is closed. Let the print head cool down if overheated. Replace empty label rolls. For paper jams, contact support—do not attempt self-repair.

Q4 Bluetooth Connection Failed

A: Ensure Bluetooth is enabled on your phone. Keep the printer nearby. Check for connections to other printers. Confirm no other devices are paired with the printer.

Maintenance

Cleaning the Printer

Regularly use a clean soft cloth or cotton swab to gently wipe the surface of the printer to remove dust and stains. Be careful not to use wet cloths or corrosive detergents to avoid damaging the shell and internal parts of the printer.

Replace the Printing Paper

When the thermal paper is used up or different types of thermal paper need to be replaced, follow the steps to install the thermal paper to replace it. Make sure that the new paper roll is compatible with the printer and is installed correctly. It is recommended to purchase suitable printing paper on the official website.

Maintain the Print Head

The print head of this device is a thermal print head. To avoid overheating and damage to the print head, do not continuously print for a long time. Regularly check whether the print head is dirty or damaged. If so, use a special cleaning tool or cotton swab to gently wipe the print head. Be careful not to use too much force to avoid damaging the print head.

Safety Precaution

- Do not disassemble the internal parts of the printer at will to avoid safety accidents.
- During the working process of the printer, do not touch the print head to prevent burns.
- In order to avoid danger, please do not use the printer in humid, high-temperature, flammable and explosive environments, such as in the bathroom or next to the stove.
- Place the printer in a location that is out of children's reach. This can prevent dangers such as children accidentally pressing the button, randomly plugging and unplugging the power supply, or playing with the printing paper.
- Please use the original charger or a regular charger that meets the charging parameters of this device to charge.
- During use or charging, if you find that the battery is abnormally hot, you should stop using it immediately and disconnect the power supply.
- Please recycle waste batteries properly in accordance with local environmental protection regulations, and do not throw them away at will.

FCC Warnings

This device complies with part 15 of the FCC Rules. Operation is subject to the following two conditions:
(1) This device may not cause harmful interference.
(2) This device must accept any interference received, including interference that may cause undesired operation.

Note:

This equipment has been tested and found to comply with the limits for a Class B digital device, pursuant to part 15 of the FCC Rules. These limits are designed to provide reasonable protection against harmful interference in a residential installation. This equipment generates, uses, and radiates radio frequency energy. If this device is not installed and used in accordance with the instructions, it may cause harmful interference to radio communications. However, there is no guarantee that interference will not occur in a particular installation

If this equipment does cause harmful interference to radio or television reception, the user is encouraged to try to correct the interference by one or more of the following measures.
This interference can be determined by turning the equipment off and on.
1. Reorient or relocate the receiving antenna.
2. Increase the separation between the equipment and receiver.
3. Connect the equipment to an outlet on a circuit different from that to which the receiver is connected.
4. Consult the dealer or an experienced radio/TV technician for help if necessary.

Note:

The Grantee is not responsible for any changes or modifications not expressly approved by the party responsible for compliance. Such modifications could void the user's authority to operate the equipment.

The device has been evaluated to meet general RF exposure requirements.

This equipment complies with FCC's RF radiation exposure limits set forth for an uncontrolled environment. This device and its antenna(s) must not be co-located or in conjunction with any other antenna or transmitter.

