

Warm Tips

The top roller is to adjust Focus

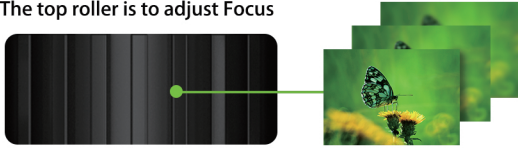

What should I do if the projected image is blurry?

1. Please turn the roller on the top to adjust the focal length until the picture is clear. (with the roller picture above)
2. Please place the projector at an appropriate projection distance, the best recommended distance is 0.8M-1.8M

When connecting with the laptop via HDMI cable, if occurs the below case, please refer to the following instructions:

- 1) With image but no sound. Just enter the Setting of Sound, choose the **“HITV (Intel) display audio”**

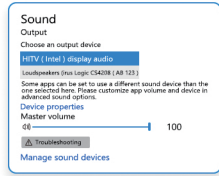

- 2) No Sound and no image. Press the **Win + P** key at the same time, then select **“Copy”** in the popup

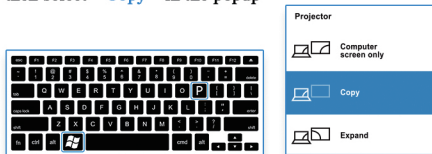

iOS Devices Connect

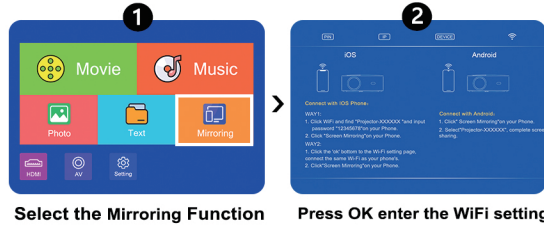

Select the Mirroring Function

Press OK enter the WiFi setting

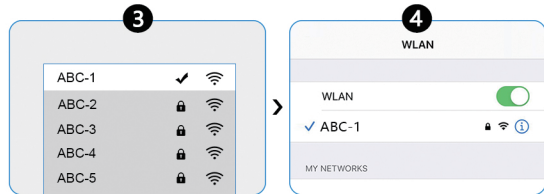

Connect the Projector to your WiFi

Connect Your Phone to the Same WiFi

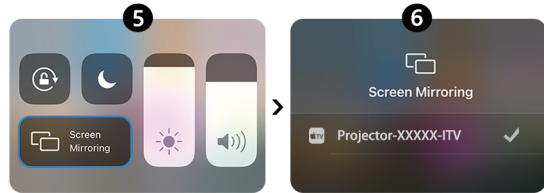

Tap Screen Mirroring on Your Phone

Choose the Projector-XXXXX-ITV

Android Devices Connect

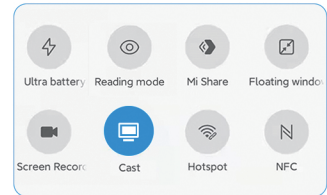
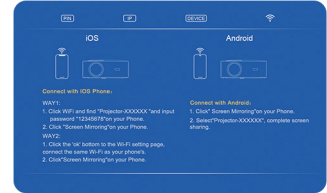
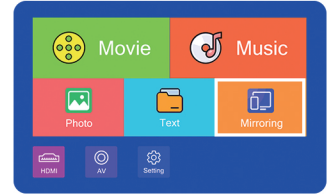

find Multi-Screen/Miracast/Smart View function on your Android devices

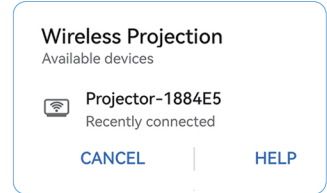

Connect Your Phone to the Same WiFi

HORLAT