



**PADDOCK INDUSTRIAL WET DRY  
VACUUM**

**P/N – PIV70**

**User and Maintenance Manual**



## TABLE OF CONTENTS

INTRODUCTION .....	3
SPECIFICATIONS.....	4
WARNING.....	4
SAFETY MANAGEMENT PROCEDURES.....	5
GENERAL SAFETY .....	5
ELECTRICAL REPAIRS .....	7
EQUIPMENT SAFETY GUIDELINES .....	7
GENERAL INFORMATION & PROPER USES.....	8
OPERATION .....	8
TROUBLESHOOTING.....	10
EXPLODED PARTS DIAGRAM .....	11
WARRANTY INFORMATION .....	12
SUPPORT INFORMATION .....	12



## 1. INTRODUCTION

A powerful, heavy duty, yet affordable industrial wet / dry vacuum. With massive twin motors the Paddock vacuum cleaner will get the job done. Designed as a standalone vacuum or to be run off a range of equipment requiring dust suppression. An economical alternative to Kerrick and Hilti industrial vacs.

### Paddock Industrial Vacuum Cleaner & Dust Extractor

- Supplied as a full kit - ready to use!
- Operates as a wet & dry vacuum
- Massive twin 1200W motors
- Run on a standard household power socket
- Simple to service and maintain

The Paddock industrial vacuum is built for tough dust and water extraction jobs. A heavy-duty polyethylene tank is mounted on a sturdy trolley and frame. Swivel wheels and oversized rear wheels make the vac portable and easy to pull along, even on rough surfaces. The head unit is attached with two large fasteners giving quick access to the filter. When operating as a wet vacuum the tank can be quickly emptied using the external waste removal hose. A simple to use switch panel allows each of the two motors to be operated independently giving varying levels of suction. Supplied with the vacuum kit is a 3m kink resistant vac hose and two heads (1x wet head, 1x dry head). The hose end is an industry standard 40mm diameter which suits many brands of equipment requiring dust extraction. For products not supporting the 40mm connection a simple vacuum adapter can be used. The other end of the hose is a quick lock fitting that is securely attached to the industrial vacuum providing an excellent seal.

Congratulations and thank you for choosing the Paddock industrial vacuum. This manual is an important part of your machine. It provides critical safety information and operating instructions to help you use and maintain your machine safely and correctly.



## 2. SPECIFICATIONS

BRAND	PADDOCK MACHINERY
Function	Wet or dry vacuuming Dust & water collection
Volume	70L
Power	2x 1200W Motors
Voltage	240V 50Hz (Single Phase)
Current Drawer	9 A
Operating Temperature (Max)	60°C
Air Flow	106 L/s
Filtration Size	20 - 25 Micron
Filter Type	Conical cloth sani-filter with spreader
Vacuum Suction	250MBar
IP Rating	IPX4
Cooling	Air Cooled
Noise Levels	85 - 90 dB
Barrel Diameter	44cm
Power Cord	3m
Vacuum Hose Length	2.6m
Hose Diameter	40mm
Includes	Trolley Hand wand 2x heads (wet & dry) Dust separator filter
Warranty	12 Months Australian Warranty

## 3. WARNING

Carefully read and understand all instructions and warnings in this manual before operating the vacuum. Failure to follow the safety precautions may result in serious injury or death.

This product is designed for certain applications only. The manufacturer cannot be responsible for issues arising from modification. It is strongly recommended this product not be modified and/or used for any application other than that for which it was designed. If you have any questions relating to a particular application, DO NOT use the product until you have contacted Paddock Machinery to determine if the vacuum is suitable for the application.



## 4. SAFETY MANAGEMENT PROCEDURES



1. The packaging around the cleaner (plastic bags, clips, ties etc) pose a choking hazard and should be kept out of the reach of children and animals.
2. This machine is not designed to be used by children.
3. The end of the suction hose / accessories must be kept away from your face / body and that of others at all times during operation as the suction created can cause damage to the eyes, ears and mouth in particular.
4. Do not use adapters or multiple sockets, without performing an analysis of the electric voltage and current draw. Consult an electrician if required.
5. If any electrical extension is used, ensure it matches the electrical specifications of the machine and that the connection of the plug with the socket is compliant and sealed.
6. Take care of the electrical cable. It must be protected from water, tears and chemical agents. Do not repair the cable in case of damage but replace it with a new one. All repairs must be done by the manufacturer, service agent or a similarly qualified person.
7. DO NOT pull cable to drag the machine into position or to remove the plug from socket.
8. Only disconnect the power plug when the machine is turned off.
9. DO NOT handle the plug with wet hands.
10. Unplug the cable before servicing machine.
11. Never use flammable liquids or operate machine in or near flammable liquids, vapours or combustible dusts or gases.
12. Should the machine leak liquid or foam, make strange noises or get abnormally hot switch off the machine immediately and take it in for repair / service.

## 5. GENERAL SAFETY

**WARNING:** Read and understand all instructions.

Failure to follow all instructions listed as follows may result in serious injury or death.

**CAUTION:** Do not allow persons to operate or assemble this vacuum until they have read this manual and have developed a thorough understanding of how the vacuum works.

**WARNING:** The warnings, cautions, and instructions discussed in this manual cannot cover all possible conditions or situations that could occur. It must be understood by the operator that common sense and caution are factors which cannot be built into this product but must be supplied by the operator.



## WORK AREA

1. Keep work area clean, free of clutter and well-lit. Cluttered and dark work areas can cause accidents.
2. Keep children and bystanders away while operating the vacuum. Distractions can cause you to lose control, so visitors should remain at a safe distance from the work area.
3. Be alert of your surroundings.

## PERSONAL SAFETY

1. Stay alert, watch what you are doing and use common sense when using the vacuum. Do not use the vacuum while you are tired or under the influence of drugs, alcohol or medication. A moment of inattention while operating the vacuum may result in serious personal injury.
2. Dress properly. Do not wear loose clothing, dangling objects, or jewellery. Keep your hair, clothing and gloves away from moving parts. Loose clothes, jewellery or long hair can be caught in moving parts.
3. Use personal safety equipment. Use safety goggles or safety glasses with side shields which comply with current national standards, or when needed, a face shield. Use a dust mask or respirator if working in dusty work conditions. This applies to all persons in the work area. Also use non-skid safety shoes, hardhat, gloves, dust collection systems, and hearing protection when appropriate.



## VACUUM CLEANER USE AND CARE

1. Do not modify the vacuum in any way. Unauthorized modification may impair the function and/or safety and could affect the life of the equipment. There are specific applications for which the vacuum was designed.
2. Always check for damaged or worn-out parts before using the Vacuum. Broken parts will affect the vacuum operation. Replace or repair damaged or worn parts immediately.
3. Do not exceed the vacuum load capacity.
4. Store idle Vacuum. When the Vacuum is not in use, store it in a secure place out of the reach of children. Inspect it for good working condition prior to storage and before re-use.



## 6. ELECTRICAL REPAIRS

### WARNINGS:

1. All electrical repairs must be performed by qualified person only!
2. Paddock cannot be held responsible for any damage/injury caused to persons or property, because of the incorrect use of the machine.



## 7. EQUIPMENT SAFETY GUIDELINES

1. Improper connection of the equipment-grounding conductor can result in a risk of electric shock., Check with a qualified electrician or service person if you in doubt as to whether the outlet is properly grounded. Do not modify the plug provided with the appliance. If it will not fit the outlet, have a proper outlet installed by a qualified electrician.
2. Make sure that the appliance is connected to an outlet having the same configuration as the plug. No adapter should be used with this appliance. If the appliance must be reconnected for use on a different type of electric circuit the reconnection should be made by a qualified service person.
3. Use of the vacuum cleaner is governed by the laws in force in the country where it is used.
4. Besides the operating instructions and the laws in force in the country where the vacuum cleaner is used, the technical regulations for ensuring safe and correct operation must also be observed.
5. Do not carry out any operation that could jeopardize the safety of people, property and the environment.
6. This equipment is dangerous to children and persons unfamiliar with its operation. The operator should be a responsible, properly trained and physically able person familiar with machinery and trained in this equipment's operations.
7. Personal protection equipment including hardhat, safety glasses, safety shoes, and gloves are recommended during assembly, installation, operation, adjustment, maintenance, repairing, removal, or moving the implement. Do not allow long hair, loose fitting clothing, or jewellery to be around the equipment.
8. Do not modify the equipment in any way. Unauthorized modification could result in serious injury or death and may impair the function and life of the equipment.
9. PADDOCK Machinery, or any of its subsidiaries will not be held liable for any damages, losses or injury due to the misapplication or misuse of this product or for any other reason. Always wear ANSI approved safety glasses, protective clothing, and proper hand and foot protection always. Keep all people, pets or animals, clear from work area.
10. Always leave enough room around the vacuum cleaner to reach the controls easily.
11. Abide by the maintenance schedule.



## 8. GENERAL INFORMATION & PROPER USES

1. This Vacuum cleaner is suitable for commercial use, in hotels schools, hospitals, factories, shops, offices and apartment hotels/complexes.
2. This vacuum cleaner is suitable for cleaning and vacuuming solid materials in indoor and outdoor environments.
3. The vacuum cleaner has been designed to be used by one operator only.
4. This vacuum cleaner consists of an automated vacuum unit, with a filter upstream and a container for collecting the vacuumed material.

## IMPROPER USES

1. Outdoors in case of atmospheric precipitation.
2. When placed on uneven surfaces.
3. When the filtering unit is not installed.
4. When the vacuum inlet and/or hose are placed on parts of the human body.
5. Use without the cover on the vacuum unit.
6. Use without guards protective covers and safety systems installed by the manufacturer
7. When the cooling vents are partially or totally clogged.
8. When the vacuum cleaner is covered with plastic or fabric sheets.
9. Use with the air outlet partially or totally closed.
10. When used in narrow areas where there is no fresh air.
11. Vacuuming liquids with vacuum cleaners without liquid level monitoring function.
12. Vacuuming the following materials:
  - a. Burning materials (embers, hot ashes, lit cigarettes, etc.).
  - b. Naked flames,
  - c. Combustible gas
  - d. Flammable Liquids
  - e. Explosive Dust

## 9. OPERATION

1. Lift the machine out of the box by gently angling the box and pulling the vacuum cleaner from the carton, using its handle.
2. Insert the flexible hose into the tank inlet and press until you hear a click as it locks into place. Unclip the two clips on the side of the motor head and lift the motor from the tank.
3. **Preparation for Use:** Fit the hose into the suction hose connection until it clicks. Assemble the suction tubes and fit to the hose. Fit correct accessory to suction tube.
4. **Turning on/off:** There are two switches that come with this vacuum cleaner. Each switch controls a motor engaging both switches will increase the suction of the vacuum cleaner. Turn on either one or both motors depending on the suction required.



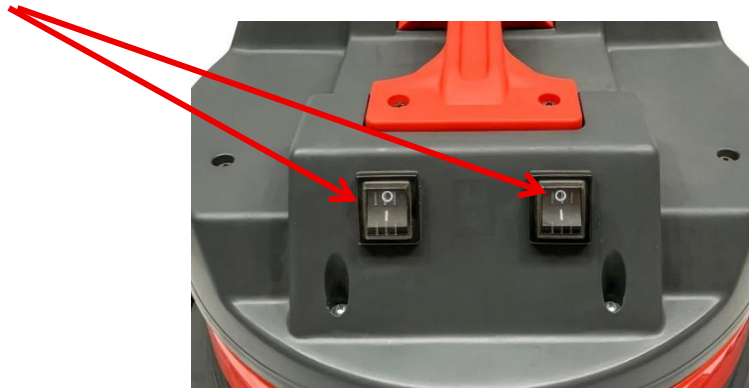

5. **Filter Usage:** Fit fabric filter in tank for suction of dry dust. Remove fabric filter from tank for suction of liquids if your machine is a wet/dry model.
6. **Wet & Dry vacuuming:** This vacuum cleaner comes with a kink resistant vac hose and two heads (1x wet head, 1x dry head).
  - a. If dry vacuuming – Ensure that cloth filter and its bag support ring are fitted into the top of the tank.
  - b. If wet vacuuming – Remove the dust separator and its support rack and replace motor head back on the tank and clip into place.
7. **After Use (Dry Vacuuming):** Empty tank after use.
  - a. Shake filter bag to dislodge dust before removing from tank.
  - b. **NEVER** bang the vacuum tank onto surfaces to remove dust or debris as this will damage the tank edge and seal.

***MUST: After (Dry Vacuuming) thoroughly clean out before reassembling the unit and using as Wet Vacuum. Especially after vacuuming concrete dust.***

8. **After Use (Wet Vacuuming):** To empty the tank when wet vacuuming there is a sewage pipe located on the tank. Unclip this, remove the plug cap and drain the waste water. Replace the cap and clip back onto the tank. **DO NOT** allow wet concrete dust to sit inside the machine after use.

***MUST: After (Wet Vacuuming) allow machine to completely dry out before reassembling the unit.***

***Refer to Figure 18 & 19 on the diagram on Page 11. Part 18 must be free to always move in Part 19. If obstructed/blocked this will cause potential damage to the machine.***

9. **Maintenance and Cleaning:**
  - a. **Attention:** Remove plug from socket before any maintenance operation on the head of the machine.
  - b. Check the filter bag for holes or signs of wear and tear to avoid microscopic particles entering your motor.
  - c. Empty and clean filter bag after every use. (If cleaning with water ensure that it is dry before you replace it.
  - d. Clean the rubber which is in the cover of the head.

- e. Check the hoses and electric cable.
- f. We recommend that the carbon brushes on your motor are replaced every 200 hours.



## 10. TROUBLESHOOTING

PROBLEM	CAUSE	REMEDY
<b>The vacuum cleaner does not start</b>	Lack of power supply	Check for power at the socket.  Check the condition of the socket and the cable. Ask for assistance to be performed by a qualified manufacturer's technician.
<b>The vacuum cleaner motors increase in rpm</b>	Clogged primary filter	Replace filter or clean out disturbing debris in the filter.
	Clogged vacuum hose	Check the vacuum hose and clean it.
<b>Dust leaks from the vacuum cleaner</b>	The filter is torn	Replace it with another of identical type.
	Inadequate filter	Replace it with another of a suitable category and check.
<b>Noisy motors</b>	Motor brushes (carbon) worn or broken	Remove and replace the (carbon) motor brushes.
<b>Electrostatic shock coming from the vacuum cleaner</b>	Non existent or insufficient grounding	Check all ground connections. In particular on the vacuum inlet fitting; replace the hose with an antistatic hose.



## 11. EXPLODED PARTS DIAGRAM

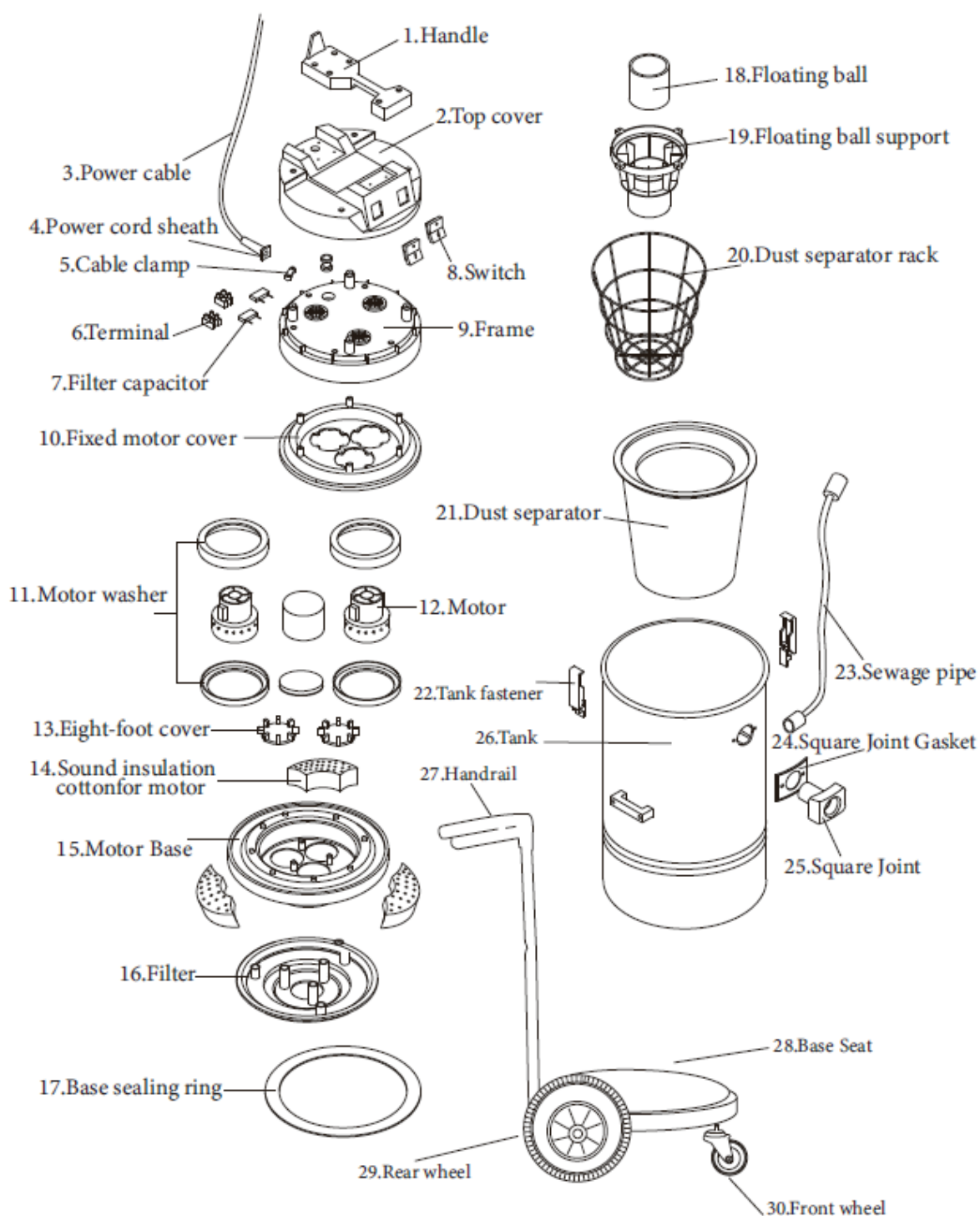

***Part 18 must be free to always move in Part 19. If obstructed/blocked this will cause potential damage to the machine.***

## 12. WARRANTY INFORMATION

The below information is an addition to information covered under the standard Terms and Conditions of sale at your place of purchase.

**VACUUM** – Is warranted for manufacturing faults and defects for a period of 12 months from date of purchase.

**ACCESSORIES / ATTACHMENTS** – 12 months

**EXCLUSIONS** - Normal wearing parts and consumables are not covered by warranty. Examples include: filters, hoses, tires. Equipment damaged, misused, not maintained, adjusted incorrectly, effected by fire, rain, accident or flood will not be covered by warranty.

## 13. SUPPORT INFORMATION

### SALES ENQUIRIES:

P: 1300 246 406

E: [info@paddockmachinery.com](mailto:info@paddockmachinery.com)



### SUPPORT REQUESTS

Via the website support request - [www.paddockmachinery.com](http://www.paddockmachinery.com)

### ADDRESS:

47 Eagleview Place

Eagle Farm QLD 4009

Australia